

# ASSEMBLY INSTRUCTIONS

## DINING TABLE

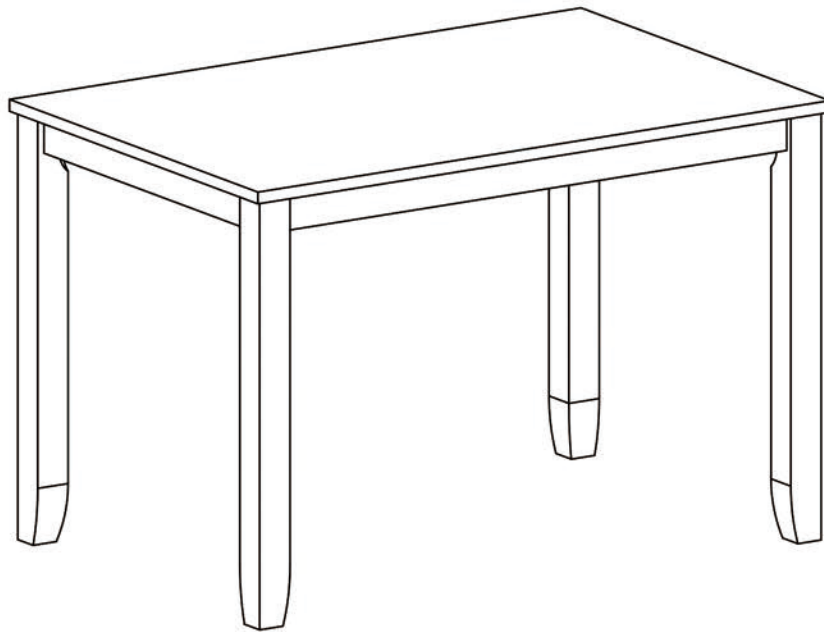

### **IMPORTANT NOTE:**

- PLACE ALL PARTS ON A CLEAN AND SMOOTH SURFACE SUCH AS A RUG OR CARPET TO AVOID THE PARTS FROM BEING SCRATCHED.
- BEFORE YOU BEGIN, KINDLY FOLLOW THE ASSEMBLY INSTRUCTIONS STEP BY STEP.
- DO NOT TIGHTEN ALL SCREWS AND BOLTS UNTIL THE TABLE IS FULLY SET-UP.

## CARTON CONTENT:



1 x 1



2 x 4

### TABLE PART LISTS

NO.	DESCRIPTION	SKETCH	QTY
1	TABLE TOP		1 PC
2	TABLE LEG		4 PCS

### TABLE HARDWARE LISTS

NO.	DESCRIPTION	SKETCH	QTY
A	HEX COMB 5/16 x 2 1/2"		8 PCS
B	SPRING WASHER 5/16"		8 PCS
C	FLAT WASHER 5/16"		8 PCS
D	SPANNER 12.8		1 PC

## ASSEMBLY INSTRUCTIONS

### STEP 1

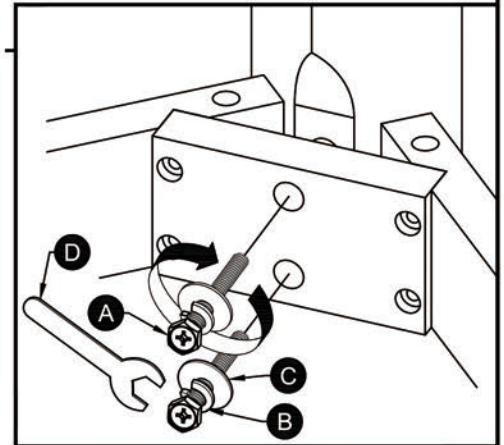
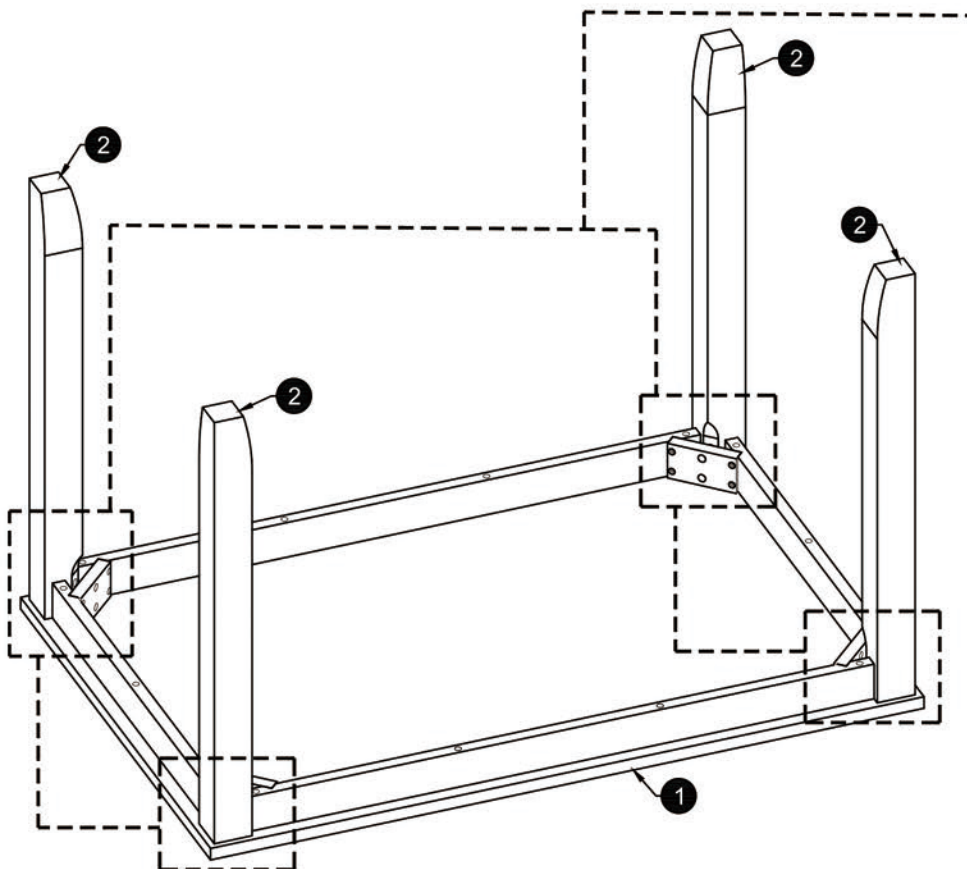

ASSEMBLY  
COMPLETE !

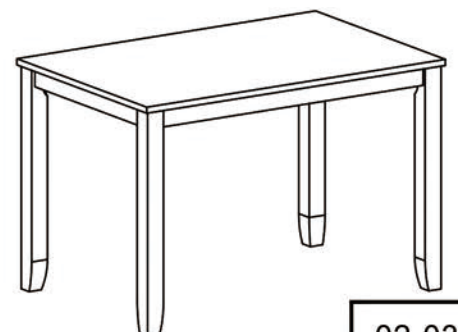

# ASSEMBLY INSTRUCTIONS

## DINING CHAIR

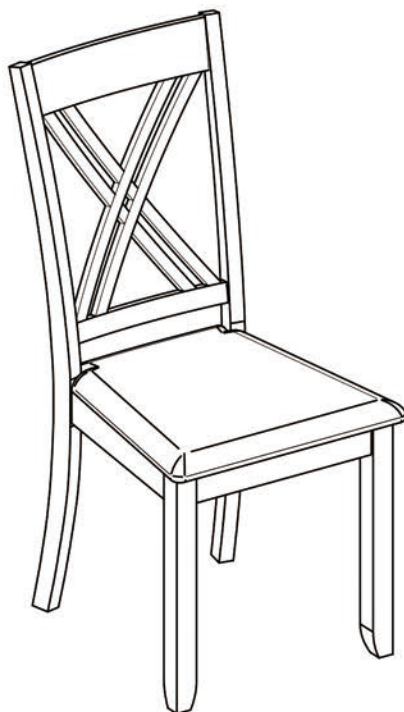

### **IMPORTANT NOTE:**

- PLACE ALL PARTS ON A CLEAN AND SMOOTH SURFACE SUCH AS A RUG OR CARPET TO AVOID THE PARTS FROM BEING SCRATCHED.
- BEFORE YOU BEGIN, KINDLY FOLLOW THE ASSEMBLY INSTRUCTIONS STEP BY STEP.
- DO NOT TIGHTEN ALL SCREWS AND BOLTS UNTIL THE CHAIR IS FULLY SET-UP.

CARTON CONTENT:

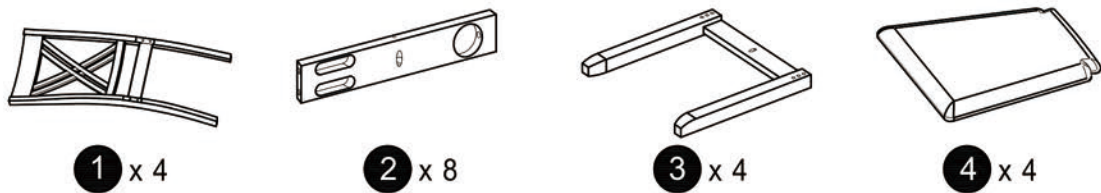

CHAIR PART LISTS				CHAIR HARDWARE LISTS			
NO.	DESCRIPTION	SKETCH	QTY	NO.	DESCRIPTION	SKETCH	QTY
1	BACK LEG		4 PCS	A	JCBC BOLT M6 x 45mm		24 PCS
2	SIDE RAIL		8 PCS	B	SPRING WASHER 1/4"		24 PCS
3	FRONT LEG		4 PCS	C	WOOD DOWEL M8 x 30mm		16 PCS
4	SEAT		4 PCS	D	ALLEN KEY M4		1 PC
				E	C/B SCREW M4 x 30mm		12 PCS

STEP 1

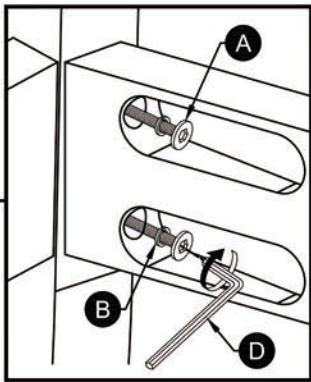
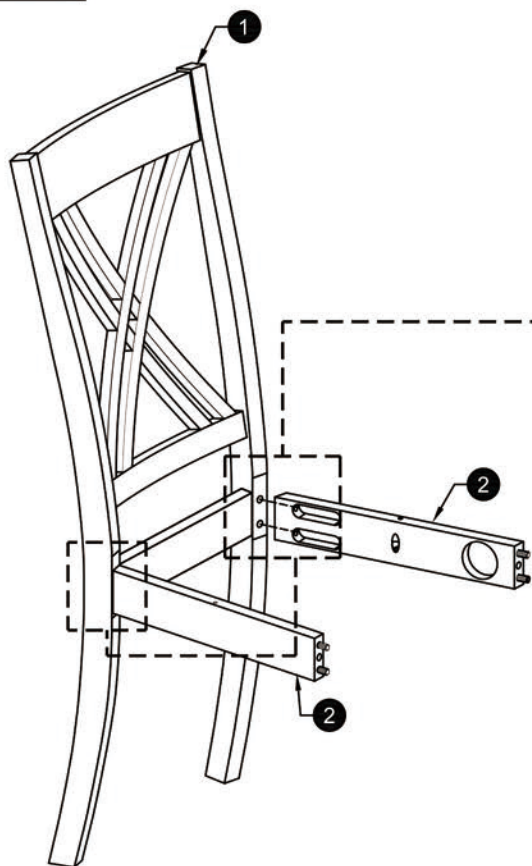



STEP 2

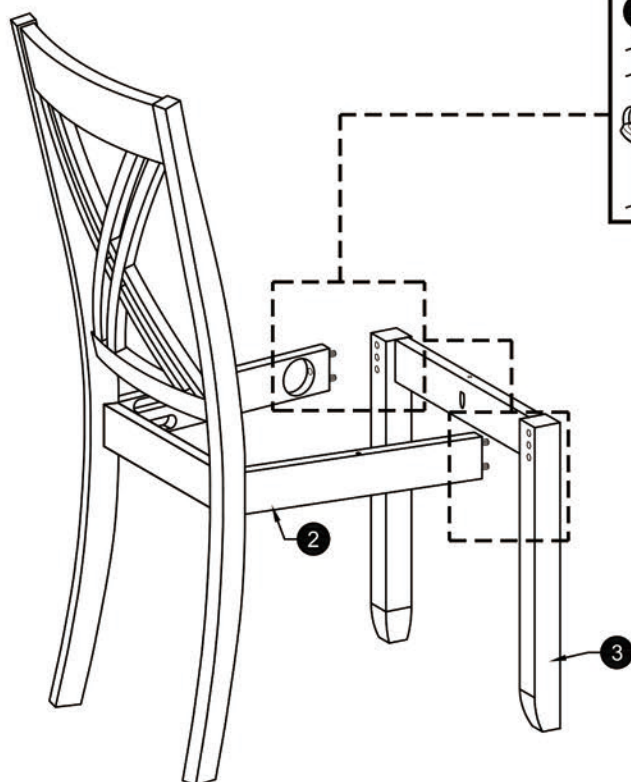

STEP 3

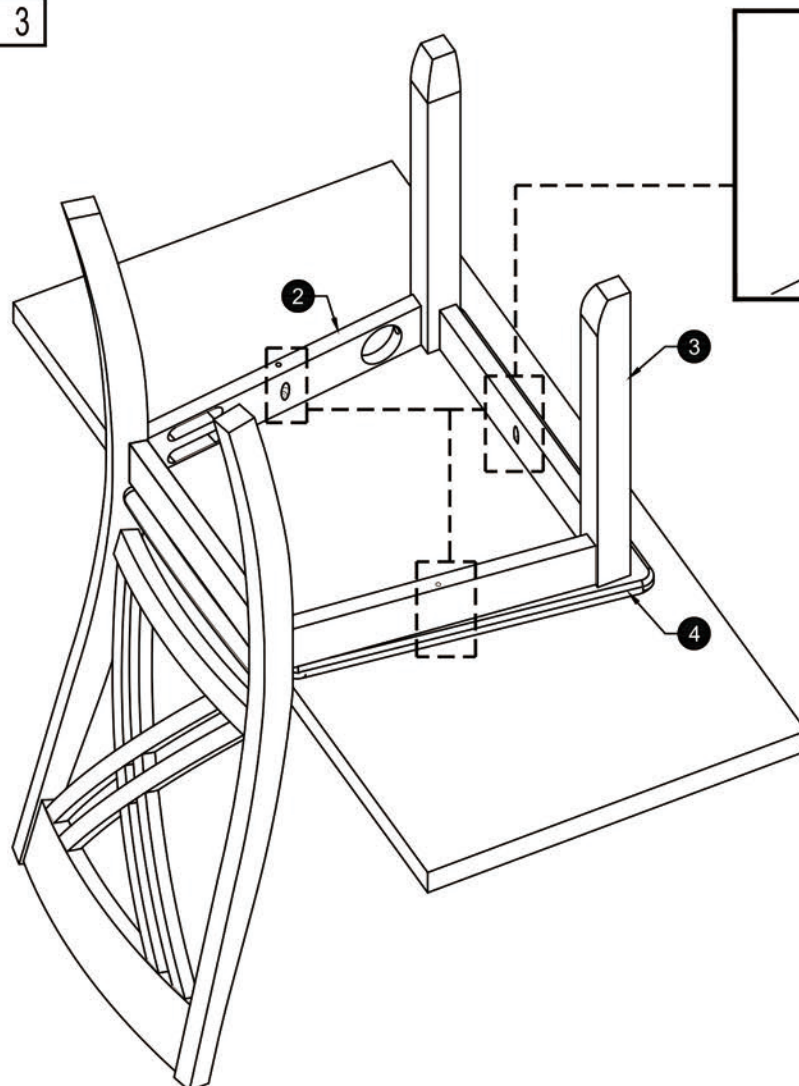

ASSEMBLY  
COMPLETE !

