

Hutch storage

Accessory Package

PLEASE NOTE: Check that you have received all components and hardware before assembling. If you are missing any parts, please contact us for replacement parts.

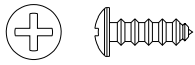

A. 1/2" Flat Head Screw - 31

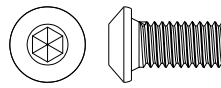

B. 1/2" Small Machine Screw - 8

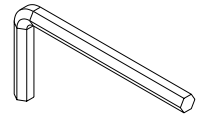

C. Wrench - 1

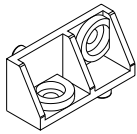

D. Plastic Angle code - 4



E. EXTENSION RAIL - 2



F. Cam Screw - 9

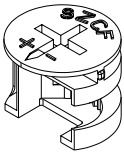

G. Cam Lock - 9

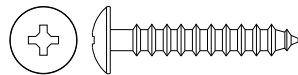

H. 1" Flat Head Screw - 12

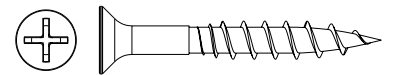

I. 1-1/2" Flat Head Screw - 9

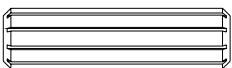

J. Wood Dowel - 14

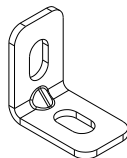

K. Iron Angle code - 2

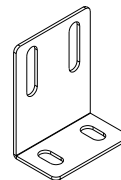

L. L type Angle yards - 3

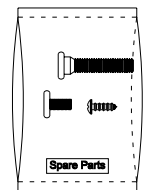

N. Spare Parts - 1

Diagram of Components

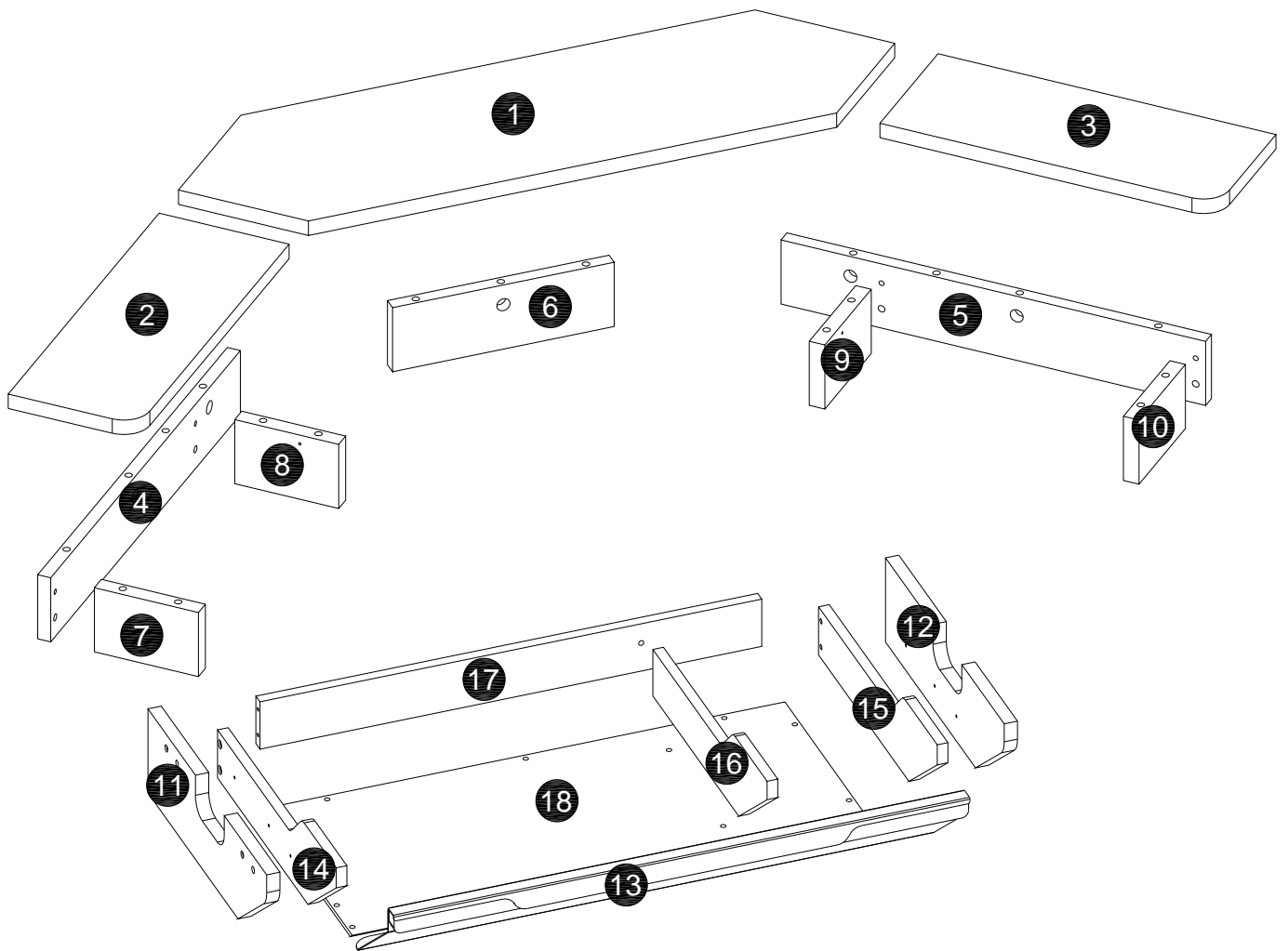

STEP 1

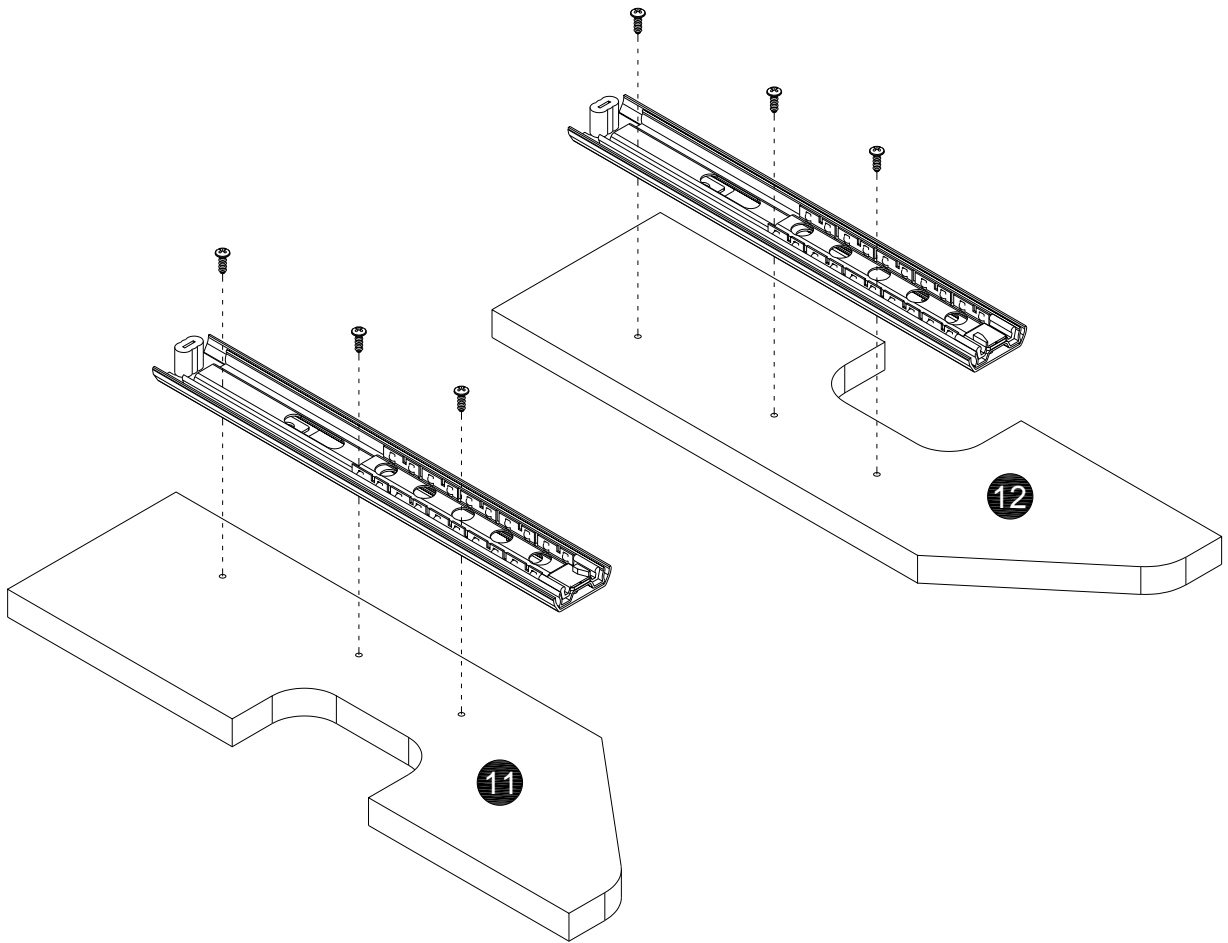
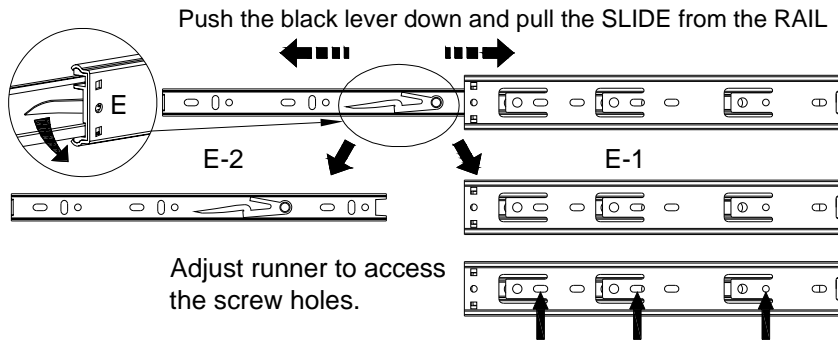

E.EXTENSION RAIL -2



A.1/2"Flat Head Screw- 6

STEP 2

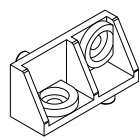
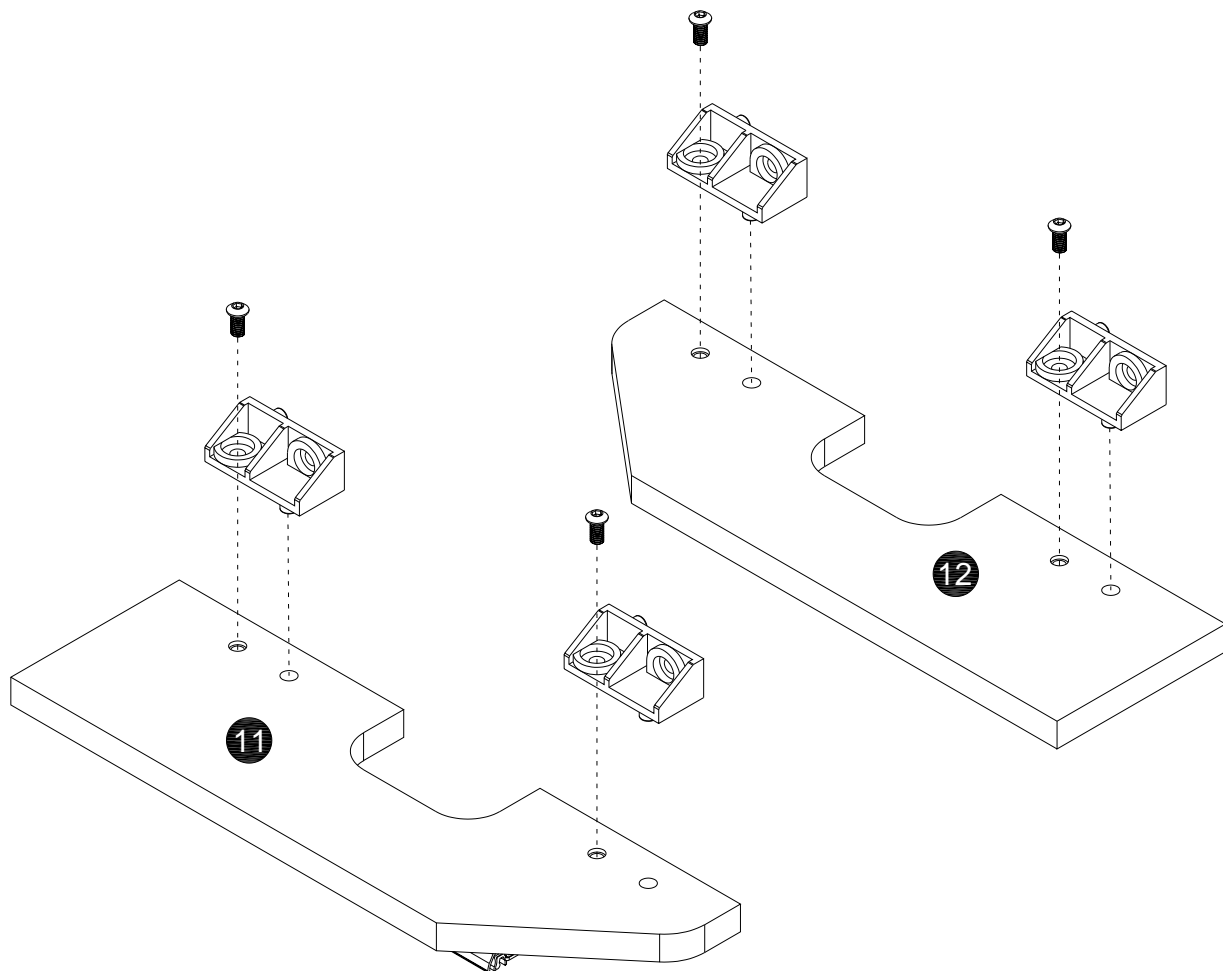

D. Plastic Angle code- 4

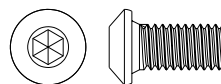

B. 1/2" Small Machine Screw - 4

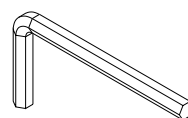

C. Wrench - 1

STEP 3

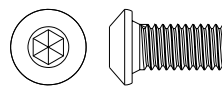
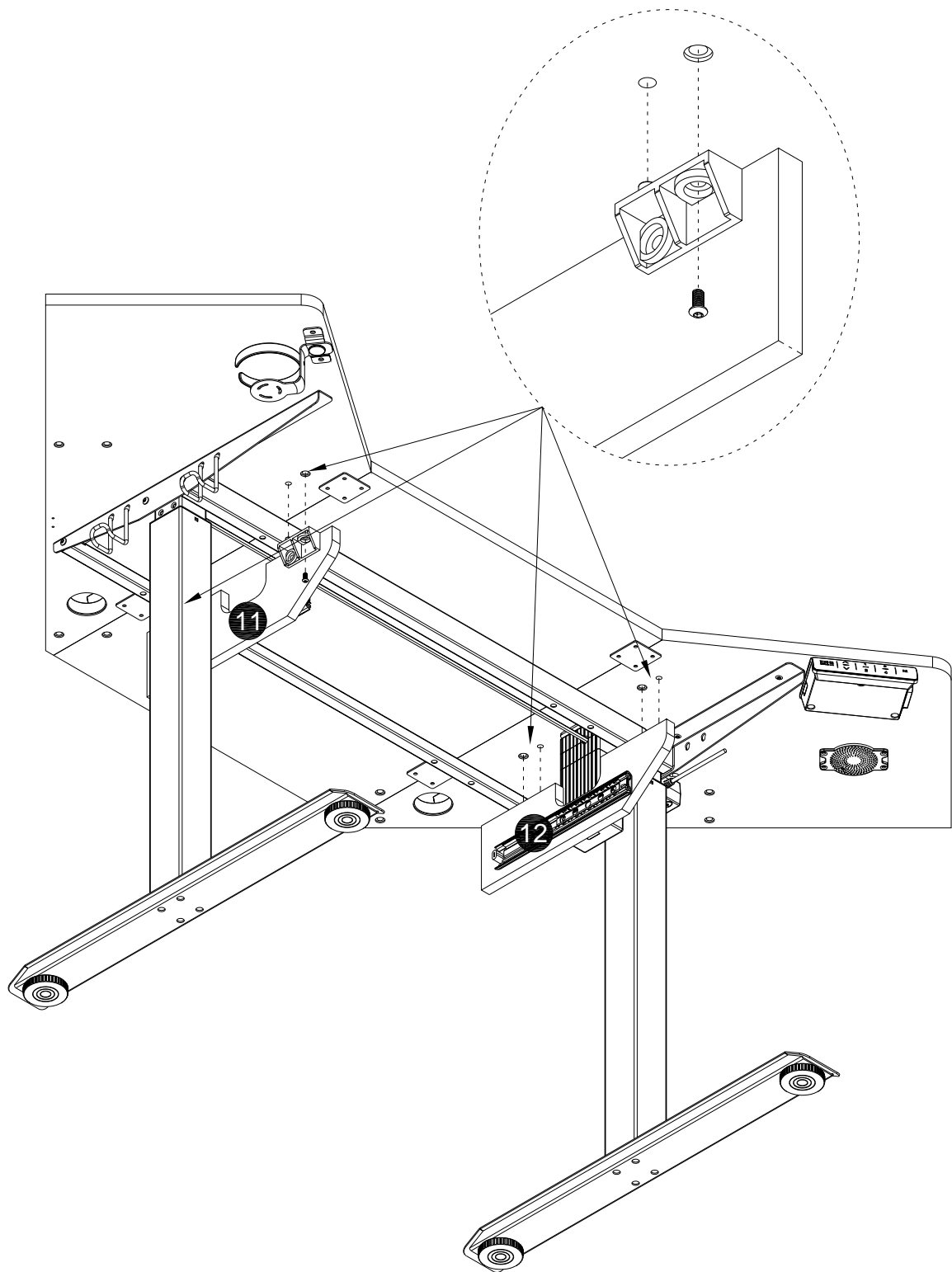

B. 1/2" Small Machine Screw - 4

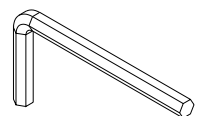

C. Wrench - 1

STEP 4

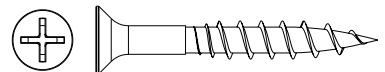
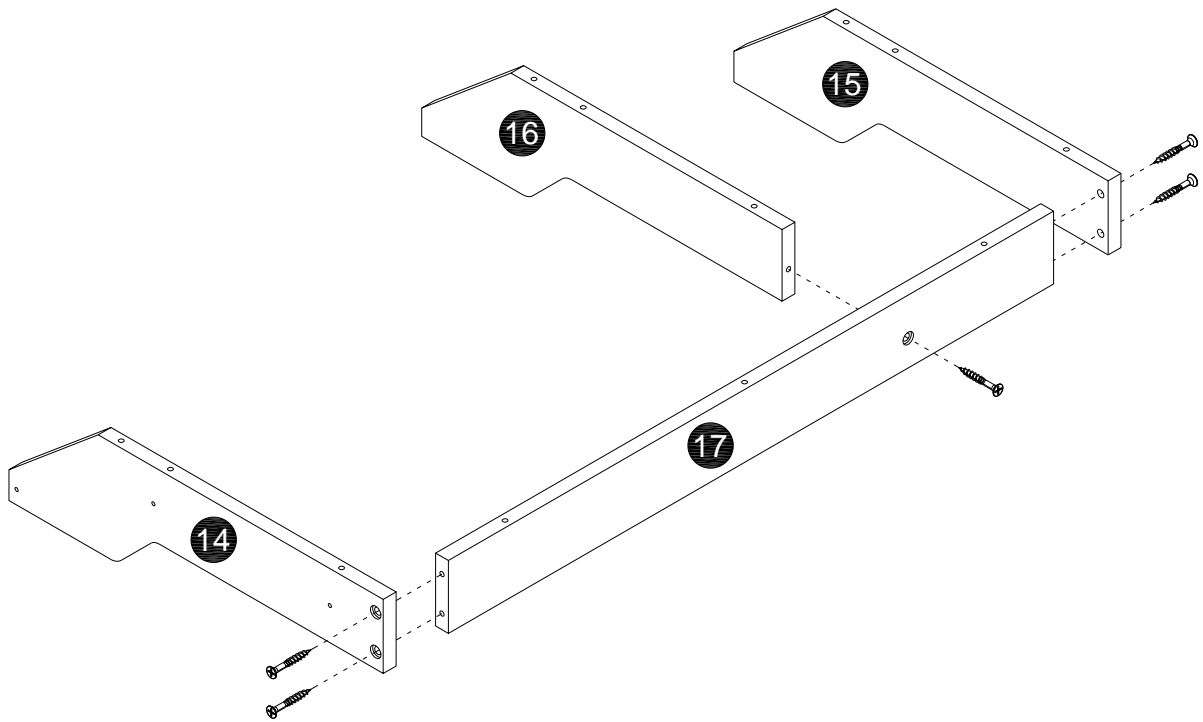

I. 1-1/2" Flat Head Screw- 5

STEP 5

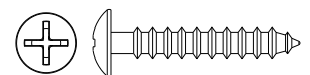
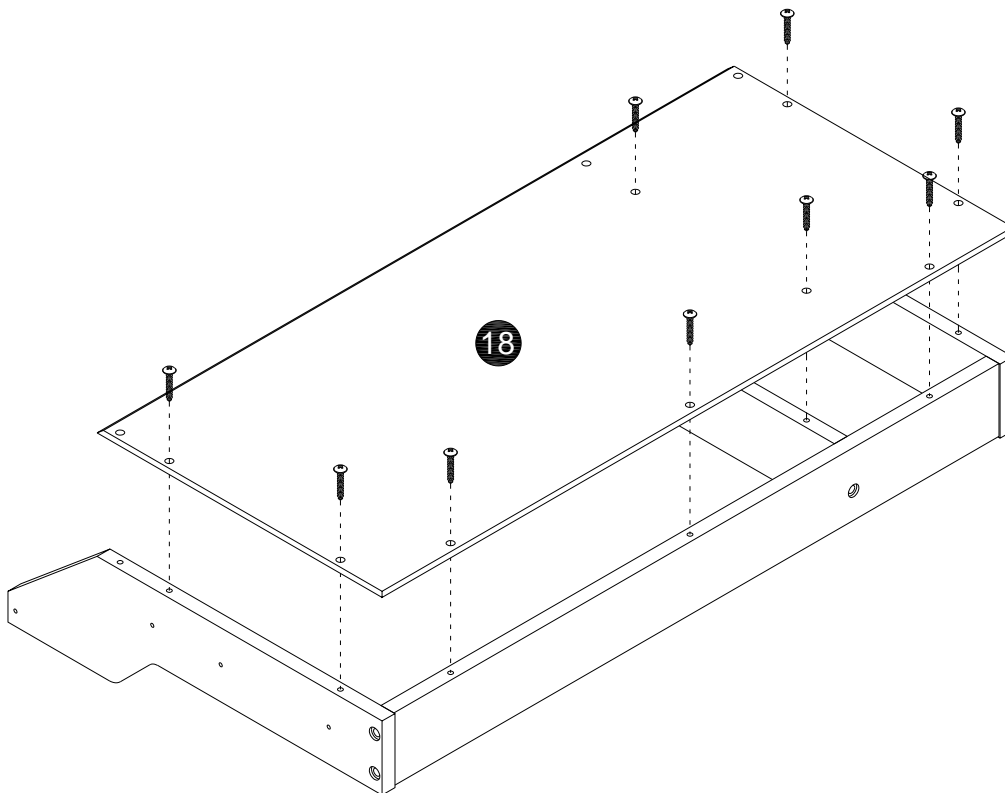

H. 1" Flat Head Screw- 9

STEP 6

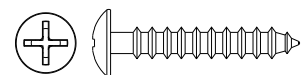
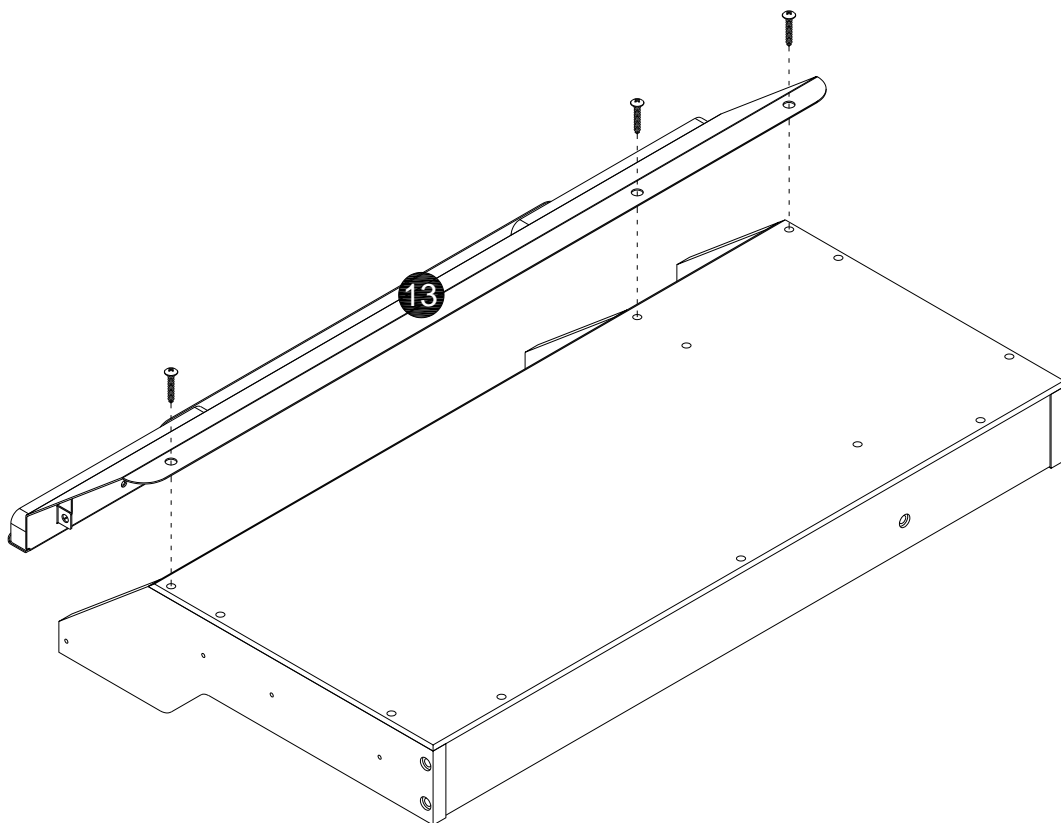

H. 1" Flat Head Screw- 3

STEP 7

Adjust runner to access the screw holes.

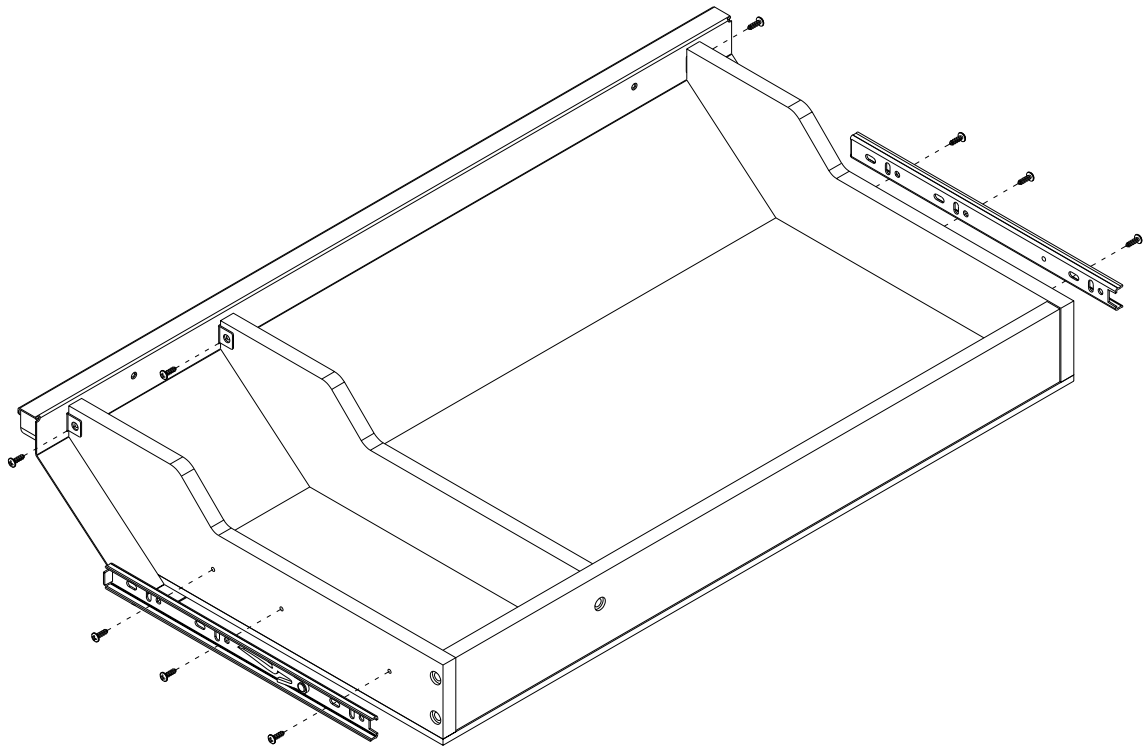

E.EXTENSION RAIL -2

A.1/2"Flat Head Screw- 9

STEP 8

MAXIMUM LOAD
9 kg / 20 lbs

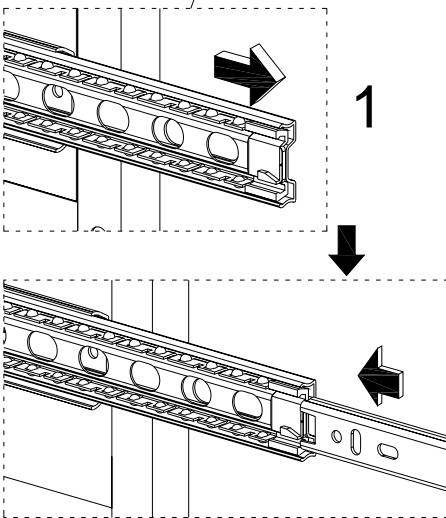
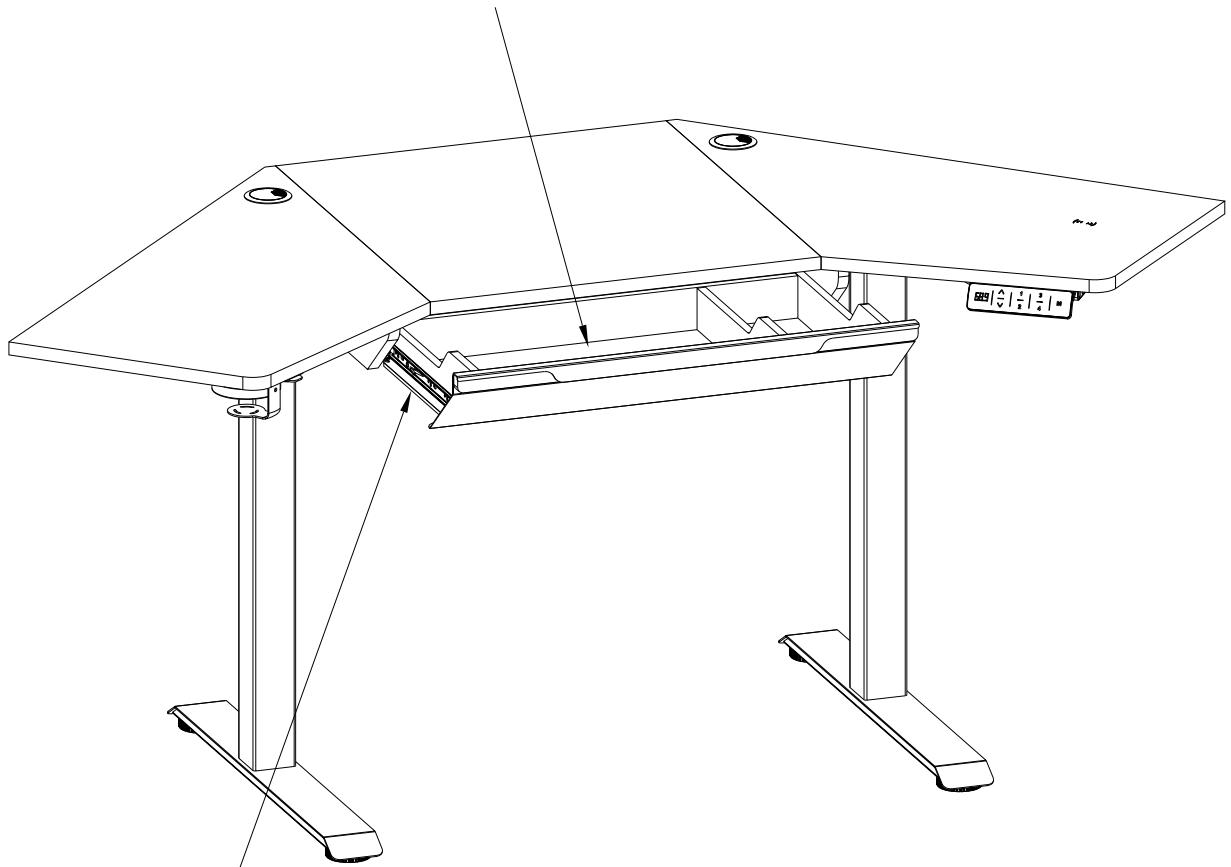

Carefully stand your unit upright.

To insert the drawer into your unit, line up the EXTENSION SLIDES on the drawer with the EXTENSION RAILS on the

unit and push the drawer into the unit until the drawer is fully inserted. The drawer will push in hard until it is all the way in, then it will slide in and out easier.

STEP 9

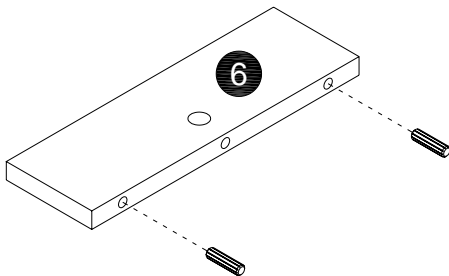
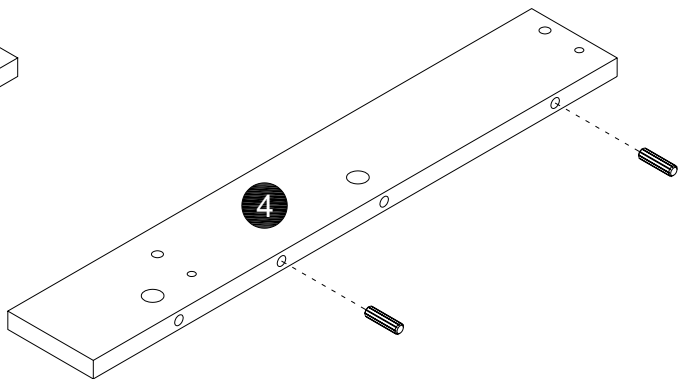
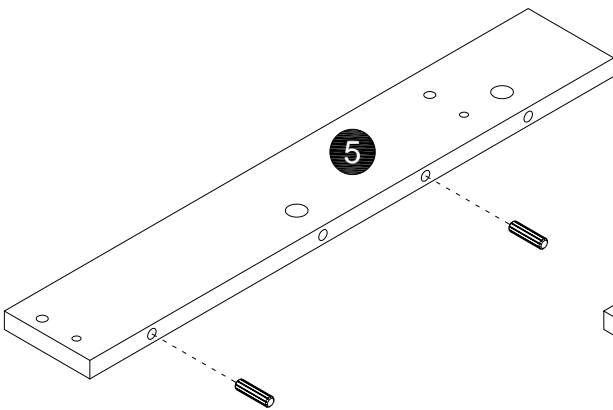
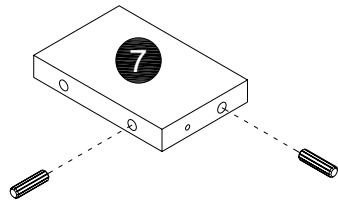
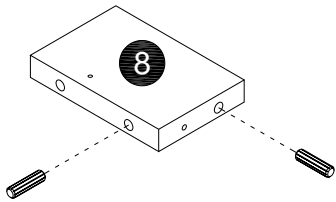
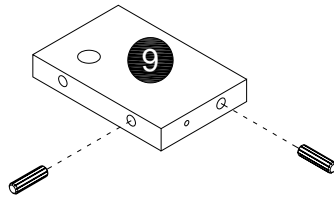
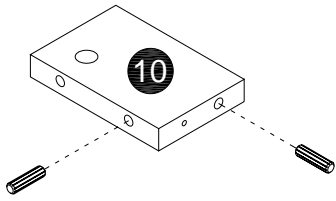

J.Wood Dowel - 14

STEP 10

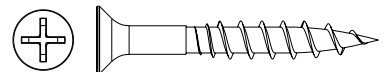
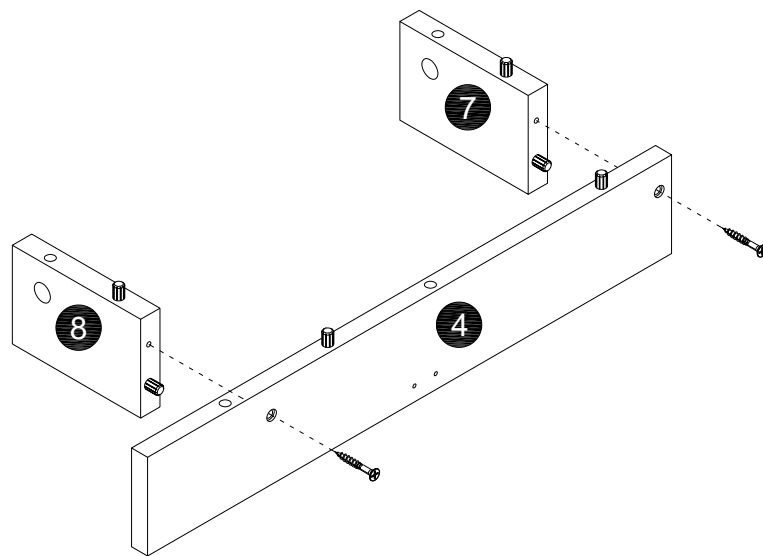
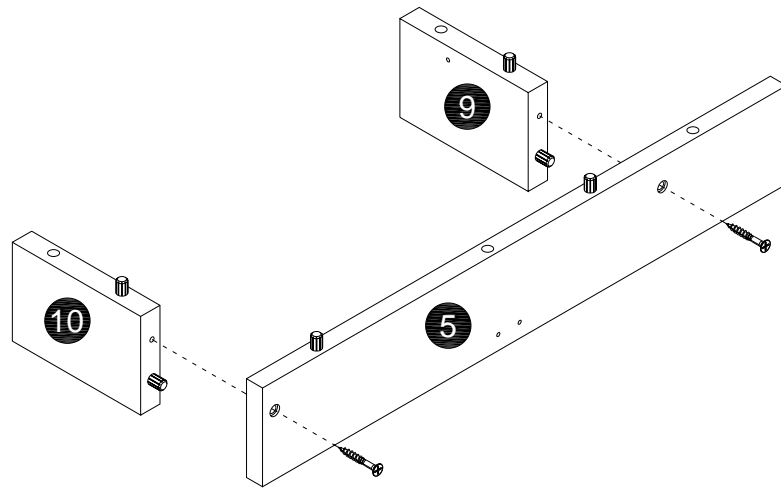

I. 1-1/2" Flat Head Screw- 4

STEP 11

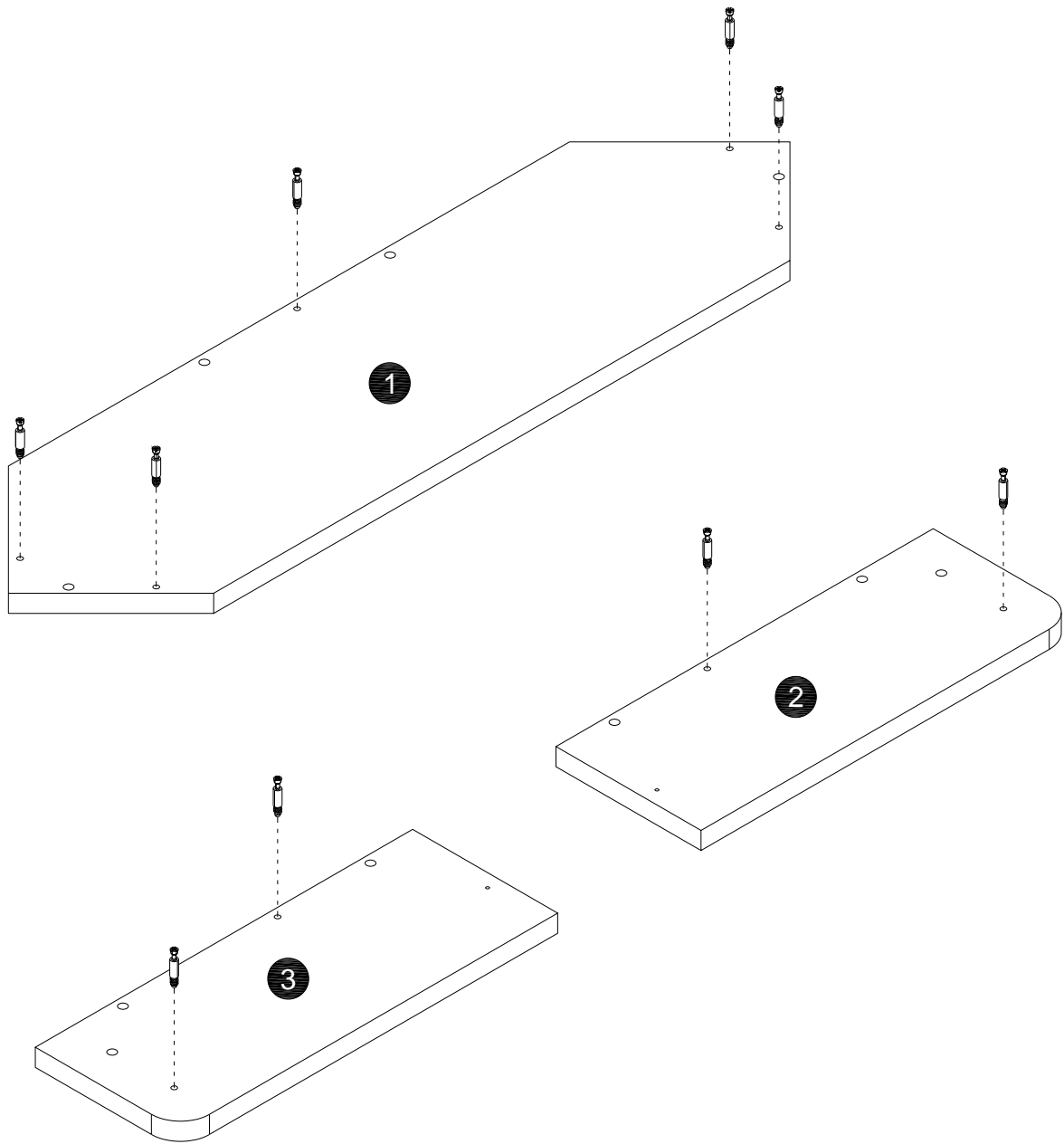

F.Cam Screw - 9

STEP 12

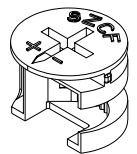
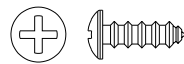
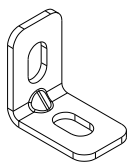
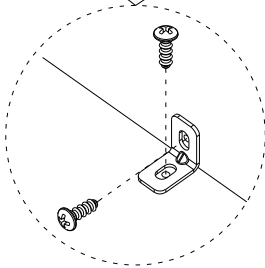
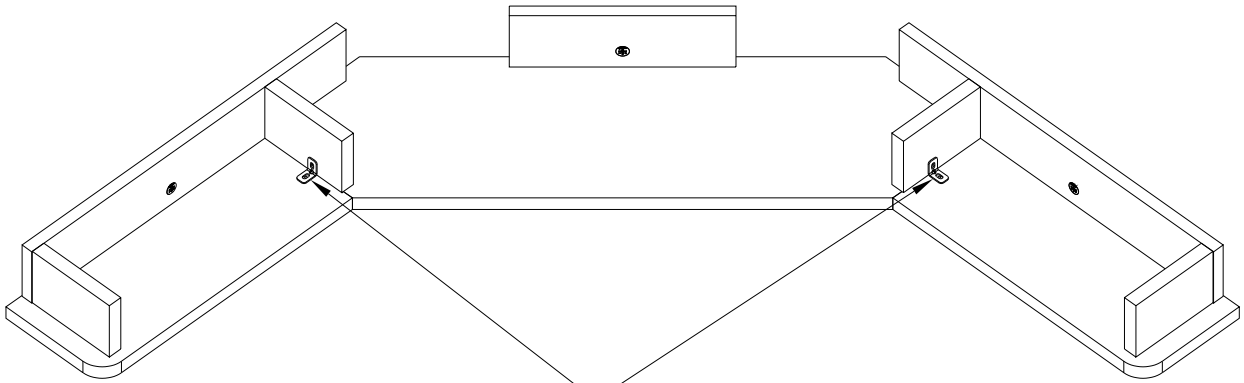
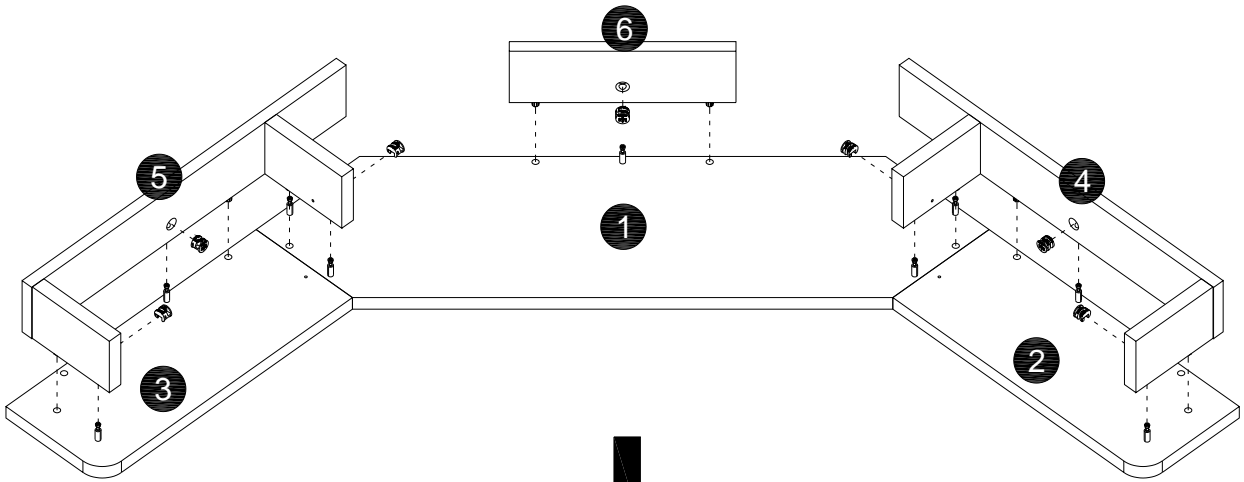
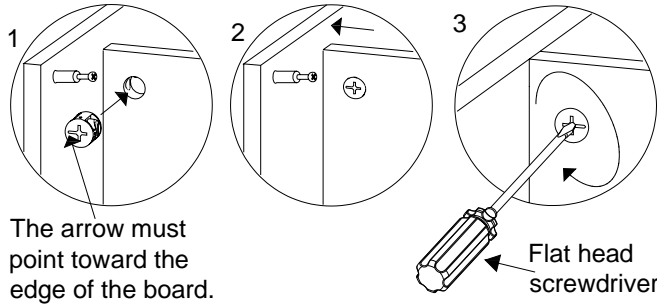

K.Iron Angle code - 2

A.1/2"Flat Head Screw- 4

G.Cam Lock - 9

STEP 13

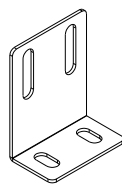
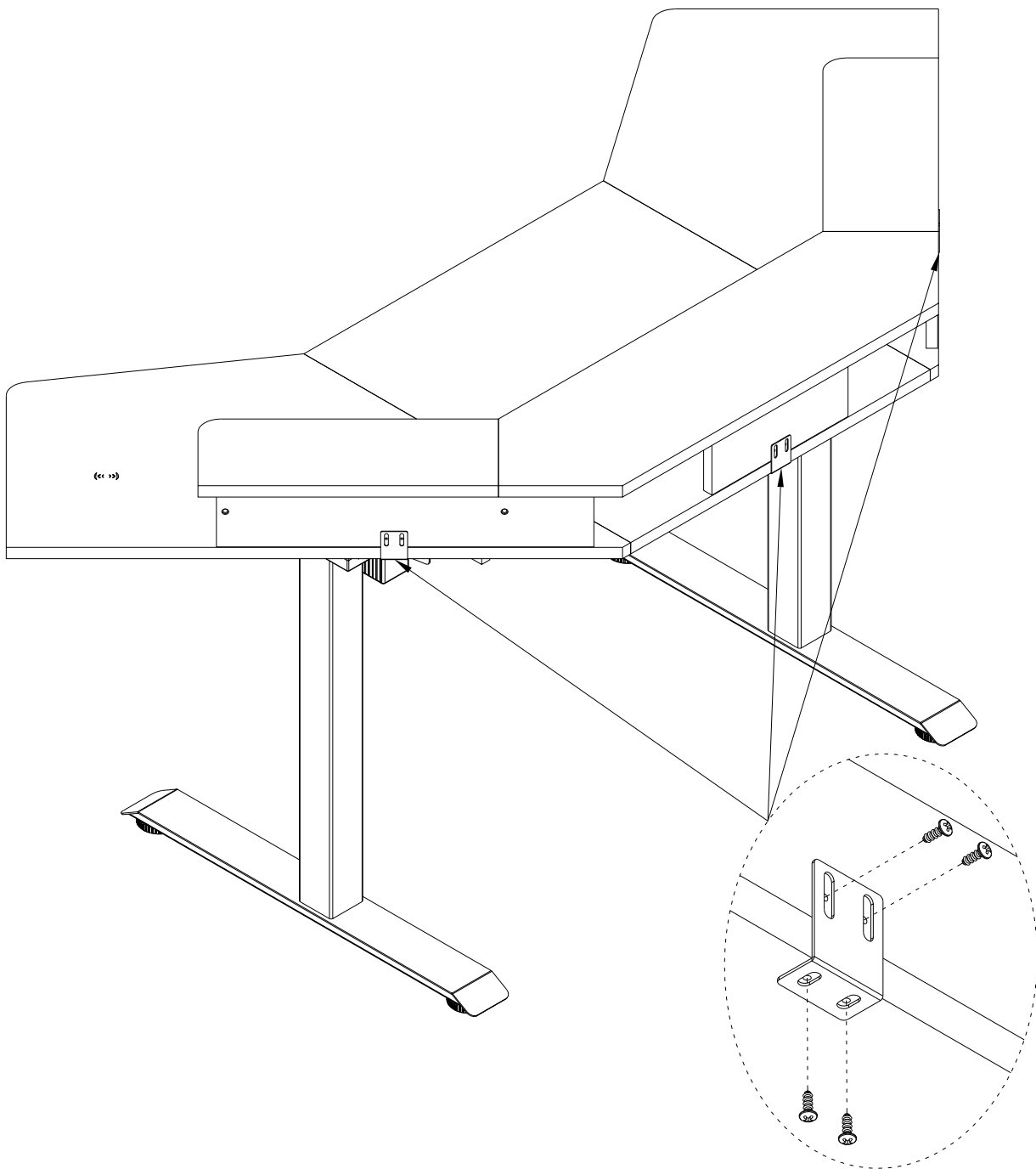

L.L type Angle yards - 3

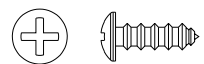

A.1/2" Flat Head Screw- 12

STEP 14

