

Product Information

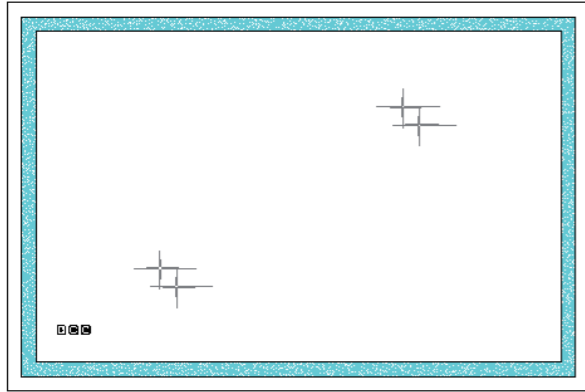

For easy installation of your Mirror please do the following: Thoroughly read all instructions before installing the enclosed product. Read and take note of all safety, care, and maintenance information.

PLEASE KEEP THIS INSTRUCTION MANUAL FOR FUTURE REFERENCE FOR PRODUCT OPERATION AND MAINTENANCE.

Product Features

Frameless Light Mirror
Extra thick frosted LED light
Can be hung vertical or horizontal
Touch switch on & off / dim function
Anti-fog pad

please send an E-mail with your order No. & issues to our customer service, we will respond within 24 hours, Customer Service Team: support@idealhouse.vip



Warning: Please read!

1. The mirror should be installed by a professional installer.
2. It is recommended to have at least two people available to install the mirror. All mirror glass is Explosion-proof glass, but it is better to wear proper protective gear during installation in case to be hurt by sharp shards if the glass suddenly shatters.
3. Using the included proper anchor and screws for securing the unit to the wall is crucial. Screwing to the stud is recommended.

Product List



LED Mirror*1



hang strip*1



Plastic expansion bolt *3



Screws*3



Insulated terminal*3



glove*1



Horizontal ruler*1



Instructions*1



Magnifying makeup mirror*1
(Optional for some models, non-standard configuration)

Tools and Materials Request



Tape measure



Horizontal ruler



Drill



Drill bit



Pencil



Glass cement

Warning: Always keep power off during installation and maintenance, do not turn on the power until the installation is complete.

Installation Instruction

Please decide to hang your mirror in vertical or horizontal, it is better to have one more person help you install the mirror together.

1

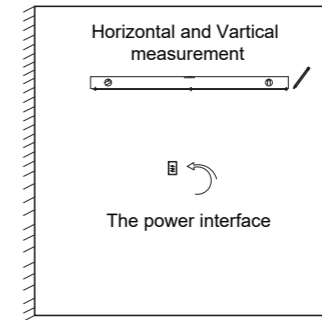

Step 1: Take out the hanging strips that come with the packaging, choose a suitable height on the installation wall, and use a level to do a parallel test to ensure that the screw holes at both ends of the hanging strips are positioned parallel, and mark the holes on the wall with a pencil.

2

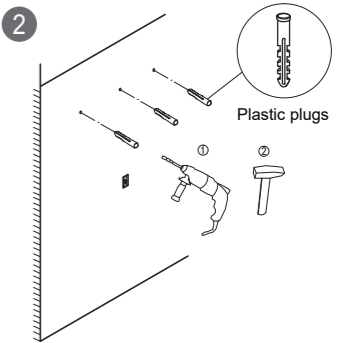

Step 2: Use an electric drill to drill a hole at the marked position, and hammer the expansion tube into the hole.

3

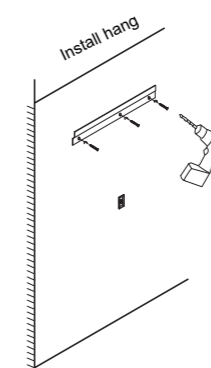

Step 3: Align the hole on the hanging bar with the expansion tube, and screw the screw into the expansion tube with a hand electric drill to fix the hanging bar.

4

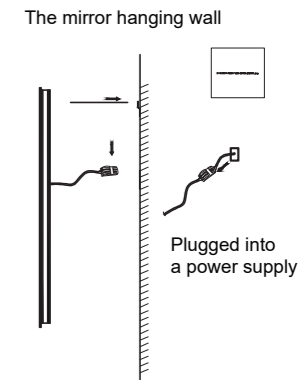

Step 4: It must be operated by a professional licensed electrician.



you can directly use the plug that comes with the mirror to connect to the wall socket



or cut the plug and use the inner core wire to connect, the green is connected to the ground wire, the white is connected to the neutral wire, and the black is connected to the fire wire. The insulated terminal wraps the wire ends; then turn on the power and debug.

5

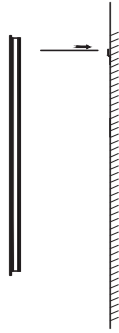

Step 5: Hang the LED mirror to the hang strips, confirm it hangs well.

6

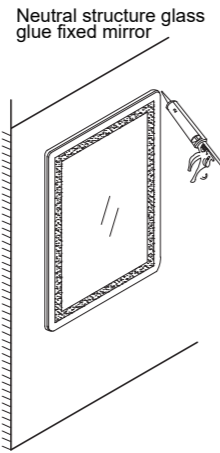

Step 6: Use neutral glass glue to reinforce the lower edge of the back frame.

Functional test



Short press to turn on/off defogger, automatic shut down after 60 minutes.



Short press to turn on/off LED strip, long press for dimming brightness from % to 100%.



Short press to switch CCT (Warm light-warm and white light-white light); long press for stepless CCT adjustment



Button indicator light description: white when starting up, 100% brightness, 30% brightness when shutting down; land 30% brightness when clicking again. The switch has a power-off memory function.

Trouble shooting

Missing/Wrong/Broken parts and installation issues

Send email with your question pic, order NO. and screenshot of order details to: support@idealhouse.vip

Respond within 24 hours

Issue resolved

Common problems and solutions

serial number	problems	possible causes	solutions
1	* press light button, no light on * touch switch, no response	1. not correctly connect the power line 2. power drive has problems	1. Check that the power port is correctly connected and powered on 2. Check the electronic circuit between electronic parts connect well or loose. 3. Replace the power drive
2	* the button light is on, Mirror light not power on, or no response after touching	1. The connection between the light strip and the switch is loose 2. light strip is broken 3. Control switch no works	1. Check the connection between the control switch and the light strip is loose 2. Replacement light strip 3. Change control switch
3	* Light on, anti-fog film does not heat	1. The anti-fog film no work 2. The relay no works	Replace the anti-fog film or relay
4	* The button light is on, the light is also on, but the touch control button is not sensitive	* The position of the touch switch and the lens logo is not accurate.	Readjust the position of the touch control button accordingly