

4" USB Desk Fan



DF0004

Batch code:

Please read these instructions carefully before use and retain for future reference

Before switching on you appliance

Always check for any damage which may have been caused in transit

CONTENTS

Important Safety Instructions.....	2-3
Appliance Overview.....	4
Operating Instructions.....	4
Cleaning and Maintenance.....	5
Trouble Shooting Guide.....	5
Disposal Information.....	5
Terms and Conditions and Warranty Information.....	6-7

IMPORTANT SAFETY INSTRUCTIONS

Read and follow all of the instructions even if you feel you are familiar with the appliance, and find a place to keep this manual handy for future reference

Important: This appliance is intended for domestic use only. When using electrical appliances, basic safety precautions should always be followed:

1. Please remove packaging and check to see if there is any damage to the appliance before use.
2. Do not operate the appliance with a damaged USB cable, after it malfunctions or has been dropped or damaged in anyway. All electrical repairs must be carried out by a qualified electrician. Inadequate repairs may result in a major source of danger for the user and invalidate the warranty.
3. Incorrect use of this appliance may cause damage to the appliance or any products that it may be connected to.
4. Please check the USB plug for faults before connecting to other USB ports as it may cause damage to the appliance or your product.
5. This appliance can be connected to the mains via a DC5V power adaptor.
6. This appliance can be used by children aged from 8 years and above if they have been given supervision or instruction concerning the use of the appliance in a safe way and understand the hazards involved.

7. Cleaning and user maintenance shall not be made by children.
8. Keep the appliance and its cable out of reach of children.
9. Children shall not play with the appliance.
10. Appliances can be used by persons with reduced physical, sensory or mental capabilities or lack of experience and knowledge if they have been given supervision or instruction concerning use of the appliance in a safe way and understand the hazards involved.
11. Always unplug the appliance before cleaning. When unplugging make sure to grasp by the USB plug and not the cable.
12. This appliance is for indoor use only.
13. If the USB cable is damaged, it must be replaced before further use by a qualified technician otherwise malfunction or injury may occur.
14. Do not immerse the appliance or cable, in liquids.
15. When the appliance is not in use, remove the USB plug from the USB port.
16. Do not use the appliance near a source of heat or on an unstable surface.
17. Do not cover when in use.
18. DO NOT touch the guard surface when the appliance is operational. RISK OF HARM
19. Do not insert any object between the grill into the fan blades.
20. Any type of servicing apart from general cleaning must be done by a qualified technician.
21. Do not attempt to open the appliance; there are no user serviceable parts inside.
22. THIS APPLIANCE MUST BE ATTENDED AT ALL TIMES WHEN IT IS SWITCHED ON.

APPLIANCE OVERVIEW

1. Front Grill
2. Blade
3. Blade axle sleeve
4. Motor
5. Motor hearing
6. Rear Grill
7. Switch
8. Stand
9. Rubber Feet
10. USB Cord

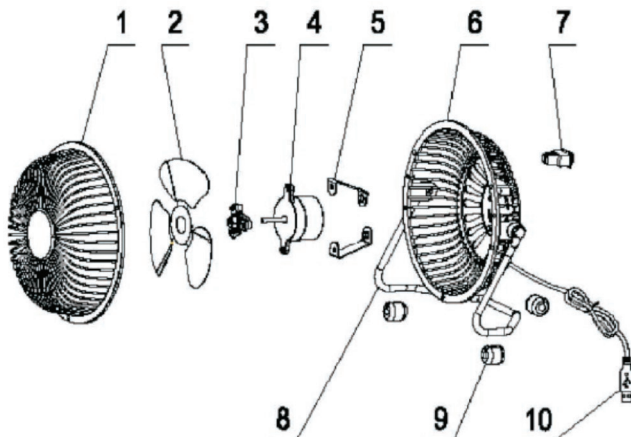

OPERATING INSTRUCTIONS

1. Place the fan on a dry flat surface

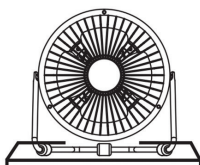

2. Ensure power switch is set to 'O' off, this can be found on the rear of the fan

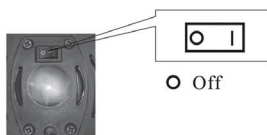

3. Insert USB plug into USB port of computer.
Note: When plugging in, pay attention to the position of the plug. Forcing it may damage or break the USB plug or your computer or DC5V adaptors USB port.



4. The fan can now be switched on 'I' by the power switch found on the rear of the fan.

Note: If the computer is off then the fan will not work as it will not receive any power.

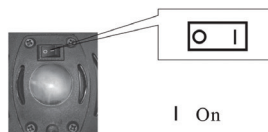

5. To adjust the air flow ensure the fan is switched off and unplugged then simply tilt the fan to your required angle.

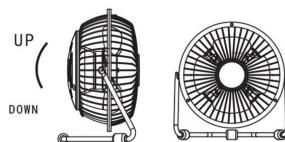

CLEANING AND MAINTENANCE

1. Disconnect from mains before maintenance or cleaning.
2. Use only a damp cloth to clean the enclosure.
3. Plastic parts should be cleaned with mild soap and a damp cloth. The fan must be cleaned thoroughly before storage and covered with plastic bags and stored in a dry place.

TROUBLE SHOOTING GUIDE

If you experience difficulties with the appliance, please check the suggestions below before contacting customer services on 01473 271272:

Problem	Possible Cause	Possible Solution
The appliance does not work.	The appliance is not properly plugged into the USB port.	Plug the appliance in firmly.
	The appliance is not switched on.	Make sure the appliance is switched on.
	There is no electricity running through from the device / socket.	Switch on the device or ensure power supply is connected.
The appliance is too noisy.	Sitting unevenly.	Ensure fan is sitting on a flat surface.
	Not secured together correctly.	Make sure all components are secured correctly.

Disposal Information



The European Directive 2012/19/EU on Waste Electrical and Electronic Equipment (WEEE), requires that old household electrical appliances must not be disposed of in normal unsorted municipal waste.

Old appliances must be collected separately in order to optimise the recovery and recycling of the materials they contain and reduce the impact on human health and the environment.

The crossed out “wheeled bin” symbol on the product reminds you of your obligation, that when you dispose of the appliance it must be separately collected. Consumers should contact their local authority or retailer for information concerning the correct disposal of their old appliance.



Igenix Warranty Terms & Conditions

This product is guaranteed for a period of 12 months as standard from the date of purchase against mechanical and electrical defects. You can extend your warranty for a further 12 months by registering your product.

Upon registration we will cover your product for a period of 24 months from the original purchase date against any mechanical or electrical defects.

To qualify for the guarantee, the product must be used for domestic household use only and in accordance with the instructions in the user manual. Any misuse of the product will result in the warranty being void.

The guarantee does not cover accidental damage, misuse, neglect, tampering or incorrect adjustment or installation.

The guarantee will be rendered invalid if the product is resold, has had its serial number removed (or has an invalid serial number), or if an unauthorised person has carried out any repairs or alterations.

The warranty does not cover accessories or consumable parts that require replacement under normal use. This includes shelving, dials, filters, belts and trays etc.

In the unlikely event of a breakdown please refer to the Troubleshooting guide in your user manual and check all plugs, fuses and the electricity supply.

If you still require assistance please contact our Customer Service department on **01473 271 272** or write to us at the following address:

**Customer Service Department
38 Bluestem Road, Ransomes Europark
Ipswich, IP3 9RR**

Please quote the Product Code which begins 'IG' or 'DF' and the Batch Code beginning '5' and give details of the exact fault. We will then decide whether to repair or replace the item.

Before we arrange the repair or replacement you will be required to return a copy of your proof of purchase. Please retain your original.

If an item is replaced within the agreed guarantee period, the guarantee for the replacement item will be calculated from the purchase date of the original.

In the event that the product is inspected and no fault is found or the product is not within the guarantee period you will be charged for the repair and any carriage costs.

igenix

Thank you for choosing Igenix

As a valued customer we would like to offer you a FREE 2 year warranty to cover your product against any electrical or mechanical defects.

This means that in the unlikely event you develop a fault or problem with your product we will happily repair or replace the item free of charge.

To qualify for the 2 year warranty you must register your product within 30 days of purchase. The full Terms & Conditions of our warranty policy are shown on the opposite page. They are also available on our website. **www.igenix.co.uk**

To register your product, please complete all sections of the form below and return to us at the following address: Igenix, 38 Bluestem Road, Ransomes Europark, Ipswich, IP3 9RR.

Alternatively you can visit the Igenix website and complete the form online.

Customer Details:

Title: _____ First Name _____ Surname: _____

Address: _____

Post Code: _____

Email: _____

Telephone: _____

Product Information:

Product Code (Beginning IG or DF): _____ Product Description: _____

Batch Number (Beginning 5): _____ Serial Number (if applicable): _____

Date of Purchase: _____

Retailer Name: _____

Retailer Location: _____

Please tick here to confirm you have read and accept our Terms & Conditions

Please tick here if you DO NOT wish to receive marketing information from us

Customer Signature: _____ Date: _____

igenix

38 Bluestem Road, Ransomes Europark, Ipswich, IP3 9RR

Tel. 01473 271 272

Disclaimer: Igenix operate a policy of continual improvement and development.
We therefore reserve the right to change/alter the specification and appearance of our appliances without prior notice.
All diagrams and images shown in this manual are for illustration purposes only.