

# ASSEMBLY INSTRUCTIONS

MODEL : 9024A  
MONACO DINING CHAIR

(Box 1)  
BOX OF DINING CHAIR(X2)

No	ITEM	Qty
A	Back Rest	1 pc
B	Front Leg	2 pc
C	Cusion Seat	1 pc

(Box 1)  
HARDWARE LIST(X2)

No	ITEM	Qty
1	JCBB Bolt m8x40mm Blk	2 pcs
2	JCBB Bolt m8x50mm Blk	4 pcs
3	JCBB Bolt m8x70mm	4 pcs
4	Spring Washer M8 Blk	10 pcs
5	Flat Washer M8 x 22 Blk	10 pcs
6	Allen Key M5	1 pcs

**STEP 1.1 :** Remove chair leg from the box seat (C) by open the bottom seat cover as shown.

**STEP 1.2 :** Align the cushion seat (C) to the Back Rest (A) by secure with JCBB Bolt (1) ,Spring Washer (4) & flat washer (5) and tighten them with Allen Key (6) (DO NOT TIGHTEN BOLTS DURING THIS STEPS)

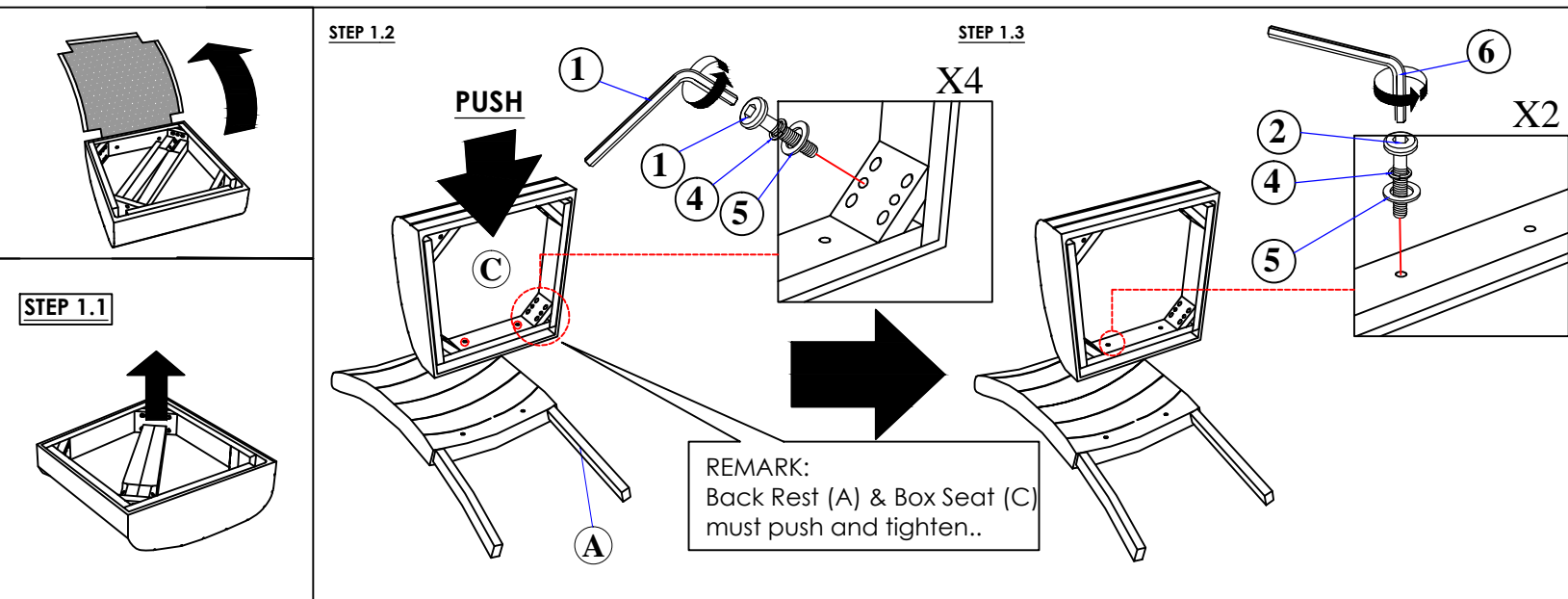

**STEP 2.1 :** Align Front Leg (B) into cushion seat (C) and fix with JCBB Bolt (2),Spring Washer (4),Flat Washer(5) tighten them with Allen Key(6) as shown.

**STEP 2.2 :** closed down the cover of bottom cushion seat (C) after all parts completely fixed.

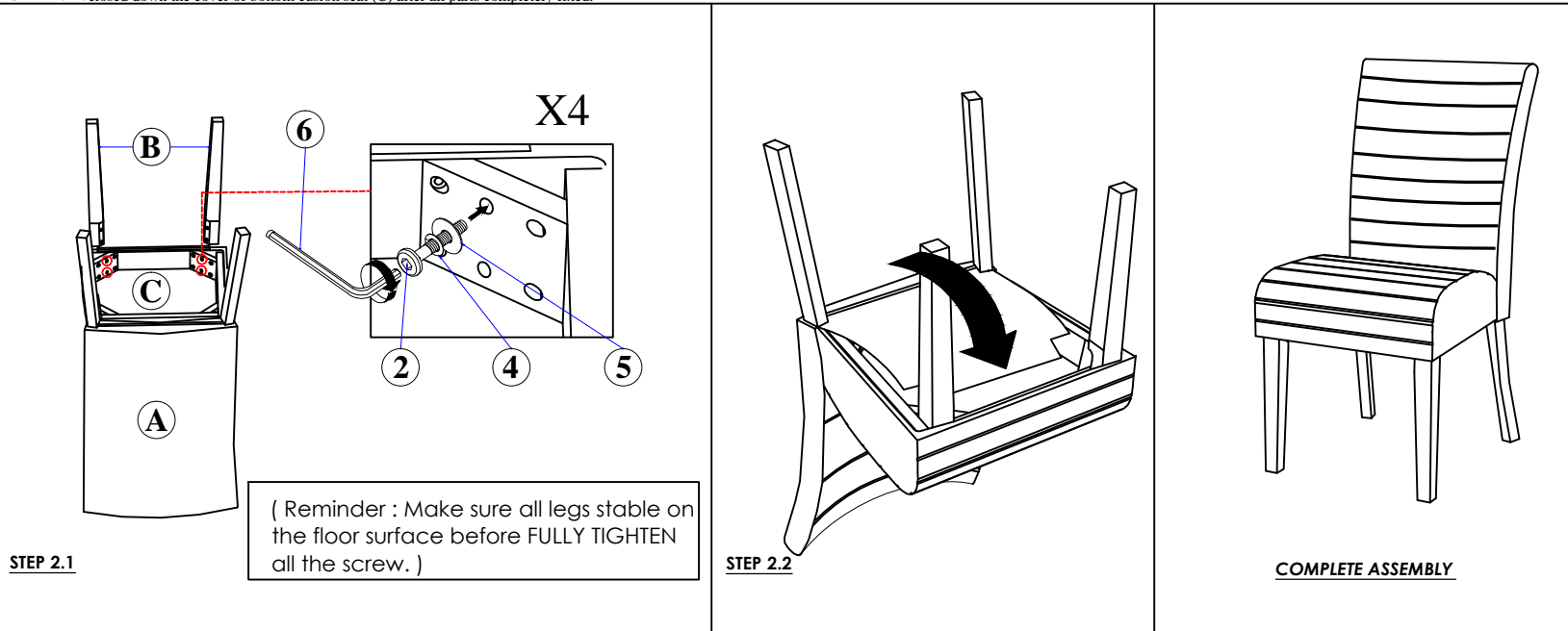

NOTE : MUST TIGHTEN SCREWS PERIODCALLY WITH USE SCREW WILL BECOME LOOSE CHECK TIGHTNESS OF ALL SCREW EVERY 6-8 WEEKS.