

Leave the Power Massage Heated Recliner Chair in a shady outdoor area for 1-2 days.

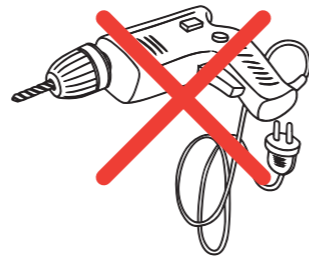

For longer use

Re-tighten the bolts every 6 months using the enclosed Allen key.  
\*Using an electric drill can damage the chair. Please re-tighten the bolts manually.



## Safety Information



Sit in the center of the chair, with your back against the backrest  
Do not sit on the front edge of the chair  
Do not stand on the chair  
Do not use the chair with more than one person  
Do not push the chair around when a person is sitting in it  
Do not push down on the backrest when a person is reclined  
Do not place your entire weight on the backrest

- This sofa is designed for one person weighing up to 297.63 lbs(135 kgs). Avoid exposing the furniture directly to sunlight or to heating and air conditioning outlets. Do not place your upholstery furniture too close to windows, radiators, or vents, and be sure to use window treatments to block the sun's rays. Do not use rough cleaning tools or corrosive
- detergents to clean the sofa.
- Some parts are heavy and/or have sharp edges; install them carefully to avoid injury to yourself or others around you.

# INSTRUCTION MANUAL

Model: SF-L8270

✉ HJ-Customer-Service@outlook.com  
☎ (909)637-7665 | (909)637-7593

# INSTRUCTION MANUAL

## SF-L8270

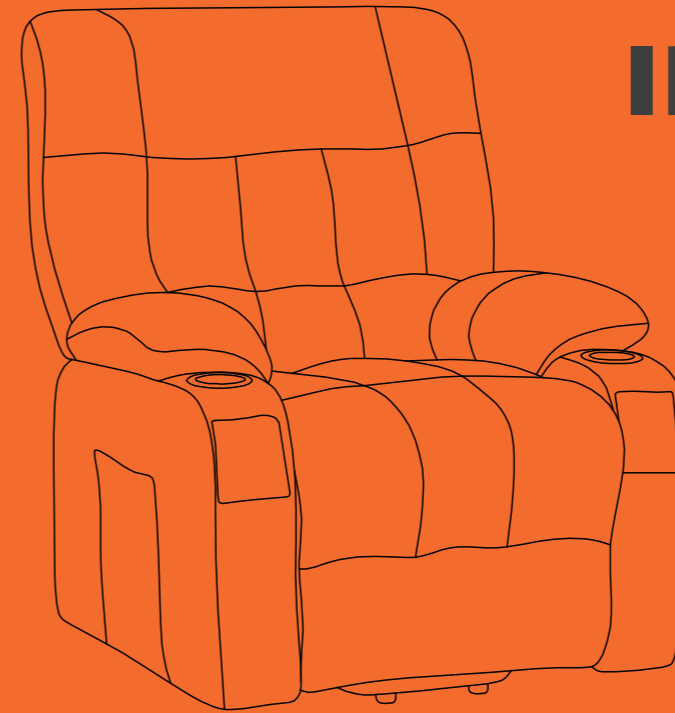

✉ HJ-Customer-Service@outlook.com  
☎ (909)637-7665 | (909)637-7593

## Package List

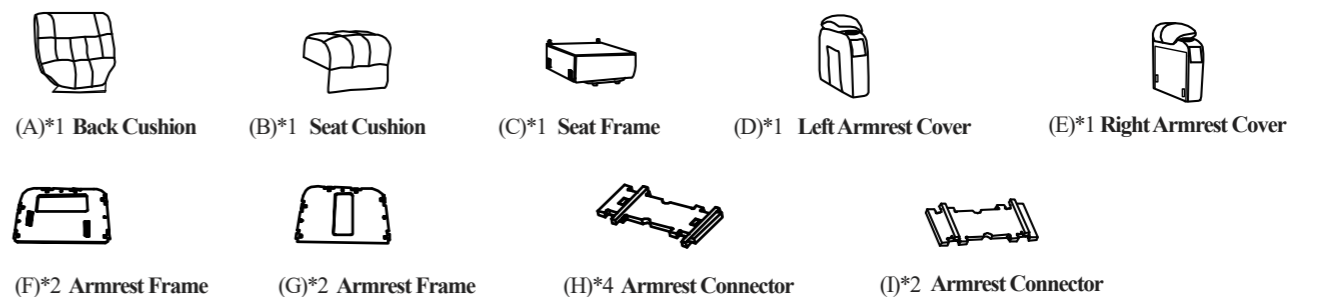

## Hardware

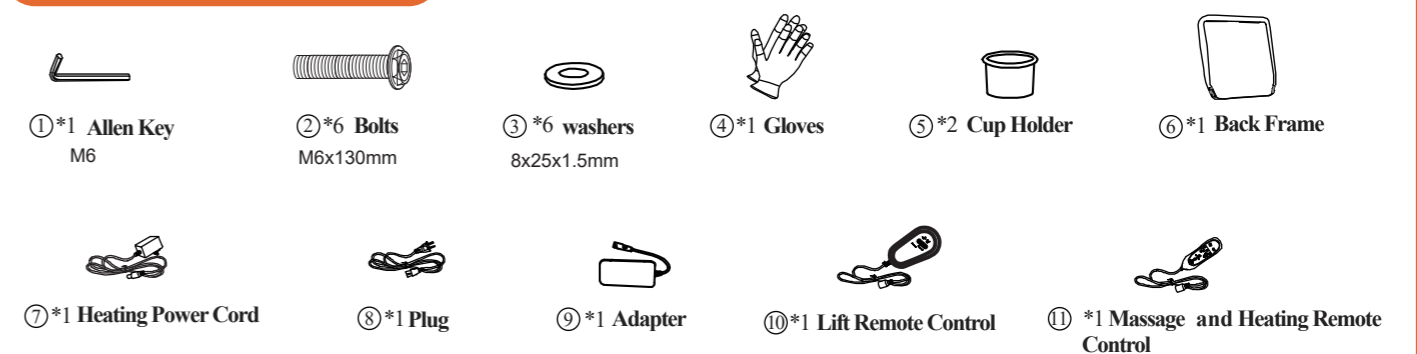

# Assembly Instruction

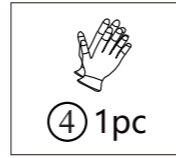

④ 1pc

Armrest components

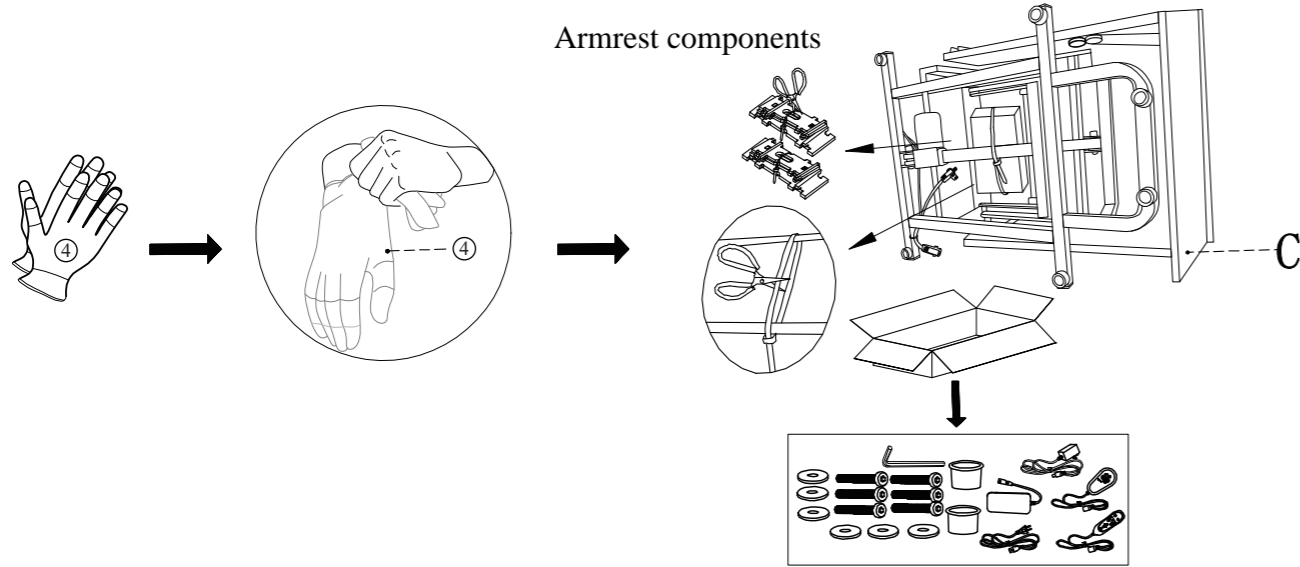

**1** Put on gloves ④ and remove the parts inside the bottom of the seat frame (C).

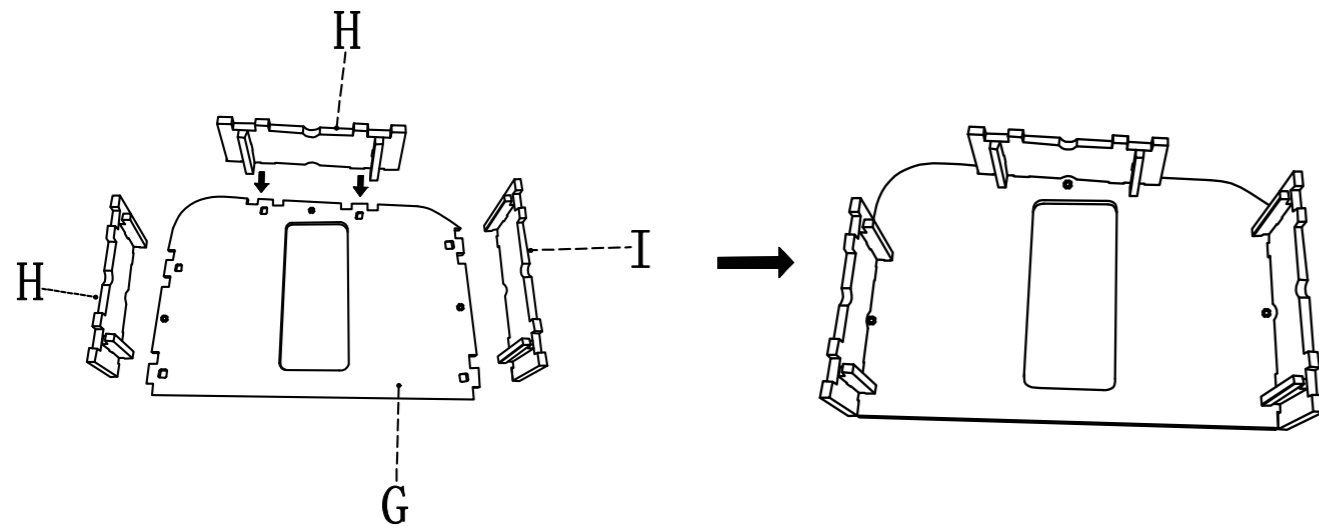

**2** Attach two armrest connectors (H) & one armrest connector (I) to armrest frame (G).

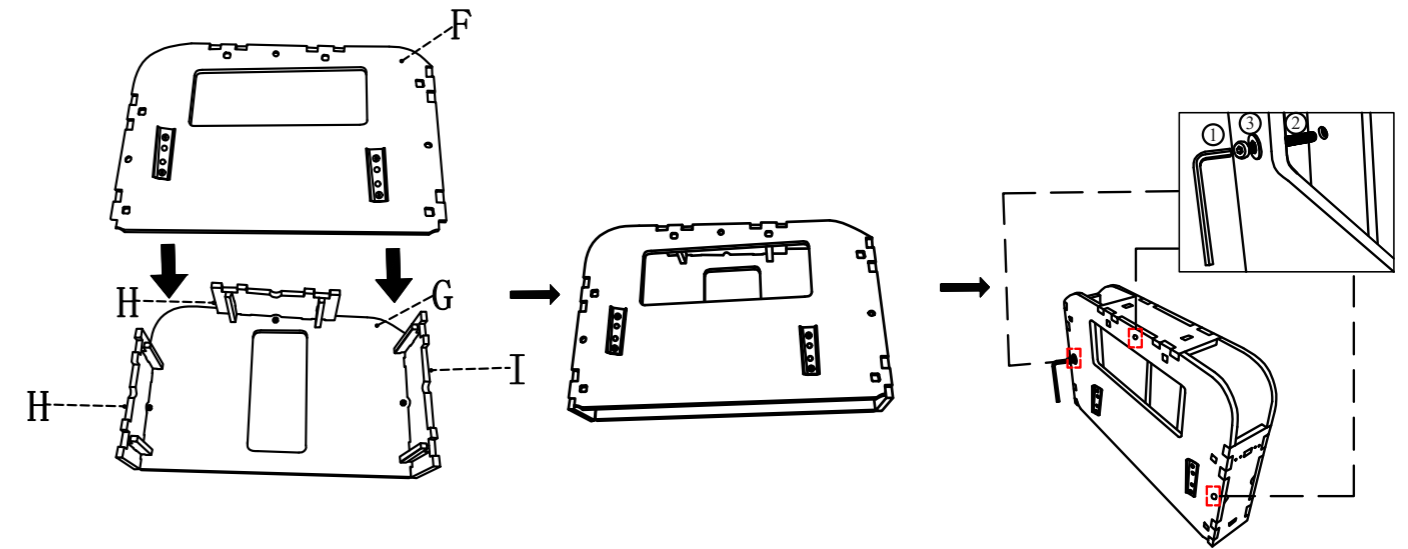
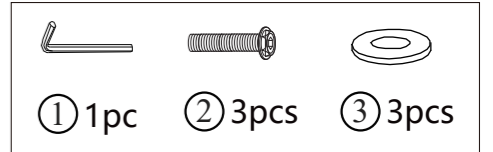

Attach the armrest frame (F) to the armrest connectors as shown. Then, position the assembled armrest frame upright and fasten it using bolt ② and washer ③ with the Allen Key ①.  
**Attention: Only 3 screws, 3 washers, and Allen Key are required for single-sided installation.**

**3**

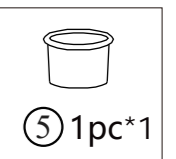

⑤ 1pc\*1

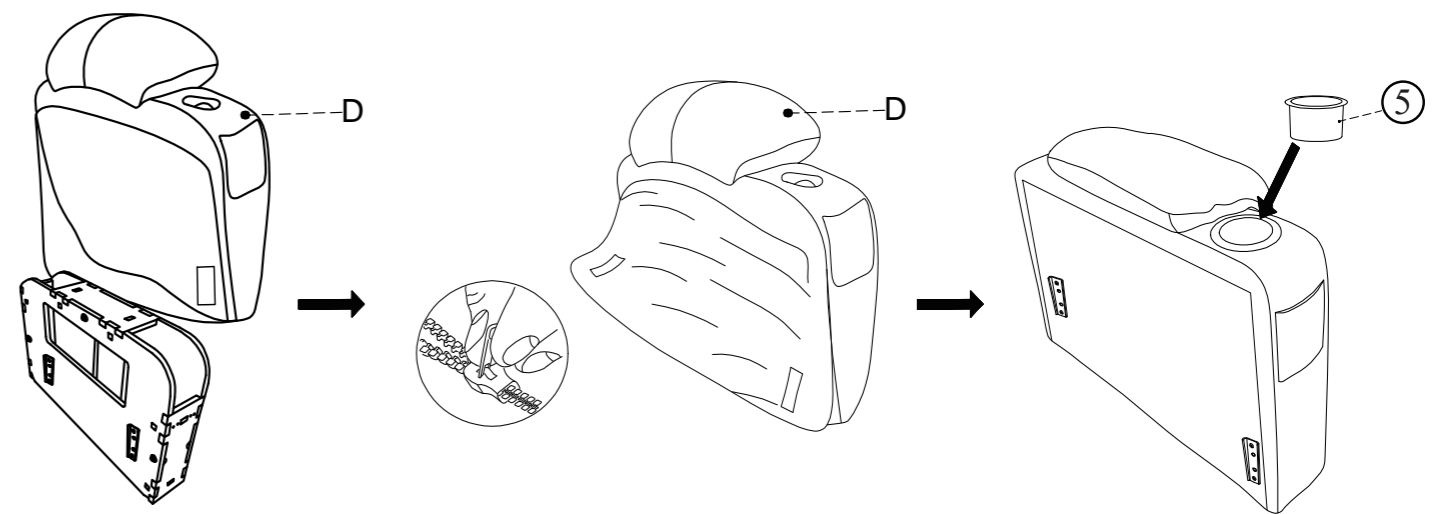

Attach the Right Armrest Cover (D) to the assembled armrest frame in Step 3 and zip it up, then install the cup holder as shown. **Repeat the steps 2-4 to assemble the Left Armrest(E).**  
**Attention: Only one cup holder is required for single-sided installation.**

**4**

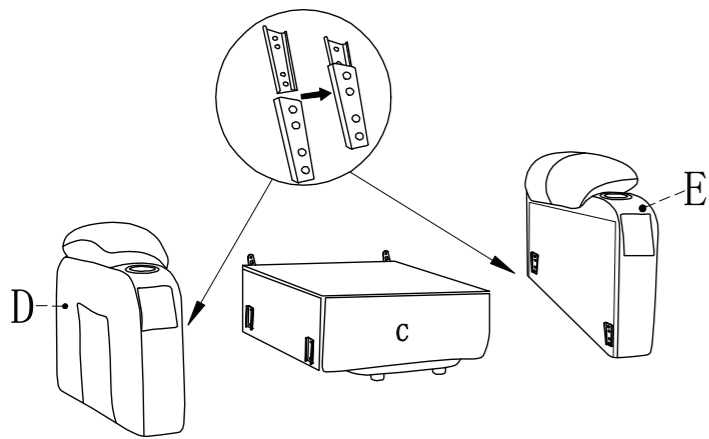

**5** Attach the assembled armrest (D) and (E) to each side of the seat frame (C), and make sure the latches are locked.

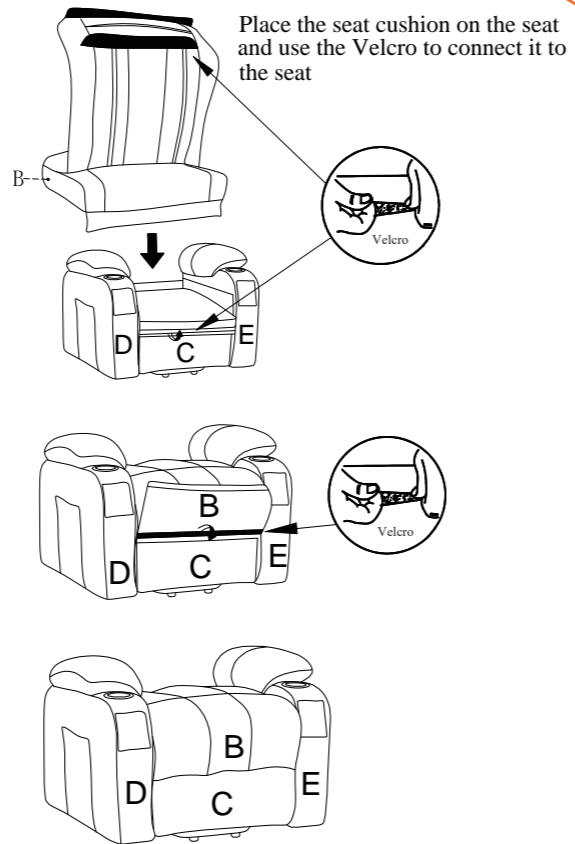

**6** Attach the seat cushion (B) to the seat frame (C), and fasten the Velcro.

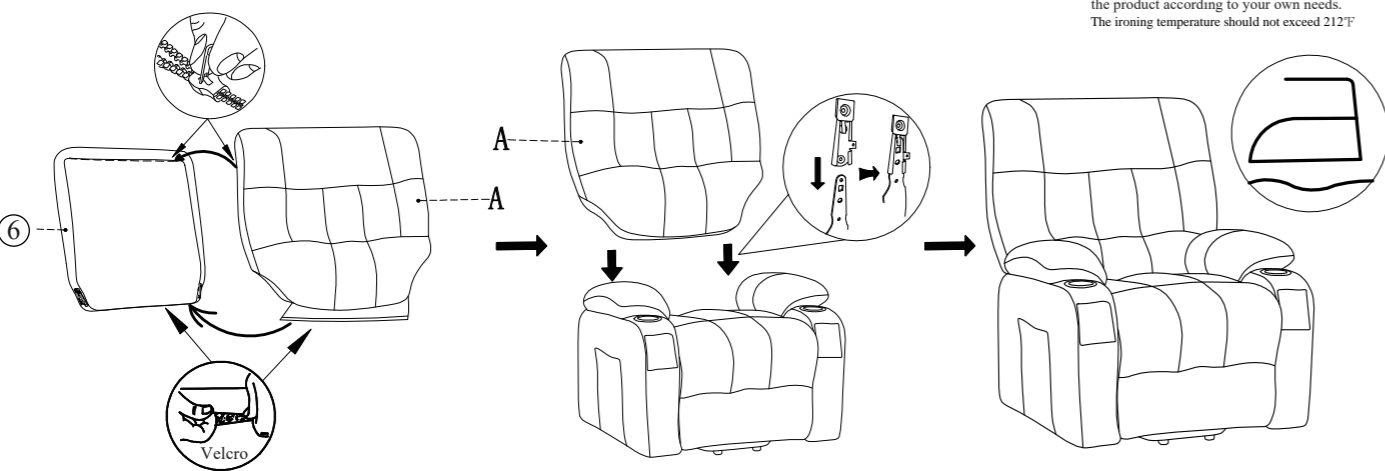

Attach the back cushion (A) to the back frame ⑥, zip it up and fasten the Velcro.

**7** **NOTE:** Once installed, the product can be ironed and finished according to your needs. The ironing temperature should not exceed 212°F

**Note:** After installation, you can iron and organize the product according to your own needs. The ironing temperature should not exceed 212°F

Connect the cords of the same color together.

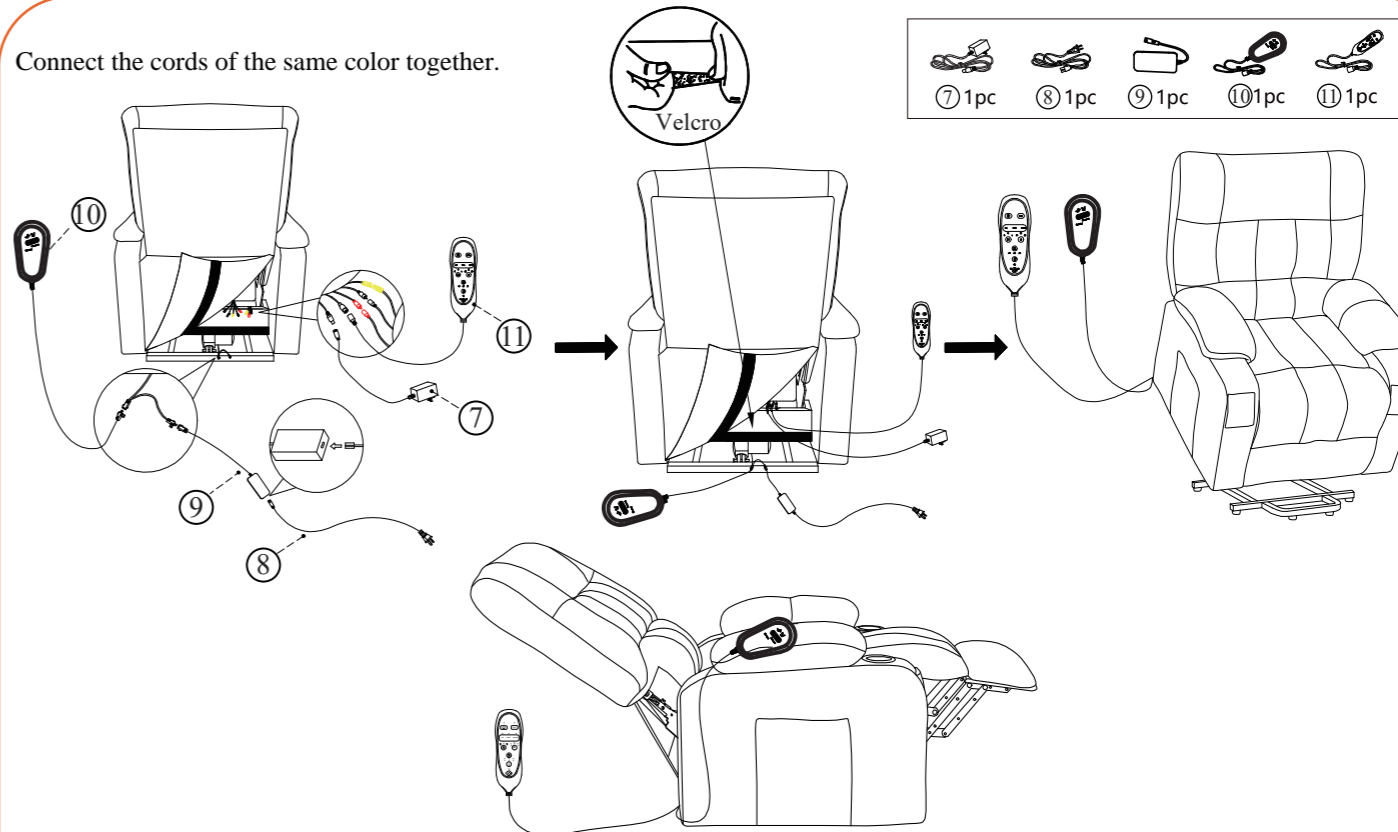

**8** Connect the Heating Power Cord (7) to the Massage and Heating Remote Control (11), then connect Plug (8), Adapter (9) and Lift Remote Control (10) as shown, then fasten the Velcro on the backside.  
**NOTE:** Please iron according to your needs after installation, not exceeding 212°F

## Instructions For Use

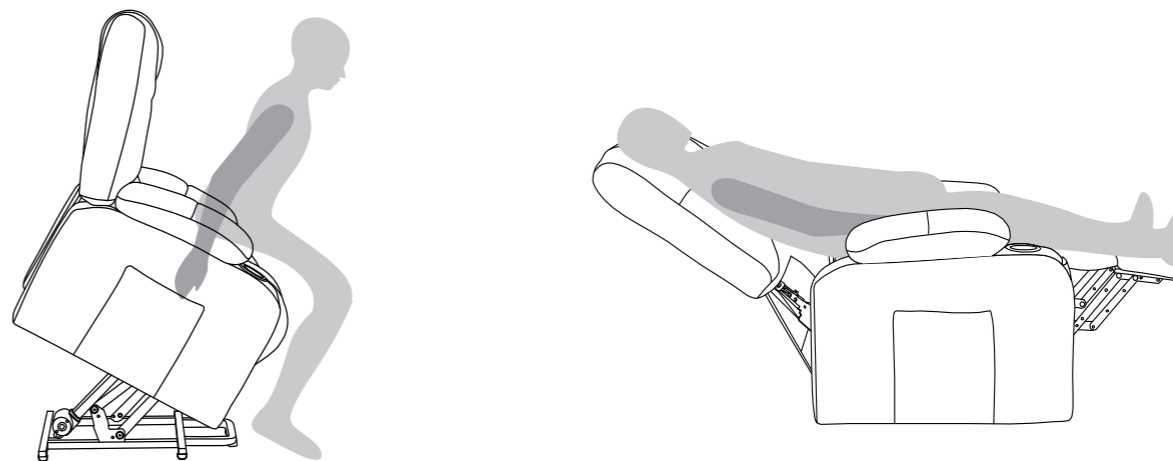

## CAUTION:

\* Lubricate all parts and tighten all bolts every 6 months or whenever needed.

**NOTE:** Before using the chair, check to ensure that all bolts are fully tightened.

# REMOTE CONTROL

## Function of the remote

### Voltage parameters :

- 1.Voltage: AC110-240V DC12V
- 2.Current: 1A
- 3.Power: 12W
- 4.Voltage Grade: Class III
- 5.Frequency: 50-60Hz

### PRODUCT FEATURE

- Heating massage, three temperature settings, M1-M2-M3.
- 8 Vibration Motors.
- 3 Massaging Modes.
- 3 Massaging Intensity.
- Four massage zones, each zone can be operated individually.
- The default timing options are 15, 30, and 60 minutes.

### HOW TO USE

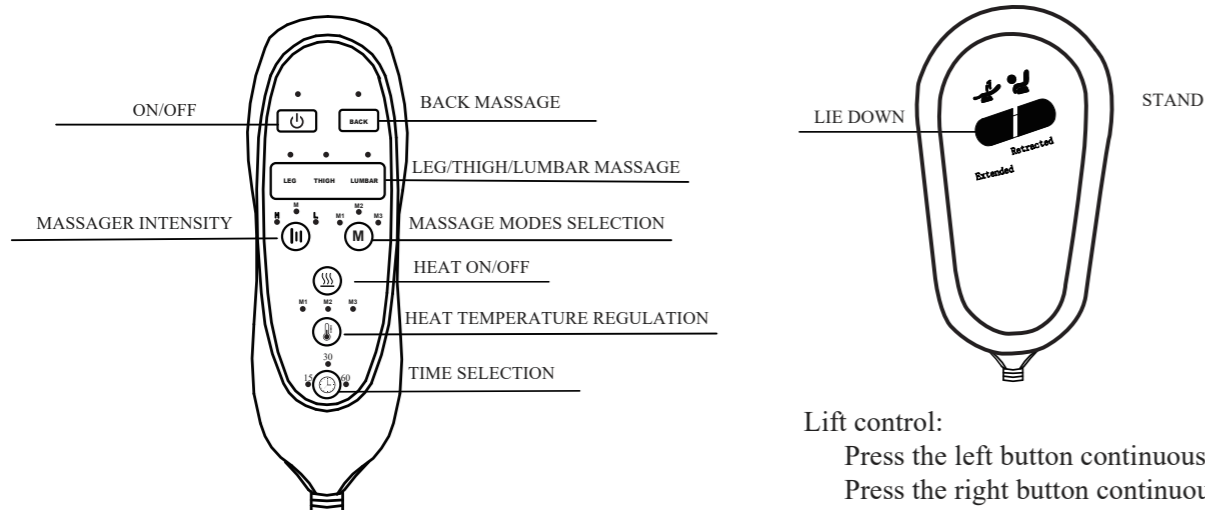

Lift control:  
Press the left button continuously to lie down.  
Press the right button continuously to stand up.

1. Plug the adapter jack into the socket on the back of the massage chair ( see Fig.A), then plug the adapter into a wall outlet.

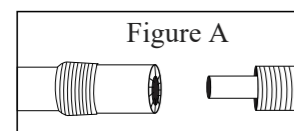

2. Press the **POWER** button once to turn the unit on, and the LED indicator will light up when power is on. To turn the massage function off, press the button again.
3. Turn on the massage in each zone by pressing the **BACK, LUMBAR, THIGHS** or **LEGS** buttons. The LED indicator will light up when each zone is activated. To turn a zone off, press the button again.
4. To choose a desired massage mode, press the **MODE** button. To change modes, press the **MODE** button until the LED for the desired mode lights up.
  - PULSE** ---provides a deep percussive massage (M1).
  - PRESE** ---provides a rapid percussive massage (M2).
  - WAVE** ---delivers a progressive left and right vibration massage (M3)

5. To change the massage intensity, press the **INTENSITY** button. The LED for **HIGH (H)** or **Mid (M)** or **LOW (L)** intensities will light up when it's chosen.

NOTE: Discontinue use immediately if you feel any discomfort or pain.

6. NOTE: For your benefit, the massage chair is equipped with an auto-shut-off feature. If you choose 15 minutes, the massage chair will shut off after 15 minutes of use. If you choose 30 minutes, the massage chair will shut off after 30 minutes of use. If you choose 60 minutes, the massage chair will shut off after 60 minutes of use.

7. **DO NOT use for more than 60 minutes of continuous use.**

### IMPORTANT SAFETY INSTRUCTIONS

The following basic precautions should always be observed when using electrical appliances:

1. This product is for use on a 12V circuit. Make sure to connect the product to an outlet with the same plug configuration.
2. Always unplug the massager after use and before cleaning.
3. If the massager falls into water, do not reach for it. Please unplug it immediately.
4. Do not leave the appliance unattended when it is plugged in. When not in use, unplug it from the outlet before installing or removing parts or accessories.
5. Do not use it outdoors.
6. Do not carry the supplied cord as a handle with the device.
7. Keep the cord away from heated surfaces.
8. Close supervision is required when using this equipment near children or disabled people.
9. Do not operate where aerosol (spray) products are used or oxygen is inhaled in case of danger.
10. To disconnect, press the 'POWER' button on the Massage and Heating Remote Control. After ensuring all functions have stopped, unplug the massage chair.
11. When using the chair, keep the cord away from heat-generating surfaces.
12. Use this equipment for the purposes described in this manual. Do not use accessories not supplied with this equipment.

### HEALTH CAUTION

- If you have any concerns regarding your health, consult your doctor before using this product.
- Individuals with pacemakers should not use this product.
- If you experience pain in a muscle or joint for a prolonged period, discontinue use and consult your doctor. Persistent pain could be a symptom of a more serious condition.

### MAINTENANCE INSTRUCTIONS

#### TO STORE:

Place the unit in its box or in a safe, dry, and cool place. Avoid contact with sharp edges or pointed objects that might cut or puncture the fabric. Do not wrap the power cord around the unit.

#### TO CLEAN:

- To clean the unit, make sure the massager is unplugged. Allow the unit to cool, then wipe it down with a damp, clean cloth. Do not use any strong chemical cleaners.
- Do not submerge the unit in any liquid. Clean the fabric cover by wiping it with a damp sponge and a mild detergent or suds. Clean with a dry cloth.
- Do not use abrasive cleaners, brushes, gasoline, kerosene, or glass /furniture polish. Do not use paint thinners or water hotter than 212°F to clean the unit.