

# ASSEMBLY INSTRUCTIONS

## DESCRIPTION: QUEEN BED

**Caution:** Please read instructions thoroughly before unpacking assembly parts. Sharp, exposed staple tips can cause injury, therefore, for your protection, please remove any exposed staple used in packing.

1. We recommend that you should assemble this product with the assistance of another person; this will make assembly easier, and will help to eliminate damage to the product or injury to persons during assembly.
2. Be sure to check all packing materials carefully for small parts that may have come loose inside the carton during shipment.
3. please do not over tighten screws or bolts.
4. Please put all parts on a non-abrasive floor before assembly, and follow the assembly steps to assemble your newly purchased product correctly and efficiently.

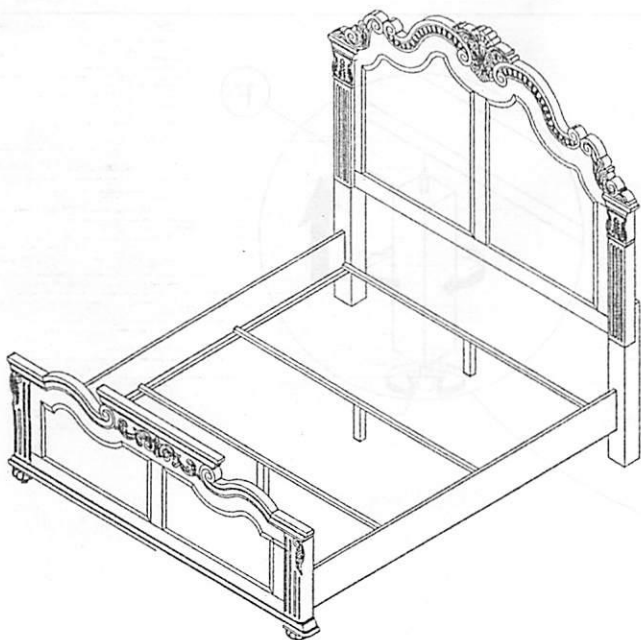

No		PARTS LIST		Q'TY
A		HEADBOARD SIZE	68-3/4" X 4-7/16" X 68"	1PC
B		LEG SIZE (L&R)	3-7/16" X 3-3/4" X 30-7/8"	2PCS
C		FOOTBOARD SIZE	68-3/4" X 4-3/16" X 28"	1PC
D		SIDE RAIL SIZE	82" X 7-1/2" X 11/16"	2PCS
E		SLATS SIZE	60-13/16" X 2-3/4" X 11/16"	3PCS
F		SUPPORT WITH LEVELER	7-1/2" X 1-1/4" X 1-1/4"	3PCS

No		HARDWARE LIST		Q'TY
a		BOLT	Ø5/16" x 2"	10PCS
b		LOCK WASHER	Ø5/16" X 10D X 1.1mm	10PCS
c		FLAT WASHER	Ø5/16" X 18D X 2mm	10PCS
d		WRENCH	2-1/4" X 4mm	1PC
e		SCREW	1-1/4" X 4mm	6PCS

### STEP 1

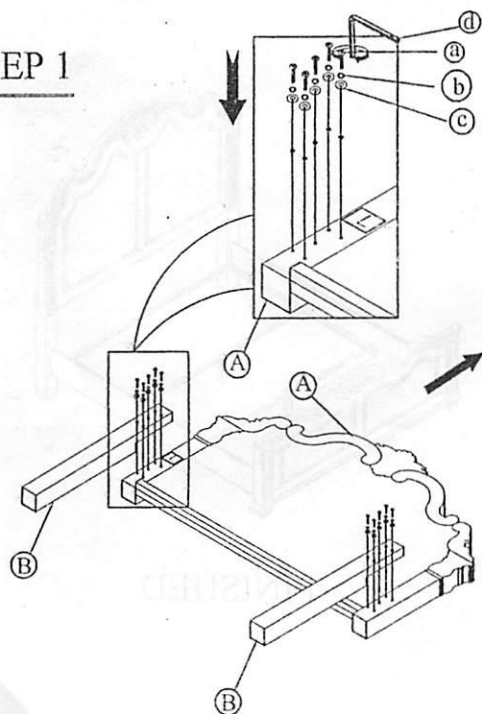

### STEP 2

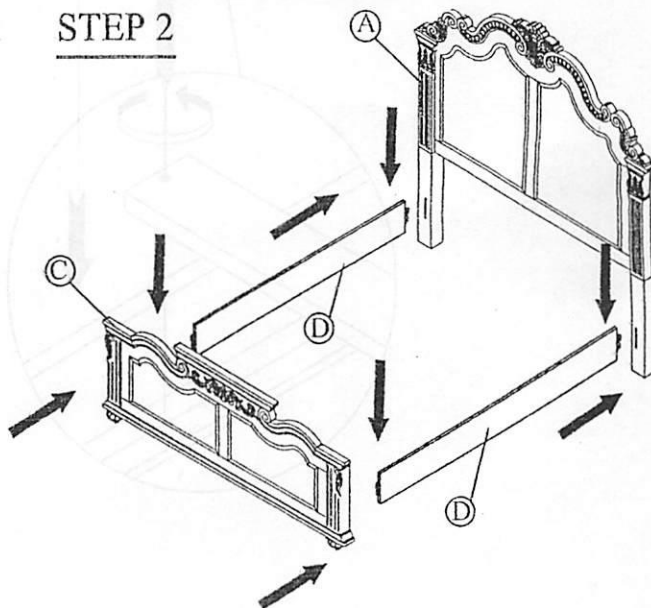

# ASSEMBLY INSTRUCTIONS

## DESCRIPTION: QUEEN BED

**Caution:** Please read instructions thoroughly before unpacking assembly parts. Sharp, exposed staple tips can cause injury, therefore, for your protection, please remove any exposed staple used in packing.

1. We recommend that you should assemble this product with the assistance of another person; this will make assembly easier, and will help to eliminate damage to the product or injury to persons during assembly.
2. Be sure to check all packing materials carefully for small parts that may have come loose inside the carton during shipment.
3. please do not over tighten screws or bolts.
4. Please put all parts on a non-abrasive floor before assembly, and follow the assembly steps to assemble your newly purchased product correctly and efficiently.

### STEP 3

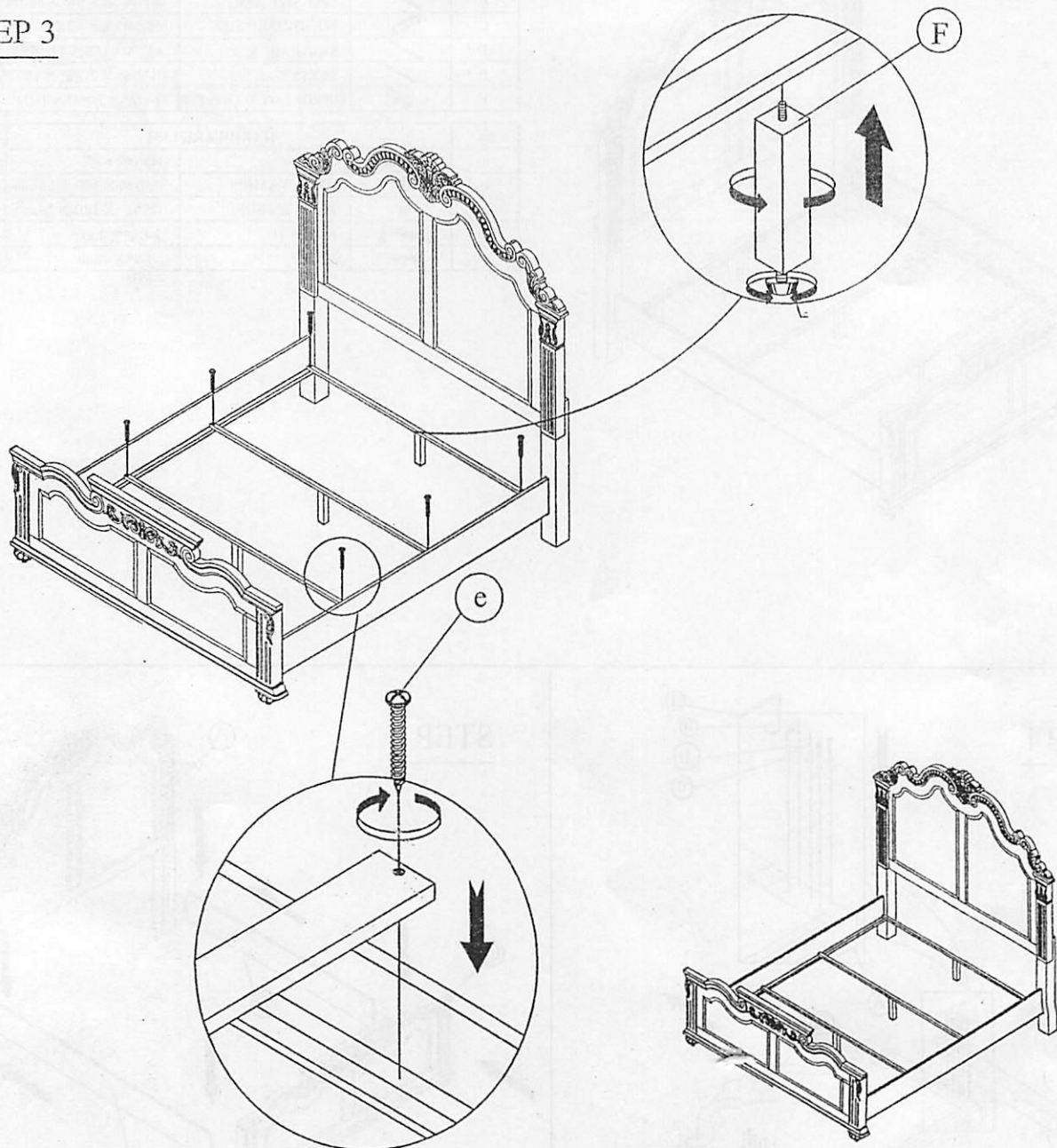

FINISHED