

Computer Desk

Installation Option I

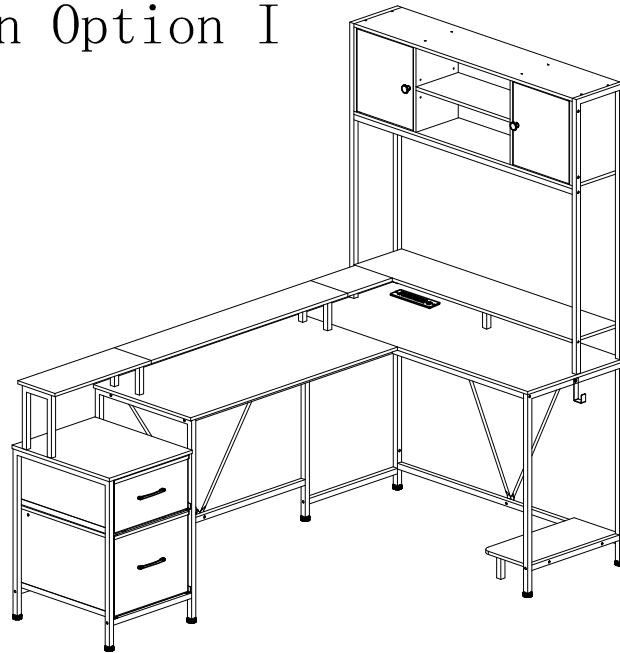

Installation Option II

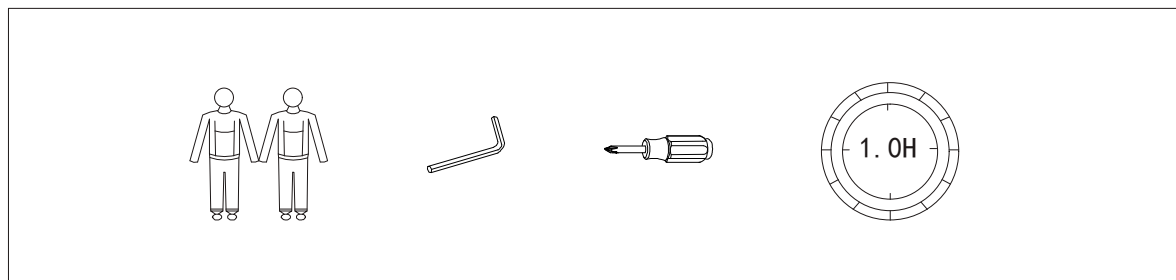
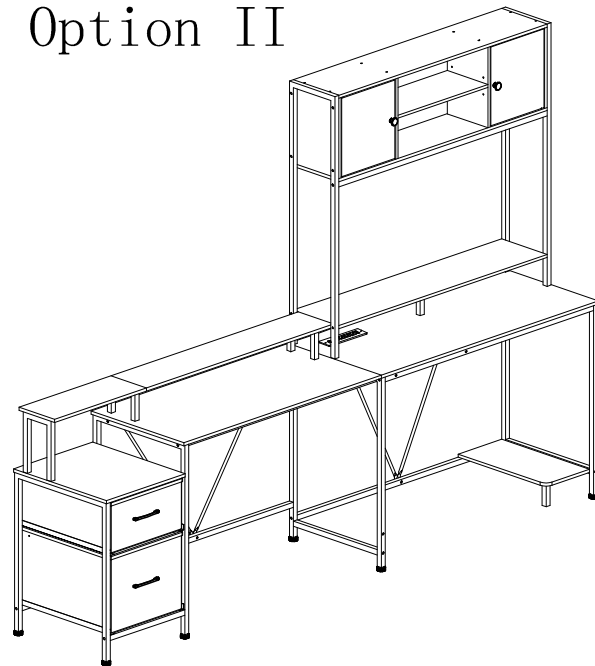

GAUTION : When tightening the screws , tighten sequentially .
Do not tighten any screws fully and then towards the next one .
When every part is OK , then tighten all the screws

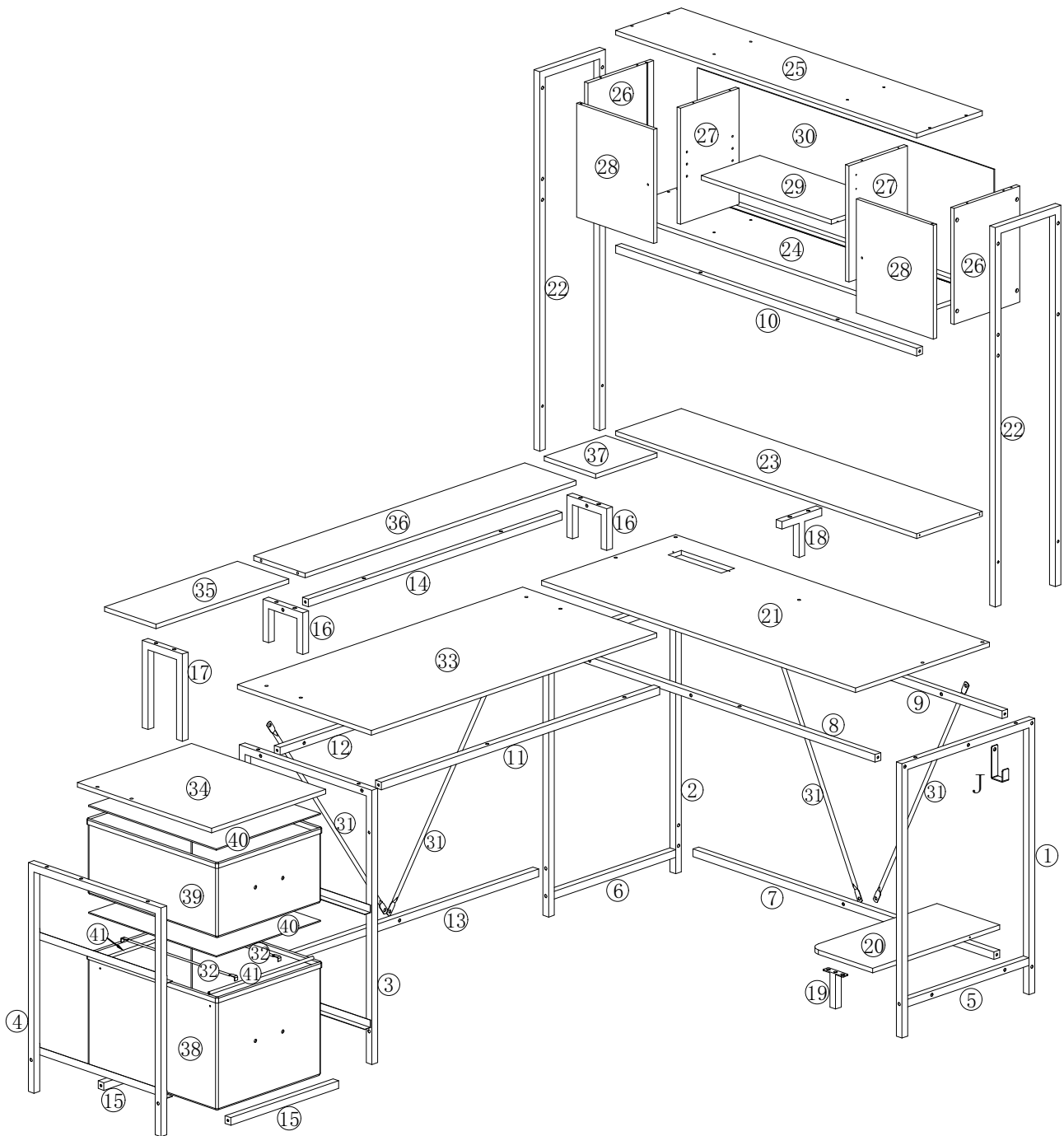

A	x8	B	x24+1	C	x16+1	D	x24+1	E	x10+1	F	x34+1
		M6x35		M6x28		M5x38		M6x10		M6x25	
G	x1	H	x2	I	x2	J	x1	K	x2	L	x2
		ST3.5x12						ST3.5x12		M4x16	
M	x8	N	x4	O	x2	P	x2	Q	x1	R	x2
		ST3x16		M6x50		P	P1	M3 M4		6x30	
S	x7	U	x1	V	x8	X	x2				
M6						ST4x30					

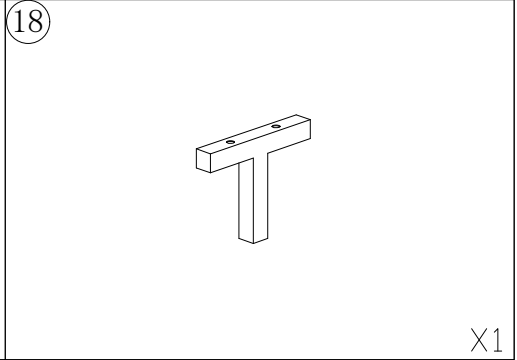
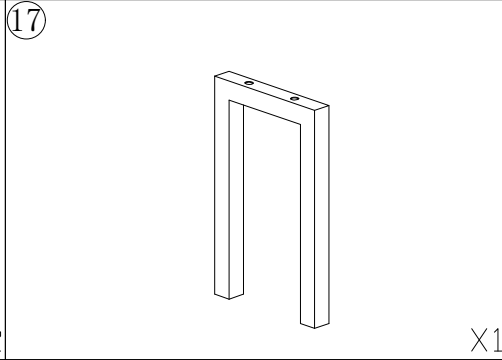
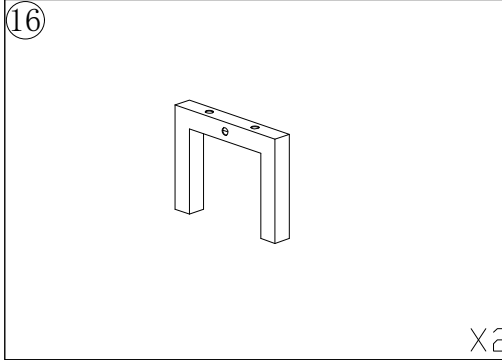
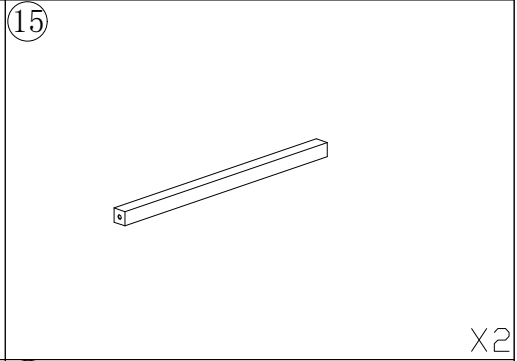
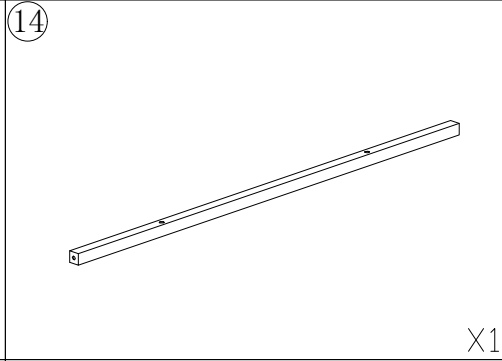
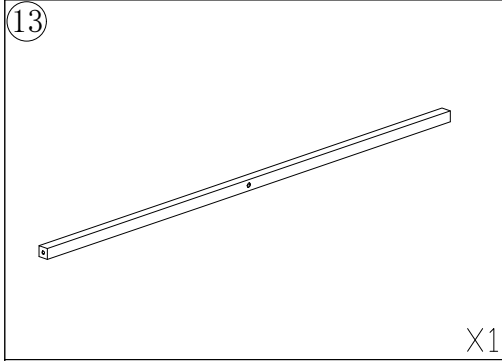
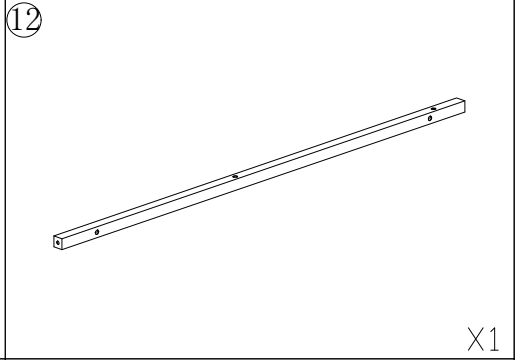
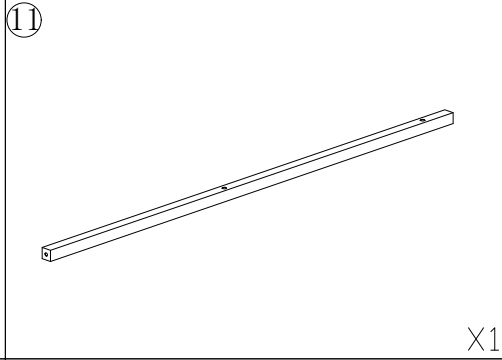
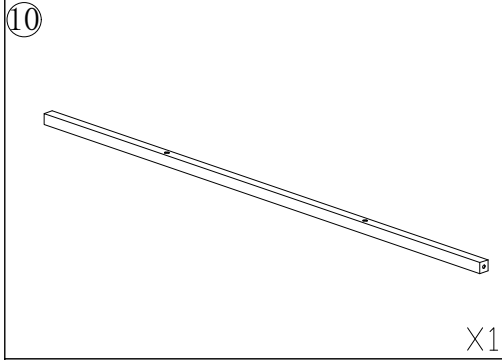
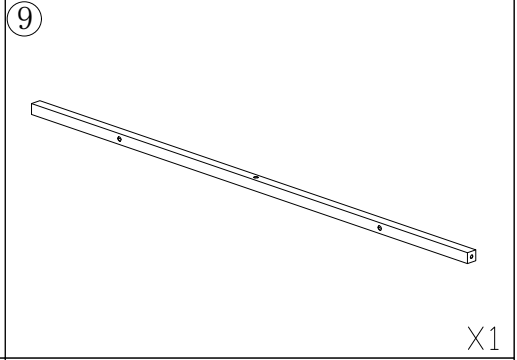
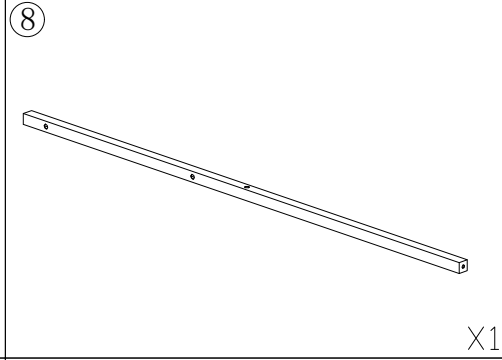
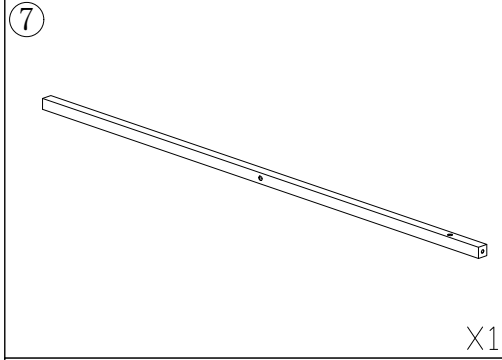
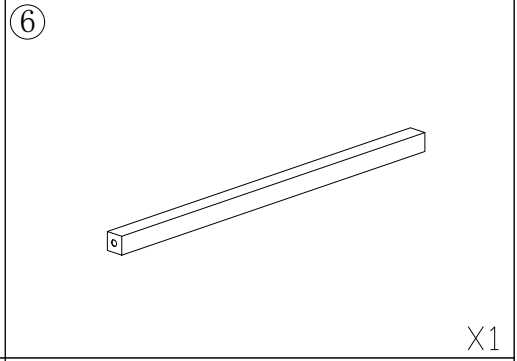
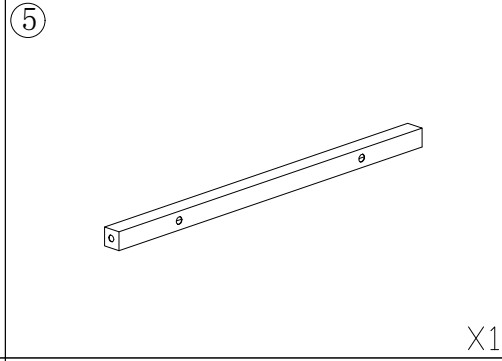
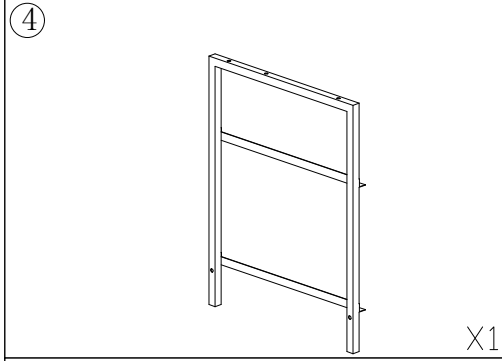
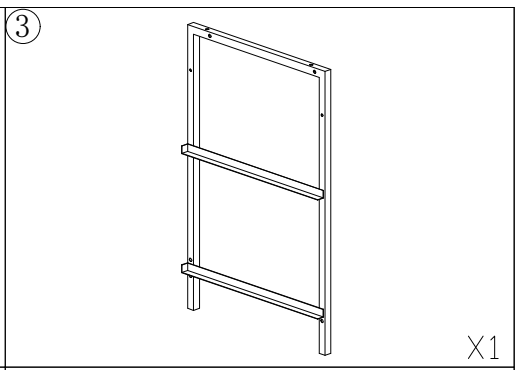
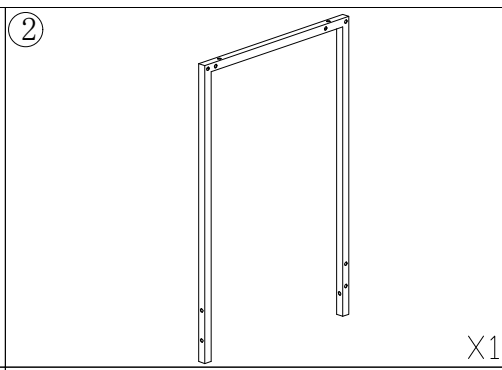
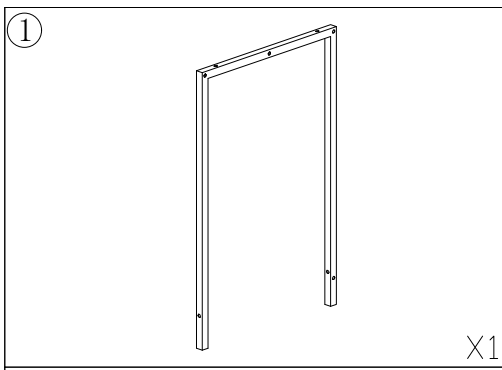

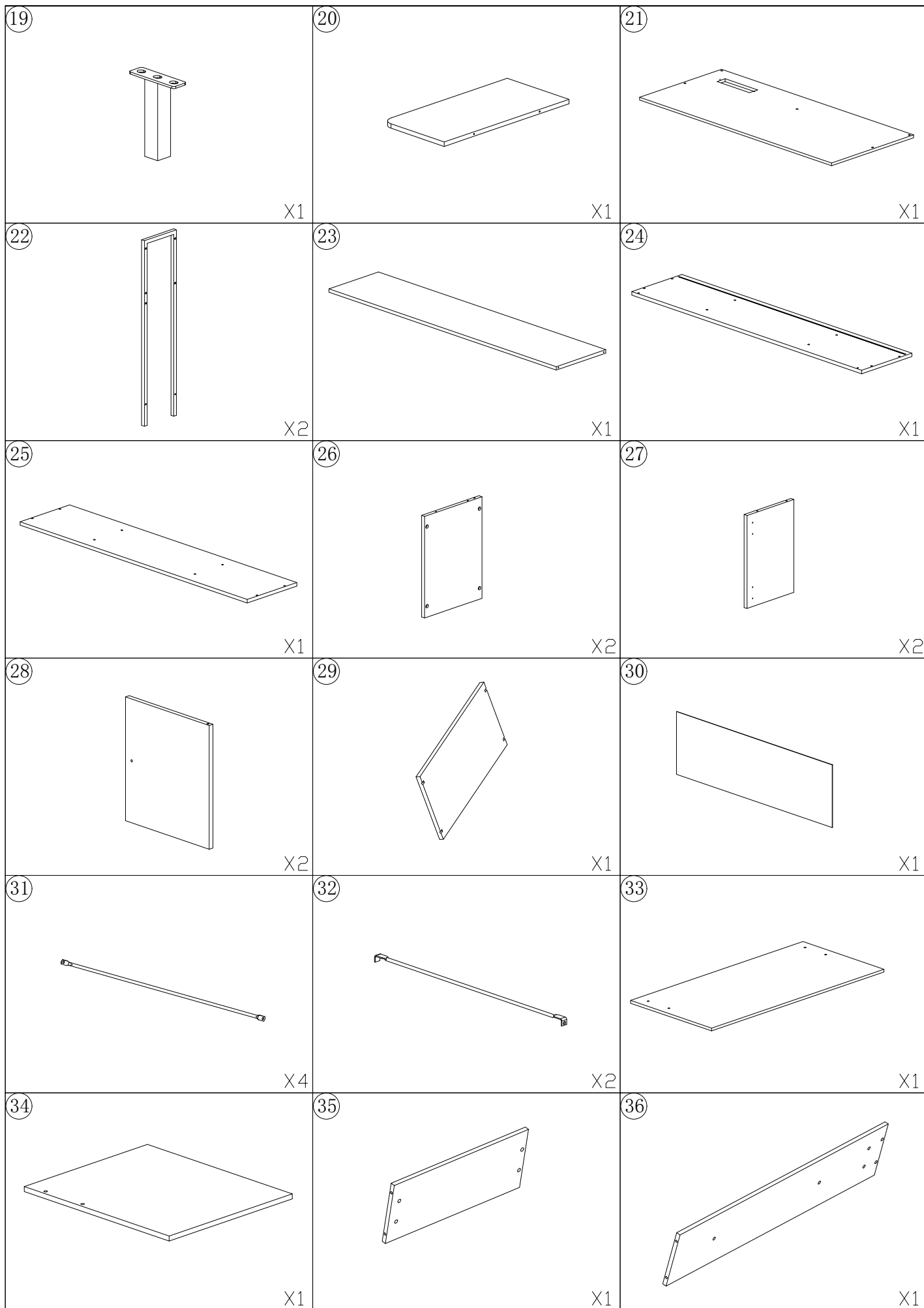

37

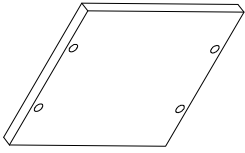

X1

38

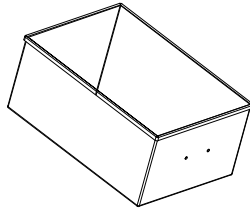

X1

39

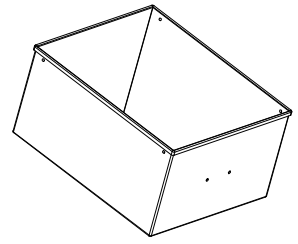

X1

40

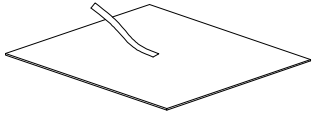

X2

41

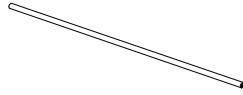

X2

Step 1

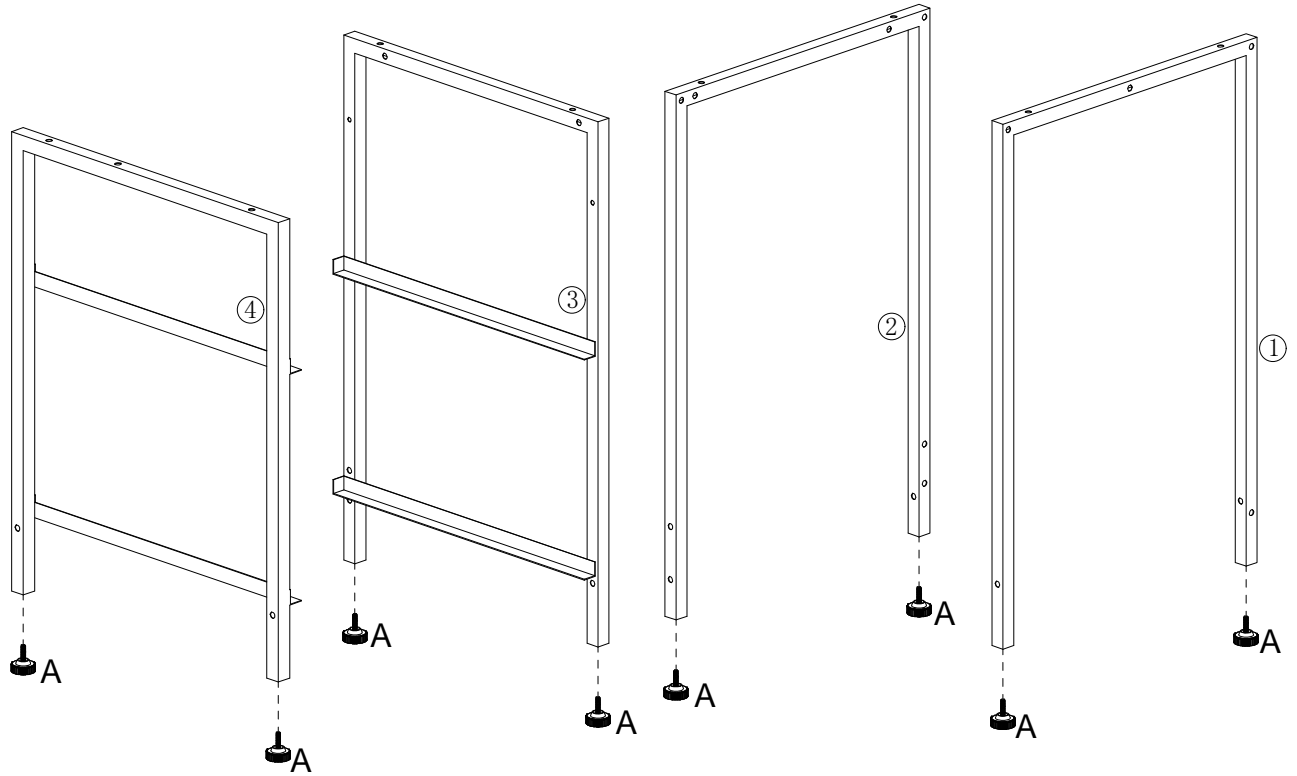

A	X8
	

Step 2

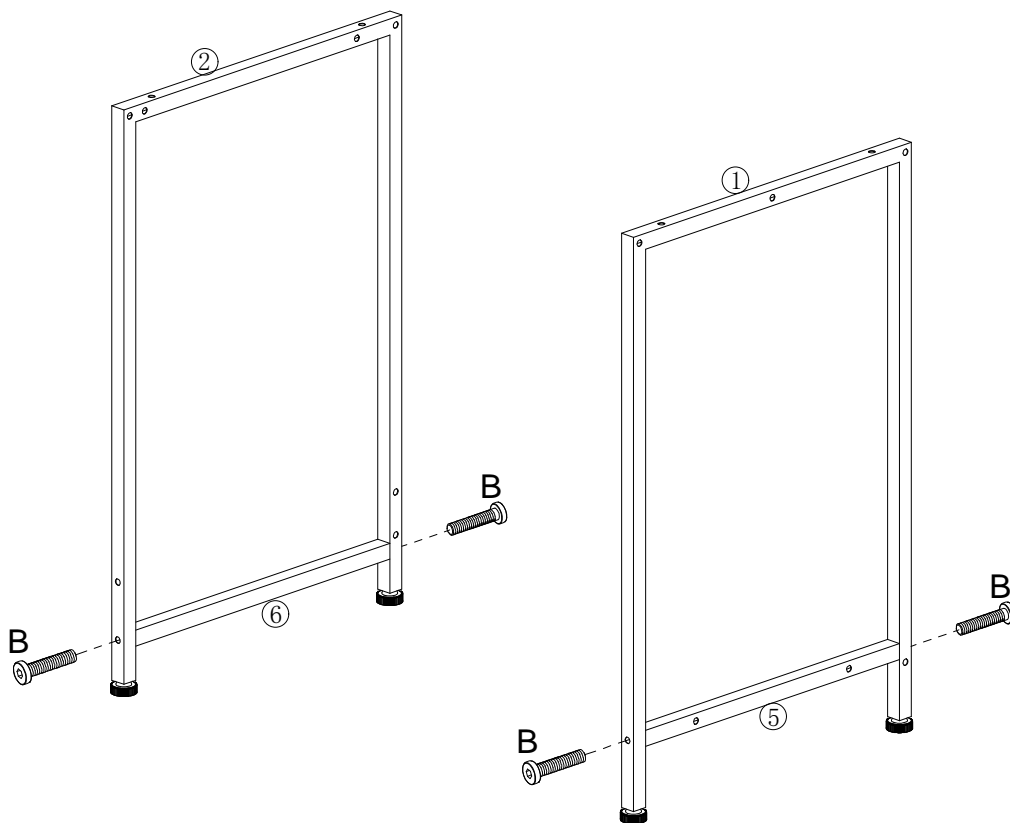

B	X4
	
M6x35	

Step 3

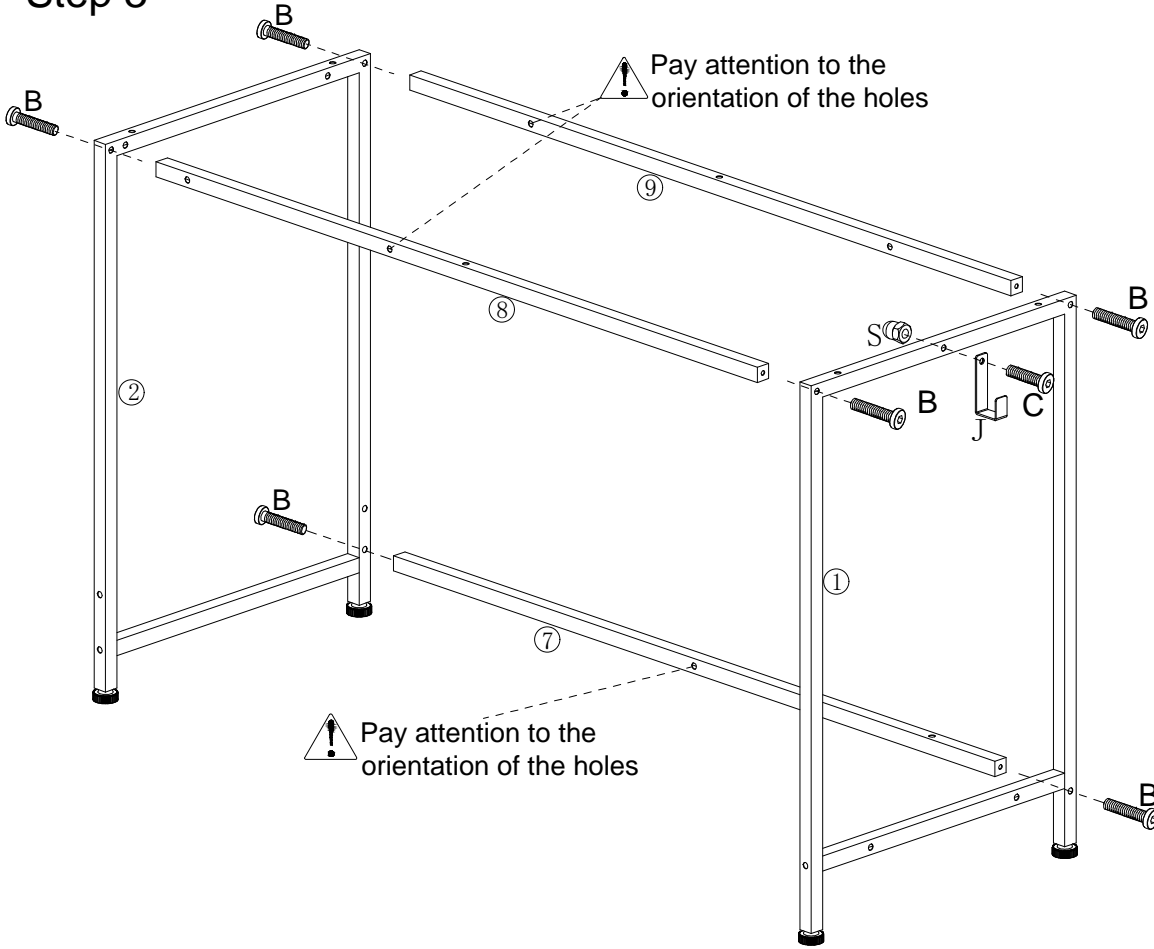

S	X1
M6	
J	X1
M6	
C	X1
M6x28	
B	X6
M6x35	

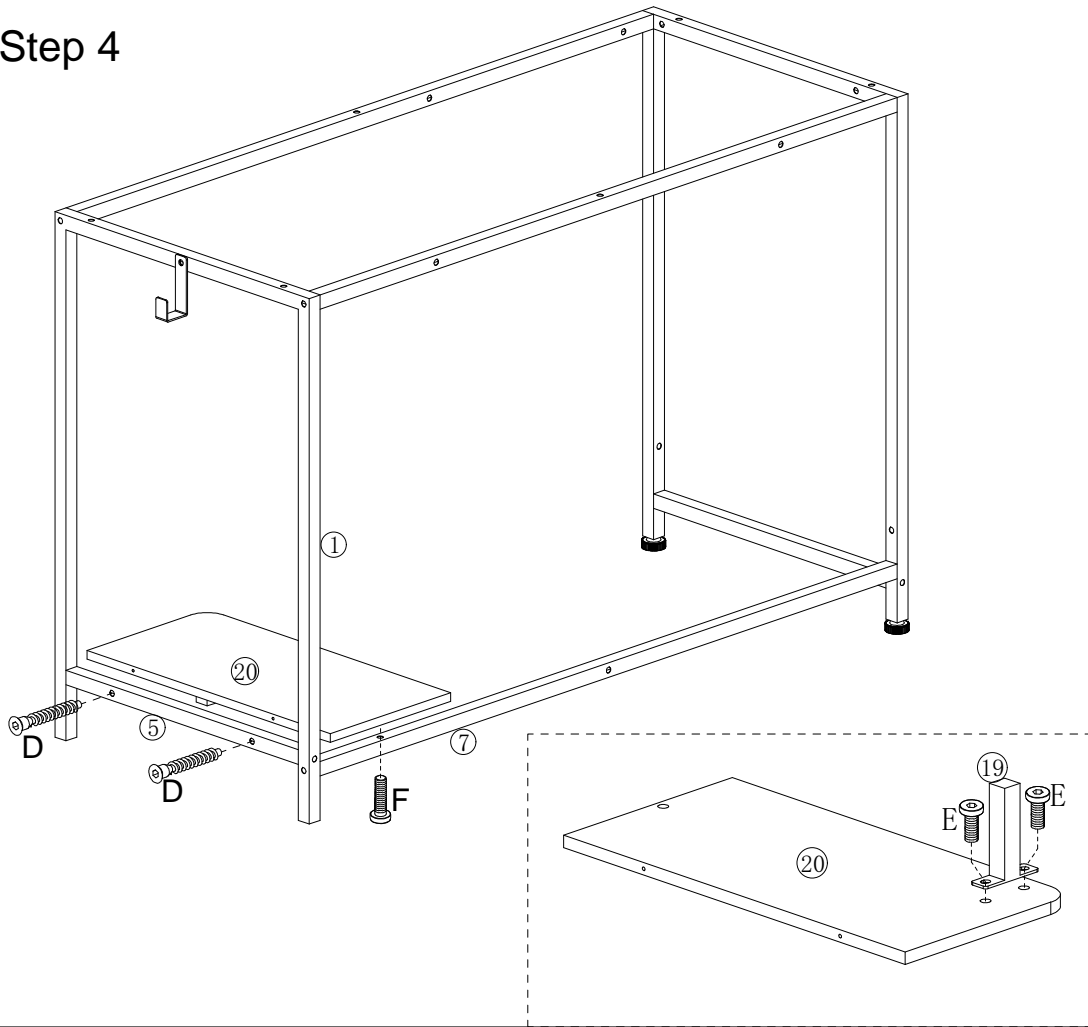

Step 4

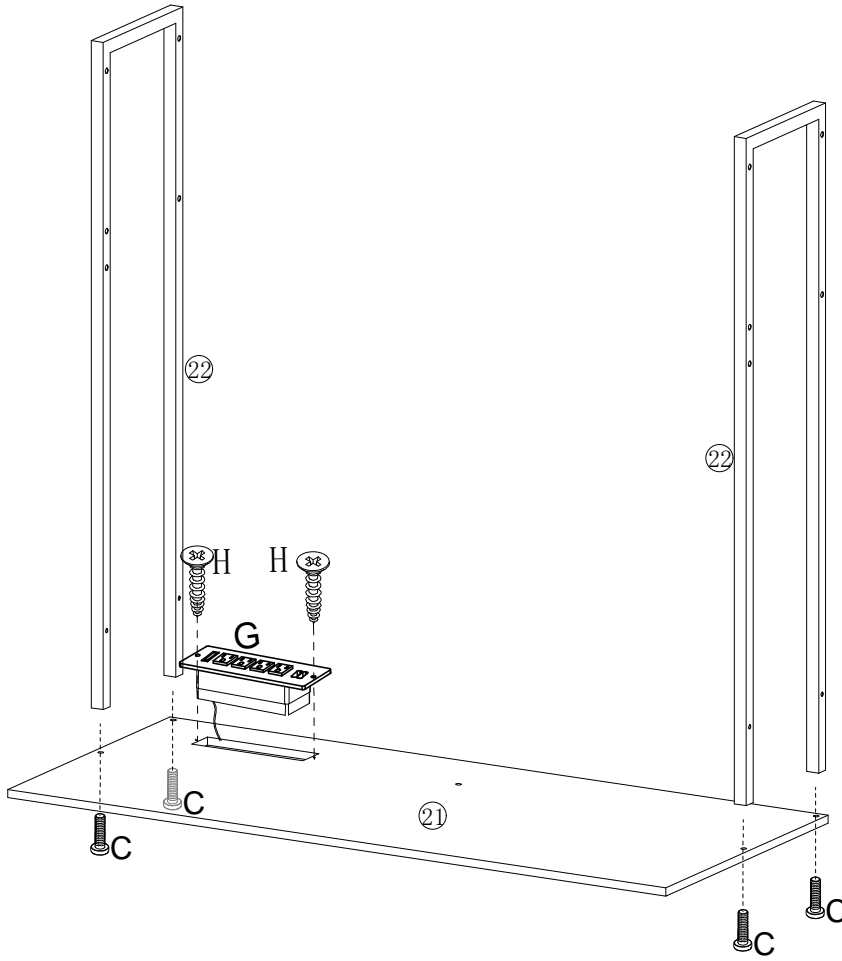

F	X1
M6x25	
D	X2
M5x38	
E	X2
M6x10	

Step 5

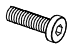



C	X4
	
M6x28	
H	X2
	
ST3.5X12	
G	X1
	

Step 6

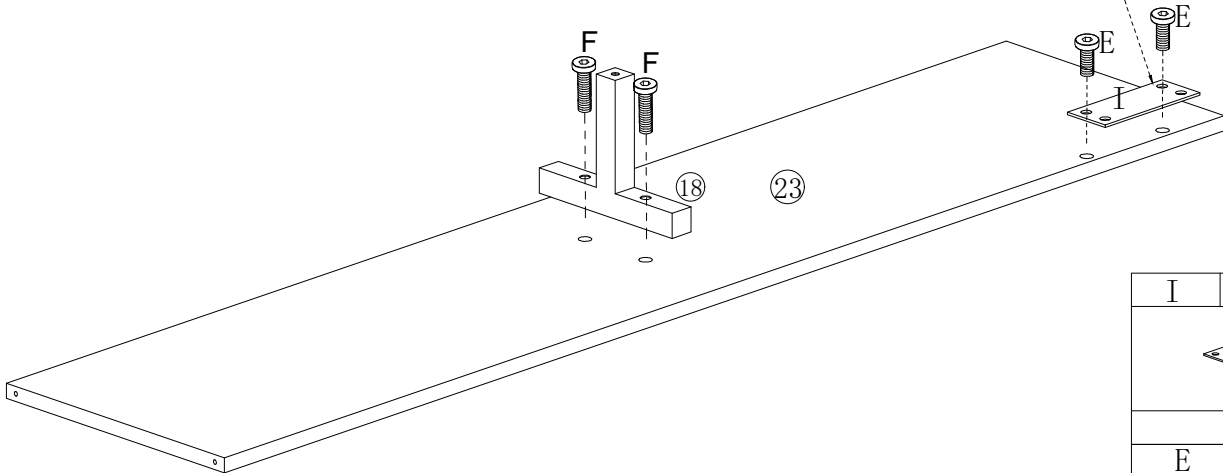
⚠ Pay attention to Installation option II does not require this piece of iron

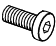

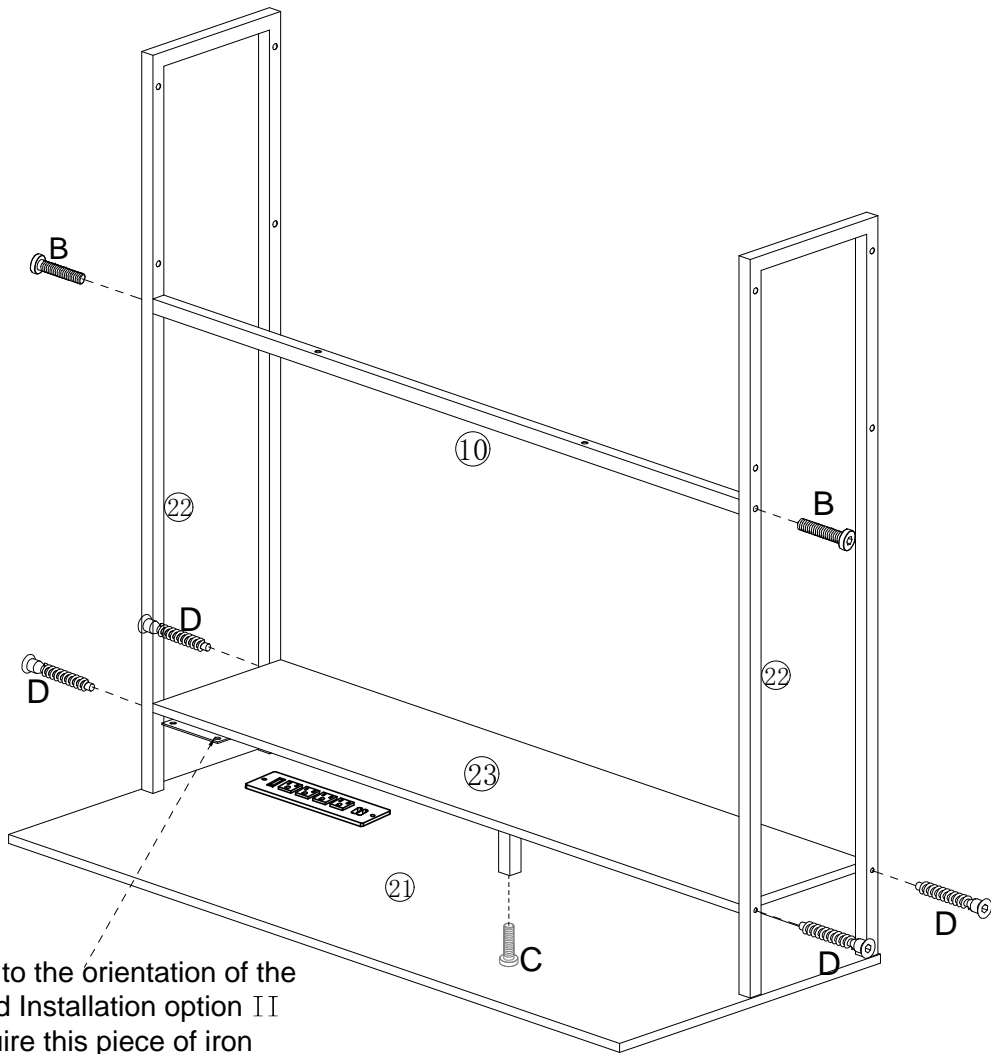

I	x1
	
E	X2
	
M6x10	
F	X2
	
M6x25	

Step 7

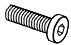

⚠ Pay attention to the orientation of the sheet iron and Installation option II does not require this piece of iron

C	X1
	
M6x28	
B	X2
	
M6x35	
D	X4
	
M5x38	

Step 8

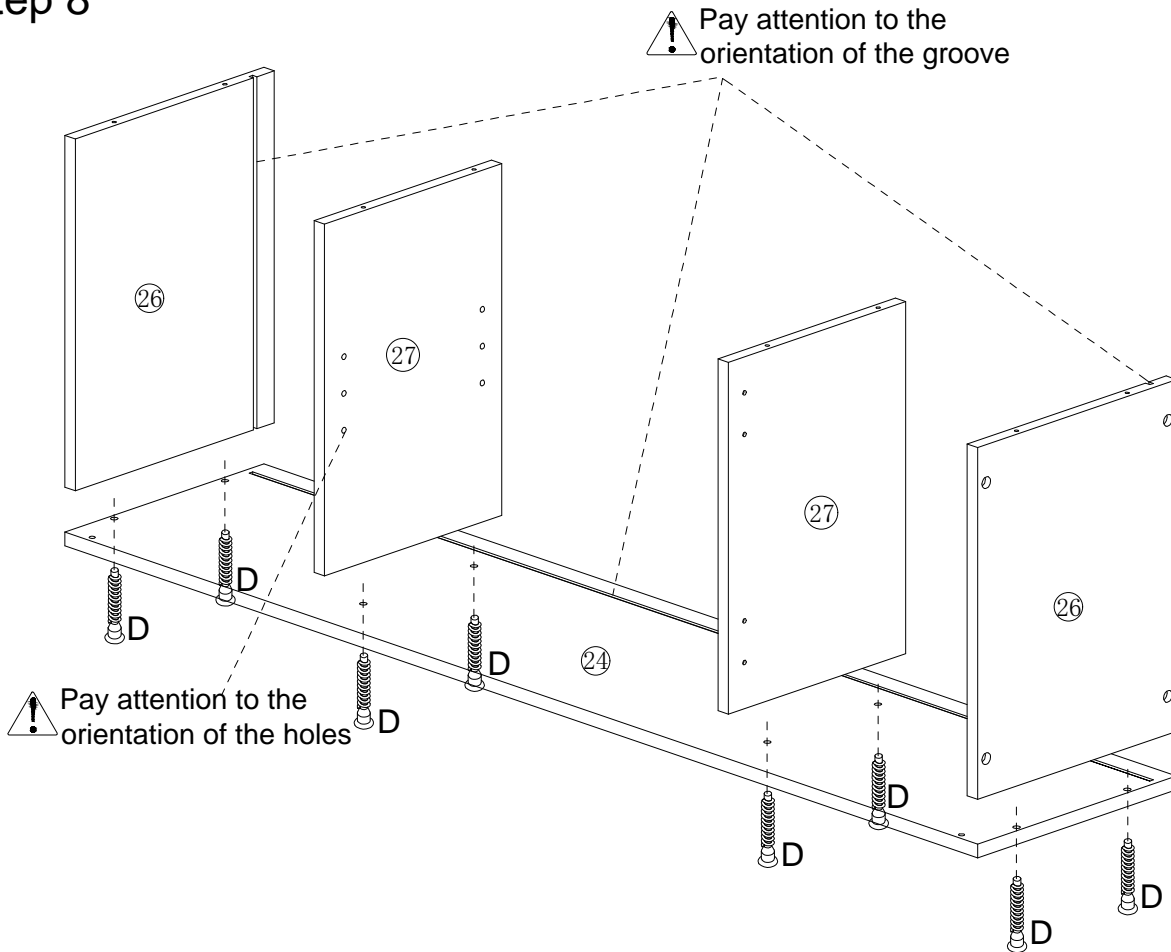



⚠ Pay attention to the orientation of the groove

⚠ Pay attention to the orientation of the holes

D	X8
	
M5x38	

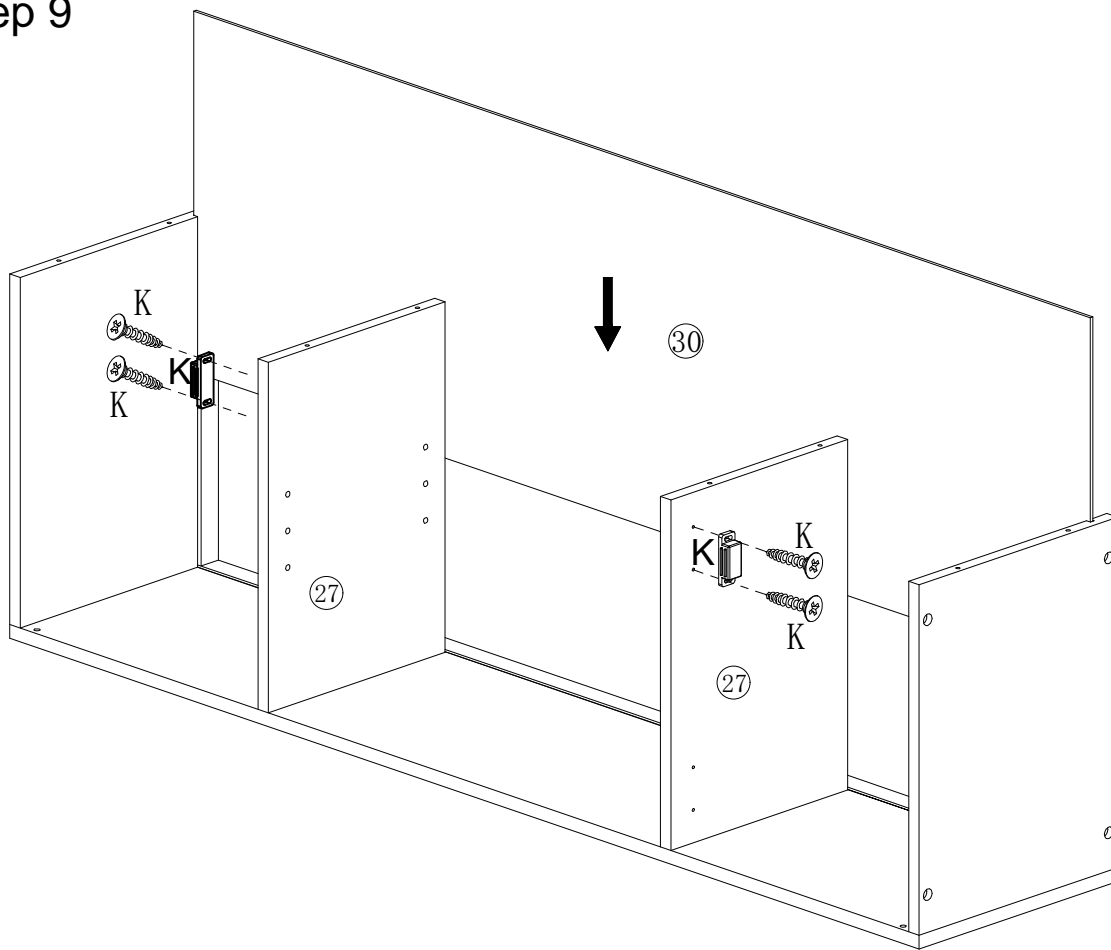

Step 9



K	X2
	
ST3.5X12	

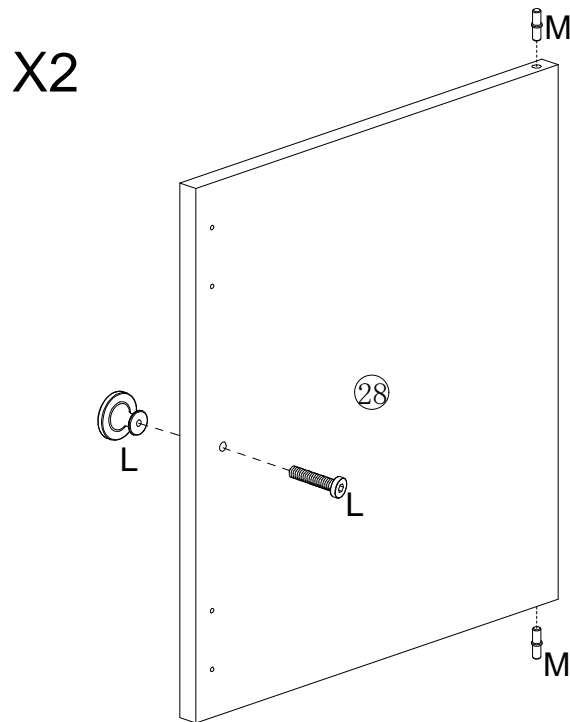

Step 10

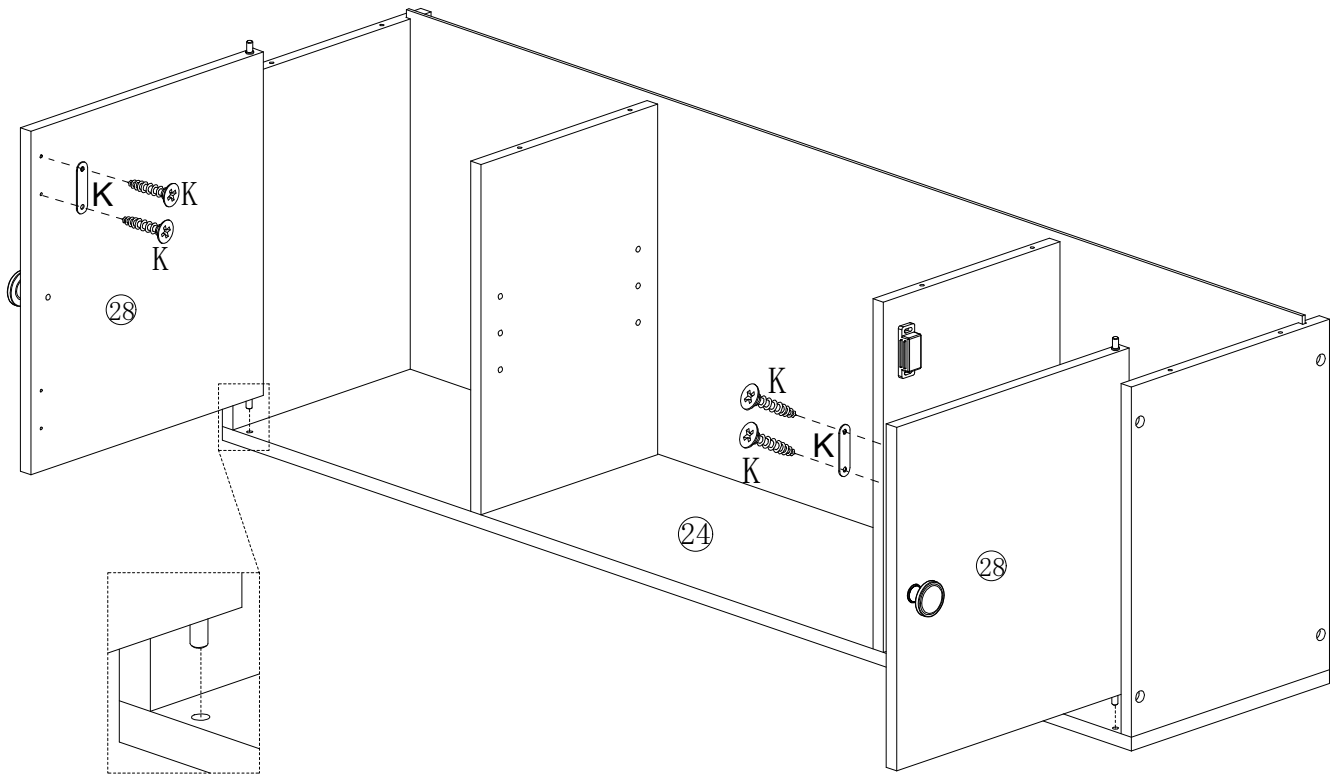

M	X4
	
L	X2
	
M4x16	

Step 11



K	X2
	
ST3.5X12	

Step 12

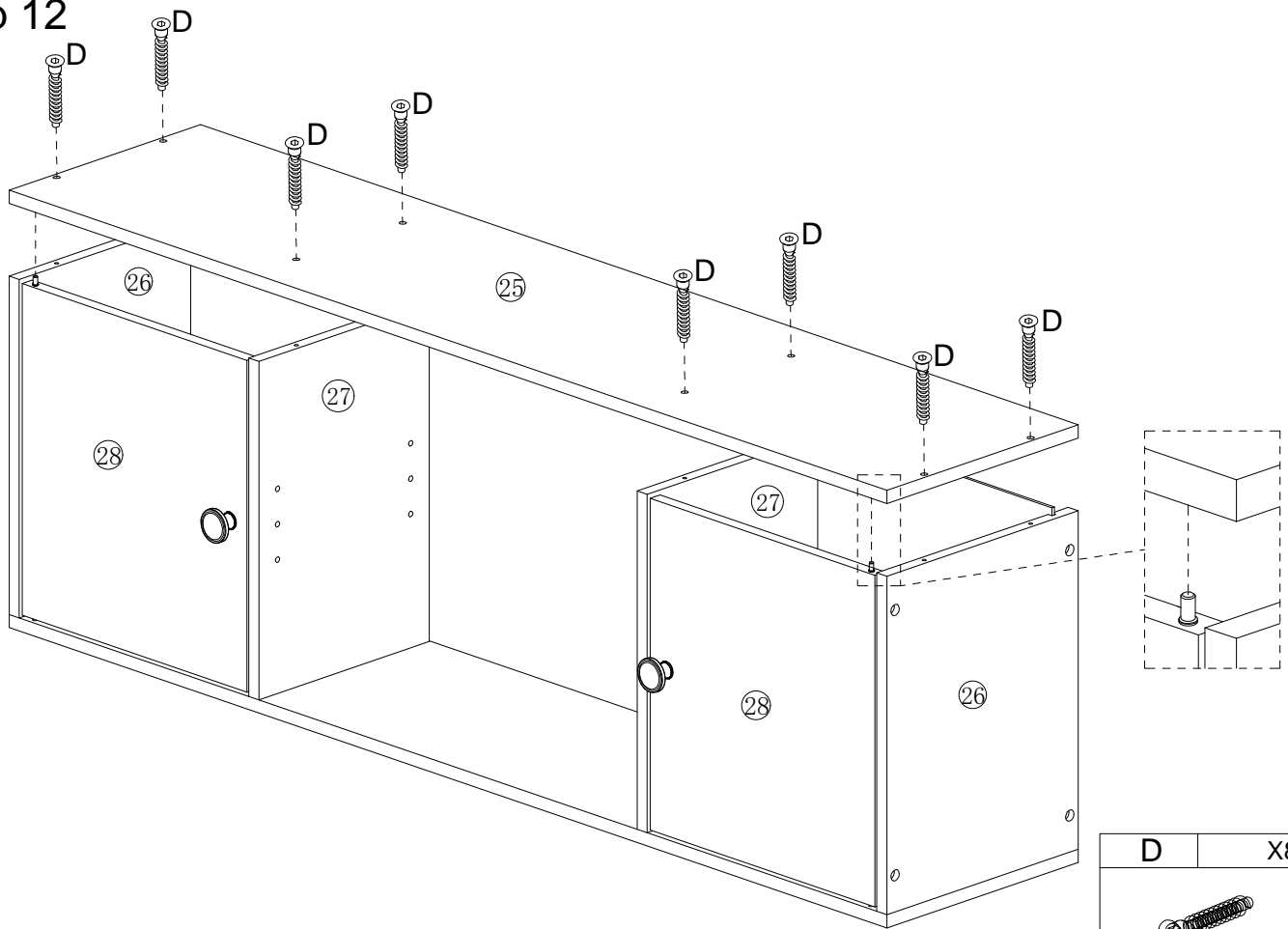

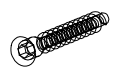
D	X8
	
M5x38	

Step 13

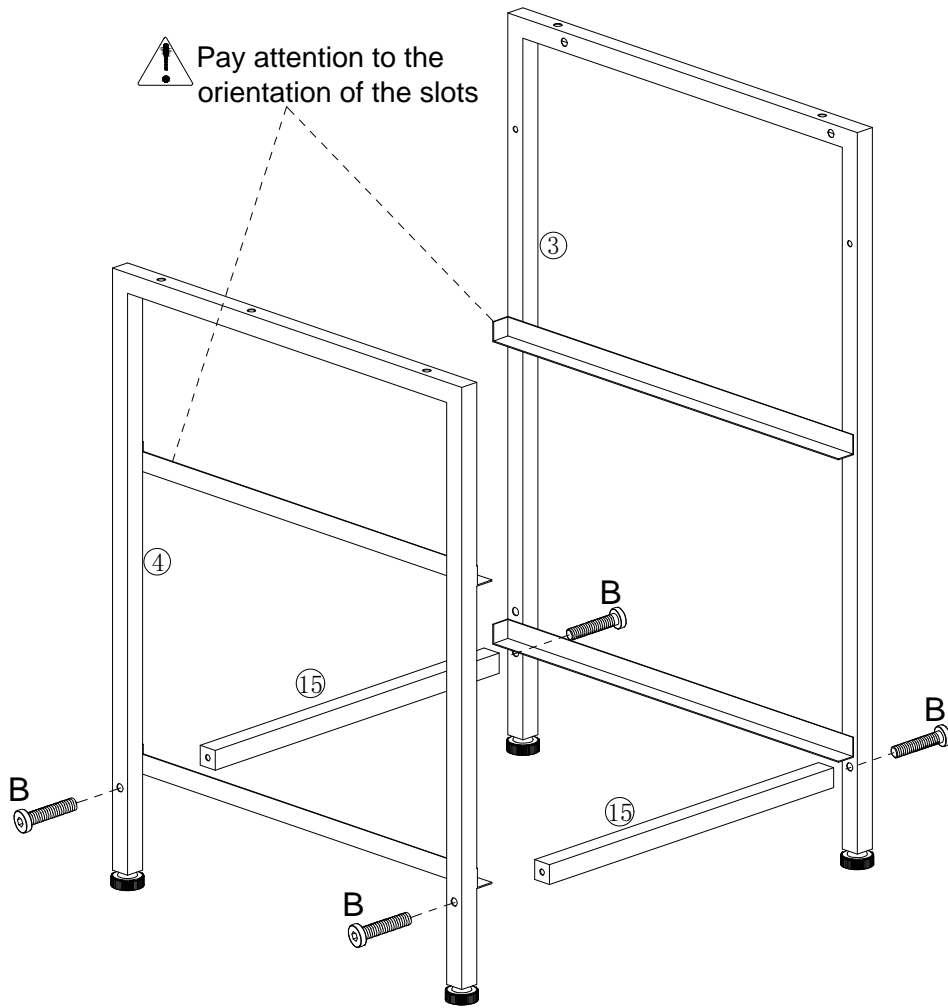

⚠ Pay attention to the orientation of the slots

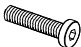

B	X4
	
M6x35	

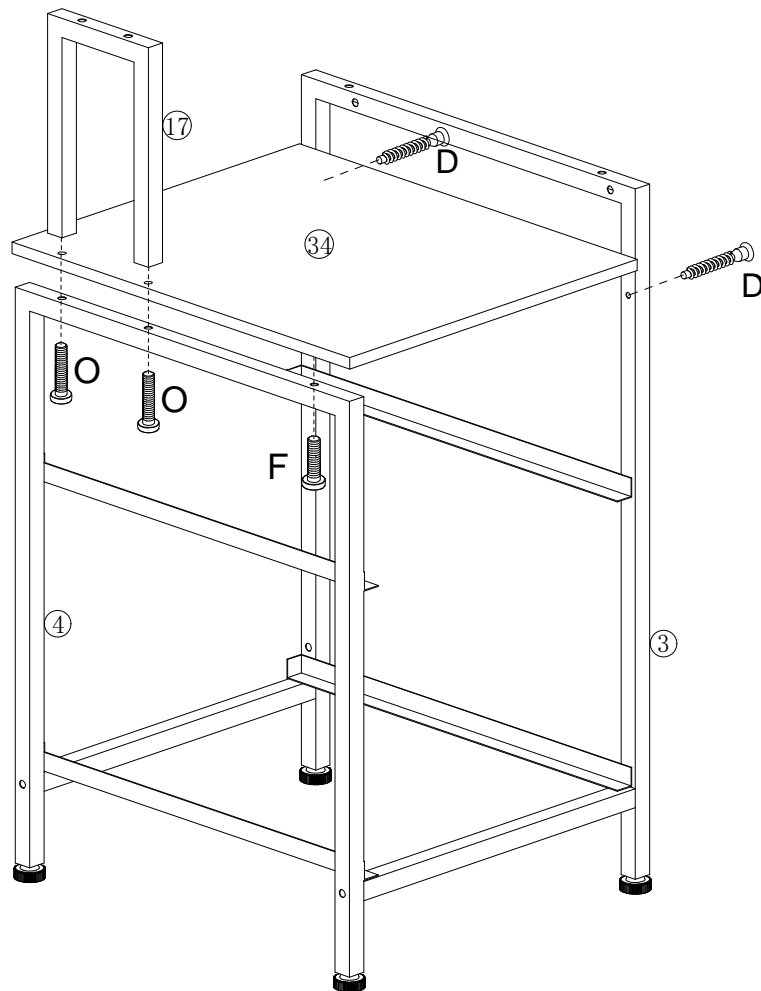
Step 14



O	X2
	
M6x50	
D	X2
	
M5x38	
F	X1
	
M6x25	

Step 15

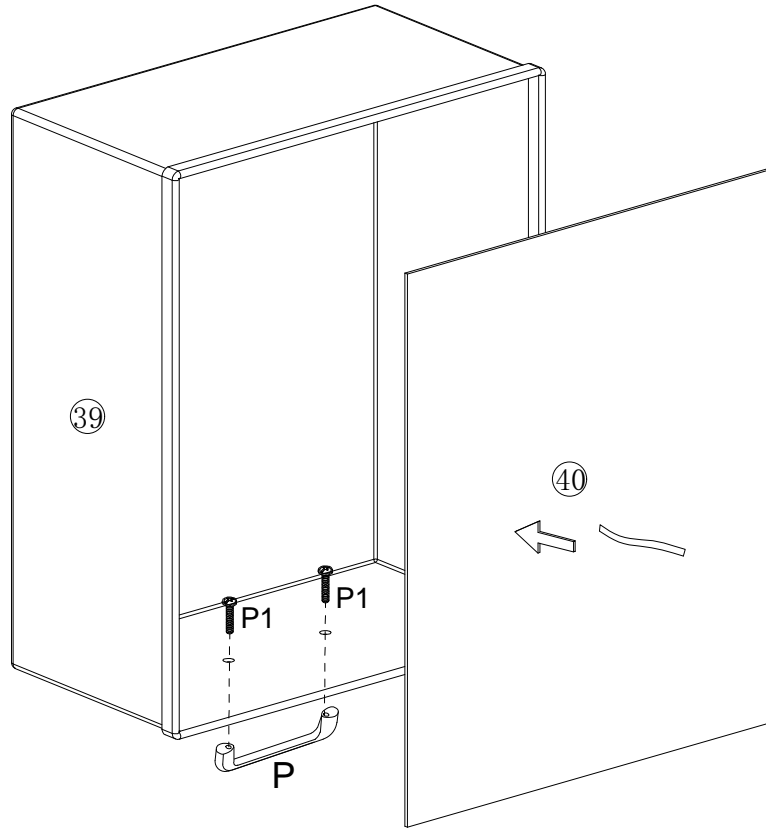
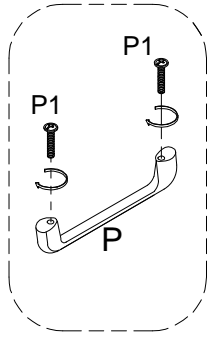

P	X1
P	P1

Step 16

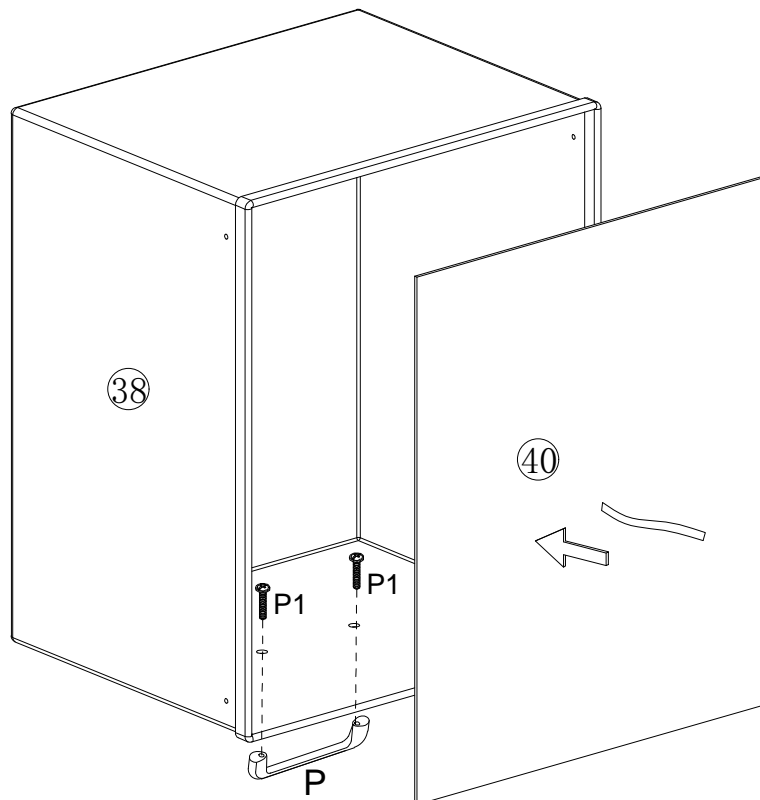
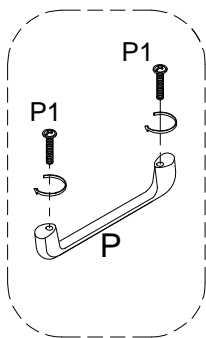

P	X1
P	P1

Step 17

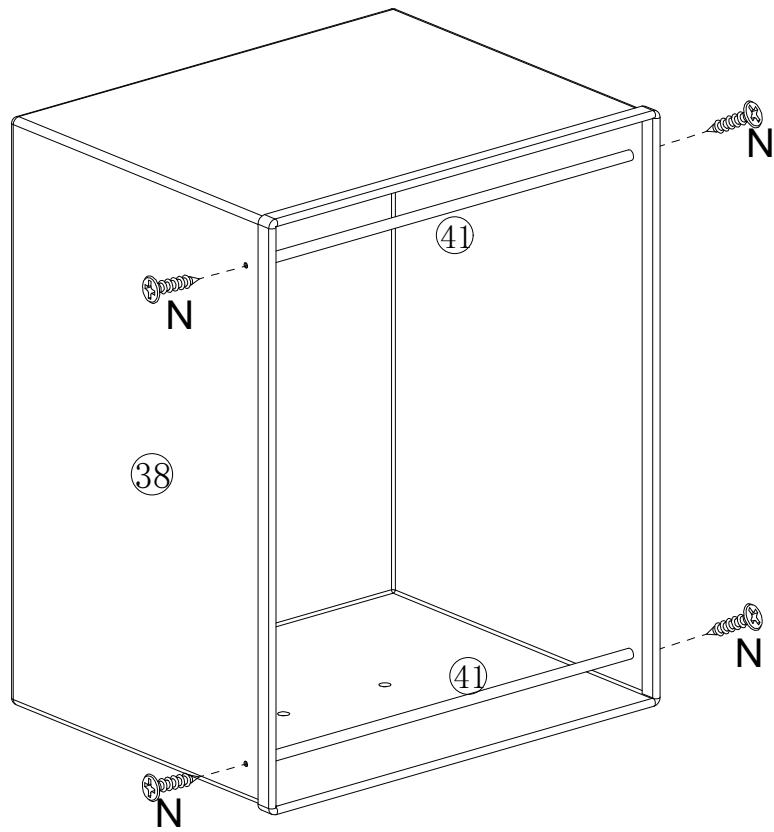

N	x4
	
ST3x16	

Step 18

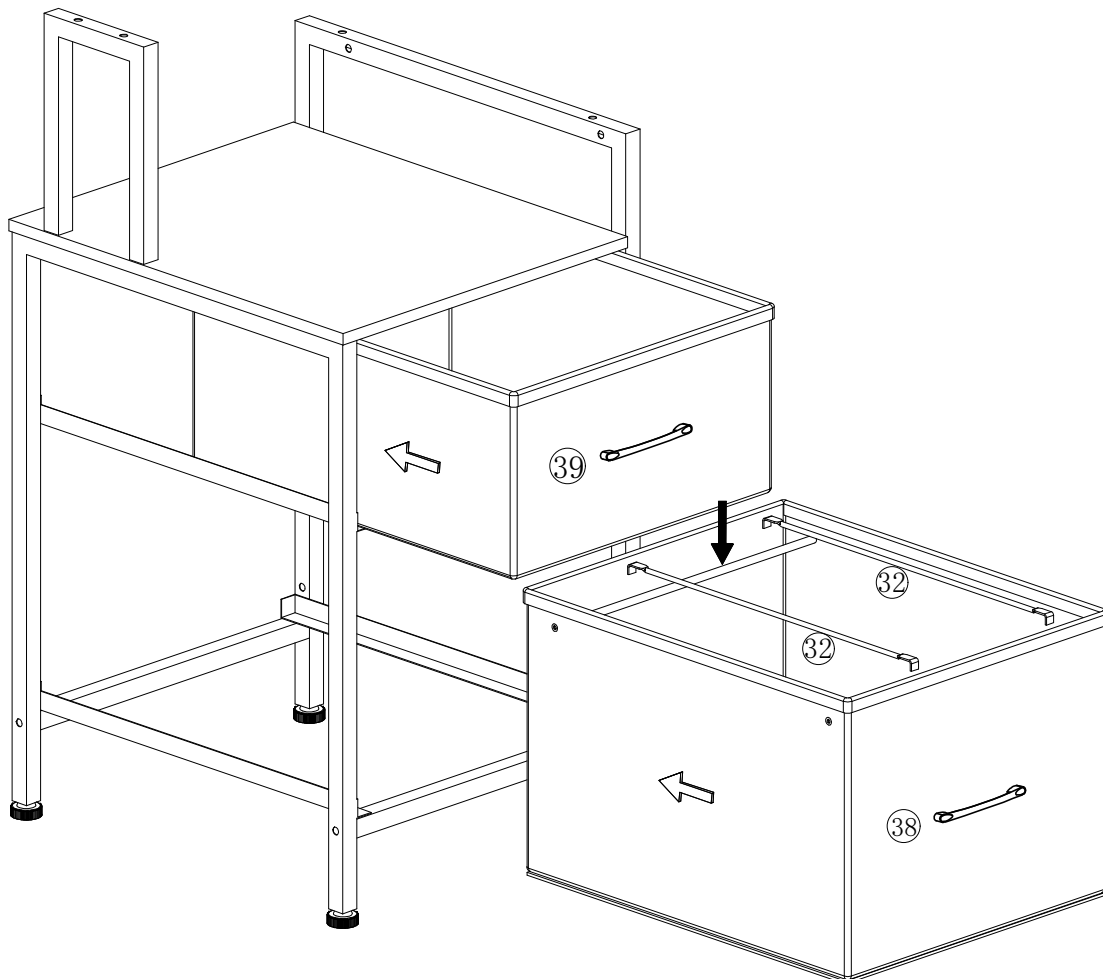

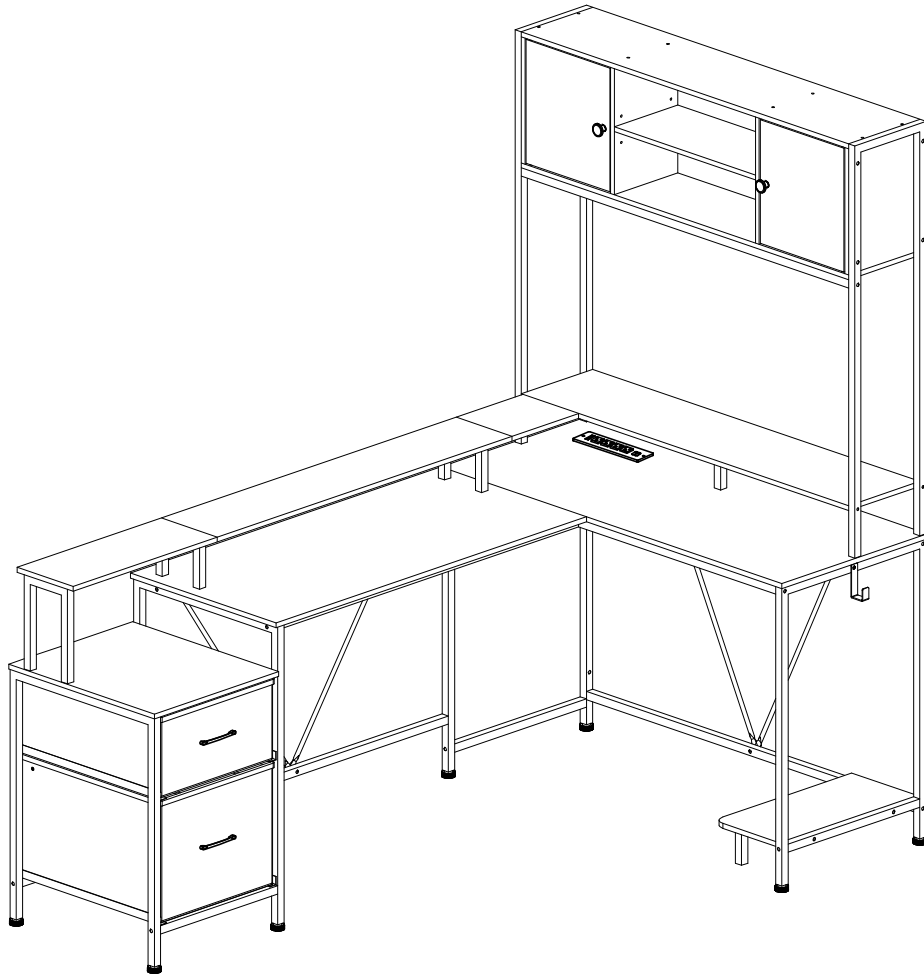

Installation Option I

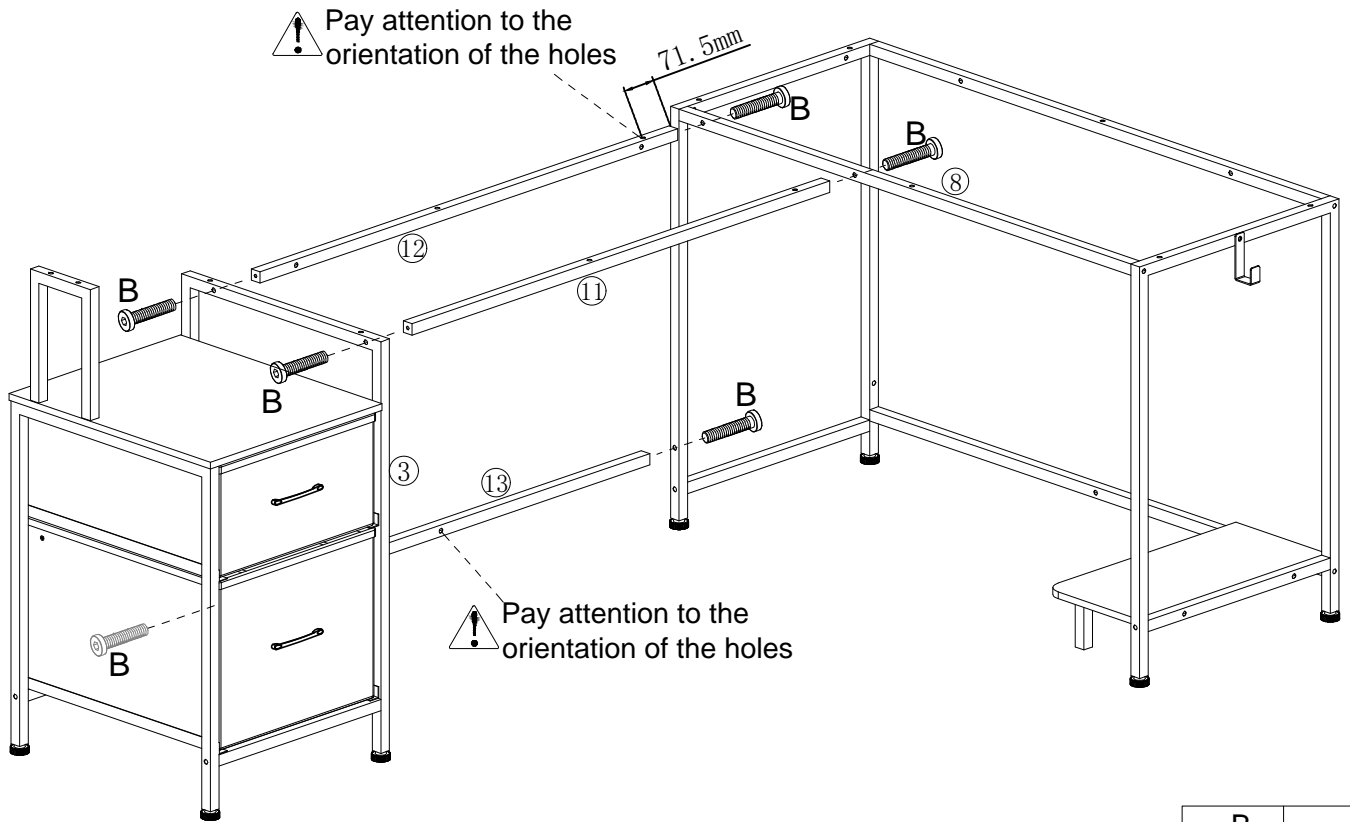

With the basic components of Step1-step18,
the following installation method is the first.

Step 19-1



B	X6
	
M6x35	

Step 20-1

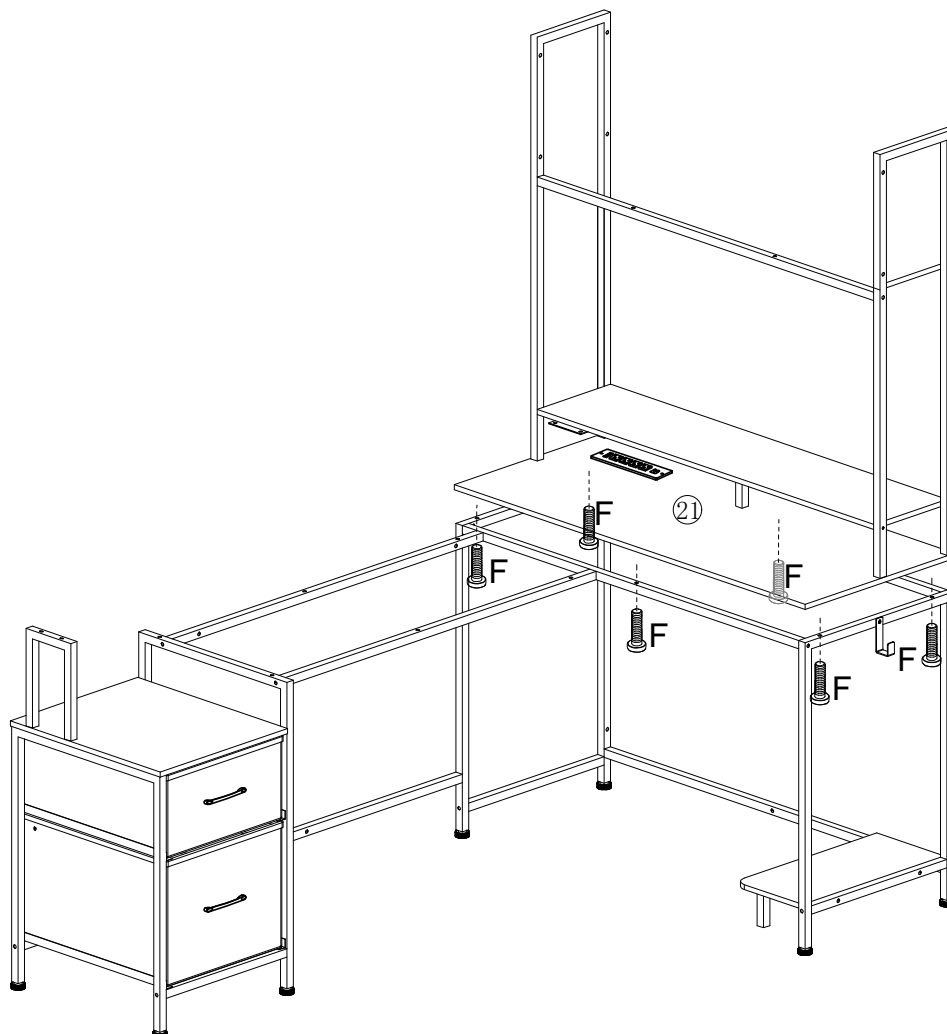

F	X6
	
M6x25	

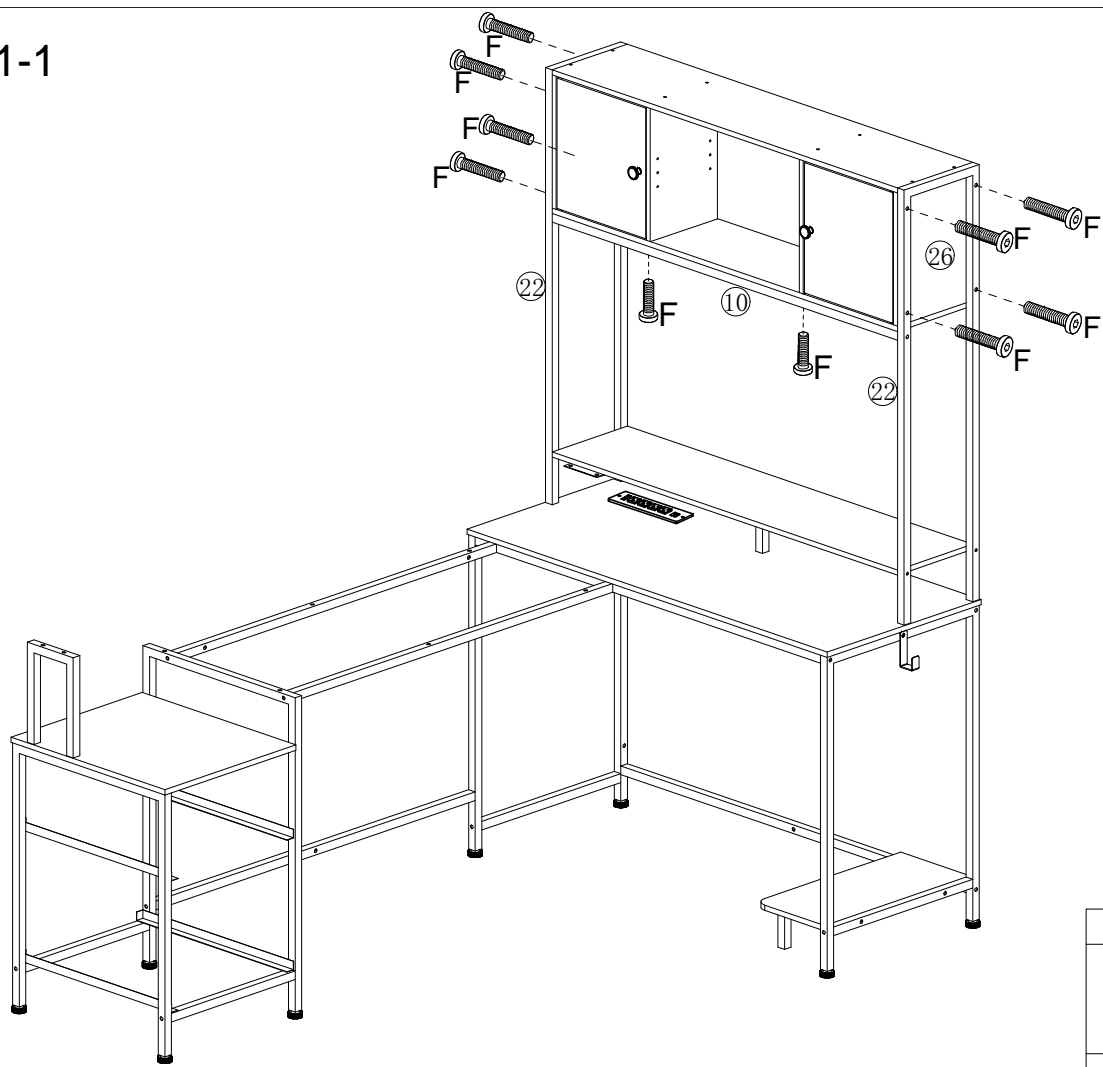

Step 21-1

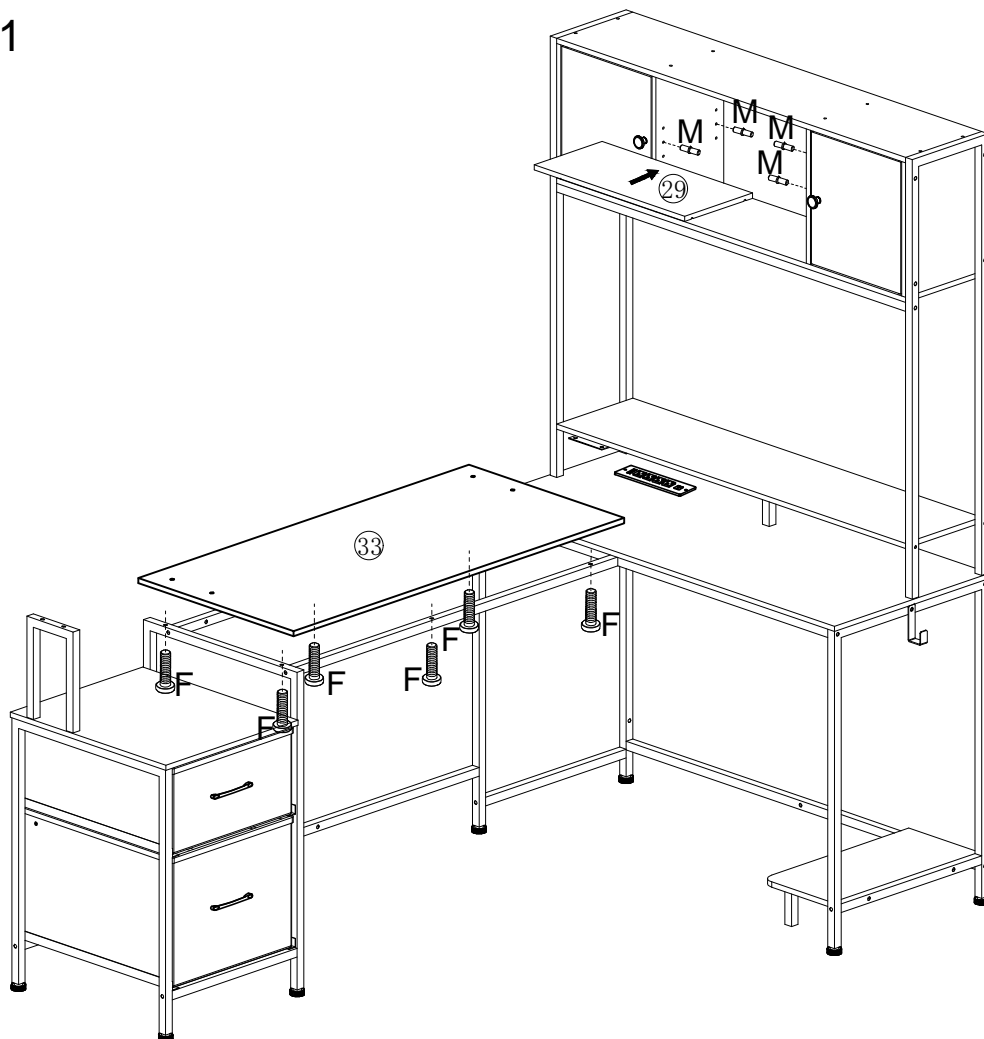

F	X10
	
M6x25	

Step 22-1

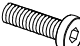

F	X6
	
M6x25	
M	X4
	

Step 23-1

The board goes into the dowel first

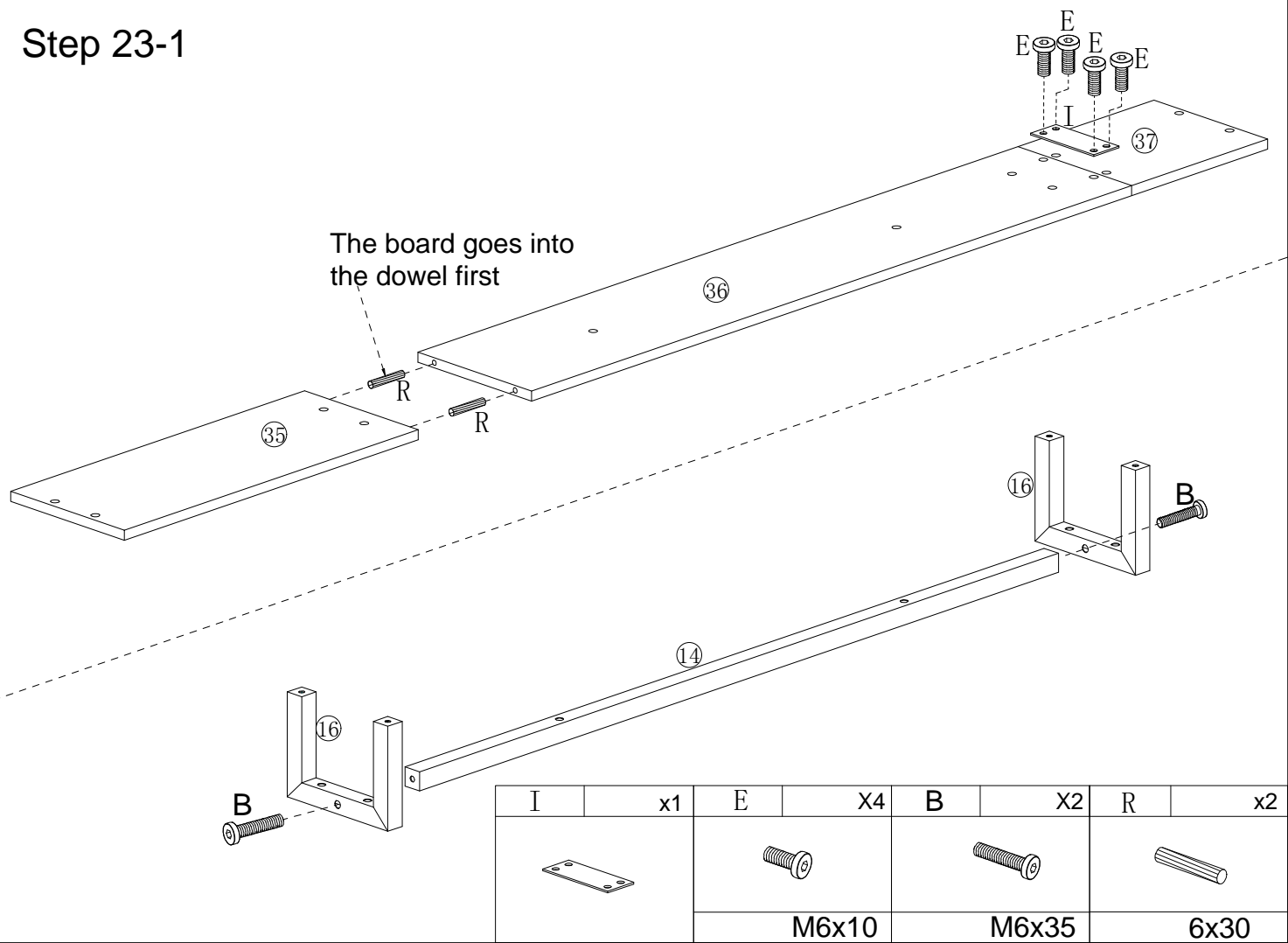

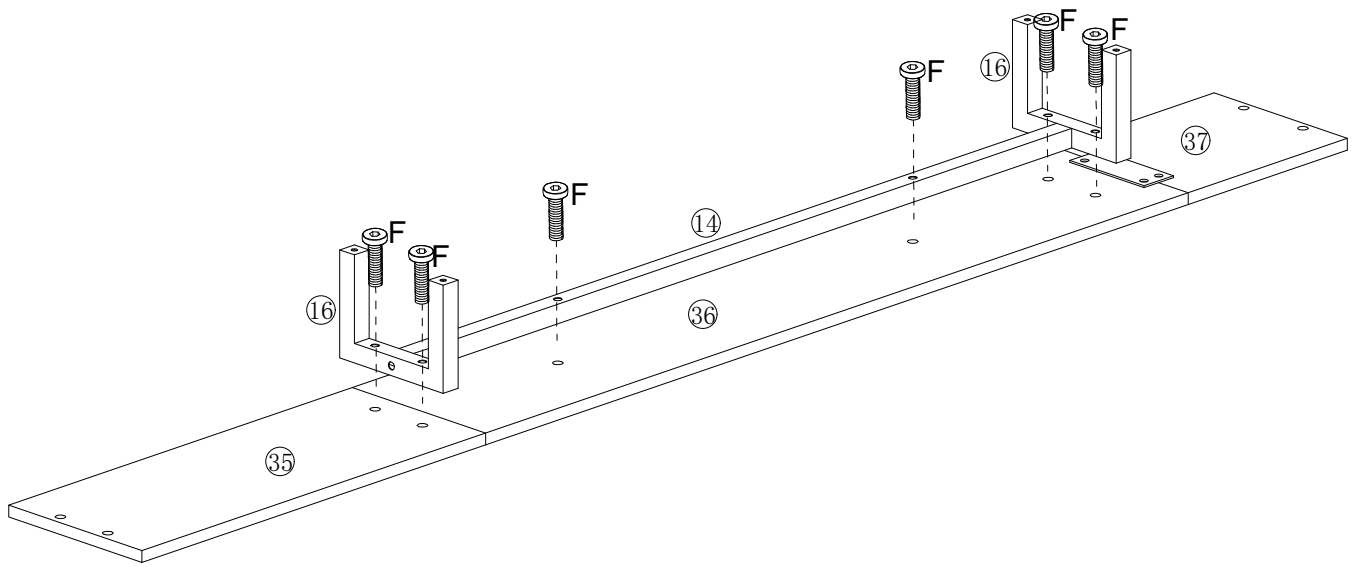

Step 24-1



F	x6
	
M6x25	

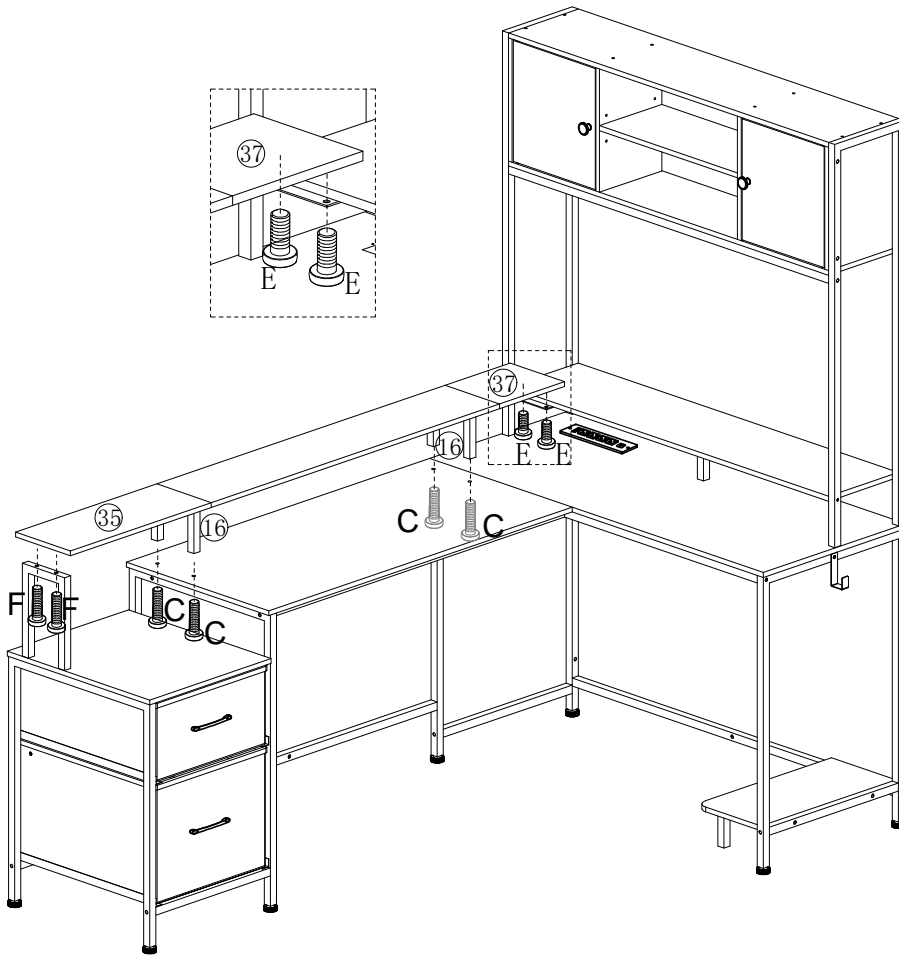

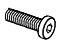
Step 25-1

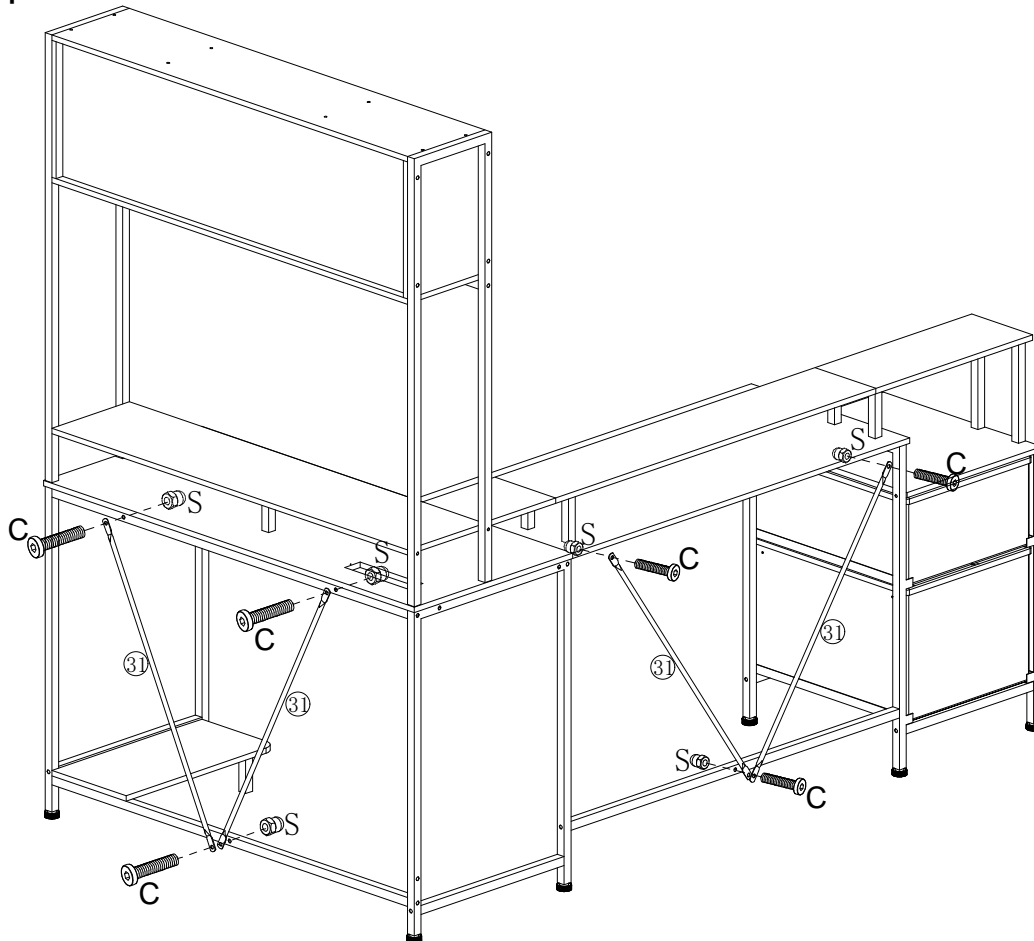

F	X2
	
M6x25	
E	X2
	
M6x10	
C	X4
	
M6x28	

Step 26-1



S	X6
	
M6	
C	X6
	
M6x28	



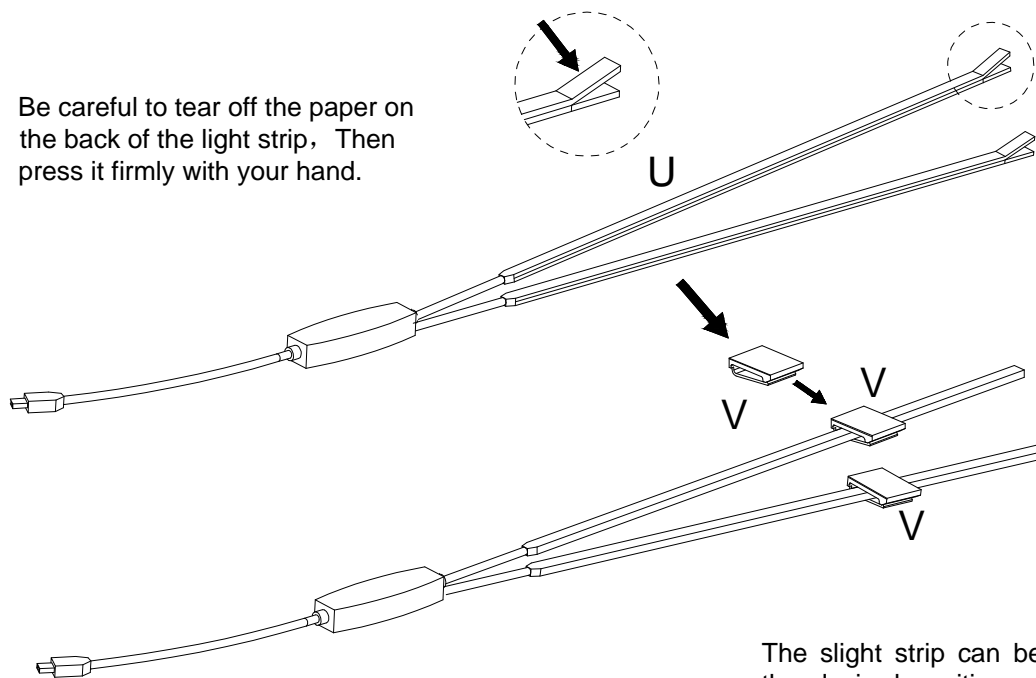

Step 27-1

Be careful to tear off the paper on the back of the light strip, Then press it firmly with your hand.

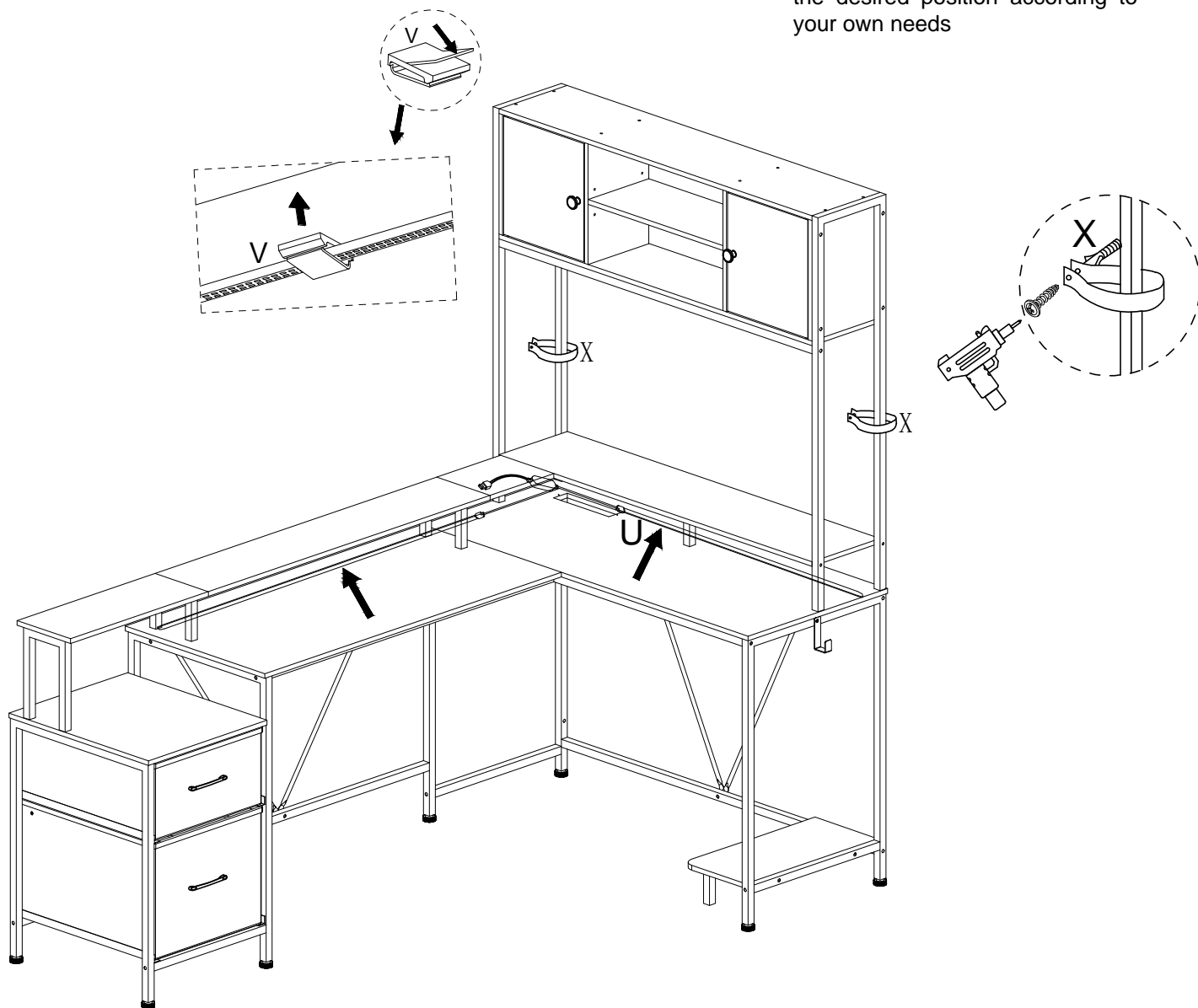

The slight strip can be pasted to the desired position according to your own needs

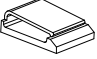

X	X2	V	x8	U	x1
					
ST4×30					

Installation Option II

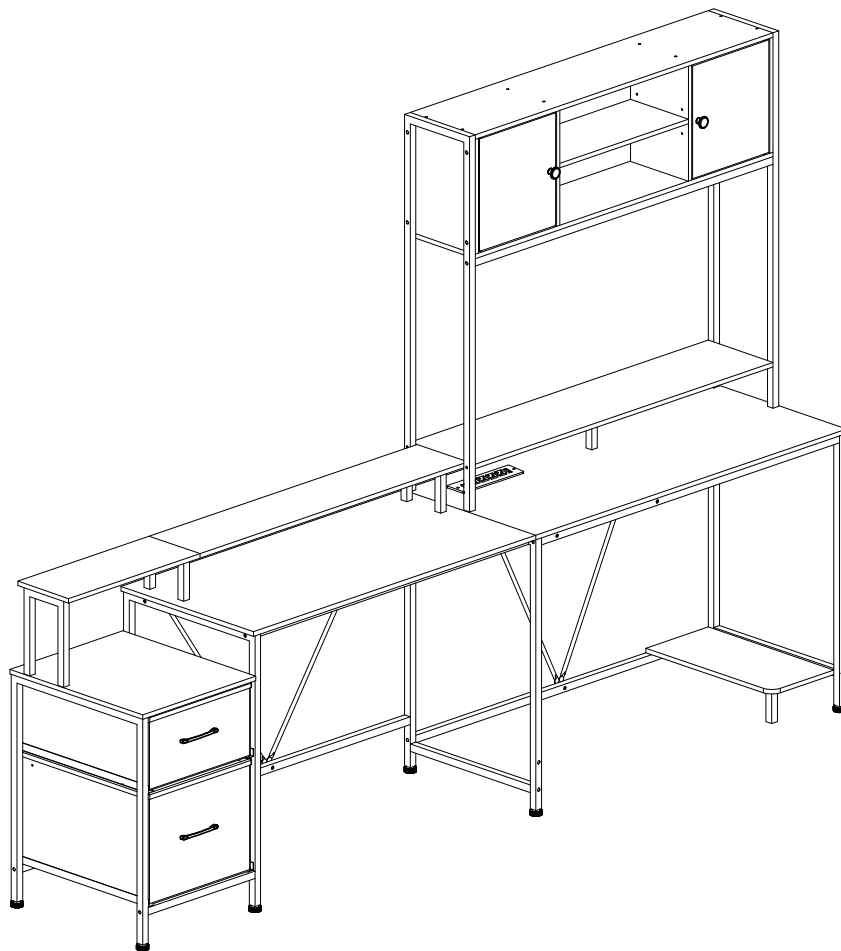

With the basic components of Step1-step18,
the following installation method is the second.

Step 19-2

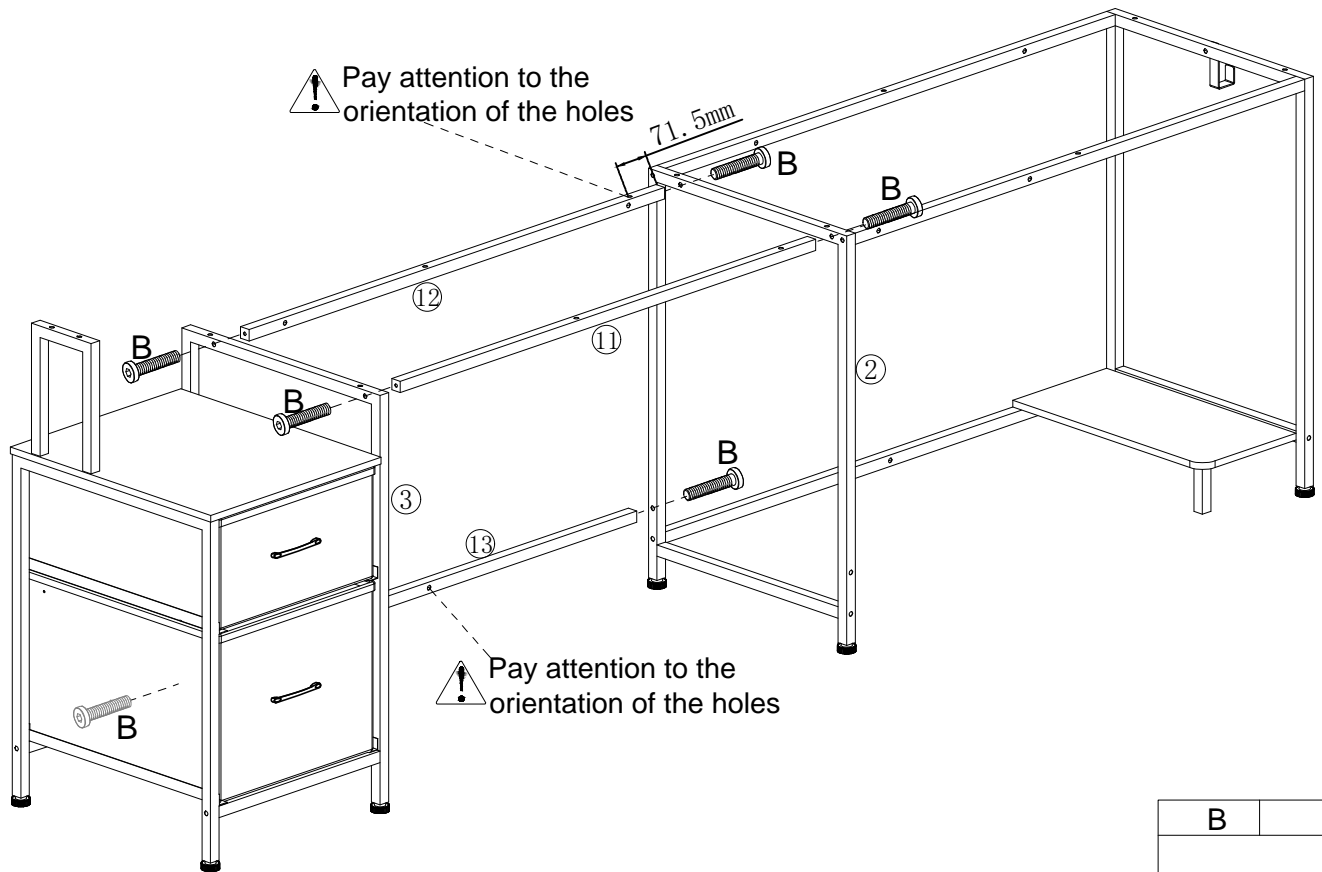

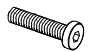
B	X6
	
M6x35	

Step 20-2

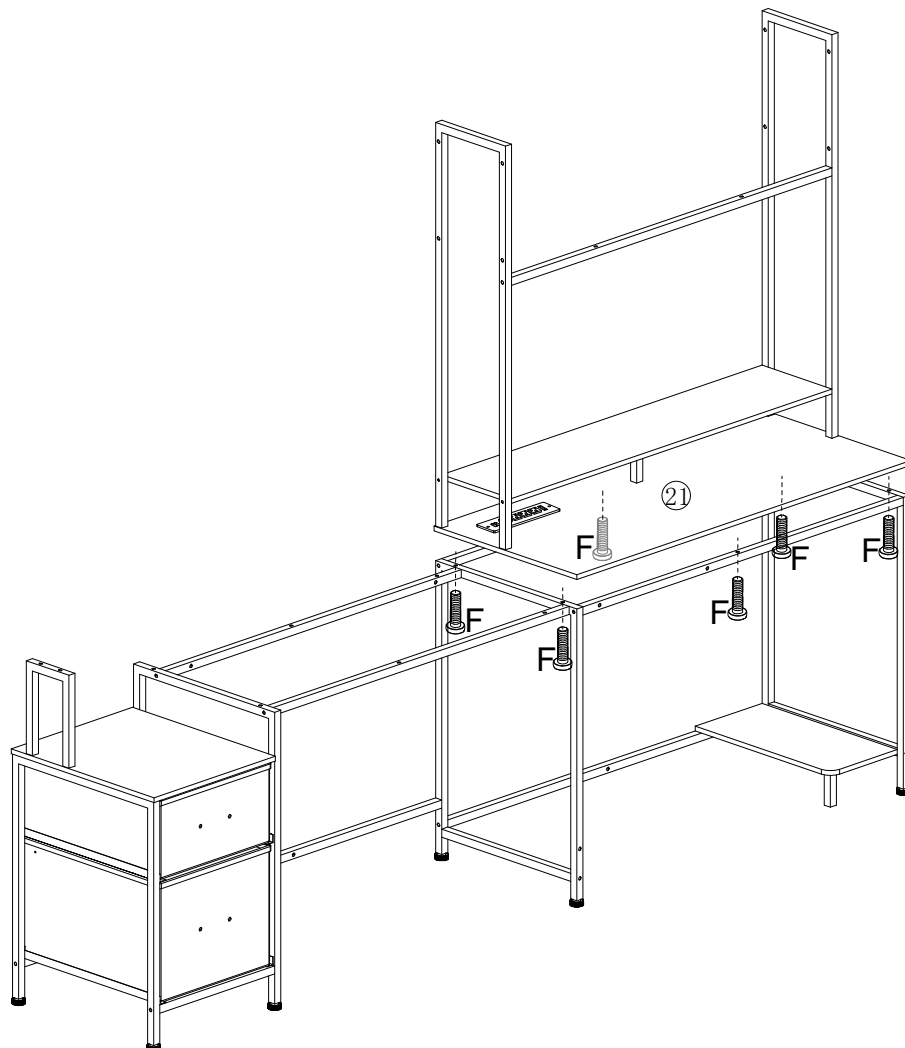

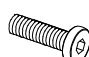
F	X6
	
M6x25	

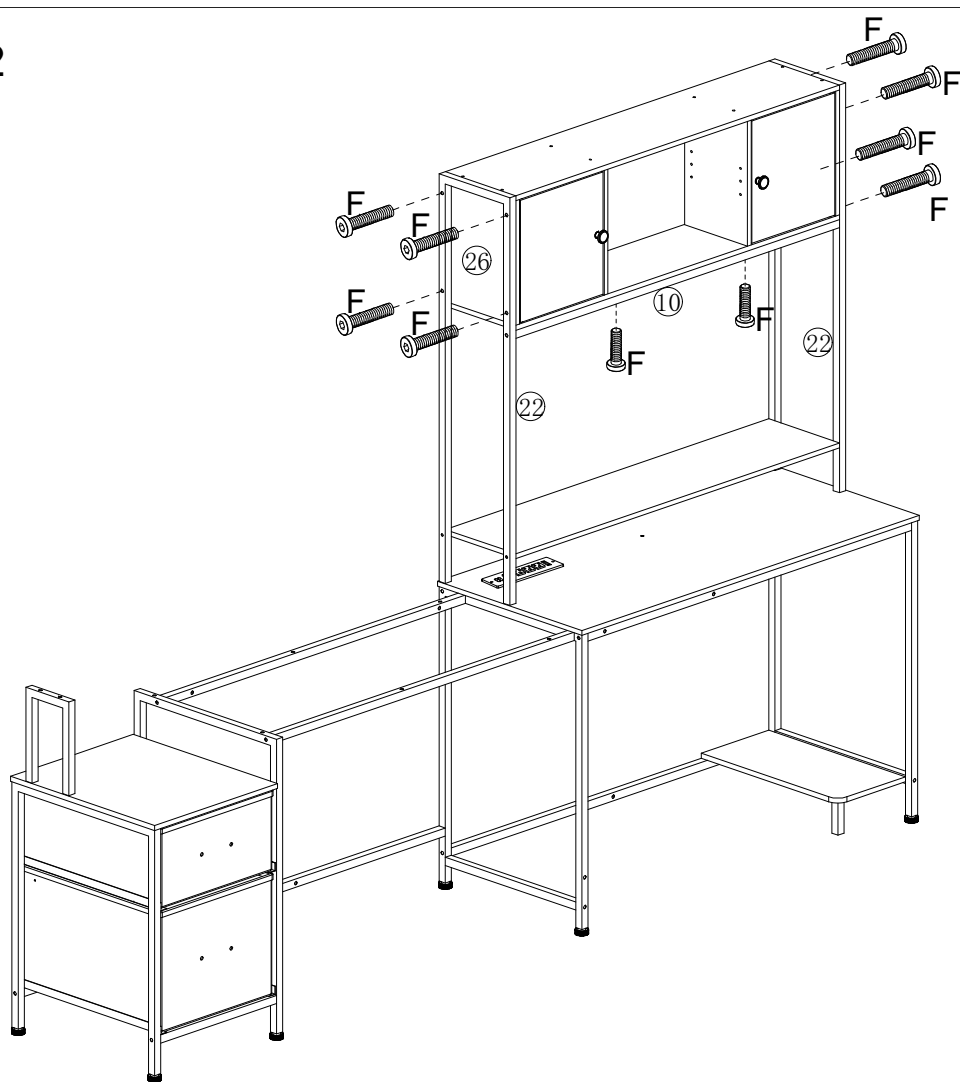

Step 21-2

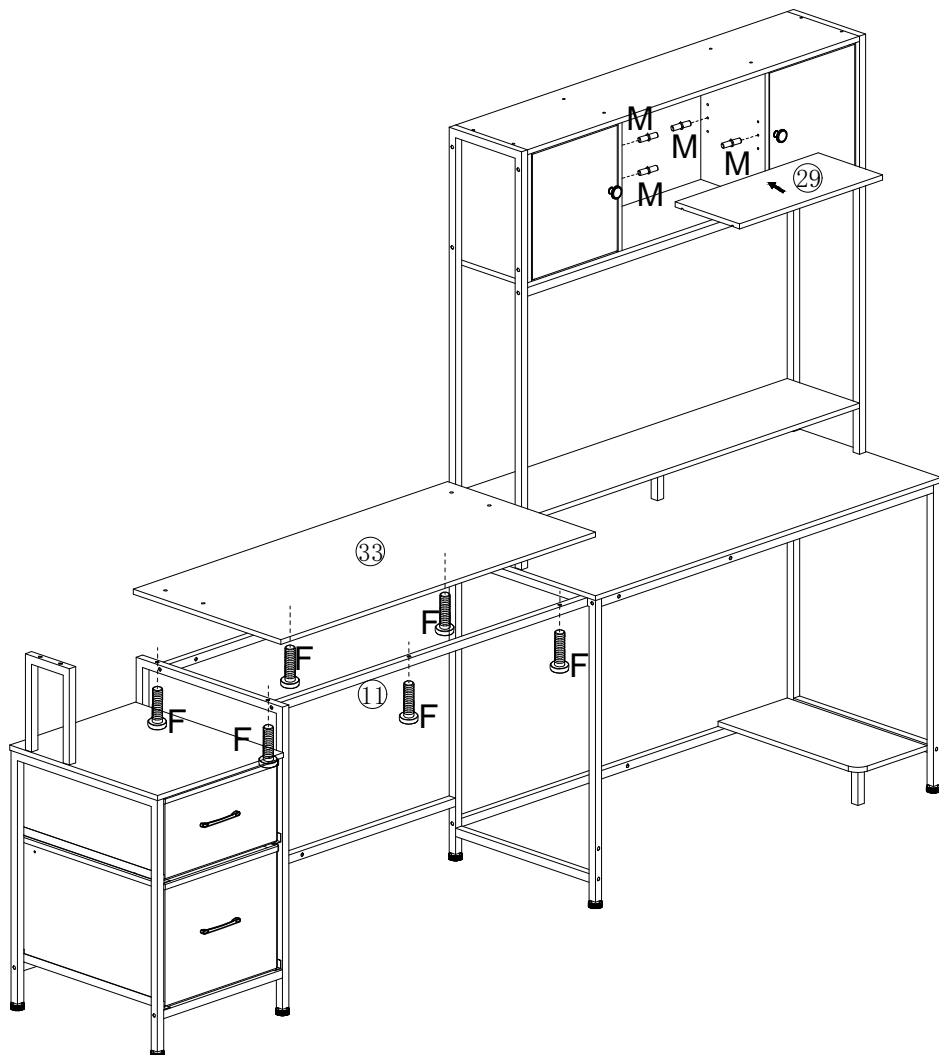

F	X10
	
M6x25	

Step 22-2



F	X6
	
M6x28	
M	X4
	

Step 23-2

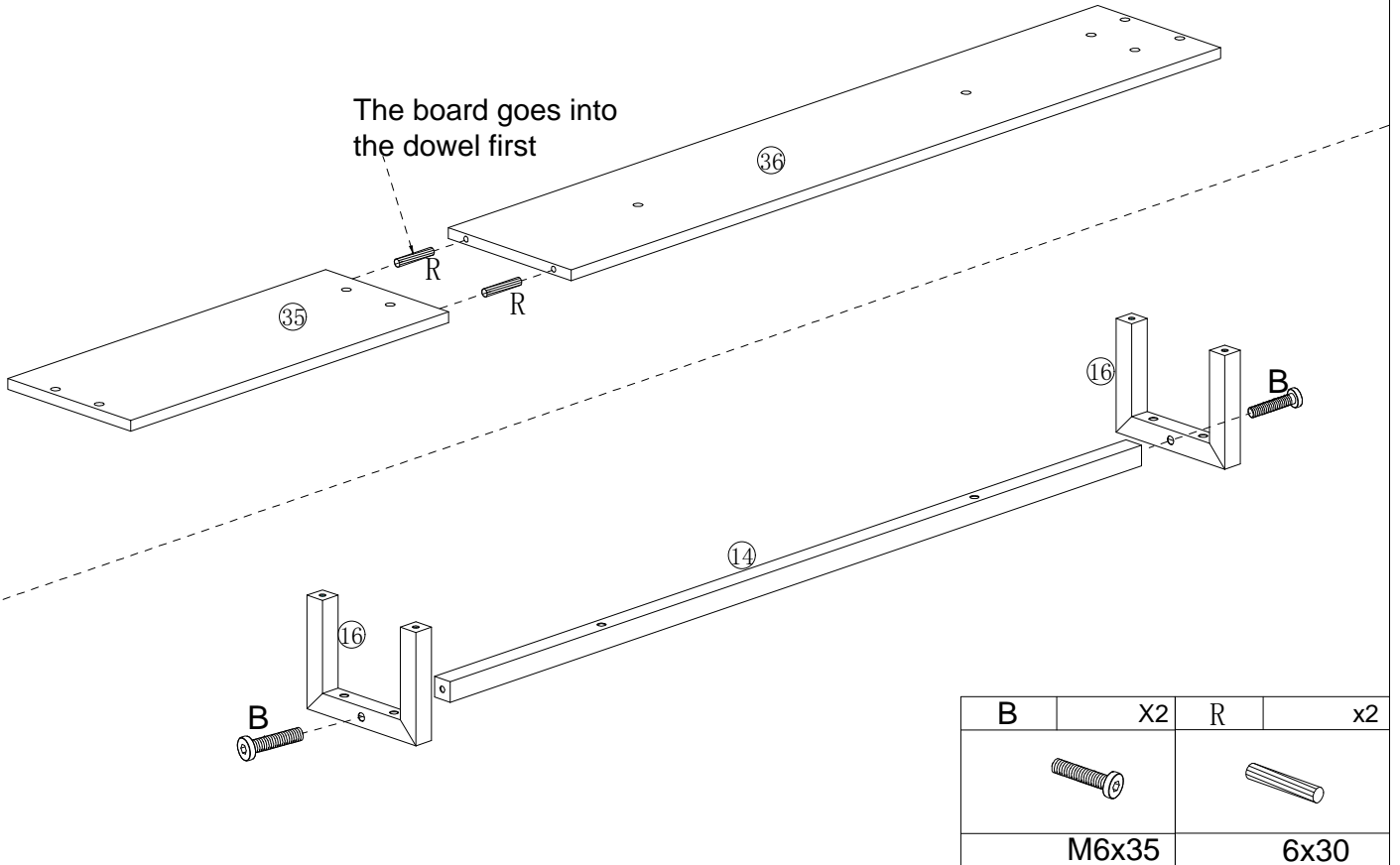

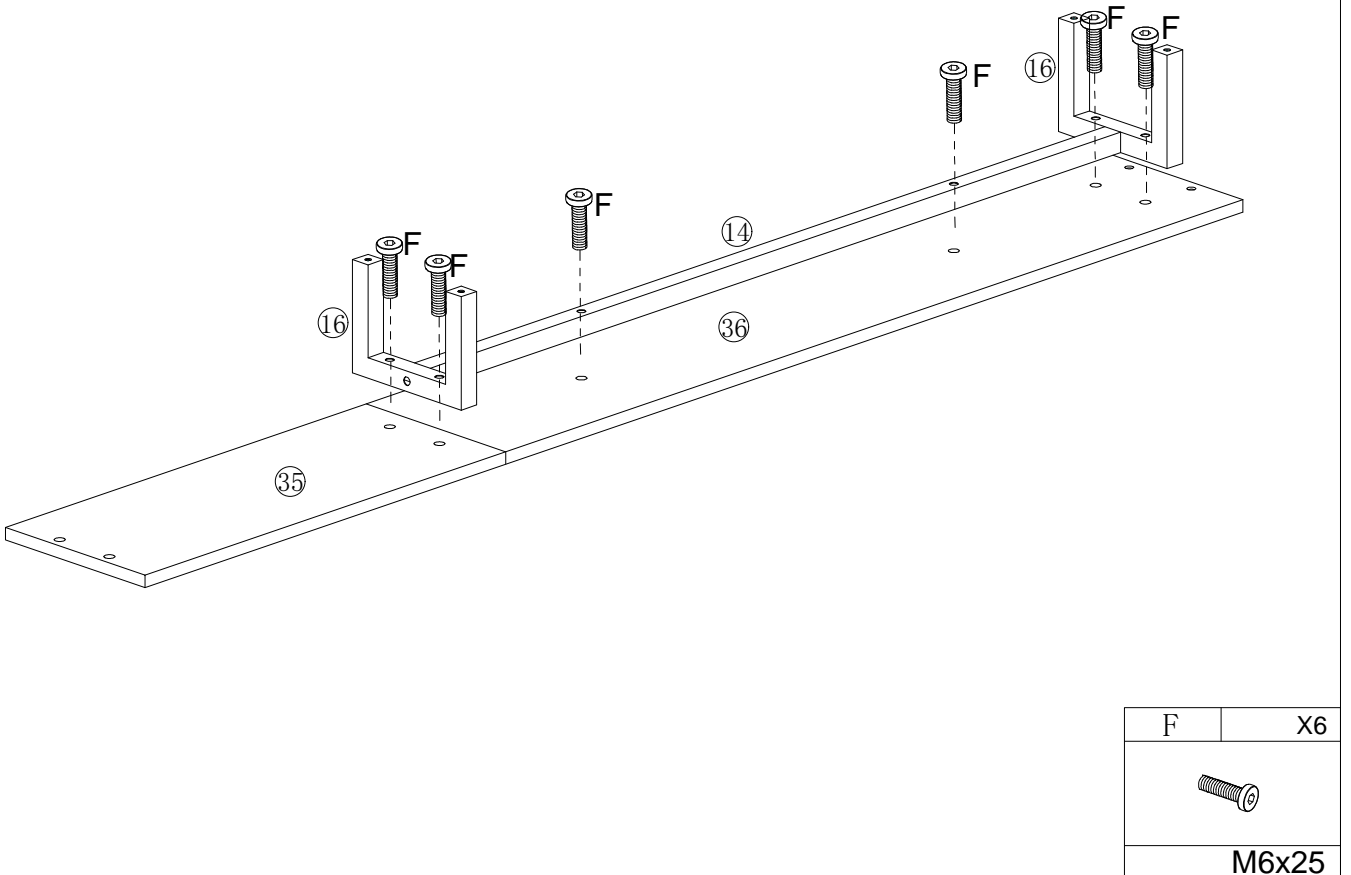

Step 24-2



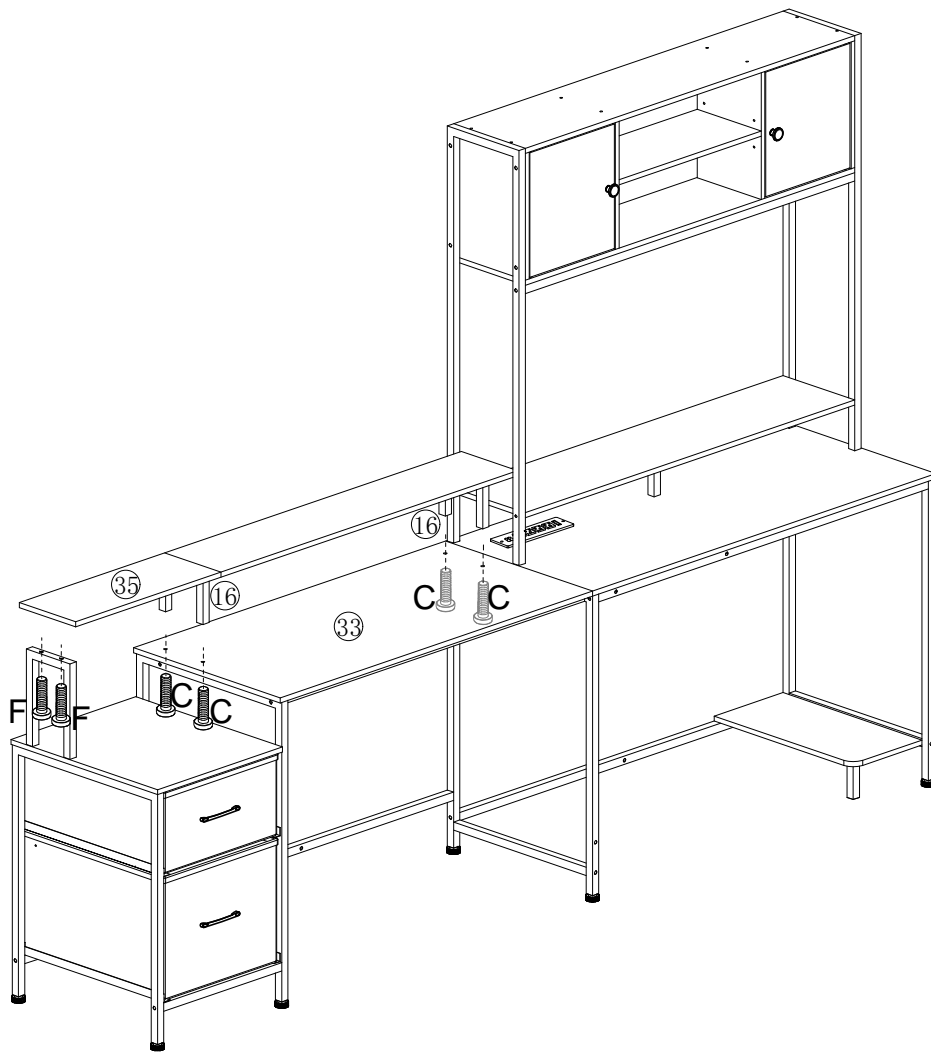

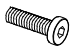
Step 25-2

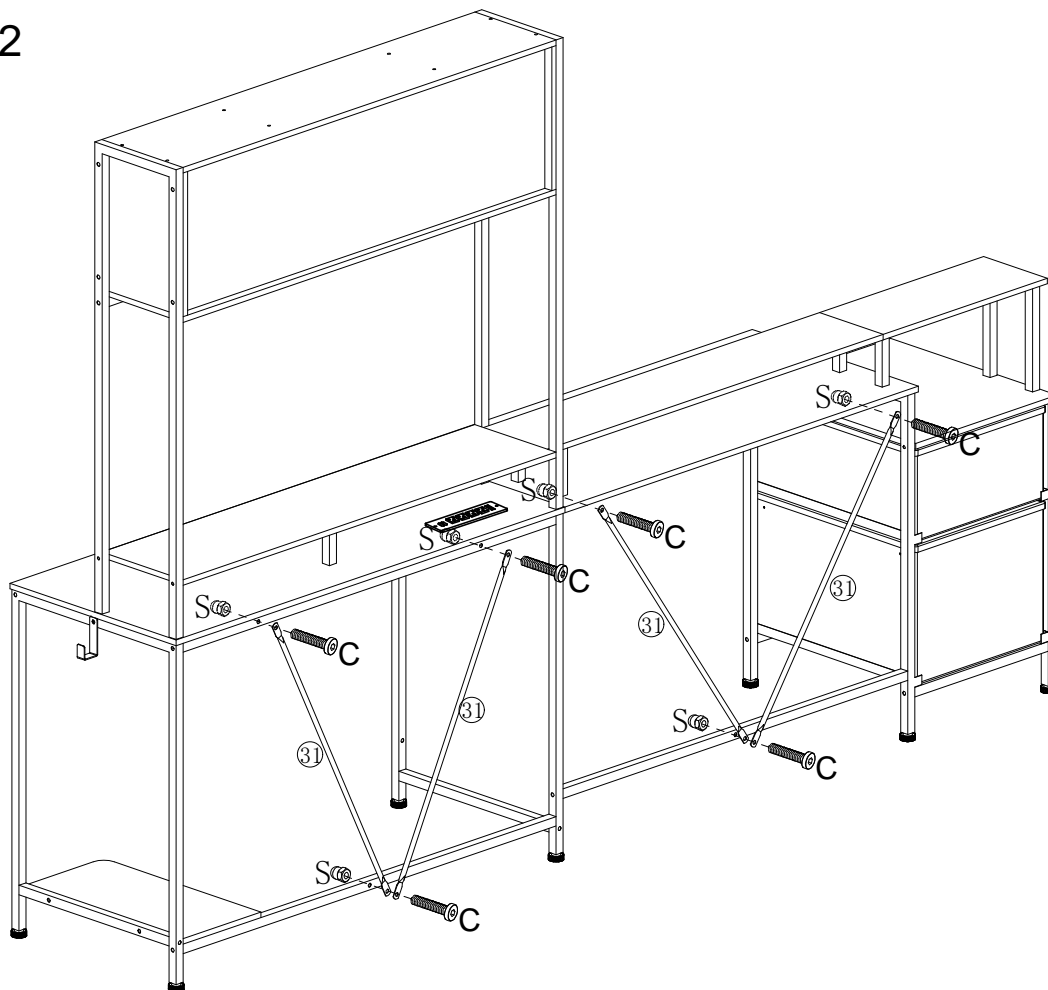

F	X2
	
M6x25	
C	X4
	
M6x28	

Step 26-2



S	X6
	
M6	
C	X6
	
M6x28	

Step 27-1

Be careful to tear off the paper on the back of the light strip. Then press it firmly with your hand.

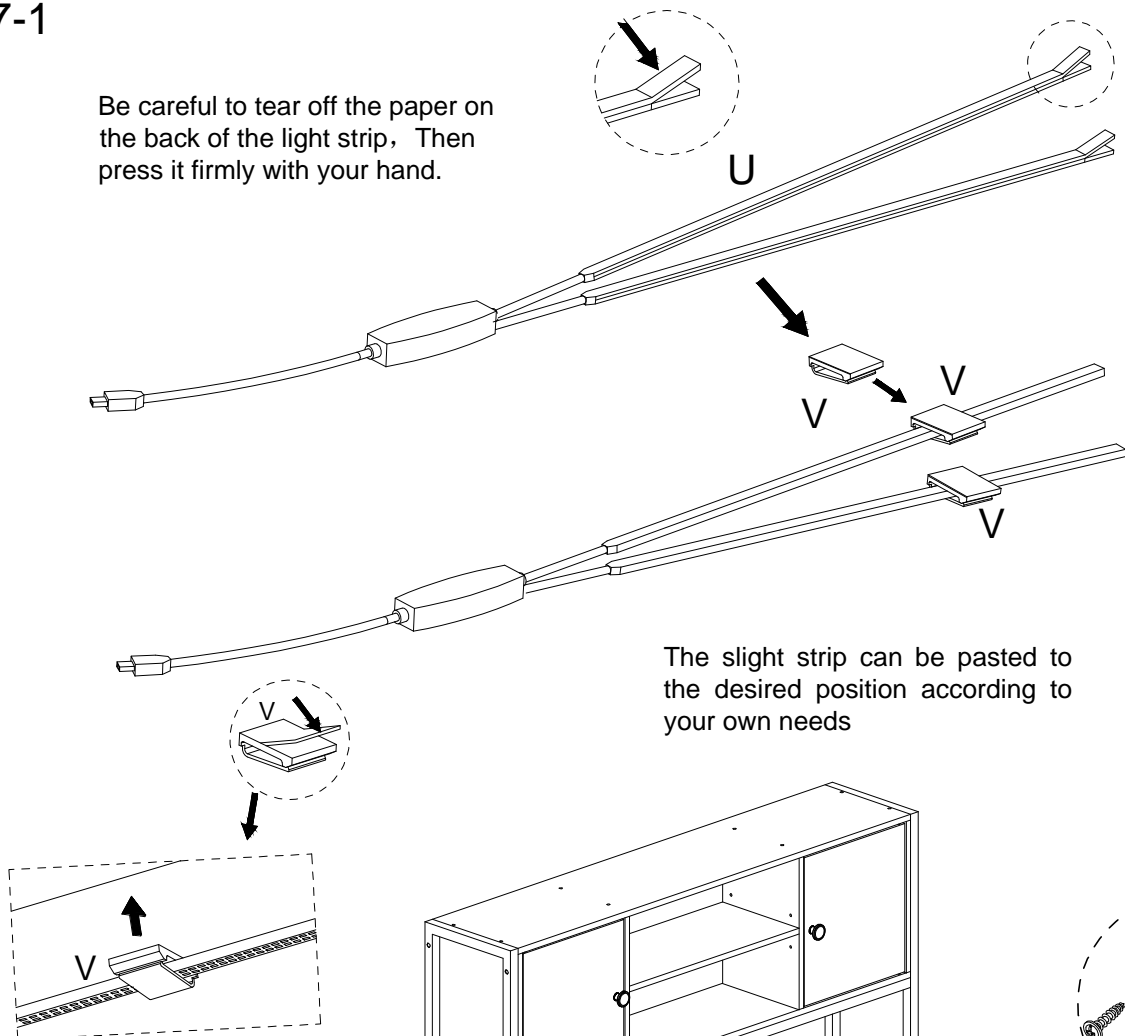

The slight strip can be pasted to the desired position according to your own needs

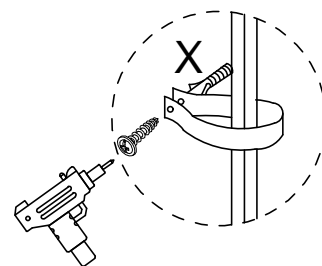
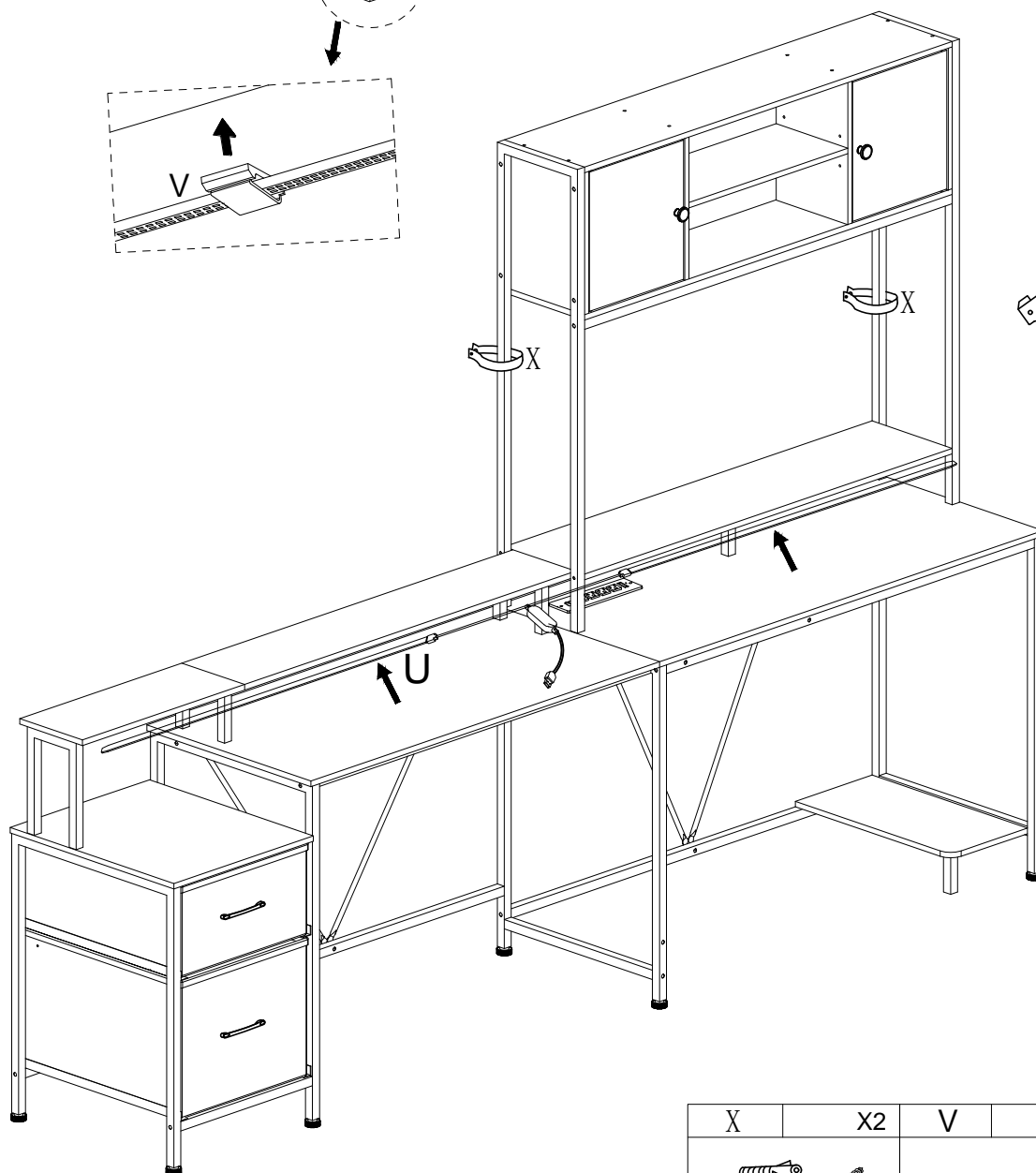

X	X2	V	x8	U	x1
ST4×30					