

# Manual

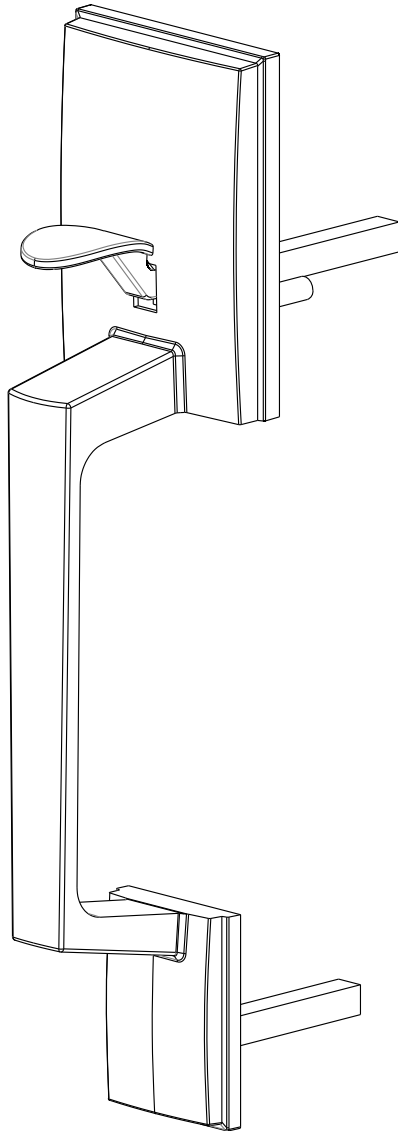

**Scan the QR Code: Use your smartphone to scan the QR code below and access the installation video.**

**Website Login: Visit our official website at [www.secusly.com](http://www.secusly.com), log in, and navigate to the installation video section to watch detailed guidelines.**

**The installation video provides clear instructions to ensure a smooth setup process. If you have any questions or encounter any issues, please contact our customer support at**

**[support@secusly.com](mailto:support@secusly.com).**

**Thank you for choosing our product! We wish you a successful installation!**

**Thank you!**



**Front Door Handle  
Installation Guide**

**Please scan the QR code to watch installation video for the smart lock before you install it.**

# Installation Instructions

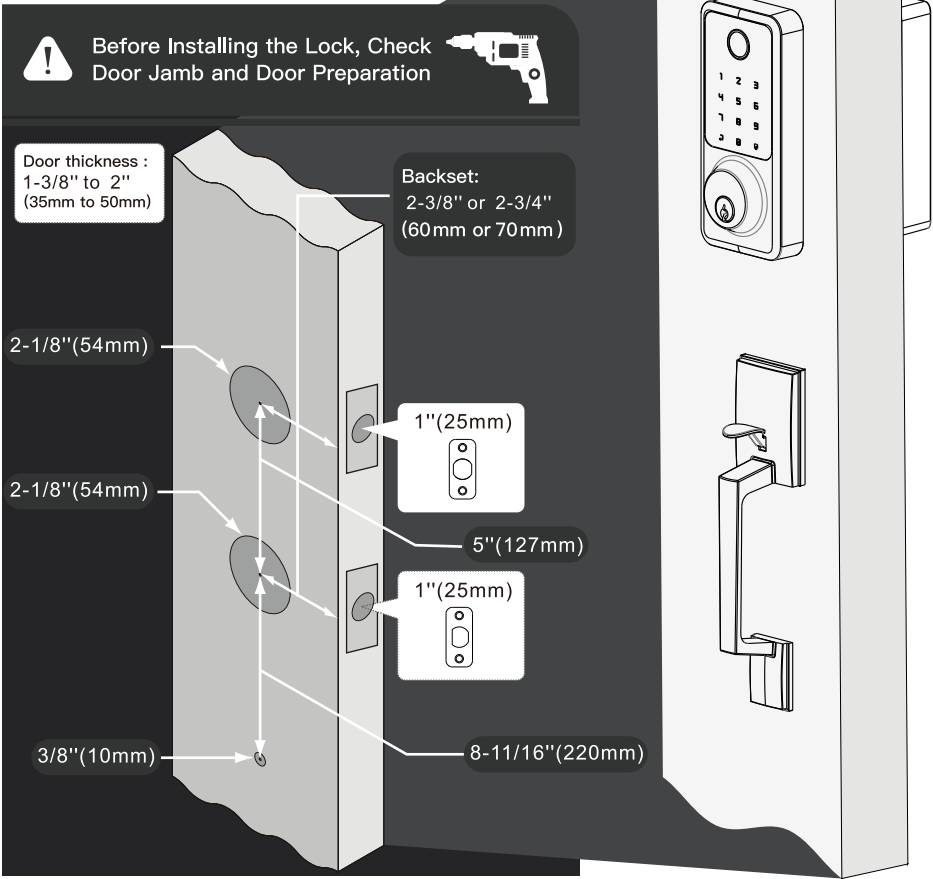

# Parts List:

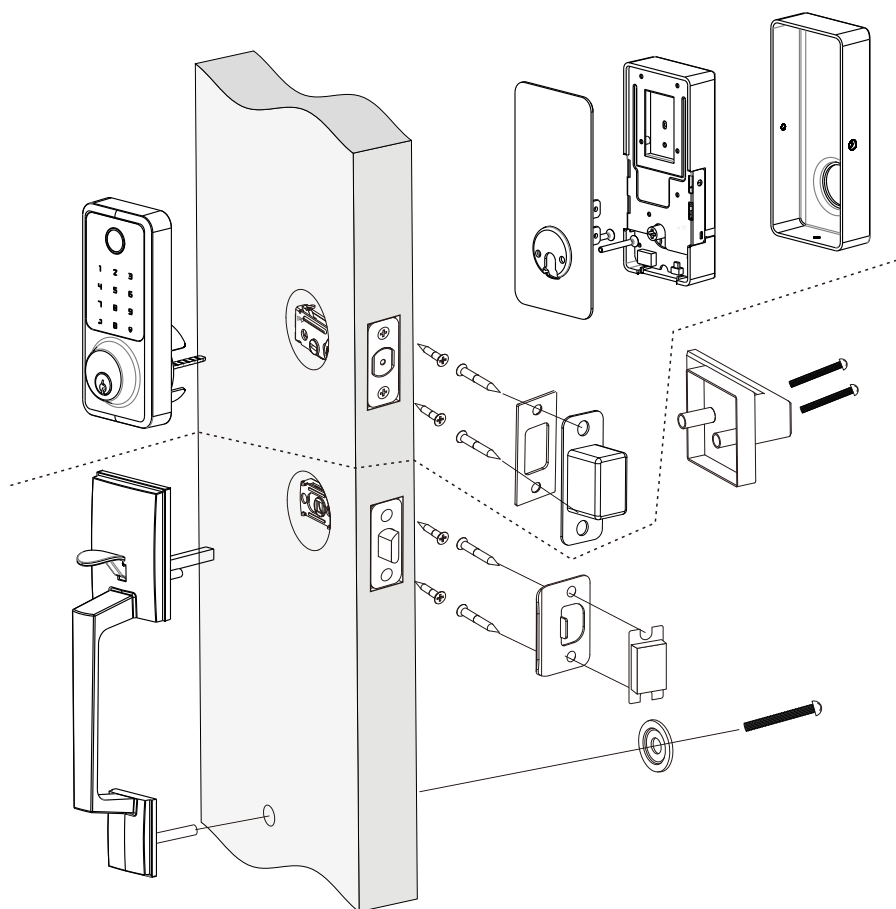

## A: Parts identification

a

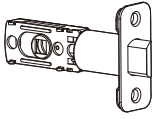

Latch

b



Strike

c

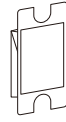

Dust Cover

d

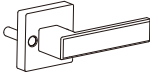

Door Lever

e

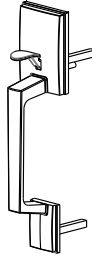

Handleset

f

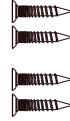

Latch/Strike Screws

g



Mounting Plate Screws

h



Shim

# 1. Prepare the door and check dimensions

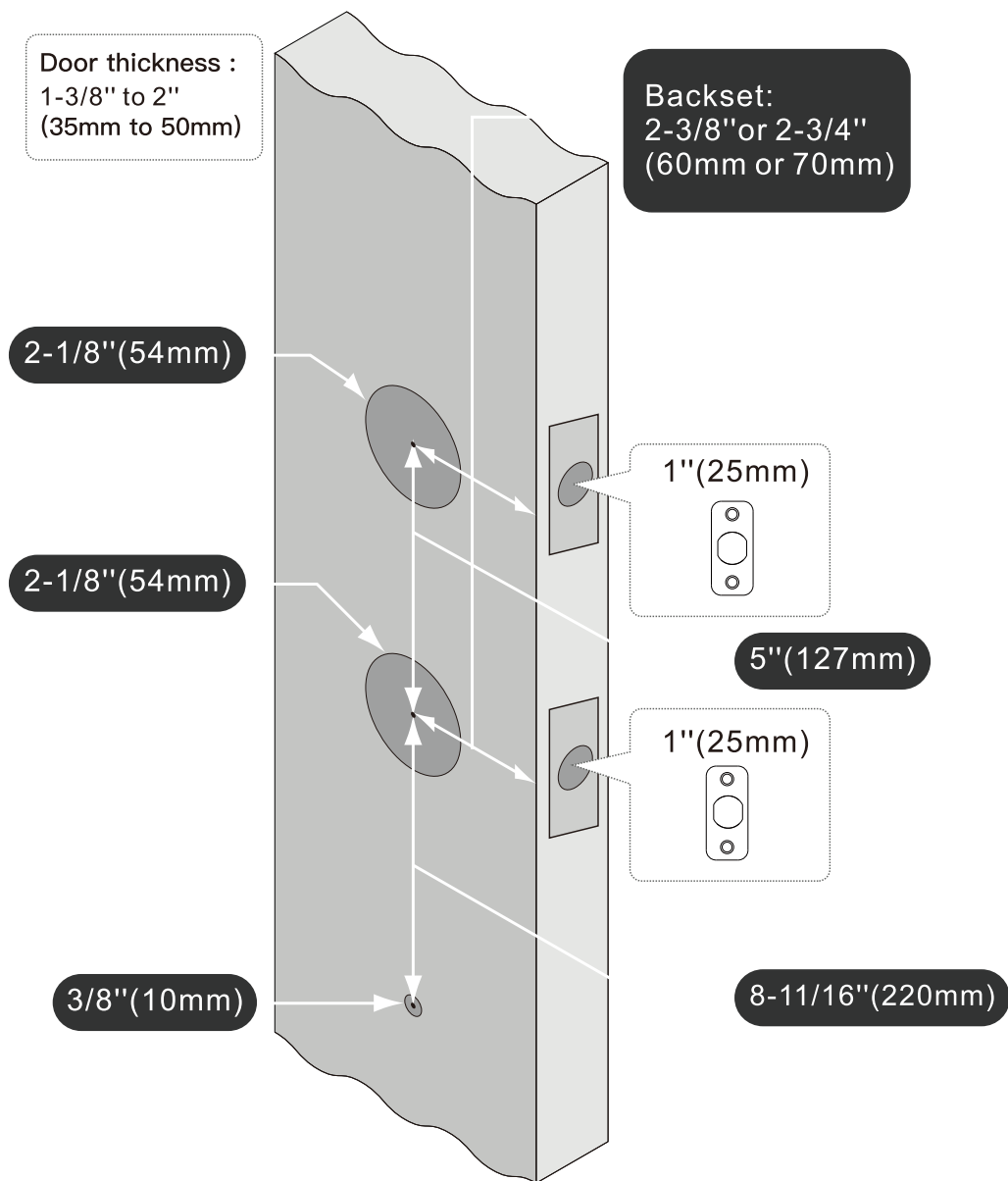

a

Left push door

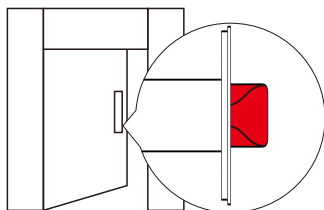

Indoor

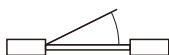

Outdoor

**Left push door**

Right push door

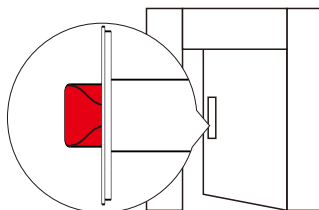

Indoor



Outdoor

**Right push door**

When the door is pushed inwards, the latch is installed outwards.

b

Left pull door

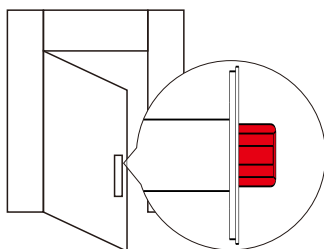

Indoor

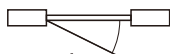

Outdoor

**Left pull door**

Right pull door

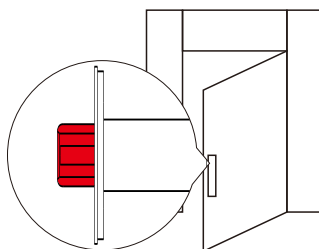

Indoor



Outdoor

**Right pull door**

When the door is pulled out, the latch is installed inward

## 2. Choose faceplate

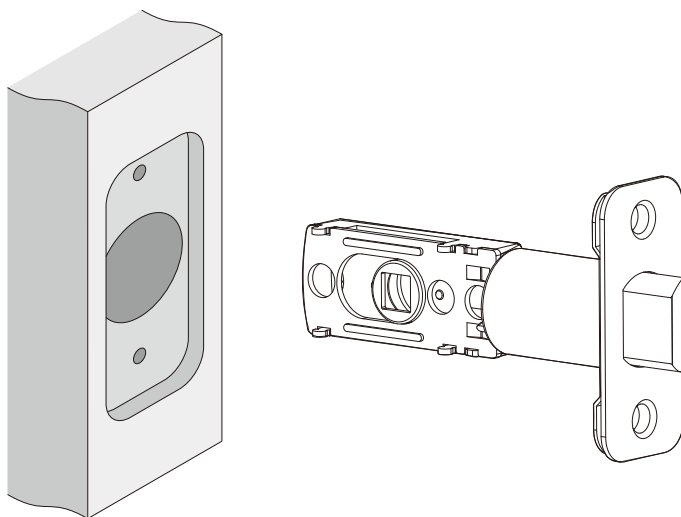

Is the slotted hole centered in the door hole?

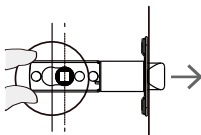
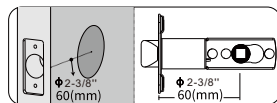
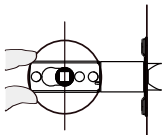
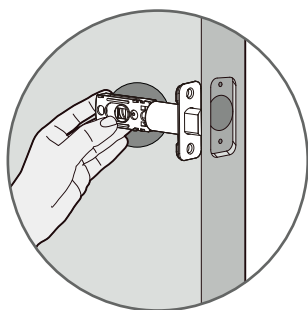

Bolt ships with backset in 2-3/8" (60mm) position. If required, turn the bolt case and pull to extend to 2-3/4" (70mm) backset position.

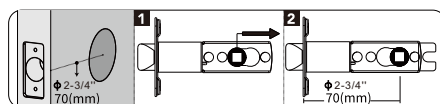



### 3. Install latch

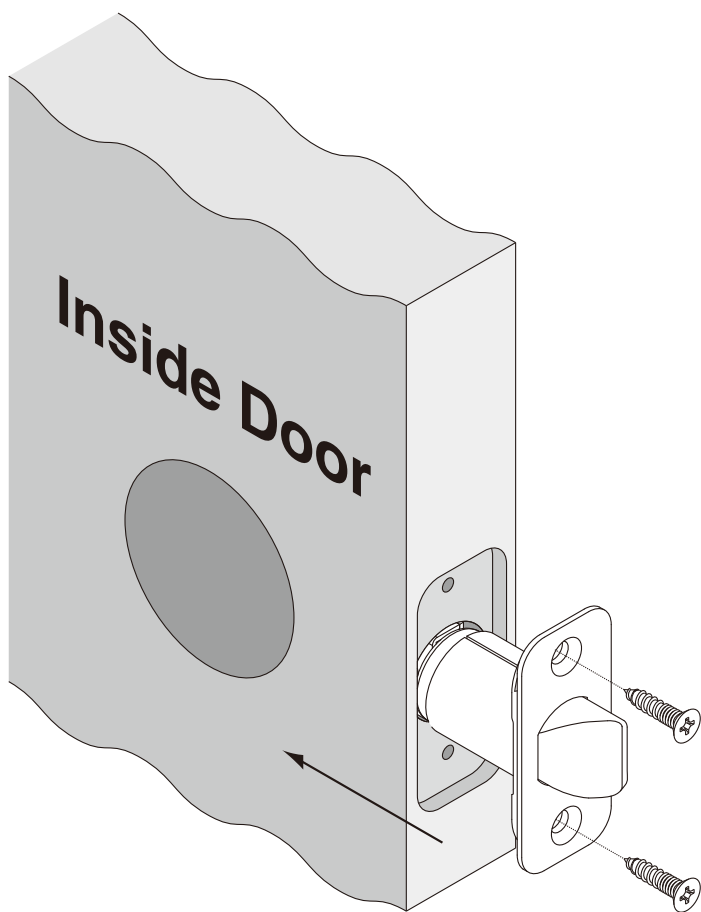

## 4. Install handleset

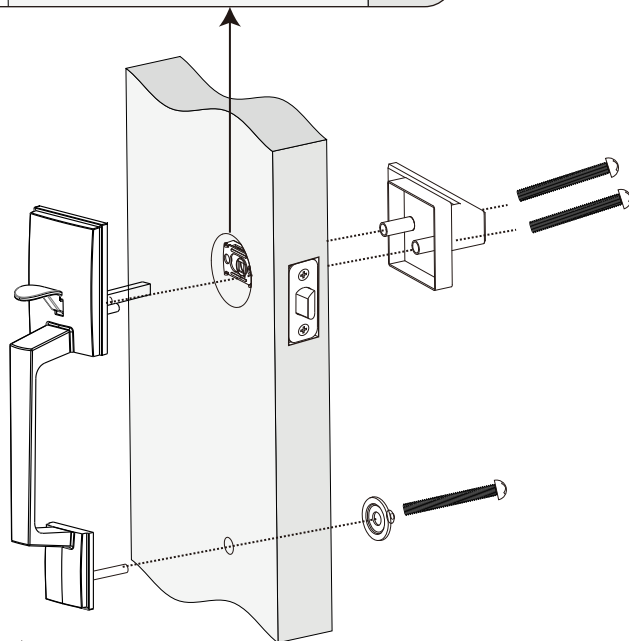
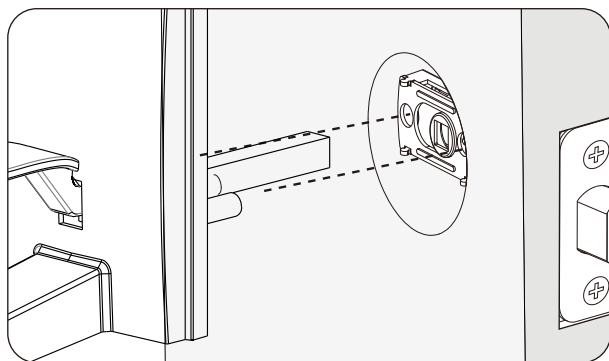
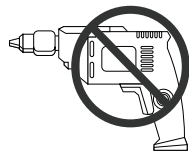

## 5. Install lever

