

Two Ways of Use

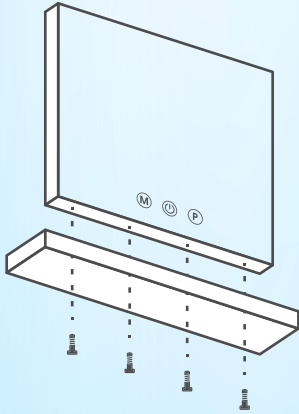

A

Use the included screws to secure the detachable base, turning your table into a Hollywood-style vanity.

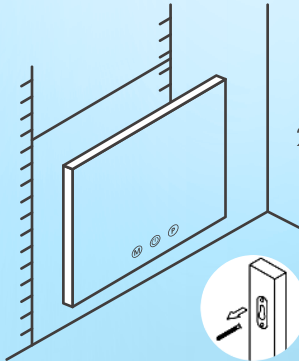

B

1. Pre-drilling holes on the wall.
2. Pushing the wall anchor gently into the pre-drilling hold.
3. Driving screws with a screwdriver into the anchor.
4. Hanging up the mirror.



INSTRUCTION MANUAL

Accessories Power Adapter

LED Hollywood Style Makeup Mirror

Function Key



- **Adjustable Brightness**
- **3 Color Modes**

Brightness Adjustable

Hold the button to adjust the mirror brightness.

On / Off Button

Tap the button to turn the light ON or OFF.

Color Mode Switch

Short press to change the light color: warm/natural/cold

Accessory Description

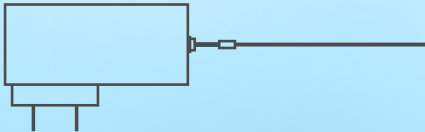

Please use the provided power adapter without product and do not use an inappropriate power adapter, as it may damage the mirror.

Before You Start, Please Make Sure to Read the Instructions Carefully.

- ⚠ Please place the makeup mirror on a stable surface to prevent slipping.
- ⚠ Before use, make sure the adapter plug is properly connected and inserted into a power outlet.
- ⚠ Avoid exposing the mirror to high temperatures, humidity, or direct sunlight.
- ⚠ Always unplug the mirror before cleaning the surface. Do not immerse the mirror in water or any other liquids.

If you have any questions or need help, you can contact our customer service team. Wishing you the opportunity to showcase your beautiful makeup mirror!