

---

# Smart Lock Manual

## Smart Life Stays In Motion

---



Download via Google  
Play and App Store



The mechanical key that comes with the smart lock is used as an emergency unlocking method. Remember not to keep it indoors. It can be stored in a safe place outside the room for use in an emergency (such as in your own car or office).

# 1. Product Description

Name	Function	Parameter	
Fingerprint/palm vein	Total User Capacity	300 Profiles (including password, card, fingerprint/palm vein, face)	
		Administrator	ID001-009 (9 in total)
		Normal User	ID010-300 (291 in total)
		Face Capacity	100
Password	Normal Password Length	6~9 digits	
	Virtual Password	Up to 20 digits	
RFID/NFC/Access Card	Card Type	13.56MHz complies with IOS/IEC14443 (such as M1 card)	
Electrical Properties	Operating Voltage	6.5-8.4V, lithium battery	
Work Environment	Operating Temperature	-25°C~ 70°C	
	Operating Humidity	< 93% RH (no condensation)	

Product specification parameters are as follows (the following data is subject to laboratory testing.)

This product has eight unlocking methods: fingerprint, password, card, facial recognition, palm vein, APP temporary password, APP remote unlocking, and a mechanical key. Visual & voice navigation, mainstream capacitive touch buttons, and a CORTEX-M0 architecture main control MCU chip can support expansion and docking of various gateway platforms to achieve remote authorization and remote unlocking. Users can perform hierarchical management of permissions. When danger occurs, the rear lock can be quickly opened/closed with one button.

## 2. System Function and Introduction

### 1. Initial State

(1) In the initial state, to unlock the door, use any fingerprint, palm vein, face, M1 card, or 6-digit number and press "#".

(2) There is no administrator password in the initial state. After adding a user, the lock can be unlocked normally only after the added user key is successfully verified.

Note: After registering the administrator key, you need to verify the registered administrator key when entering the system menu again.

(3) Press and hold the unlock and lock buttons for 5 seconds at the same time or operate on the system menu. The system will prompt to restore the initialization and confirm twice. This function is used to delete all user information, reset the device, and log out of the network.

### 2. Overview of General Operating Principles

(1) System menu: In wake up mode, press the "\*" and "#" key + administrator password to enter the system function settings.

(2) Registered passwords, cards, faces, and palm veins cannot be registered repeatedly, if user A has registered, user B cannot use them again.

(3) Open the door: Swipe the card/enter the password/fingerprint/palm vein/facial recognition to open the door normally without entering the system menu.

(4) Lock: In sleep mode, press and hold the front lock "\*" key, or the rear lock key to automatically lock.

### **3. Unlocking User Management and Information Overview**

- (1) Administrator: open the door and system setting.
- (2) Ordinary users: only open the door.
- (3) User information can be created and deleted; the current logged in administrator information cannot be deleted.

### **4. Facial Recognition Unlocking**

If facial recognition unlocking fails 5 times, the motion sensing wake-up function will be locked for 2 minutes. The screen will prompt that the sensor has been locked, and the current lock count down will be displayed, indicating that the face has been locked.

### **5. Trial-error Alarm**

If the unlocking information fails for 5 times, the door lock will sound an alarm and will temporarily unable to be unlocked for 180 seconds.

### **6. Language Volume Settings**

Enter the system to switch the system language (Chinese/English); the volume can be set to high/medium/low/silent.

Note: In silent mode, the doorbell and alarm prompt sounds are normal.

### **7. Time Settings**

The default is the factory time. You can set the year/month/day/hour/minute through the keyboard.

Time format: 2020-01-01 00:00

## **8. Other Instructions:**

### **(1) Power control function**

Every time the door is opened, the real-time power level is detected and displayed. When the power level is lower than 80%, the system will issue a low-battery alarm.

### **(2) Automatic detection at power on**

After the system is powered on, it will automatically perform a self-check on some key electronic parts.

### **(3) Engineering mode**

Enter 888# + administrator password to set the door lock as follows:

- Door opening direction: Press "1" to select left or right door opening;
- Motor torque: Press "2" and select low, medium or high motor torque according to the lock type.
- Tilted tongue reversal time: Press "3" to set the latch return time to "100-900ms".

### 3. Door Lock Operation Details

#### 1. System Wake-up

- (1) Wake-up method: Press any touch key on the front lock or the fingerprint recognition area to wake up the door lock.
- (2) Wake-up time: When the function is set, the system will enter the standby sleep state after 15 seconds of no operation.

#### 2. Verify Unlocking

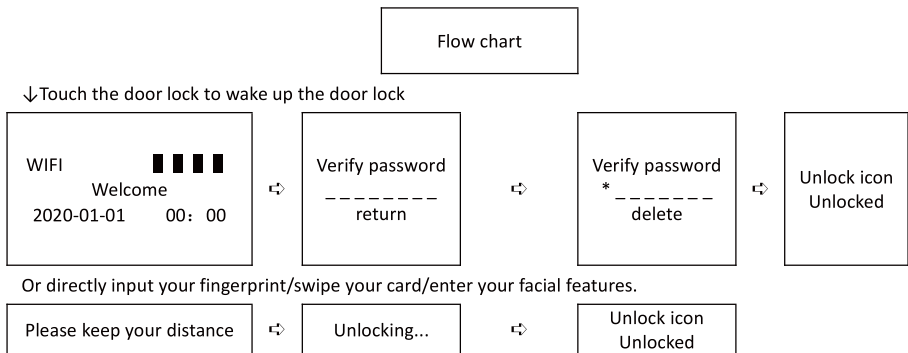

#### 3. Management Menu

After using the administrator user to verify your identity, you can enter the user management settings. User management settings are divided into two permissions: administrator user and ordinary user. For the above functions, you can add/delete the user's fingerprint, password, card, and face according to the interface prompts.

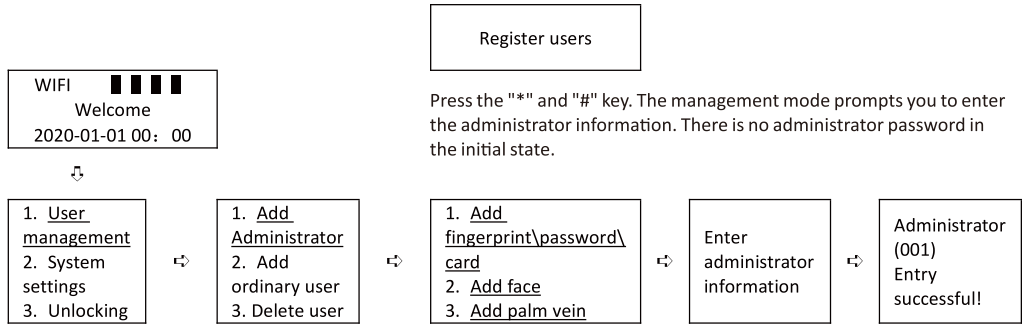

Note: The method of adding a common user is the same as that of adding an administrator.

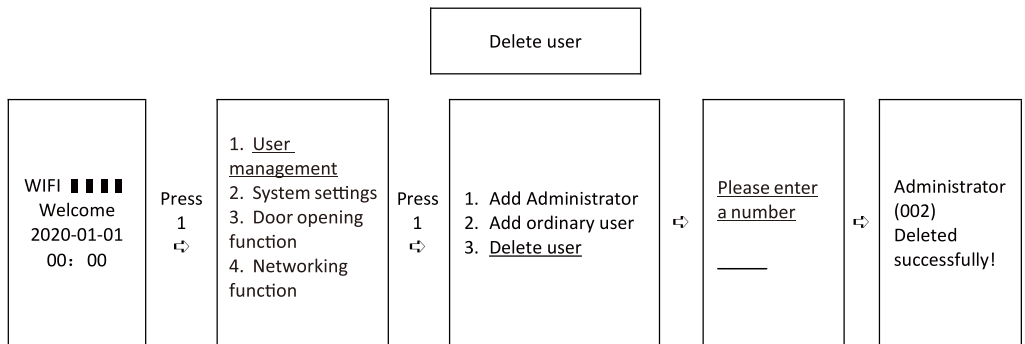

Press the "\*" and "#" key to verify administrator privileges.

## 4. System Settings

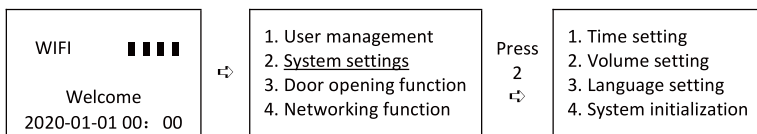

Press the "\*" and "#" key to verify administrator privileges.

After successfully verified, the administrator can enter the system settings: time settings, volume settings, language settings, and system initialization.

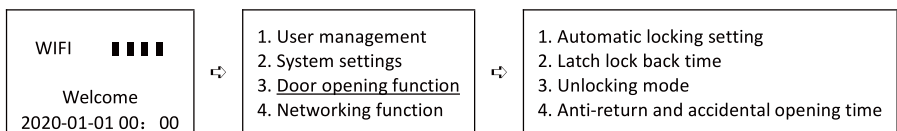

Press the "\*" and "#" key to verify administrator privileges.

Go to System Settings > Door Opening Function Settings:

- (1) Automatic lock setting: Press "1" and select: 0,5-30 seconds.
- (2) Latch bolt relocking time: Press "2" to select: 2-9 seconds.
- (3) Unlocking mode setting: Press "3" to set: single verification mode, double verification mode, and normal open. Select the normal open mode, and any fingerprint, M1 card, face, or 6-digit password to unlock the door.
- (4) Anti-return accidental opening time: Press "4" to select: 5-30 seconds.

## 5. Shortcut Key Functions

Query time: 2#; Query version number: 666#;

Card encryption setting: 301# + Verification administrator, set to on or off;

Anti-theft detection: 302# + verification administrator, can be set to open or close;

Face/palm vein function: 303# + verification administrator, can be set to open or close;

Stay alarm function: 304# + verify the administrator, can be set to open or close;

Motion sensing function: 305# + verification administrator

(set low sensitivity, high sensitivity, turn off motion sensing);

Lock body detection function: 306# + verification administrator

(electronic detection of lock body);

Remote unlocking: 307# + verification administrator, can be set to open or close;

Door ajar tone: 308# + verification administrator

(electronic detection of lock body);

Log export: 309# + verification administrator

(card and dedicated card reader are required);

Stay alarm tone: 310# + verified administrator, set to on or off;

Motion sensing reminder tone: 311# + verified administrator, set to on or off.

## 6. Camera Internet Connection Settings:

For the camera internet-connected model, there is a WiFi icon in the upper left corner of the display screen, and the internet settings can choose to connect and disconnect the door lock.

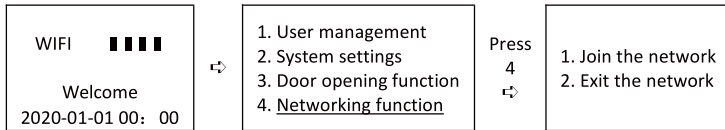

Press the "\*" and "#" key to verify administrator privileges.

## 7. Data statistics and records

This function mainly queries the door opening records. The records are displayed in descending order by time, and up to 512 groups of information can be displayed.

***Due to the continuous upgrade of platform software, there may be slight differences in the app during actual use. Please refer to the actual situation. This manual is for reference only.***

# Installation Diagram of 6068 mortise

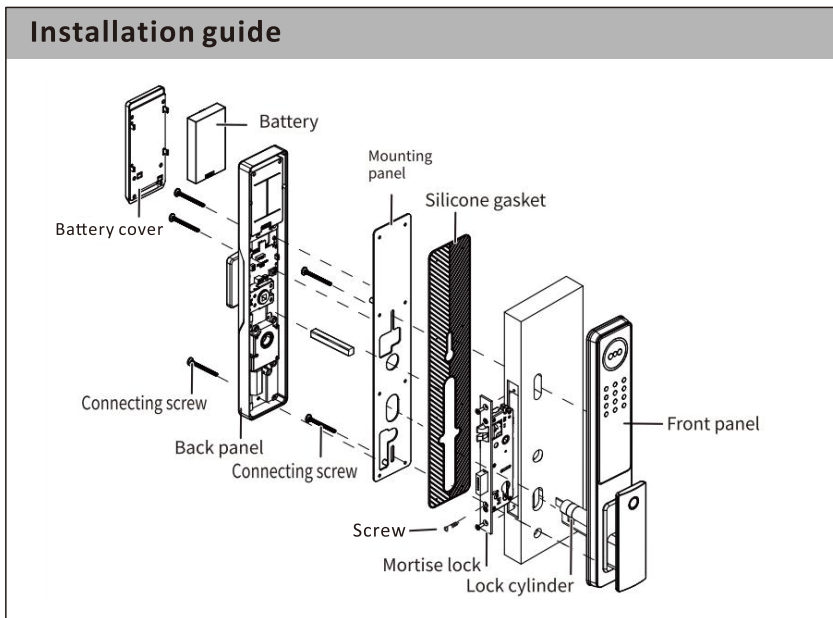
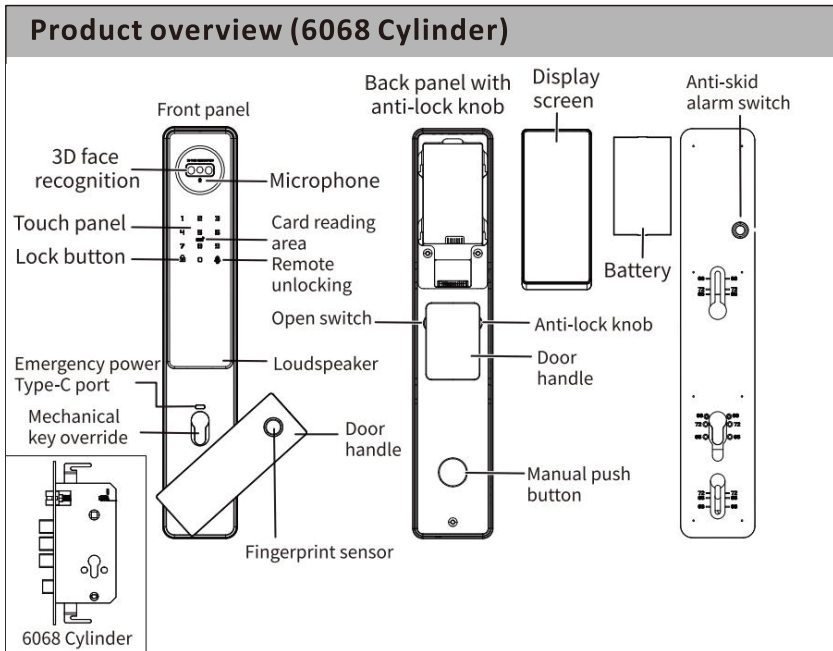

## Adjusting the lock direction

6068 Mortise

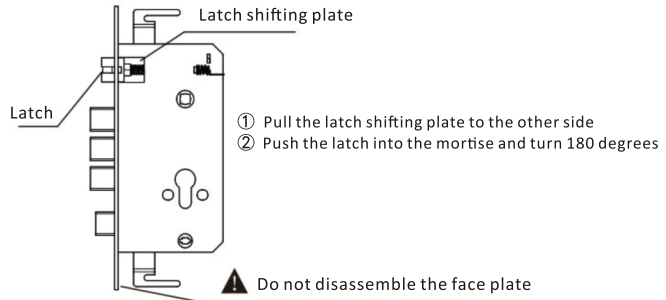

## Installation

### 1. Install the lock

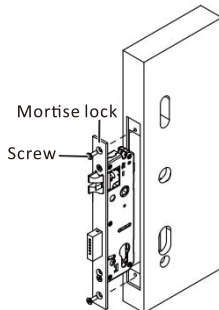

### 2. Install the front panel

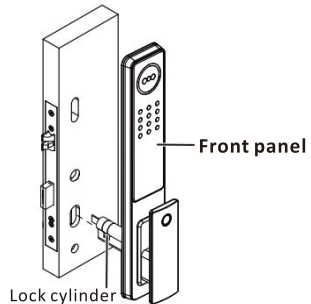

## 2. Install the mounting panel

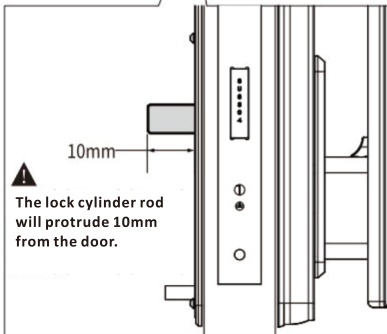
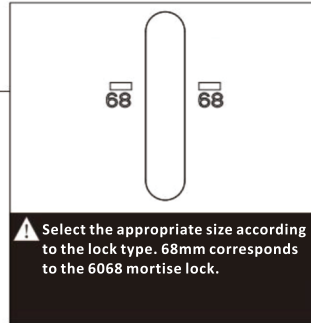
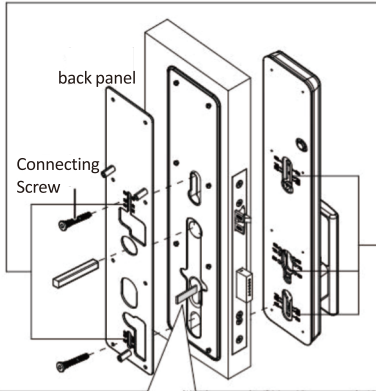

## 4. Install the back panel

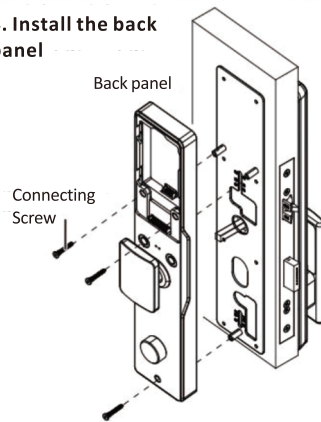

## Installation

### 5. Install the battery

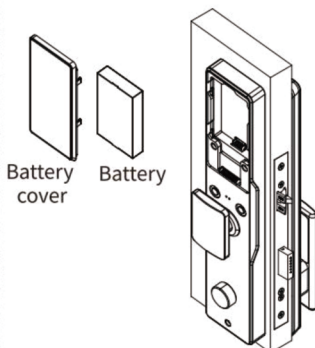

### 6. Install strike plate & strike box

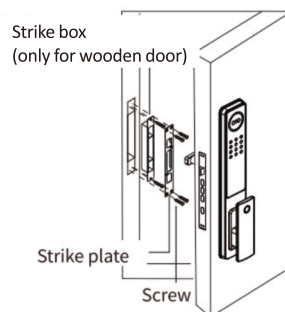

# Carro Home App Operation Instructions

## Download and Install

Download the free Carro Home App from the App Store or Google Play or scan the QR Code below.

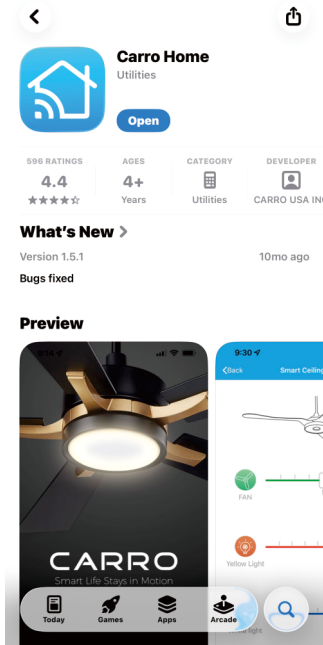

## Open Carro Home App



**Carro Home**  
Utilities

Open

## 1. Register an account

- Enter the Carro Home App
- Click "Sign Up"
- Enter the account registration interface
- Enter your mobile phone number or Email
- Agree to the Terms and Conditions
- Verify the code sent

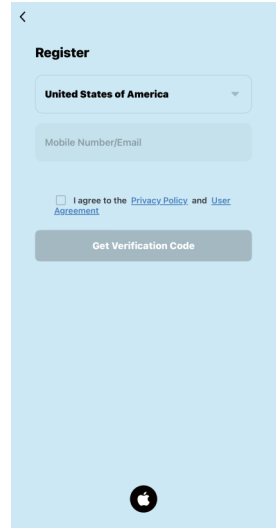
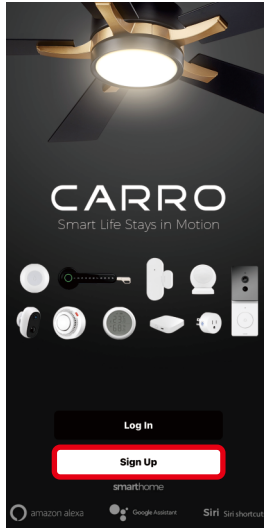

---

## 2. Login account

- Log in
- Enter the account information
- Enter the corresponding password
- Login successful

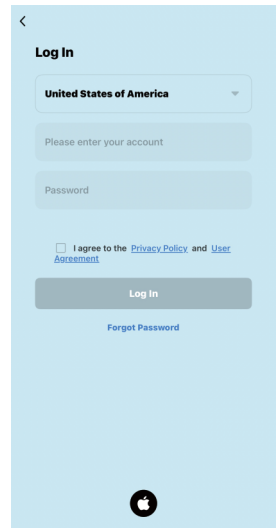
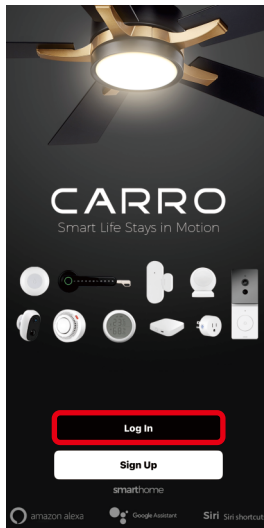

### 3. Add Device

1) Press "\*" and "#" to authenticate admin identity and then press "4" for network setting.

2) Click the "+" in the device list, then a window will pop up to show you the device, then tap "Add".

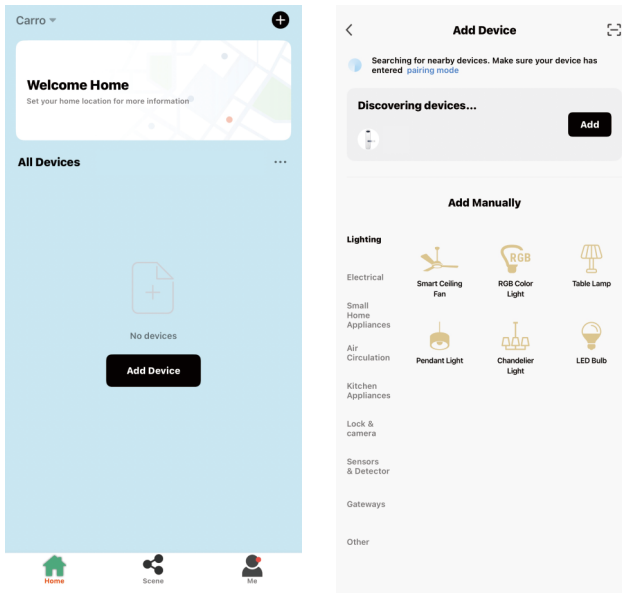

Add Device

4. Connect to WIFI, enter the password of the connected WIFI, click "Next".

**Note:** This smart door lock needs to use 2.4Ghz WIFI to work when connecting the device, and after connecting, it can use either 5Ghz or 2.4Ghz.

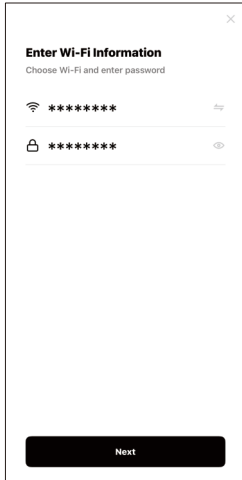

5. Wait for the device to connect to the network.

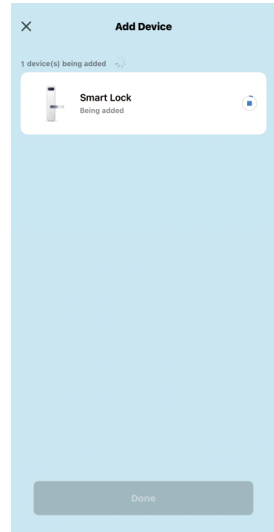

---

6. The connection to the network is successful.

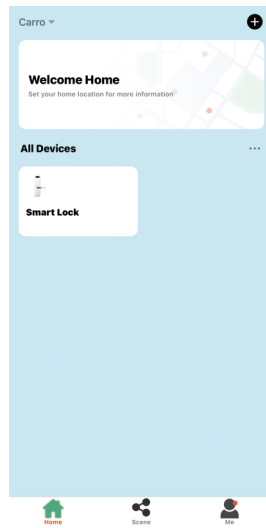
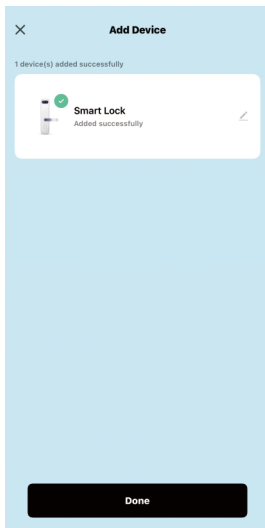

### 7. Press the doorbell to unlock remotely

The guest can request for the remote unlocking of the door by pressing the doorbell.

The owner can then press and hold on the unlock button to open the door for the guest.

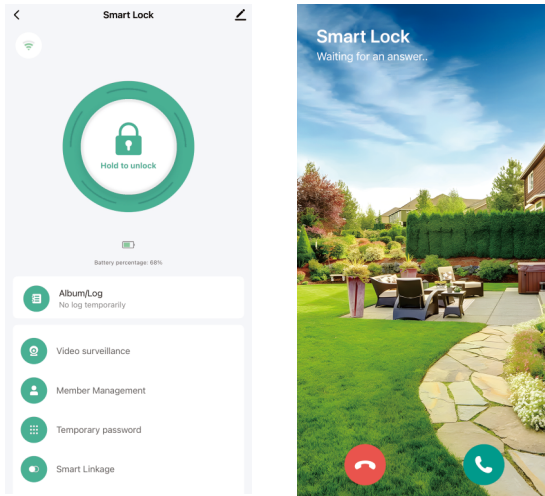

---

### 8. User List

Click the door opening record to view the remote unlocking logs. The alarm message interface displays the image of the customer who pressed the doorbell, and the operation log interface displays the unlocking information, as shown below:

