

Installation Instructions

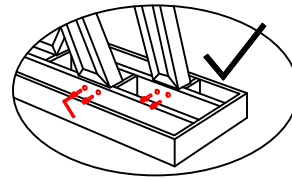

Right Method:
Put 4 screws into the
holes at the same time,
and tighten them.

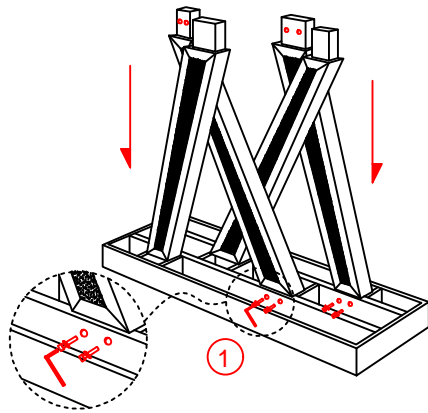
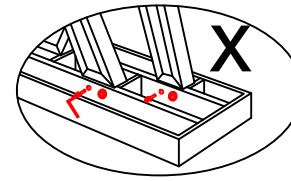

Wrong Method:
After tightening one,
place the other screw
in the hole.

PARTS LIST

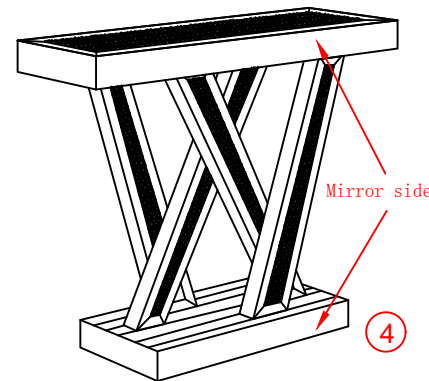
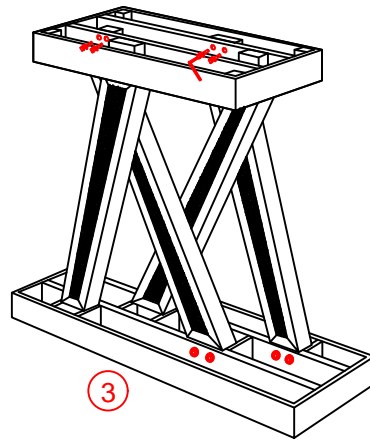
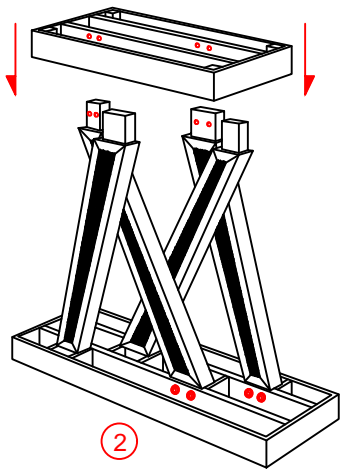
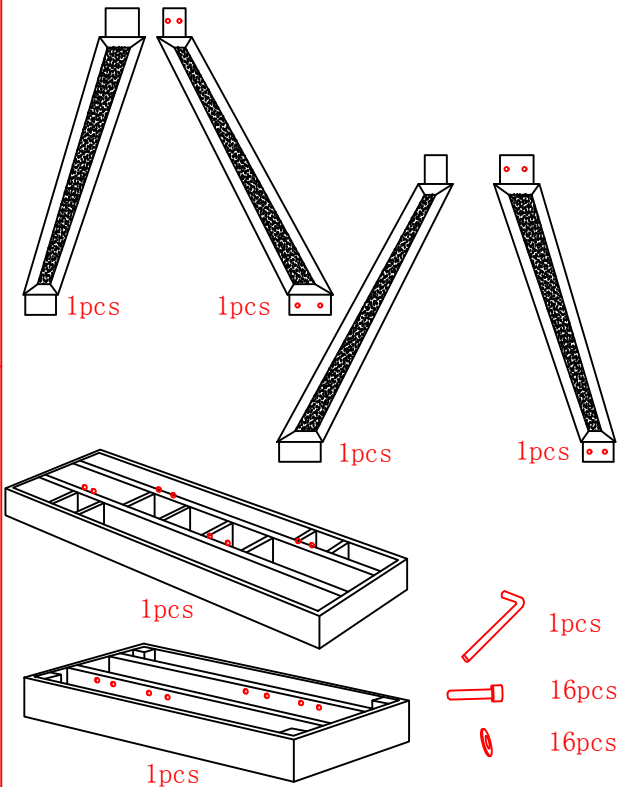

Step 1, Screw the 4 table legs to Tabletop.

(Legs installation, they need to face the mirror side, like desktop and table bottom.)

***Note:** When installing a leg, do not install another screw after tightening one screw, otherwise the other screw may not be screwed in.

Step 2, Screw the end of the 4 table legs to Tablebase.

PARTS LIST

***Note:**

1. According to the same number labels to fix, for example: 1-1, 2-2, 3-3, 4-4..

2. Front side is mirror face.