

Shower Mixer with Massage Hand Held Shower Set

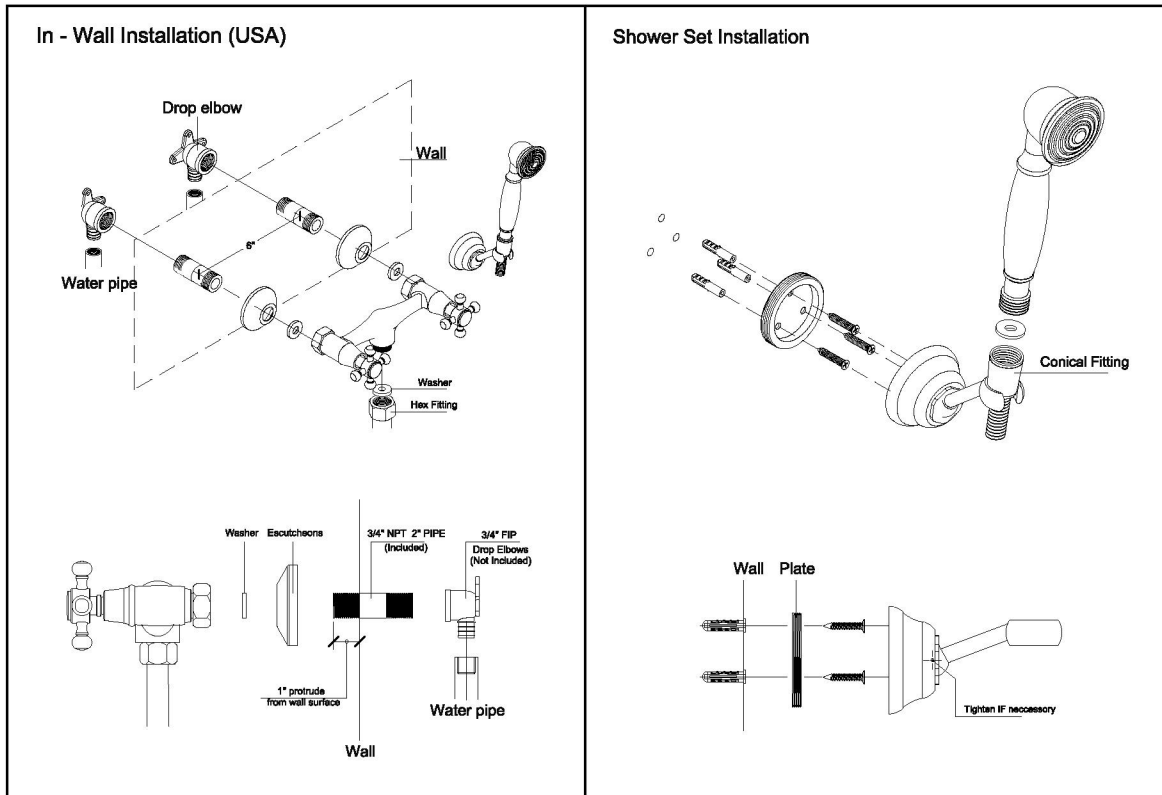

1. Plumb Hot and Cold $\frac{3}{4}$ " NPT 2" PIPES (Included) to protrude 1" from FINISHED wall surface, 6" APART. (NOTE: The $\frac{3}{4}$ " NPT 2" PIPES should be installed to $\frac{3}{4}$ " FIP Brass Drop Elbows).
2. Slip Escutcheons over $\frac{3}{4}$ " NPT 2" PIPE before attaching MIXER.
3. Attach and Tighten Mixer's $\frac{3}{4}$ " Female fittings to $\frac{3}{4}$ " NPT 2" Pipes Male fittings. Make sure washers are inserted into Mixer fittings BEFORE attaching to Pipes. As the Pipes are NPT (Tapered) the installation should be water tight. Use included Telfon Tape if any leaks detected.
4. Adjust Escutcheons as required.
5. Discard the S-Pipes as these are for European Installation ONLY (1/2" IPS).
6. Using Base of Shower Wall Mount, mark screw locations.
7. Drill guide holes into wall and insert Screw Anchors.
8. Attach Shower Wall Mount BASE to wall. Screw Shower Wall Mount onto Base.
9. Insert Washers into BOTH Shower Hose Fittings.
10. Attach Hand Shower to Conical End of Shower Hose.
11. Attach Shower Hose Hex Nut to end of Mixer.
13. To tighten the arm, turn the large nut on front of Shower Mount Clockwise.