



## Smart WiFi Outlet Plug



### Quick Guide

Model NO: ASHP01F

### Features

#### Remote Access

Control, schedule and monitor your favorite home devices anywhere, anytime, through your smartphone or tablet

#### Voice Control

Pair it with Alexa or Google Assistant and control your home devices with your voice

#### Device Control Sharing

Support multiple users to control the same device

#### Manual Control

Manually turn device on/off by pressing the button on the top

### Product Contents

1x  
Smart Power Plug



1x  
Quick Start Guide



1x  
Device Sharing Guide



### Easy Installation

- The smart home device only supports 2.4Ghz frequency. If your router supports both the 2.4Ghz and 5Ghz frequency, the 5G network is usually labeled as "Router-5G" so please connect to the other one.

- Each smart home device can only be registered to one account but it can be shared with others by using the sharing function of the app.

- 1 Download the free eco4life app from the Apple App store or Google Play store
- 2 Follow the on screen instructions to create account for eco4life
- 3 Plug in the Smart Outlet to a wall outlet
- 4 Press the "+" icon in the top right corner of the app

- 5 Press the "Outlet" icon from the list

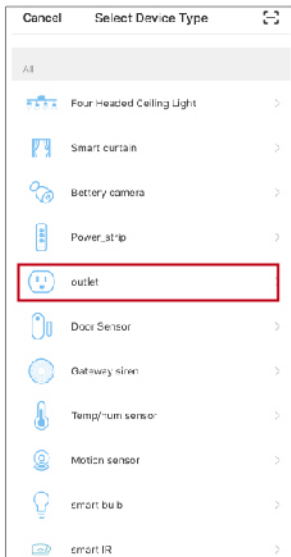

- 6 Follow the instructions in the app to connect the device

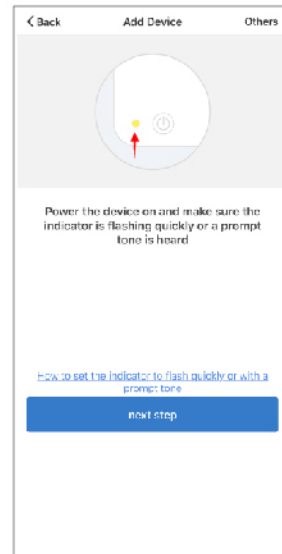

### Light Indicators

#### Red Light (Blinking):

Waiting for configuration

#### Red Light (steady On):

Successfully connected to the wireless network

#### Blue Light (On):

Smart power outlet on

#### Blue Light (Off):

Smart power outlet off

### Technical Specification

Input: 120V~AC 60Hz 10A

Output: 120V~AC 10A Max

Output Power: 1200W Max

Wi-Fi: 2.4G

Size: 58mmx 41mmx 30mm

Working temperature & humidity:

-25°C~ +40°C / 10%~90%