

ASSEMBLY INSTRUCTIONS

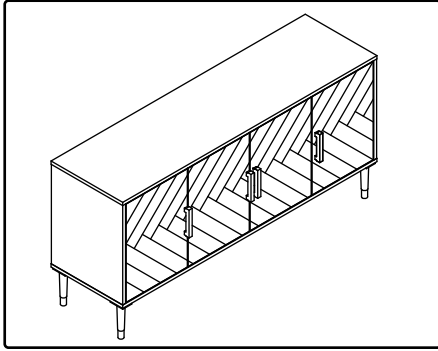

+ Do Not Use
Power Tools



+ Suggested
Adults

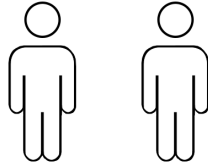

NOTE:

- 1 Read instructions cover to cover.
- 2 Save all packaging until assembly is completed.

1 IMPORTANT SAFETY INFORMATION

Do not assemble the product if any of the following parts arrived damaged:

- Part ① - Table top
- Part ② - Leg
- Part ③ - Shelf
- Part ④ - Shelf

2 IMPORTANT ASSEMBLY INFORMATION

- Assembly Step① Put all legs in place ,use bolt to connect leg on top.
- Assembly Step② Unscrew screw and take handle from inside of door.
- Assembly Step③ Put handle in place and fasten tight on door.
- Assembly Step④ Put shelf #4 in place of cabinet.
- Assembly Step⑤ Take off the shelf supporter at moment.
- Assembly Step⑥ Put shelf #3 in place of cabinet.
- Assembly Step⑦ Put shelf supporter on .
- Assembly Step⑧ Put the expander screw on your wall and fasten tip-over tag if any necessary.

*Warning: Do not over tighten screws, or it could damage the Table Top.

+ Parts Included

①

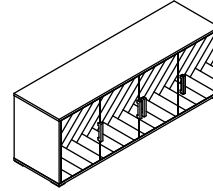

x1

②

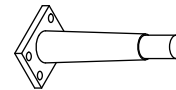

x6

③

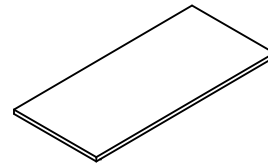

x1

④

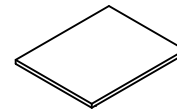

x2

+ Hardware Included

A

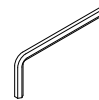

Allen Key
M4 1PCS

B

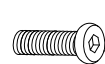

Bolt
M6x20 24PCS

C



Washer
M6x16 24PCS

D

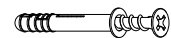

Expander
M6x55 2PCS

ASSEMBLY INSTRUCTIONS

1

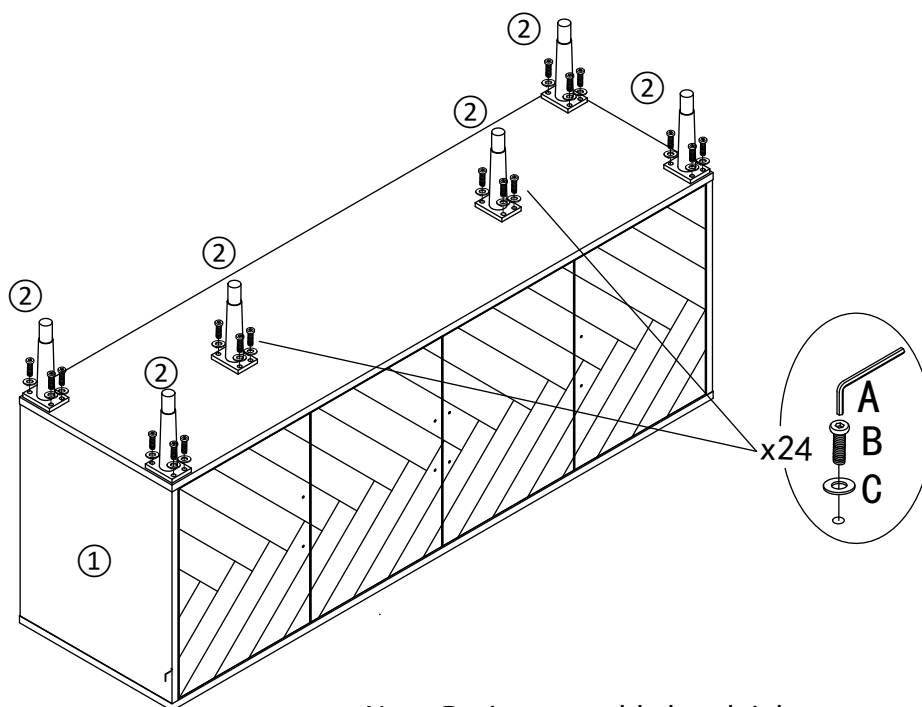

Note: During assembly, hand tighten screws only.
When the screws are in place, tighten completely.

2

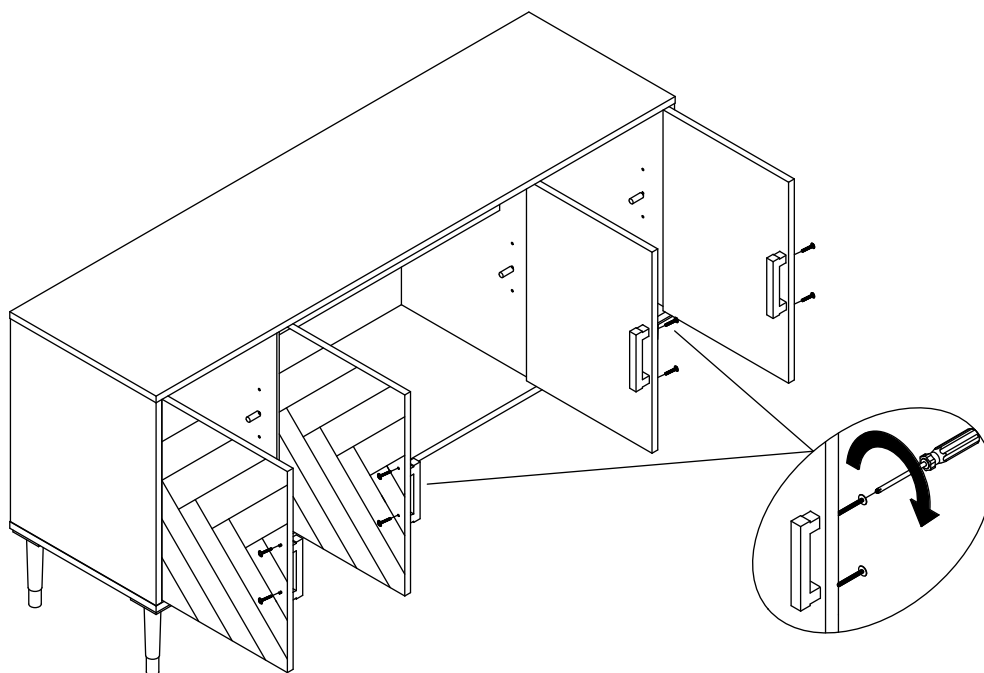

ASSEMBLY INSTRUCTIONS

3

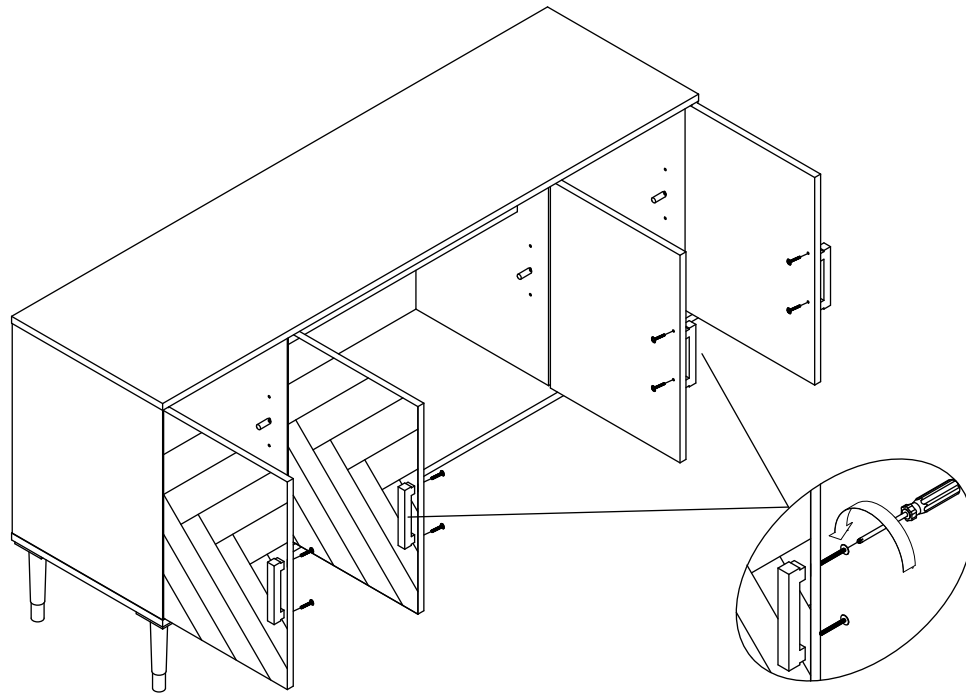

4

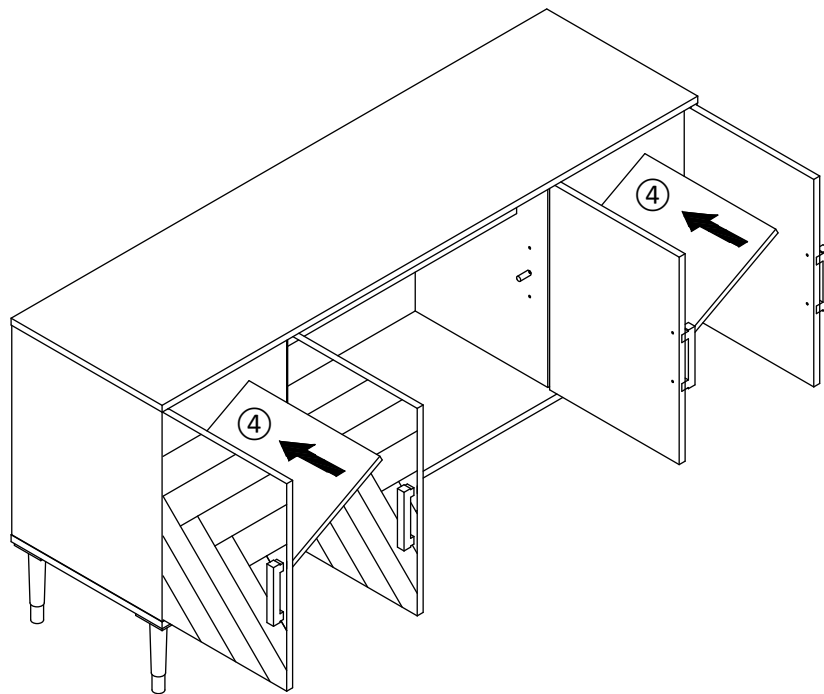

ASSEMBLY INSTRUCTIONS

5

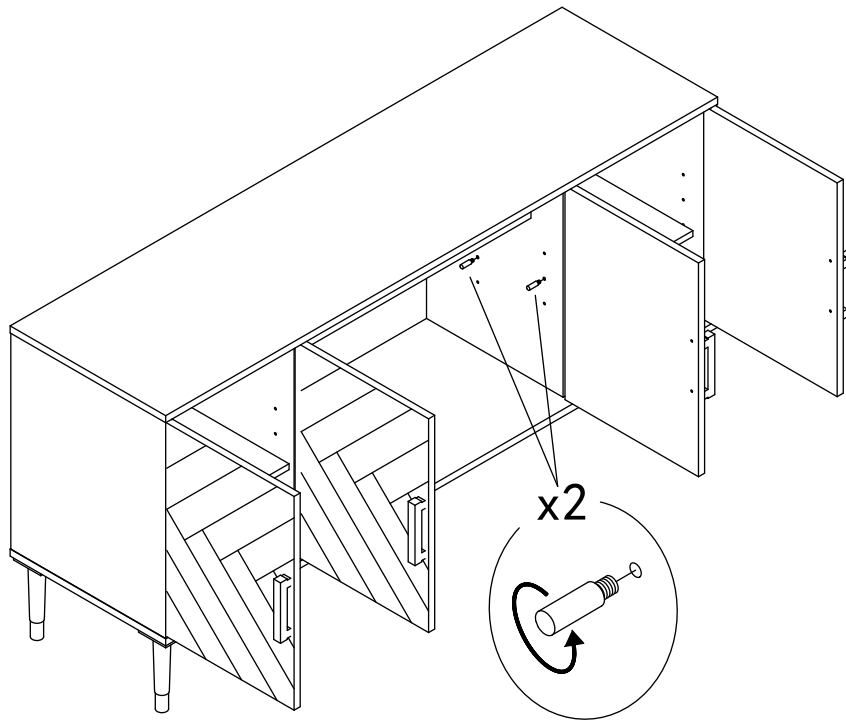

6

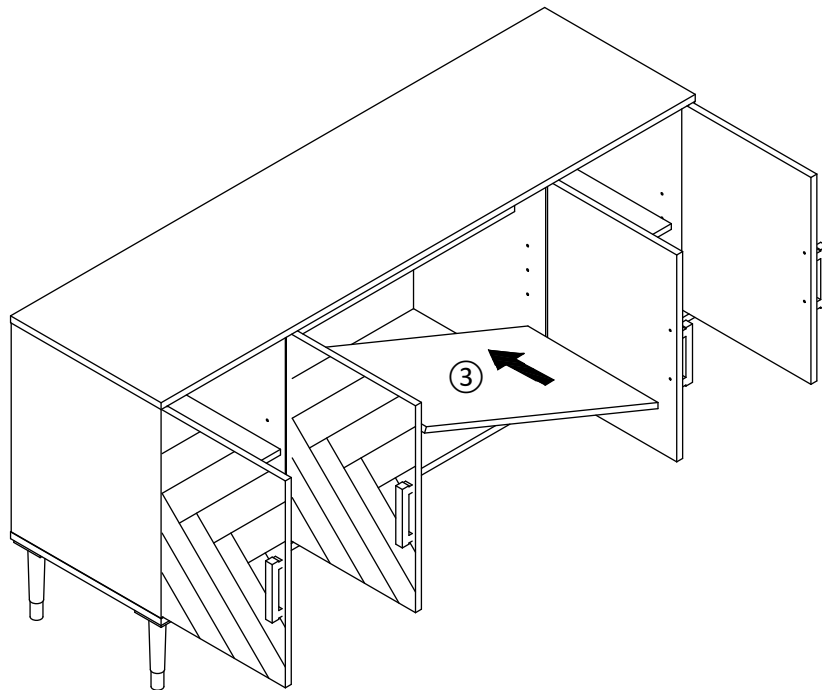

ASSEMBLY INSTRUCTIONS

7

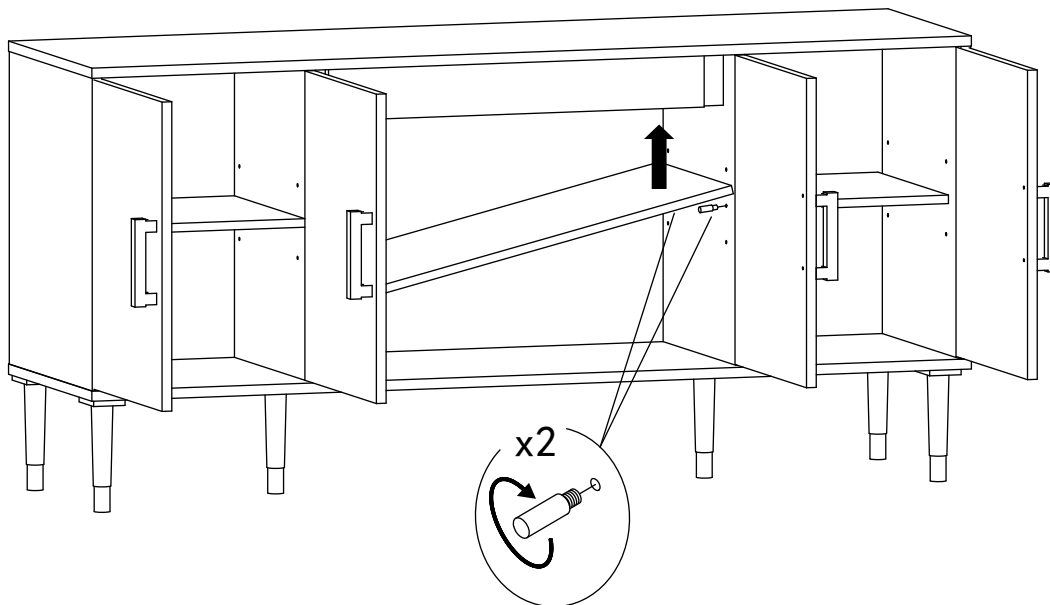

8

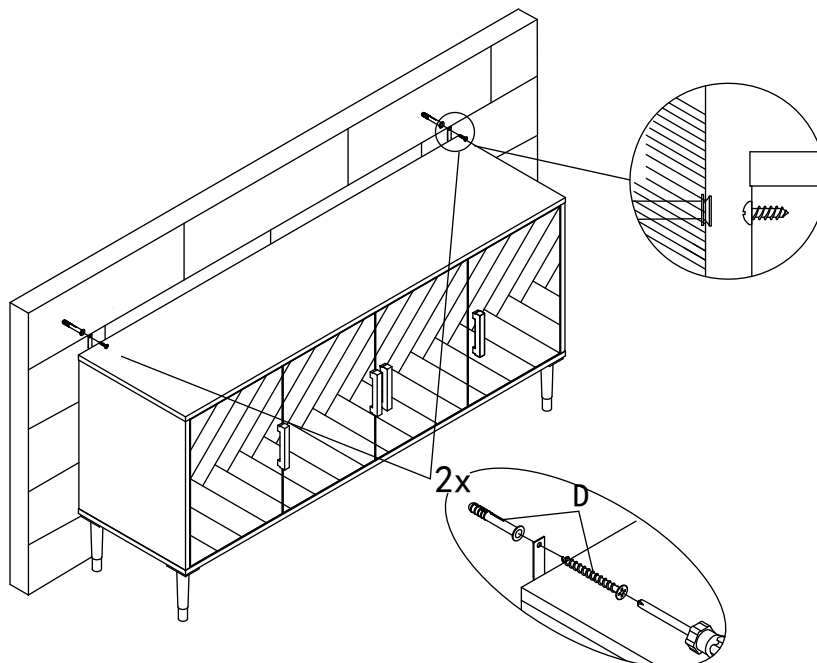

Put the expander screw on your wall if any necessary.

ASSEMBLY INSTRUCTIONS

Hinges Adjustment Facilities



Warning : To ensure all hinges continue to work smoothly, pls check them regularly and adjust them necessary.

Question 1

How to adjust the two door are not aligned and lower with screw adjustment?

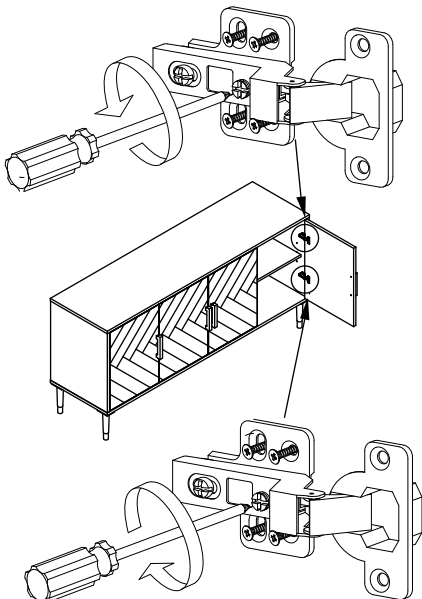
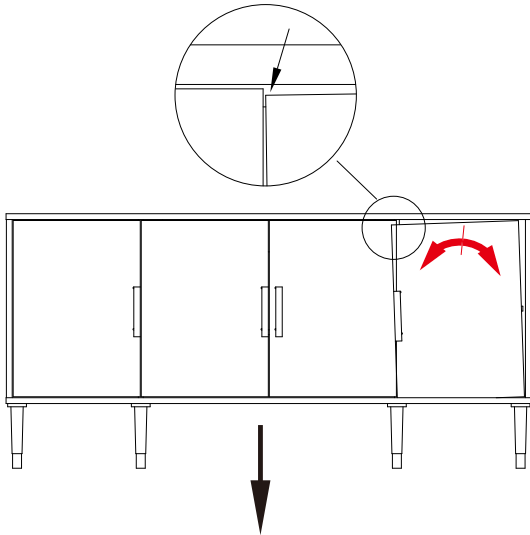

Turn right middle bolt adjuster properly until door is balanced

Question 2

How to adjust the two door are not aligned and higher with screw adjustment?

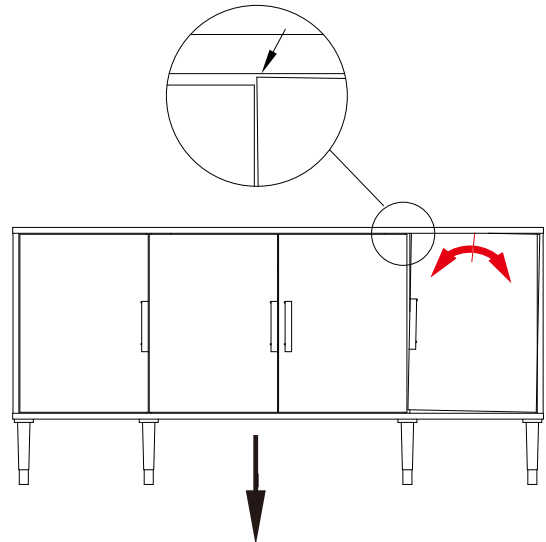

Turn right middle bolt adjuster properly until door is balanced

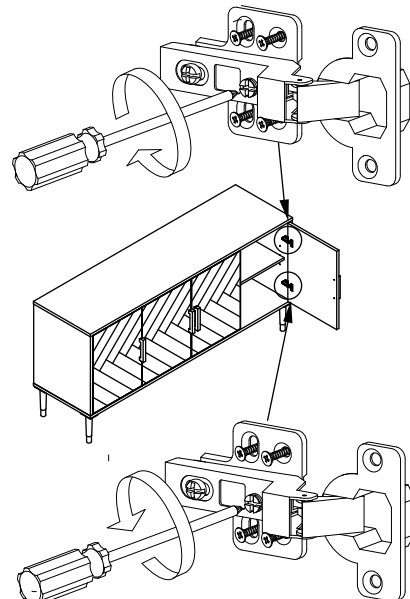

Turn left middle bolt adjuster properly until door is balanced

ASSEMBLY INSTRUCTIONS

Hinges Adjustment Facilities



Warning : To ensure all hinges continue to work smoothly, pls check them regularly and adjust them necessary.

Question 3

How to adjust the door gap at side with screw adjustment?

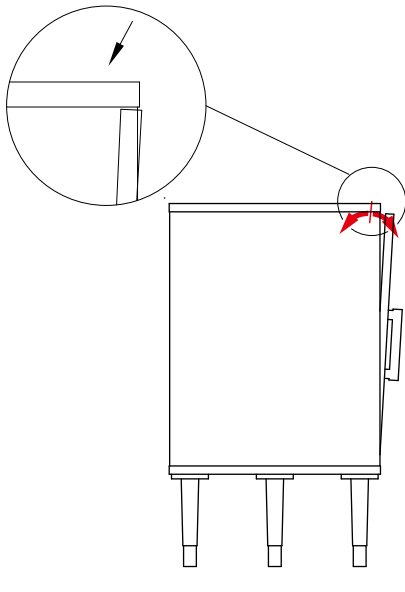

Turn left the adjuster properly until door is balanced

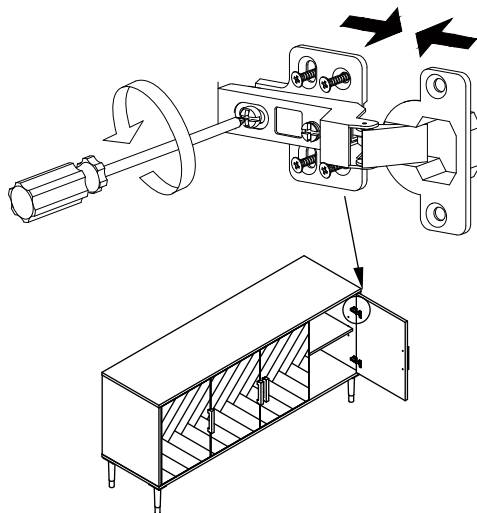

Question 4

How to adjust the door gap at front with screw adjustment?

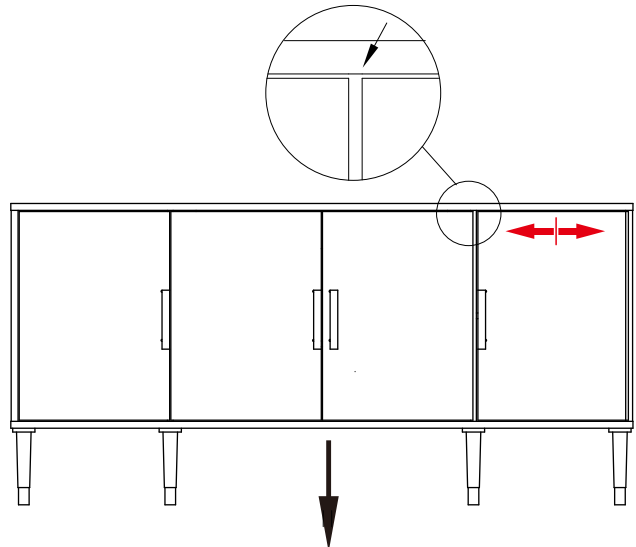

Turn right middle bolt adjuster properly until door is balanced

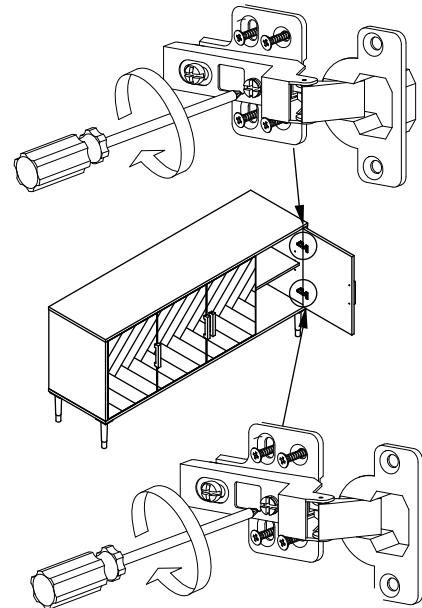

Turn right middle bolt adjuster properly until door is balanced