

Scan this QR code for
product information, videos,
and assembly assistance.

FULL-MOTION TV WALL MOUNT



HAVE QUESTIONS?

Monday - Friday from 5:00am - 5:00pm PST



proav@mount-it.pro



1 (855) 552-6699



www.mount-it.pro

Step 1a

Wood Stud Mounting Option

- With a stud finder locate the wall studs and center the Wall Mount (#A) at the desired height. Use a Bubble level (#E) to ensure straightness and mark the center of the 4 mounting holes with a pencil as shown here.
- Use a 1/4" drill bit and drill on the marked locations to a depth of 2.4".
- Secure the Wall Mount (#A) to the wall using the Lag Screws (#W-A) and Washers (#W-C). Tighten the screws until secure.

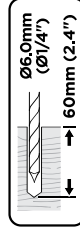
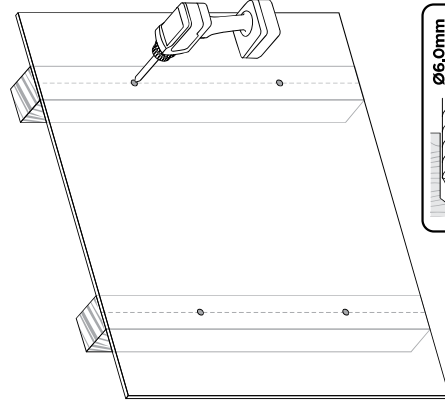
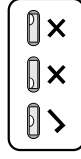
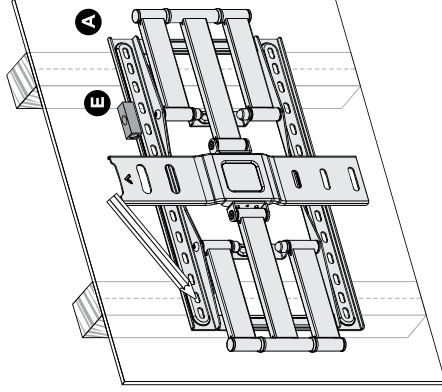
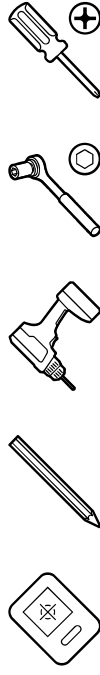

Step 1b

Concrete/Brick Mounting Option

- Use a Bubble level (#E) to ensure straightness, hold the Wall Mount (#A) to the desired location on the wall and mark the center of the 4 mounting holes with a pencil as shown here.
- Use a 3/8" drill bit and drill on the marked locations to a depth of 2.4". Clear any dust and debris from the holes and insert the Concrete Anchors (#W-B).
- Secure the Wall Mount (#A) to the wall using the Lag Screws (#W-A) and Washers (#W-C). Tighten the screws until secure.

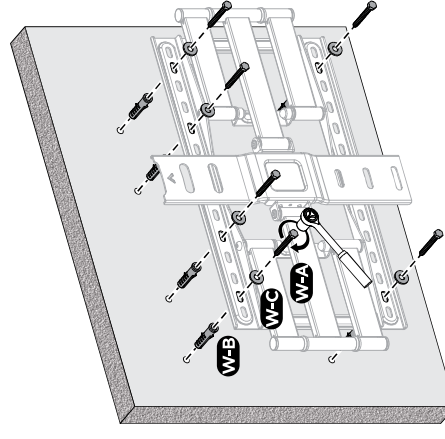
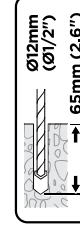
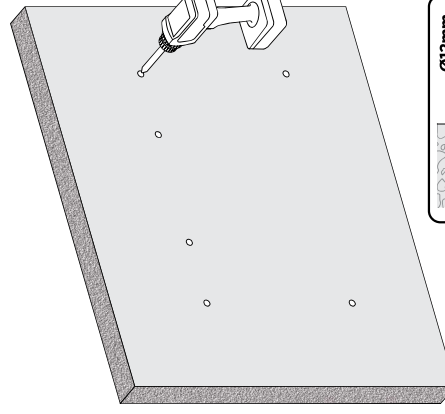
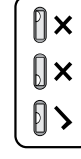
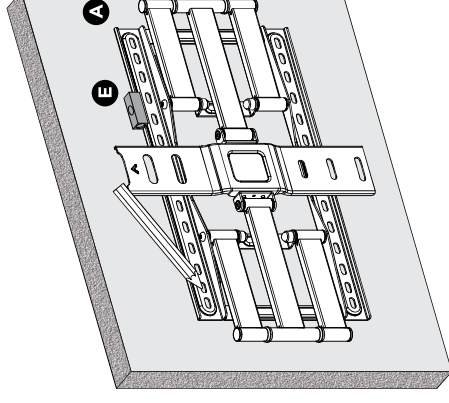
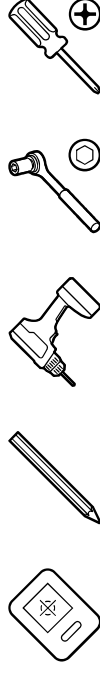

Step 2

Prepare the Mount Arms

- Pull the mount forward until it reaches the full extension from the wall.

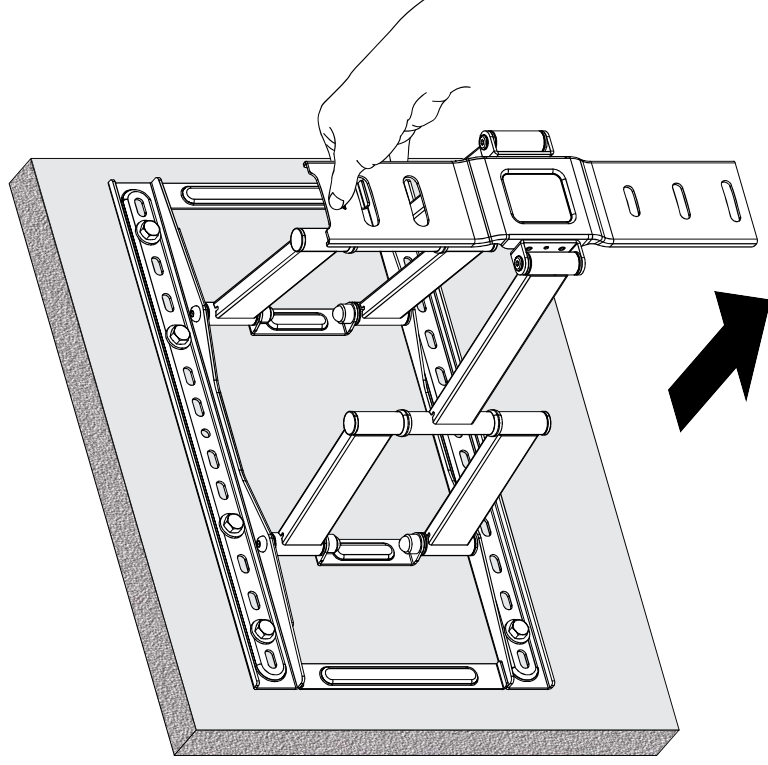

Step 3

Install the Brackets to the TV

- Install the Upper (#B) and Lower(#C) Brackets to the TV's VESA mounting holes. Ensure that the Upper Bracket (#B) is oriented as shown here, with the hook facing towards the bottom of the TV.
- Select the appropriate size mounting bolt (#M-A through M-D) and washer (#M-E) for your display's mounting holes and verify the length of the VESA bolt is not too long. If you are unsure of the correct bolt size for your display refer to your TV user manual or contact the TV manufacturer for sizing information. If necessary, use the included spacers (#M-F, M-G) between the mount and the TV to adjust the length of the mounting bolt. Multiple spacers can be used in combination to achieve the desired bolt depth. Attach the VESA Brackets using the selected hardware in the matching configuration shown here.

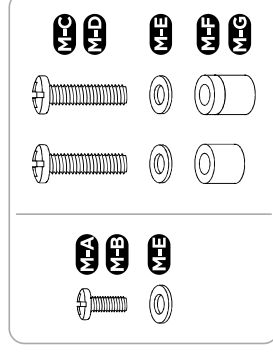
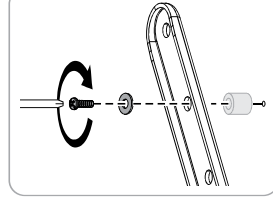
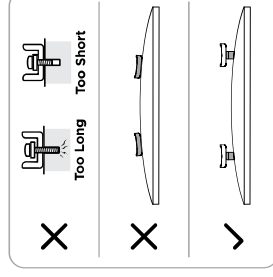
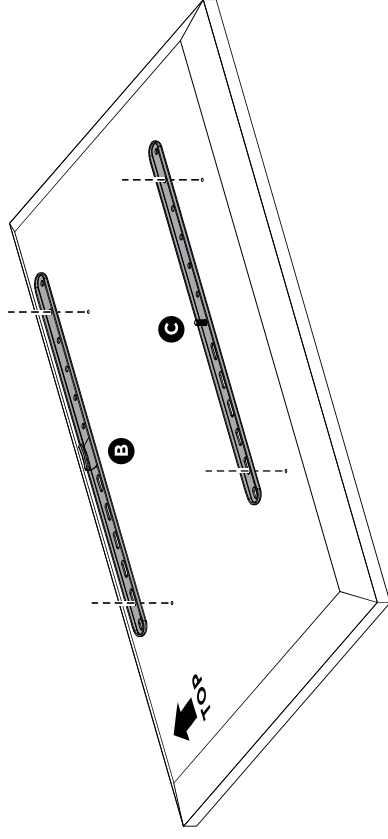

Step 4

Hang the TV on the Wall Mount

- Hang the TV onto the wall mount so that the hook attaches over the top of the bracket as shown in the magnification bubble.

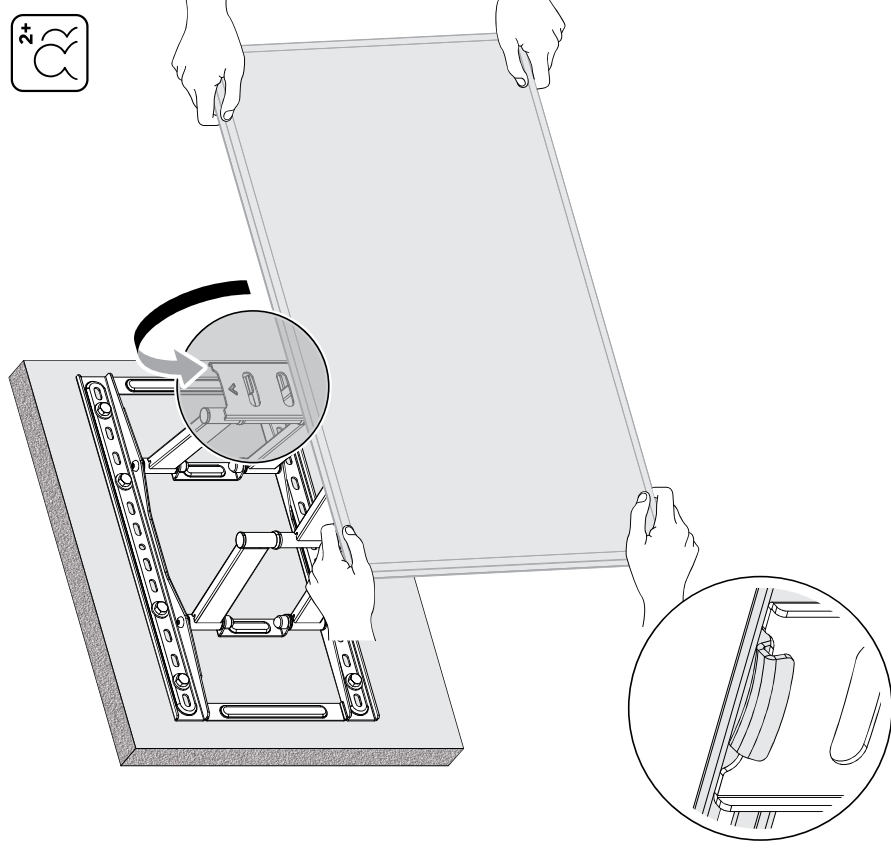

Step 5

Install the Levelling Nut

- Lower the bottom half of the screen until the bolt on the Lower Bracket (#C) passes through the hole on the wall plate. Use a bubble level to adjust the level of the TV then install the Levelling Nut and tighten it using the Wrench (#H) until it is secure.

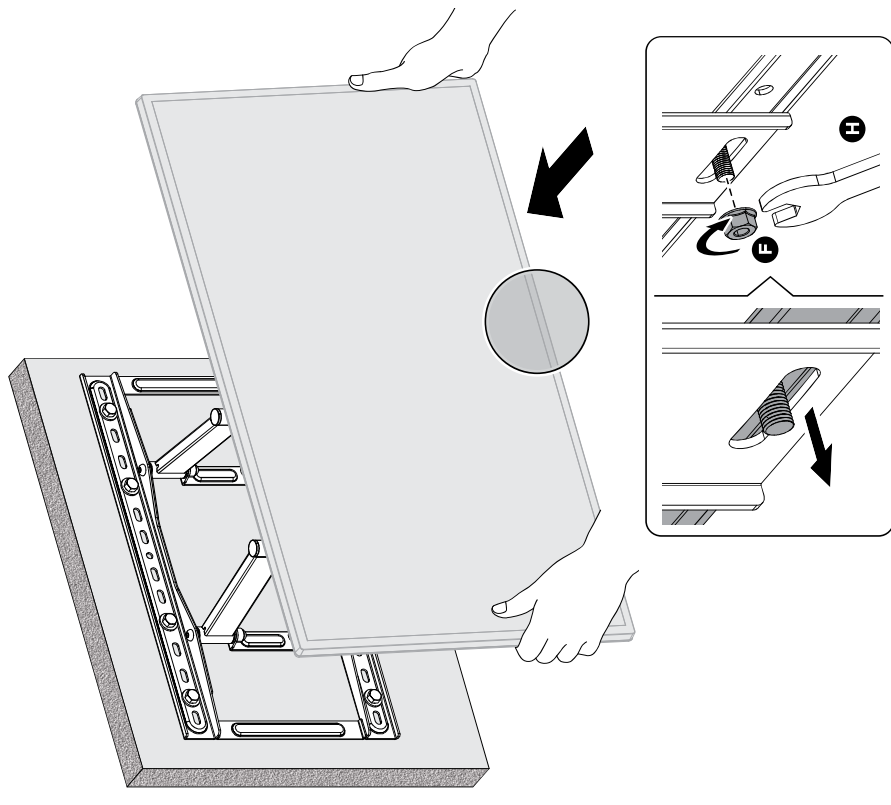

Step 6

Cable Management

- Route cables along one side of the mount arms and secure them in place using the Cable Ties (#D). Ensure enough slack is left in the cable to allow for movement.

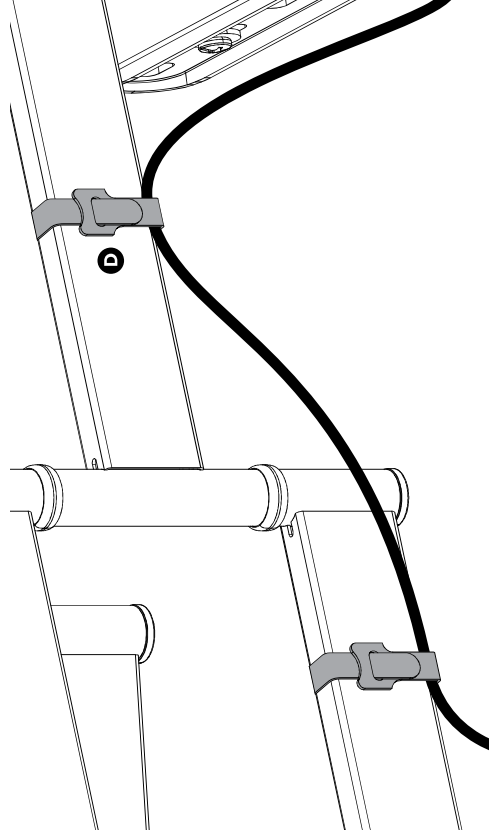

Step 7

Final Adjustments

Note: Adjust the tilt of the screen using the bolts shown here. Loosen the bolts, tilt the screen to your desired viewing angle, then tighten the bolts down again.

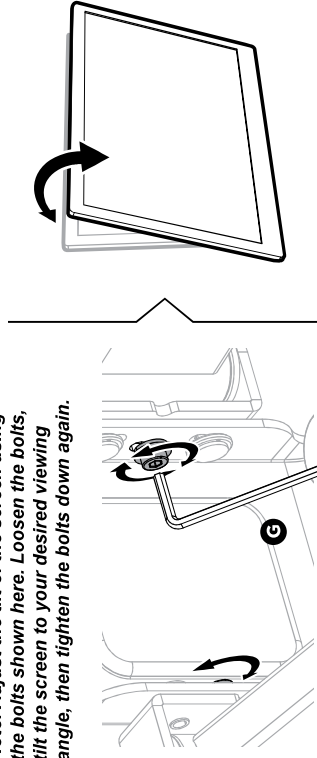

Note: Adjust the level of the screen by loosening the bolt, adjusting the tilt of the screen, then tightening the bolt back down.

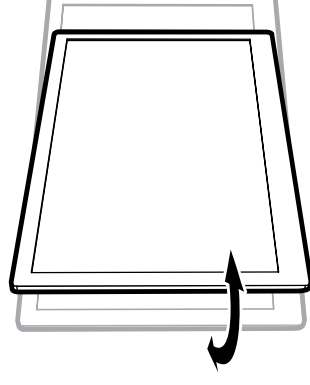
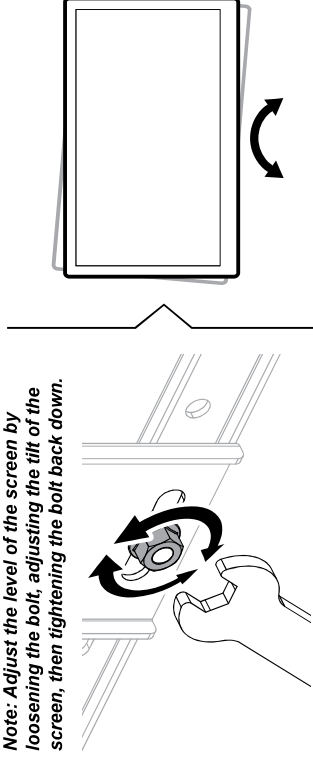

Visit us at **www.mount-it.com** for product registration and warranty information.

Our US based customer service team is standing by to answer any questions you have about your Mount-It! product.



proav@mount-it.pro

Available by phone **Monday - Friday from 5:00am to 5:00pm** PST.



1 (855) 552-6699

Chat live with an agent on our website!



www.mount-it.pro