

△ REQUIRES ITEM 15

**3902MH**      **3902M**  
**3902MP**      **3902MK**  
**3902MPI**      **3902MR**  
**3902MRI**

To order spare parts add and/or replace as stated below:

**SPD-** prefix added to part number(s)  
**-ZZ** replaced with finish code (see finish table)  
**-WW** replaced with **-90** (light finish) or **-96** (dark finish)

Ex: **SPD-7-100463-PC** or **SPD-86030-96**

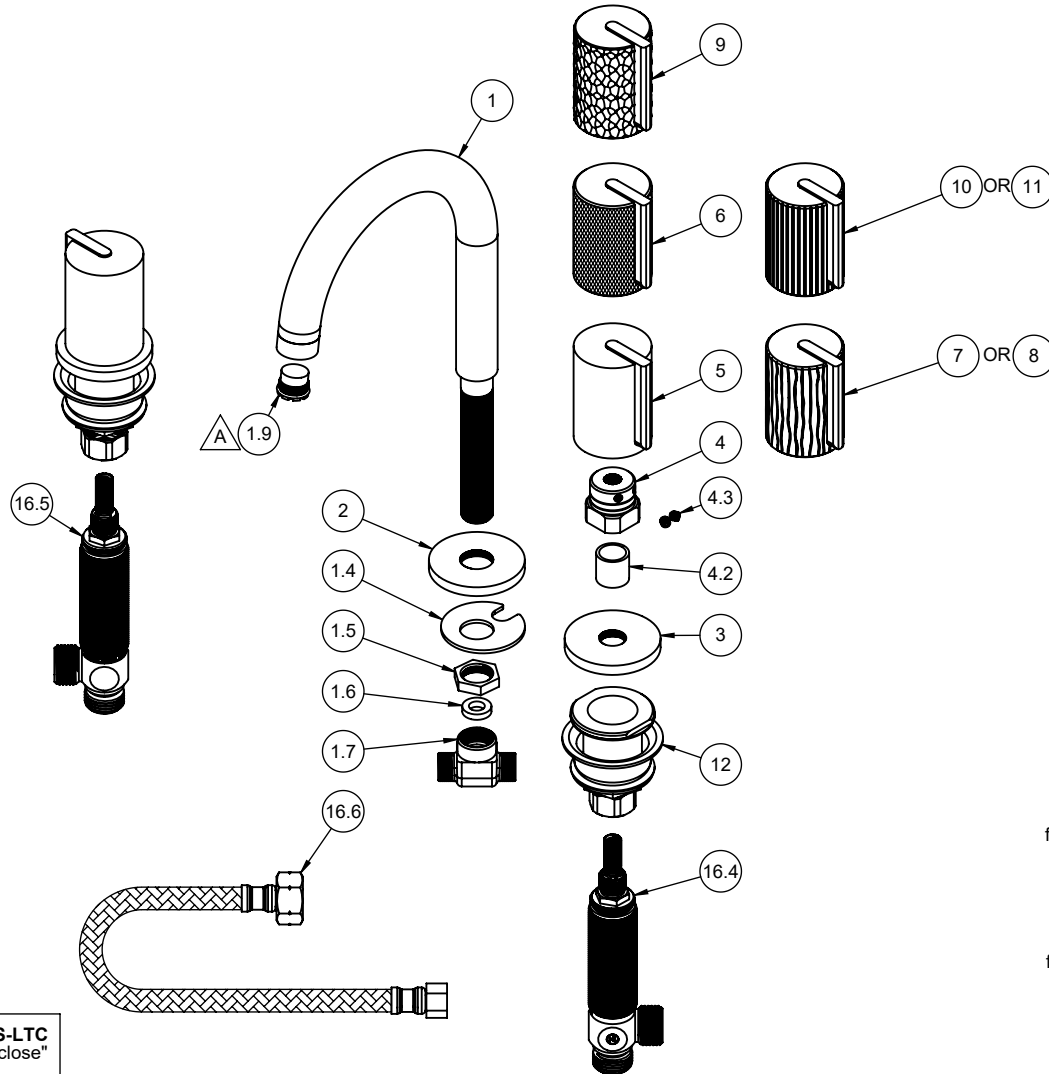

ITEM	PART NO.	DESCRIPTION	QTY
1	7-100463-ZZ	ASM, LAV ANGLED ARC SPOUT, SMOOTH SHELL <i>(incl. 1.4, 1.5, 1.6, 1.7, 1.9)</i>	1
1.4	881766-99	WSHR HORSESHOE	1
1.5	881276-99	NUT, HEX 3/8"-18 NPSM X .20 HT	1
1.6	87162-80	WSHR Ø8.5 X Ø15.5 X 3.5MM EPDM A70 (NSF-61-12 & WRAS)	1
1.7	880083-90	TEE, 3-WAY LAV - SS	1
1.9	880356-81	INSERT, 1.2 GPM, TT LAMINAR (CACHE)	1
2	11089-ZZ	ESCUTCHEON, RD Ø2" W/ M18 X 1.0	1
3	11090-ZZ	ESCUTCHEON, RD Ø2" W/ 9/16"-20	2
4	6-200327	ASM, CYL HDL CARRIER <i>(incl. 4.2, 4.3)</i>	2
4.2	87342-81	BUSHING, Ø14.30 X Ø17.50 X 16.70MM UHMW	1
4.3	86033-90	SETSCREW 10-24 X 3/16 SCKT HD CUP PT SS	2
for 39 Series	5	7-100594-ZZ ASM, SMOOTH CYL HDL	2
for 39K Series	6	7-100596-ZZ ASM, KNURL CYL HDL	2
for 39R Series	7	7-100597-ZZ ASM, RIVULET CYL HDL	2
for 39RI Series	8	7-100597I-ZZ ASM, RIVULET CYL HDL - INTAGLIO	2
for 39H Series	9	7-100598-ZZ ASM, HAMMERED CYL HDL	2
for 39P Series	10	7-100606-ZZ ASM, PINSTRIPE CYL HDL	2
for 39PI Series	11	7-100606I-ZZ ASM, PINSTRIPE CYL HDL - INTAGLIO	2
	12	6-200294 KIT, W/S INV NUT - 2 SETS (1 SET= 6-200294-1)	1
for ITEM 4.3	14	882043-99 KEY, ALLEN, 3/32", BLACK	1
for ITEM 1.9	15	223472-99 KEY, TT CACHE AERATOR INSERT	1
	16.4	6-200087 ASM, COLD-LAV "NL" BODY & CART (.25 Pb)-G4 <i>(incl. CART-WS-LTC)</i>	1
	16.5	6-200088 ASM, HOT-LAV "NL" BODY, CART (.25 Pb)-G4 <i>(incl. CART-WS-RTC)</i>	1
	16.6	880099-99 HOSE, POLY BRAIDED, 1/2 IPS X 3/8 CMP X 12 (DN6-SILICONE) (NL, NSF-61-12 & WRAS)	2

