









Email Address: icemagecs@gmail.com

Ice Maker Instruction
(HS-22 / HS-23)

Safety Precautions

Do not store or use gasoline, or other flammable liquids in the vicinity of this or any other appliance. Read product labels for warnings regarding flammability and other hazards.

-  Warning: This product is with a flammable refrigerant. Keep away from ignition sources and ensure indoor ventilation during maintenance. Do not use flammable items near the machine to prevent fire hazards.
-  Warning: Keep the area around the machine free from obstacles and ensure proper ventilation.
-  Warning: Do not use any machinery, equipment, or other methods to accelerate the defrosting process, except those recommended by the manufacturer.
-  Warning: Do not damage the refrigeration circuit of the machine.
-  Warning: Do not use any electrical appliances inside the food storage compartment of the machine unless recommended by the manufacturer.
-  Warning: The insulation material of the cabinet contains flammable cyclopentane. Keep away from ignition sources to avoid burning, and dispose of it by professionals when necessary.
-  Warning: Do not store explosive substances in the appliance, such as aerosol propellants.
-  Warning: Only fill with drinking water.

-  Warning: The refrigeration system contains refrigerant under high pressure. Do not damage the refrigeration system. Repairs to the refrigeration system should be performed by professionals.

This appliance is intended for household and similar use, such as:

1. Kitchen areas in shops, offices, or other work environments.
2. Farmhouses and accommodations including hotels, motels, and residential settings.
3. Guesthouses or bed and breakfast establishments.
Applications in the foodservice industry and similar non-retail business.

Contents

- Important Safety Tips ----- 2
- Getting To Know Your Ice Maker ----- 5
- Operating Steps And Maintenance ----- 7
- To Use Your Ice Maker ----- 9
- Trouble Shooting ----- 11
- Technical Specifications ----- 12
- Schematic Diagram ----- 13
- Customer Notes ----- 14

Important Safety Tips

Your personal safety and the safety of others are paramount. We have prepared many safety tips related to this machine for you. Please make sure to read and adhere to these tips.

This is the safety warning symbol. 

All safety warnings will be accompanied by this symbol or words such as 'Danger' and 'Warning'

If you do not follow these safety instructions, you could be seriously injured.

All safety tips describe potential hazards, inform you how to reduce the chance of injury, and explain the consequences of not following the safety instructions.

 **Danger**

 **Warning**

When using or operating the ice maker, please do not touch the evaporator as it may cause frostbite to your skin.

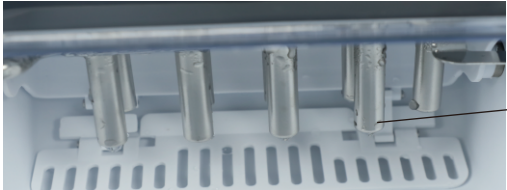

Evaporator Column

When using household appliances, it is essential to adhere to basic safety regulations to reduce the risk of fire, electric shock, and harm to individuals or objects. Before using this appliance, please read the following safety tips carefully.

- Do not use or operate the machine if the power cord is damaged.
- Use the correct power outlet and ensure that the power plug is fully inserted into the outlet.
- Do not place the power cord on carpets or insulating materials, and do not cover the power cord. Keep the power cord away from walking paths and avoid immersing it in water.
- We do not recommend using extended power cords as it may cause over-heating or fire. If necessary, use an extension cord with a minimum rating of 1.5 square millimeters.
- Disconnect the power before cleaning or performing any maintenance.
- Adult supervision is required when the appliance is used in the presence of children.
- Do not clean the ice maker with flammable liquids, as this may cause fire or explosion.
- Do not overturn the ice maker. If it has been overturned, place the machine upright for 24 hours before turning it on
- HS-22 model ice machine operating voltage is 110~120V/AC/60HZ
HS-23 model ice machine operating voltage is 210~230V/AC/50HZ

In winter, if you are moving the ice maker from outdoors to indoors, please wait for a few hours before connecting it to the power supply. This will allow the temperature of the ice maker to rise and become consistent with the room temperature.

- (1) When handling, installing, and operating the appliance, care should be taken to avoid damage to the refrigerant tubing.
- (2) Warning: Flammable refrigerant used, this appliance is to be installed in accordance with the Safety Standard for Refrigeration Systems, ANSI/ASHRAE 15.
- (3) Warning: Flammable refrigerant used, to minimize the risk of possible ignition due to incorrect parts, component parts shall be replaced with designated components.
- (4) Warning: the ice maker shall not be installed in corridors or hallways of public buildings.

Getting To Know Your Ice Maker

To open the packaging

- 1.Remove all internal and external packaging. Check for the ice basket and ice scoop. If any accessories are missing, please contact customer service.
- 2.Remove the ice basket and wash it in warm water. Then, clean the water reservoir with warm water and a soft cloth.
- 3.Clean the evaporator's columns using water.
- 4.Place the ice maker in a location where it is not directly exposed to sunlight and away from heat sources and radiation. Ensure that the ice maker is placed horizontally with at least 15cm of space on both sides and the back.
- 5.Ensure that the location where the ice maker is placed has a suitable electrical outlet for power connection.

To power on the ice maker

 **Danger**

Incorrect use of the grounding wire may pose a risk of electric shock. If the power cord is damaged, please contact the after-sales service department for assistance.

For your safety, this device should be properly grounded. The power cord of this device is equipped with a grounding plug, which is used in conjunction with a standard grounding wall socket to minimize the possibility of electric shock.

To clean the ice maker

Before using the ice maker, for the first time, or the clean procedure has not been running for a long time, it is highly recommended to run this procedure first.thoroughly clean the entire machine.

- 1.Remove the ice basket.
- 2.Open the drain plug to empty the water reservoir.
- 3.Clean the interior of the machine with a diluted cleaning agent, warm water, and a soft cloth.
- 4.The exterior of the machine should be regularly cleaned with a diluted cleaning agent and warm water.
- 5.Use another soft cloth to dry the interior of the machine.
- 6.Close the drain plug. When the machine is not in use for an extended period, it is important to empty the water reservoir and dry the interior.
- 7.Standby mode, double-click the power button to enter the cleaning mode. The light on the power icon will flash. The ice maker will take 1 minute to pump water into the sink then drain the water,This is a cycle.Cycles 5 times, and then exits the cleaning mode. Clicking the power button during cleaning mode will exit the mode.After cleaning, remove the drain plug from the bottom of the ice maker and drain the water. Tighten the drain plug after drain the water (Tilting the machine is not allowed) 

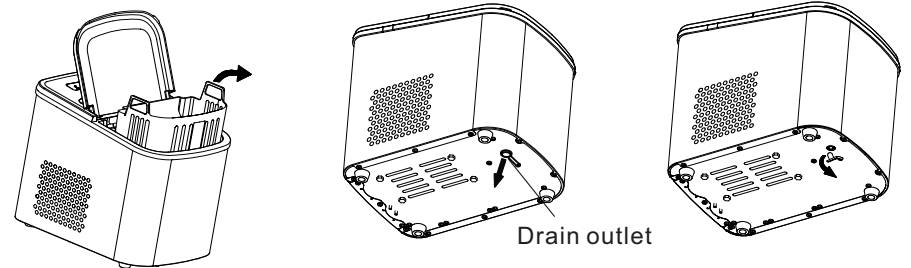

Operating Steps And Maintenance

1. Ice scoop
2. Infrared ice full sensor
3. Ice basket
4. Lid
5. Air intake
6. Air outlet
7. Maximum water level position
8. Control panel

A. Power switch / Small/Large ice selection / Cleaning function. (Long press for 2 seconds to power on/off, short press to switch between small and large ice, double-click to activate the cleaning function when the machine is powered off)

- B. Full ice indicator
- C. Small ice indicator
- D. Big ice indicator
- E. Water shortage indicator
- F. Power indicator

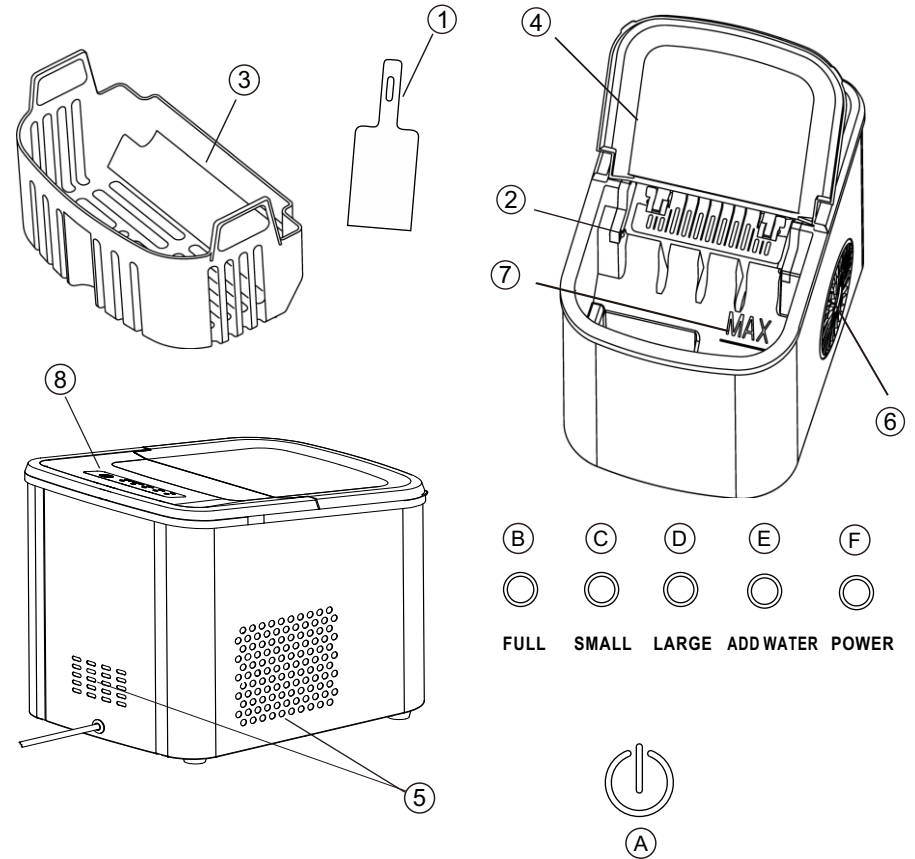

To Use Your Ice Maker

1. Open the lid and remove the ice basket. Fill the water reservoir with water up to the maximum water level mark. Place the ice basket back into the machine and close the lid.
2. Before the first operation and connecting to the working power supply, carefully check whether the voltage, frequency, and usage location indicated on the equipment nameplate are consistent.
3. Connect to the working power supply, the ice making mode light will turn on, displaying the status of large or small ice. You can choose the large or small ice mode according to your needs, and the device will enter the waiting ice making operation state; Press and hold the 'Power' button on the control panel for 2 seconds to start the ice-making process.
4. It takes around 3 minutes and 30 seconds to produce the first batch of small ice cubes. Subsequent batches of small ice cubes will take the same amount of time. The first batch of large ice cubes will take around 5 minutes. Please note that the size of the ice cubes may vary depending on the ambient temperature and water temperature. If the ambient temperature is above 28 degree, the ice making time will increase.

5. After the ice machine is running, check the water level of the water reservoir regularly. If the water pump fails to supply water, the ice machine will stop automatically. The 'ADD WATER' indicator light will flash, indicating a lack of water. In this case, fill the water reservoir and press the 'Power' button to resume the ice making process.
6. If the ice basket is full, the ice maker will automatically stop producing ice, and the 'Ice Full' indicator light will flash. When the level of ice cubes in the basket drops below the infrared sensor, the machine will resume working.
7. When the water pump malfunctions, it also displays a shutdown status and the water shortage alarm light is on. Please contact a professional for assistance.
8. It is recommended to replace the water in the water reservoir every 24 hours to maintain cleanliness. If the ice maker will not be used for an extended period, it is advised to empty the remaining water from the water reservoir.

Recommendation: Use water that is safe for direct consumption.

Statement: When the machine is damaged and cannot be used, please contact the manufacturer for recycling. Do not discard at will.

Fault Troubleshooting

Fault Symptoms	Possible Causes	Solutions
'ADD WATER' indicator light is on.	1.Insufficient water: The water level in the reservoir is below the required minimum level. 2.Clogged bottom filter in the water tank.	1.Add water. 2.Clean thoroughly.
'FULL' indicator light is on.	1.The ice basket is filled with too many ice cubes. 2.There is an obstruction blocking the sensor.	1.Remove the ice from the ice basket 2.Take out any foreign objects or ice cubes that may be obstructing the sensor.
The ice cubes sticking together	The water temperature inside the water tank is too low	Adjust the water temperature in the tank to the recommended level Within the range of 8-32 degrees celsius, or switch to Little Ice mode.
Full of ice but the light does not display.	The machine is placed in an area with excessive light	Move the machine to a location with less intense light
The ice-making process is normal, but no ice cubes are being formed	The ambient or water temperature is too high	Add water below 32 degrees
	Refrigeration system leaks	Contact after-sales service
	Refrigeration system clogged	Contact after-sales service

Technical Specifications

Model	HS-22	HS-23
Power Input	110~120V/AC/60HZ	210~230V/AC/50HZ
Protective Class	I	
Climate	ST	
Ice Making Current/ Power	2.3A/170W	1A/170W
High pressure side design pressure	400psi	
Low pressure side design pressure	150psi	
Maximum Water Volume	1.5L	
Refrigerant/ Refrigerant Charge	R290 / 35g	
Net Weight	8.9kg	
Size (W*D*H)mm	340*241*295	

Schematic Diagram

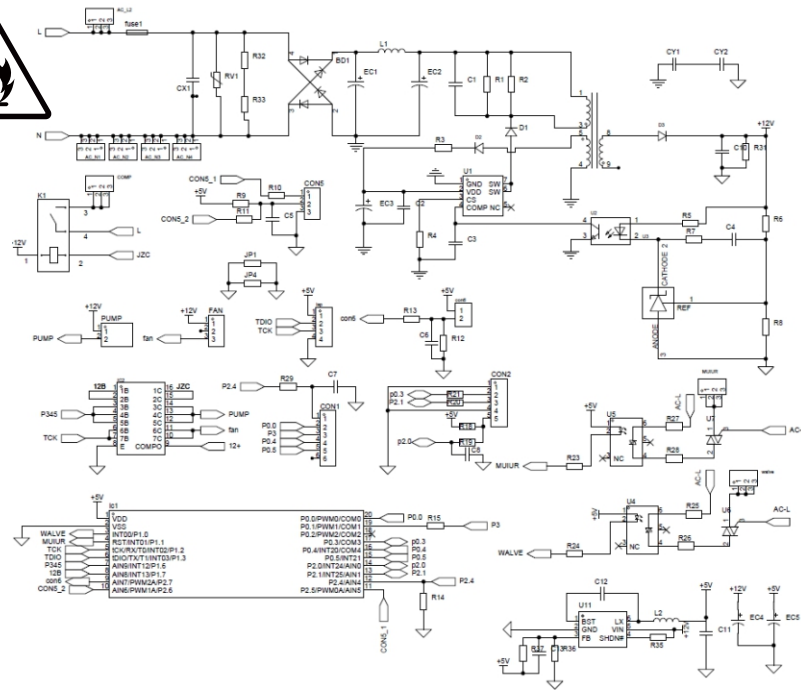

Customer Notes

Thank you for choosing our company's product. With this warranty certificate and invoice, starting from the date of purchase (as indicated on the invoice), our company will provide the following services:

1. Free one-year warranty for the entire machine.
2. Free one-year warranty for major components (compressor).
3. The following situations are not covered under the warranty and will be subject to repair charges:
 - (1) Damage caused by improper use, maintenance, or storage by the consumer.
 - (2) Damage caused by disassembly by a non-designated authorized repair department of our company.
 - (3) No warranty certificate or valid invoice.
 - (4) Product does not match the warranty certificate and invoice or has been modified.
 - (5) Damage caused by force majeure.
 - (6) Warranty period has expired.

For faster service, locate the model, type, and serial numbers on your appliance.
ATTACH YOUR PROOF OF PURCHASE HERE, PROOF OF PURCHASE IS
REQUIRED TO OBTAIN WARRANTY SERVICE.

Please have the following information available when you contact the Support
Team:

- Name, address and telephone number.
- Model number and serial number.
- A clear, detailed description of the problem.
- Proof of purchase including dealer or retailer name, address and date of purchase.