

Baby Slide

USER'S MANUAL

Special Note

The instructions used in this manual are solely for the illustration of the operation method and structure of the product. When there is a marginal difference between the physical object and the figure, the actual product shall prevail. For the purpose of quality and product improvement, the company may change the structure and appearance of the product without notice.

Thank you!

WARNING

- Assembly by an adult. Install with this side *AWAY* from child.
- Children must be used under the guardianship of adults.
- The range age of use of this product is 1- 8 years.
- Only used by one child who does not exceed 60 kgs.
- Only for domestic use.
- This activity toy is usually suitable for indoor use or temporary outdoor use.
- Use only with the mechanism securely engaged. Do not expose the product to direct sunlight for a long time.
- Keep the assembly and installation instructions for further reference.
- When the product is damaged, broken or disassembled, stop using the product.
- A recommendation to place the activity toy on a level surface at least 2 m from any structure or obstruction such as a fence, garage, house, overhanging branches, laundry lines or electrical wires.
- The activity toys shall be used over concrete, asphalt or any other hard surface. Do not use in soil that is not hard.
- Consumers should not modify original activity toys without guidance from the manufacturer or a professional, especially to reduce the number of certain products.
- This product is not for commercial use and will not carry any warranty for commercial use.

CLEANING INSTRUCTION

Use a soft sponge or cloth with some detergent to scrub the surface of products, and then dry the surface with dry cloth.

MAINTENANCE INSTRUCTIONS

- Regular inspection and maintenance of major components, without which the activity toys may tip over or become hazardous.
- Check the tightness regularly and tighten it according as required.
- Always check all plastic parts to avoid cracks or abrasion and make sure it is properly fixed when necessary.
- Replace defective parts in accordance with the manufacturer's instructions.
- Check all coverings for bolts and sharp edges and replace when required.

MOUNTING ACCESSORIES

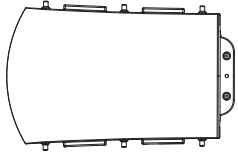

① Buffer plate*1

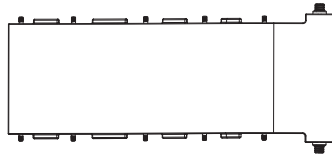

② Slide*1

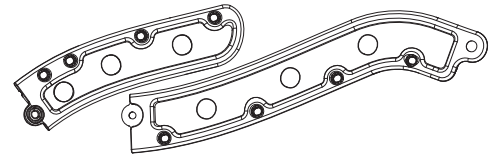

③ Slide handrails*2 each

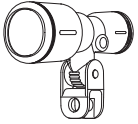

④ Telescope*1

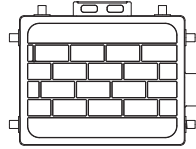

⑤ 2-ear platform*1

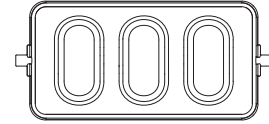

⑥ 3-hole lower baffle*2

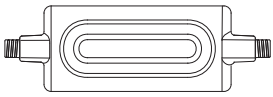

⑦ Foot pedal*1

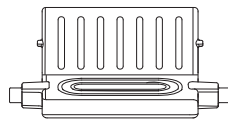

⑧ One-piece foot pedal*2

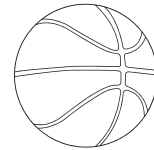

⑨ Basketball*1

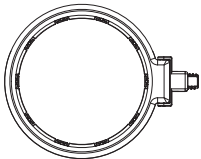

⑩ Folding ball frame*1

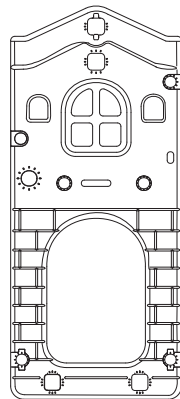

⑪ Large side panel*1

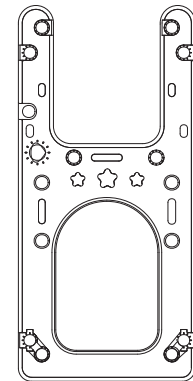

⑫ U-shaped side panel*1



⑬ Screw*1



⑭ Small cross nut*14



⑬ Little Prodigy Nut*18



⑭ Flower nut*2

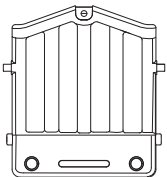

⑰ Platform baffle*1

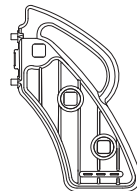

⑱ Stair handrail*2

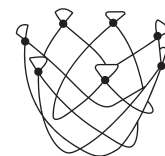

⑲ Basketball net*1

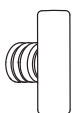

⑳ Rectangular screw*2



㉑ Rectangular screw*2



㉒ Large nut*7



㉓ Plastic screwdriver*1

INSTALLATION INSTRUCTIONS

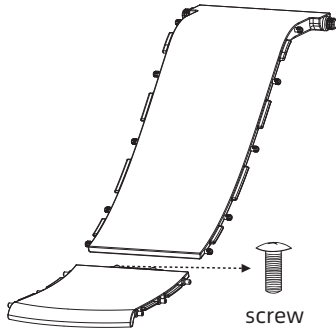

1 Buffer plate and slidaway assembly

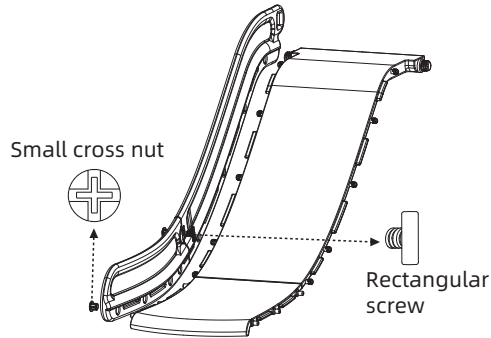

2 Install the handrail on one side of the slide

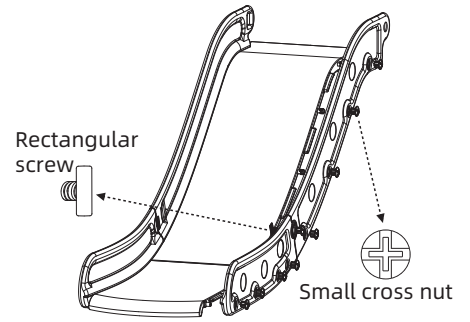

3 Fix the other side of the slide rail

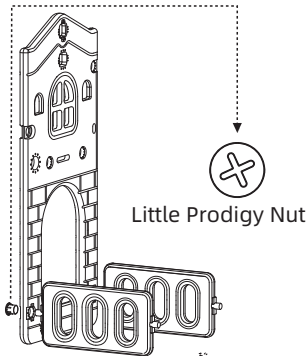

4 Fix the 3-hole lower baffle to the large side plate respectively

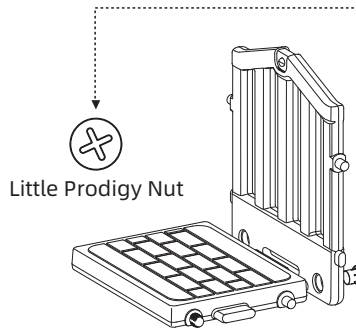

5 Platform baffle and 2-lug platform assembly

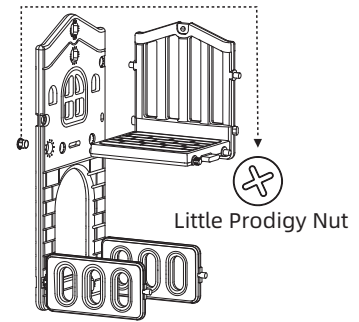

6 Secure the assembled 2-lug platform to the large side panel

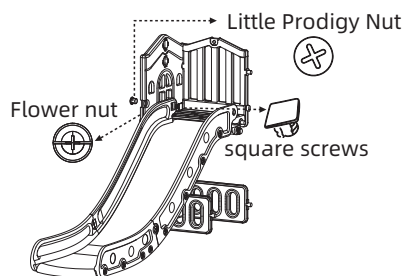

7 Fix the assembled slide to the large side plate and align it with the 2-lug platform

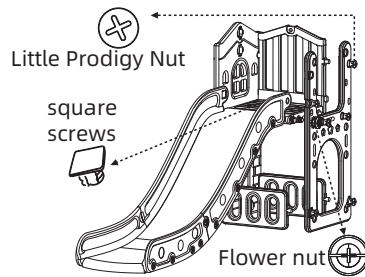

8 Attach the U-shaped side panels to the 2-lug platform and the other side of the slide

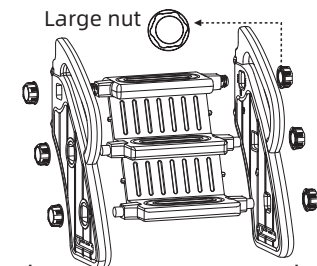

9 Use large nuts to secure the foot pedals and one-piece foot pedals to the stair railings in sequence.

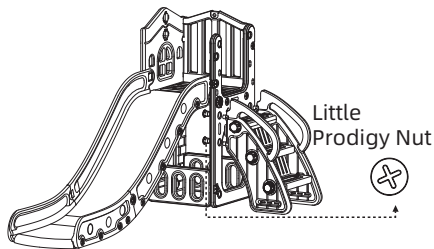

10 Use small prodigy nuts to fix the assembled stairs to the U-shaped side panels

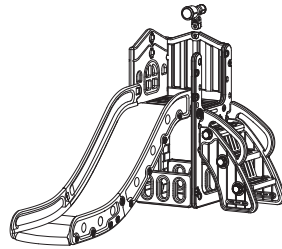

11 Snap the telescope to the corresponding position on the platform baffle

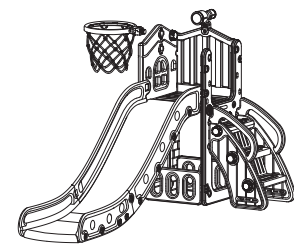

12 Use large nuts to fix the basketball hoop to the large side panel and hang the basketball net to complete the installation.

NOTE: The installation of the basketball net is shown below:

