

ASSEMBLY INSTRUCTIONS

STEP 1: Take out the backrest and find the position of the backrest insert and the position of the seat cushion slot. Align the insert with the two slots on the seat cushion simultaneously and gently push down. When you find that it can be fully embedded, press down again to make the insert and the slot completely buckle.

STEP 2: Take out the ear and find the position of the backrest insert. Align the insert with the two slots.

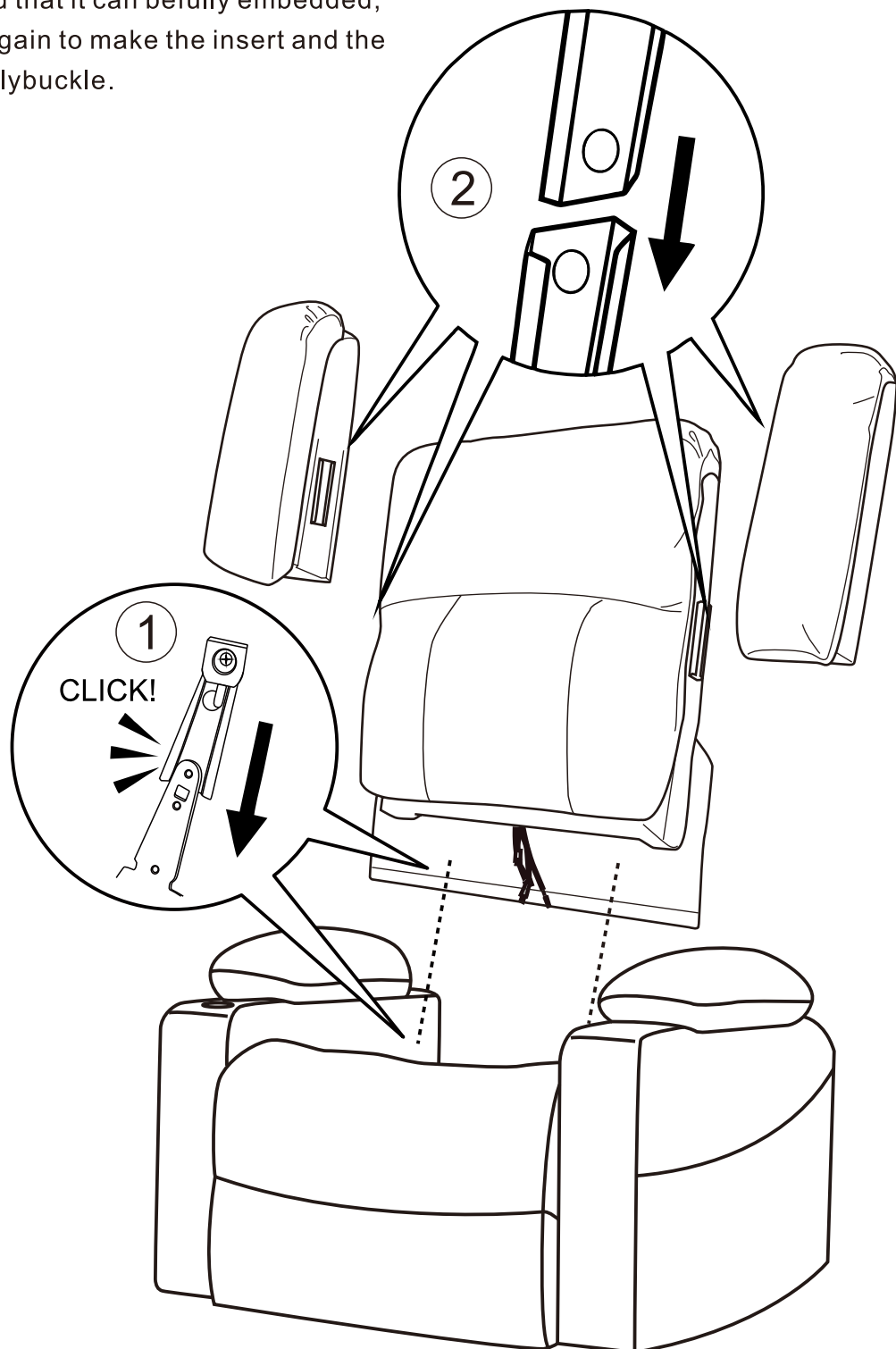

STEP 3 : Please follow the steps to plug in the power
(How to connect a line)

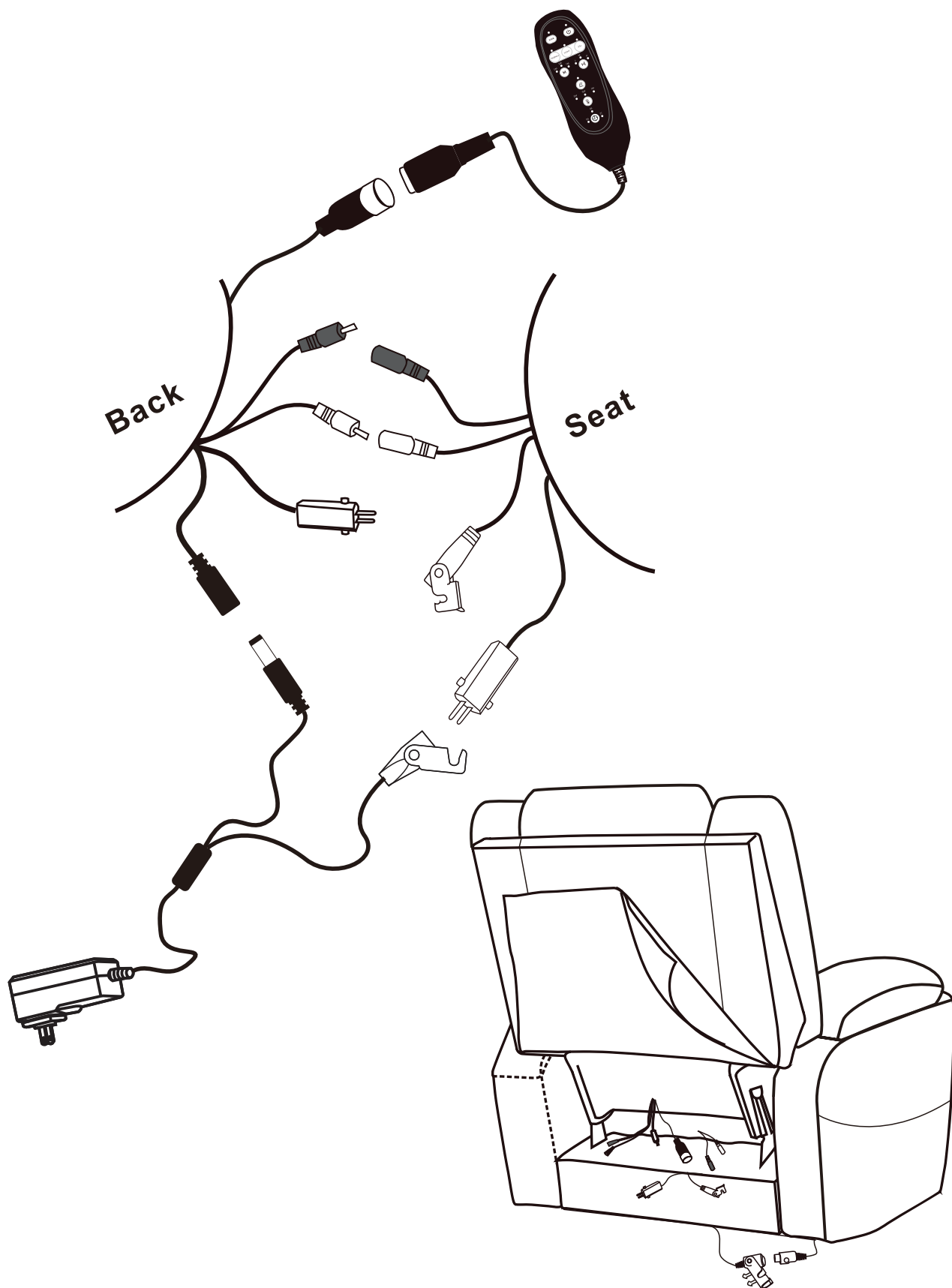

STEP 4 : Take out the phone holder and insert it into the left armrest.

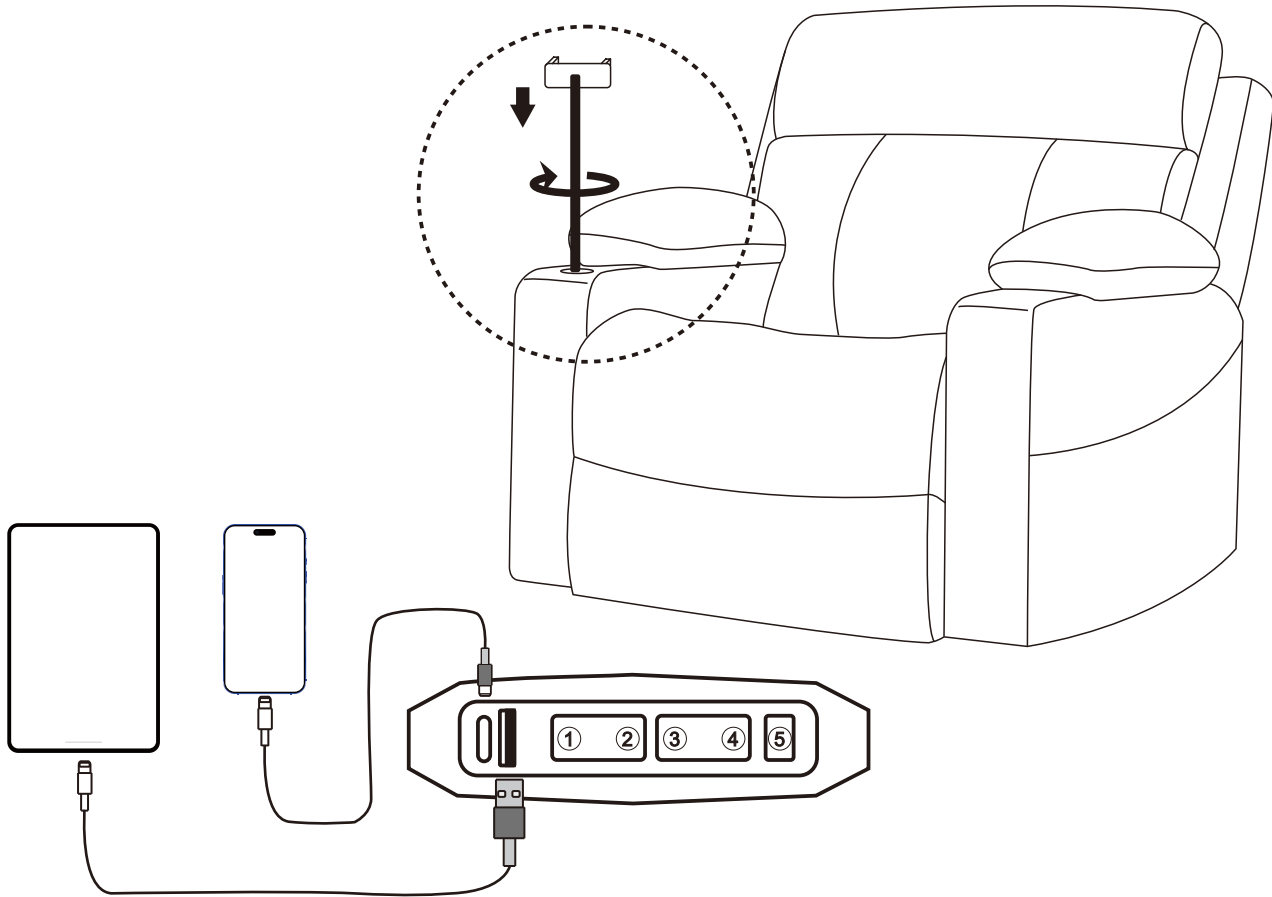

- ① Unfold the sofa
- ② Close the sofa
- ③ Unfold the headrest of the sofa
- ④ Close the headrest of the sofa
- ⑤ One-click reset

How to use remote control?

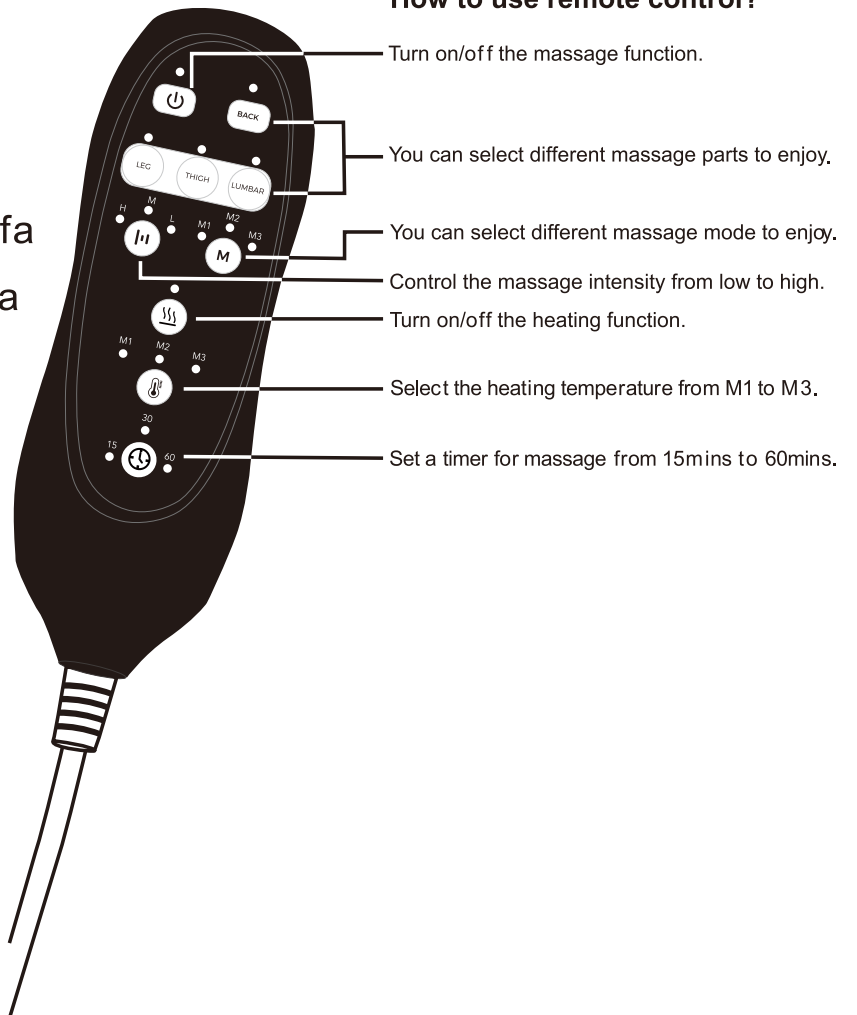

TO STORE OR CLEAN

Maintenance

Instructions

Rotate reversible cushions regularly.

Turn over & Rotate

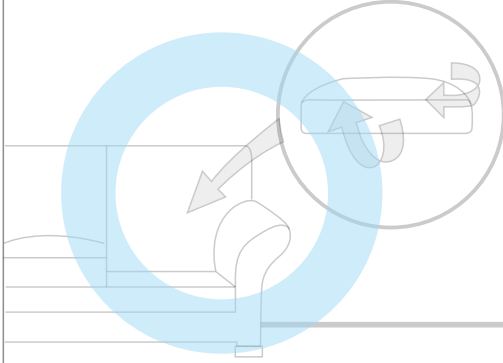

Vacuum your furniture regularly with upholstery tools.

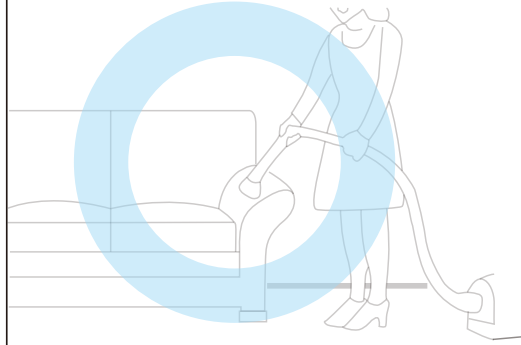

Do not expose your furniture to prolonged periods of direct sunlight.

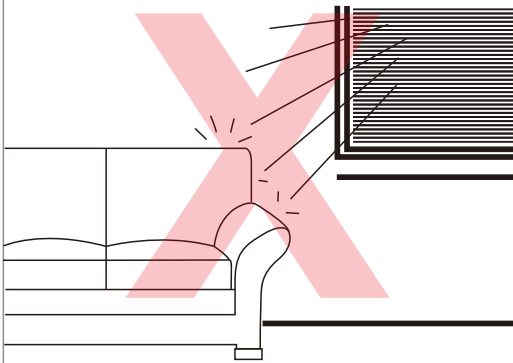

Do not place your furniture close to a radiator or similar heat source.

