

ASSEMBLY INSTRUCTIONS

---

# L-Desk

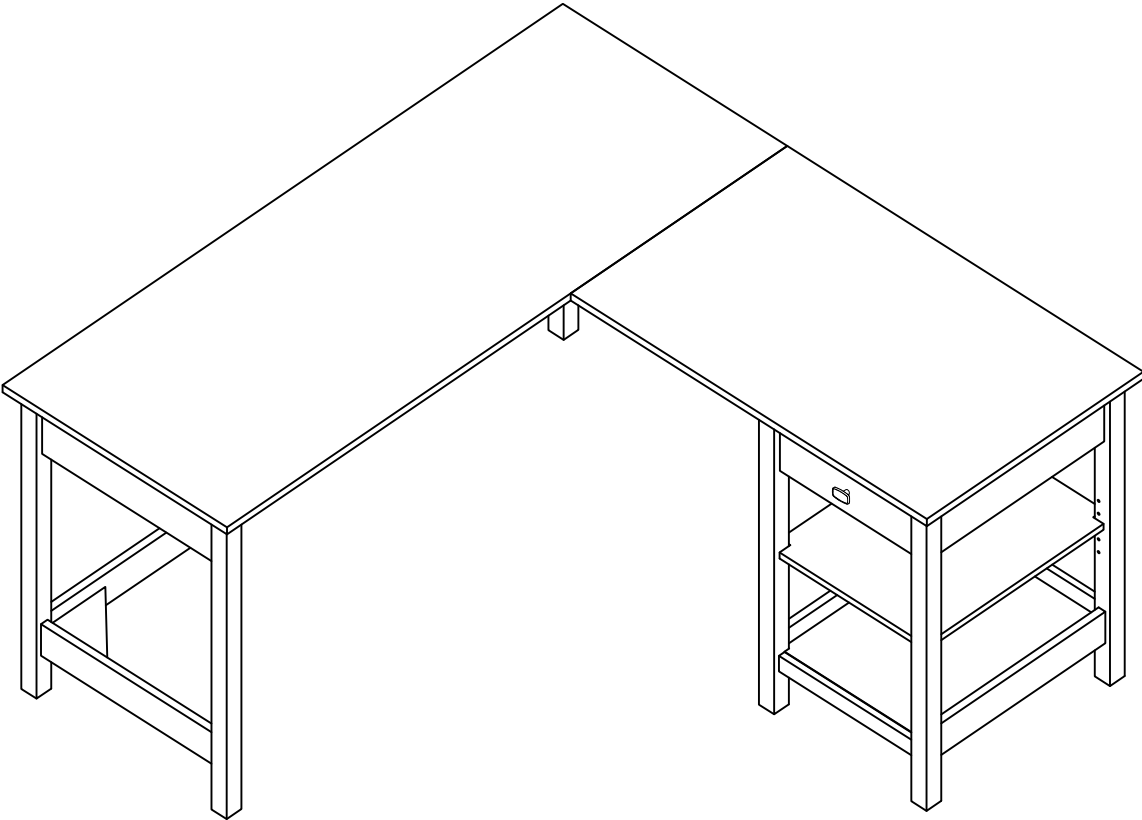

**Thank you for purchasing.** We trust that you will be completely satisfied with your product for many years to come. This products are backed by a 1-year warranty and crafted with today's styles in mind for the way you work.

**Merci d'avoir acheté .** Nous sommes sûr que vous serez complètement satisfait de votre meuble pendant de nombreuses années. Les produits sont garantis pendant 1 ans et sont conçus dans les styles actuels tout en gardant à l'esprit votre façon de travailler.

**Gracias por comprar .** Confiamos que usted estará completamente satisfecho con su mueble por muchos años. Los productos de tienen 1 años de garantía y son diseñados con los estilos de hoy en mente para la manera que usted vive.

# IT'S AS EASY AS 1,2,3

## Assembly tips:

1. Read the instructions and become familiar with the parts.
2. Ensure this carton contains all parts, fasteners and hardware.
3. To protect floors, assemble the furniture on the carton.
4. An assistant may be helpful.
5. Use of power tools is not recommended.

## Conseils d'assemblage:

1. Lisez les instructions et familiarisez-vous avec les pièces.
2. Assurez-vous que le carton contient toutes les pièces, toutes les pièces de fixation et toute la quincaillerie.
3. Pour protéger vos sols, assemblez le meuble sur le carton.
4. Il peut être utile de vous faire aider.
5. L'utilisation d'outils électriques n'est pas recommandée.

## Consejos de Ensamblaje:

1. Lea las instrucciones y familiarícese con las partes.
2. Asegúrese de que esta caja contenga todas las piezas, los sujetadores y el equipo.
3. Para proteger el piso, ensamble el mueble en el carton.
4. Un asistente puede serle útil.
5. El uso de herramientas eléctricas no se recomienda.



CONSUMER  
SERVICE

YOU CAN DEPEND ON

**Questions?** Operators are standing by at our TOLL-FREE help line to assist you with assembly; and, if necessary, to quickly replace damaged/missing parts. Assistance is available 5 days a week. Simply have your store receipt, instruction manual, and part number/description ready when you call our TOLL-FREE help line. It's that easy.

UN SERVICE CLIENTELE SUR LEQUEL VOUS POUVEZ COMPTER

**Des questions?** Des opérateurs sont prêts sur notre ligne d'assistance GRATUITE pour vous aider à l'assemblage et, si nécessaire, remplacer rapidement les pièces endommagées/manquantes. L'assistance est disponible 5 jours par semaine. Ayez simplement votre reçu de magasin, votre manuel d'instruction et le numéro de pièces/description à votre disposition lorsque vous appelez notre ligne d'assistance GRATUITE. C'est aussi simple que ça.

SERVICIO AL CONSUMIDOR CON EL QUE PUEDE CONTAR

**¿Preguntas?** Los operadores están listos para ayudarlo con el ensamblaje a través de una línea de ayuda GRATUITA, y en caso de ser necesario, reemplazar de inmediato las piezas dañadas o faltantes. La asistencia está disponible los 5 días de la semana. Solamente tenga listos su recibo de compra, manual de indicaciones y número/descripción de la pieza al momento de llamarnos a la línea de ayuda GRATUITA. Es así de sencillo.

# IMPORTANT SAFETY INFORMATION



## WARNING

Units must be assembled with the instructions, parts and hardware provided. Improper assembly or use could cause structural failure, instability, tip over, and/or serious injury.

Las unidades deben ser ensambladas de acuerdo a las instrucciones y usando el herraje incluido. El ensamblado incorrecto puede causar un fallo estructural, inestabilidad, o que la unidad se derrumbe, causando posibles heridas personales.

Les unités doivent être assemblées avec les instructions et les matériels donnés. Si vous ne le construisez pas correctement ceci pourrait causer des dommages structureaux, instabilité, se renverser et blesser quelqu'un.



## WARNING

This product is designed and intended for use with computer, fax, and printer equipment only. Improper loading with television or other heavy equipment could cause instability, tip over, and/or serious injury.

Este producto está diseñado solamente para el uso con computadores, faxes, e impresoras. Inapropiado uso al poner televisores u otro equipo pesado puede causar inestabilidad, rodamiento, y/o herida (golpes) serios.

Ce produit est uniquement conçu pour une utilisation avec un ordinateur, un télécopieur, ou une imprimante. Un chargement incorrect avec une télévision ou autre matériel lourd peut le rendre instable ou le renverser, et peut vous causer des endommagements sérieux.



## WARNING

Do not move unit when loaded. Doing so could cause instability, product collapse, tip over, and/or serious injury.

No mueva la unidad cuando esté cargada. Hacerlo puede causar inestabilidad, que el producto se derrumbe, que se la caiga encima y/o heridas (golpes) serias.

Ne pas déplacer l'unité lorsqu'elle est chargée. Faire ainsi peut causer l'instabilité, l'effondrement ou le renversement du meuble et/ou des endommagements sérieux.

**MAXIMUM RECOMMENDED WEIGHT LOADS**

---

**MAXIMUM WEIGHT: 200 LBS (90.72 KG)**  
**PESO MÁXIMO: 200 LIBRAS (90.72 KILOGRAMO)**  
**POIDS MAXIMUM: 200 LIVRES (90.72 KILOGRAMME)**

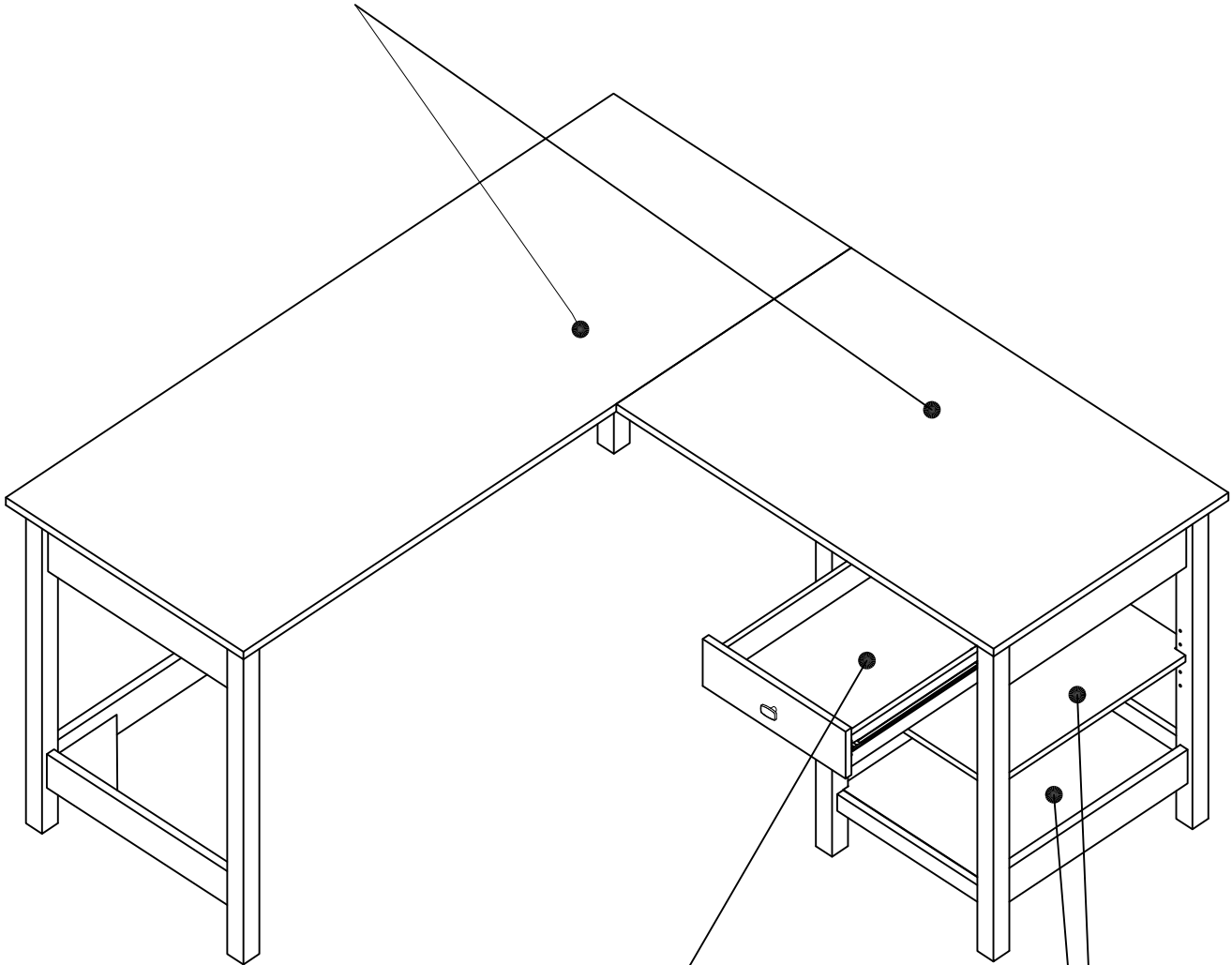

**MAXIMUM WEIGHT: 15 LBS (6.8 KG)**  
**PESO MÁXIMO: 15 LIBRAS (6.8 KILOGRAMO)**  
**POIDS MAXIMUM: 15 LIVRES (6.8 KILOGRAMME)**

**MAXIMUM WEIGHT: 30 LBS (13.61 KG)**  
**PESO MÁXIMO: 30 LIBRAS (13.61 KILOGRAMO)**  
**POIDS MAXIMUM: 30 LIVRES (13.61 KILOGRAMME)**

EXPLODED VIEW

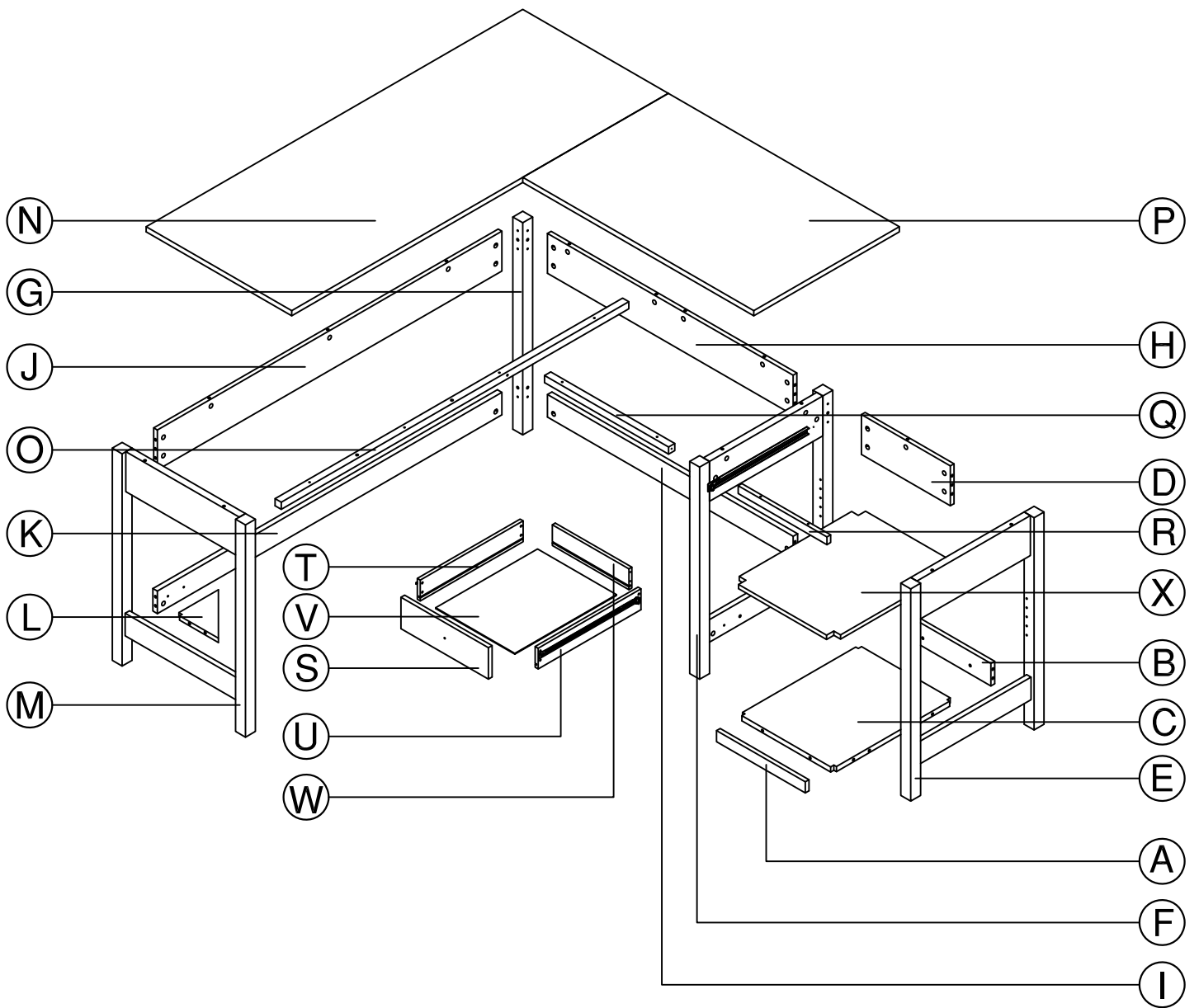
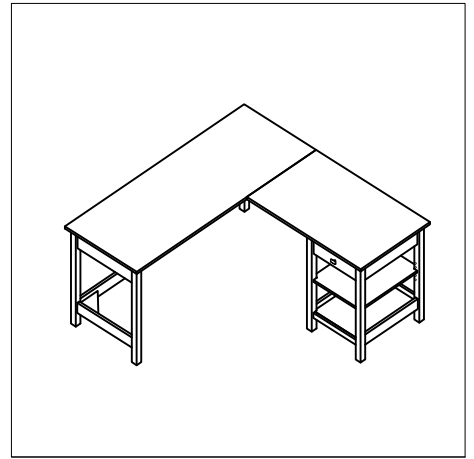

PARTS LIST

---

A [1]	W190534	I [1]	W190542	Q [1]	W190550
B [1]	W190535	J [1]	W190543	R [1]	W190551
C [1]	W190536	K [1]	W190544	S [1]	W190552
D [1]	W190537	L [1]	W190545	T [1]	S190553
E [1]	S190538	M [1]	S190546	U [1]	S190554
F [1]	S190539	N [1]	W190547	V [1]	W190555
G [1]	W190540	O [1]	W190548	W [1]	W190556
H [1]	W190541	P [1]	W190549	X [1]	W190557

A [1]	W190534	I [1]	W190542	Q [1]	W202505
B [1]	W190535	J [1]	W190543	R [1]	W202506
C [1]	W190536	K [1]	W190544	S [1]	W190552
D [1]	W190537	L [1]	W190545	T [1]	S190553
E [1]	S202500	M [1]	S202503	U [1]	S190554
F [1]	S202501	N [1]	W190499	V [1]	W190555
G [1]	W202502	O [1]	W202504	W [1]	W190556
H [1]	W190541	P [1]	W190500	X [1]	W190557

# FASTENERS

---

Fasteners are shown in actual size.

Los fijadores son demostrados en su tamaño actual.

Les attaches sont montrées dans l'échelle grandeur.

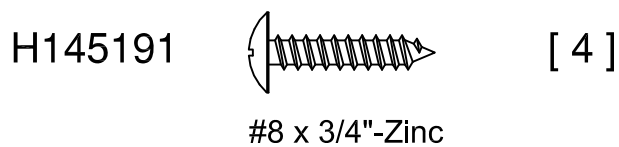
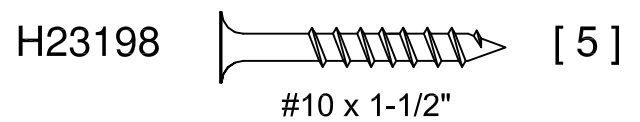
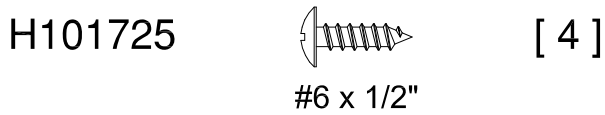
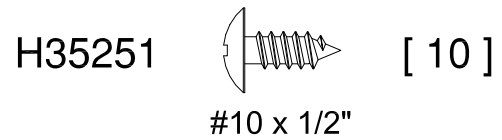
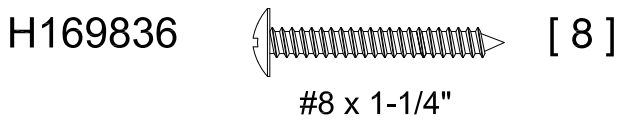
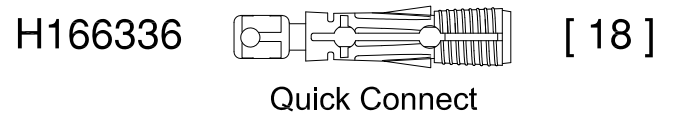
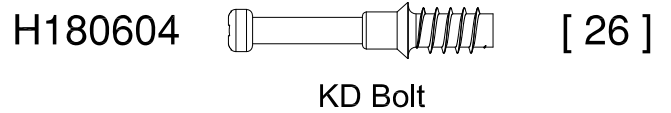
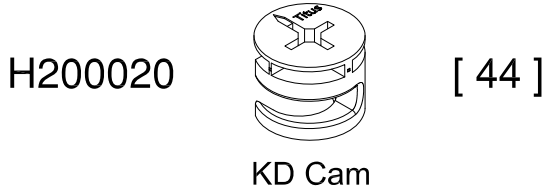

# HARDWARE

---

H193459

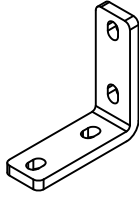

[ 1 ]

L Bracket

H39922

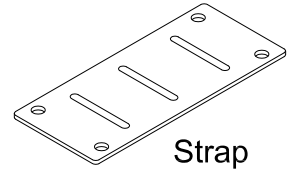

[ 2 ]

Strap

H23604

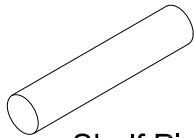

[ 4 ]

Shelf Pin

H100444

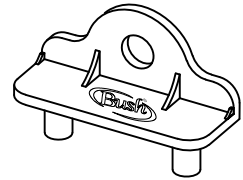

[ 2 ]

Drawer Bracket

H200135

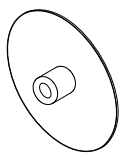

[ 21 ]

Cover Cap

H126396

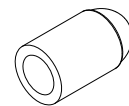

[ 4 ]

Shelf Pin Sleeve

H200136

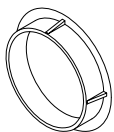

[ 4 ]

Hole Plug

HARDWARE

---

H175335

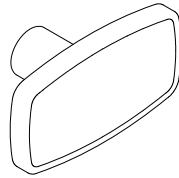

[ 1 ]

Handle

H160460

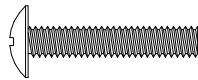

[ 1 ]

M4 x 22mm

H174929

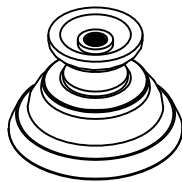

[ 1 ]

Pull

H174930



[ 1 ]

Knob Cap

H157181



[ 1 ]

#8-32 x 1-1/8"

PRE-ASSEMBLED COMPONENTS

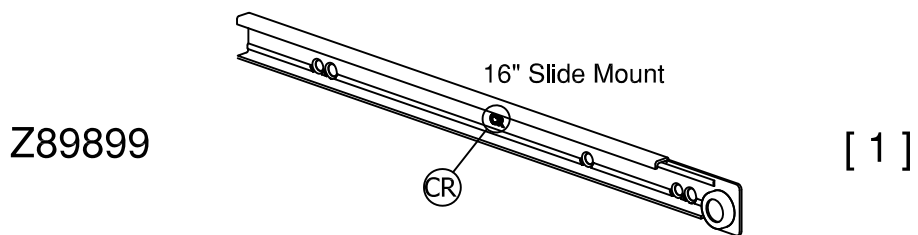
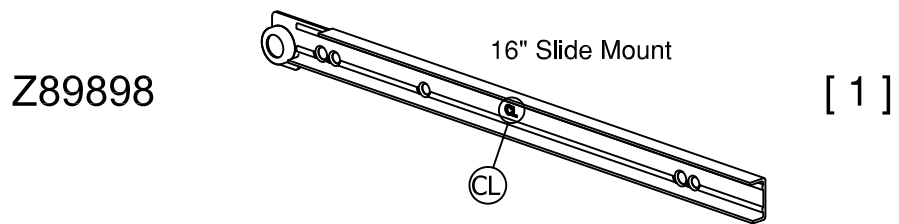
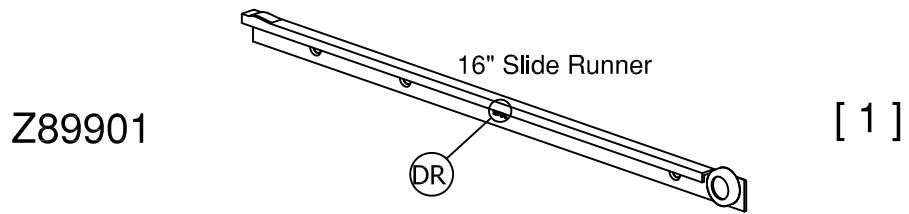
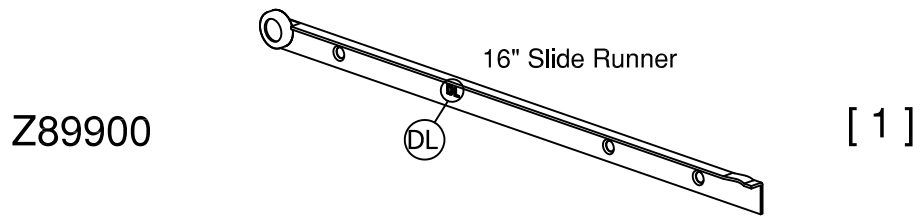

H124395



#6 x 1/2"

[ 12 ]

STEP 1

H38169



[ 6 ]

Wood Dowel 8 x 30mm

H166336

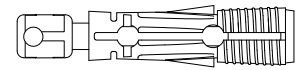

[ 4 ]

Quick Connect

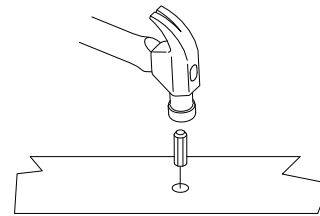
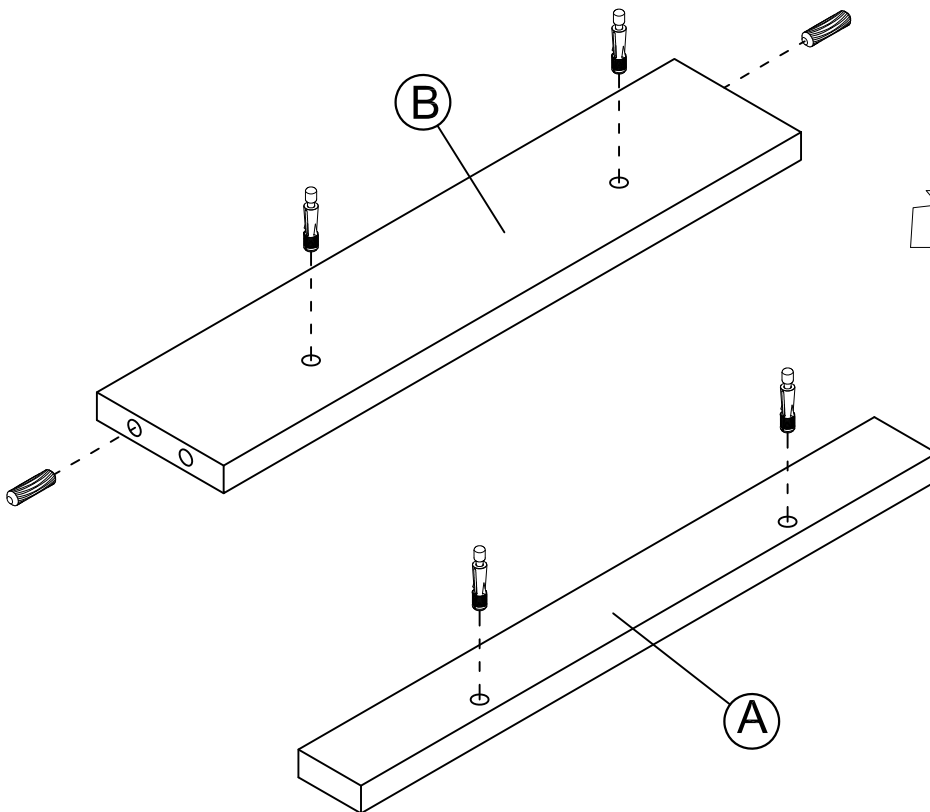
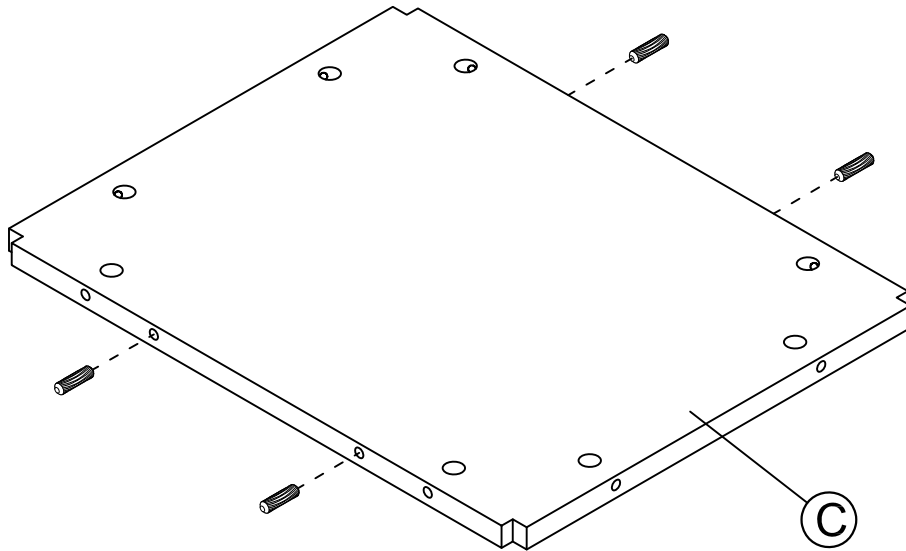

Safety glasses  
Gafas de seguridad  
Lunettes de protection

STEP 2

H200020

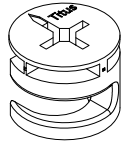

KD Cam

[ 4 ]

Push the KD cam all the way into the hole before tightening.  
Empujar la leva KD hasta el final en el agujero antes de apretar.  
Pousser la came de KD tout le chemin dans le trou avant de serrer.

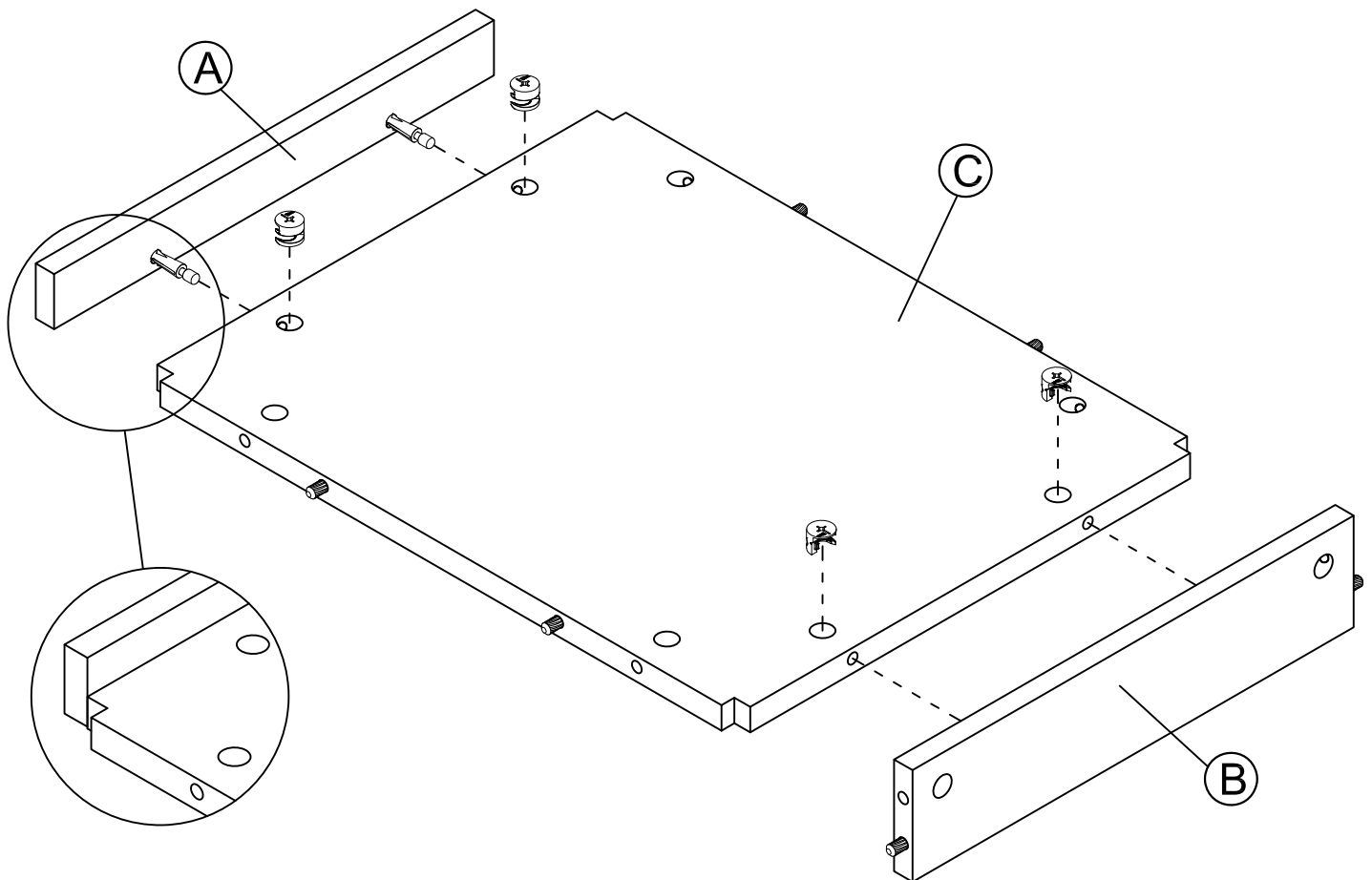
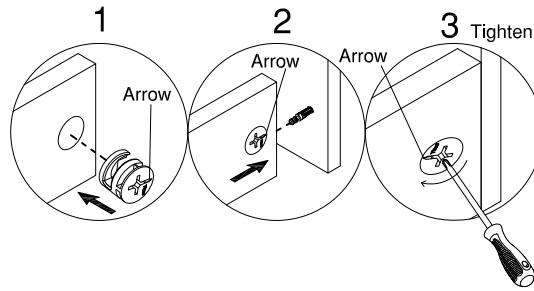

STEP 3

H38169



[ 2 ]

Wood Dowel 8 x 30mm

H180604

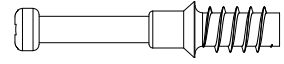

[ 5 ]

KD Bolt

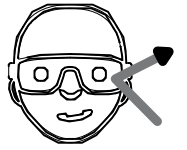
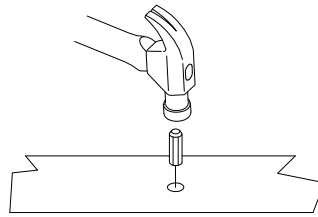
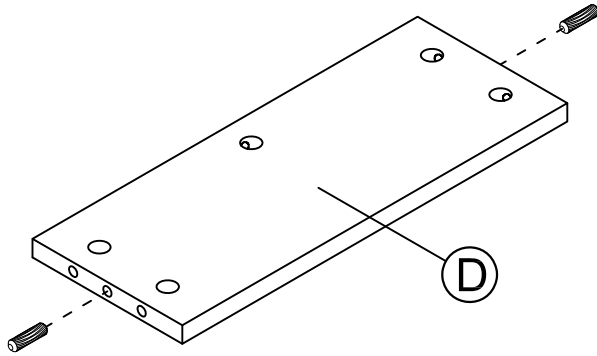

Safety glasses  
Gafas de seguridad  
Lunettes de protection

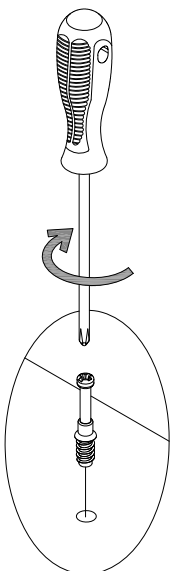
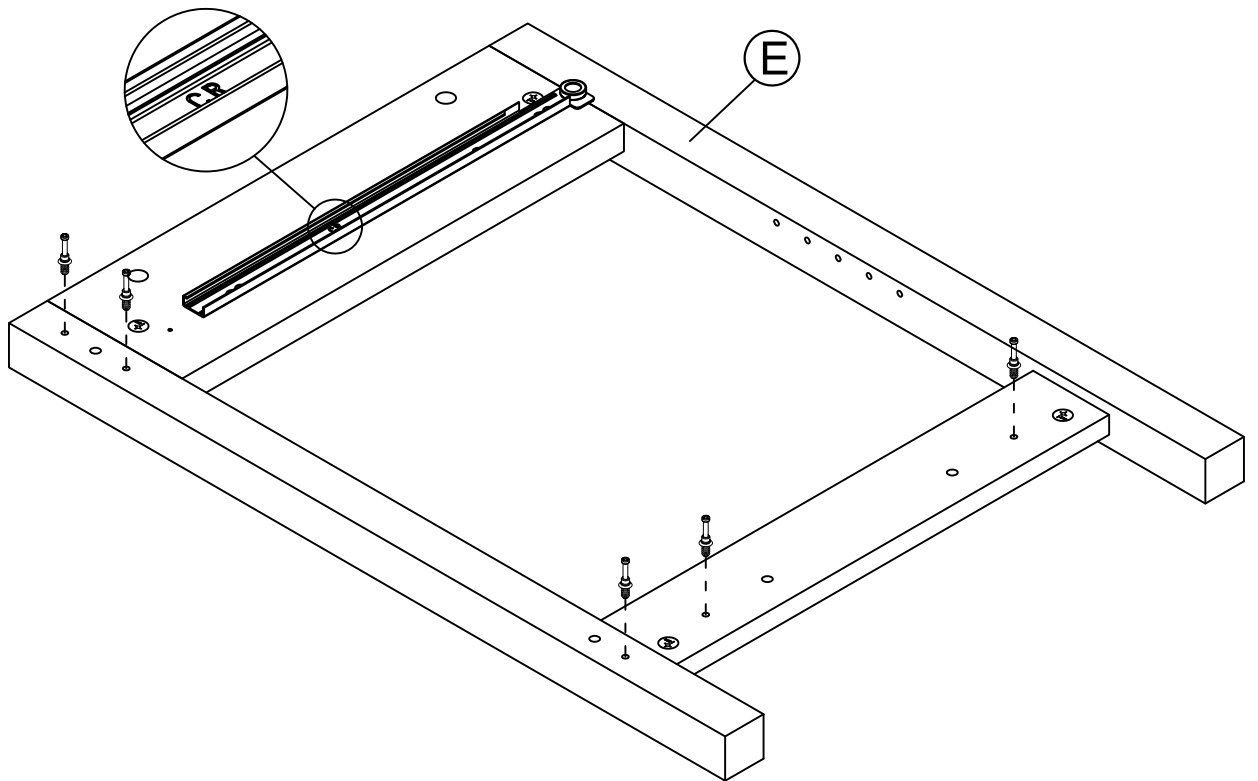

STEP 4

H200020

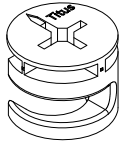

KD Cam

[ 4 ]

Push the KD cam all the way into the hole before tightening.  
Empujar la leva KD hasta el final en el agujero antes de apretar.  
Pousser la came de KD tout le chemin dans le trou avant de serrer.

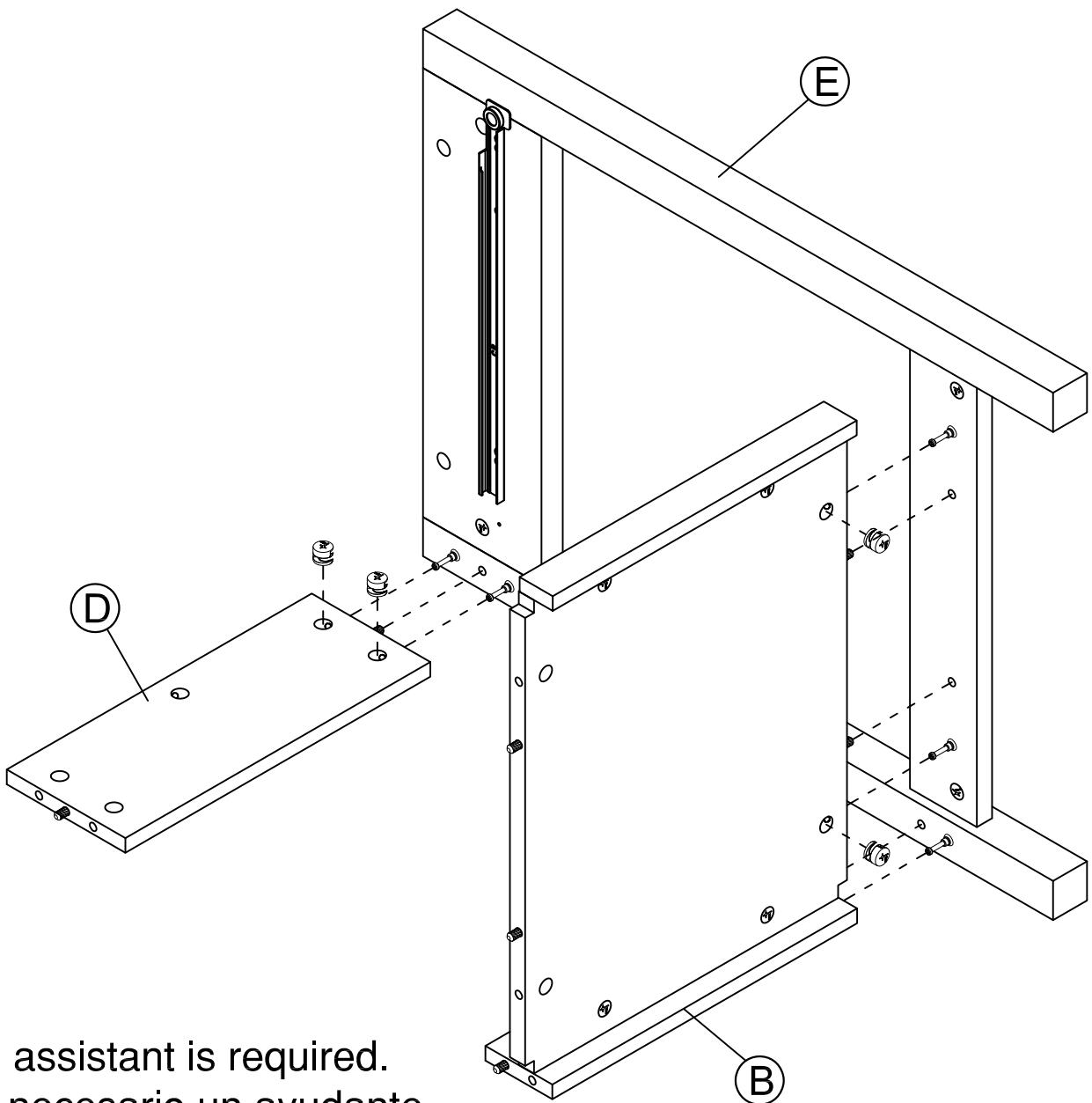
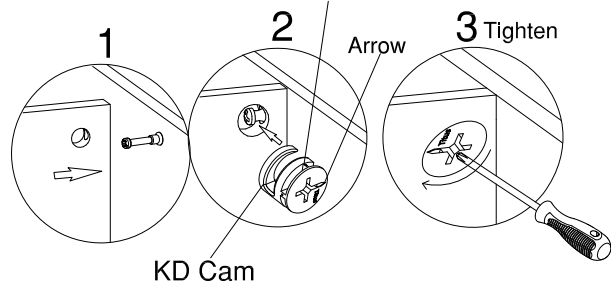

An assistant is required.  
Es necesario un ayudante.  
Un assistant est nécessaire.

STEP 5

H180604

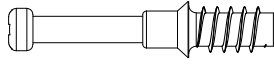

[ 8 ]

KD Bolt

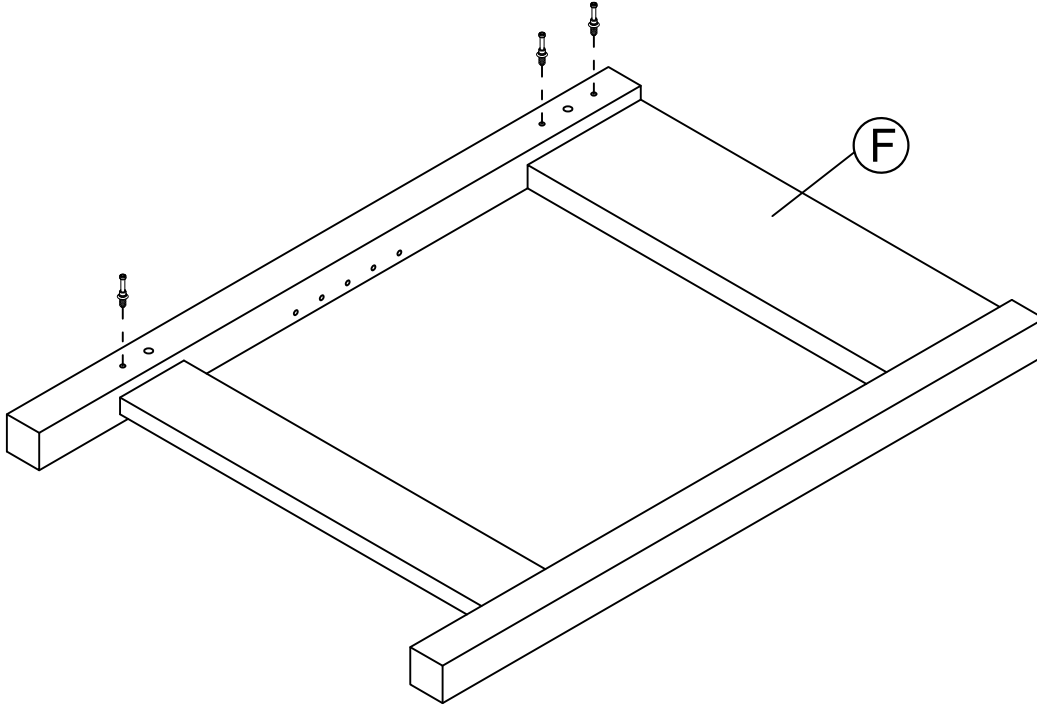

Flip F part over  
Voltear F parte sobre  
Retourner la partie F

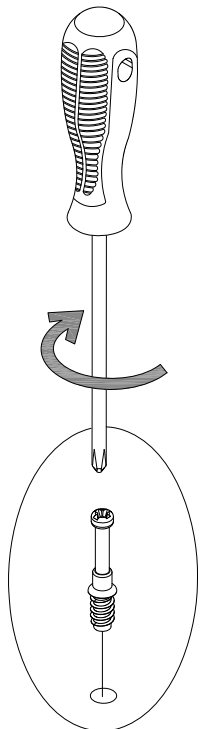
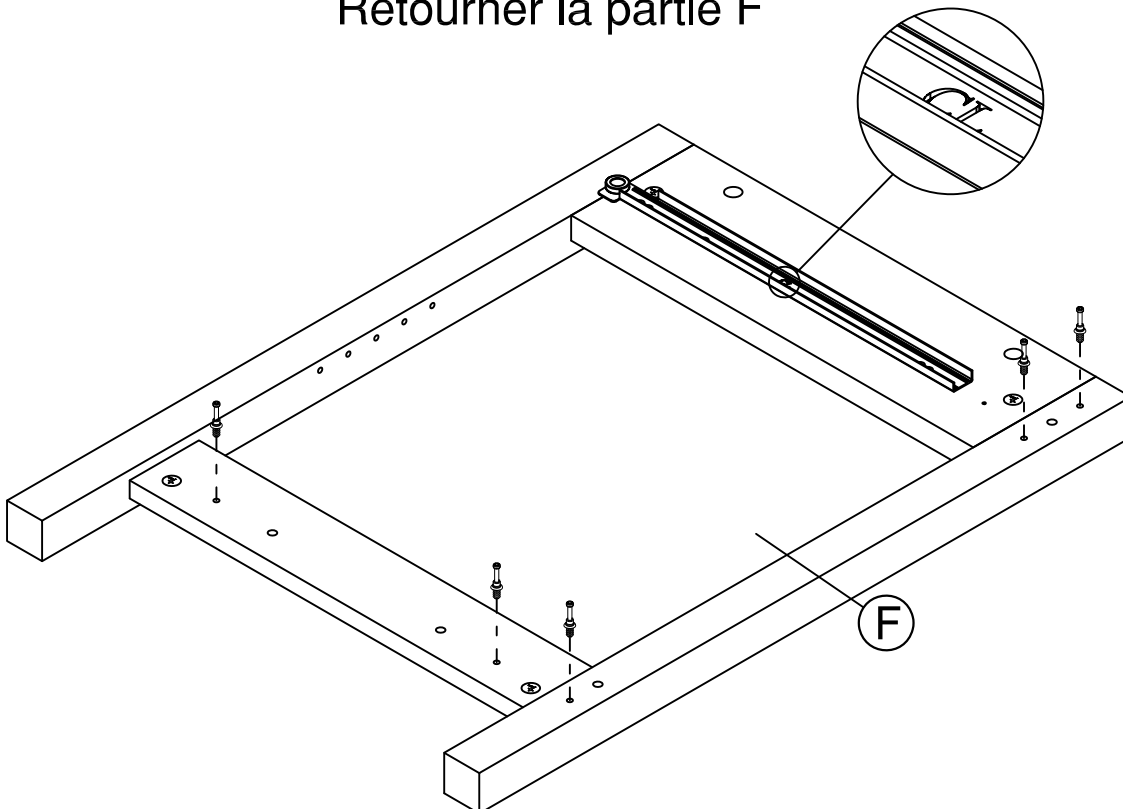

STEP 6

H200020

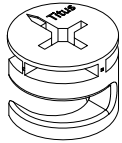

[ 4 ]

KD Cam

Push the KD cam all the way into the hole before tightening.  
Empujar la leva KD hasta el final en el agujero antes de apretar.  
Pousser la came de KD tout le chemin dans le trou avant de serrer.

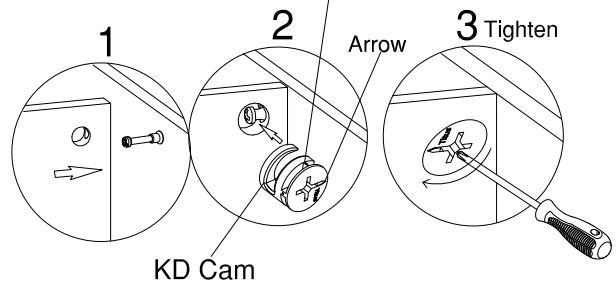

An assistant is required.  
Es necesario un ayudante.  
Un assistant est nécessaire.

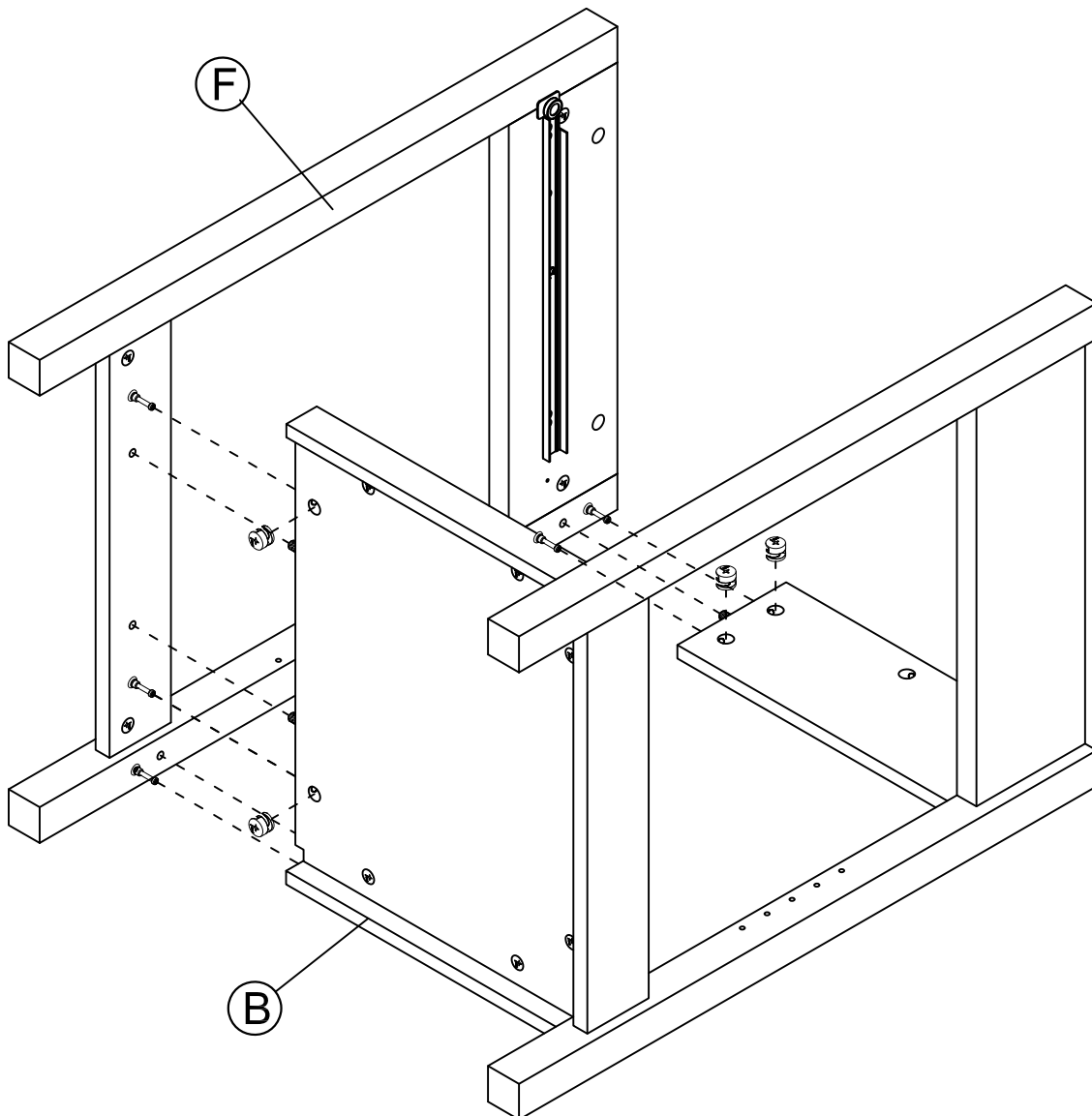

STEP 7

H200020

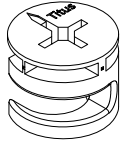

KD Cam

[ 2 ]

H200135

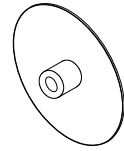

Cover Cap

[ 2 ]

Push the KD cam all the way into the hole before tightening.  
Empujar la leva KD hasta el final en el agujero antes de apretar.  
Pousser la came de KD tout le chemin dans le trou avant de serrer.

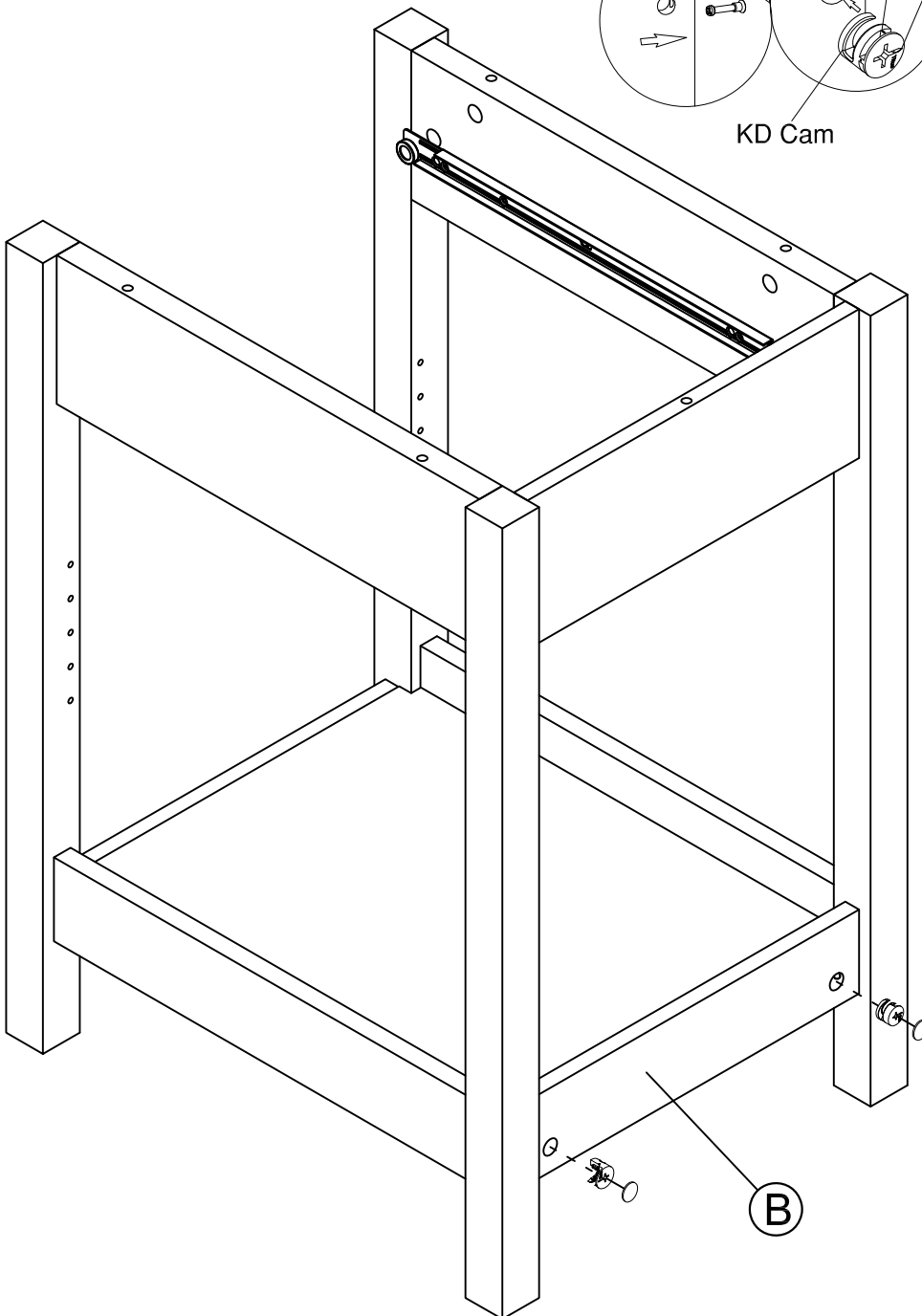
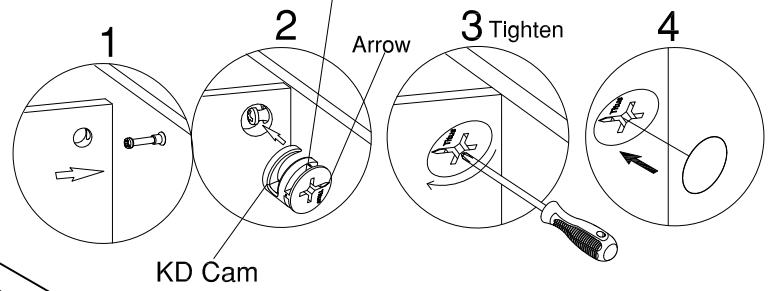

STEP 8

H180604

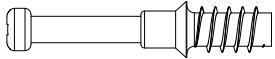

[ 6 ]

KD Bolt

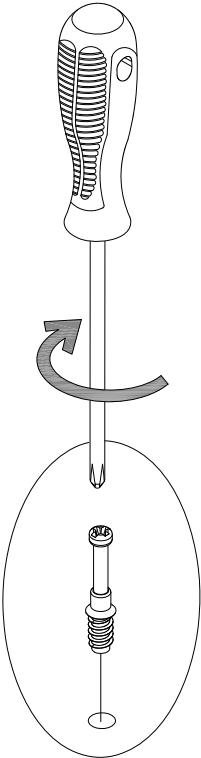
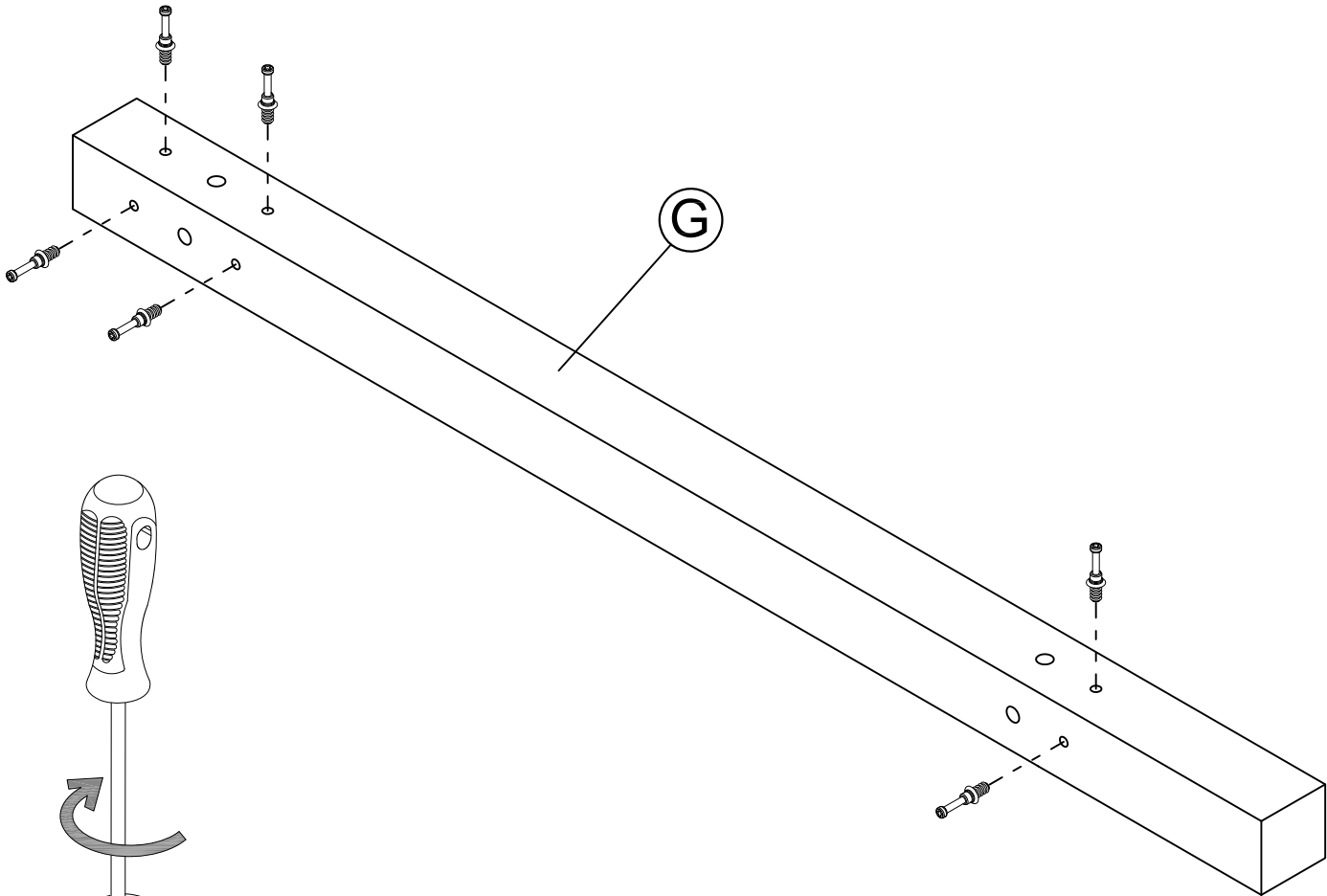

STEP 9

H38169



[ 4 ]

Wood Dowel 8 x 30mm

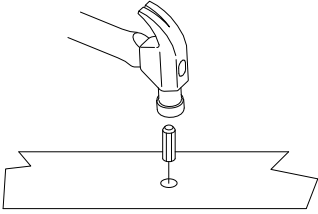

Safety glasses  
Gafas de seguridad  
Lunettes de protection

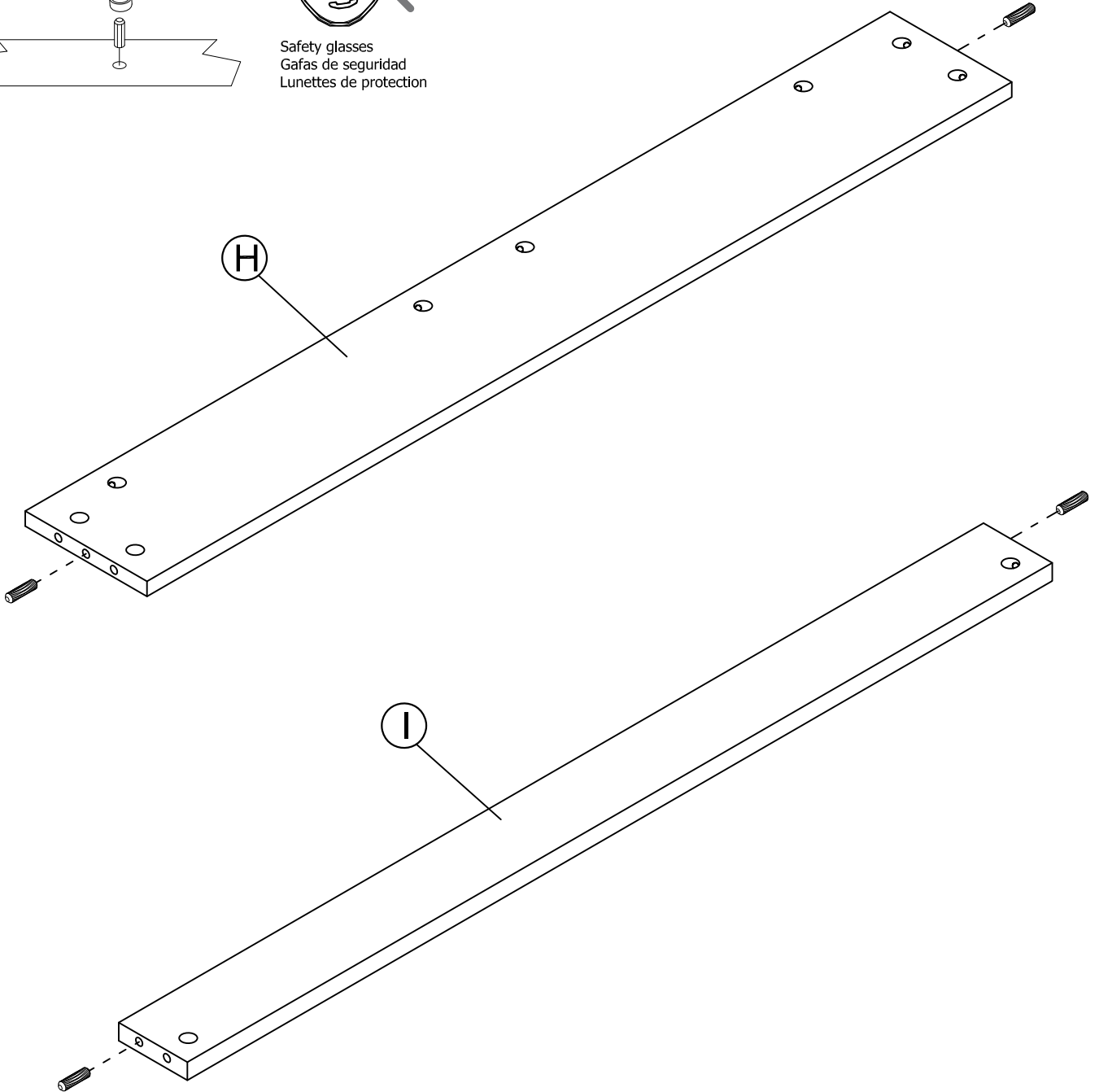

# STEP 10

H200020

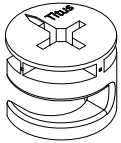

KD Cam

[ 6 ]

H200135

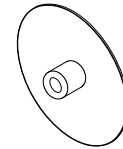

Cover Cap

[ 6 ]

Push the KD cam all the way into the hole before tightening.  
Empujar la leva KD hasta el final en el agujero antes de apretar.  
Pousser la came de KD tout le chemin dans le trou avant de serrer.

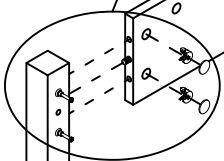
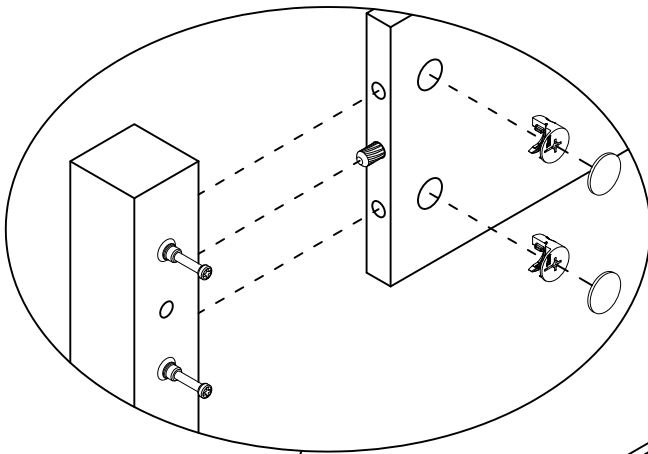
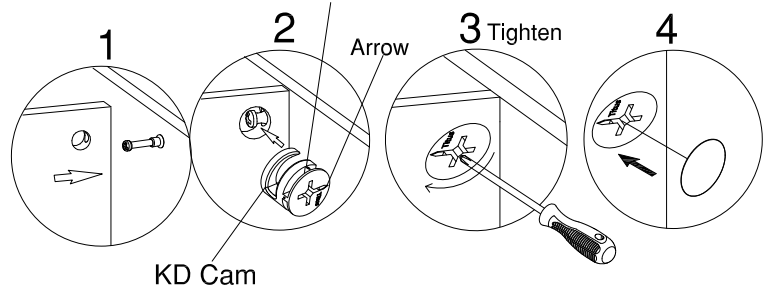

H

I

G

F

An assistant is required.  
Es necesario un ayudante.  
Un assistant est nécessaire.

# STEP 11

H38169

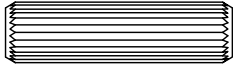

[ 4 ]

Wood Dowel 8 x 30mm

H180604

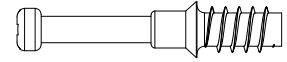

[ 2 ]

KD Bolt

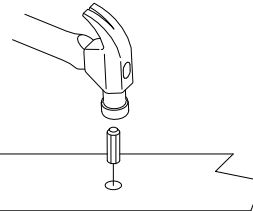

Safety glasses  
Gafas de seguridad  
Lunettes de protection

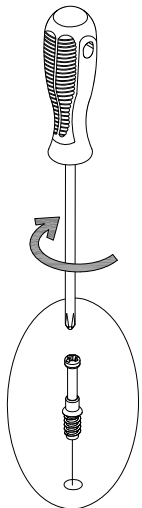
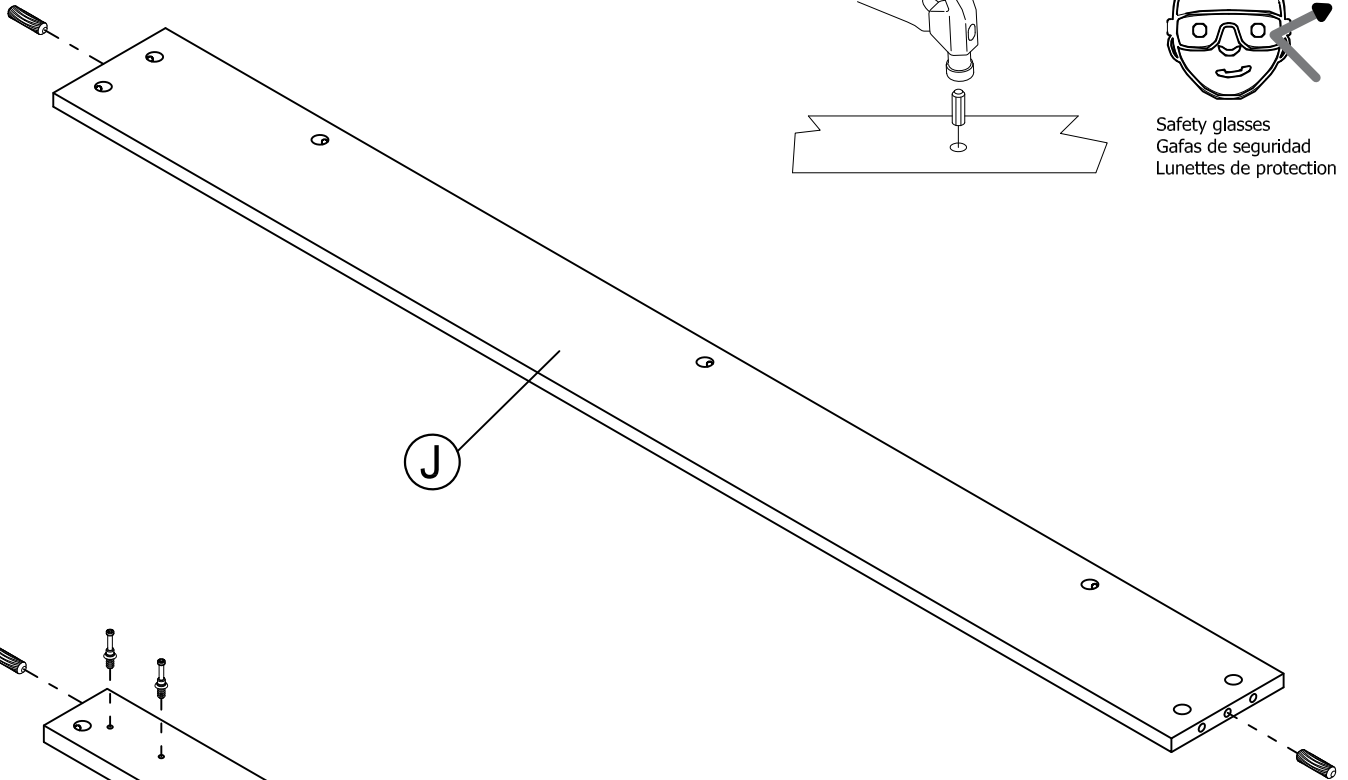

# STEP 12

H200020 [ 2 ]  
KD Cam  
KD Cam

H180604 [ 5 ]  
KD Bolt  
KD Bolt

H200135 [ 1 ]  
Cover Cap  
Cover Cap

H200136 [ 2 ]  
Hole Plug  
Hole Plug

Push the KD cam all the way into the hole before tightening.  
Empujar la leva KD hasta el final en el agujero antes de apretar.  
Pousser la came de KD tout le chemin dans le trou avant de serrer.

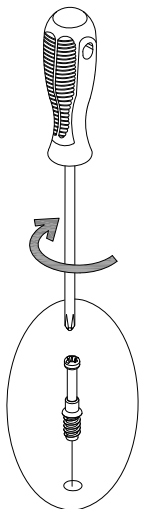
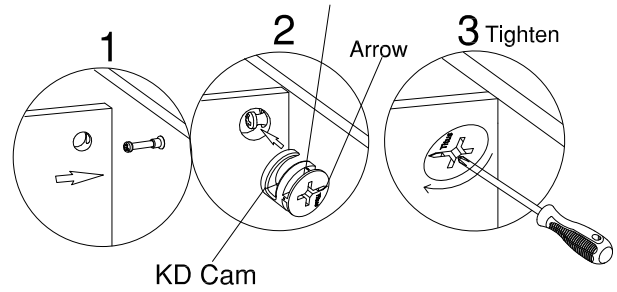
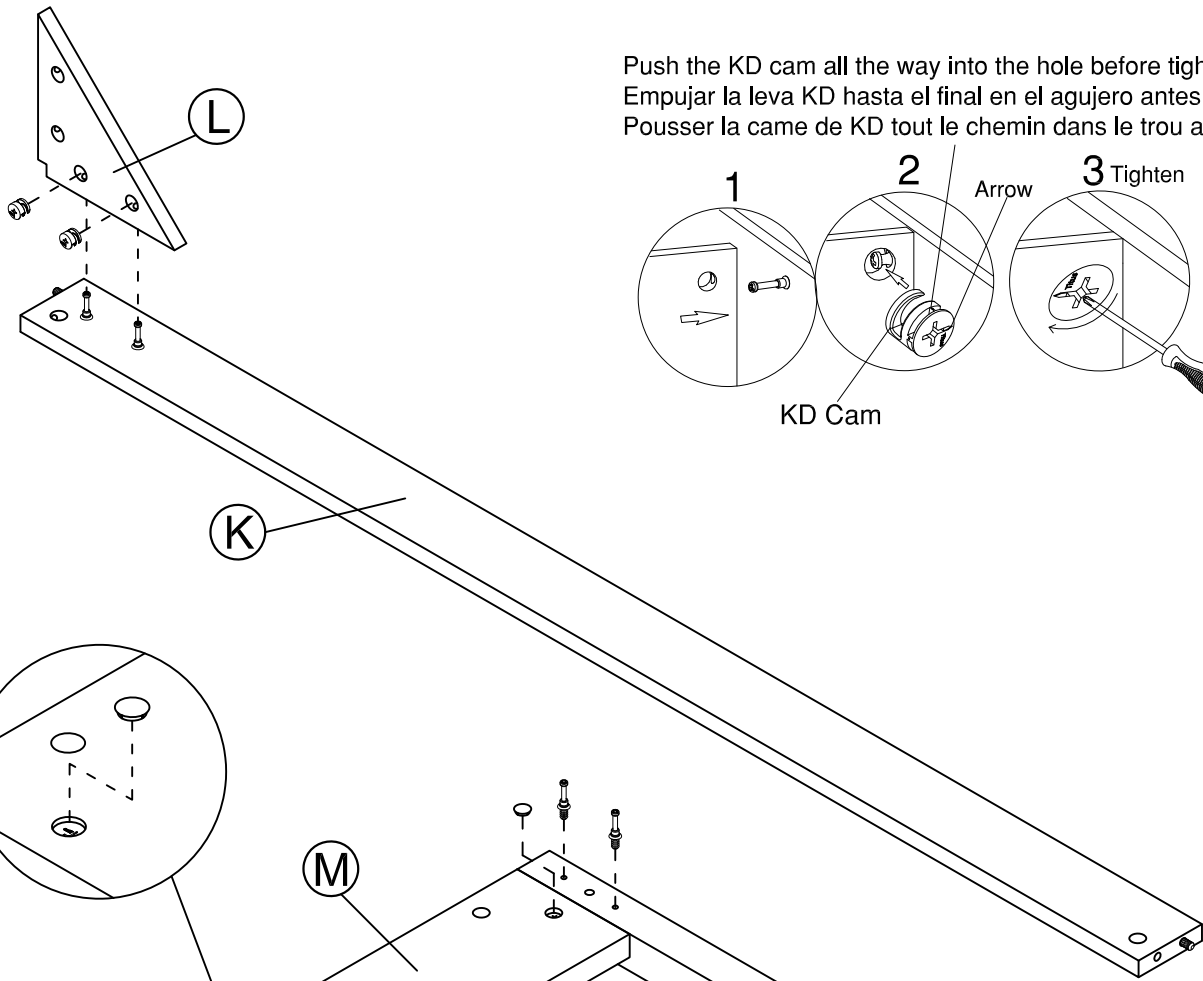

H200135

STEP 13

H200020

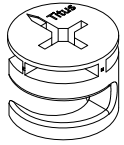

[ 5 ]

KD Cam

H200135

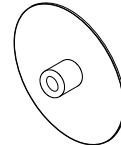

[ 2 ]

Cover Cap

Push the KD cam all the way into the hole before tightening.  
Empujar la leva KD hasta el final en el agujero antes de apretar.  
Pousser la came de KD tout le chemin dans le trou avant de serrer.

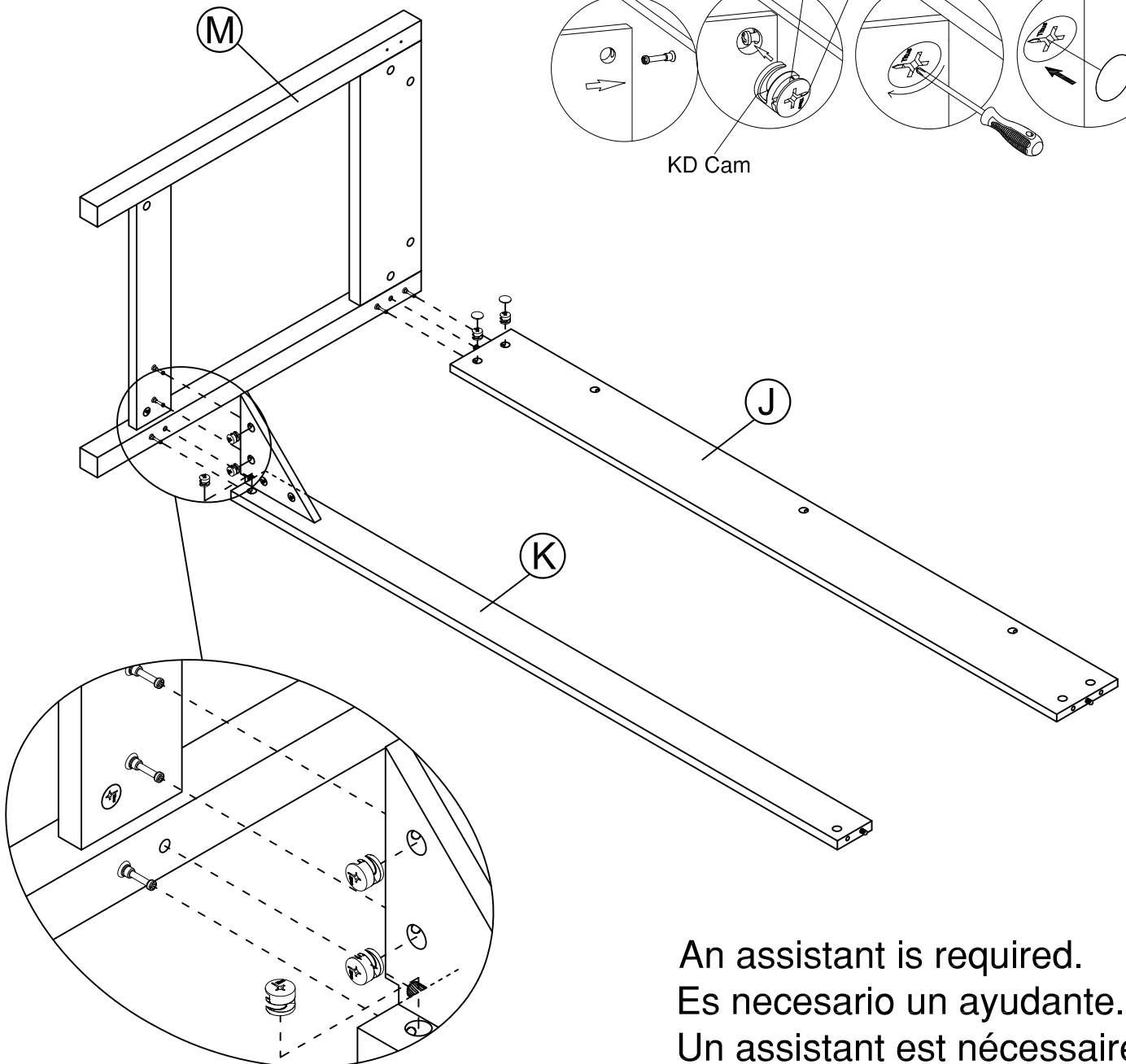
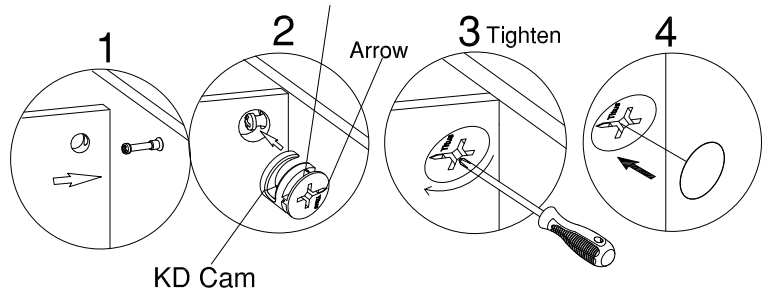

An assistant is required.  
Es necesario un ayudante.  
Un assistant est nécessaire.

## STEP 14

H200020

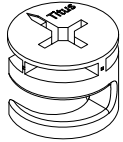

KD Cam

[ 3 ]

H200135

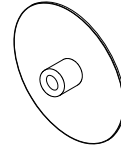

Cover Cap

[ 3 ]

Push the KD cam all the way into the hole before tightening.  
Empujar la leva KD hasta el final en el agujero antes de apretar.  
Pousser la came de KD tout le chemin dans le trou avant de serrer.

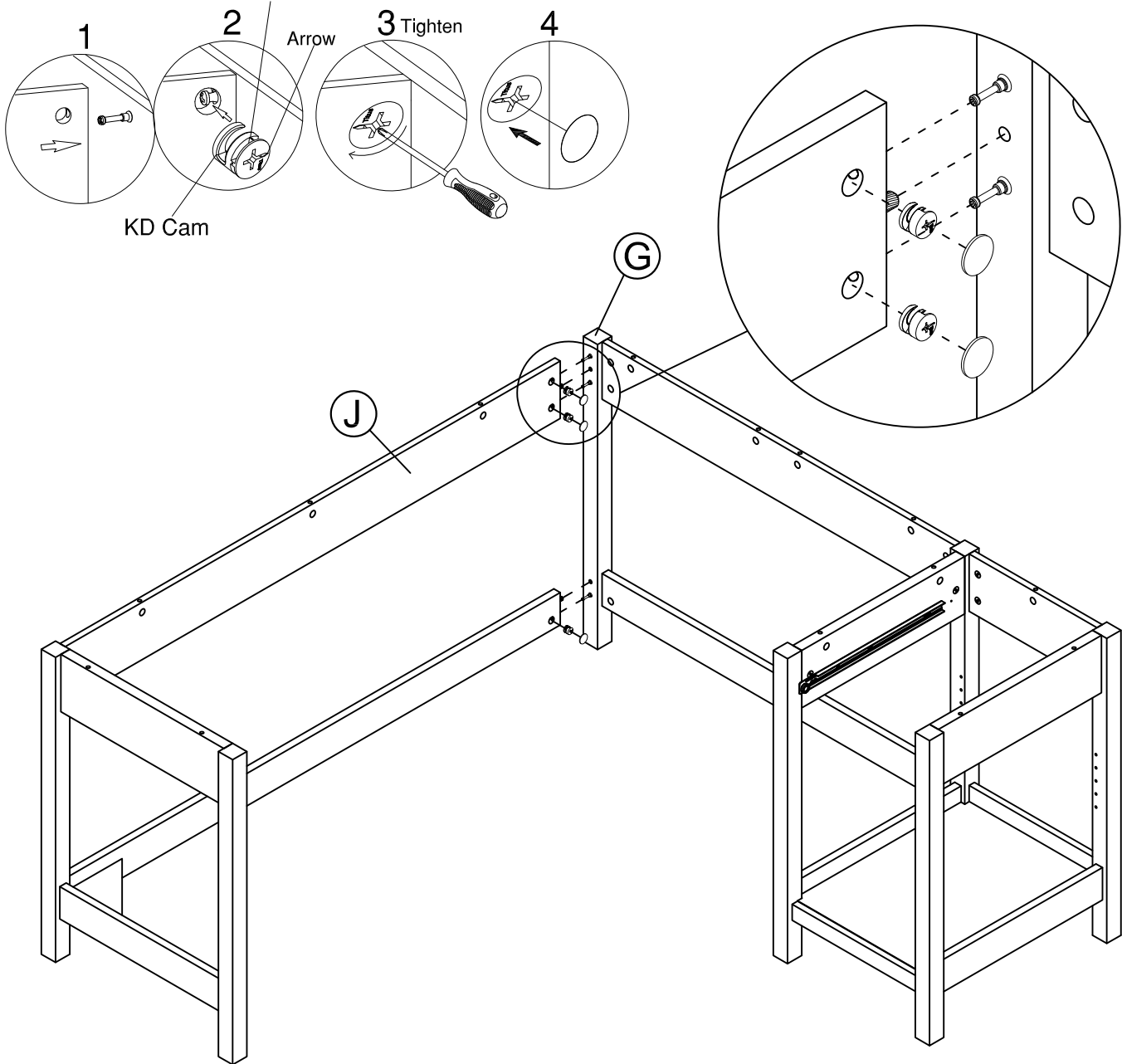

An assistant is required.  
Es necesario un ayudante.  
Un assistant est nécessaire.

STEP 15

H38169

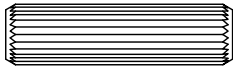

[ 3 ]

Wood Dowel 8 x 30mm

H166336

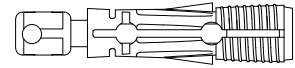

[ 7 ]

Quick Connect

H35251

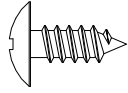

[ 4 ]

#10 x 1/2"

H39922

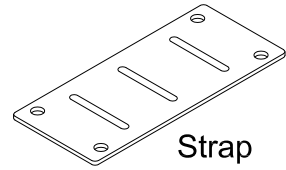

[ 2 ]

Strap

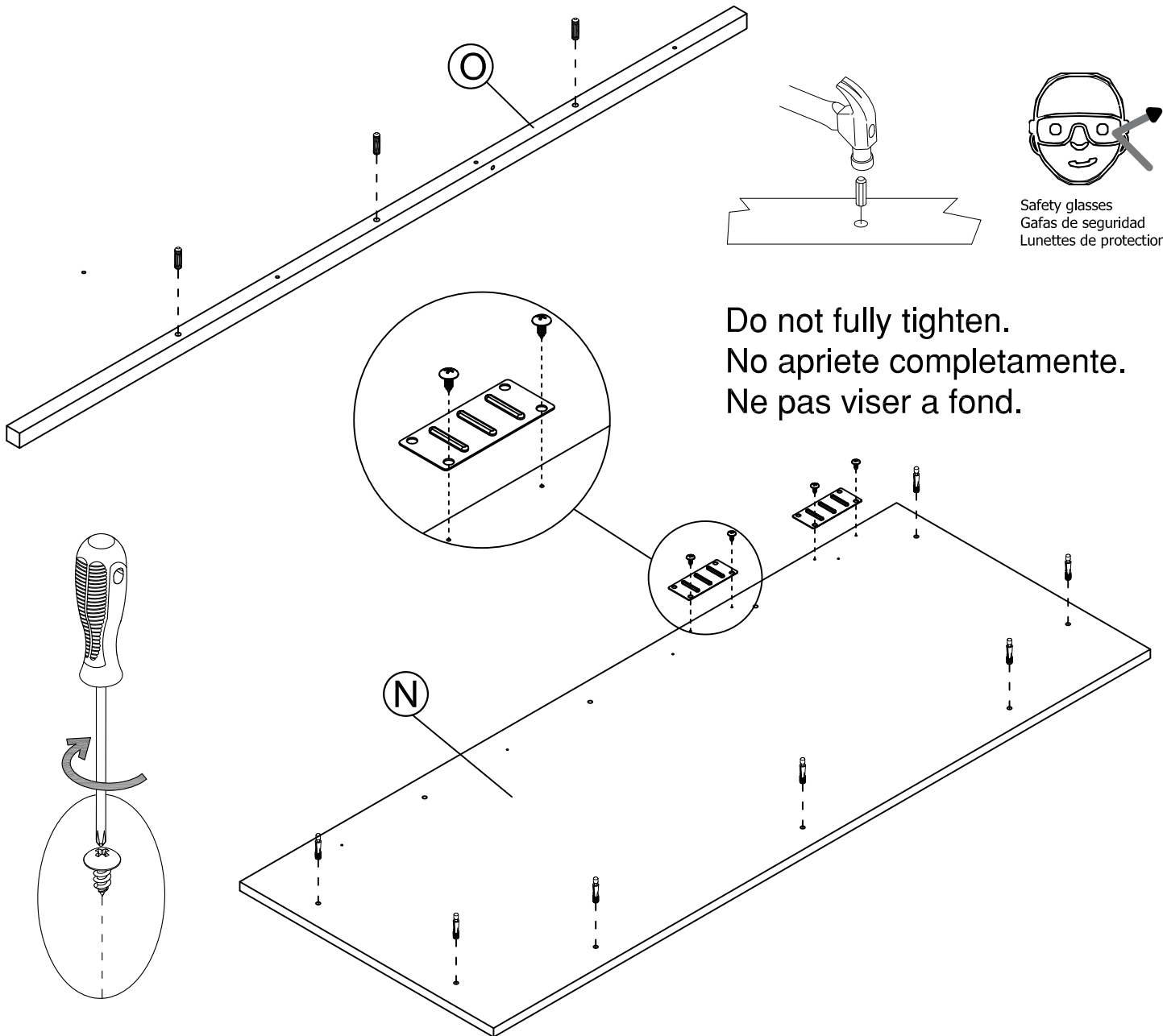

STEP 16

H169836

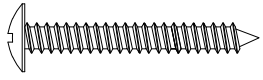

[ 4 ]

#8 x 1-1/4"

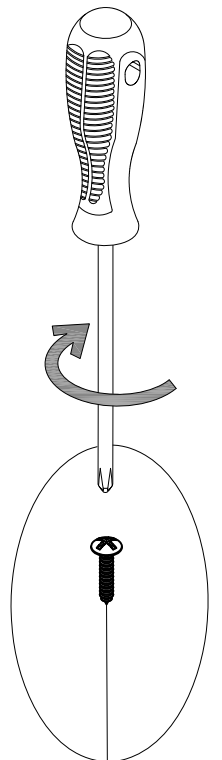
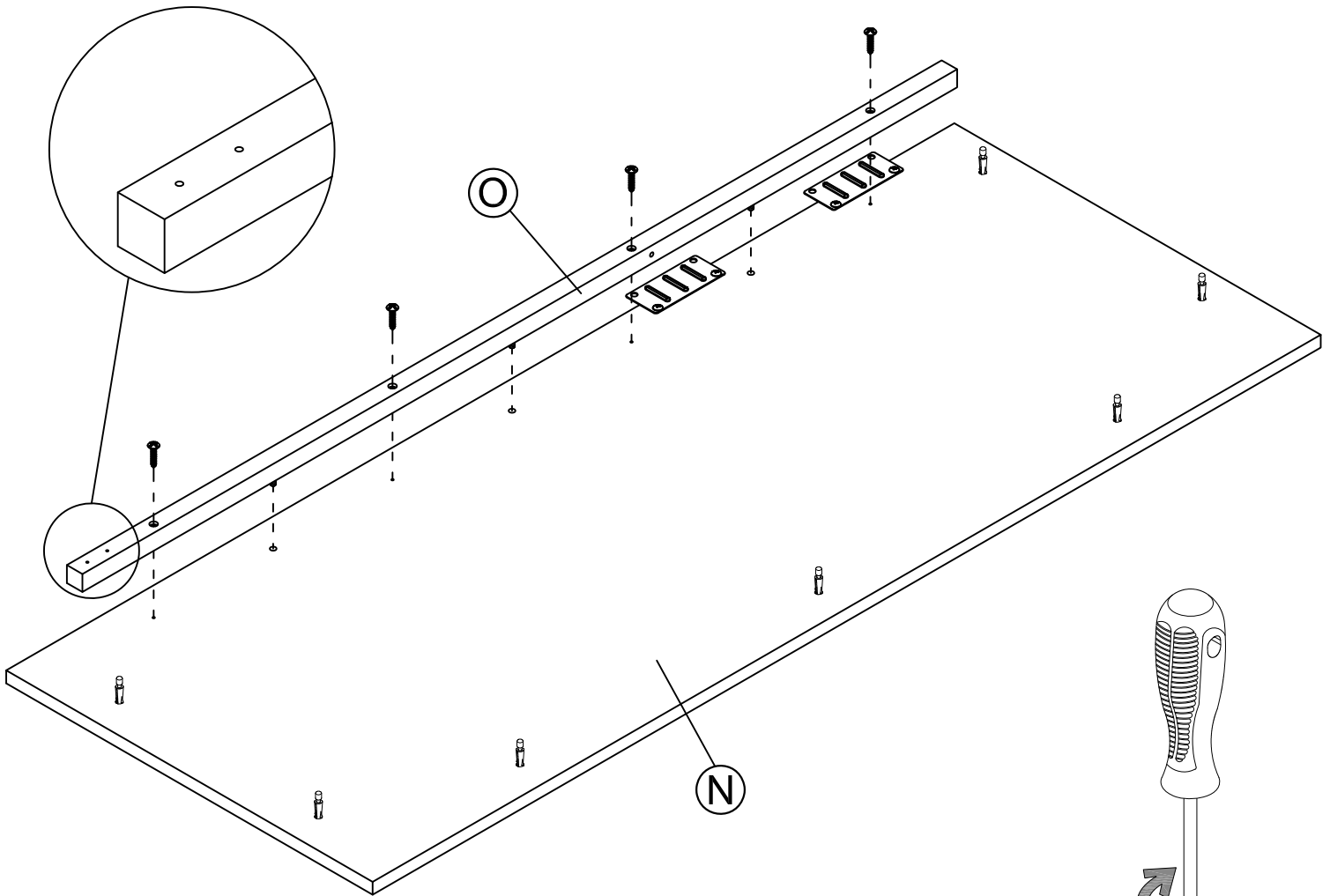

# STEP 17

H200020

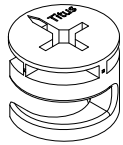

[ 7 ]

KD Cam

H200135

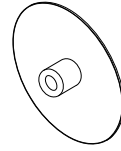

[ 5 ]

Cover Cap

Push the KD cam all the way into the hole before tightening.  
Empujar la leva KD hasta el final en el agujero antes de apretar.  
Pousser la came de KD tout le chemin dans le trou avant de serrer.

H200136



[ 2 ]

Hole Plug

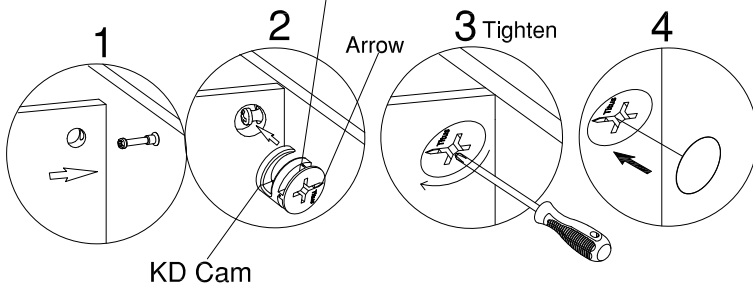

An assistant is required.  
Es necesario un ayudante.  
Un assistant est nécessaire.

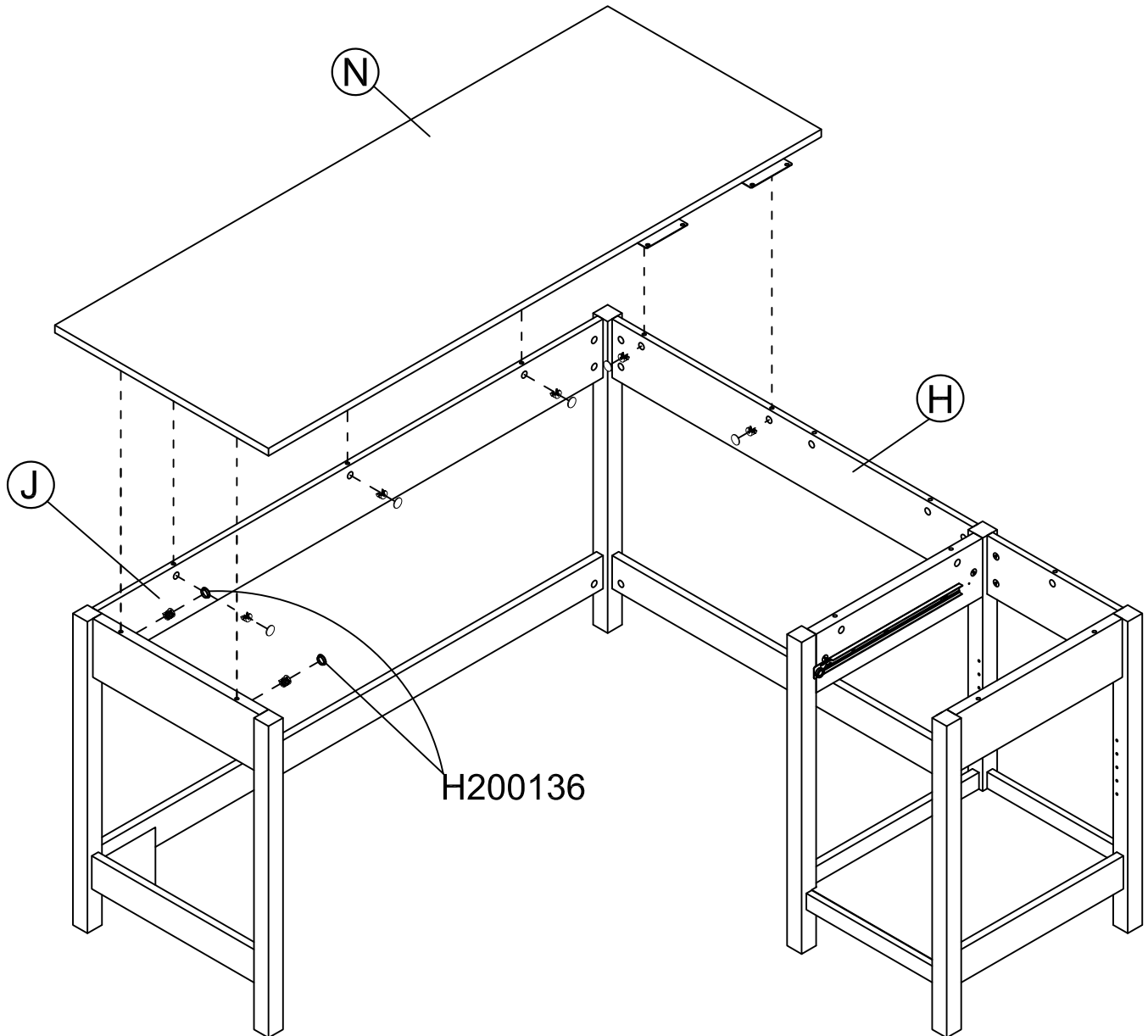



## STEP 19

H200020

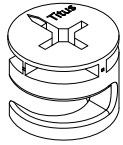

KD Cam

[ 7 ]

H200135

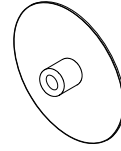

Cover Cap

[ 2 ]

Push the KD cam all the way into the hole before tightening.  
Empujar la leva KD hasta el final en el agujero antes de apretar.  
Pousser la came de KD tout le chemin dans le trou avant de serrer.

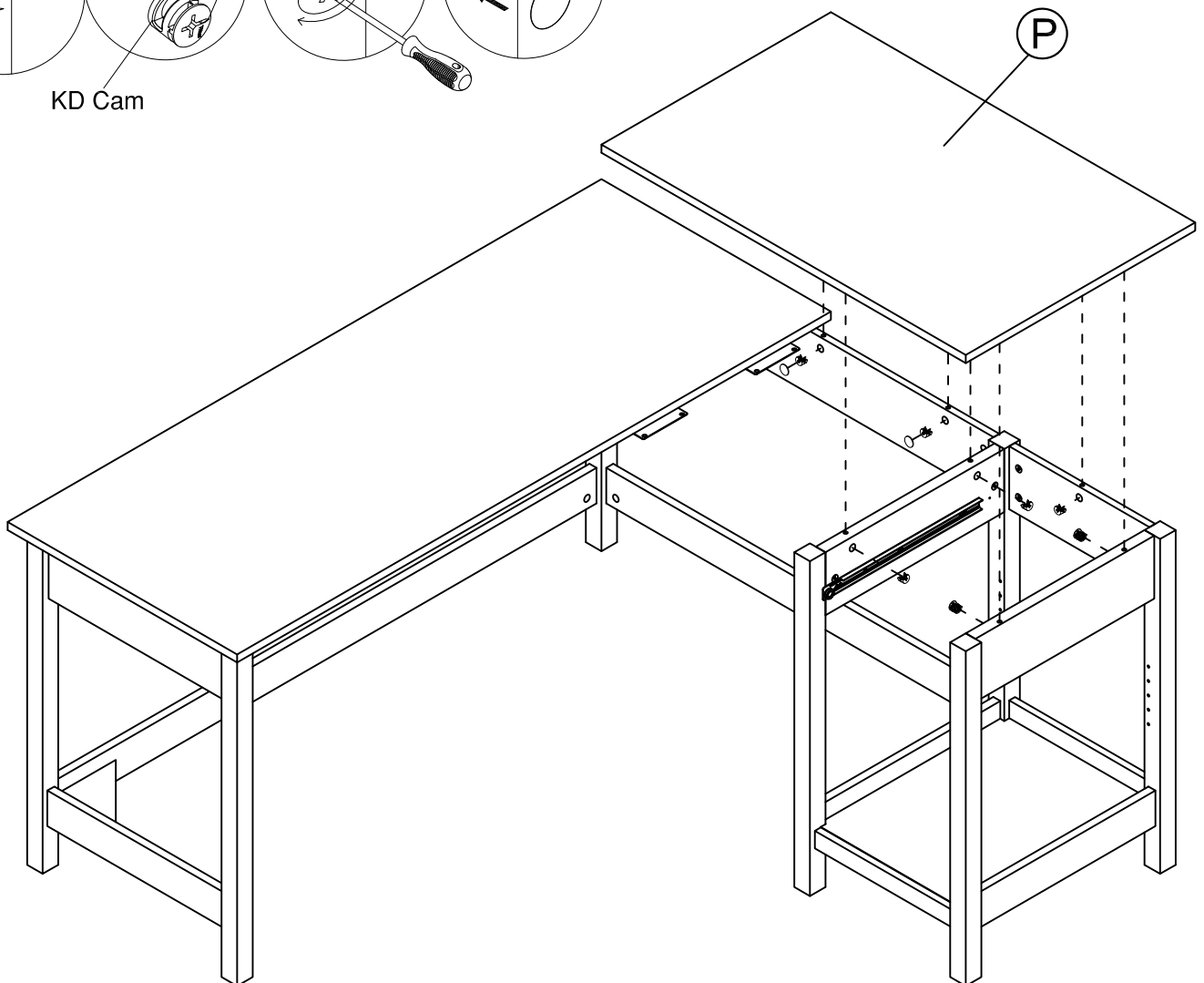
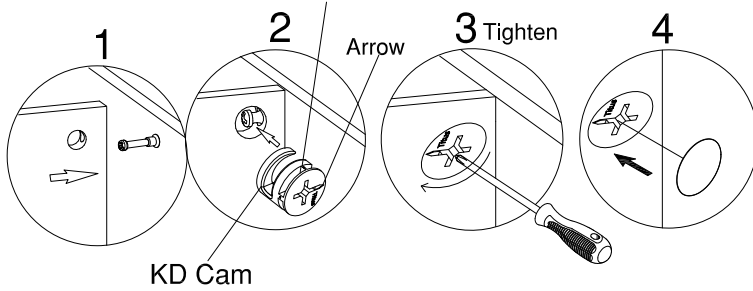

An assistant is required.  
Es necesario un ayudante.  
Un assistant est nécessaire.

STEP 20

H35251

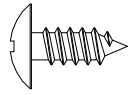

[ 4 ]

#10 x 1/2"

Tighten all screws.  
Apriete todos los tornillos.  
Serrez toutes les vis.

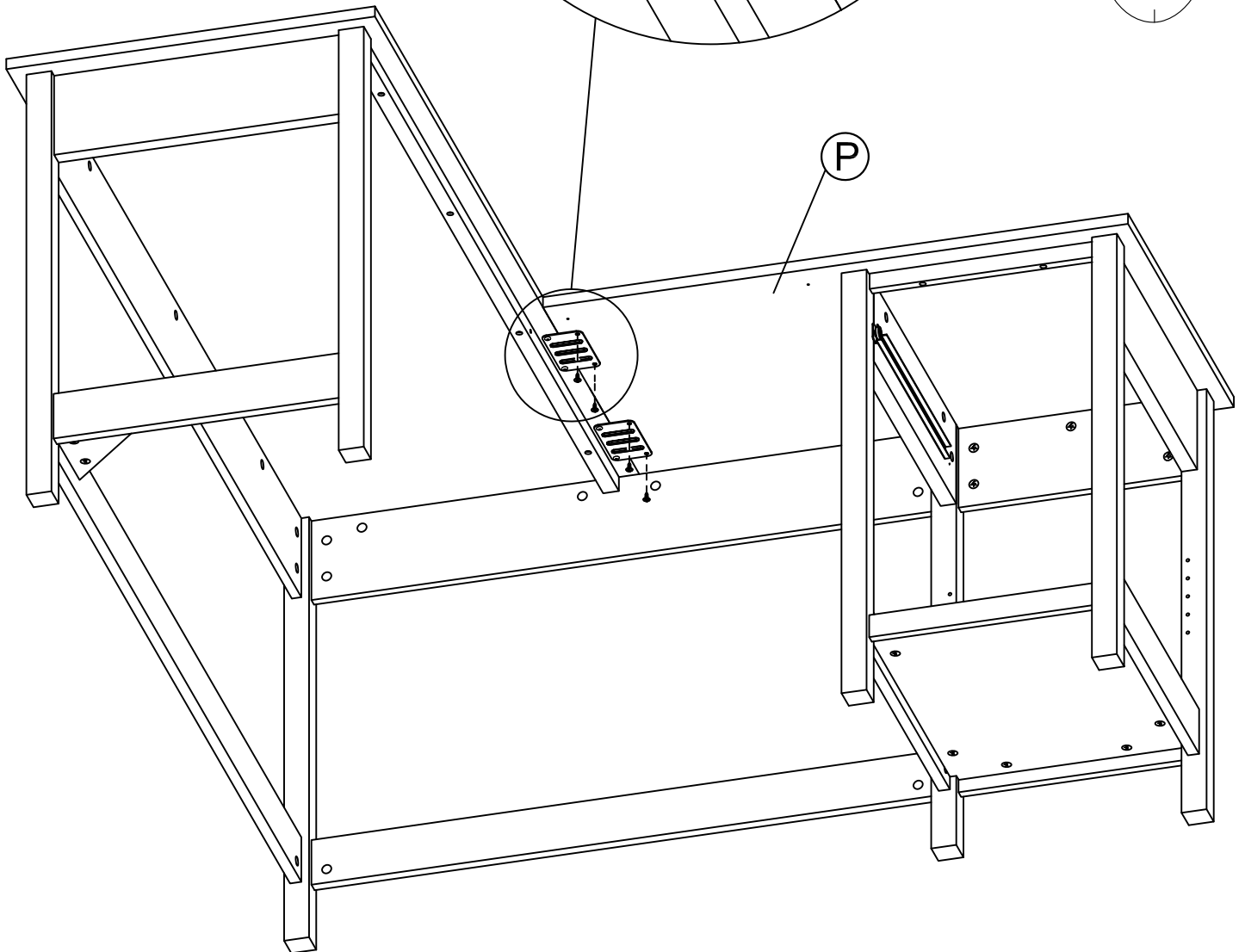
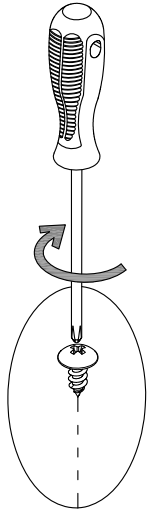
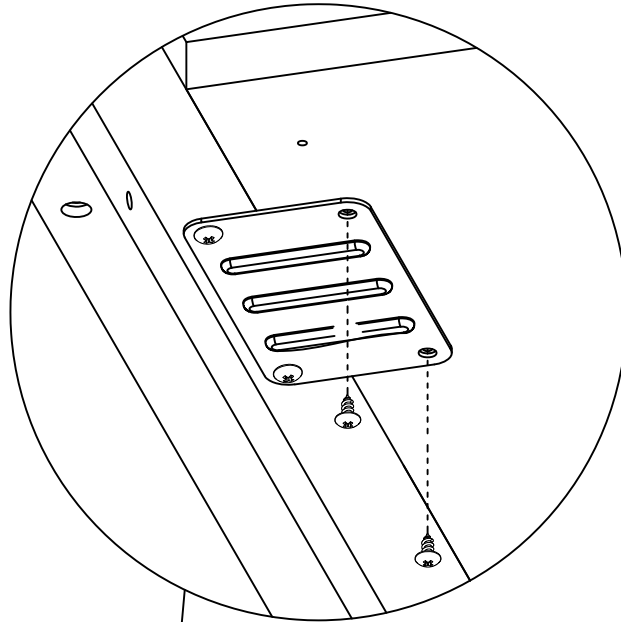

STEP 21

H23198

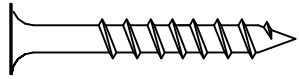

[ 1 ]

#10 x 1-1/2"

H169836

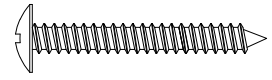

[ 2 ]

#8 x 1-1/4"

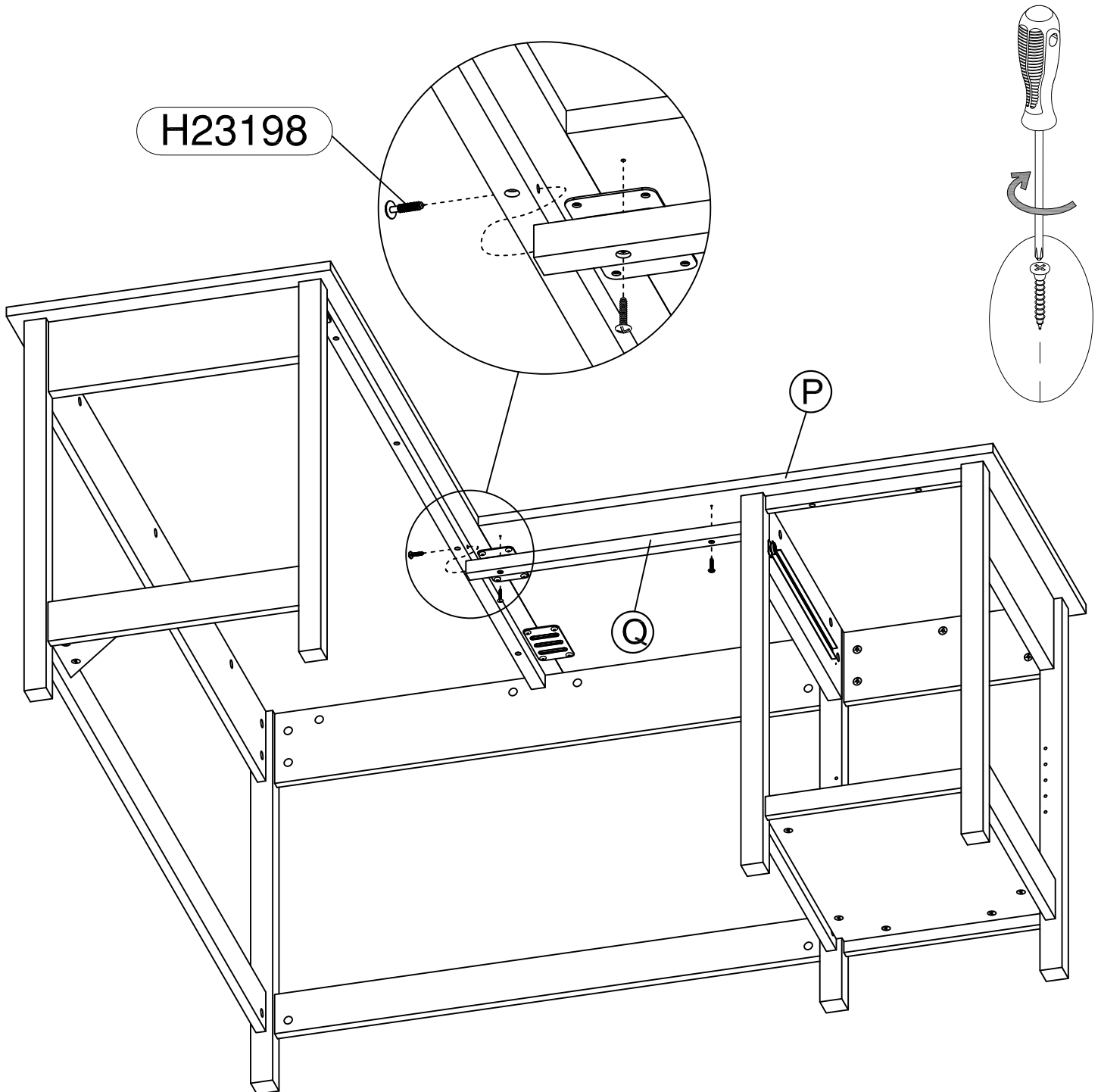

STEP 22

H145191

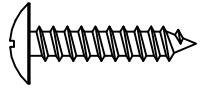

#8 x 3/4"-Zinc

[ 4 ]

H193459

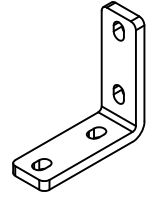

L Bracket

[ 1 ]

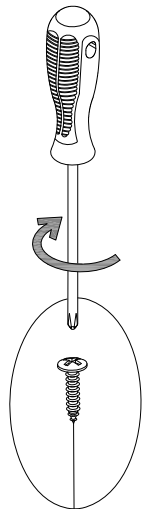
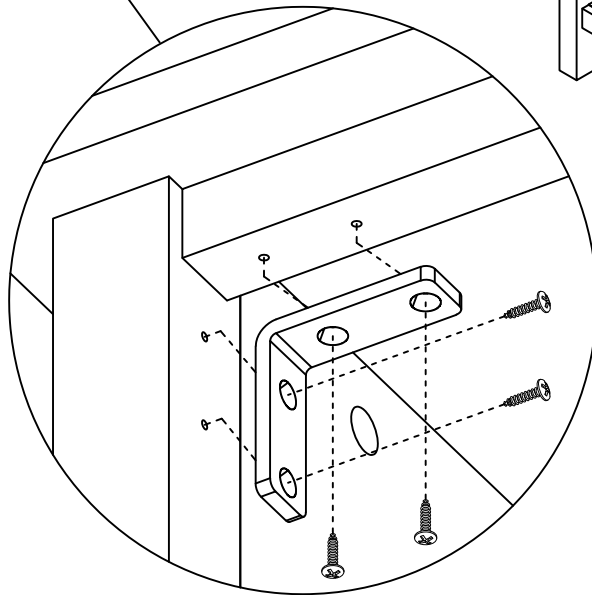
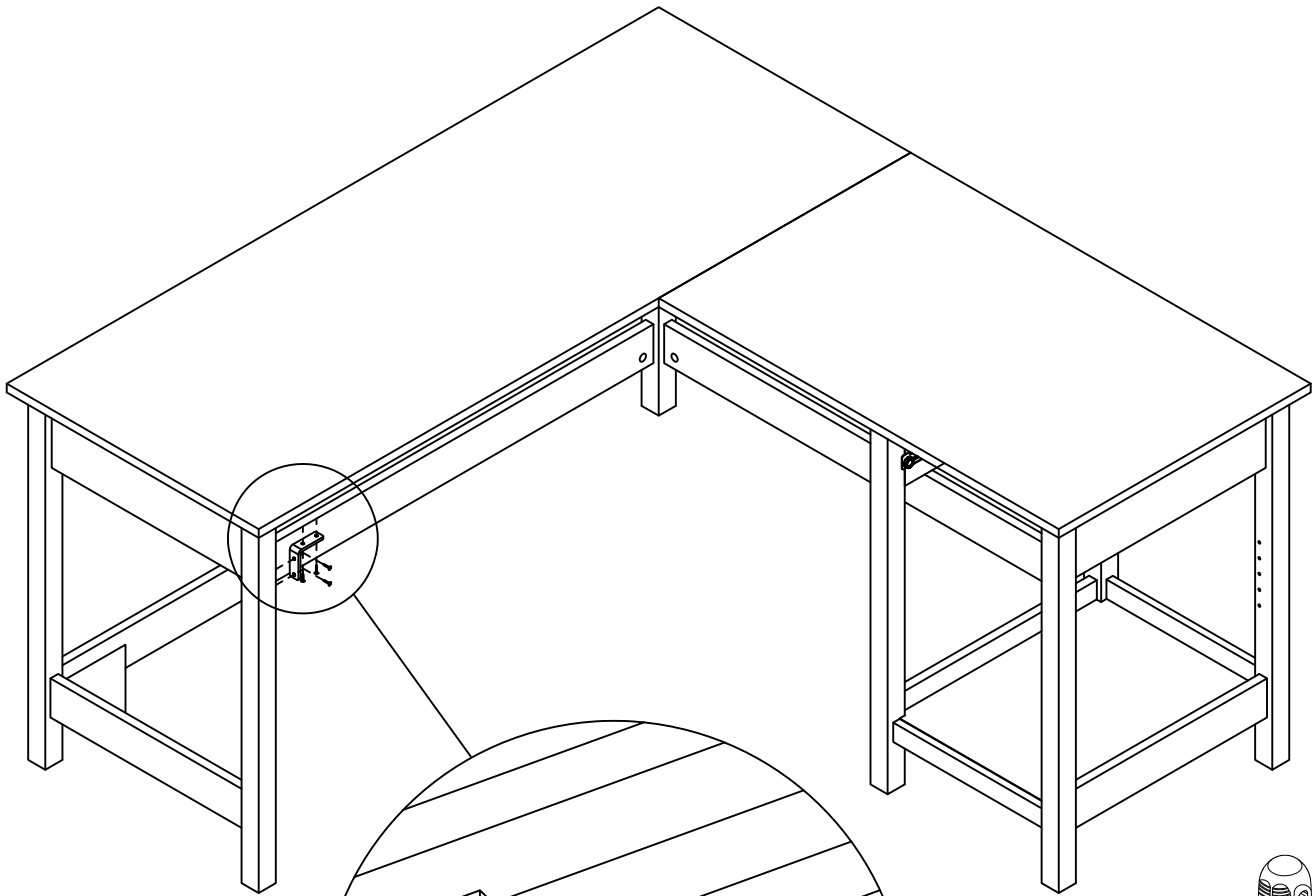

STEP 23

---

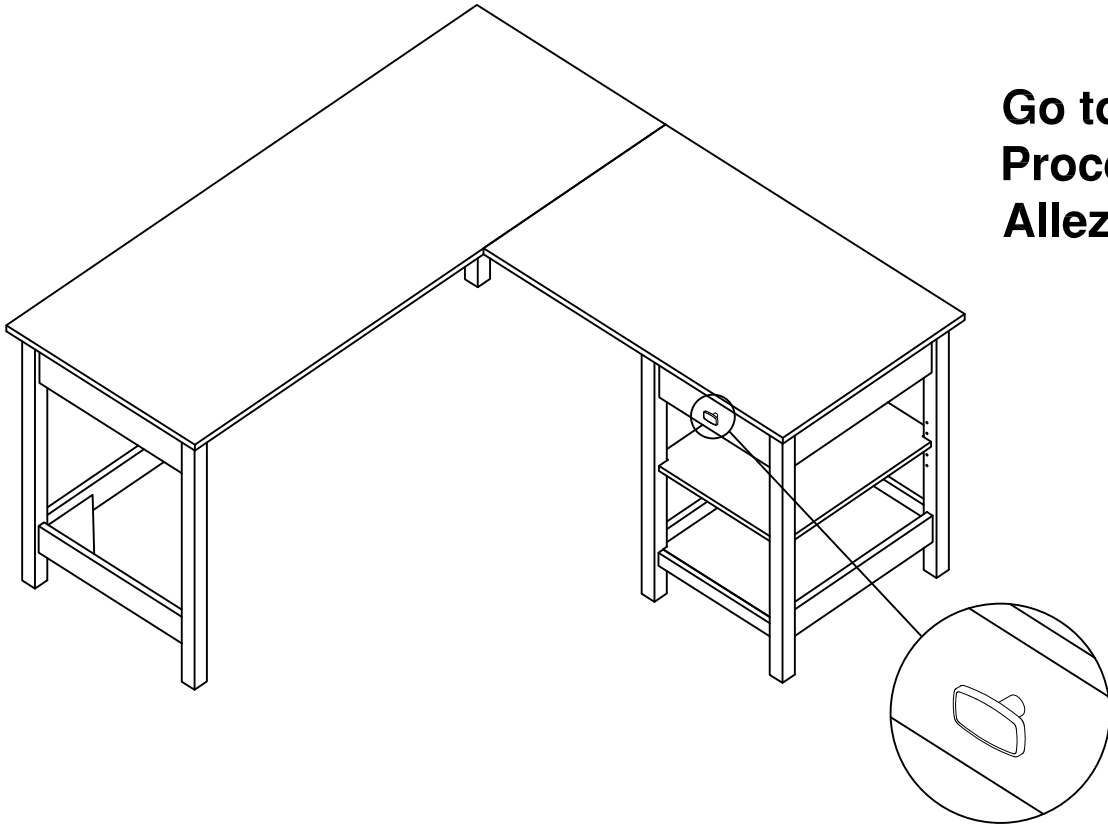

**Go to step 24**  
**Proceda al paso 24**  
**Allez a l'etape 24**

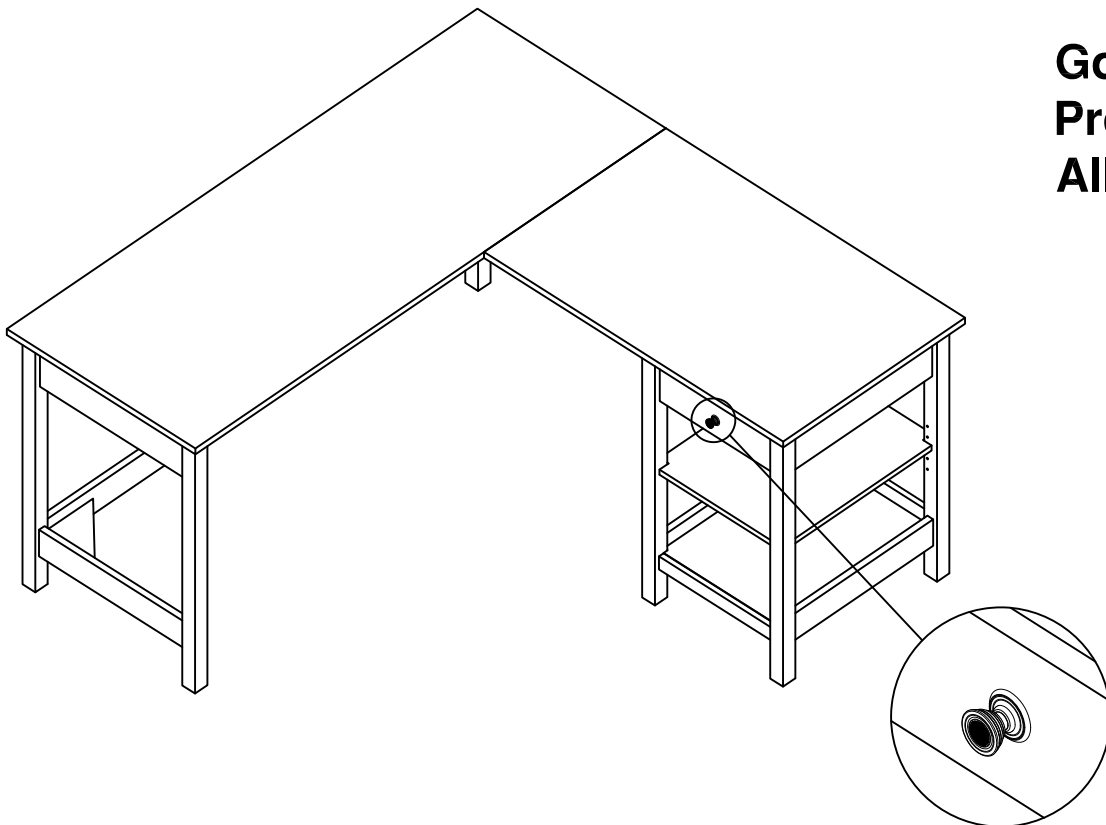

**Go to step 25**  
**Proceda al paso 25**  
**Allez a l'etape 25**

STEP 24

H100444

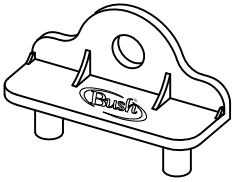

[ 2 ]

Drawer Bracket

H35251

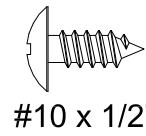

[ 2 ]

#10 x 1/2"

H160460

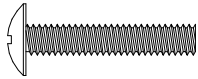

[ 1 ]

M4 x 22mm

H101725

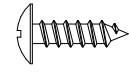

[ 4 ]

#6 x 1/2"

H175335

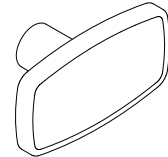

[ 1 ]

Handle

H35251

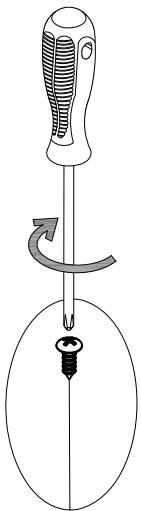
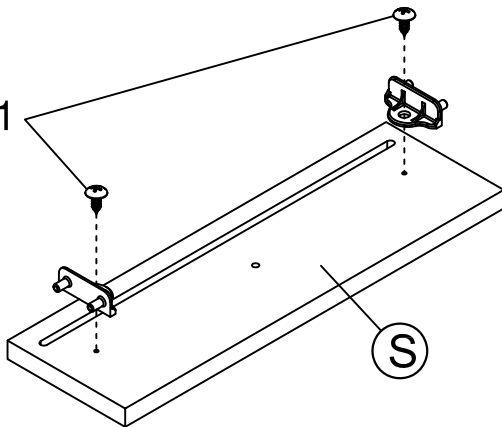

T

H160460

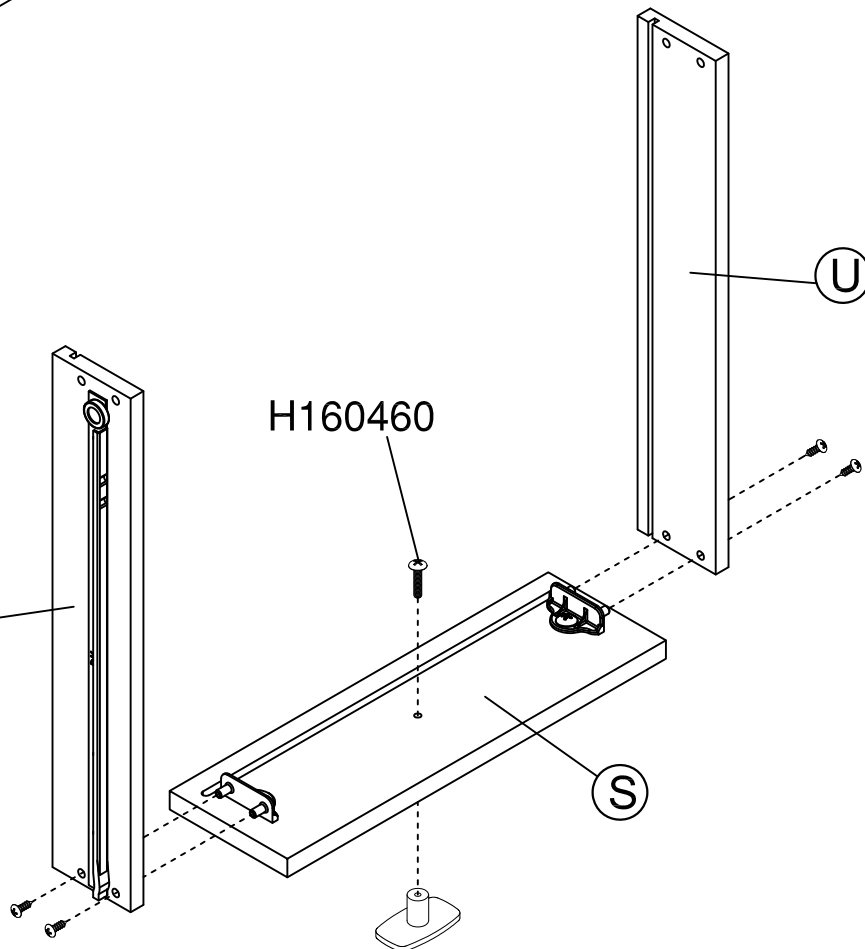



S

U

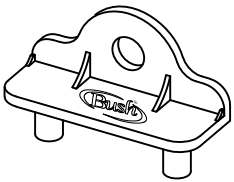
STEP 25

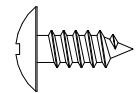
H100444  [ 2 ]  
Drawer Bracket

H35251  [ 2 ]  
#10 x 1/2"

H157181  [ 1 ]  
#8-32 x 1-1/8"

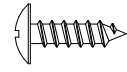
H101725  [ 4 ]  
#6 x 1/2"

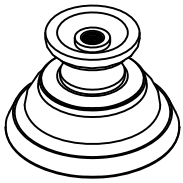
H174929  [ 1 ]  
Pull

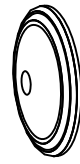
H174930  [ 1 ]  
Knob Cap

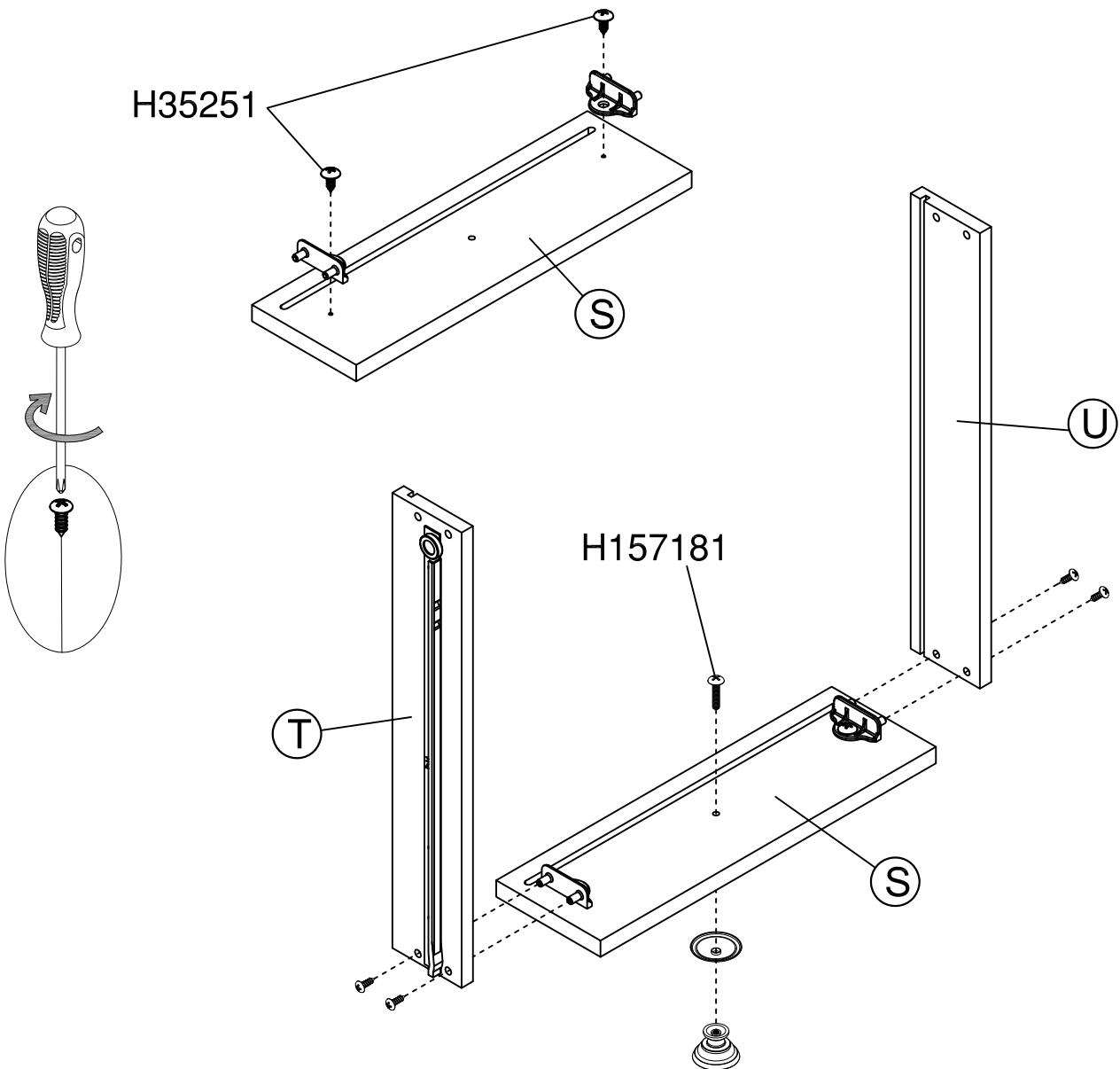

STEP 26

H23198

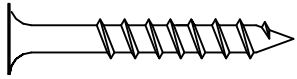

[ 4 ]

#10 x 1-1/2"

Finished side  
Lado terminada  
Cote fini

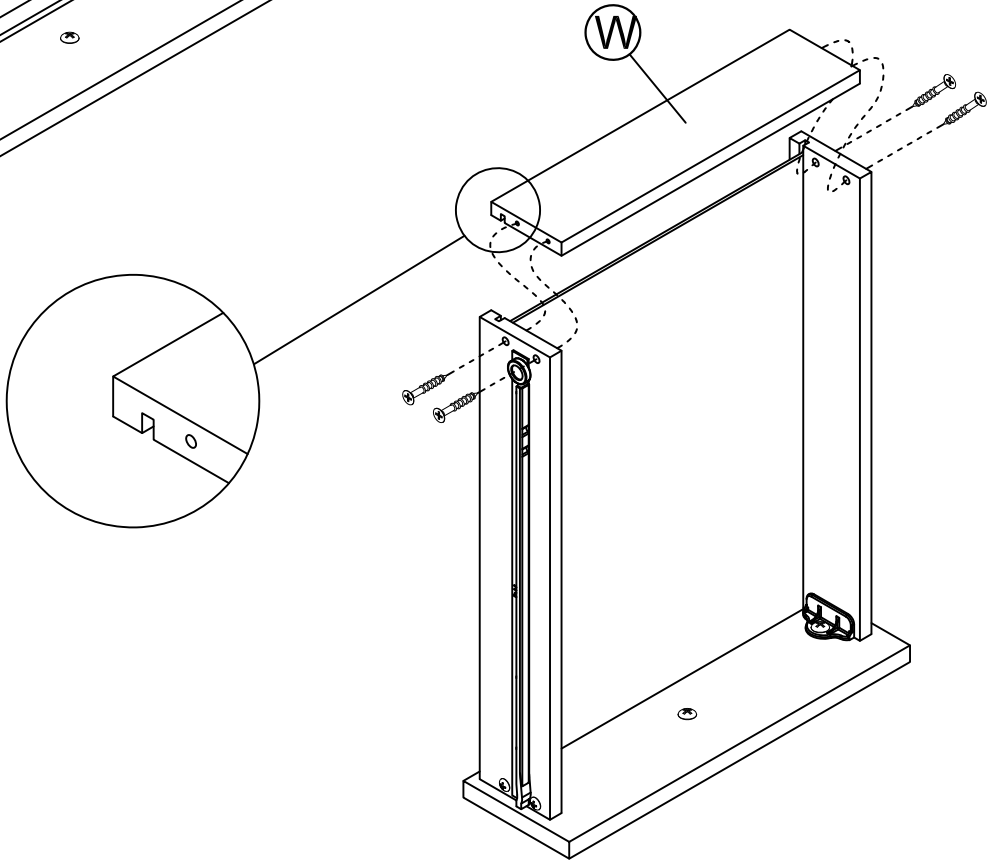
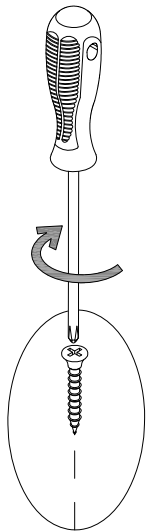
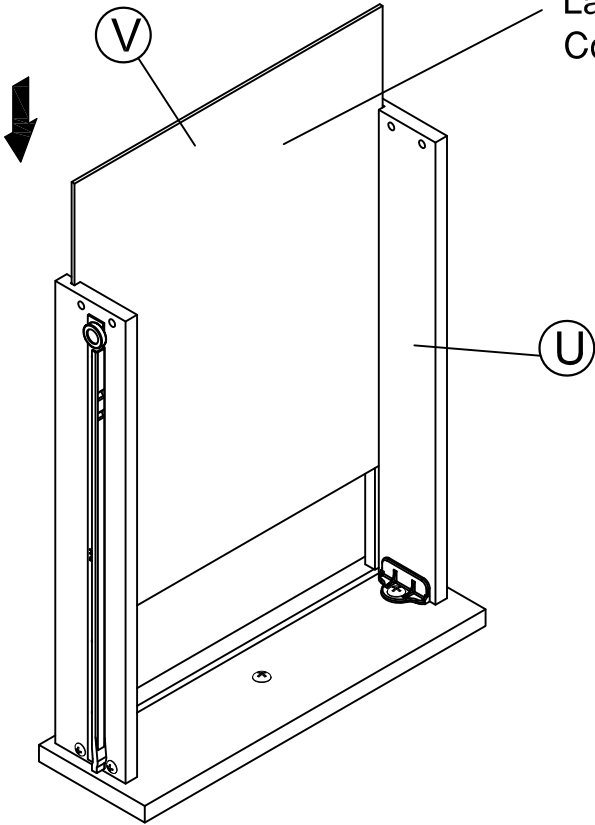

STEP 27

H23604

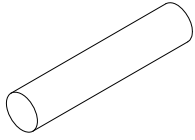

Shelf Pin

[ 4 ]

H126396

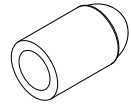

Shelf Pin Sleeve

[ 4 ]

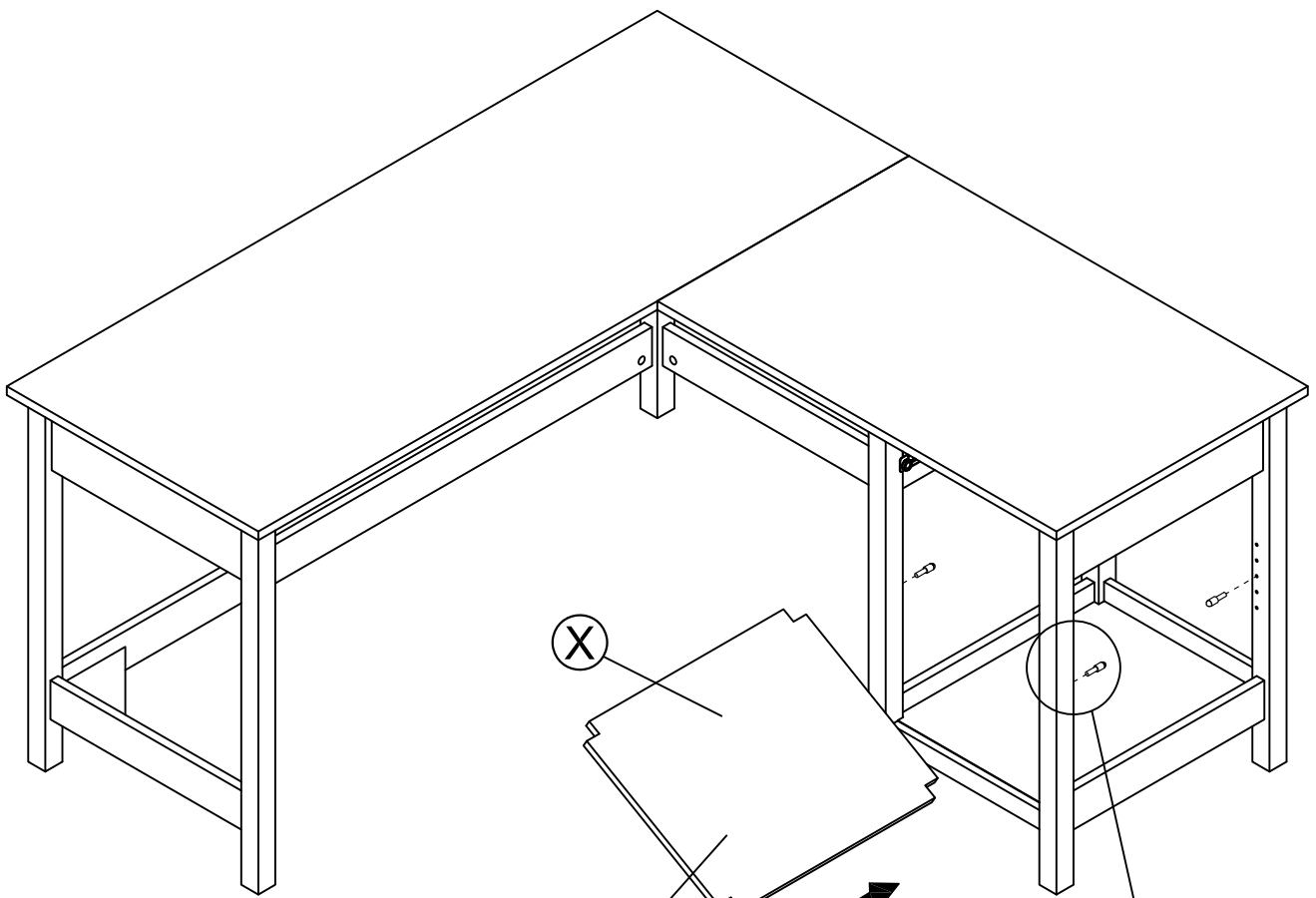

Finished side  
Lado terminada  
Cote fini



STEP 28

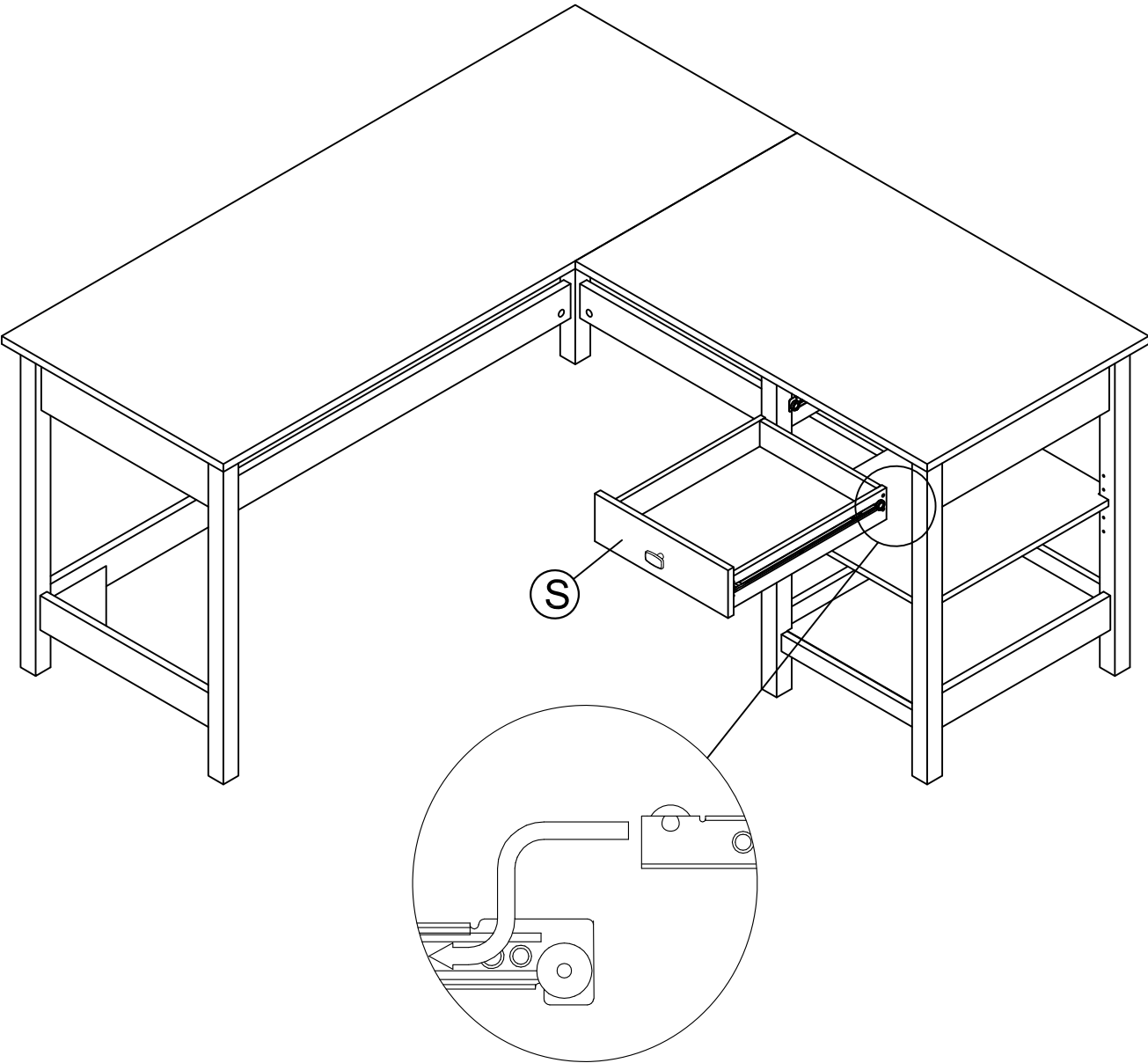

## STEP 29

### DRAWER FRONT VIEW

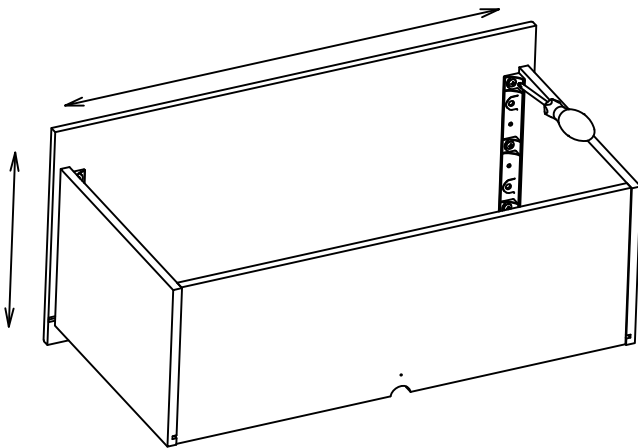
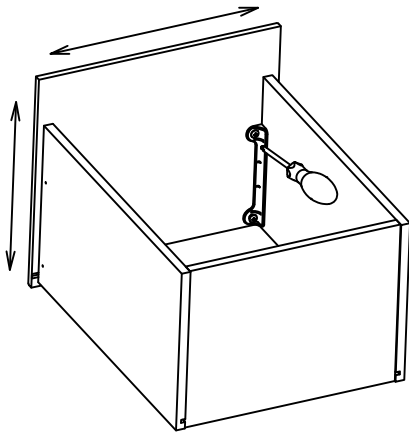
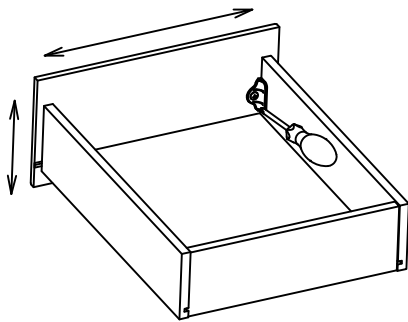
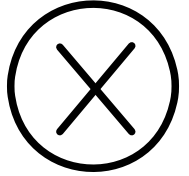
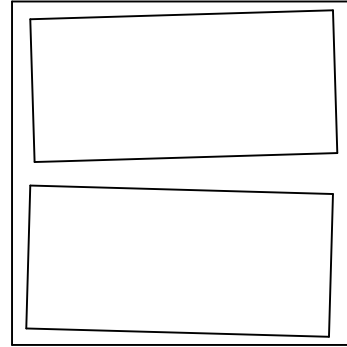
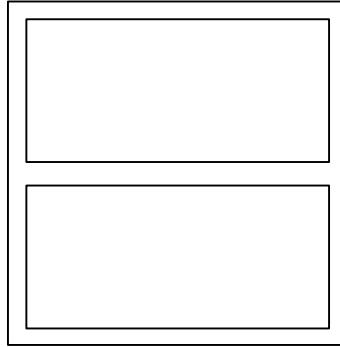

REQUIRED TOOL: PHILLIPS SCREWDRIVER

HERRAMIENTA REQUERIDA: DESTORNILLADOR PHILLIPS  
OUTIL REQUIS: TOURNEVIS CRUCIFORME

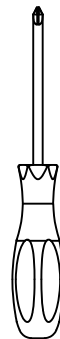

1. LOOSEN SCREWS.
2. ADJUST DRAWER FRONTS.
3. TIGHTEN SCREWS.

1. Afloje los tornillos
2. Ajustar frentes de cajón
3. Apriete los tornillos

1. Desserrer les vis
2. Ajuster les façades des tiroirs
3. Serrer les vis

# WARRANTY INFORMATION/INFORMATIONS POUR LA GARANTIE/INFORMACIÓN DE GARANTÍA

## WRITTEN WARRANTY TO YOU

In order to provide you with timely assistance, please thoroughly inspect your furniture for missing or defective parts immediately after opening the carton. Please have the Model, Part, and Lot Numbers found in the instruction manual available for your reference. You will also need your sales receipt or other proof of purchase. Replacement part(s) will be shipped to you at no charge with assuming all shipping and handling charges.

This product is warranted to the original purchaser at the time of purchase and for a period of one year thereafter.

We warrant to you, the original purchaser, that our furniture and all its parts and components are free of defects in material or workmanship. "Defects," as used in this warranty, is defined as any imperfection which impairs the use of the furniture product.

Our warranty is expressly limited to the replacement of furniture parts and components. For one year after the date of purchase, we will replace any parts that are defective in material or workmanship.

This warranty applies under conditions of normal use. Our products are not intended for outdoor use. This warranty does not cover: 1) defects caused by improper assembly or disassembly; 2) defects occurring after purchase due to product modification, intentional damage, accident, misuse, abuse, negligence or exposure to the elements; and 3) labor or assembly costs.

IMPLIED WARRANTIES, INCLUDING THE WARRANTY OF MERCHANTABILITY, SHALL NOT EXTEND BEYOND THE DURATION OF THE WRITTEN WARRANTY STATED ABOVE, AND IN NO EVENT SHALL BE LIABLE FOR INCIDENTAL OR CONSEQUENTIAL DAMAGES RESULTING FROM USE OF THE PRODUCT. Some states do not allow a limitation on how long an implied warranty lasts or the exclusion or limitation of incidental or consequential damages, so the above limitation and exclusion may not apply to you.

This warranty gives you specific legal rights. You may also have other rights that may vary from state to state.

## VOTRE GARANTIE

Afin de vous assister rapidement, veuillez inspecter votre mobilier en détail immédiatement après l'ouverture du carton en cas de pièces manquantes ou défectueuses. Veuillez tenir à disposition les numéros de modèle, de pièce et de lot qui se trouvent dans le manuel d'instruction pour votre référence. Vous aurez également besoin de votre reçu ou d'une autre preuve d'achat. La (les) pièce(s) de rechange vous sera (seront) envoyée(s) sans frais, se chargeant de tous les frais d'expédition.

Tout le produit est garanti à l'acheteur original à partir de la date d'achat pour une période d'un an.

Nous vous garantissons, à vous l'acheteur original, que notre mobilier et toutes ses pièces et composants sont sans défaut de matériau ou de fabrication. Le terme "défauts" utilisé dans cette garantie, est défini comme étant toutes les imperfections qui compromettent l'utilisation du meuble.

Notre garantie est expressément limitée au remplacement des pièces et des composants du mobilier. Pendant un an après la date d'achat, remplacera toute pièce défectueuse dans le matériau ou sa fabrication.

Cette garantie d'applique sous des conditions d'utilisation normale. Nos produits ne sont pas destinés à être utilisés en plein air. Cette garantie ne couvre pas: 1) les défauts causés par un mauvais assemblage ou démontage, 2) les défauts ayant lieu après l'achat et dus à la modification du produit, des dommages intentionnels, des accidents, une mauvaise utilisation, un mauvais traitement, la négligence ou l'exposition aux éléments, et 3) les frais de main d'œuvre ou d'assemblage.

LES GARANTIES TACITES, Y COMPRIS LA GARANTIE DE QUALITE MARCHANDE, NE S'ETENDRONT PAS AU-DELA DE LA DUREE ECRITE CITEE CI-DESSUS, ET NE SERA EN AUCUN CAS RESPONSABLE DES DOMMAGES ACCESSOIRES OU INDIRECTS RESULTANT DE L'UTILISATION DU PRODUIT. Certains états ne permettent pas d'appliquer une limite à la durée de la garantie tacite, ni une exclusion ou limitation des dommages accessoires ou indirects; dans ce cas les limitations ou exclusion ci-dessus peuvent ne pas s'appliquer à vous.

Cette garantie vous donne des droits légaux spécifiques. Il se peut que vous ayez également d'autres droits qui peuvent varier d'un état à l'autre.

## GARANTIA ESCRITA DE PARA USTED

Para brindarle asistencia oportuna, por favor, verifique detalladamente que a su mueble no le falte o tenga piezas defectuosas inmediatamente después de abrir la caja. Sírvase traer los números de modelo, parte y lote que se encuentran en el manual de instrucciones disponible para su referencia. Además, necesitará el recibo de su compra u otra prueba de compra. La(s) pieza(s) de reemplazo le será(n) enviada(s) sin recargo por asumiendo los gastos de envío y manipuleo.

Todo mueble es garantizado al comprador original al momento de la compra y por un periodo de uno año en adelante.

Le garantizamos a usted, el comprador original, que nuestros muebles sus partes y componentes están libres de defectos en materiales o trabajo. "Defectos", según se usa en esta garantía, se define como una imperfección que perjudica el uso del producto mobiliario.

Nuestra garantía se limita expresamente al reemplazo de partes y componentes mobiliarios. Durante uno año después de la fecha de compra, reemplazará cualquier parte defectuosa en material o trabajo.

Esta garantía se aplica bajo condiciones de uso normal. Nuestros productos de no son para uso en exteriores. Esta garantía no cubre: 1) defectos causados por un ensamblaje

o desensamblaje inadecuado; 2) defectos que ocurran después de la compra debido a modificación del producto, daño intencional, accidente, mal uso, abuso, negligencia o exposición a los elementos; y 3) costos de trabajo o ensamblaje.

LAS GARANTÍAS IMPLICADAS, INCLUYENDO LA GARANTÍA DE COMERCIABILIDAD, NO SE EXTENDERÁN MÁS ALLÁ DE LA DURACIÓN DE LA GARANTÍA ESCRITA MENCIONADA, Y EN NINGÚN CASO SERÁ RESPONSABLE POR DAÑOS INCIDENTALES O CONSIGUIENTES COMO RESULTADO DEL USO DEL PRODUCTO. Algunos estados no permiten una limitación sobre el tiempo de duración de la garantía implicada o la exclusión o limitación de daños incidentales o consiguientes, de manera que la limitación y exclusión mencionadas pueden no aplicarse para usted.

Esta garantía le otorga derechos legales específicos. Puede también tener otros derechos que pueden variar según los estados.