

Preferred Bath Accessories Inc.
1031 E Mountain St. Kenersville, NC 27284
PH: 888-315-8816 FAX: 866-496-8122
www.preferredbathinc.com

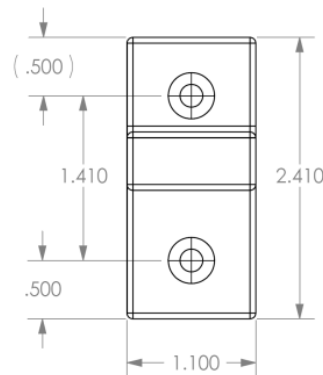

Fixed Rectangle Curved Shower Rod P/N 112-5xx
Fits 60" shower enclosure (may be cut down to fit opening)
Available Finishes: Polished Chrome and Brushed Nickel
TECHNICAL DATA

Patented Patent #USD752421S



Tplug design allows for quick installation without using set screws to mount shower bar holder to wall bracket. No screws required to assemble wall mounting bracket to the shower bar holder. Easy t-plug design allows you to just insert and rotate to connect

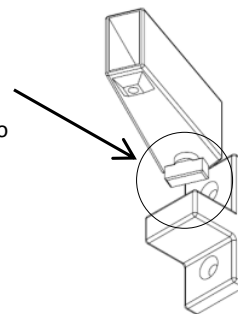

Installation:

Step 1 - Attach each wall bracket using stainless steel wood screws

Step 2 - Insert shower bar holders t-plug into the wall brackets and rotate to connect to wall bracket and insert shower bar

Step 3 - Tighten headless set screws

Wood blocking is preferred

Materials:

- 1 - Shower Bar – Polished Stainless Steel
- 2 - Wall Brackets – Zinc Die Cast
- 2 - Shower Bar Holders - Zinc Die Cast
- 2 - Set Screws
- 4 - Stainless Steel Mounting Screws
- 4 - Wall Anchors

Limited Warranty

Preferred Bath Accessories Inc. warrants to the purchaser that the product will be free from defects in material and workmanship. If the product does not comply with this warranty, Preferred Bath Accessories Inc. will repair or replace the product or, at Preferred Bath Accessories Inc.'s option, refund the purchase price. The limited warranty period is for the lifetime of the product. Limitations on the Warranty: The warranty does not cover, normal wear and tear, product abuse, neglect, improper installation or maintenance. Purchaser Requirements: If this product does not meet Preferred Bath Accessories Inc.'s warranty, return the product (postage prepaid) to the place of purchase with proof of purchase and a written claim briefly describing the defect. You may be required to provide other information or evidence of the defect.