

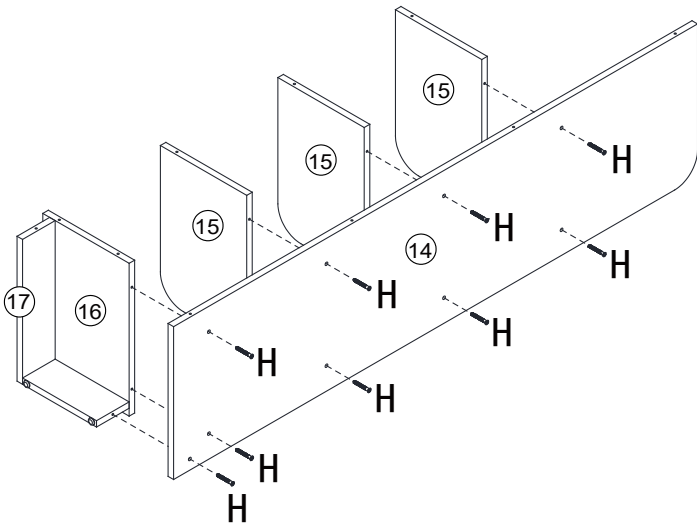

2

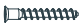
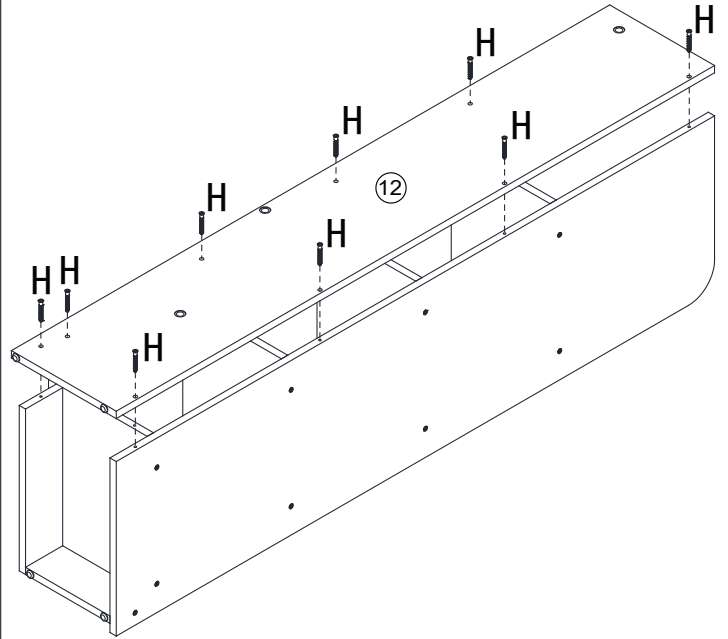

H		9pcs
M5x35		

3



H		9pcs
M5x35		

4

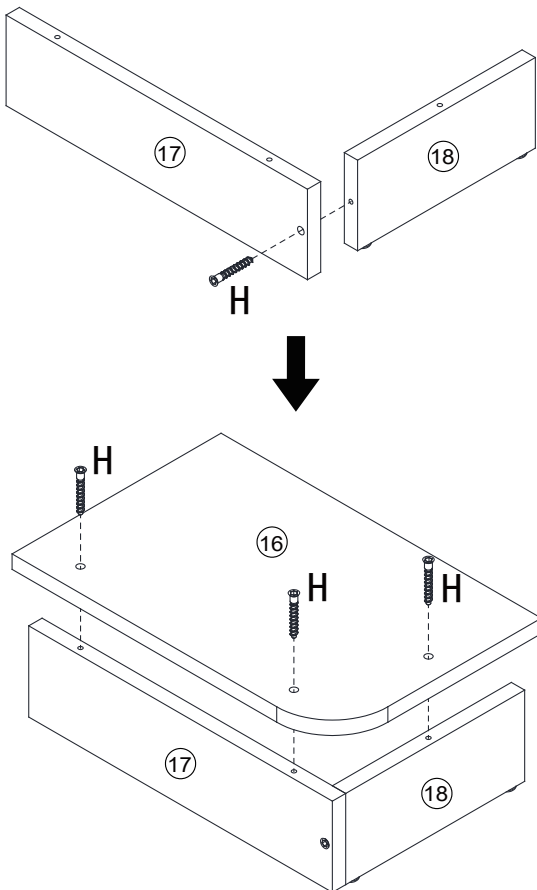

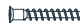
H		4pcs
M5x35		

5

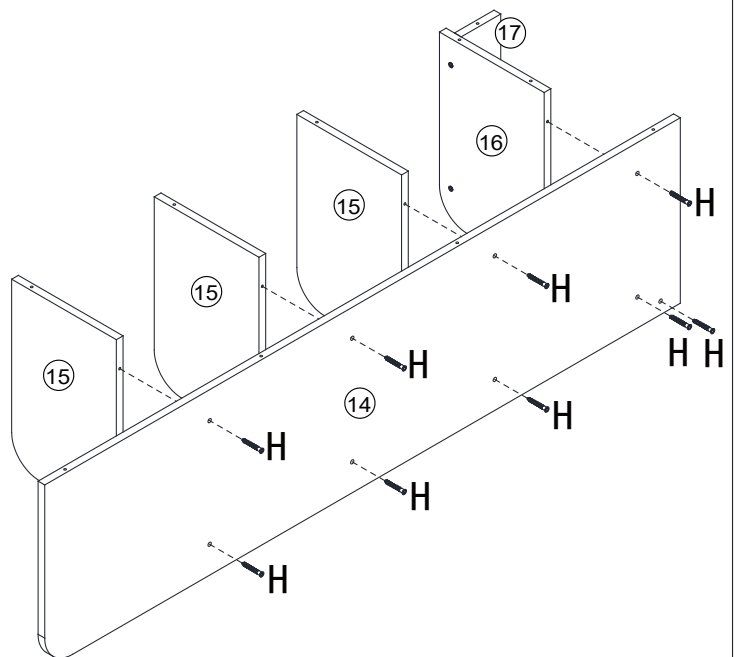

H		9pcs
M5x35		

6

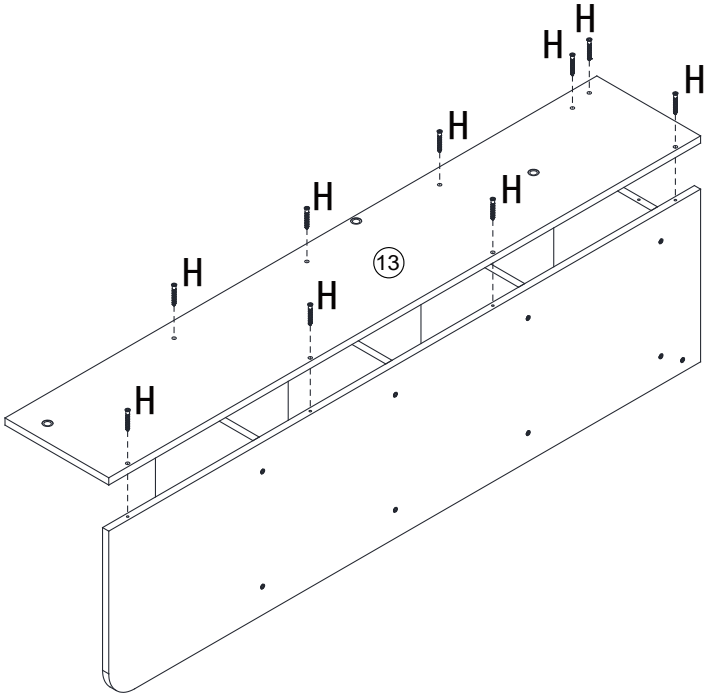

H		9pcs
	M5x35	

7

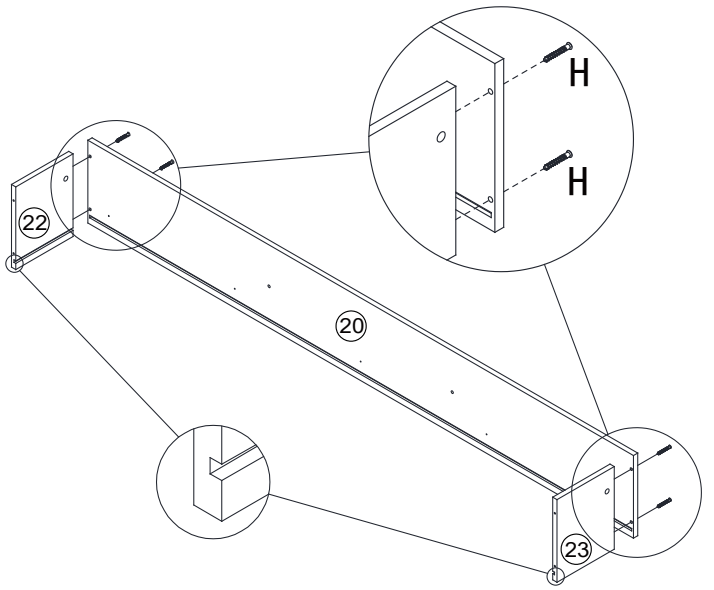

H		4pcs
	M5x35	

8

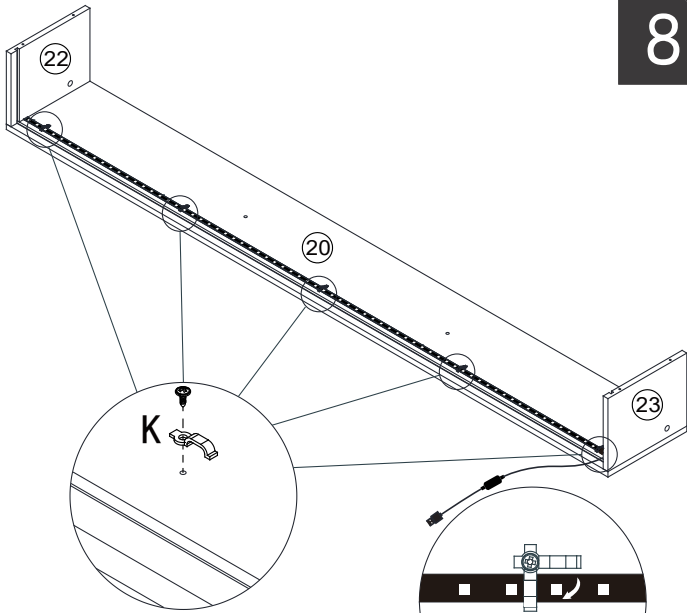

Do not lock the screws.



Lock all screws tightly

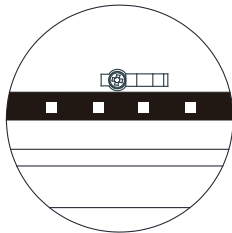

9

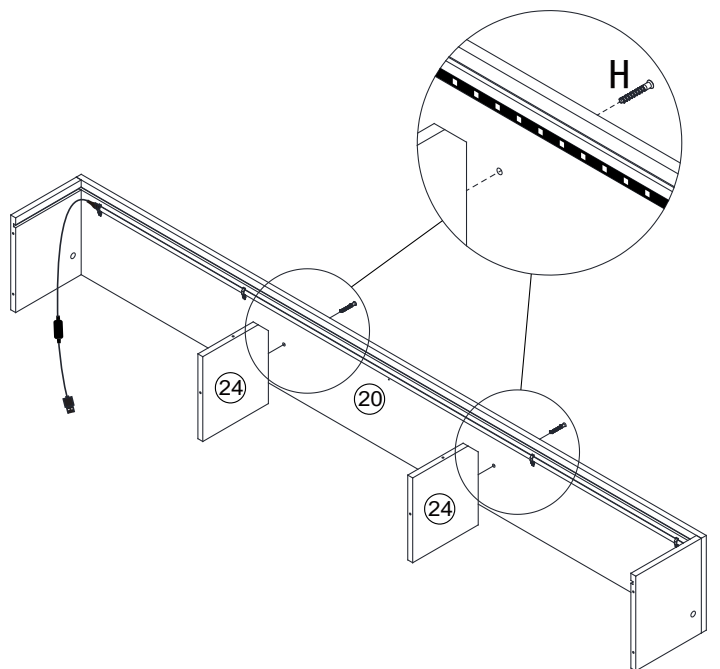

H		2pcs
	M5x35	

10

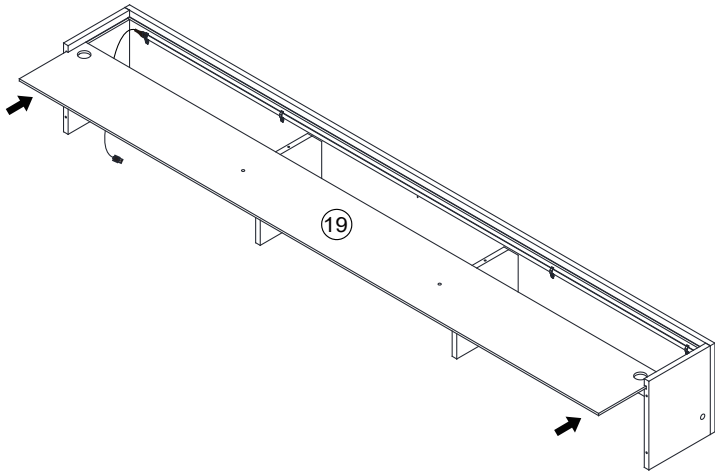

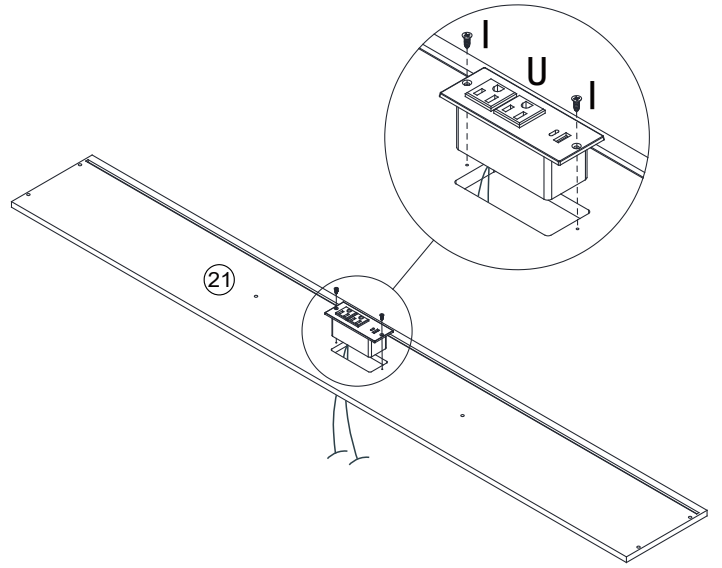

11

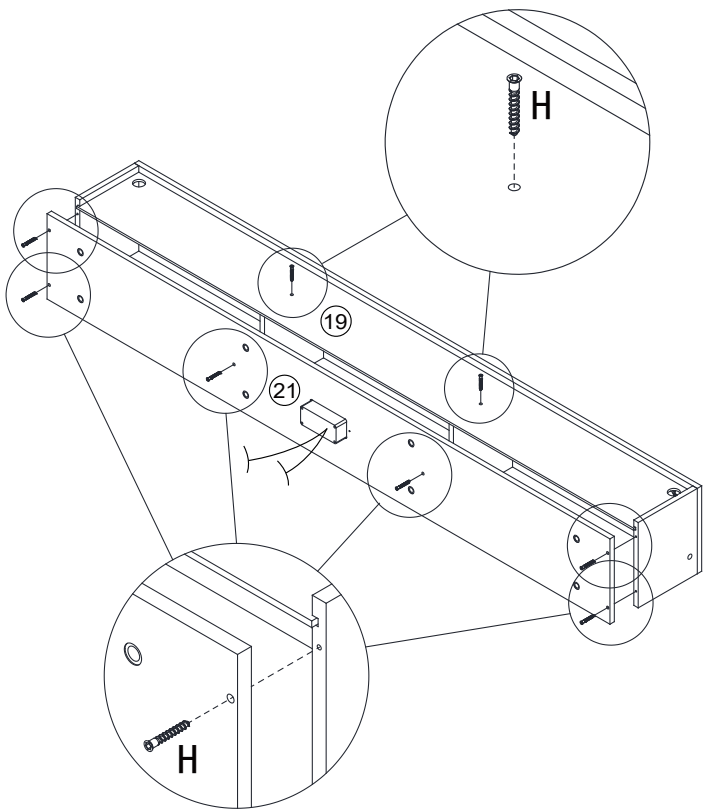

I	 ST4. 2x12	2pcs
---	---	------

12



H	 M5x35	8pcs
---	---	------

13

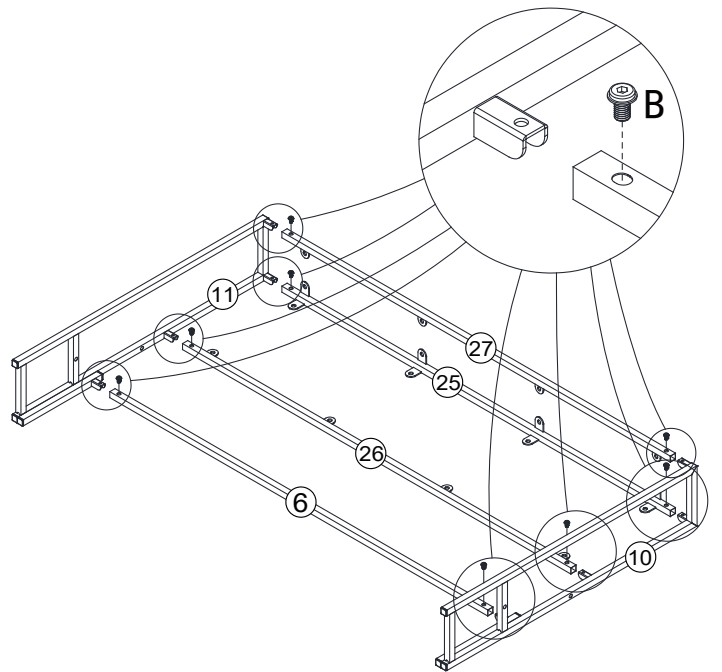

B	 M8x14	8pcs white zinc
---	---	-----------------

14

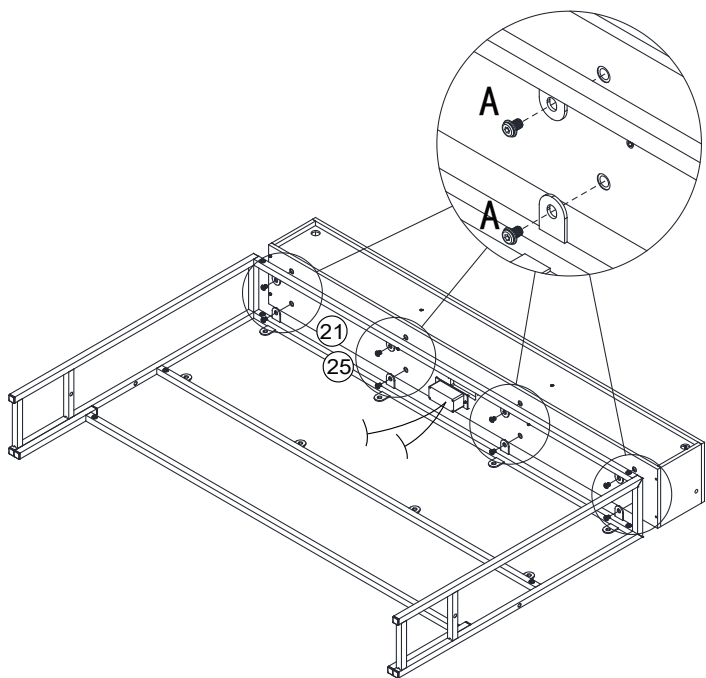

A		8pcs
---	---	------

15

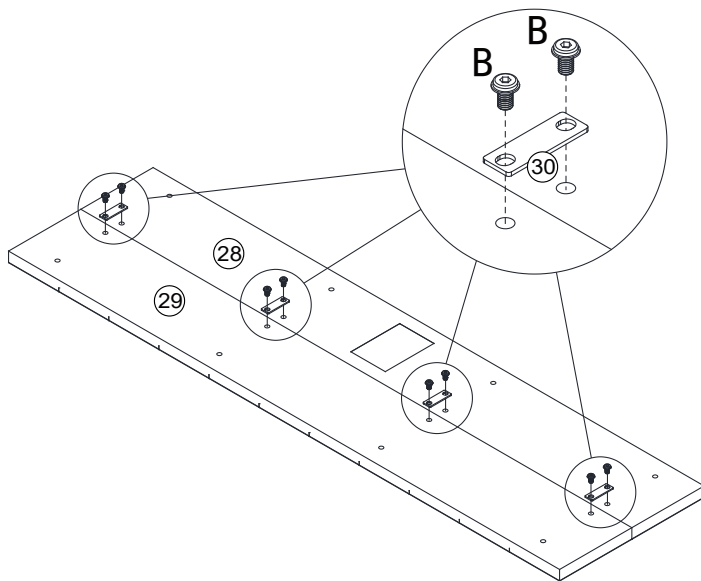

B		8pcs white zinc
---	--	-----------------

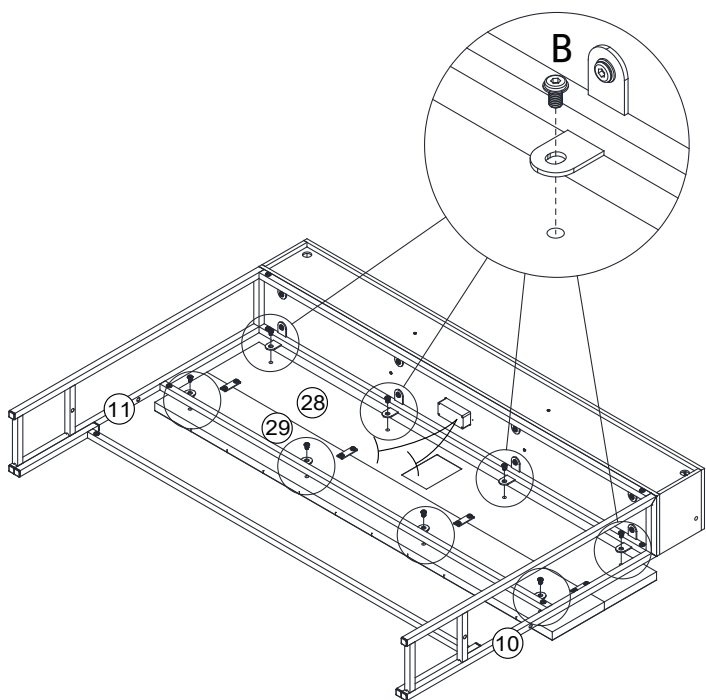

16

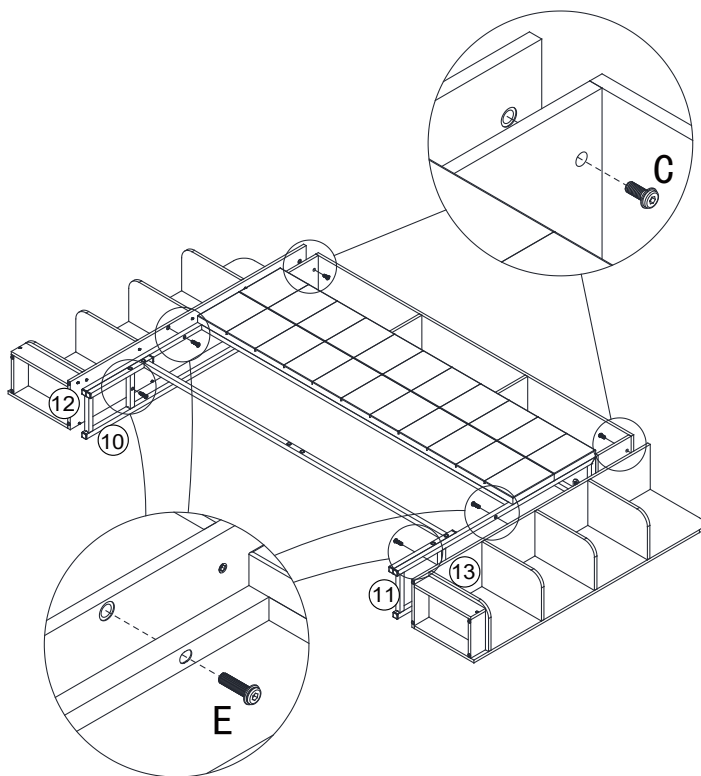

B		8pcs white zinc
---	---	-----------------

17



C		2pcs
E		4pcs

18

x2

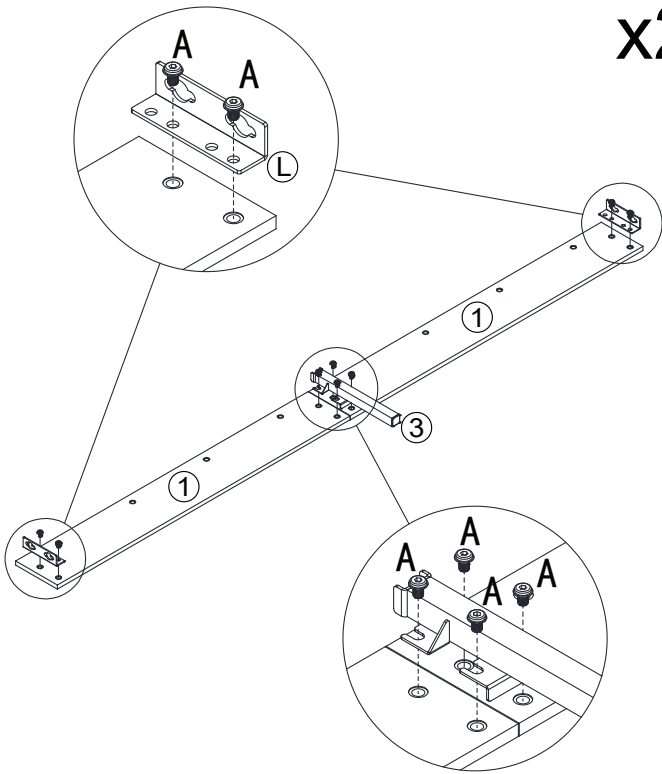

A		16pcs
M8x12		

19

x2

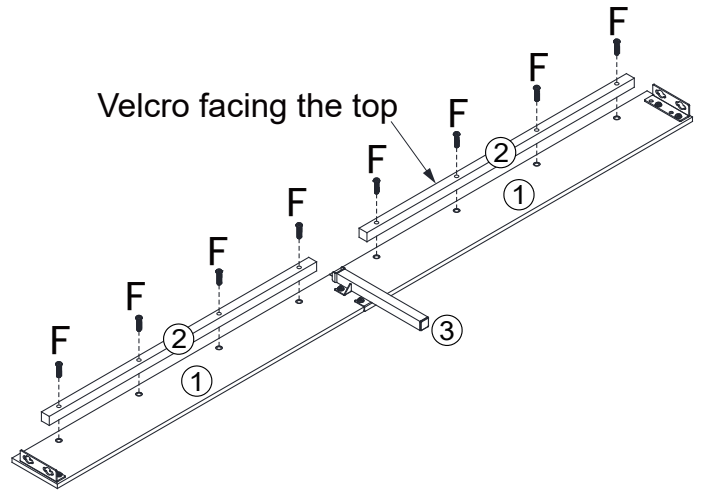

F		16pcs	white zinc
M8x33			

20

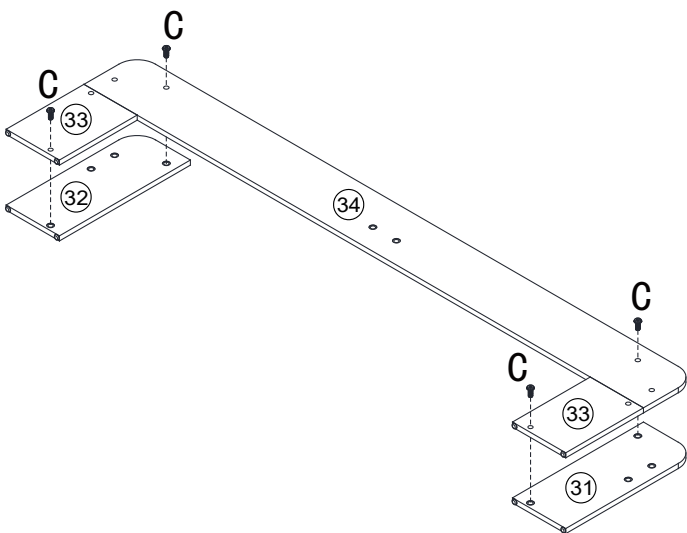

C		4pcs
M8x20		

Tighten screws D

21

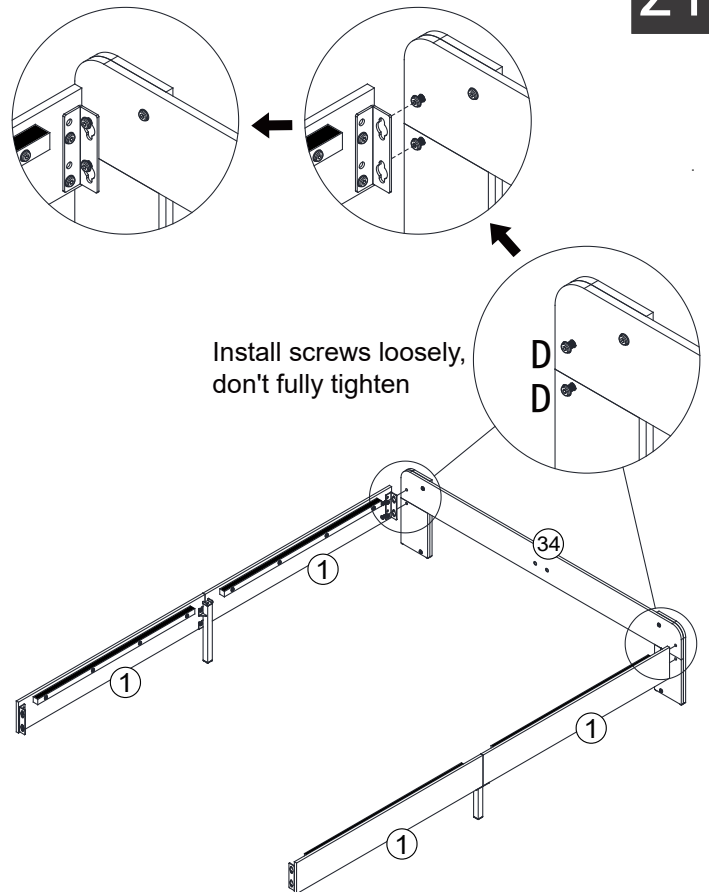

D		4pcs	white zinc
M8x25			

22

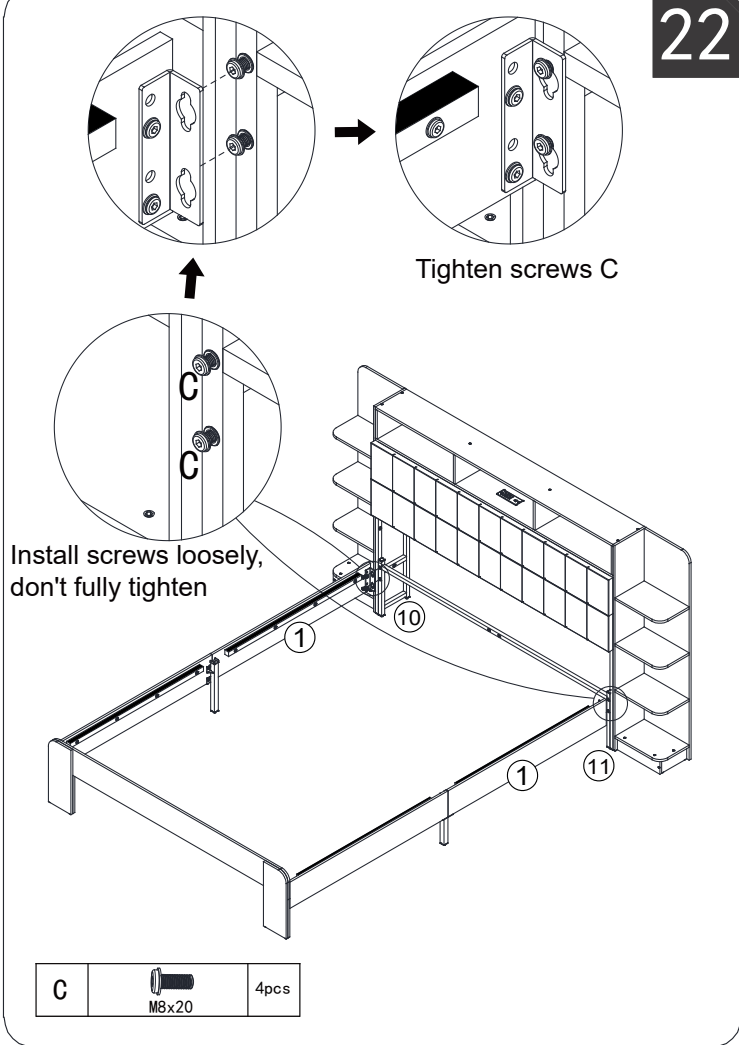

23

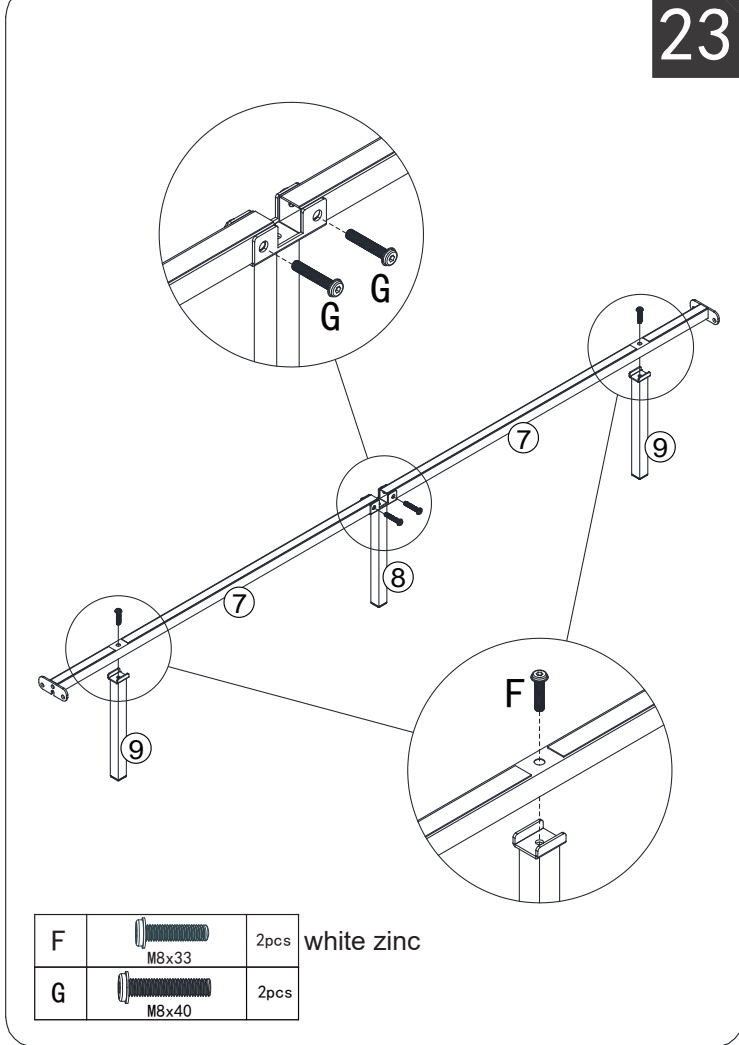

24

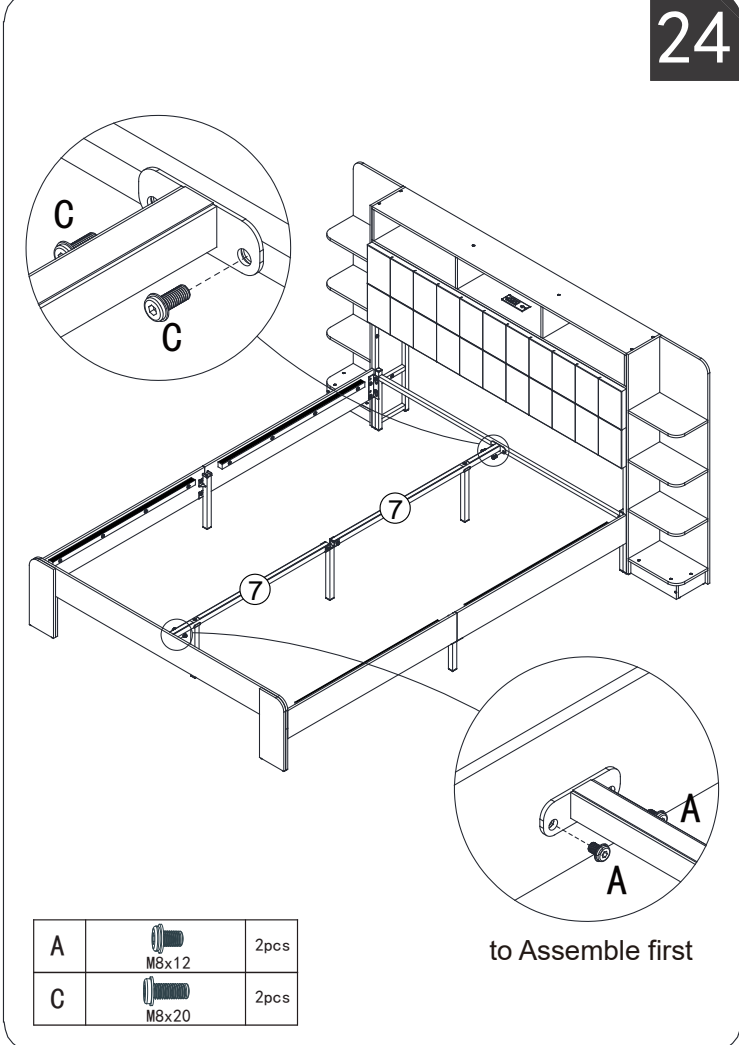

25

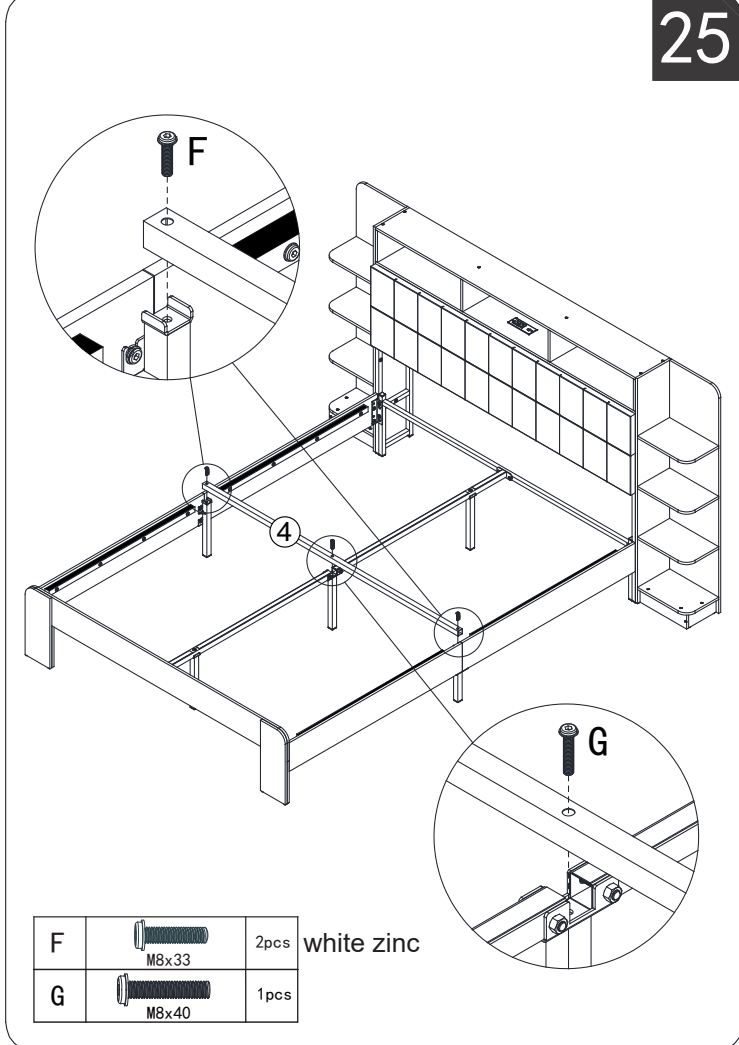

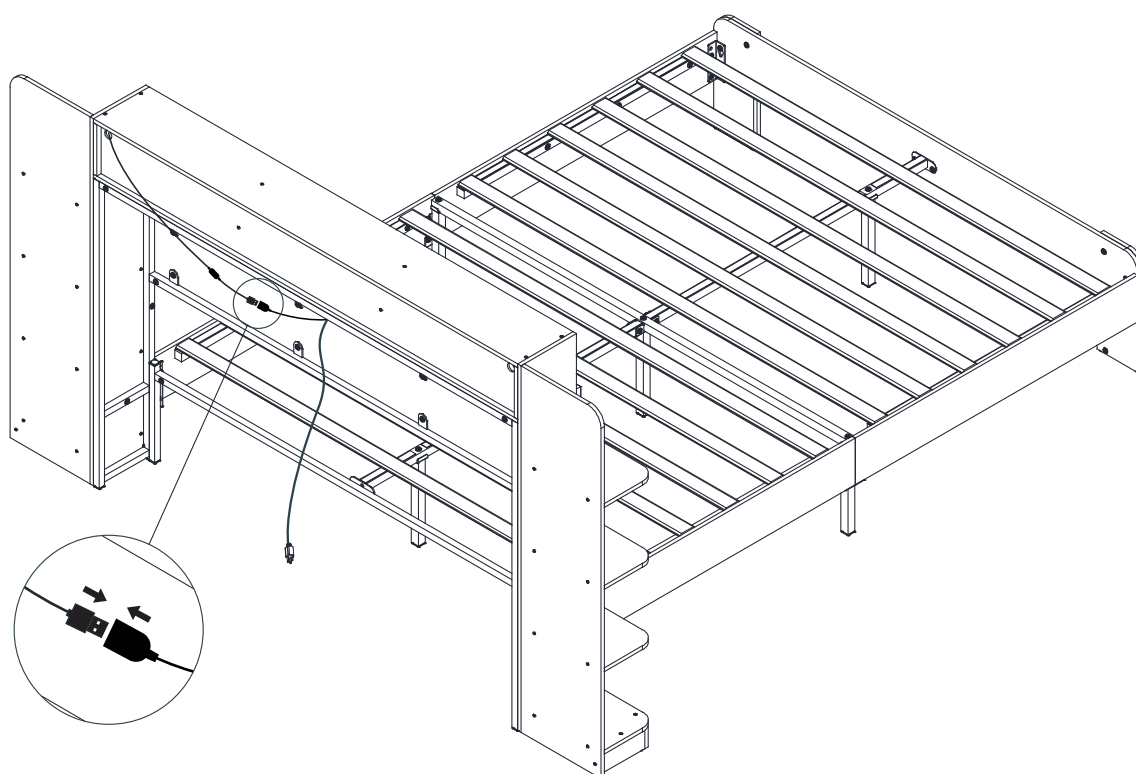
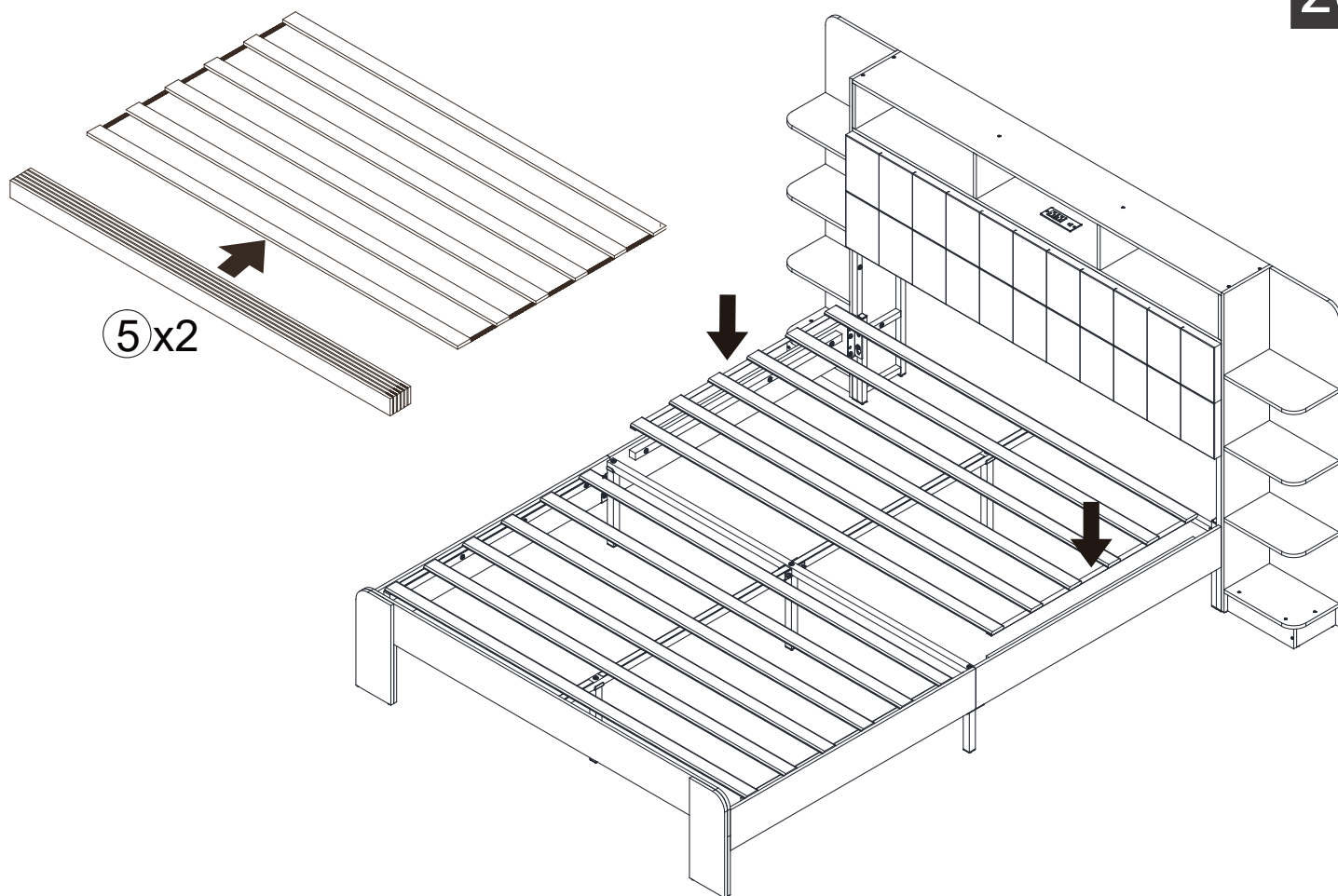

Finish

