

DRUM TRI-H

MATERIAL THICKNESS
IS 1/8 IN.

NOTE: CASTERS NOT SHOWN IN TOP VIEW

MATERIAL THICKNESS
IS 3/16 IN.

NOTE:
X'S ARE WELDS

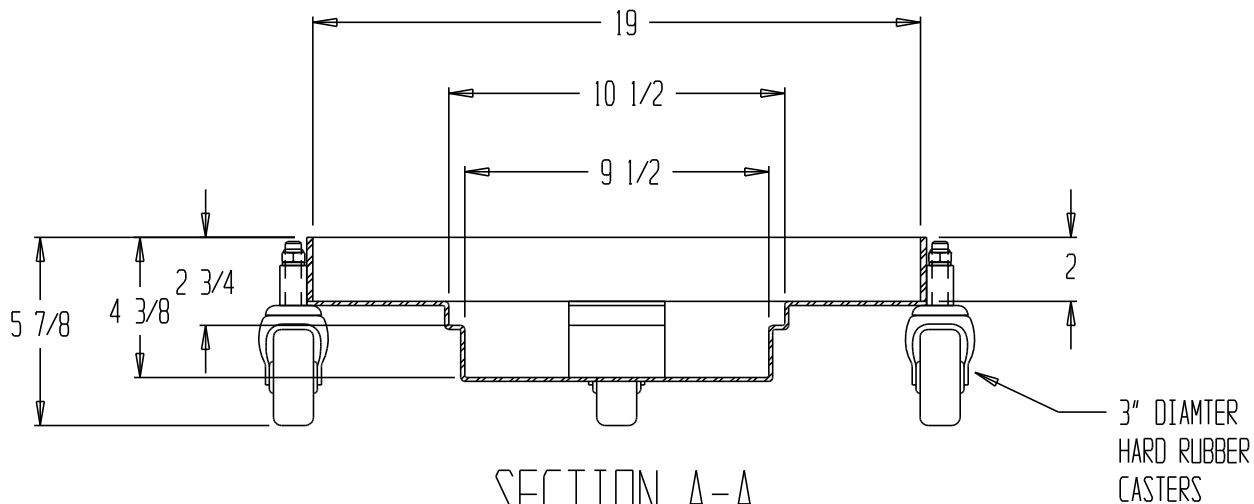

SECTION A-A

STANDARD FEATURES

MODEL NUMBER: DRUM-TRI-H
CAPACITY: 900 LBS
CASTER: HARD RUBBER

APPROVAL

I, the undersigned, hereby approve this print
[] As drawn [] As marked
This includes my approval of design & dimensions.
Signed: _____
Date: _____

PRODUCTION WILL START UPON
RECEIPT OF SIGNED APPROVAL
DRAWING

**SPECIAL UNITS ARE NON-RETURNABLE
*AVAILABLE AT ADDITIONAL COSTS

DISTRIBUTOR'S NAME: T & S EQUIPMENT		P.O.#: _
DRAWN BY: E. JOHNSON		W.O.#: _
DATE: 8/18/03		SALES: _
REFERENCE: -		DRWG./FILE NAME: 33-007-109
scale: 1:6		