

Attention:
Two people are required for assembly and lifting unit.

ASSEMBLY INSTRUCTION

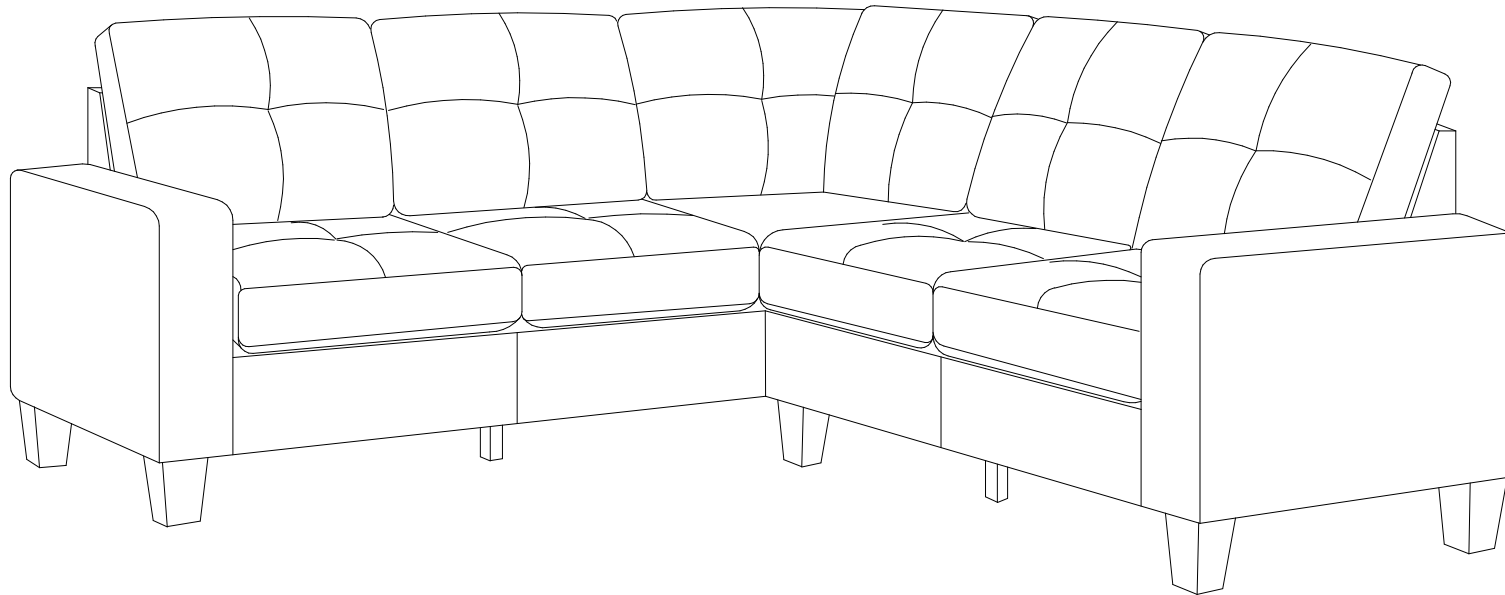

ASSEMBLY PART

1.

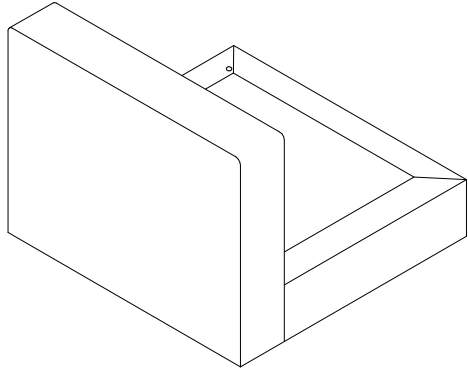

LEFT SIDE (1PC)

2.

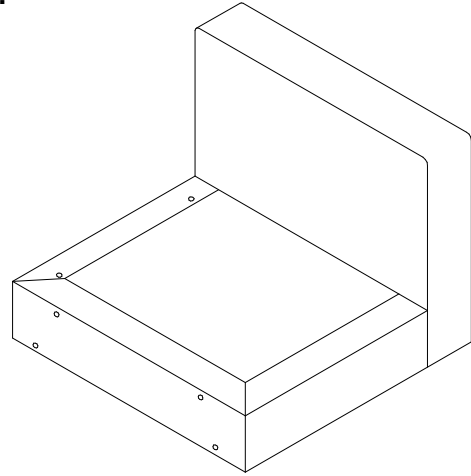

RIGHT SIDE (1PC)

3.

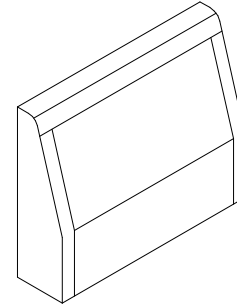

BACK REST 22.6 inch (4PCS)

4.

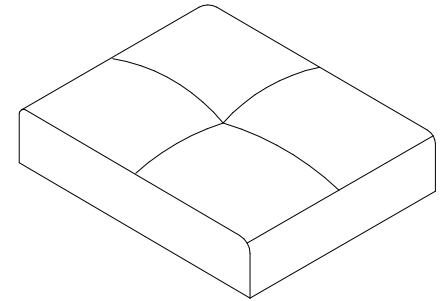

SEAT CUSHION (4PCS)

5.

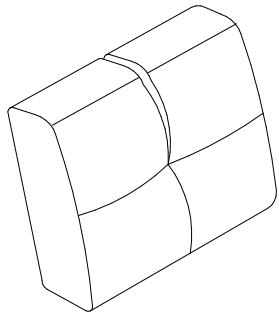

BACK PILLOWS INSIDE FILLING (4PCS)

6.

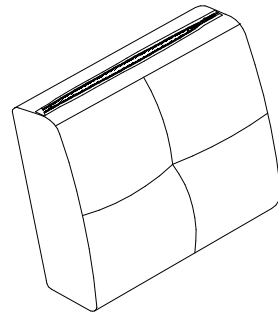

PILLOW CASE COVERS (4PCS)

7.

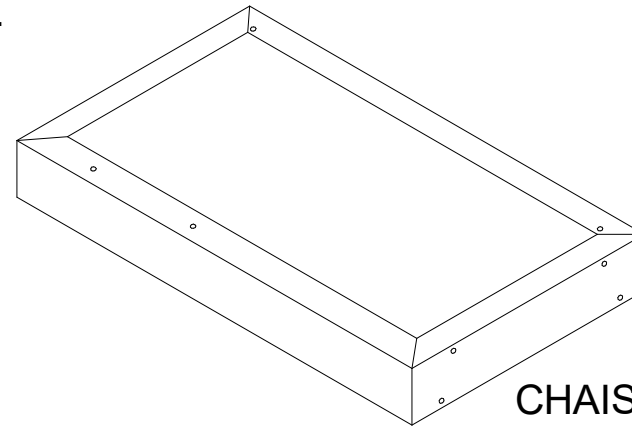

CHAISE BASE (L) (1PC)

8.

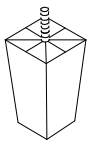

LEG (8PCS)

9.

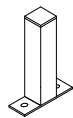

CENTER LEG (4PCS)

10.

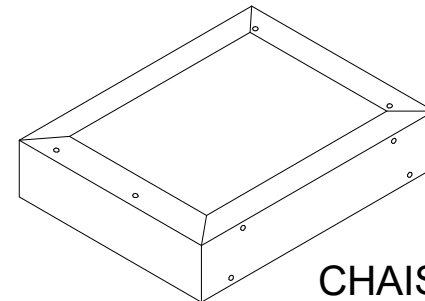

CHAISE BASE (R) (1PC)

ASSEMBLY PART

11.

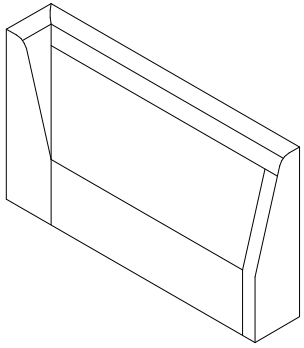

BACK REST 29.5 inch (1PC)

12.

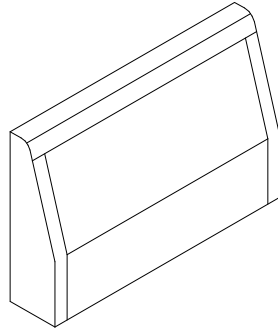

BACK REST 23.6inch (1PC)

13.

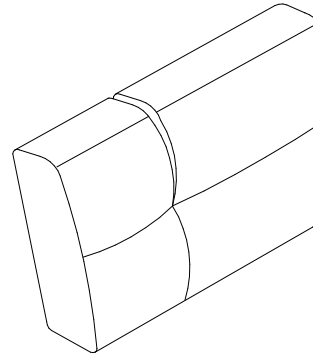

BACK PILLOW
LEFT (1PC)

14.

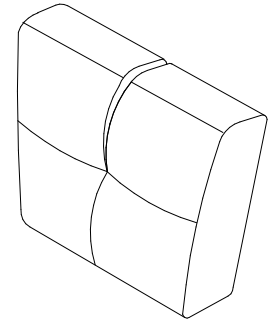

BACK PILLOW
RIGHT (1PC)

15.

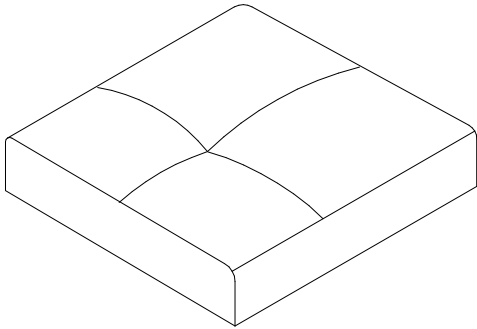

SEAT CUSHION
(CENTER) (1PC)

16.

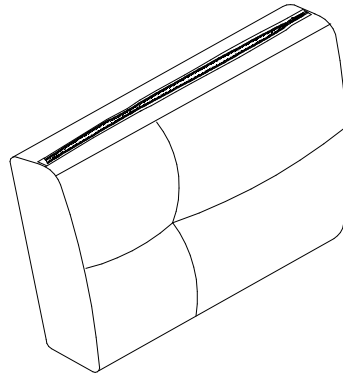

PILLOW CASE COVERS
LEFT (1PC)

17.

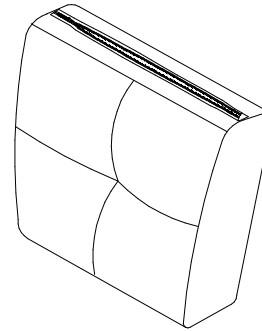

PILLOW CASE COVERS
RIGHT (1PC)

HARDWARE LIST

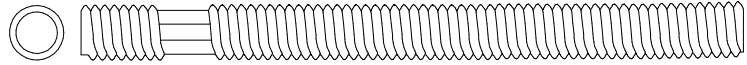

A

12PCS

5/16 x 80mm

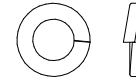

B

28PCS

Spring Washer 5/16

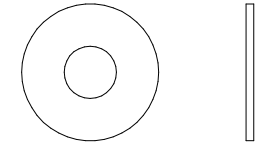

C

28PCS

Flat Washer 5/16 x 22mm

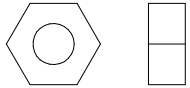

D

20PCS

Hex Nut 5/16 x 12mm



E

1PC

T Spanner

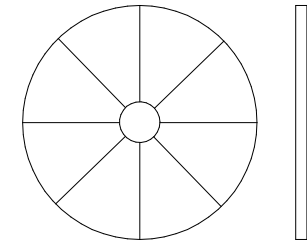

F

8PCS

Plastic Washer

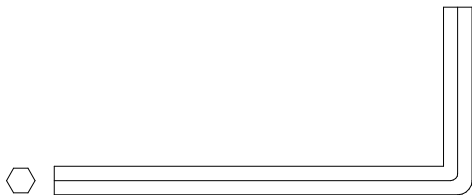

G

1PC

Allen Key M4



H

1PC

Allen Key M5

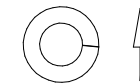

I

8PCS

Spring Washer 1/4

1 : 1



HARDWARE LIST

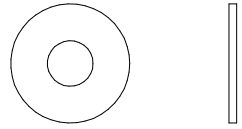

J

8PCS

Flat Washer 1/4 x 16mm

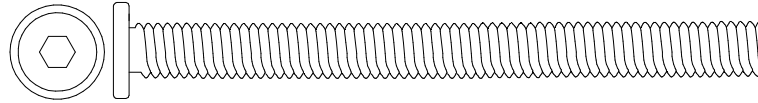

K

8PCS

JCBB Bolt 5/16 X 80mm

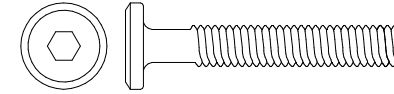

L

8PCS

JCBC Bolt 1/4 X 40mm

1 : 1



M

2PCS

Connector

ASSEMBLY INSTRUCTION

STEP 1.

Open the cover cloth located behind the Left Side (1) and remove all parts and hardware.

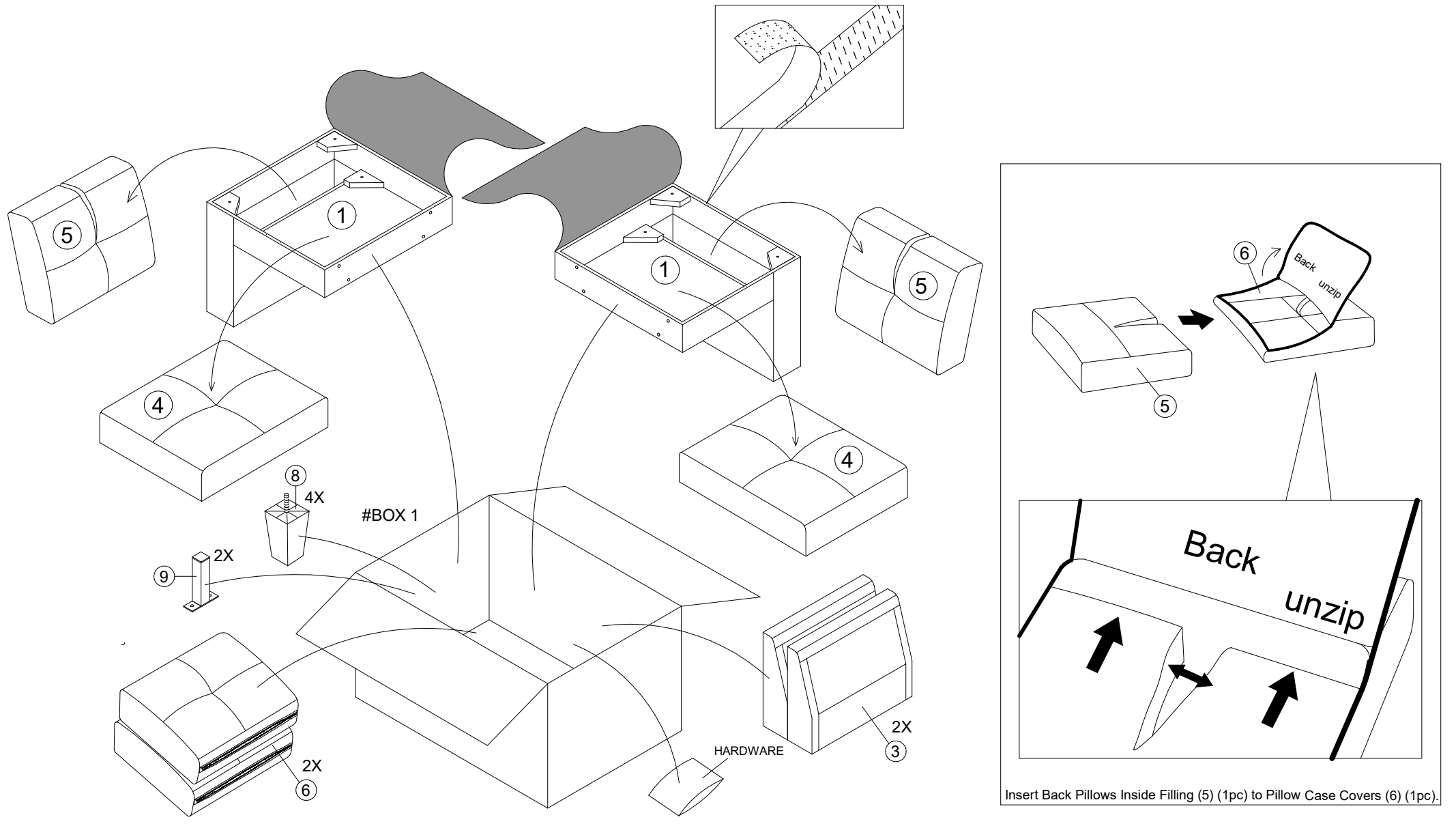

ASSEMBLY INSTRUCTION

STEP 2.

Open the cover cloth located behind the Right Side (2) and remove all parts and hardware.

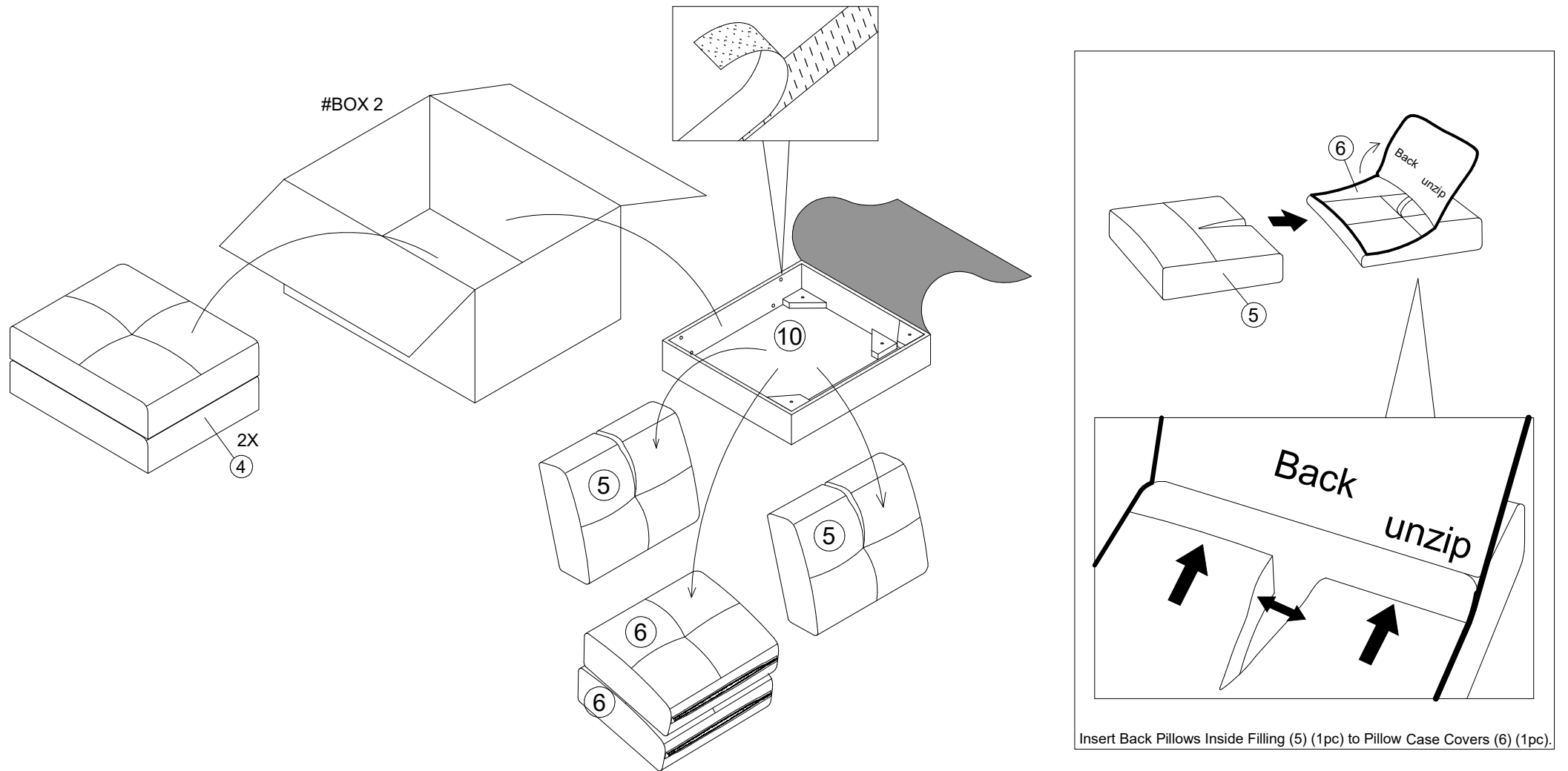

ASSEMBLY INSTRUCTION

STEP 3.

Open the cover cloth located behind the Chaise Base (R) (10) and remove all parts.

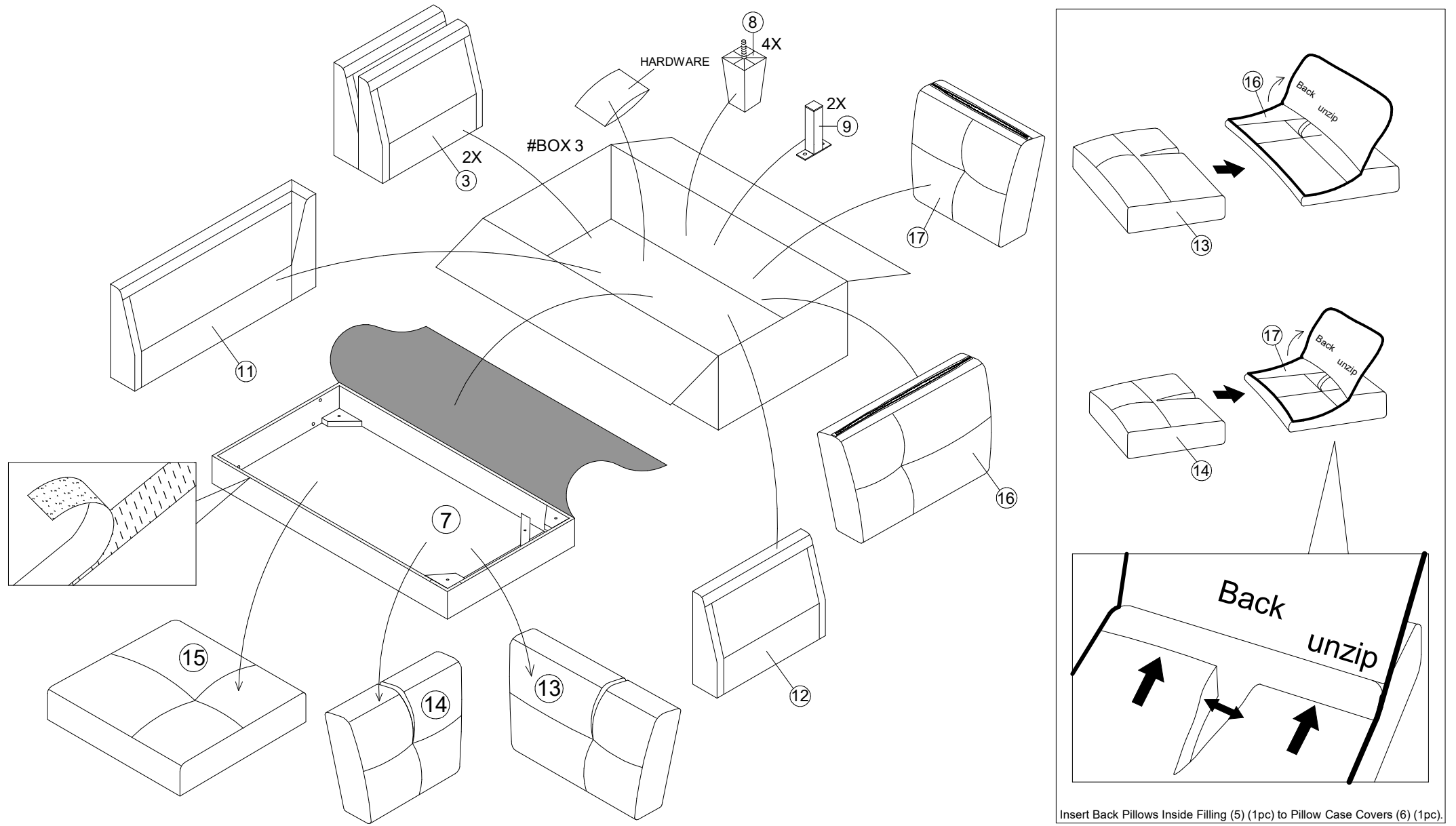

ASSEMBLY INSTRUCTION

STEP 4.

Attach 5/16 x 80mm (A) (12pcs) to Back Rest (3) (4pcs), Back Rest (11) (1pc) and Back Rest (12) (1pc).

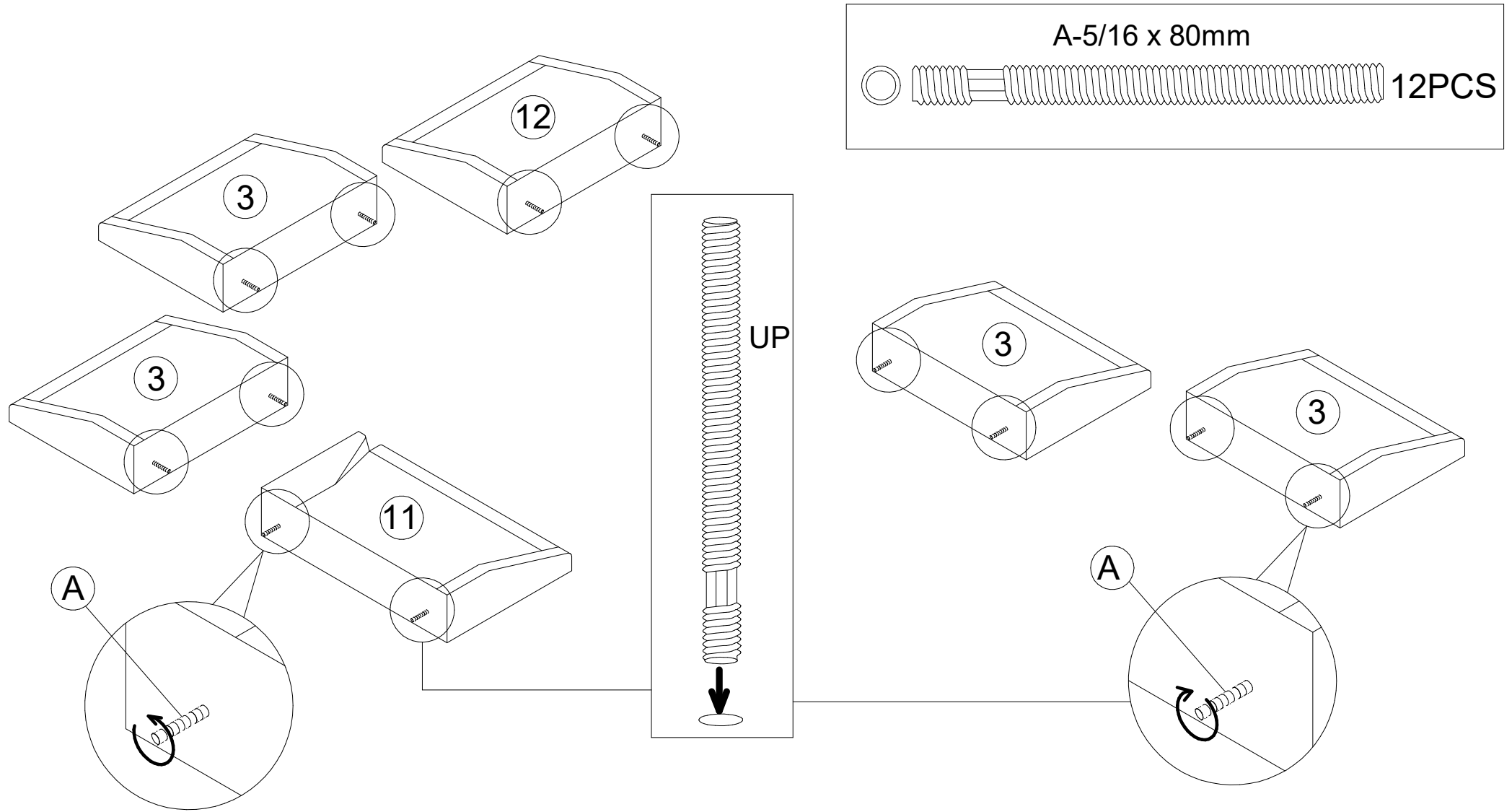

ASSEMBLY INSTRUCTION

STEP 5.
Attach the Back Rest (3) to Left Side (1), Back Rest (3), Back Rest (11) and Back Rest (12) to Chaise Base (L) (7). Use Spring Washer 5/16 (B) (8pcs), Flat Washer 5/16 x 22mm (C) (8pcs), Hex Nut 5/16 x 12mm (D) (8pcs) and T Spanner (E) to fix.

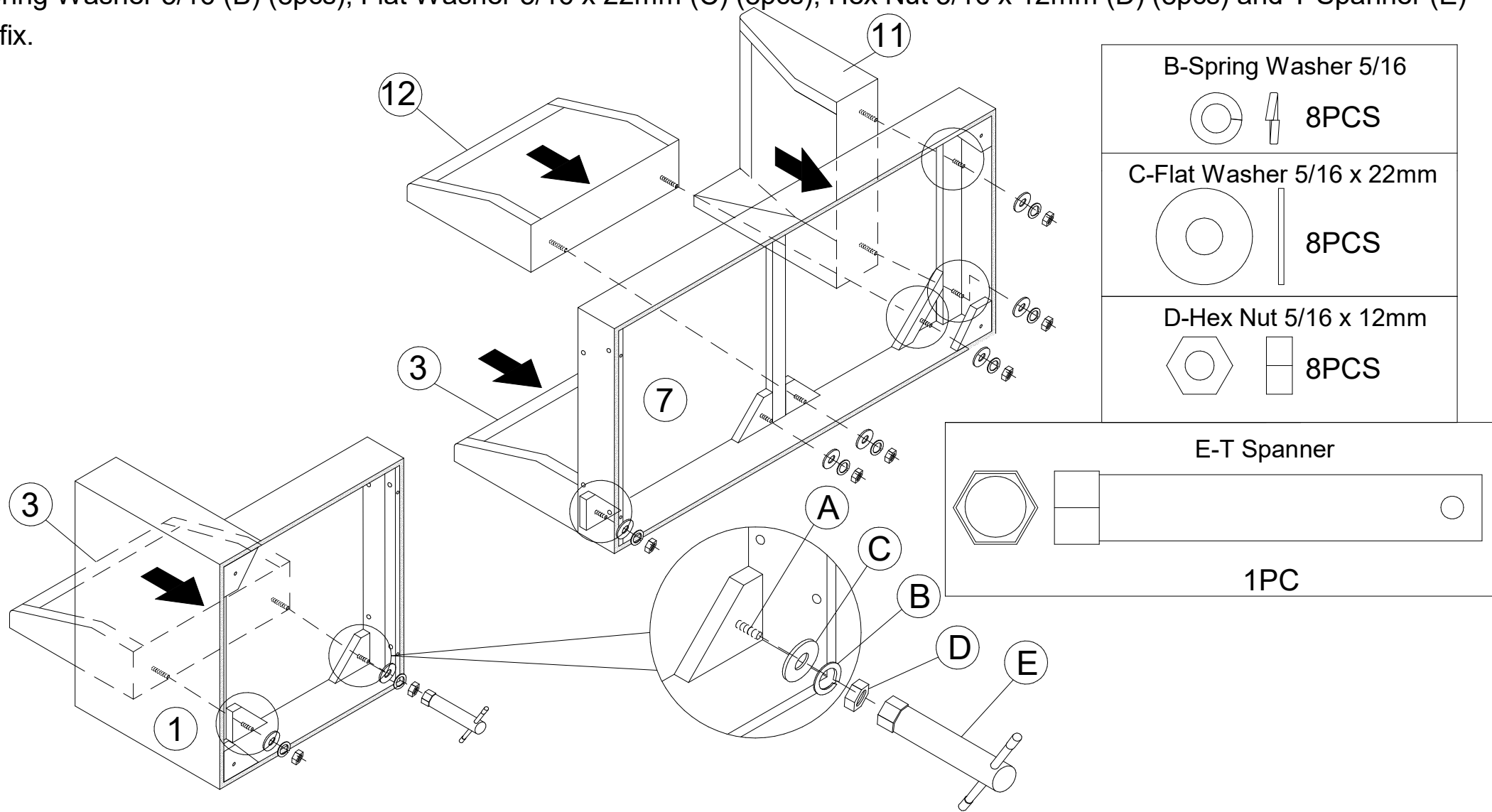

ASSEMBLY INSTRUCTION

STEP 6.

Attach Left Side (1) to Chaise Base (L) (7). Use JCBB Bolt 5/16 x 80mm (K) (4pcs), Spring Washer 5/16 (B) (8pcs), Flat Washer 5/16 x 22mm (C) (8pcs), Hex Nut 5/16 x 12mm (D) (4pcs), T Spanner (E) and Allen Key M5 (H) to fix.

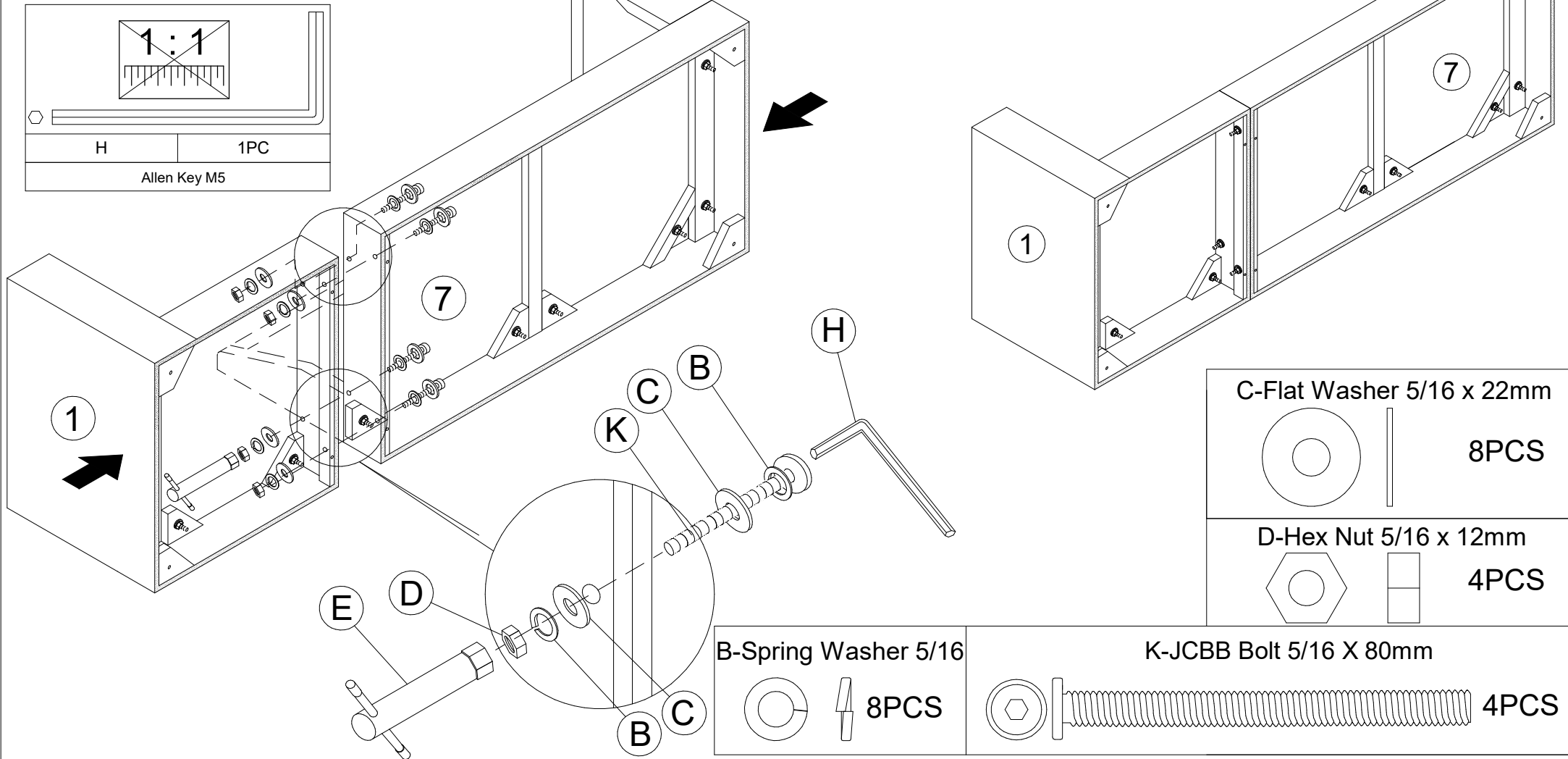

ASSEMBLY INSTRUCTION

STEP 7.

Closed a cover cloth. Attach Center Legs (9) (2pcs) to the center of the unit.

Legs are to be attached using JCBC Bolt 1/4 x 40mm (L) (4pcs), Spring Washer 1/4 (I) (4pcs), Flat Washer 1/4 x 16mm (J) (4pcs) and Allen Key (G) to fix. Attach Legs (8) (4pcs) and Plastic Washer (F)(4pcs) to the four corners of the unit.

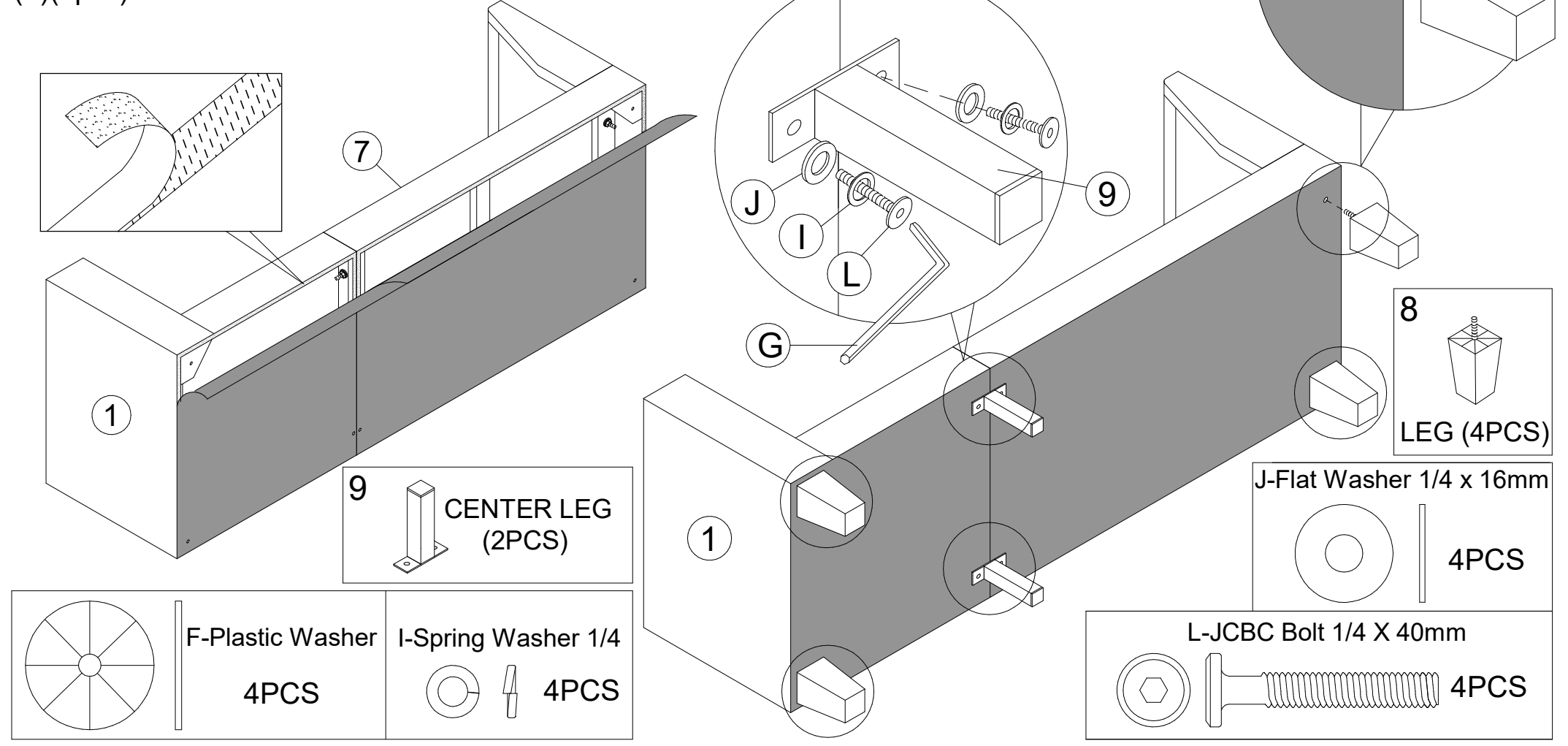

ASSEMBLY INSTRUCTION

STEP 8.

Attach the Back Rest (3) to Right Side (2) and Back Rest (3) to Chaise Base (R) (10). Use 5/16 x 80mm (A) (4pcs), Spring Washer 5/16 (B) (4pcs), Flat Washer 5/16 x 22mm (C) (4pcs), Hex Nut 5/16 x 12mm (D) (4pcs) and T Spanner (E) to fix.

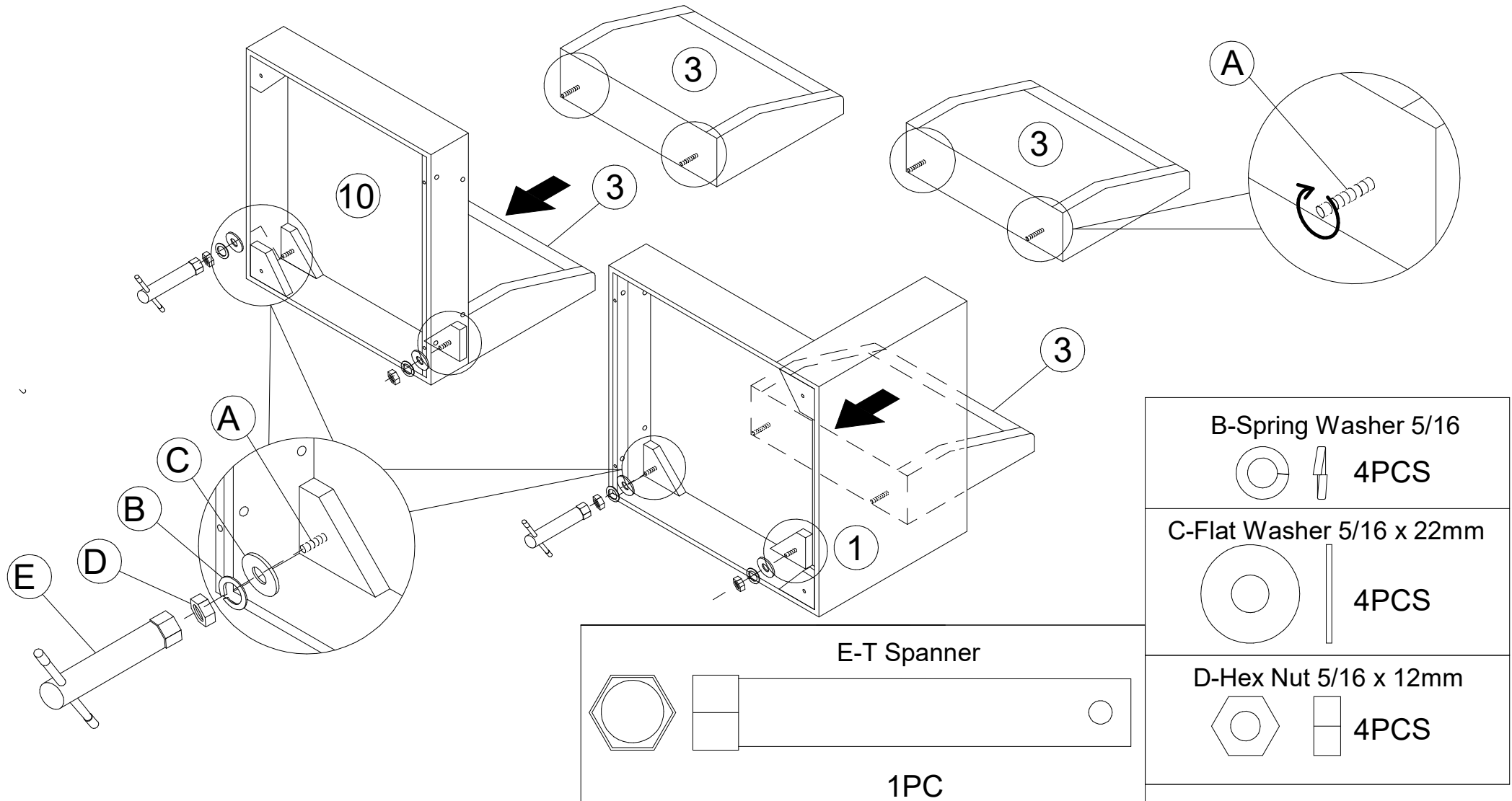

ASSEMBLY INSTRUCTION

STEP 9.

Attach Right Side (2) to Chaise Base (R) (10). Use JCBB Bolt 5/16 x 80mm (K) (4pcs), Spring Washer 5/16 (B) (4pcs), Flat Washer 5/16 x 22mm (C) (4pcs), Hex Nut 5/16 x 12mm(D) (4pcs), T Spanner (E) and Allen Key M5 (H) to fix.

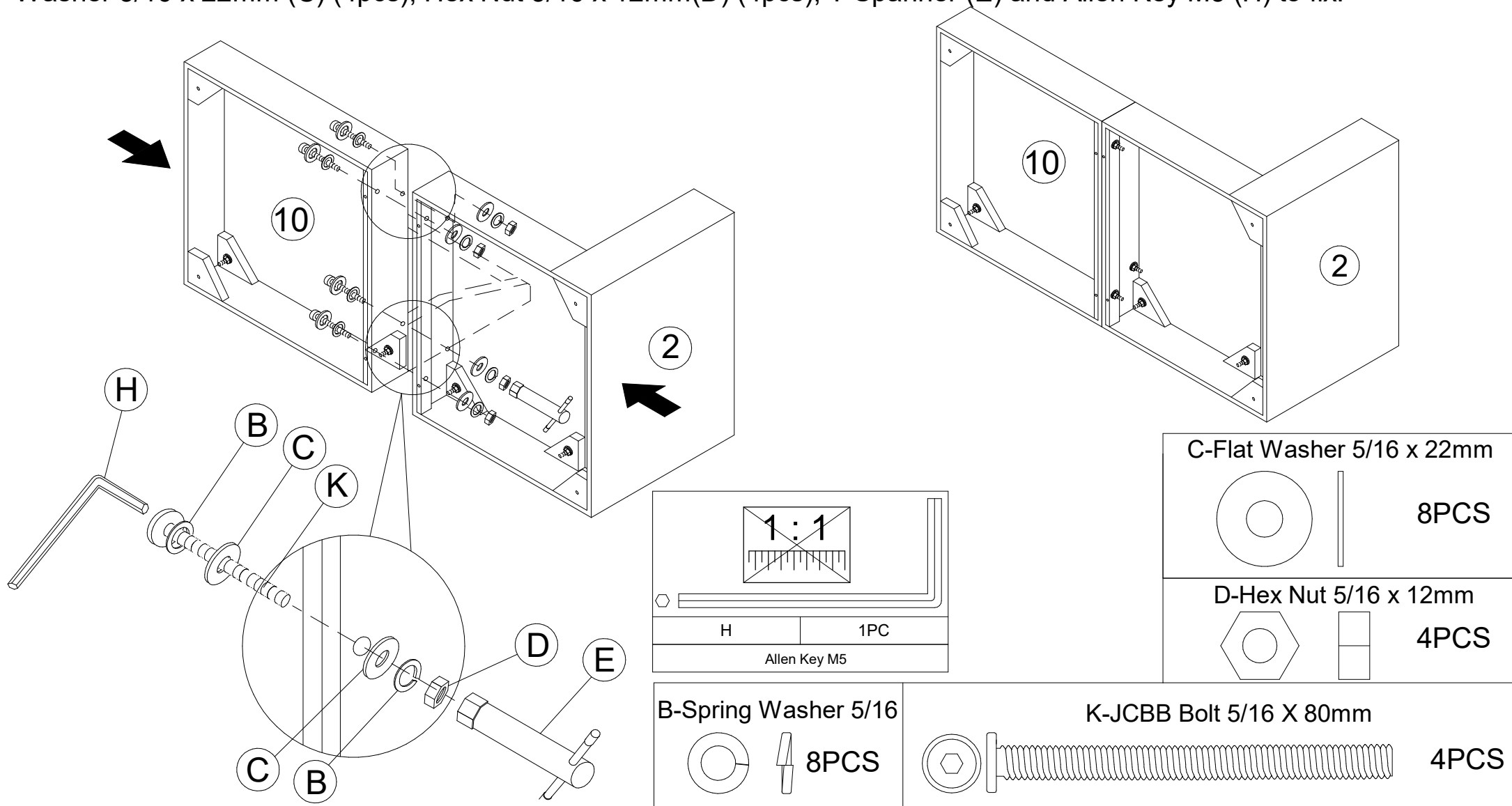

ASSEMBLY INSTRUCTION

STEP 10.

Closed a cover cloth. Attach Center Legs (9) (2pcs) to the center of the unit.

Legs are to be attached using JCBC Bolt 1/4 x 40mm (L) (4pcs), Spring Washer 1/4 (I) (4pcs), Flat Washer 1/4 x 16mm (4pcs) and Allen Key (G) to fix. Attach Legs (8) (4pcs) and Plastic Washer (F) (4pcs) to the four corners of the unit.

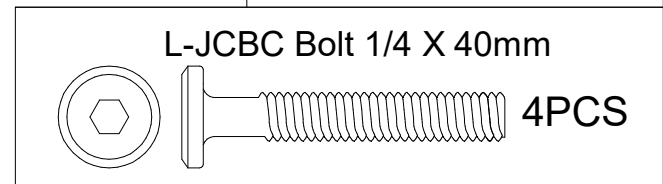
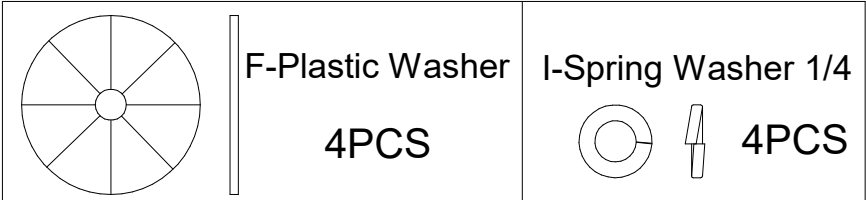
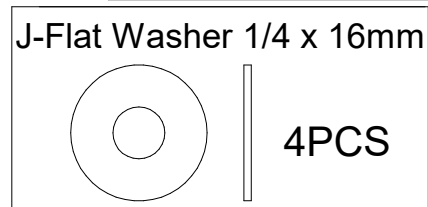
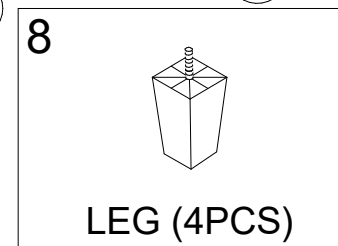
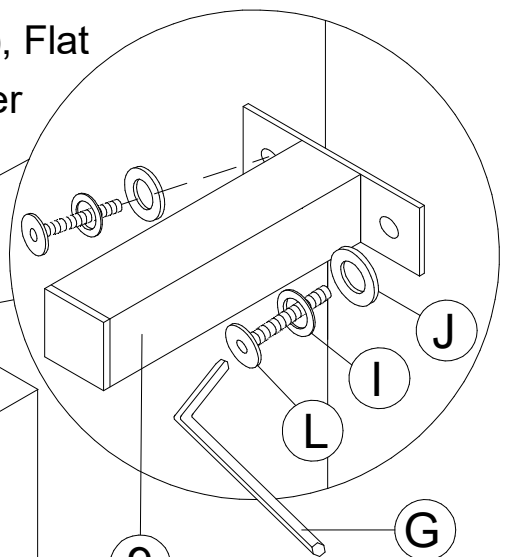
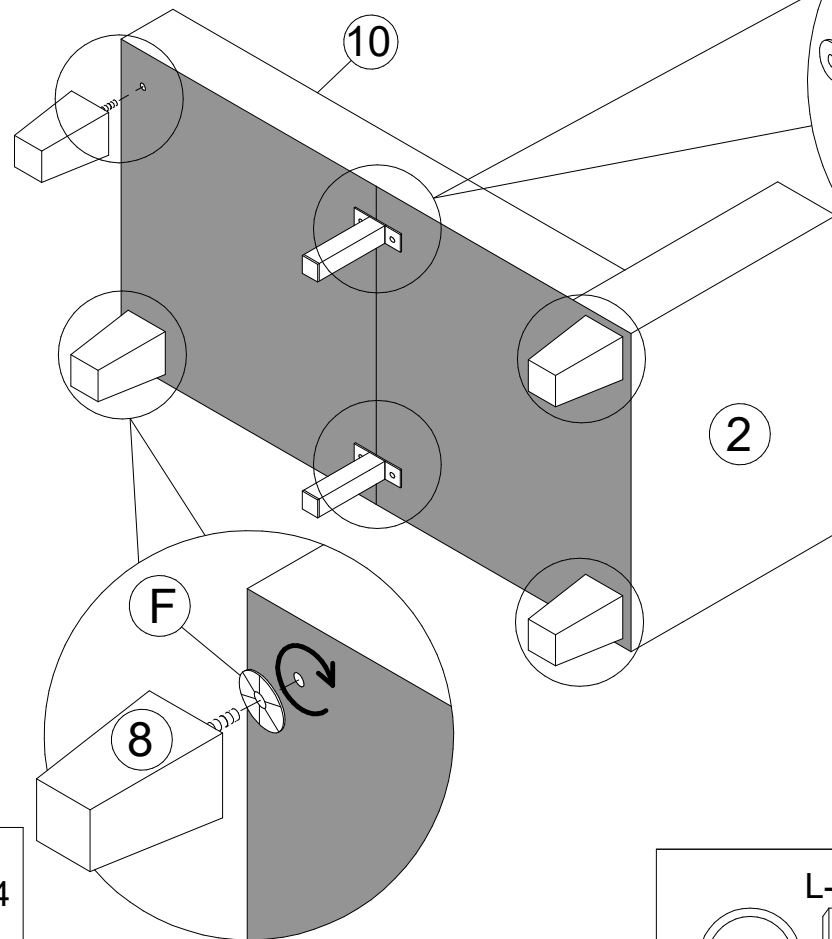
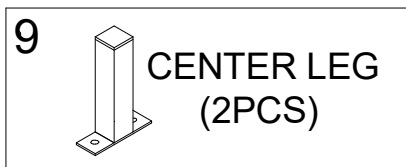
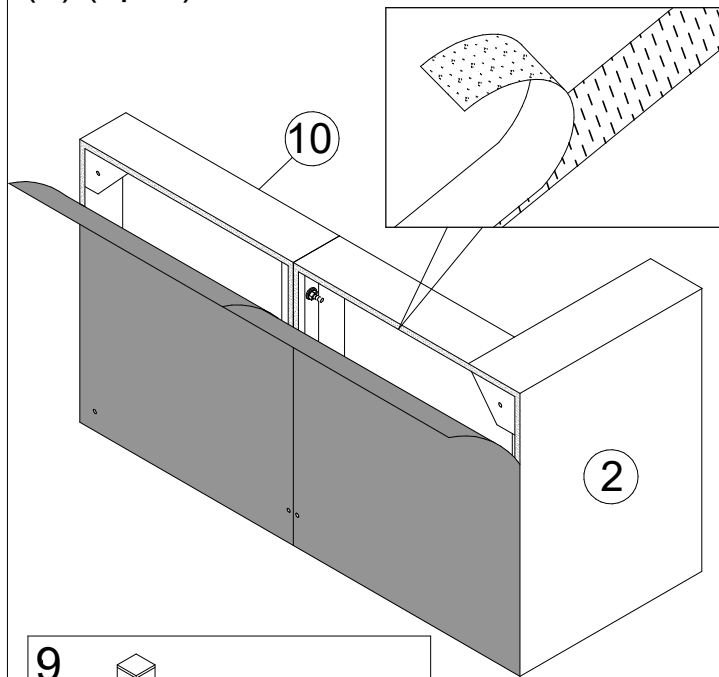

ASSEMBLY INSTRUCTION

STEP 11.

Use Connector (M) (2pcs) to set combinations Chaise Base (L) (7) and Chaise Base (R) (10).

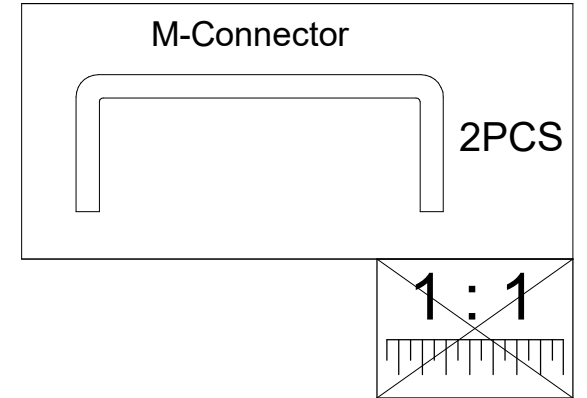
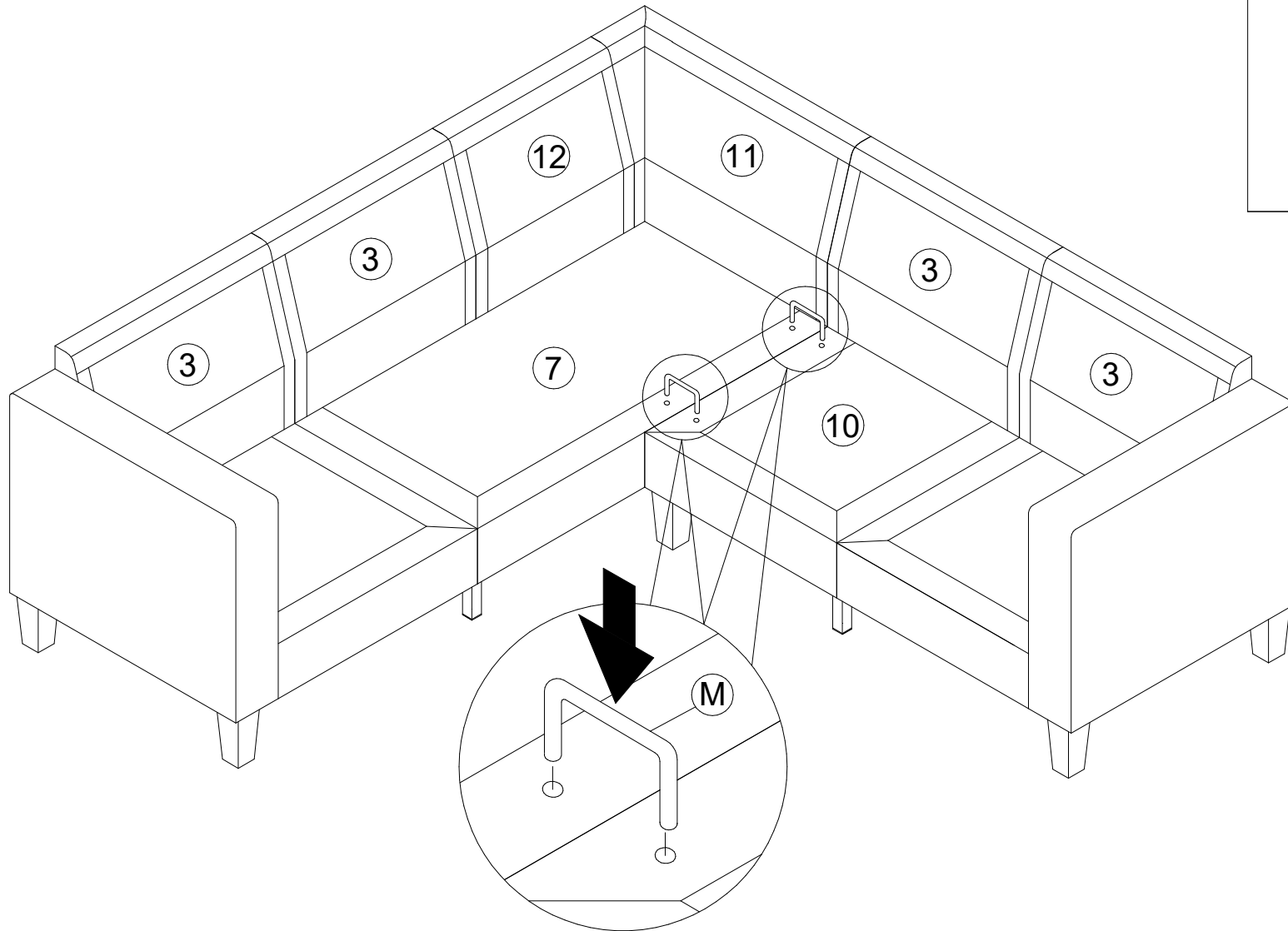

ASSEMBLY INSTRUCTION

STEP 12.

Attach the Seat Cushion (4) (4pcs) and Seat Cushion (Center) (15) (1pc).

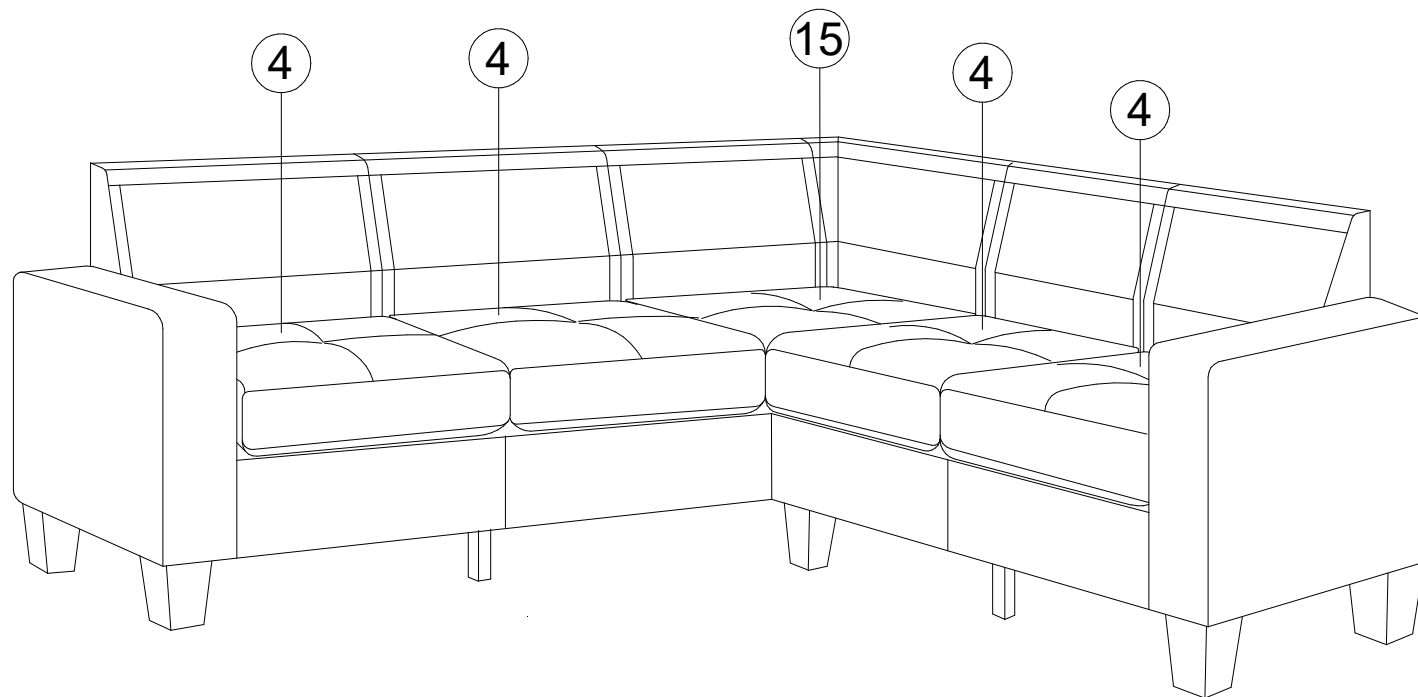

ASSEMBLY INSTRUCTION

STEP 13.

Lay Back Pillow (5) (4pcs), Back Pillow Left (13) (1pc) and Back Pillow Right (14) (1pc).

