

MOTION SENSOR CEILING LIGHT INSTALLATION & USER MANUAL

Model:V8947-PIR

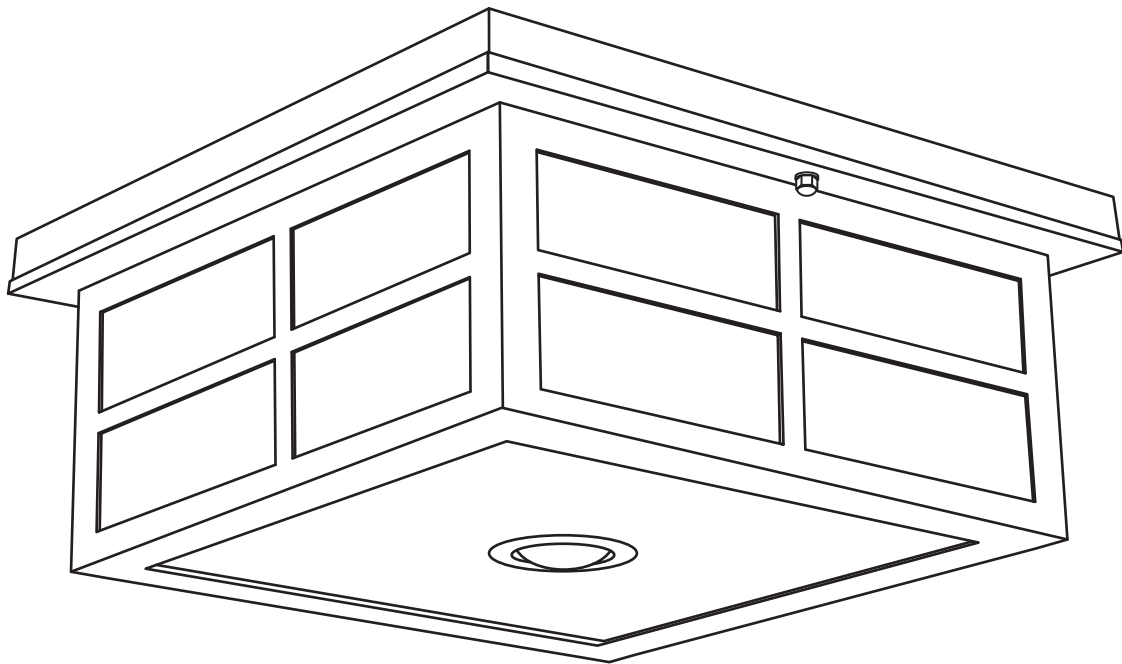

360°



INSTALLATION DIAGRAM

WIRE NUTS USE STEPS:

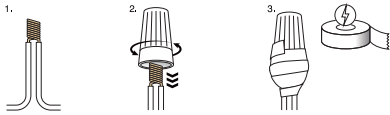

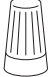
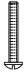
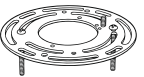
 Wire Nuts 3pcs	 Mounting Screws 2pcs	 Mounting Bracket 1pcs
---	--	---

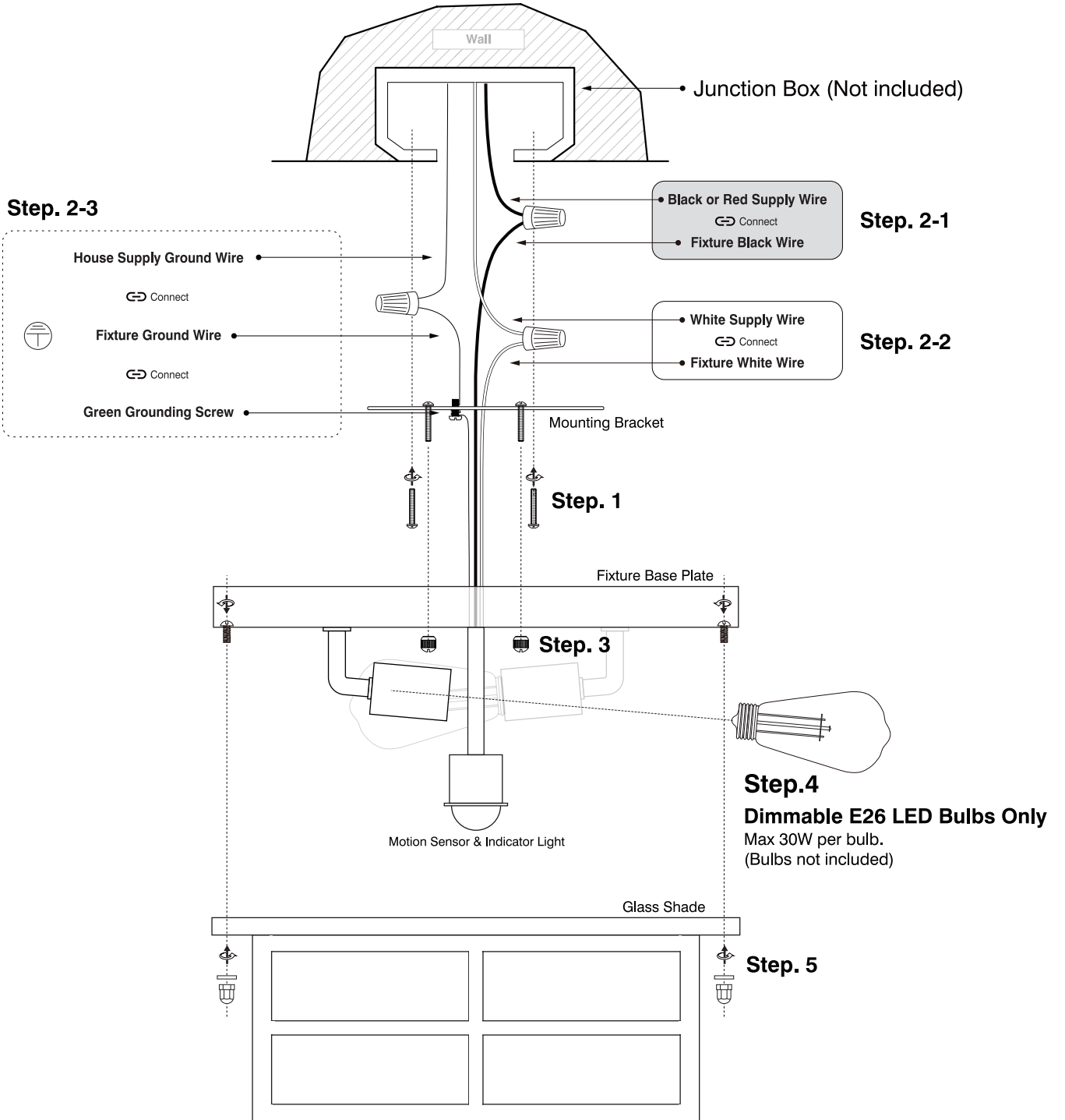

Do Not Use with Dimmers

Using a dimmer switch may damage the fixture's built-in sensor. This fixture has its own dimming function and does not require an external dimmer.

ASSEMBLY INSTRUCTIONS



INSTRUCTIONS PERTAINING TO RISK OF FIRE OR INJURY TO PERSONS
READ ALL INSTRUCTIONS
**IMPORTANT SAFETY
INSTRUCTIONS**
SAVE THESE INSTRUCTIONS

Before starting the installation, disconnect the Power by Turning Off the Circuit Breaker. Turning the Power Off using the Light Switch is not sufficient to prevent electrical shock. All electrical connections and installation must be following local codes, ordinances, and/or National Electric Code and Must Be Done by an Electrician Only.

TOOLS AND MATERIALS REQUIRED:



Phillips
Screwdriver



Wire Cutters



Pliers



Safety Gloves



Ladder

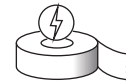

Electrical tape



Safety Glasses

INSTALLATION STEPS:

See diagram on page 1.

The product may differ slightly from the Stepures.

1. Attach the Mounting Bracket to the Junction Box (Step. 1)

Secure the Mounting Bracket to the Junction Box using two Mounting Screws.
(Ensure the side marked "GND" is facing downward.)

2. Make the Electrical Connections (Step. 2)

⚠ Must be performed by a licensed electrician in accordance with the National Electrical Code (NEC) and all local building codes.

Fixture black wire → Line (hot) from supply: black or red wire. (Step. 2-1)

Fixture white wire → Neutral from supply: white wire. (Step. 2-2)

Fixture ground wire (bare copper) → Mounting Bracket Green Grounding Screw → Supply ground wire (bare copper or green wire) (Step. 2-3)

After completing the wiring, carefully tuck the wires into the Junction Box.

3. Install the Fixture Base Plate (Step. 3)

Align the two center holes of the Fixture Base Plate with the downward-facing screws on the Mounting Bracket, then secure them using the Plastic Cap Nuts.

(Before proceeding with this step, make sure the two screws on the edge of the fixture base plate are secure and not loose.)

4. Install Two Dimmable E26 LED Bulbs, Bulbs not included. (Step. 4)

5. Install the Glass Shade. (Step. 5)

Attach the Glass Shade to the Fixture Base Plate using the Cap Nuts and waterproof washers.

7. Turn on the Power and Test the Fixture

1-YEAR LIMITED WARRANTY*

This light fixture is warranted against defects in material and quality for a 1-year period from the purchase date.

Exclusions from Warranty:

- Damage caused by acts of nature, such as lightning damage or corrosion and discoloration of components.
- Damages resulting from abuse, improper installation, electric surges, or actions of third parties.
- Costs related to removing and resealing the lighting fixture.
- Damage caused by incorrect installation orientation.

If this product fails for any reason covered by this warranty, feel free to contact us.

MOTION SENSOR QUICK GUIDE

Recommended installation height:
8 to 11 feet.

Detection range
Max. 26 ft × 360°

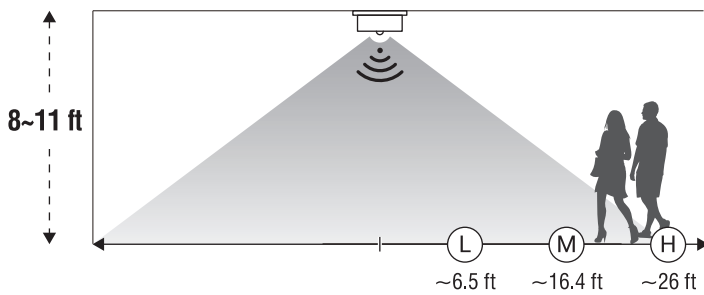

Note:
The detection distance shown is approximate and may vary with installation height and environment.

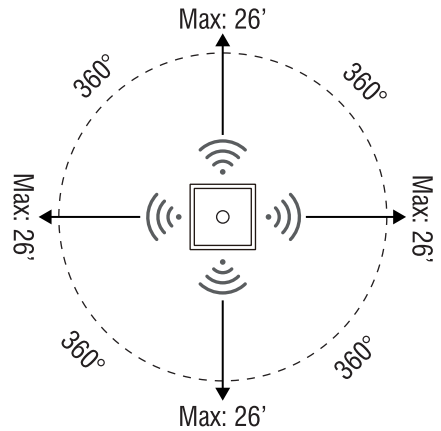

Quick Sensor Setup:

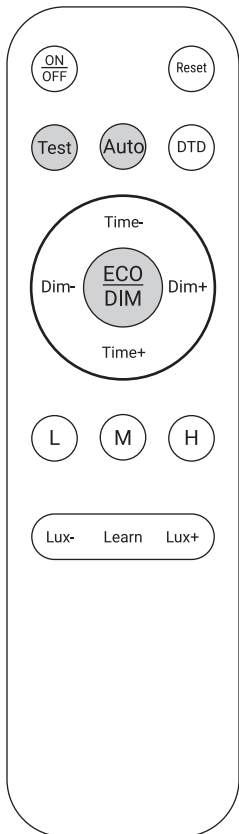

Installation test

When the fixture is powered on, it will illuminate for 15 seconds regardless of day or night, continuously testing the functionality of the fixture and bulb. When motion is detected, the light turns on at full brightness. After 2 minutes, Test Mode will automatically exit and revert to the last selected mode. (defaults to DIM Mode).

Notes:

- To re-enter Test Mode, press the **Test** button on the remote. Test Mode activated via remote will not exit automatically.
- The test mode is only for installation testing and is not a normal working mode.

Auto Mode (ECO or DIM)

After completing the initialization test, press the **Auto** button to enter Auto Mode. Then press the **ECO/DIM** button to switch between DIM and ECO modes.

The indicator light inside the sensor will display the current mode based on its color.

- **DIM Mode - Red Indicator Light**
The light stays on at low brightness when no motion is detected, and turns to full brightness when motion is detected.
- **ECO Mode - Green Indicator Light**
The light stays off when no motion is detected, and turns on at full brightness when motion is detected.

i Please refer to the Ceiling Light Motion Sensor Manual for more detailed function settings.