

ASSEMBLY INSTRUCTION

THANK YOU FOR PURCHASING THIS QUALITY PRODUCT.  
BE SURE TO CHECK ALL PACKING MATERIAL CAREFULLY FOR SMALL PARTS THAT MAY HAVE COME LOOSE INSIDE THE CARTON DURING TRANSIT.

STEP 1

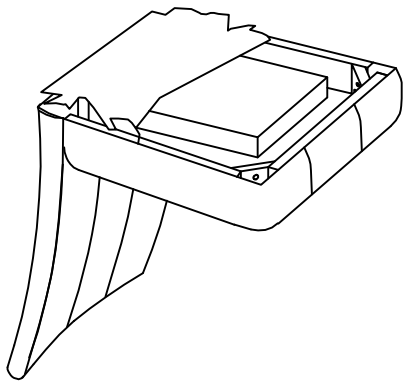

\* Please note: remove acrylic legs from the velcro compartment underneath the chair to assemble the unit

STEP 2

Secure screws into 80% when assembled the legs.

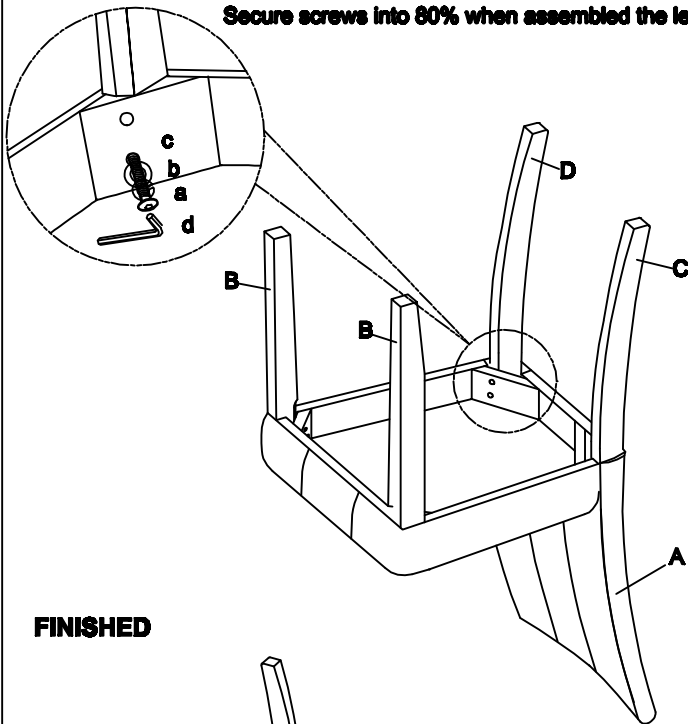

FINISHED

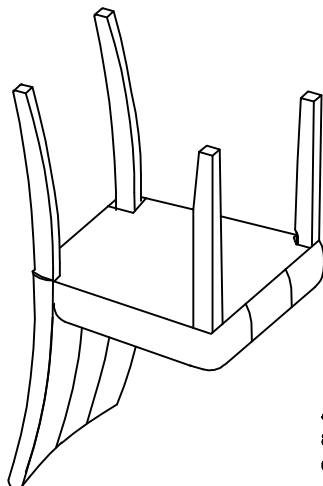

Adjust the product leveled on the ground after upside down, then tighten all screws completely.

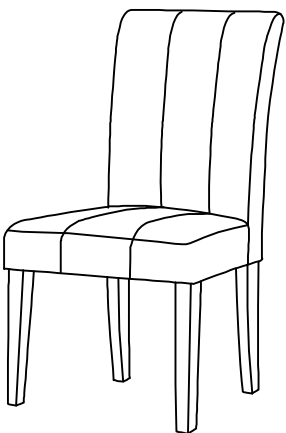

PART LIST

NO	DESC	SIZE (MM)	SKETCH	QTY
A	Seat	500x500x625mm		1 PC
B	Front Leg	430x40x40mm		2 PCS
C	Back Leg (L)	424x30x45mm		1 PC
D	Back Leg (R)	424x30x45mm		1 PC

HARDWARE LIST

NO	DESC	SIZE (MM)	SKETCH	QTY
a	Bolt	8x63.5mm		8PCS
b	Spring Washer	8mm		8PCS
c	Flat Washer	8x22mm		8PCS
d	Allen Key	5mm		1PC