

# Assembly Instructions

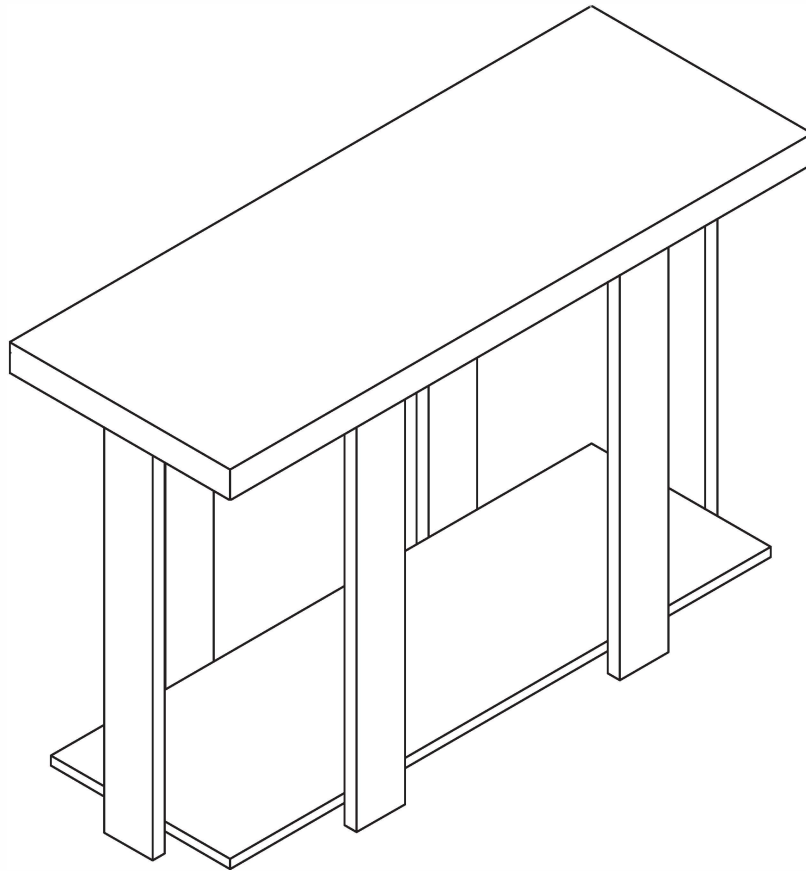

## ASSEMBLY RATING

The Assembly Rating is a 5-point system that shows the degree of effort needed in assembling a specific product (with 1 being easy and 5 being difficult). For some products, two persons are recommended.

EASY



DIFFICULT

## Tools Required For Assembly:

Allen Wrench



2 PERSONS RECOMMENDED

# ASSEMBLY & CARE ADVICE

FOR YOUR FURNITURE TO LAST, CORRECT ASSEMBLY AND PROPER MAINTENANCE ARE NECESSARY. PLEASE FOLLOW THE INFORMATION PROVIDED BELOW TO FULLY ENJOY YOUR FURNITURE.

## BASIC ASSEMBLY TECHNIQUES

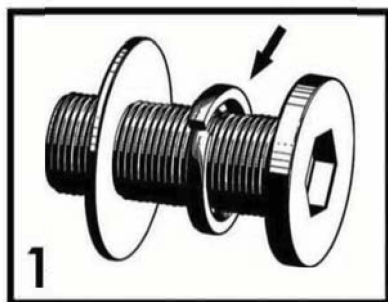

When lock or spring washer is used in an assembly, please make sure the lock or spring washer is placed between the larger flat washer and the head of the screw or bolt.



Position each part correctly and insert screws or bolts into their respective holes by hand tighten or using the proper hand tool. Only tighten when step is completed or when instructed to do so.

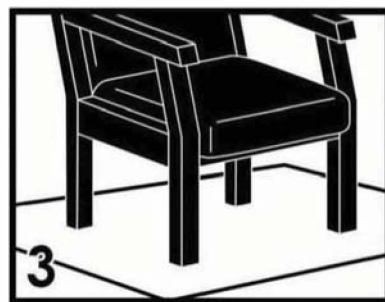

Use cardboard or carpet area when assembling furniture to prevent scratches. Make sure the furniture rests on a flat and level surface with each leg evenly touching the floor.

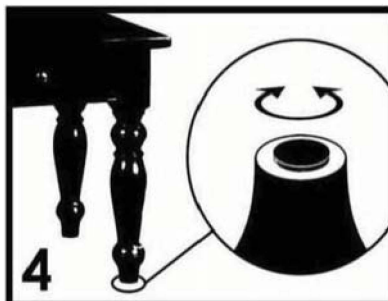

Some furniture comes with height adjustment knobs underneath each leg. To lower or to raise each leg, you need to turn clockwise or counterclockwise, respectively.

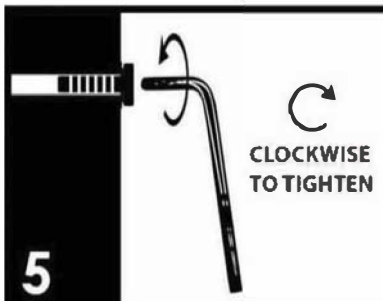

Make sure all parts are properly aligned, then use the appropriate hand tool to completely tighten the bolts or screws. Do not use power tools and do not overtighten.

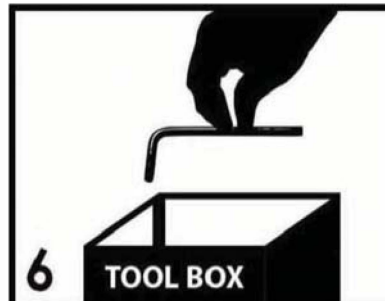

Save the instructions and store the Allen wrench or any supplied tool for later maintenance. After two weeks, check and tighten any loose hardware and repeat again every six months thereafter.

IT IS THE USER'S RESPONSIBILITY TO MAINTAIN THE FURNITURE. THE HARDWARE MAY LOOSEN OVER TIME AND MAY CAUSE THE FURNITURE TO BE WOBBLY AND UNABLE TO SUPPORT ITS INTENDED WEIGHT CAPACITY. THIS MAY LEAD TO COLLAPSE AND MAY CAUSE SERIOUS INJURY.



FAILURE TO FOLLOW THE GUIDELINES ABOVE MAY RESULT IN INJURY AND/OR PROPERTY DAMAGE.

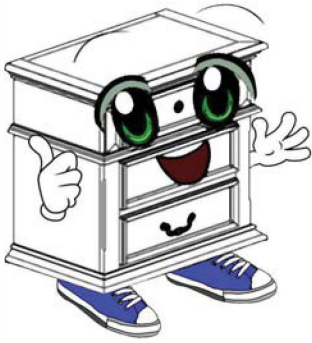

Before you begin, please read Page 2 of "Assembly and Care Advice".

And remember, do not tighten until each step is completed or instructed.

### Parts List

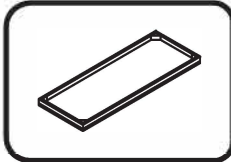

#1 x 1pc  
Table Top

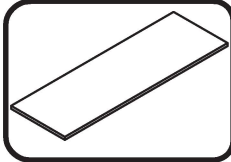

#2 x 1pc  
Bottom Panel

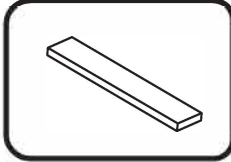

#3 x 6pcs  
Table Leg

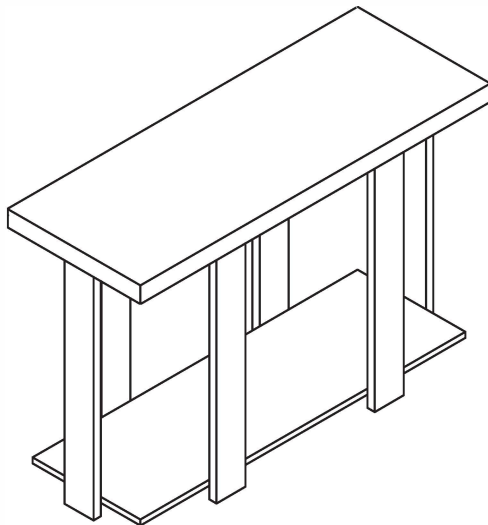

### Hardware List



#A x 12pcs  
Bolt 1/4X1-9/16"

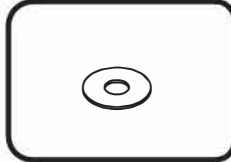

#B x 12pcs  
Flat Washer



#C x 12pcs  
Lock Washer

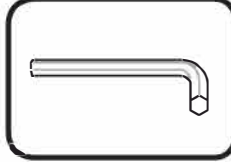

#D x 1pc  
Allen Wrench M4

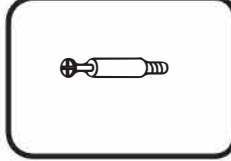

#E x 6pcs  
Cam Bolt



#F x 6pcs  
Cam Lock

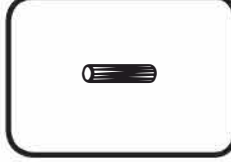

#G x 12pcs  
Wood dowel



#1

1. Insert a cam bolt (#E) into the center pre-drilled hole of the table leg (#3) and secure using a Phillips screwdriver. Then insert a wood dowel (#G) into the remaining two holes.

#E X 6PCS  
#F X 6PCS  
#G X 12PCS

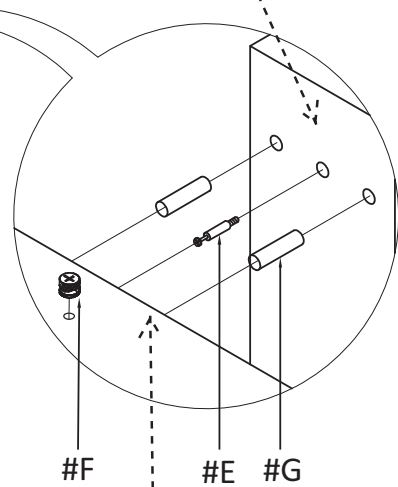
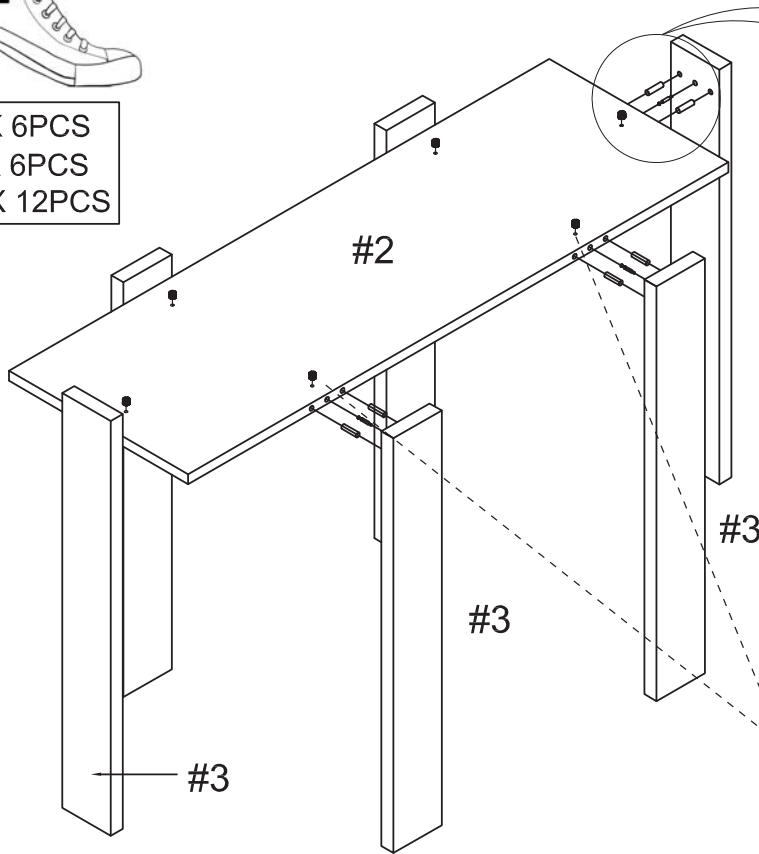

2. Insert the other ends of the cam bolts (#E) and wood dowels (#G) into the holes along the sides of the bottom panel (#2).

3. Insert 6 cam locks (#F) into the pre-drilled holes on top of the bottom panel (#2). Align the opening side of the cam lock to the cam bolt and secure using a Phillips screwdriver.



#2

2. Place the the other ends of the table legs (#3) onto the table top (#1) and align to the pre-drilled holes.

#A X 12PCS  
#B X 12PCS  
#C X 12PCS

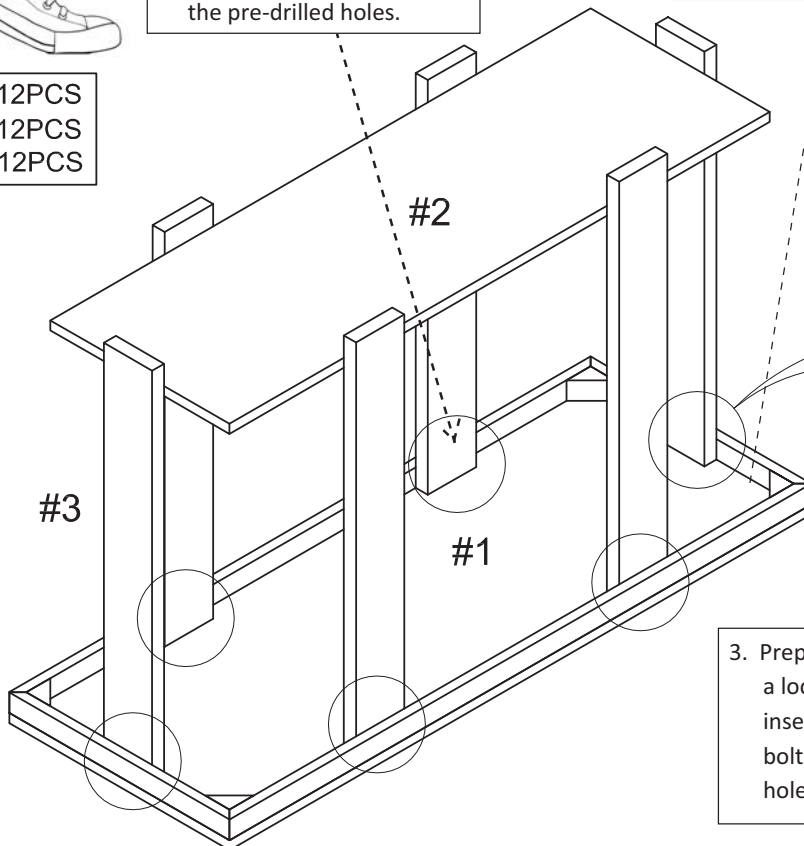

1. Place the table top (#1) face down onto a protected surface.

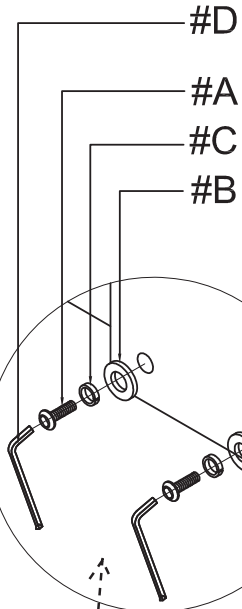

3. Prepare 12 bolt assemblies by first inserting a lock washer (#C) onto the bolt (#A) then insert a flat washer (#B) onto that same bolt (#A). Insert the bolts into the pre-drilled holes along the inner part of the legs (#3).



Carefully turn the completed table upright. Make sure the table is rested on a flat surface and does not feel loose or wobbly. If it does, double check that the bolts are secured and properly tightened.

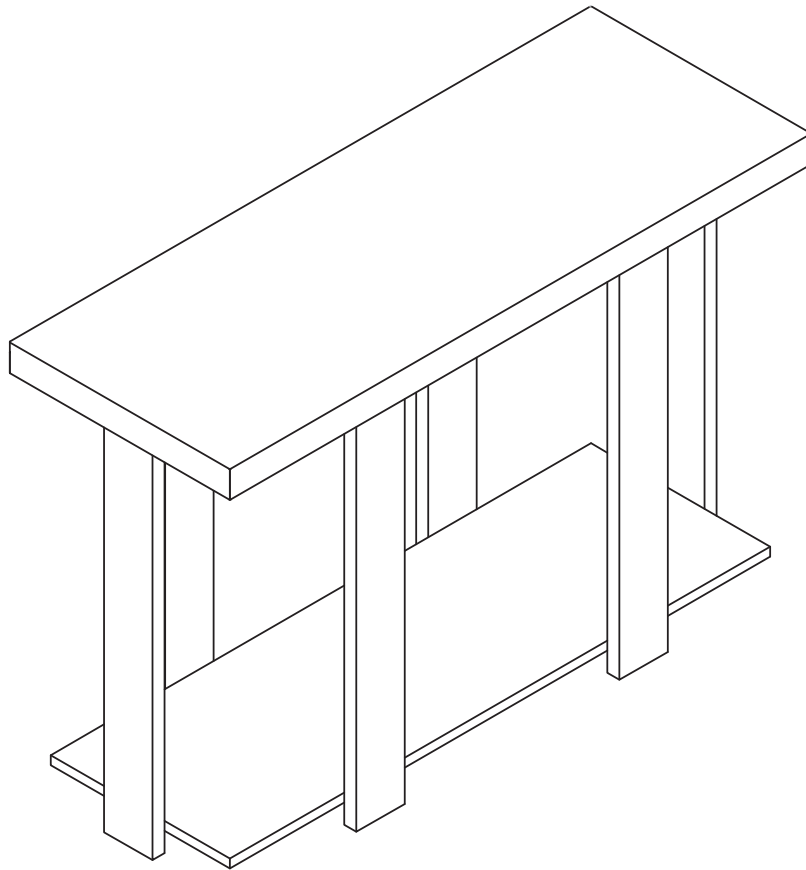

**ASSEMBLY IS COMPLETED**