

Michael Amini

LIGHTING

ITEM NO:LT-CH917-37GLD

***Congratulations on your purchase of Michael Amini Lighting!
You have selected a quality product that offers unique styling and built to last.
We thank you for your purchase and know you will be satisfied as you entertain friends and family!***

IMPORTANT SAFETY INSTRUCTIONS:

Before Assembly/Installation:

- * If you are unfamiliar with electrical wiring, we recommend you obtain the services of a qualified electrician.
- * The manufacturer and distributor accepts no liability for incorrect installation.
- * This fixture has been rated for maximum 25-watt E12 standard bulbs. Do not exceed the recommended wattage.
- * The ceiling must have a holding capacity of 495 lbs.
- * For indoor use only.
- * Components of this fixture are pre-wired. Use caution when removing from packaging .
- * Deviation from instructions may result in a risk of fire or electric shock.

PRODUCT DESCRIPTION:

General material:Crystal, Metal and Glass

Height: 95.0 cm (37½")

Diameter: 120.0 cm (47½")

Weight:45kg (99Lbs)

Grounded/Hardwired

TO ASSEMBLE:

- 1.Thread the main wire through the Ceiling Hook(1),secure with Mounting Screws(2) onto the ceiling;Connect Hang Straight (3) to Ceiling Hook (1);
- 2.Cover the Ceiling Hook (1) with Canopy (4);
- 3.Secure Canopy (4) with Ring (5) to the Ceiling Hook (1);
- 4.Hook and lock Chain (6) to Quick Link (7) to both Canopy and Hang Straight (8);
- 5.Install Glass Vase (9) to Hang Straight (8) & Iron Slice (10).
- 6.Connect the wire,twist with the Wire Connectors (27);
- 7.Attach Frame Arm (18) onto Iron Slice (10) & (20) as shown;
- 8.Install components (13),(14),(15),(16),(17) onto Frame Arm (18) as shown;
9. Install components (19),(22), (23),(24), (25),(26) onto Iron Slice (20) with Hardware (21), (22);
- 10.Install all the crystals as per Crystal Assembly Instruction;
- 11.Connect all the cables/wires as per Cable Assembly Instruction;

CARE INSTRUCTIONS:

- 1.Make sure that the power is turned off and bulb has cooled before handling.
- 2.Wipe clean with a dry or damp cloth. Do not use corrosive cleaners.

Frame Assembly Instruction

ITEM NO:LT-CH917-37GLD

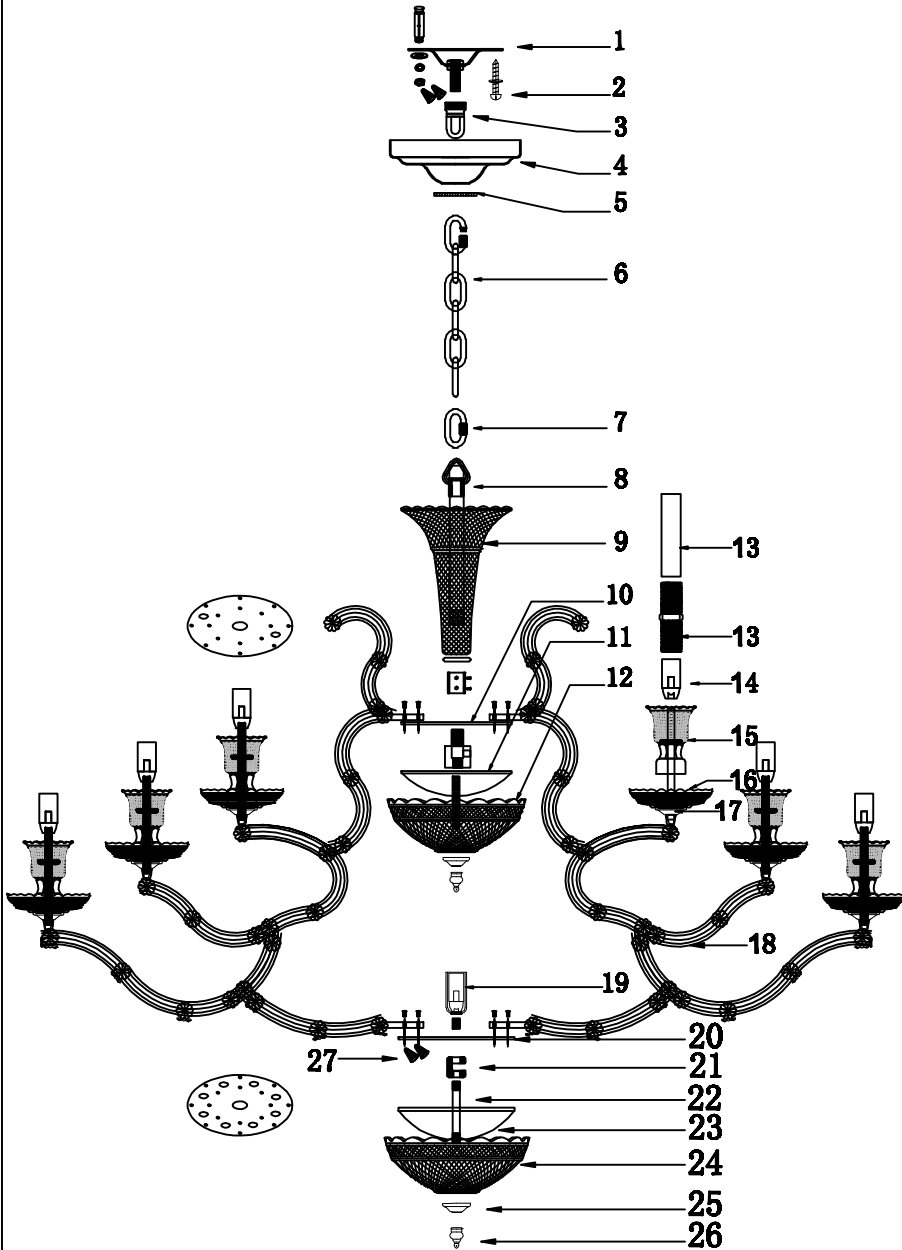

NO.	Photo	Name	Q'ty
1		Ceiling Hook	1
2		Mounting Screws (Not included)	4
3		Hang Straight	1
4		Canopy	1
5		Ring	1
6		Chain	1
7		Quick Link	2
8		Hang Straight	1
9		Glass Vase	1
10		Iron Slice	1
11		Semicircle	1
12		SM Dish	1
13		Candle Sleeve	36
		Glass Sleeve	36
14		Lamp Holder	37
15		Candle Cup	36
16		Candle Dish	36
17		Candle Base	36
18		Frame Arm	8
19		Bottom Lamp Cup	1
20		Iron Slice	1
21		Wire Feed Nut	1
22		Rod	2
23		Semicircle	1
24		LG Dish	1
25		Lamp Base	2
26		Finial	2
27		Wire Connector	13

Crystal Assembly Instruction

ITEM NO:LT-CH917-37GLD

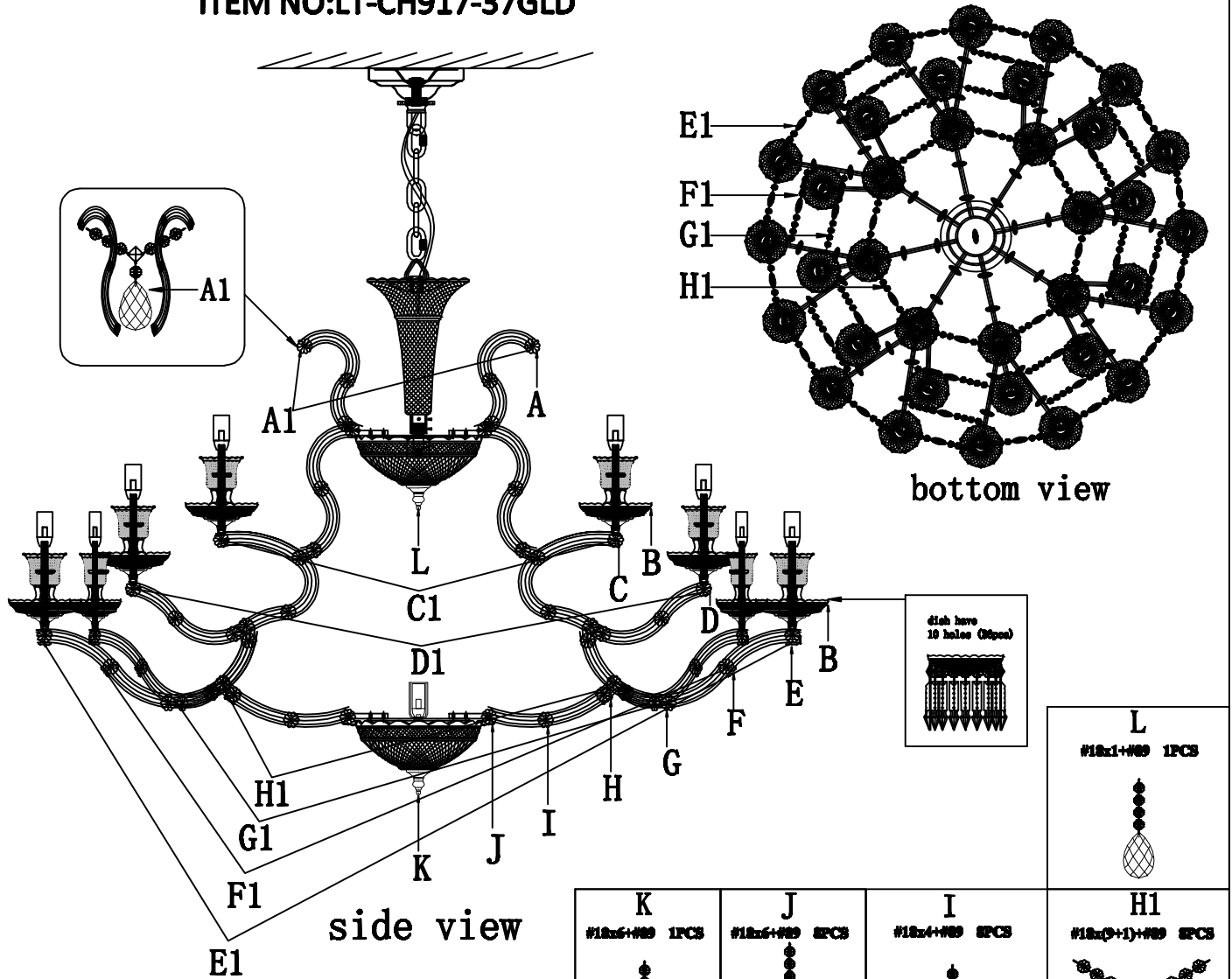

side view

bottom view

<p>D1 #18x(1)+#76 8PCS</p>	<p>E #18x3+#89 16PCS</p>	<p>E1 #18x(9)+1+#89 12PCS</p>	<p>F #18x3+#89 16PCS</p>	<p>F1 #18x(9)+1+#89 8PCS</p>	<p>G #18x2+#89 8PCS</p>	<p>G1 #18x(9)+1+#89 8PCS</p>	<p>H #18x4+#89 8PCS</p>
<p>A #18x1+#76 8PCS</p>	<p>A1 #18x(7)+1+#76 8PCS</p>	<p>B #18x1+#76 368PCS</p>	<p>C #18x1+#76 8PCS</p>	<p>C1 #18x(7)+1+#76 8PCS</p>	<p>D #18x1+#76 8PCS</p>	<p>L #18x1+#89 1PCS</p>	

Michael Amini

LIGHTING

Cable Assembly Instruction

ITEM NO:LT-CH917-37GLD

