

ASSEMBLY INSTRUCTIONS

Description: QUEEN BED

Thank you for purchasing this quality product. Be sure to check all packing material carefully for small parts that may have come loose inside the carton during shipment.

Step 1: Assembly HB (A), FB (B) with Leg (F).

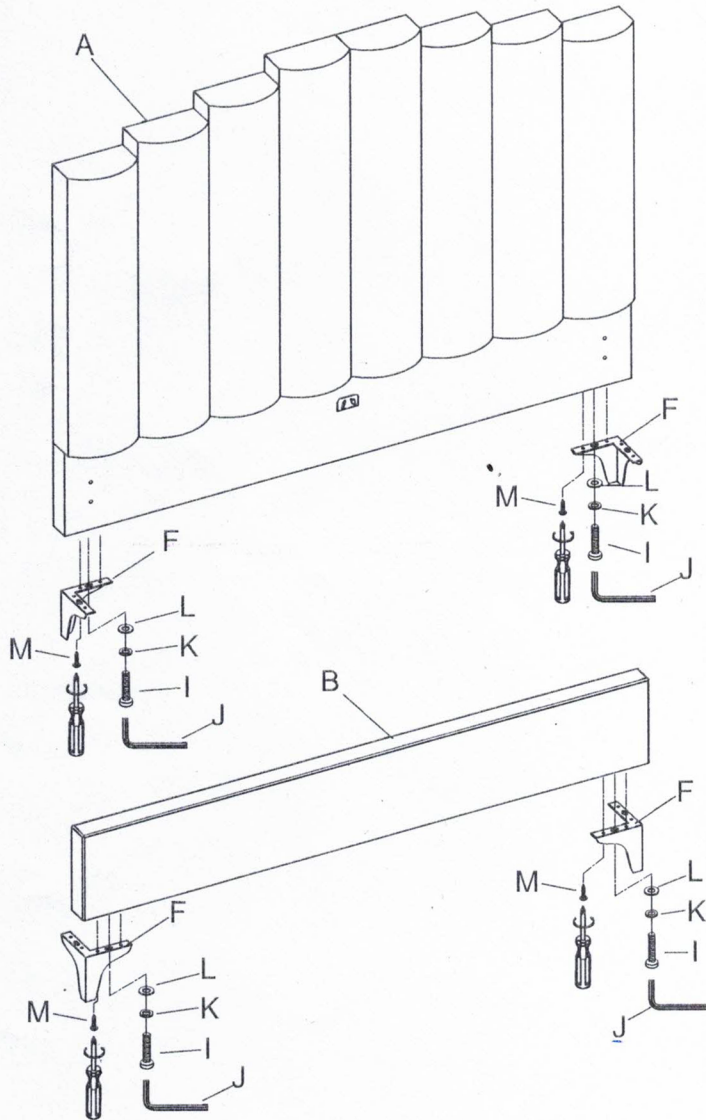

I	Bolt		Ø5/16*1-1/2"	4 PCS
K	Spring Washer		M8	4 PCS
L	Flat Washer		M8	4 PCS
J	Allen Key		M4	1 PC
M	Screw		Ø8*1"	8 PCS

TOOLS REQUIRED (NOT PROVIDED)

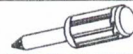

Philips Screwdriver

PARTS LIST:

No.	Description	Sketch	Quantity
A	Headboard		1 PC
B	Footboard		1 PC
C	Side Rail		2 PCS
D	Center Rail		1 PC
E	Center Rail Support Leg		3 PCS
F	Leg		4 PCS
G	Slats		1 SET

HARDWARE LIST:

No.	Description	Sketch	Size	Quantity
H	Bolt		Ø5/16*2"	4 PCS
I	Bolt		Ø5/16*1-1/2"	11 PCS
J	Allen Key		M4	1 PC
K	Spring Washer		M8	12 PCS
L	Flat Washer		M8	19 PCS
M	Screw		Ø8*1"	34 PCS
N	Spanner		M12	1 PC
O	Nut		M8	4 PCS

ASSEMBLY INSTRUCTIONS

Description: QUEEN BED

Thank you for purchasing this quality product. Be sure to check all packing material carefully for small parts that may have come loose inside the carton during shipment.

Step 2: Assembly Side Rail (C) with HB (A) & FB (B).

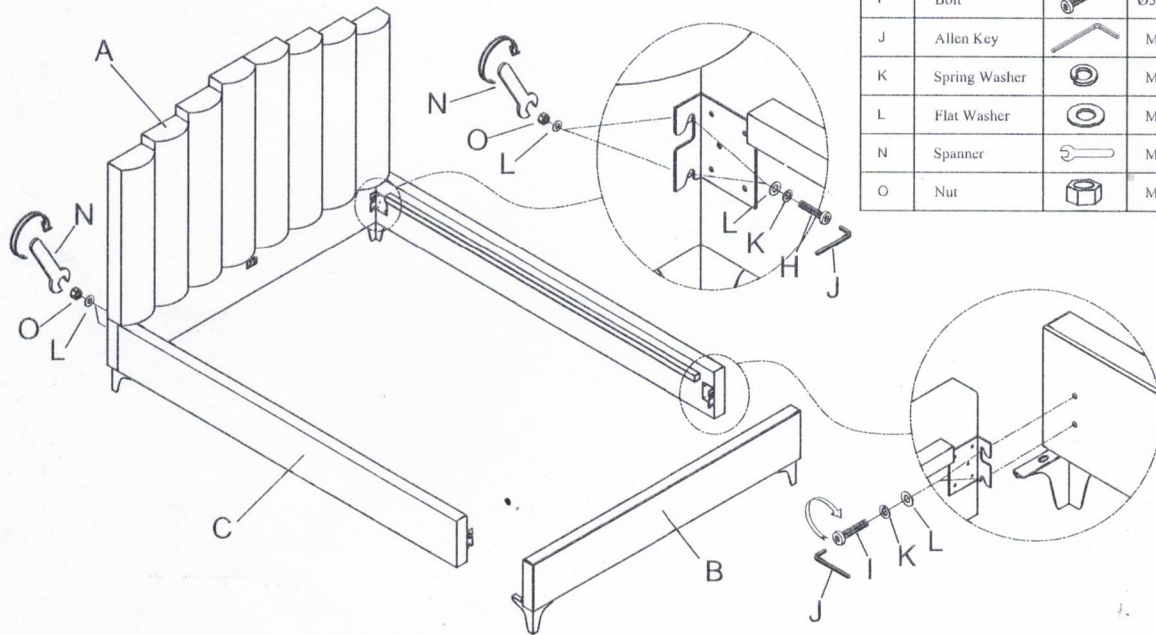

Step 3: Assembly Center Rail (D) with HB (A) & FB (B).

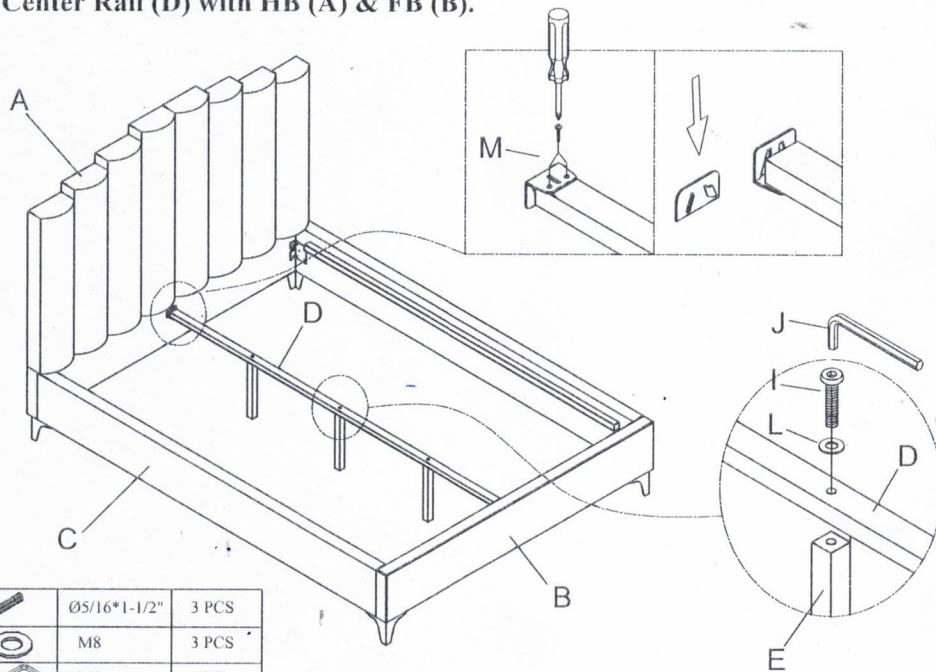

ASSEMBLY INSTRUCTIONS

Description: QUEEN BED

Thank you for purchasing this quality product. Be sure to check all packing material carefully for small parts that may have come loose inside the carton during shipment.

Step 4: Assembly slat(G) with side Rail(C).

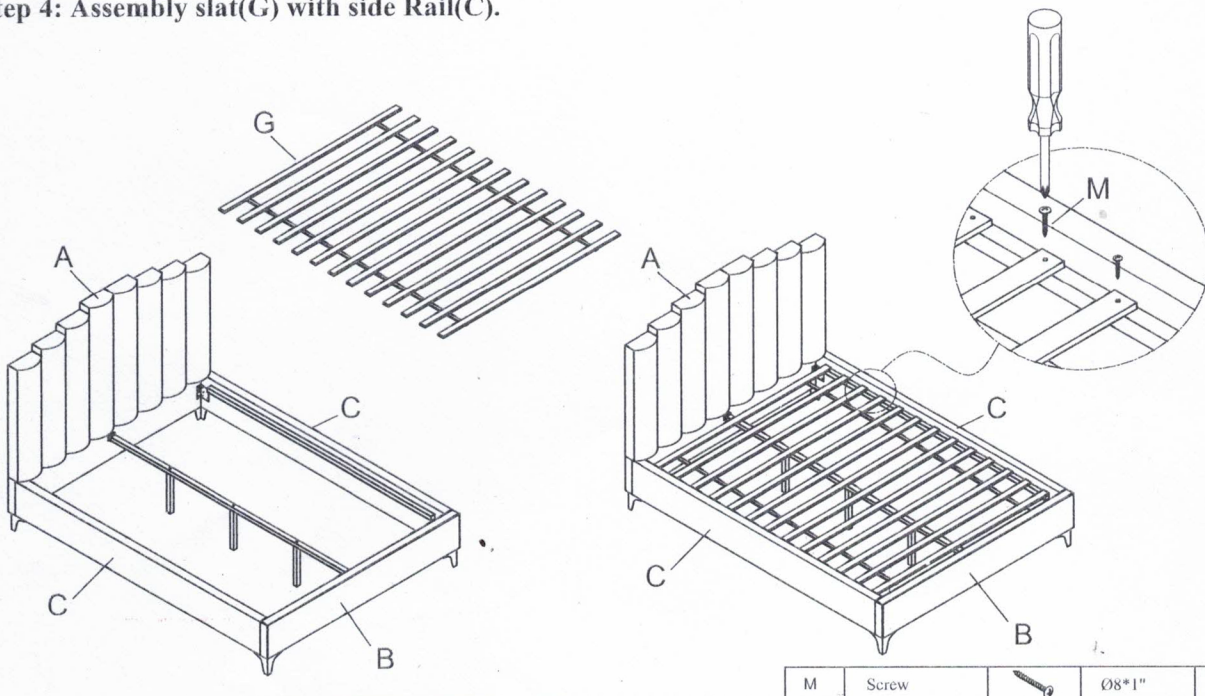

Step 5: Completed assembly for a regular bed.

