

Barrel Cabinet Instructions

Each barrel cabinet comes standard with 2 magnetic, rechargeable, motion-sensor LED lights.

On one end of each light bar, you will see the port for charging as well as the switch for OFF-ON-AUTO. (Charging is typically required once every 6 months or so.)

We recommend setting the light switch to AUTO. This will illuminate the light upon opening the cabinet door, and will shut off after 20 seconds without motion.



Next, locate the two pre-installed light brackets. Photo to left for the top one. One of the lights goes on the underside of the top barrel head and the second is for the underside of the shelf.

With the switch set to AUTO, raise the light bar into position so that the magnetic connection is made. The 'handle' of the light bar will be on right hand side as you look at the cabinet.

Shut the door of the cabinet, and allow the lights to shut off. Then open the door to confirm the motion sensor is positioned properly. If it does not turn on upon opening, simply tilt the light and sensor a bit more towards the door and you should be all set.

The two light bars will need to be recharged every so often, depending on use. Typically recharge is needed every 6 months. Simply remove from the cabinets, connect to the provided charging cabinet, and plug into any USB charger



750 Industrial Blvd, New Kensington, PA 15068

(724) 304-2674

www.MysticBarrels.com



Glass Top Tables:

Tools Required: Tape measure

- Step 1.** Place the barrel table base to your desired location. The glass tabletops sit on the four pre-installed rubber bumpers to help prevent the table from shifting.
- Step 2.** Clean the bottom side of the glass tabletop with window/glass cleaner.
- Step 3.** Center the glass top over the barrel.
- Step 4.** Use tape measure to confirm it is centered. Lift the table and reposition until centered on the barrel. Clean the top of the table and you're ready to go!

Step 1



Step 2



Step 3



Step 4



Wood Top Tables:

Tools Required:

- Tape measure
- Drill w/ Phillips head bit
- 3/32" drill bit (provided)

Step 1: Locate the 4 small holes drilled into the top barrel hoop.

Step 2: Using the **1" screws** and a Phillip's Head drill bit, pass the screw through the bracket and through the clearance hole in the barrel hoop. Secure the bracket to the barrel as shown.

Step 3: Ensure the bracket is facing downward and not at an angle. Secure the bottom screw into the barrel.

Continue same process for all 4 brackets.

Step 2

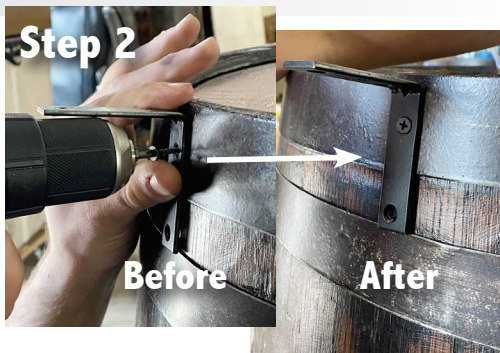

Step 3



Step 4



Step 4: Use a hammer to tap the end of the bracket downward so that it is level and flush with the top of the barrel.

Step 5: Align the grain of the wood in the direction you prefer. Most customers prefer to align the grain of the wood in line with the rivets and bung of the barrel base.

Step 5



Step 6



Step 6: Use the tape measure to ensure the table is centered around the barrel. Measure from barrel to edge of table top all the way around. Shift table top as needed to align.

Step 7!: Locate the provided 3/32" drill bit. Each of the 8 holes needs to be predrilled to approximately 1/2" depth.

The drill bits are painted with red past 1/2" depth. Simply drill the holes until the drill bit gets to the depth of the red line and then remove.

Repeat for all 8 bracket holes, being careful that the table does not shift. (Alternatively, you can pre-drill and then fasten each screw into place per step 8, one-by-one)

Step 7!



Step 8



Step 8: Secure the table top to the barrel using the **3/4" screws**.

Repeat for all 8 screw locations.