

**IMPORTANT - READ CAREFULLY - RETAIN
FOR FUTURE REFERENCE**

Gaming Bed

Assembly Instructions

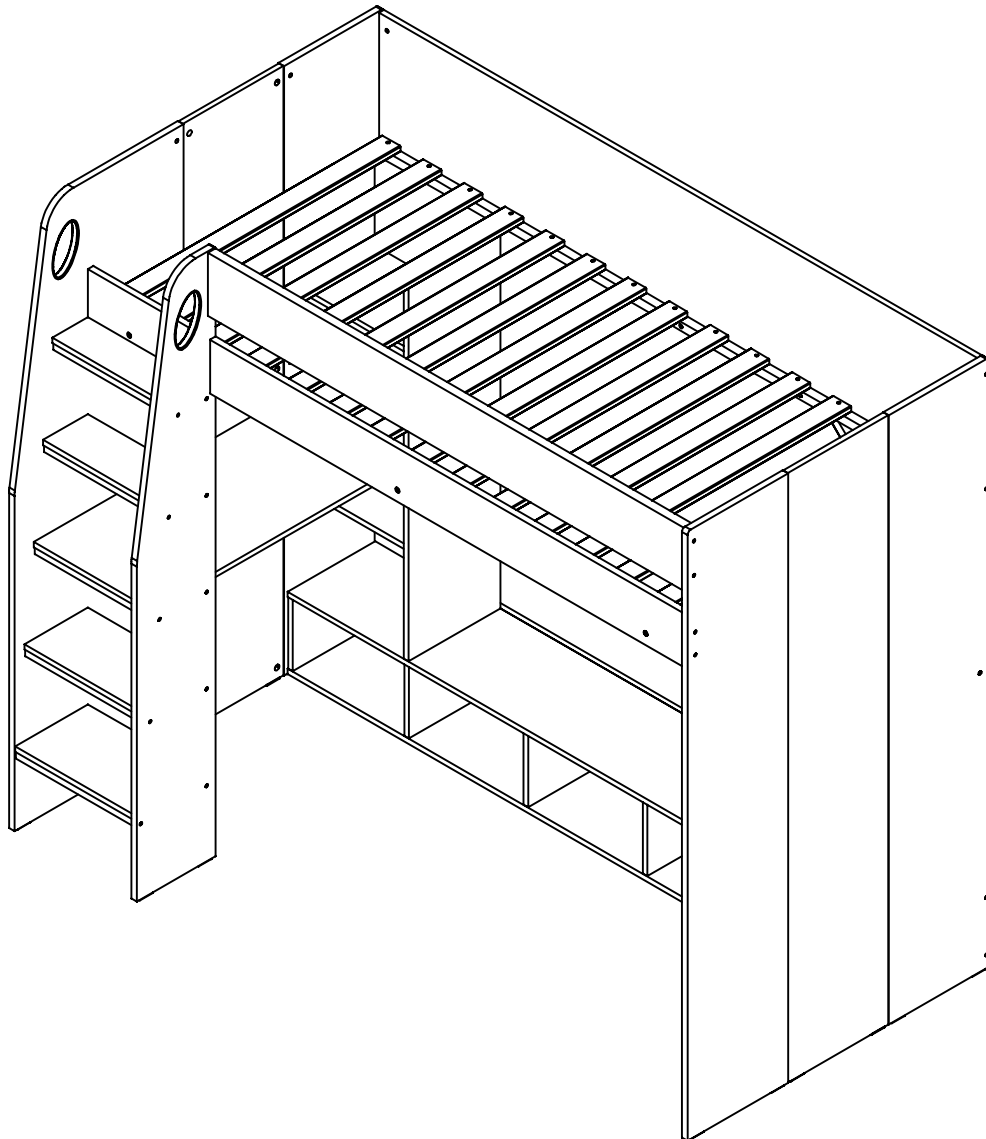

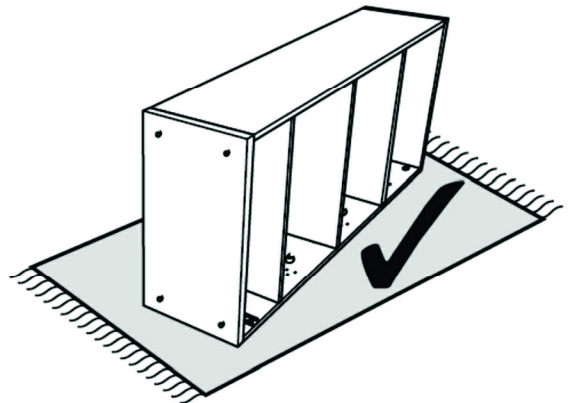
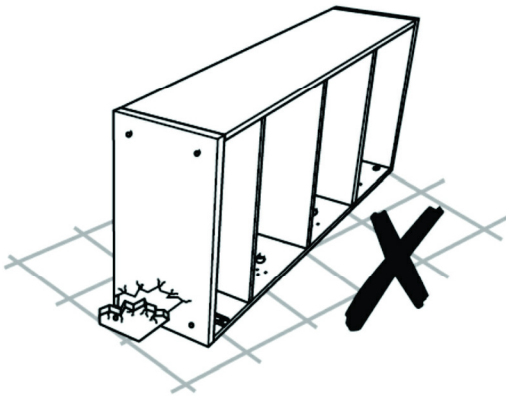
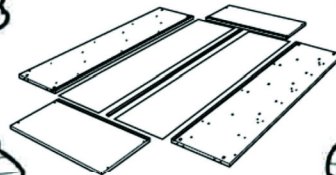
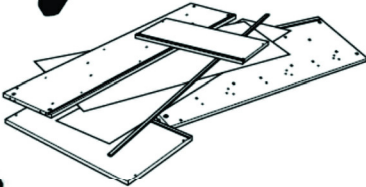
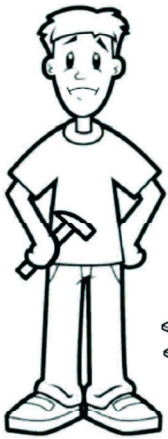
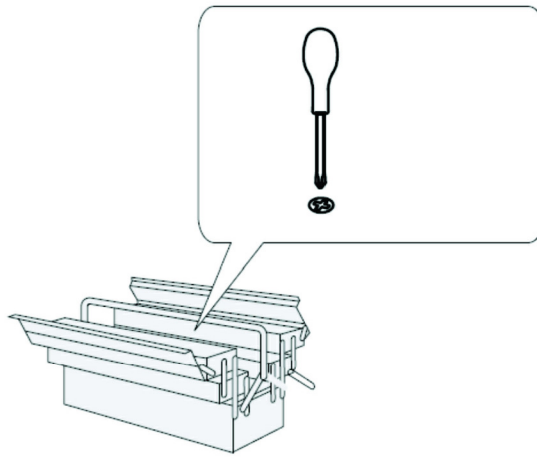

HARDWARE

A



Cam Stud
25PCS

B



Cam
37PCS

C



Contractfix Dowel
12PCS

D



M8 x 25mm
75PCS

E



M5 x 40mm
8PCS

F



M4 x 45mm
6PCS

G



M4 x 22mm
6PCS

H

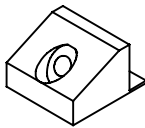

PVC Back Support
6PCS

J



M6 x 13mm
22PCS

K



M6 Round Nut
8PCS

L

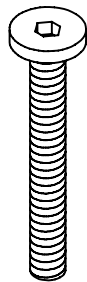

M6 x 50mm
18PCS

M

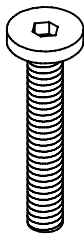

M6 x 40mm
20PCS

N

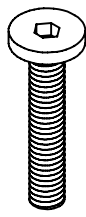

M6 x 35mm
10PCS

P

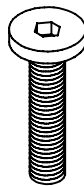

M6 x 30mm
30PCS

Q

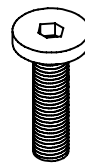

M6 x 25mm
2PCS

R

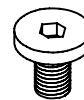

M6 x 12mm
2PCS

HARDWARE

S

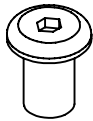

M6
7PCS

T

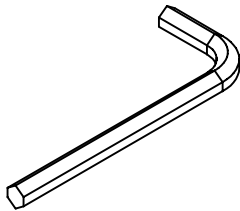

M4
2PCS

U

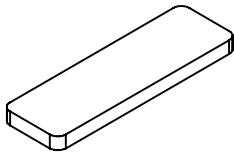

Felt Pads
24PCS

X



Sticker
36PCS

Y



Hole Plug 10mm
2PCS

V

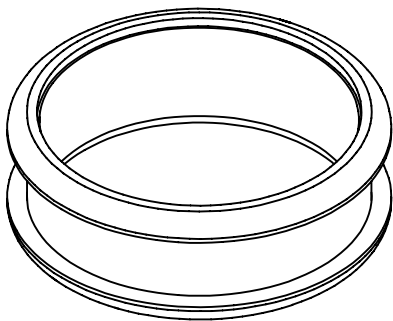

Circle Stopper
5PCS

W

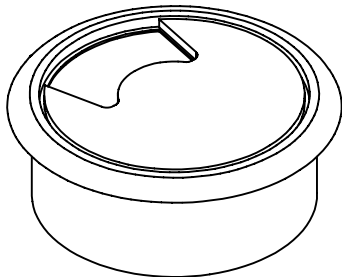

PVC Cap
1PCS

PARTS

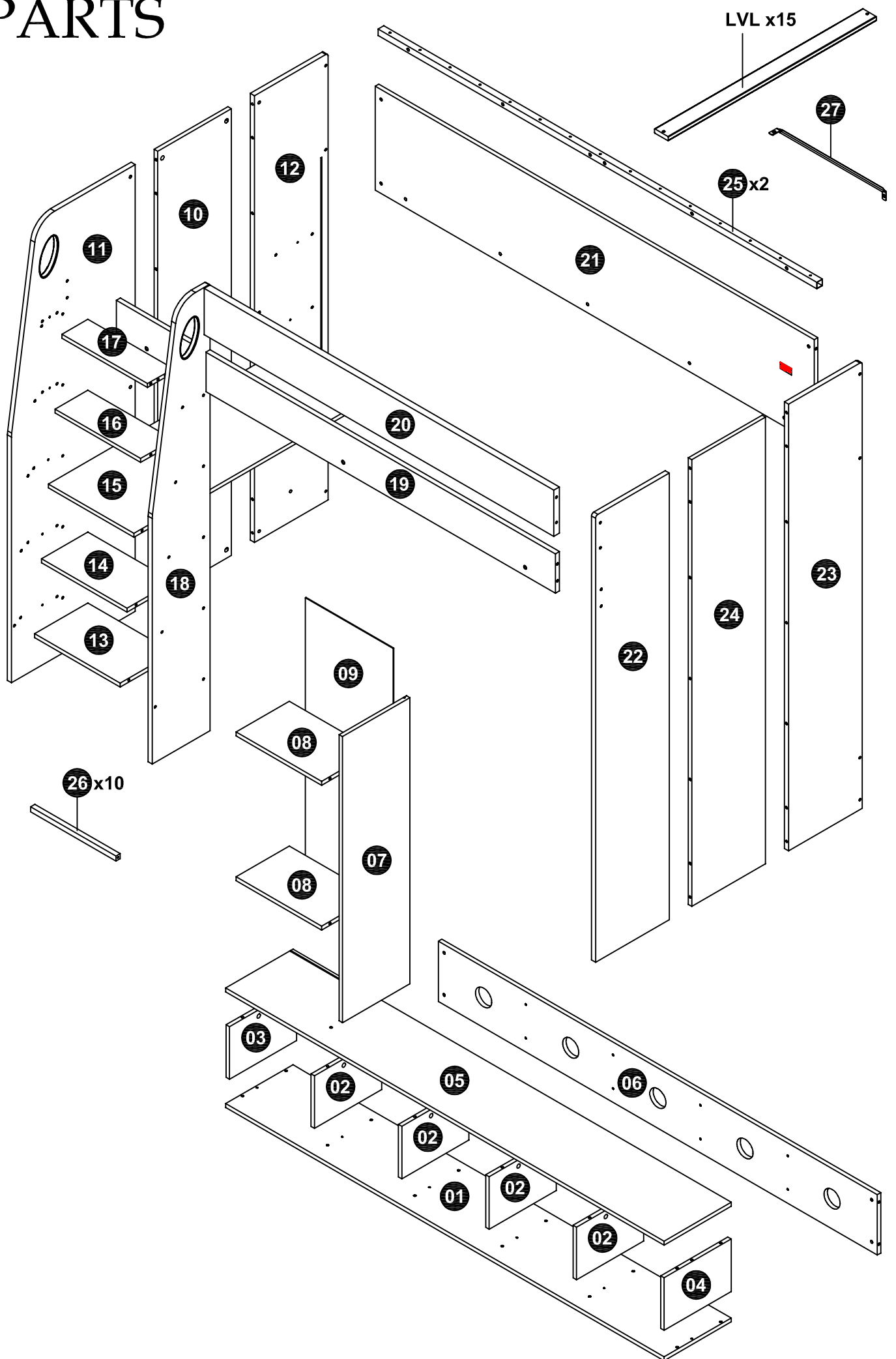

IMPORTANT INFORMATION

WARNING - High Beds and the upper bed of bunk beds are not suitable for children under six years due to the risk of injury from falls.

WARNING - Bunk beds and high beds can present a serious risk of injury from strangulation if not used correctly. Never attach or hang items to any part of the bunk bed that are not designed to be used with the bed, for example, but not limited to ropes, strings, cords, hooks, belts and bags.

WARNING - Children can become trapped between the bed and the wall, a roof pitch, the ceiling, adjoining pieces of furniture (e.g. cupboards) and the like. To avoid risk of serious injury the distance between the top safety barrier and the adjoining structure shall not exceed 75mm or shall be more than 230mm.

WARNING - Do not use the bunk bed / high bed if any structural part is broken or missing. It is recommended that you always follow the manufacturer's instructions to assemble this product.

Always follow the manufacturer's recommended mattress size, as per these instructions and the bunk bed / high bed maximum mattress height marking on the item:

Recommended Mattress Size: 90cm x 190cm (UK Single) with Maximum Depth of 17.0cm

It is necessary to frequently ventilate the room in order to keep the humidity low and to prevent mold in and around the bed.

Please periodically check all the fixings of the item and re-tighten when necessary.

This item conforms to European Safety Standards - BS EN 747-1: 2012 + A1: 2015.

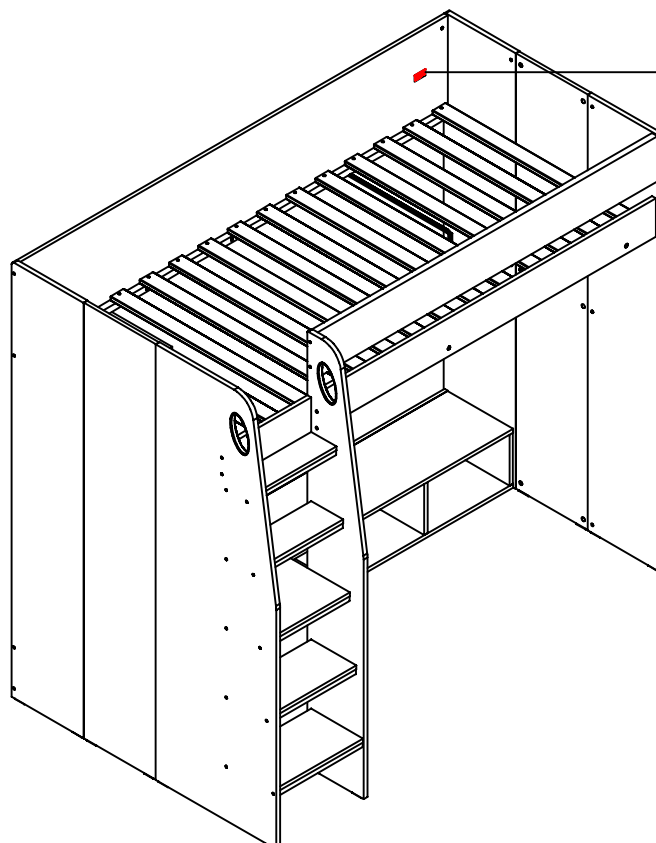

IMPORTANT SAFETY WARNING!
DO NOT PLACE THE MATTRESS ABOVE
THE LINE MARKED ABOVE AND DO NOT
REMOVE THIS LABEL

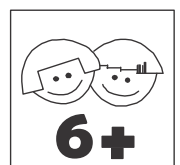

Safety Advice

Please take the time to carefully read through the whole of these instructions before you commence.

Keep these instructions for future reference.

Unpack, inspect and check off all of the contents.

Please dispose of all packaging safely.

Small component parts could choke a child if swallowed.

We strongly recommend that you keep children well away from the work area.

It would be sensible to lay a sheet or blanket on the floor where you intend to work to avoid scratching this product and to protect your floor.

This product is heavy. Take extreme care when lifting to avoid personal injury or damage to the product.

Assemble the product as close to its intended final position in the room as possible.

Please check the contents of boxes before attempting to assemble this product. A full checklist of parts and fittings is given in page 5 of this instruction leaflet.

HANDY HINT: If you keep the hardware in a bowl during assembly you will be less likely to lose them.

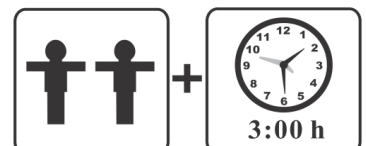
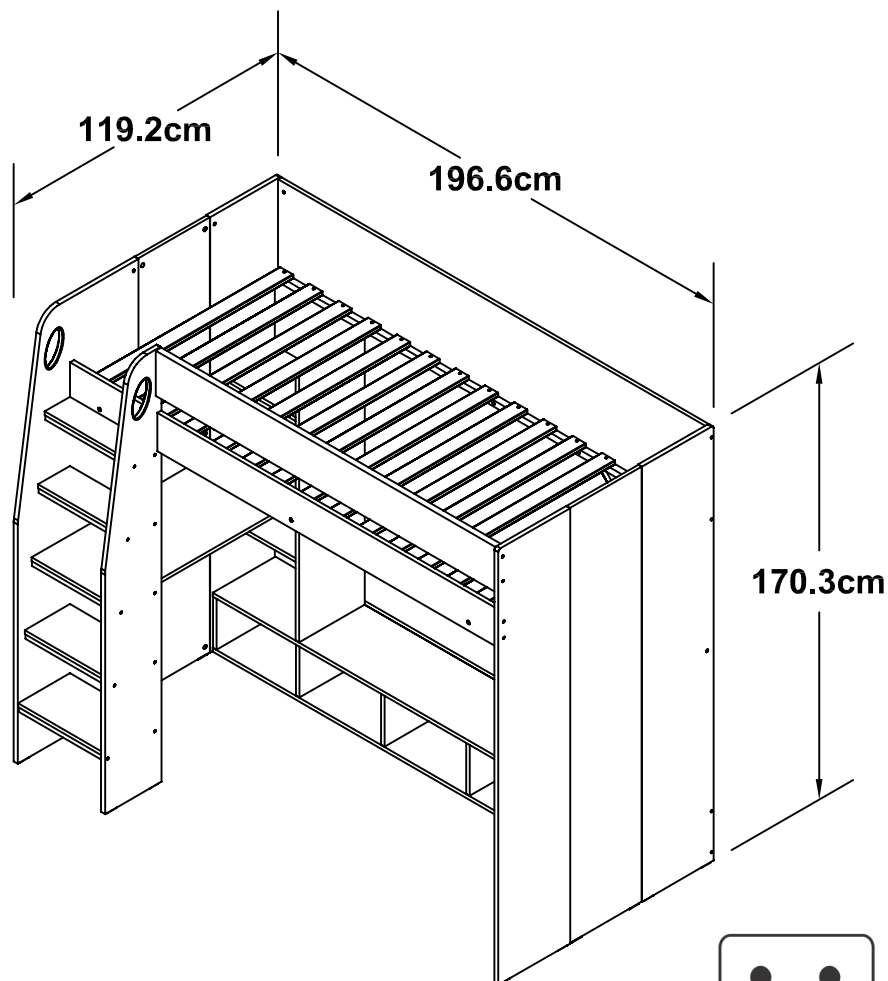

1

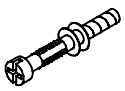

A x 6



B x 6



D x 24

WHEN FITTING CAMS

ENSURE STARTING POSITION IS CORRECT
BEFORE YOU INSERT CONNECTING BOLT
TURN CLOCKWISE UNTIL SECURE

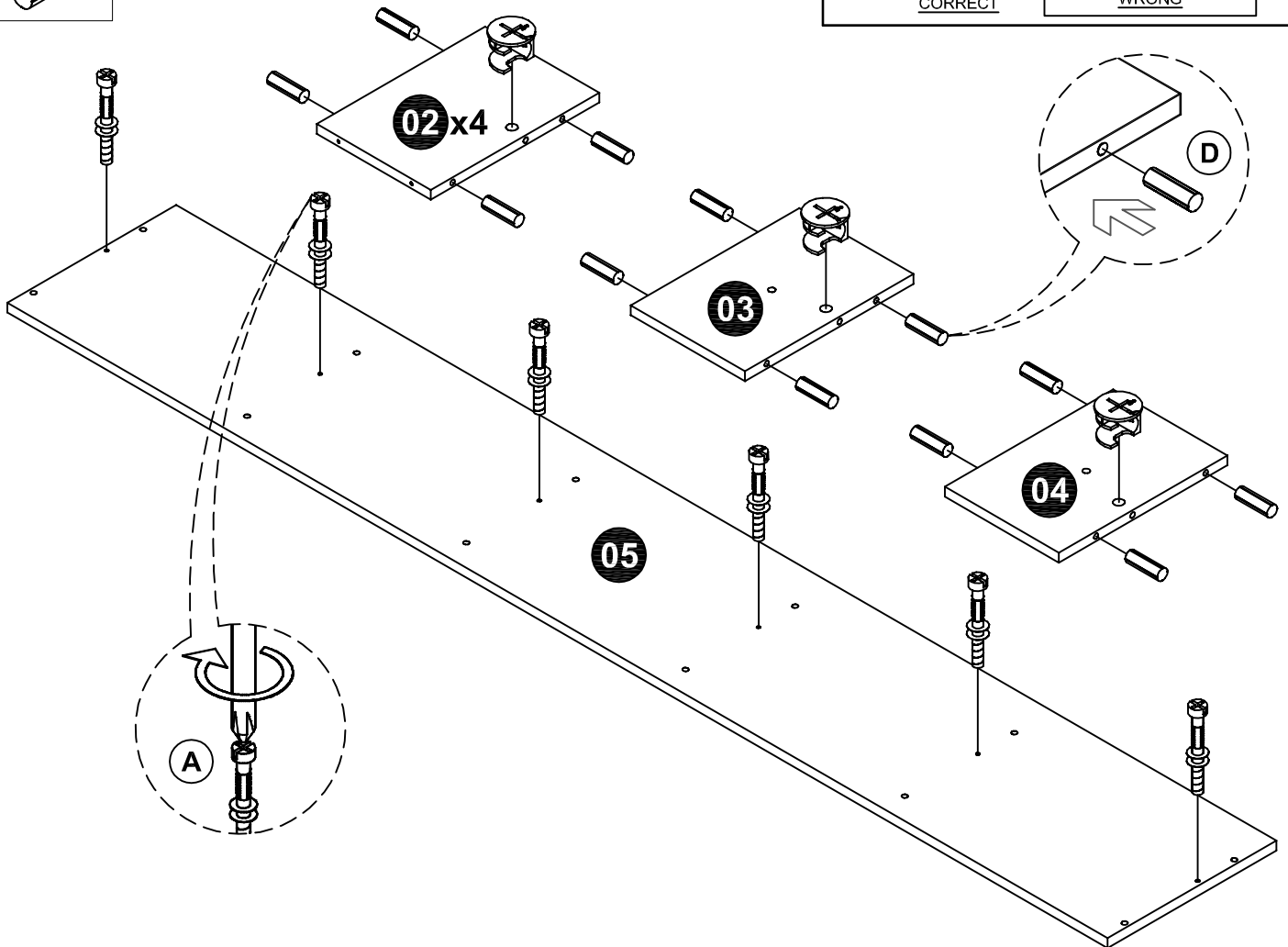
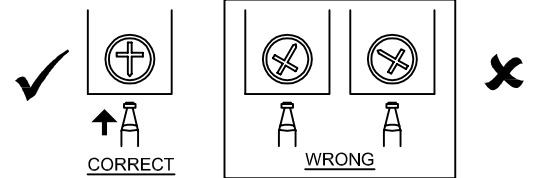

2

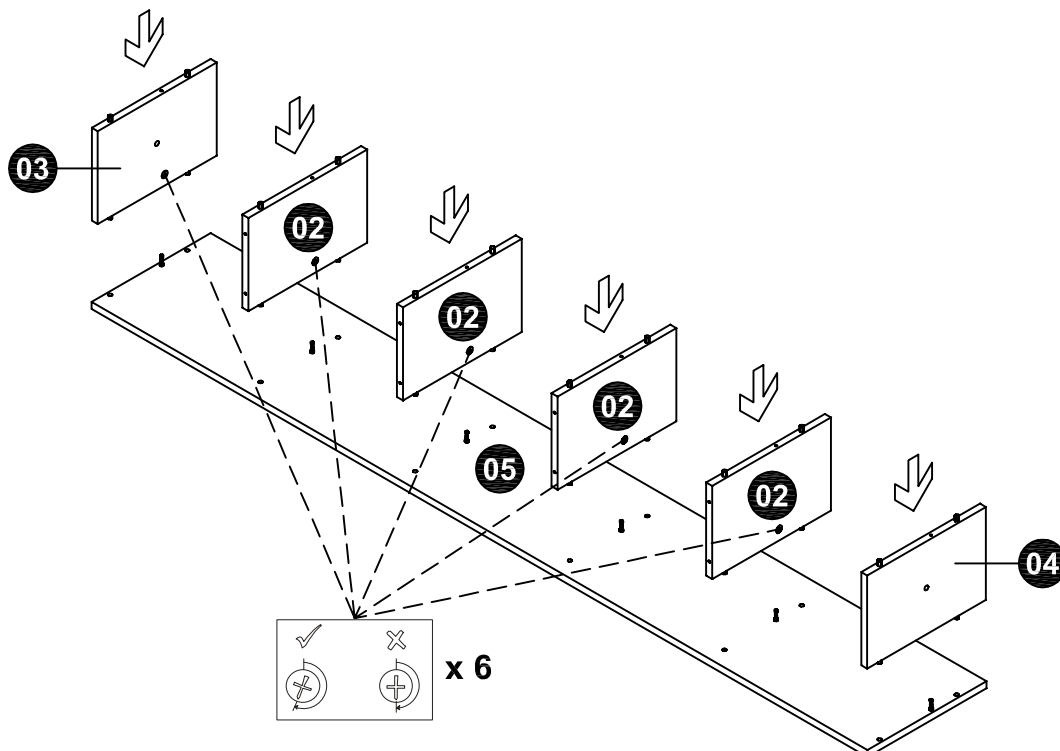

3

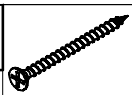

F x 6

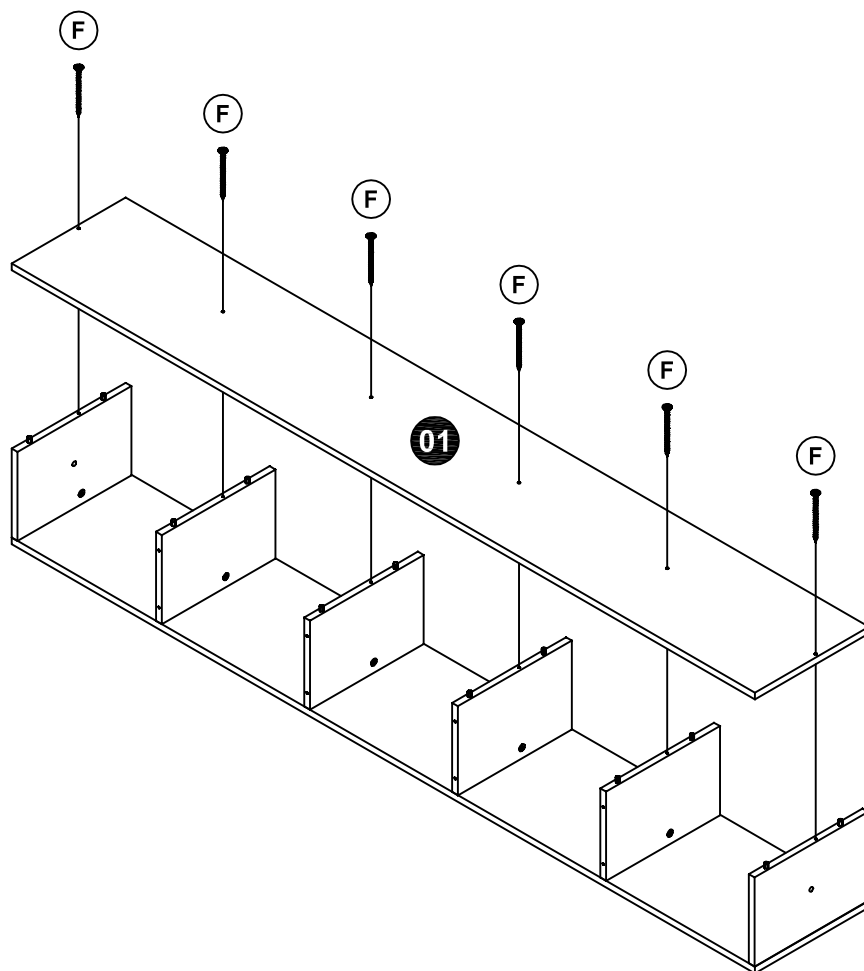

4



V x 5

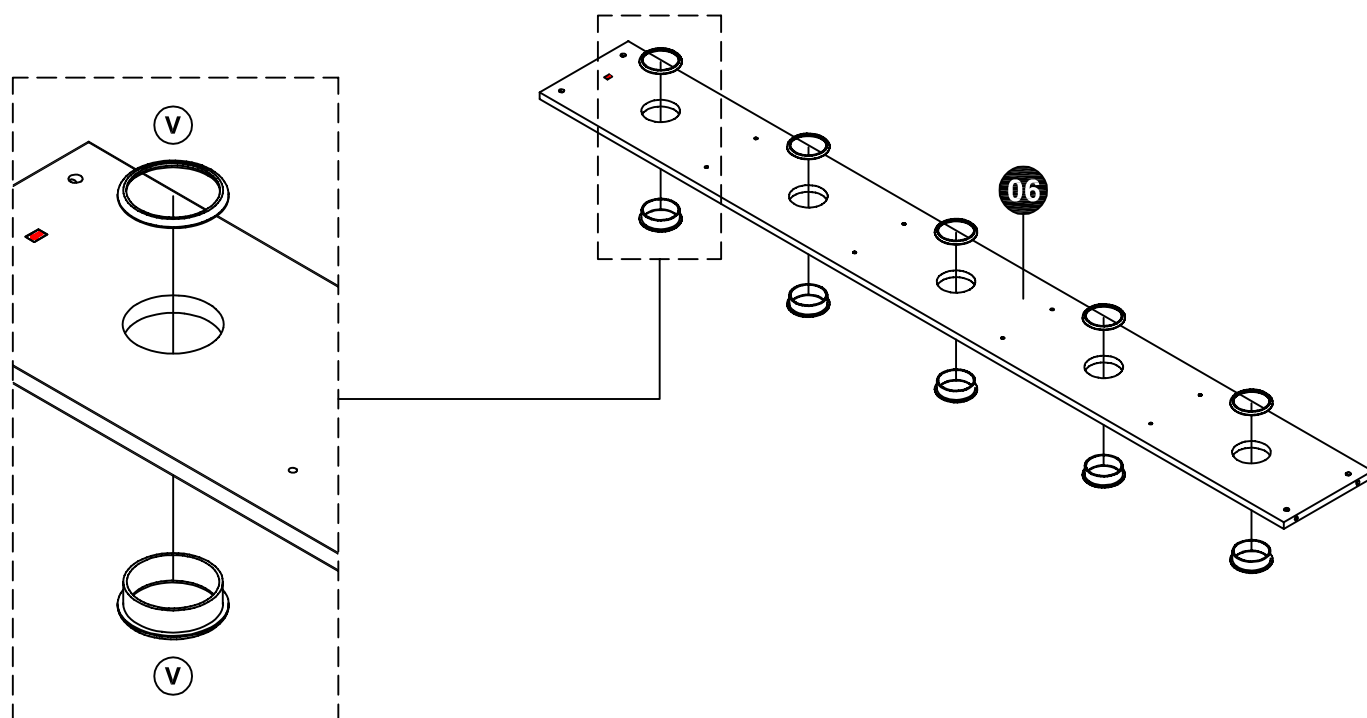

5



E x 8

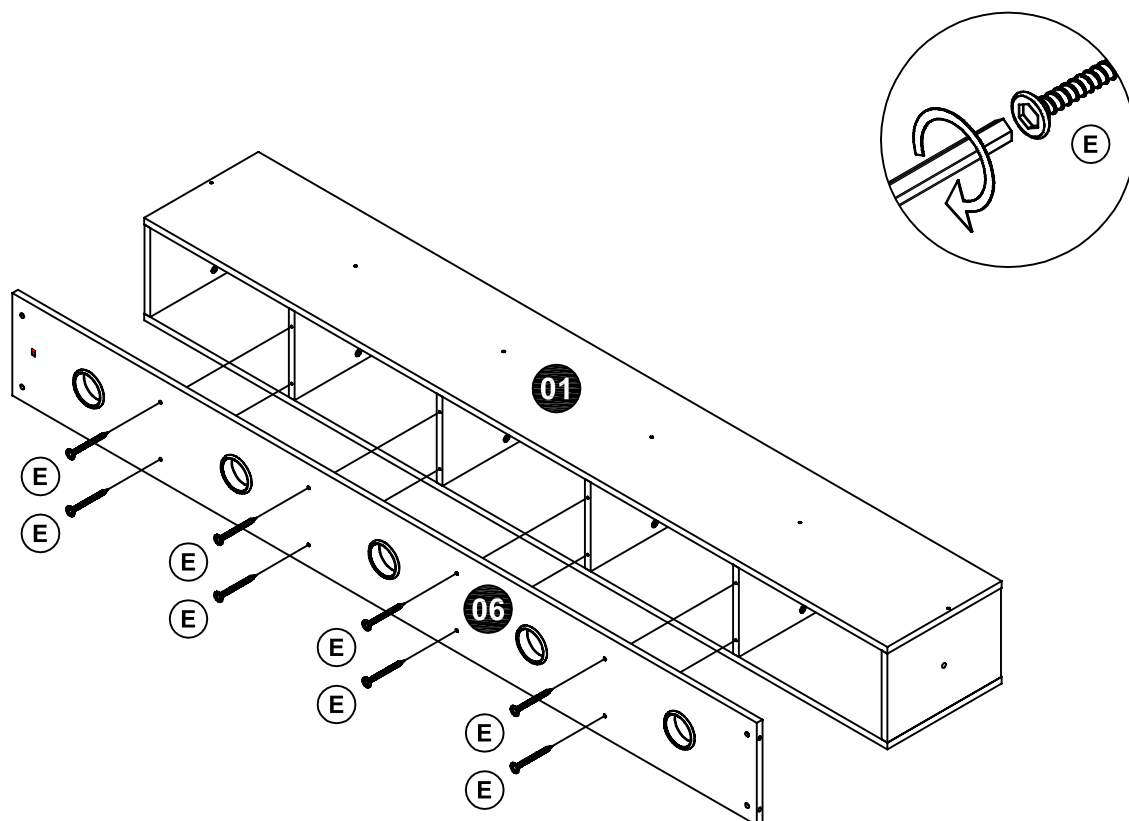

6



U x 10

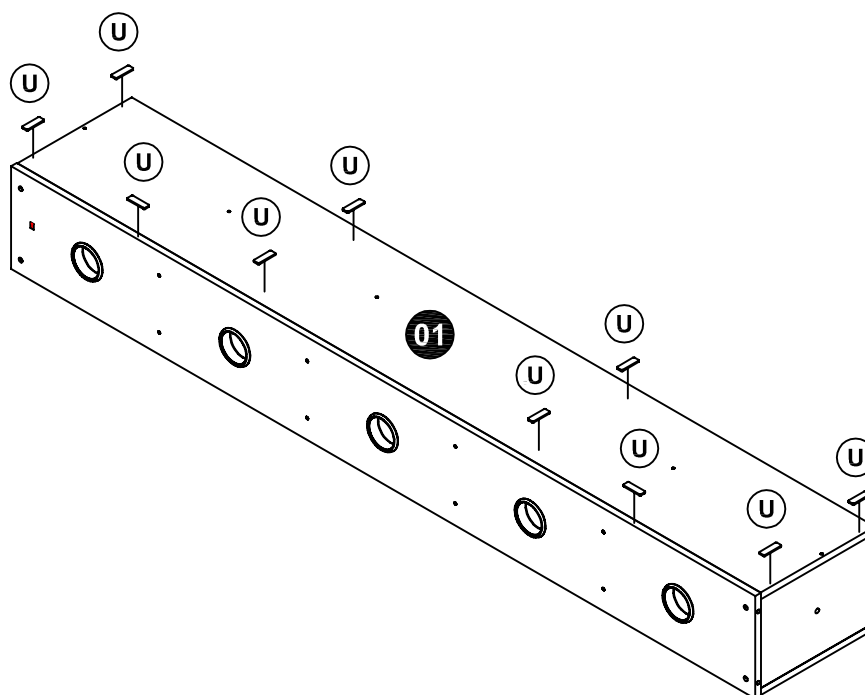

7

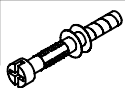

A x 10



B x 6

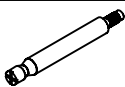

C x 6

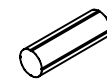

D x 8



J x 6

WHEN FITTING CAMS

ENSURE STARTING POSITION IS CORRECT
BEFORE YOU INSERT CONNECTING BOLT
TURN CLOCKWISE UNTIL SECURE

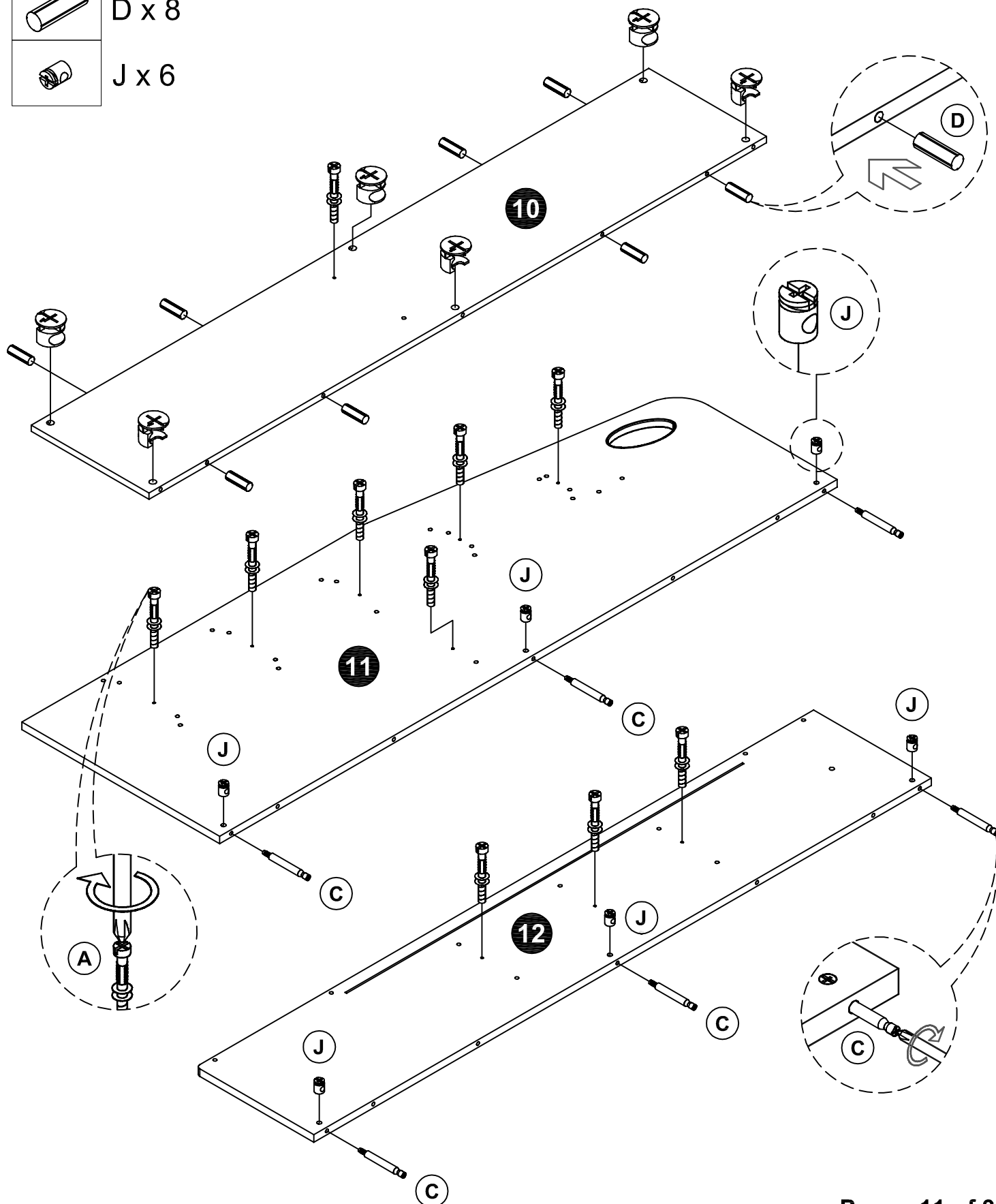
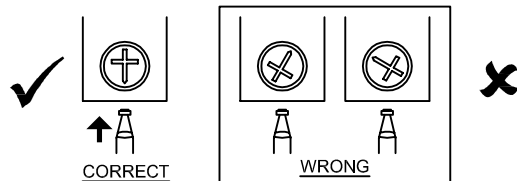

8

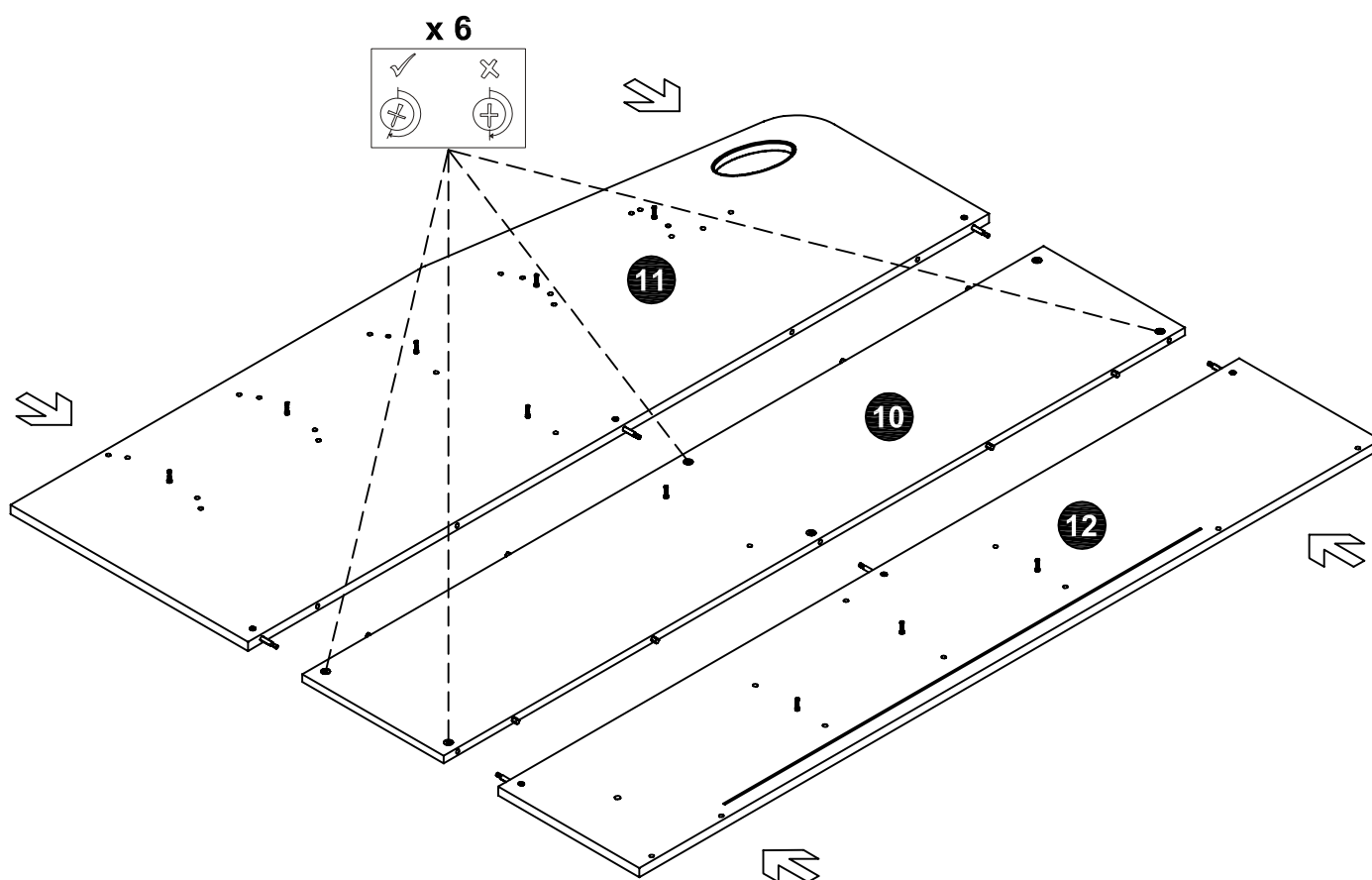

9



X x 12

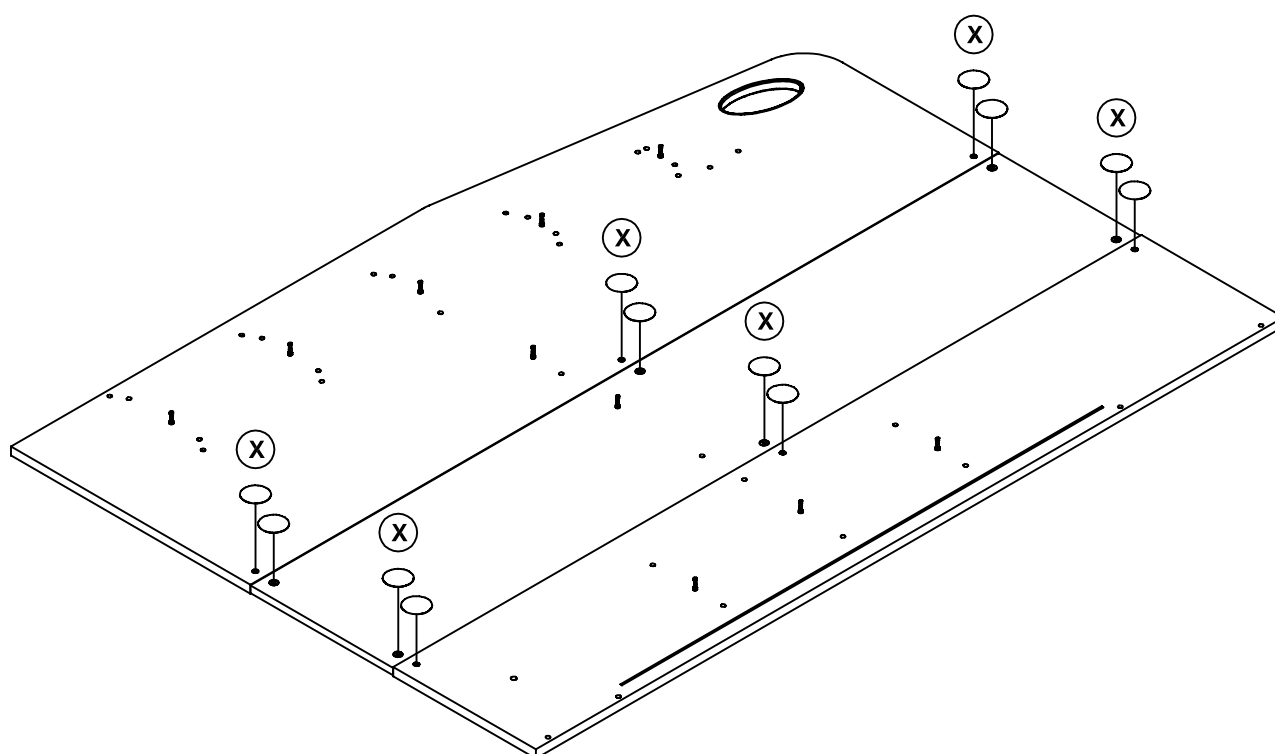

10

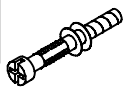

A x 8



B x 19



D x 35

WHEN FITTING CAMS

ENSURE STARTING POSITION IS CORRECT
BEFORE YOU INSERT CONNECTING BOLT
TURN CLOCKWISE UNTIL SECURE

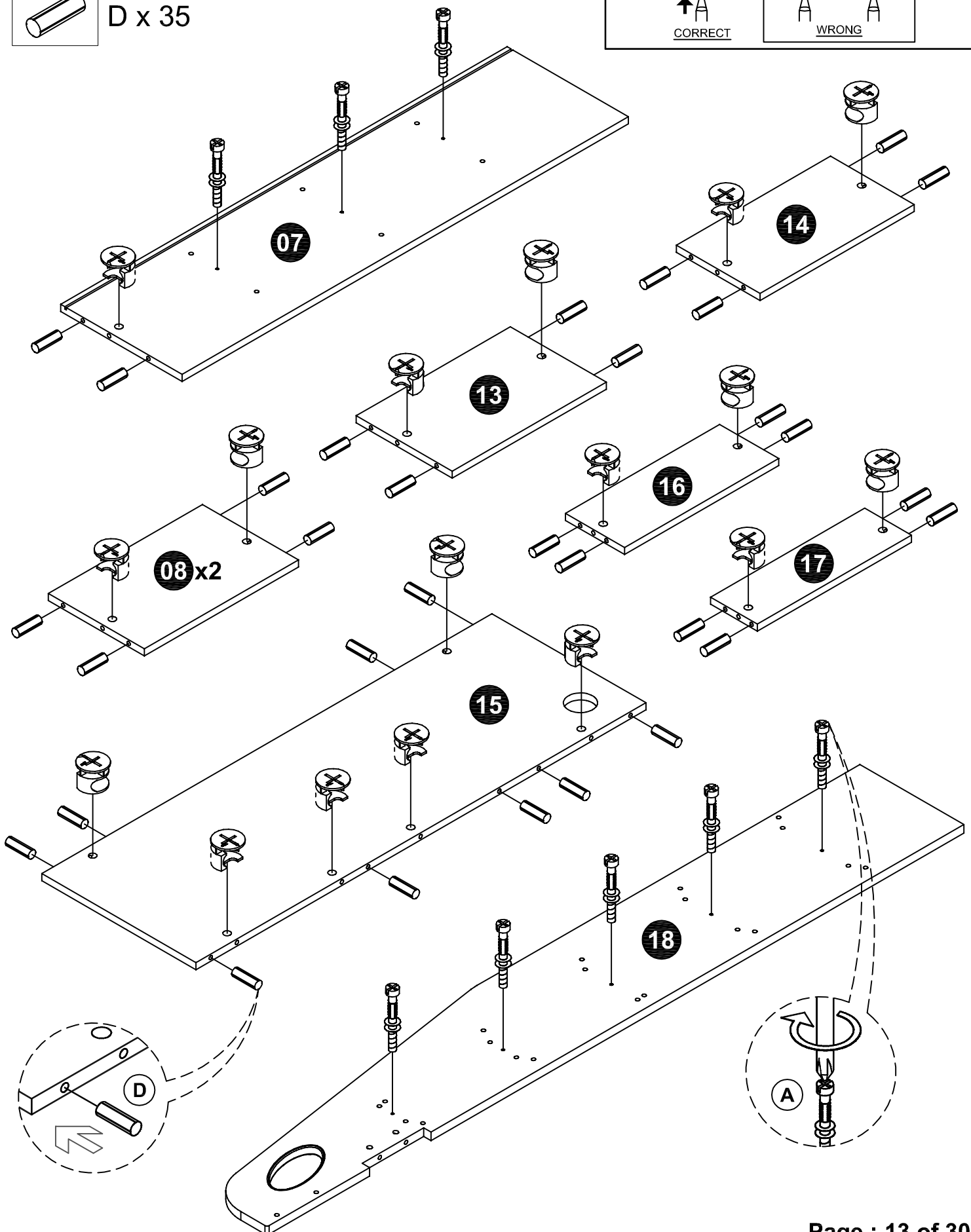
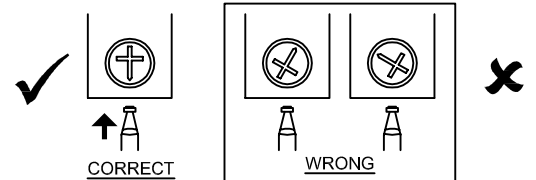

11

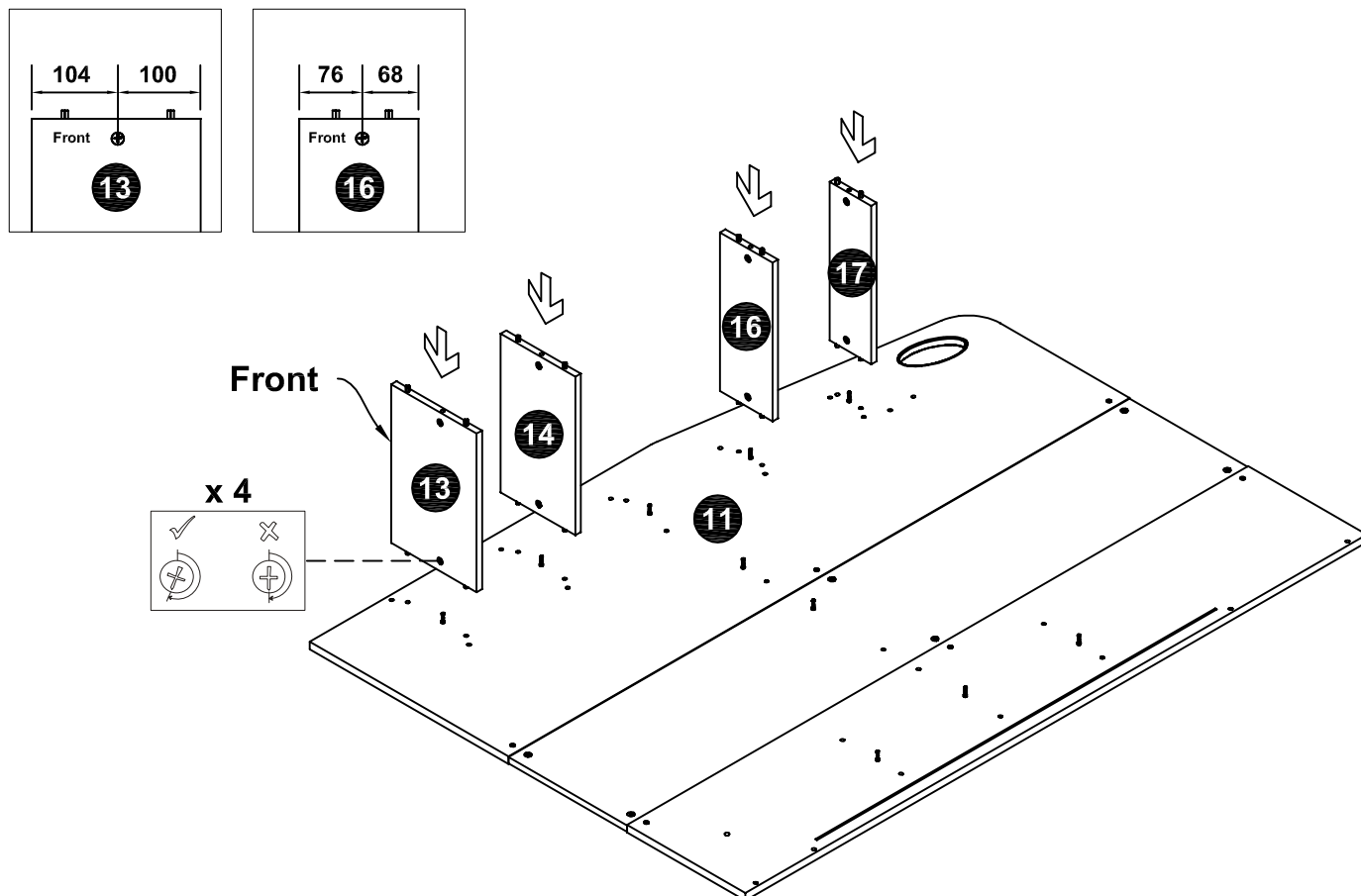

12

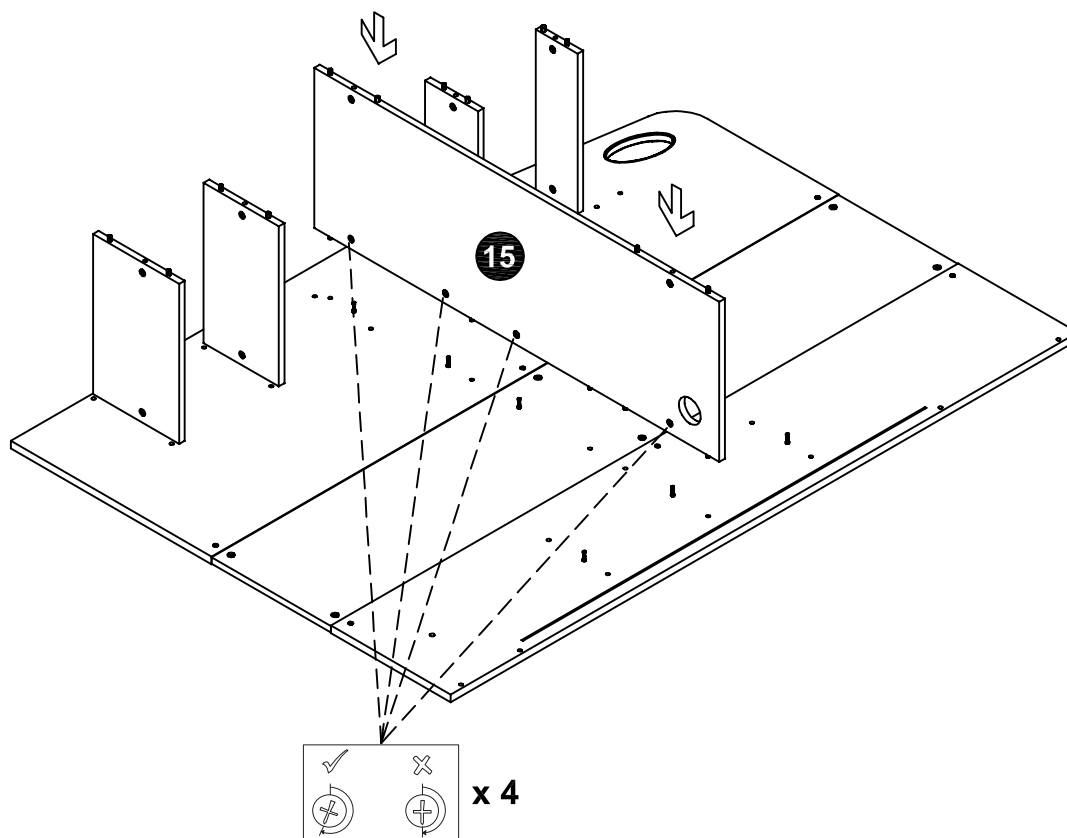

13

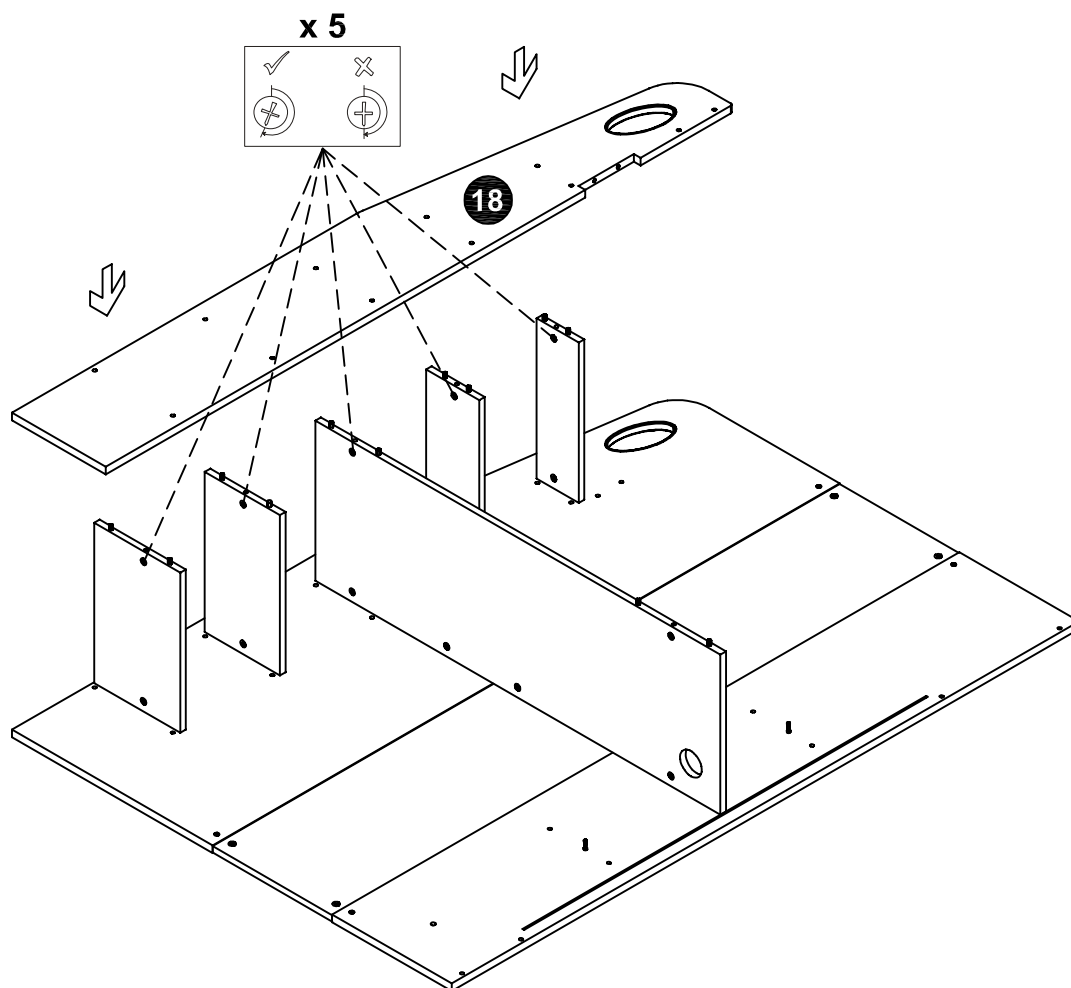

14

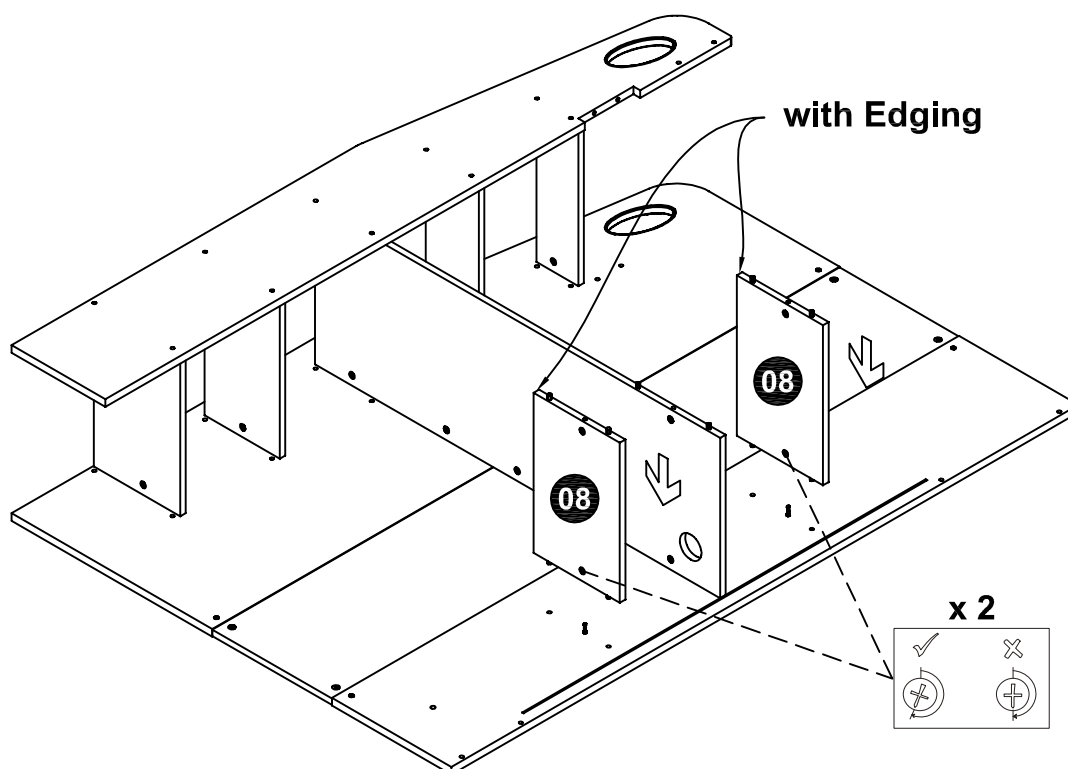

15

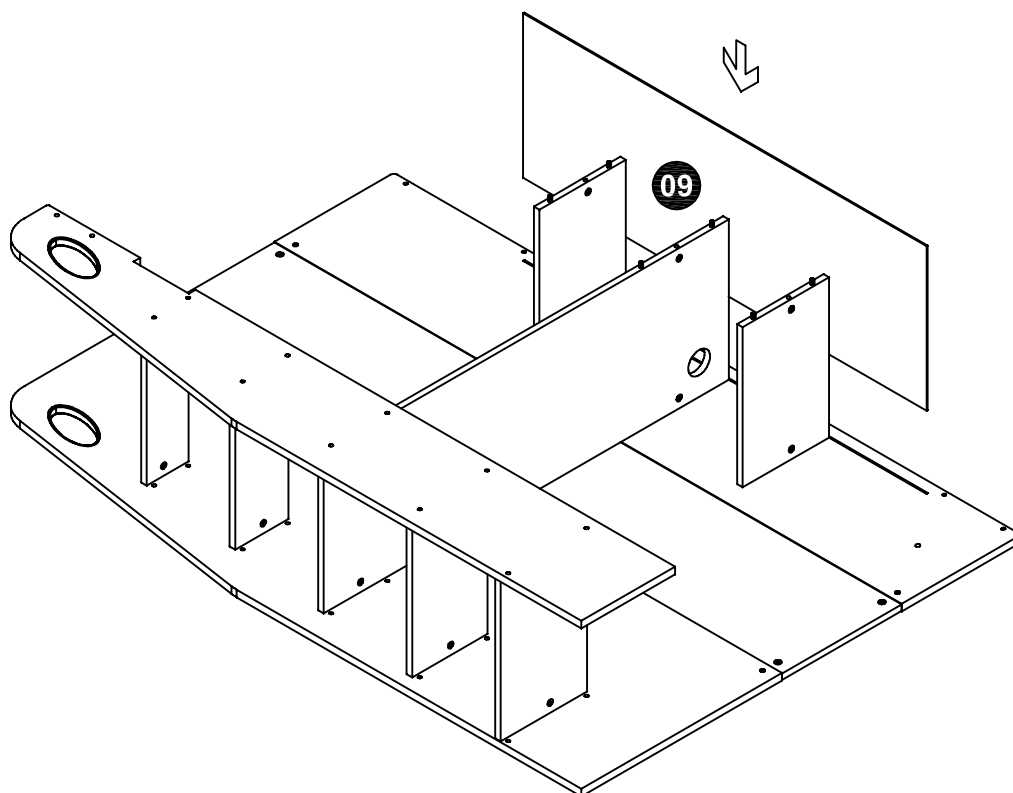

16

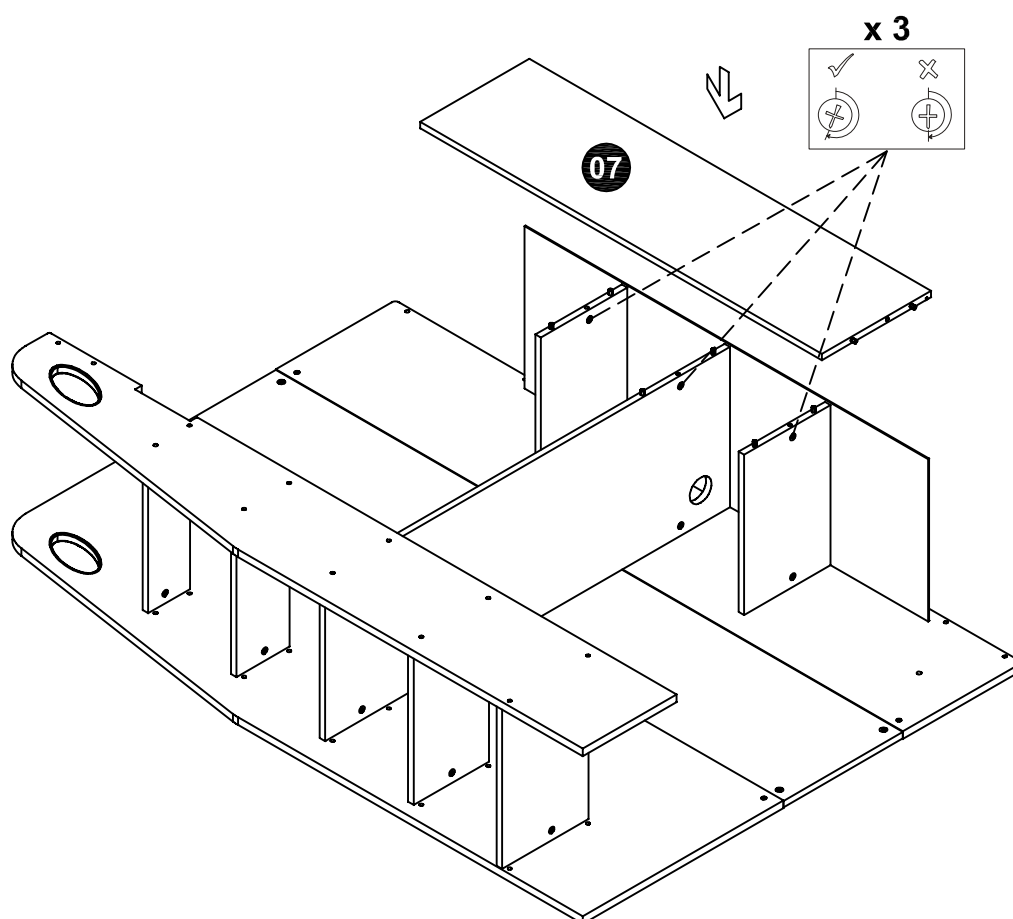

17



U x 8

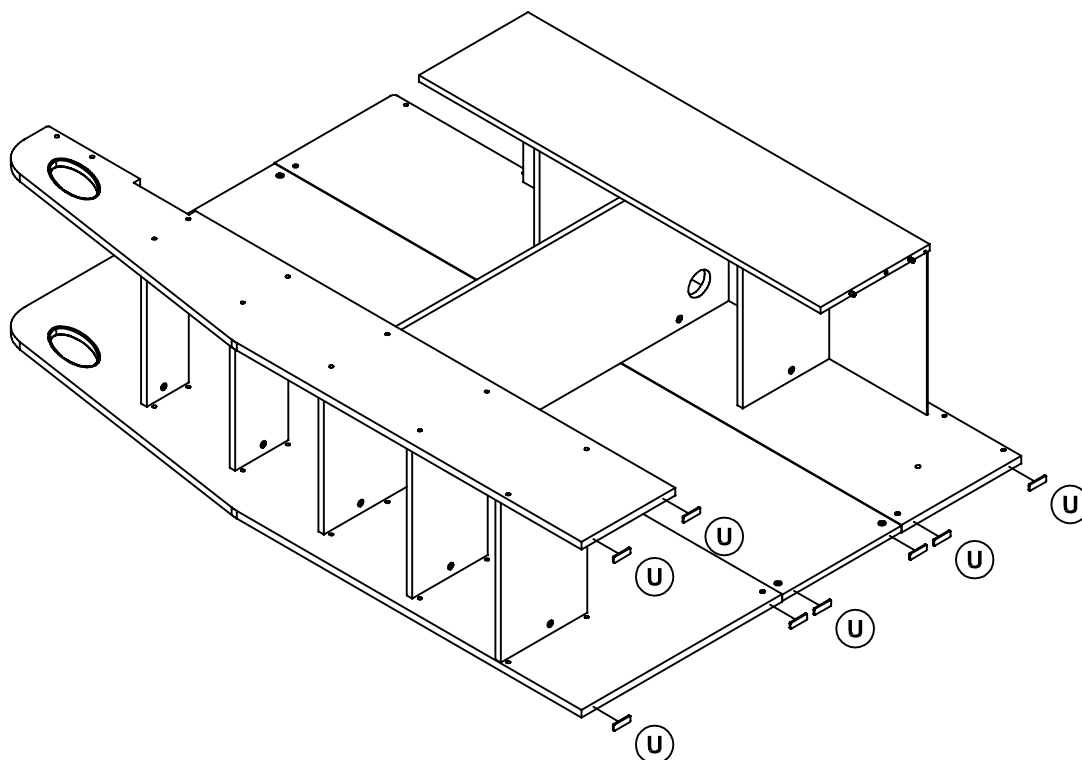

18

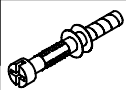

A x 1

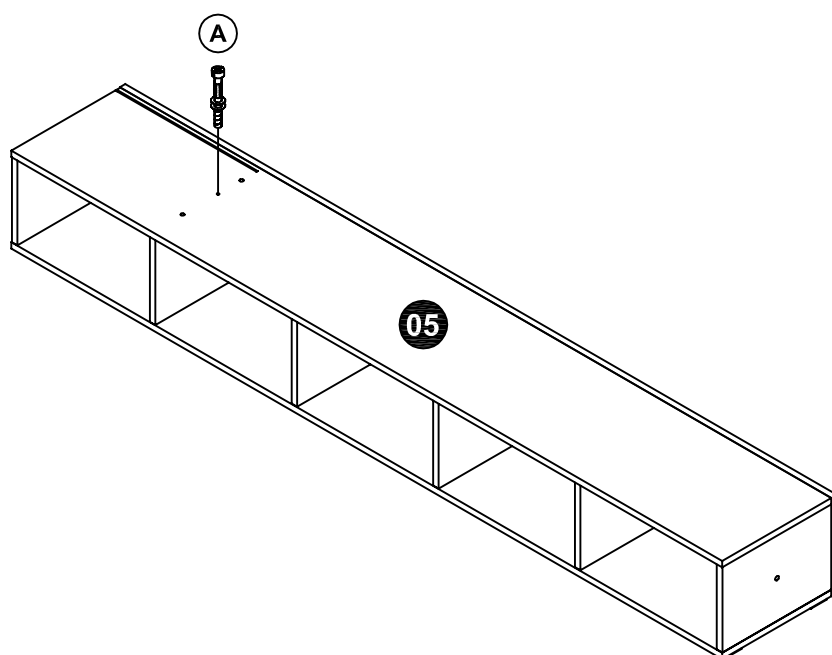

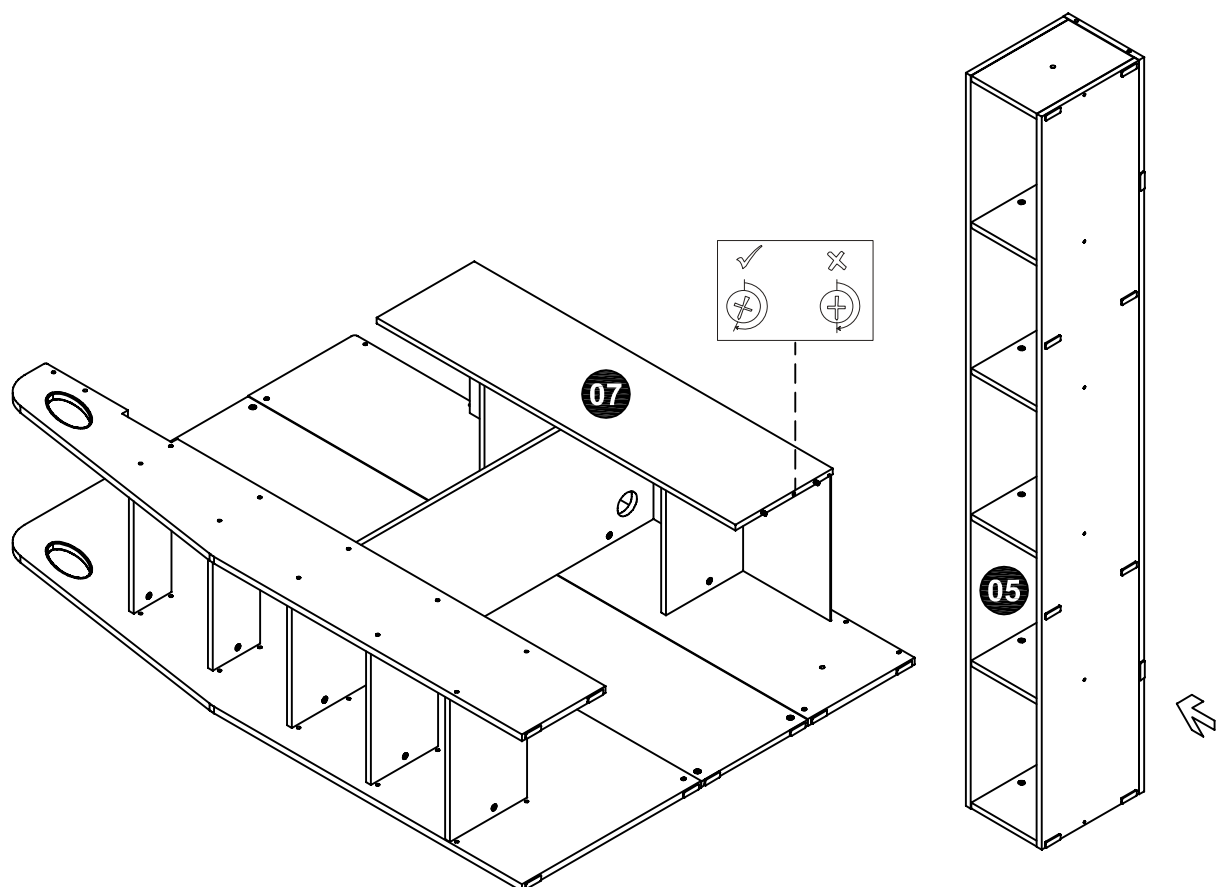

Q x 1

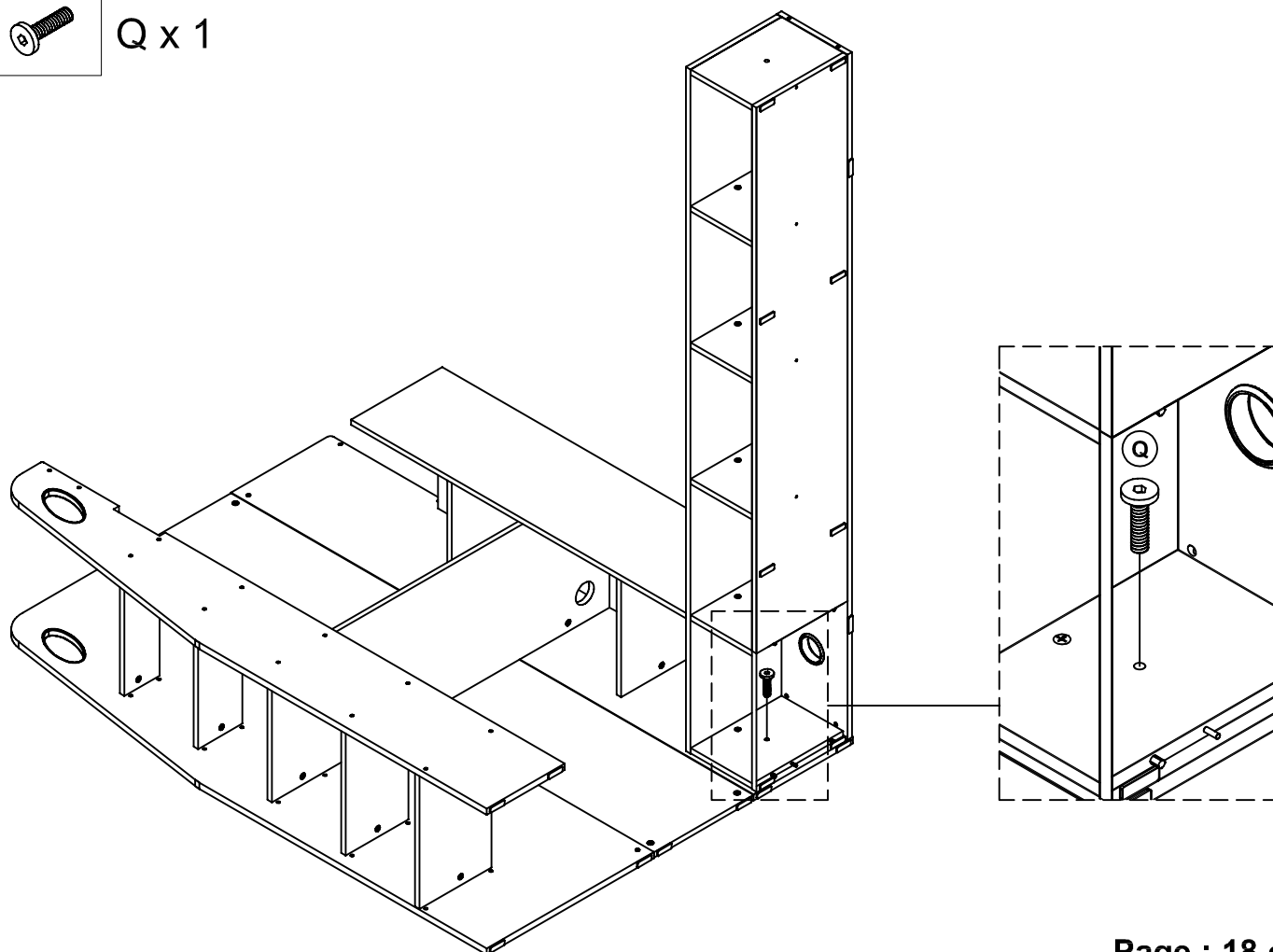

21

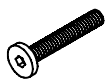

M x 20



W x 1

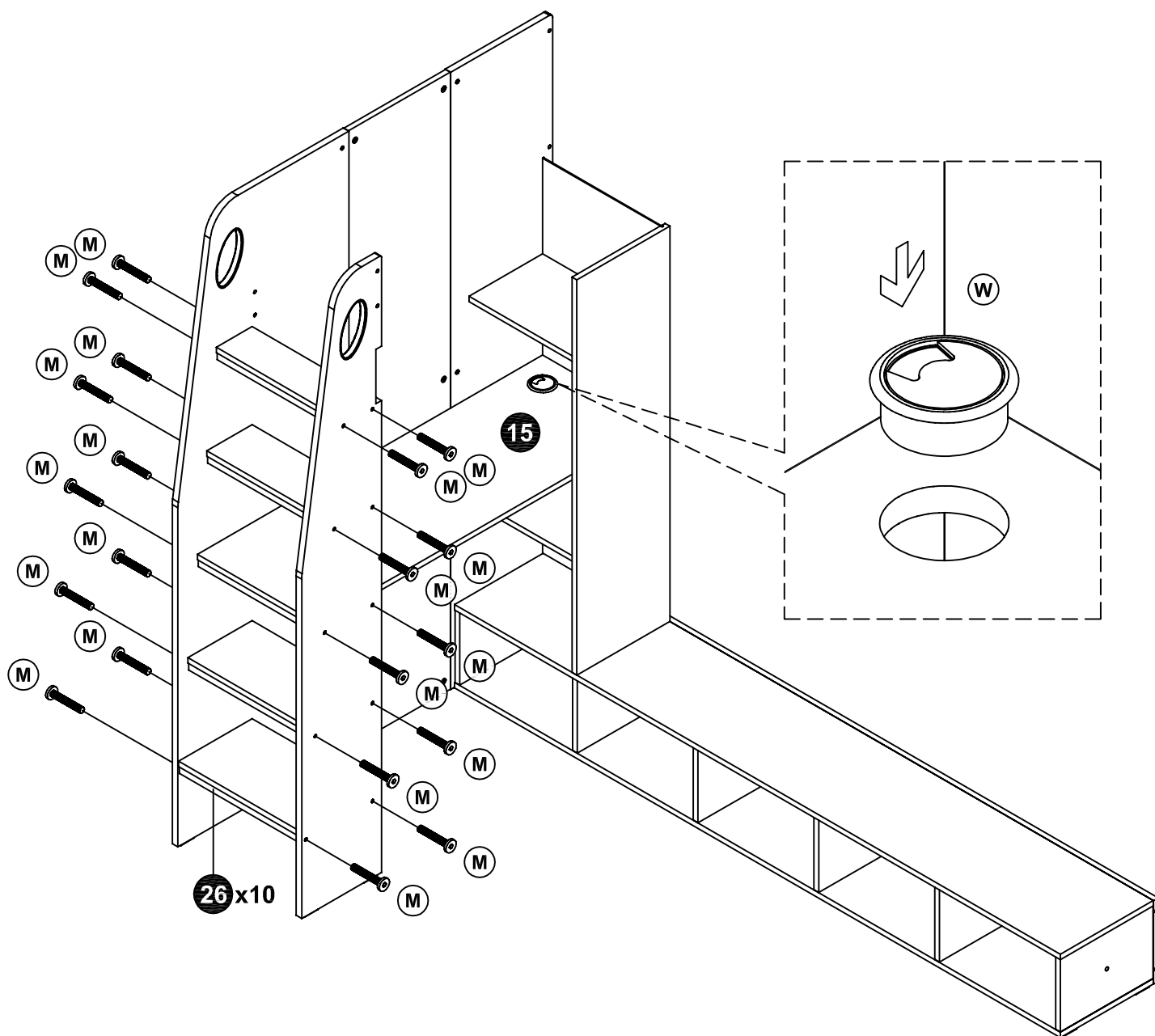

22



B x 6

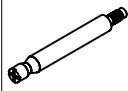

C x 6

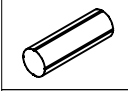

D x 8



J x 6

WHEN FITTING CAMS
ENSURE STARTING POSITION IS CORRECT
BEFORE YOU INSERT CONNECTING BOLT
TURN CLOCKWISE UNTIL SECURE

✓

CORRECT

WRONG

✗

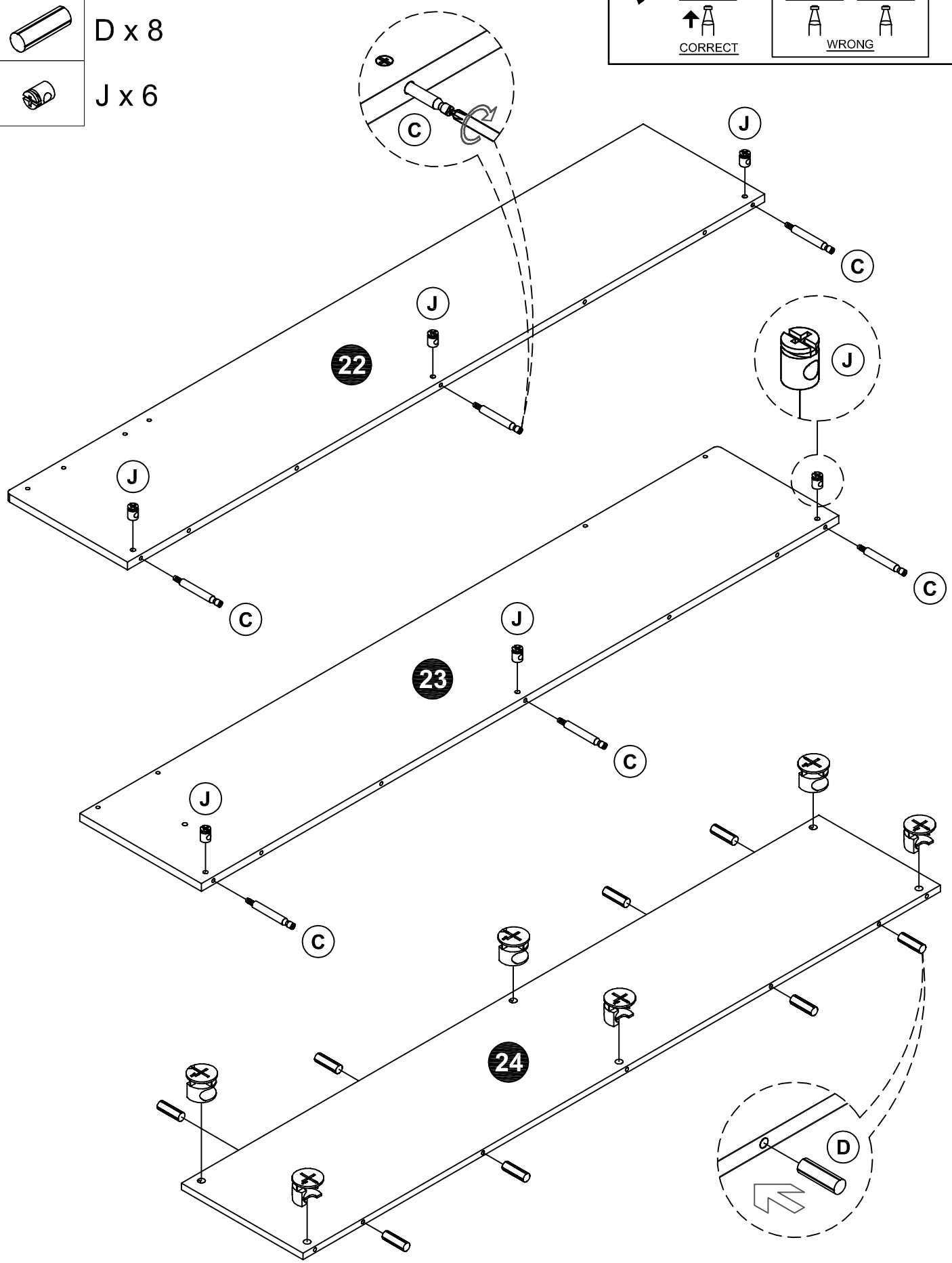

23

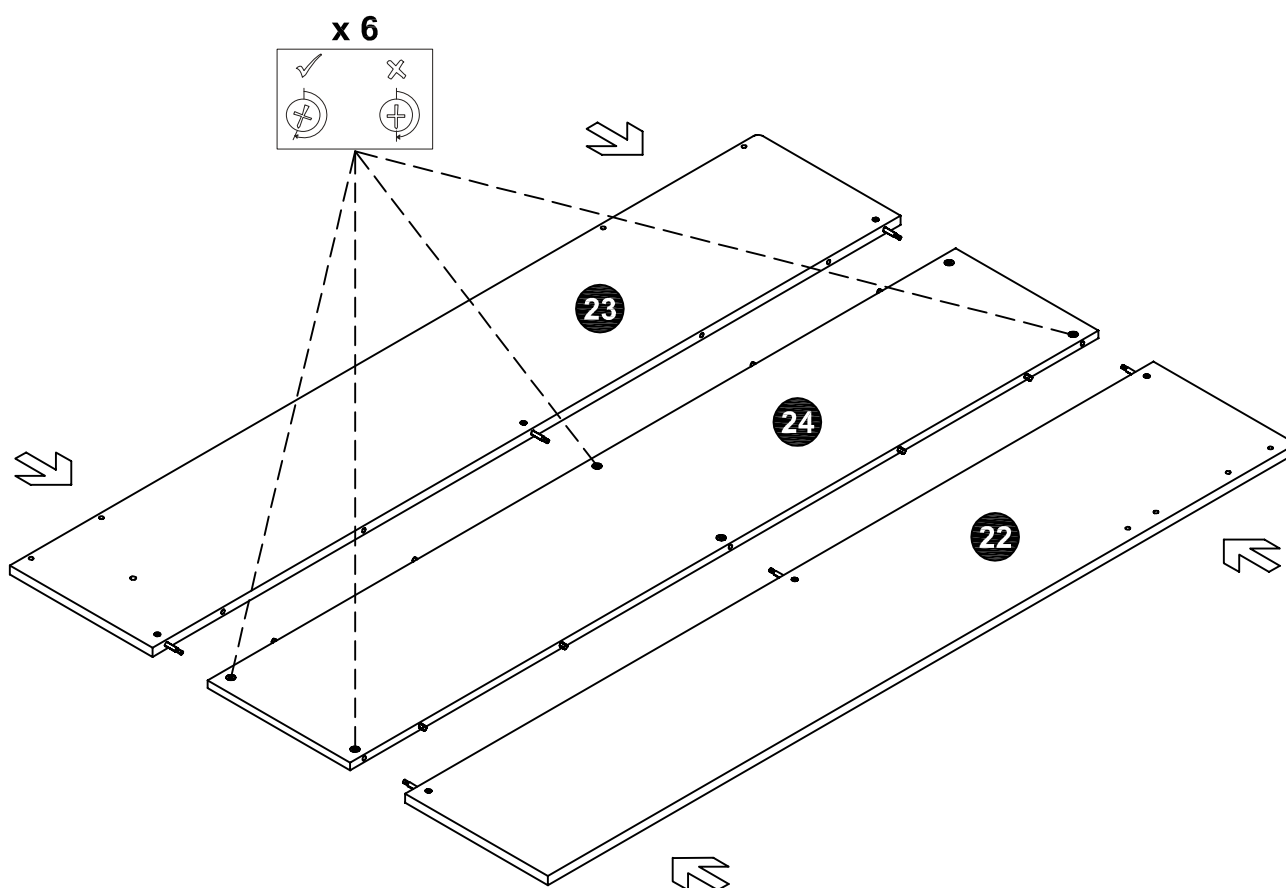

24

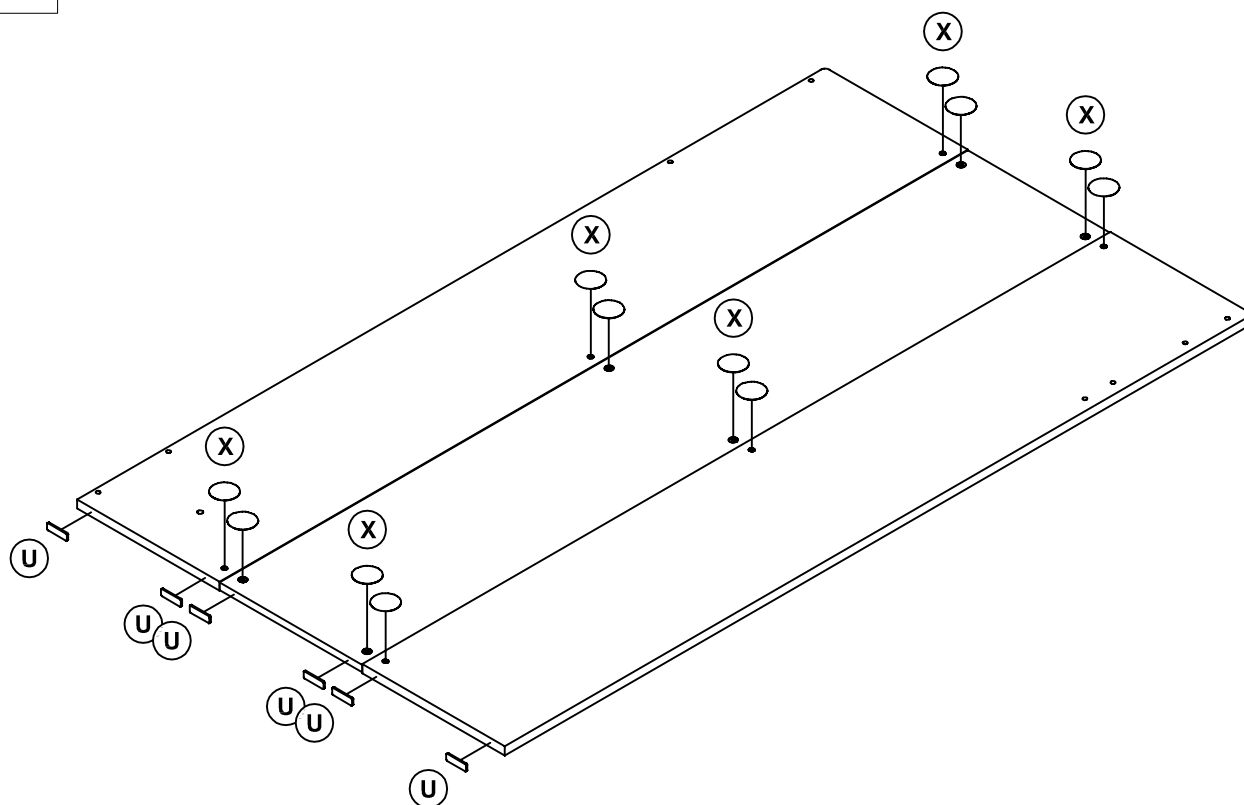
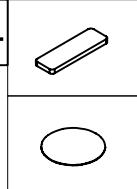

25



K x 4

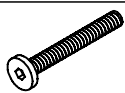

L x 4

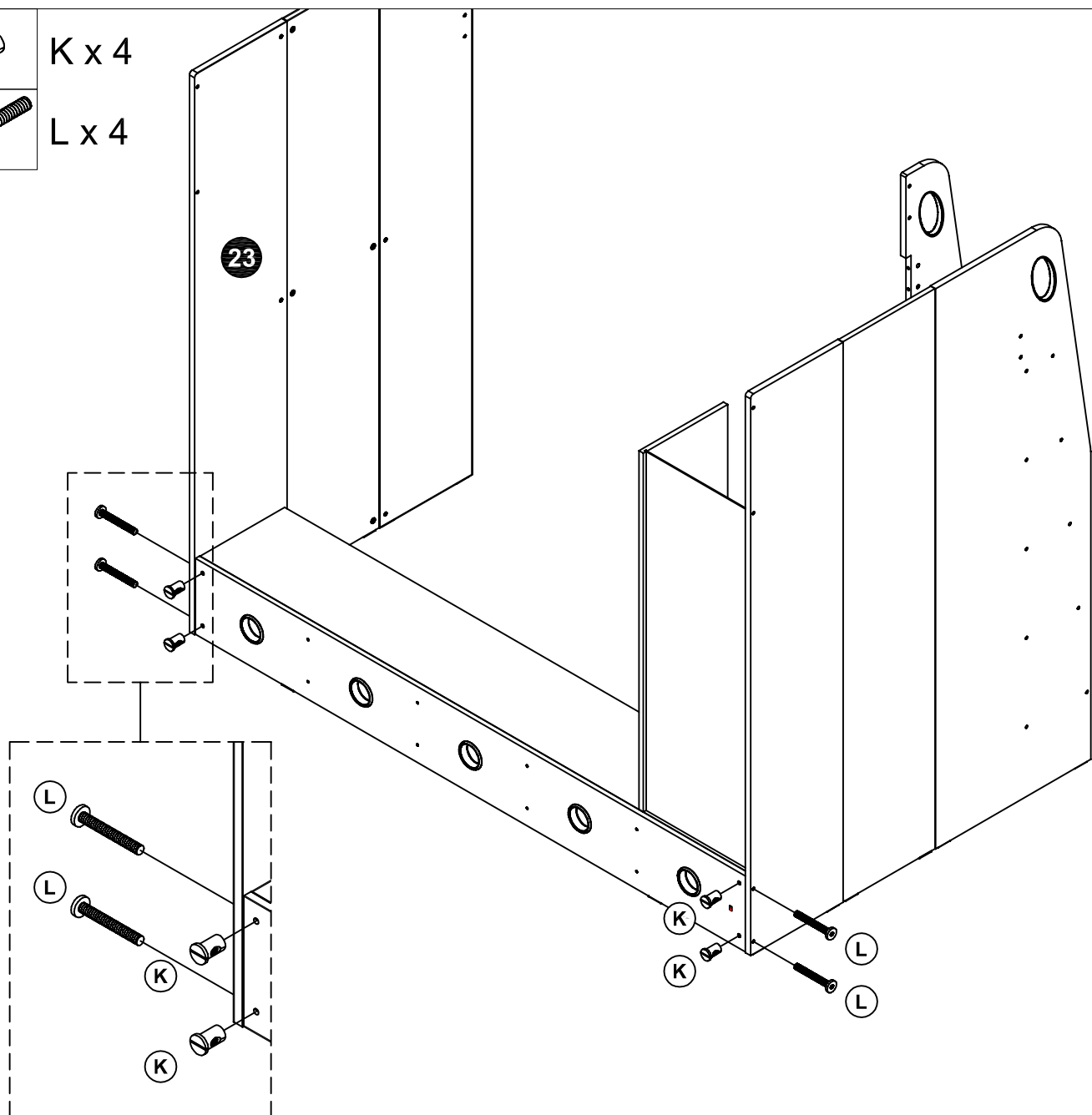

26



N x 2

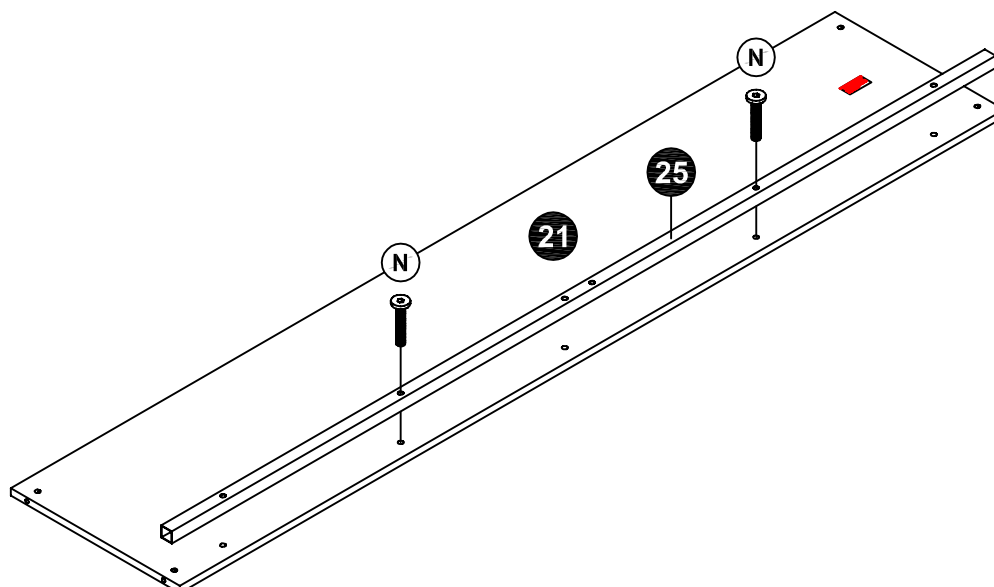

27



N x 3



S x 3



Y x 1

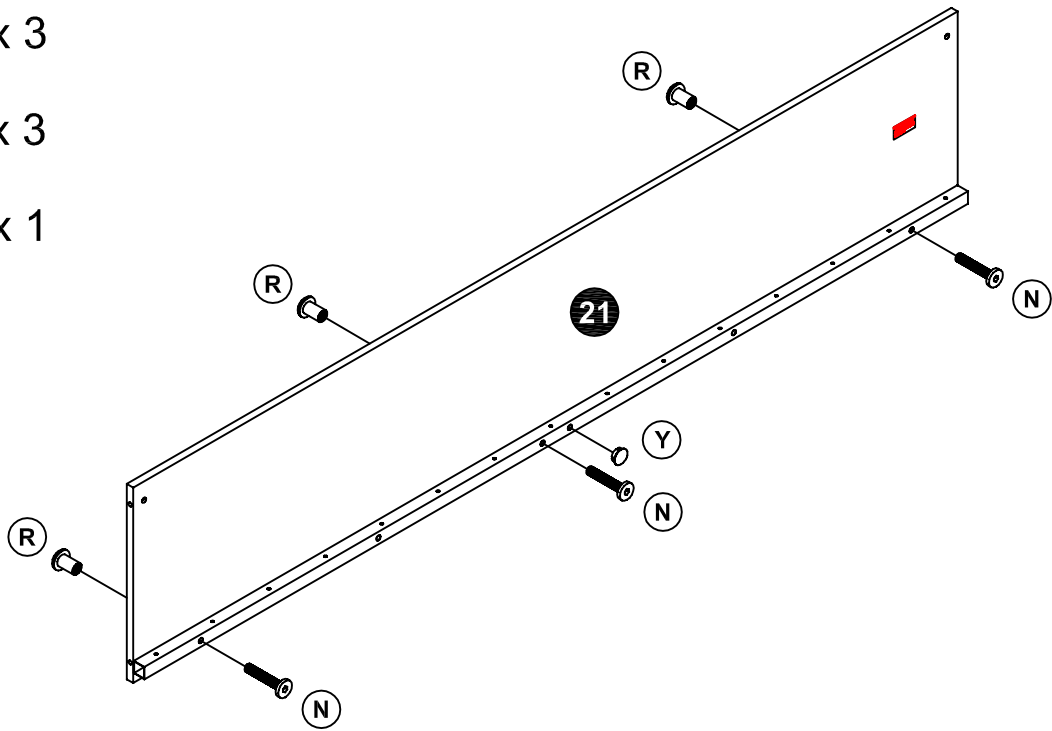

28



K x 4



L x 4

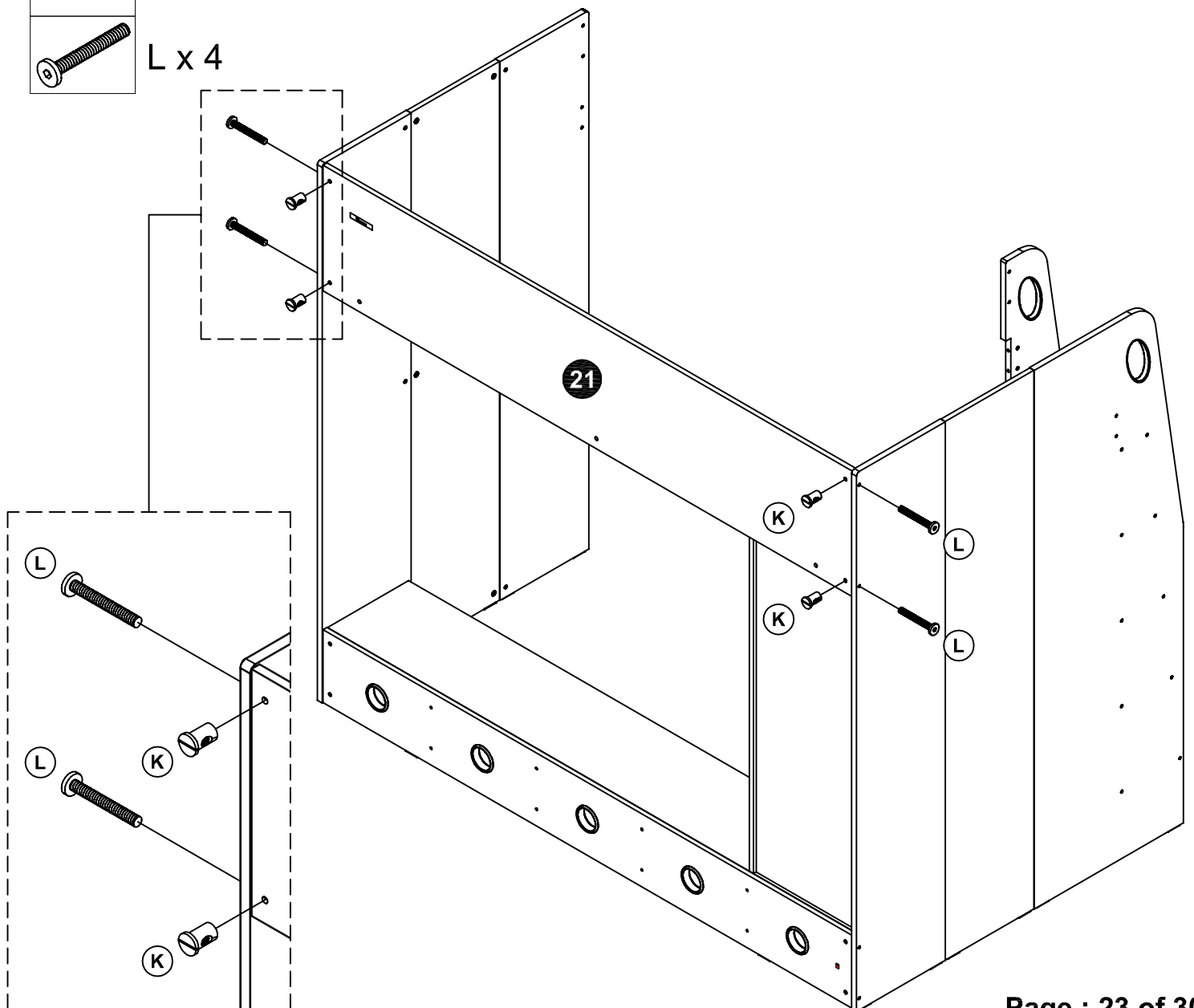

29



G x 6



H x 6

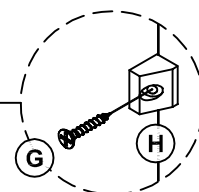
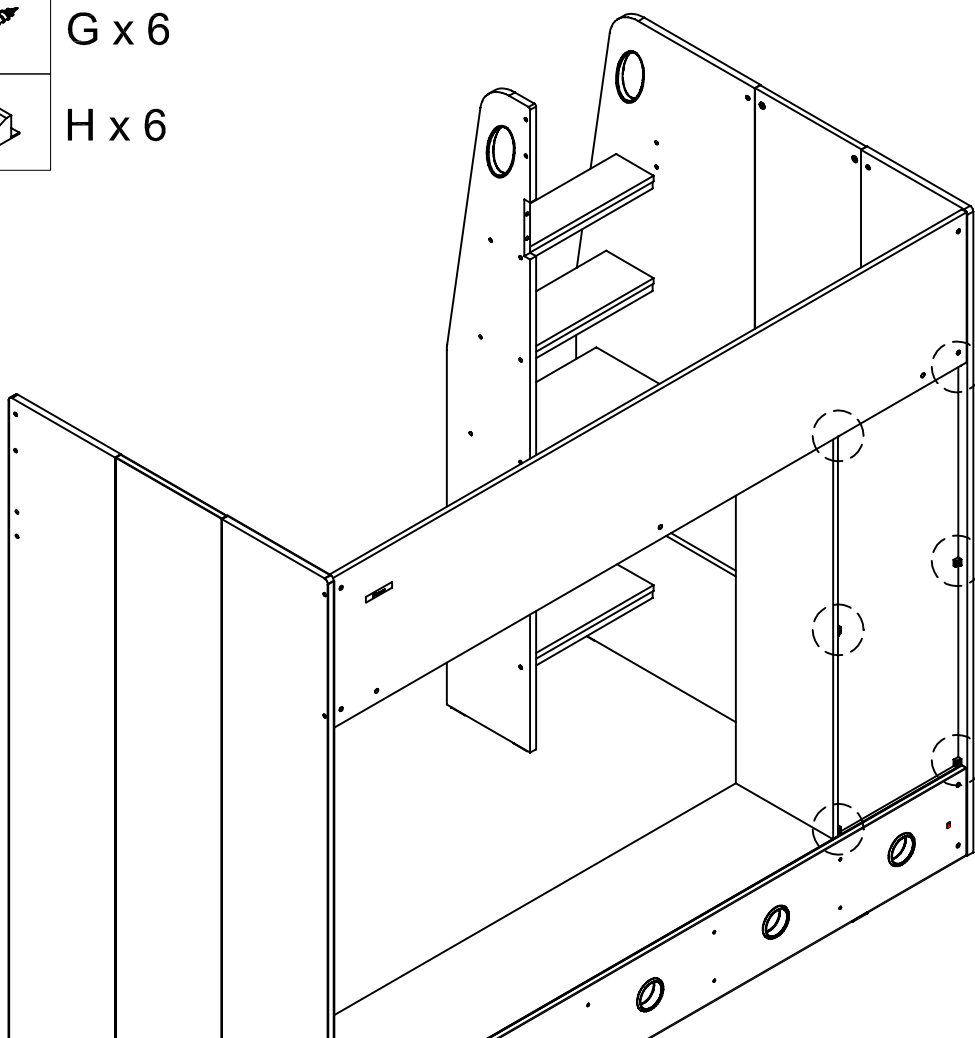

30



Q x 1

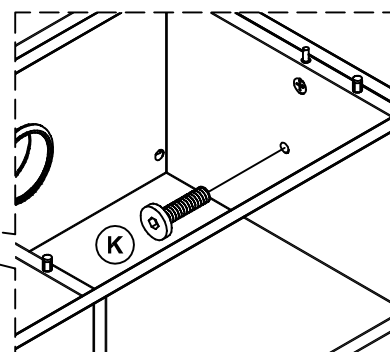
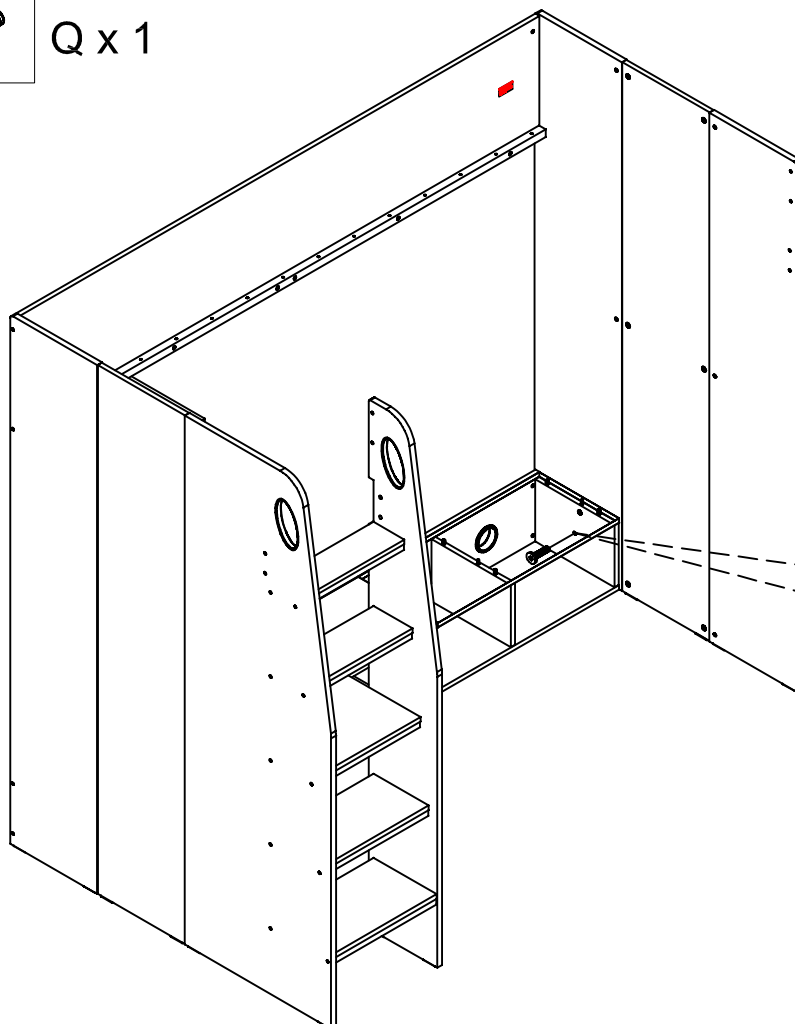

31



J x 4

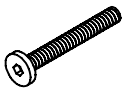

L x 4

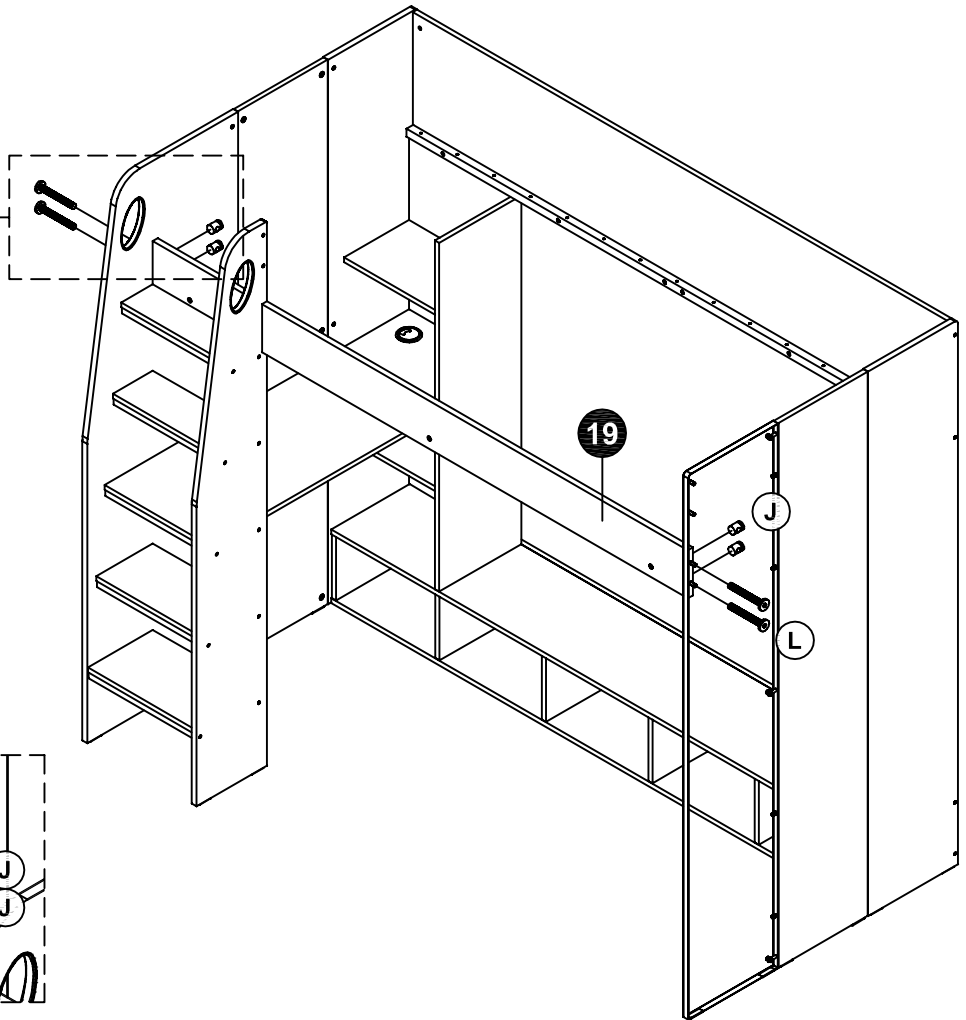

32



J x 2

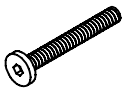

L x 2

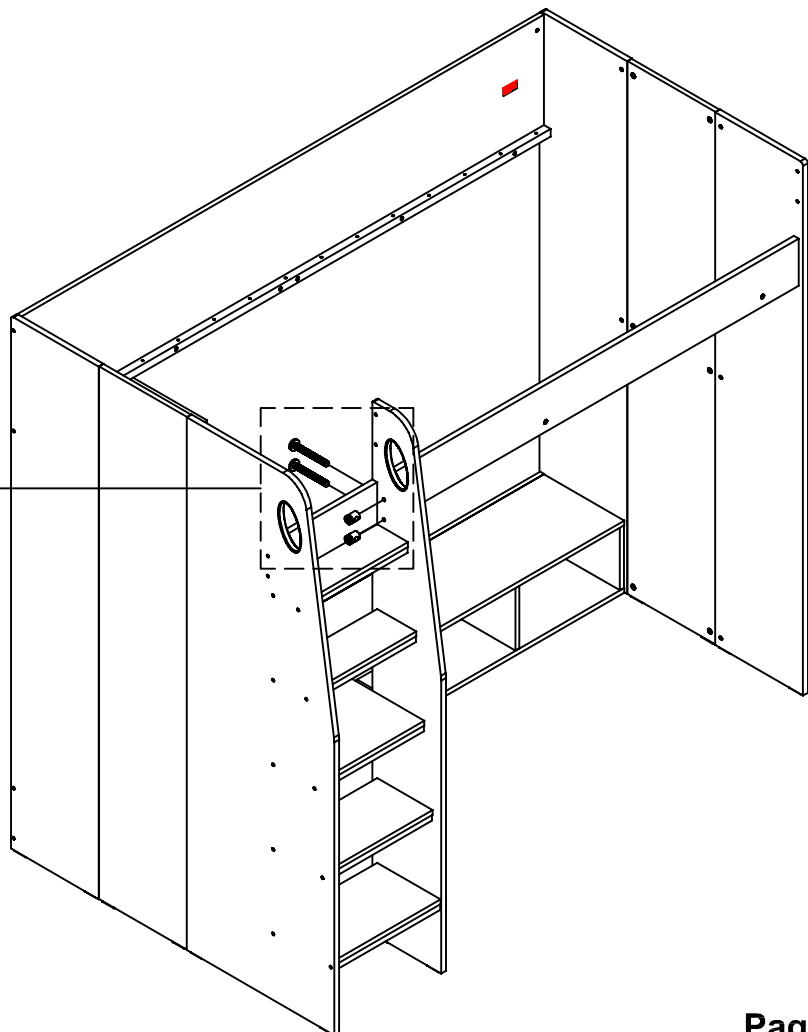
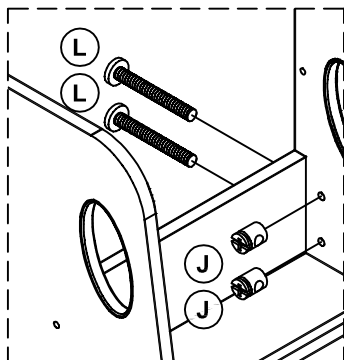

33



N x 5



S x 3



Y x 1

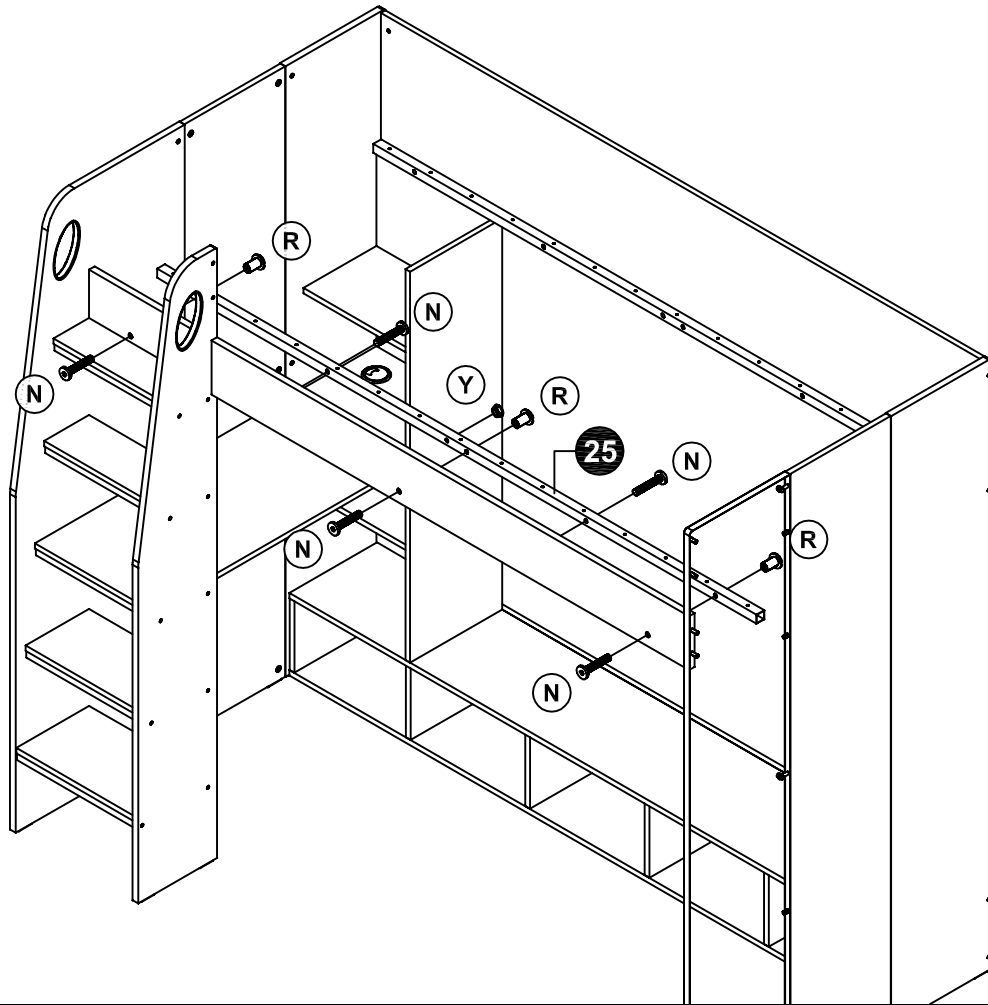

34



P x 30

LVL x15

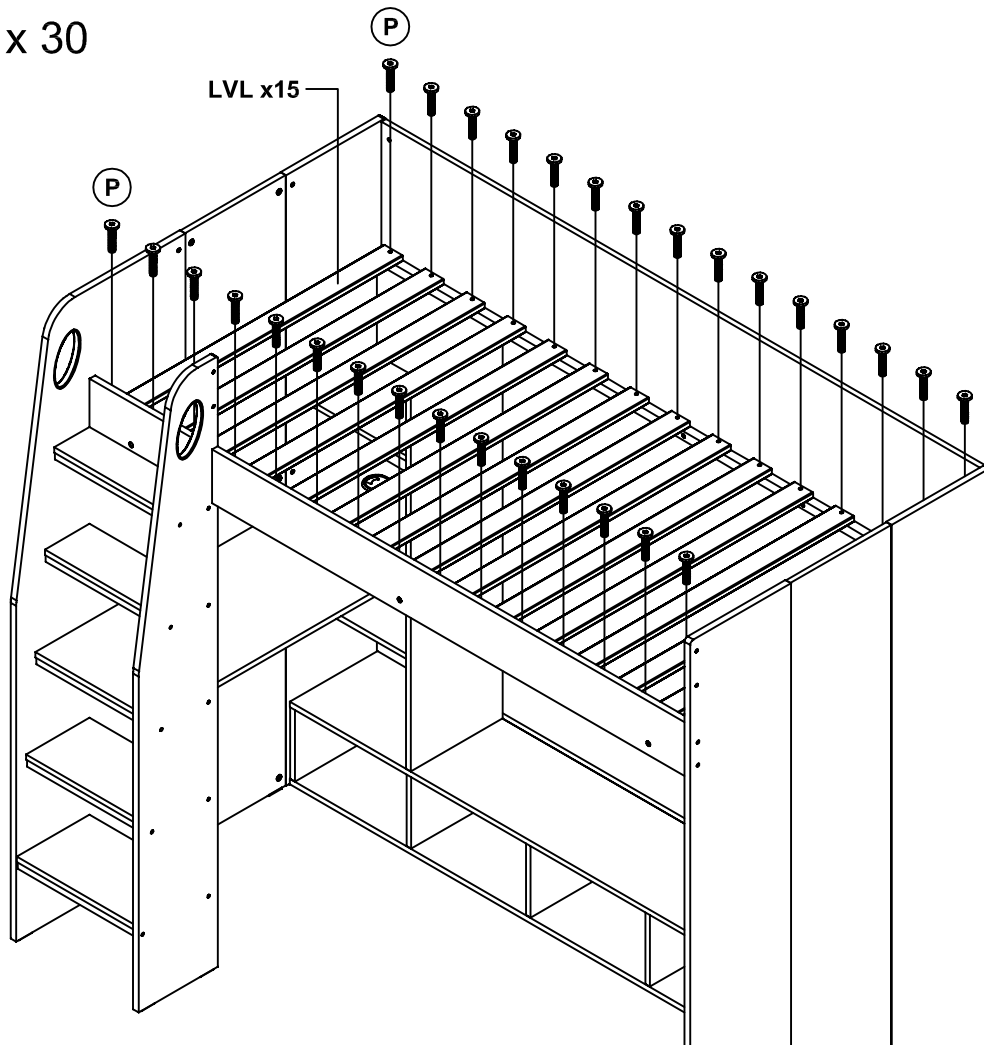

35



J x 4

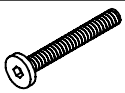

L x 4

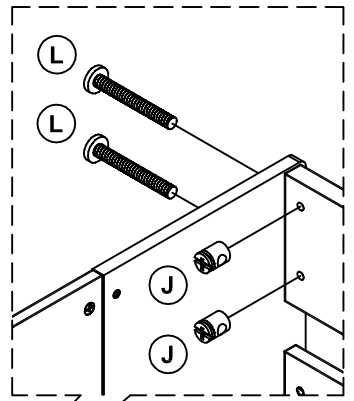
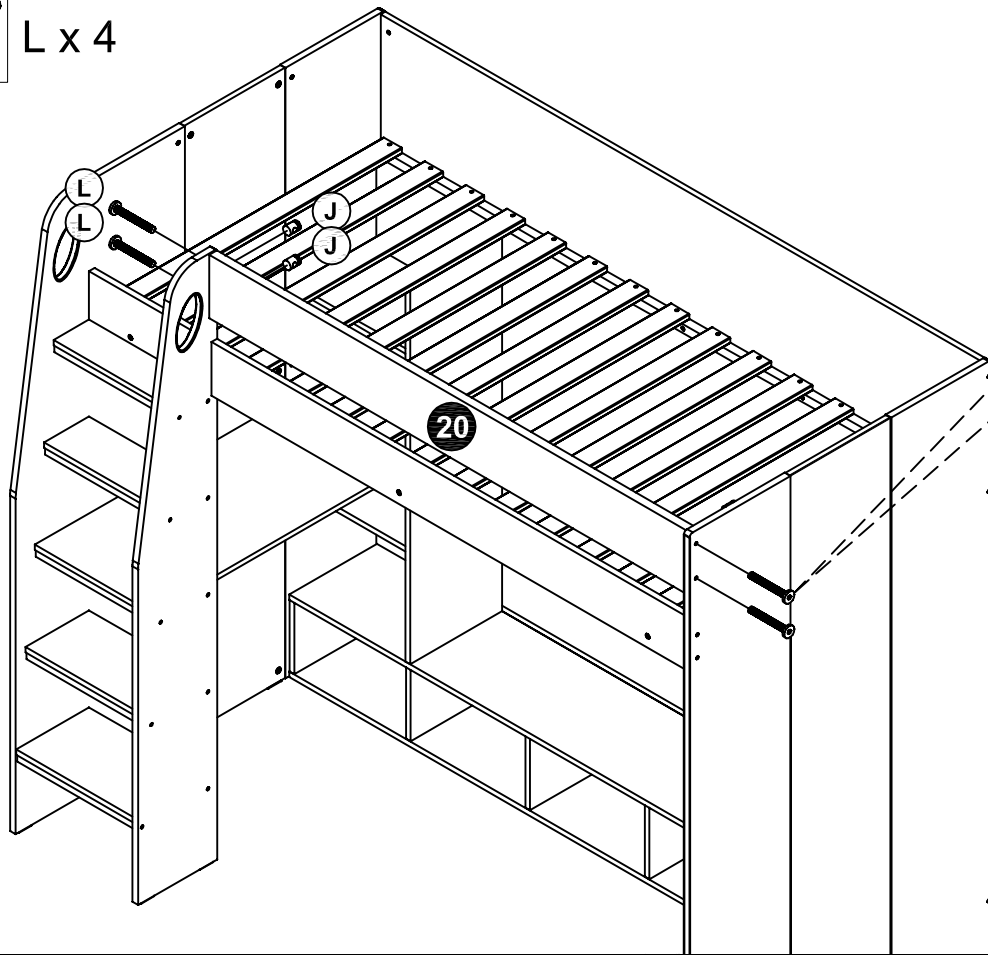

36



R x 2



S x 1

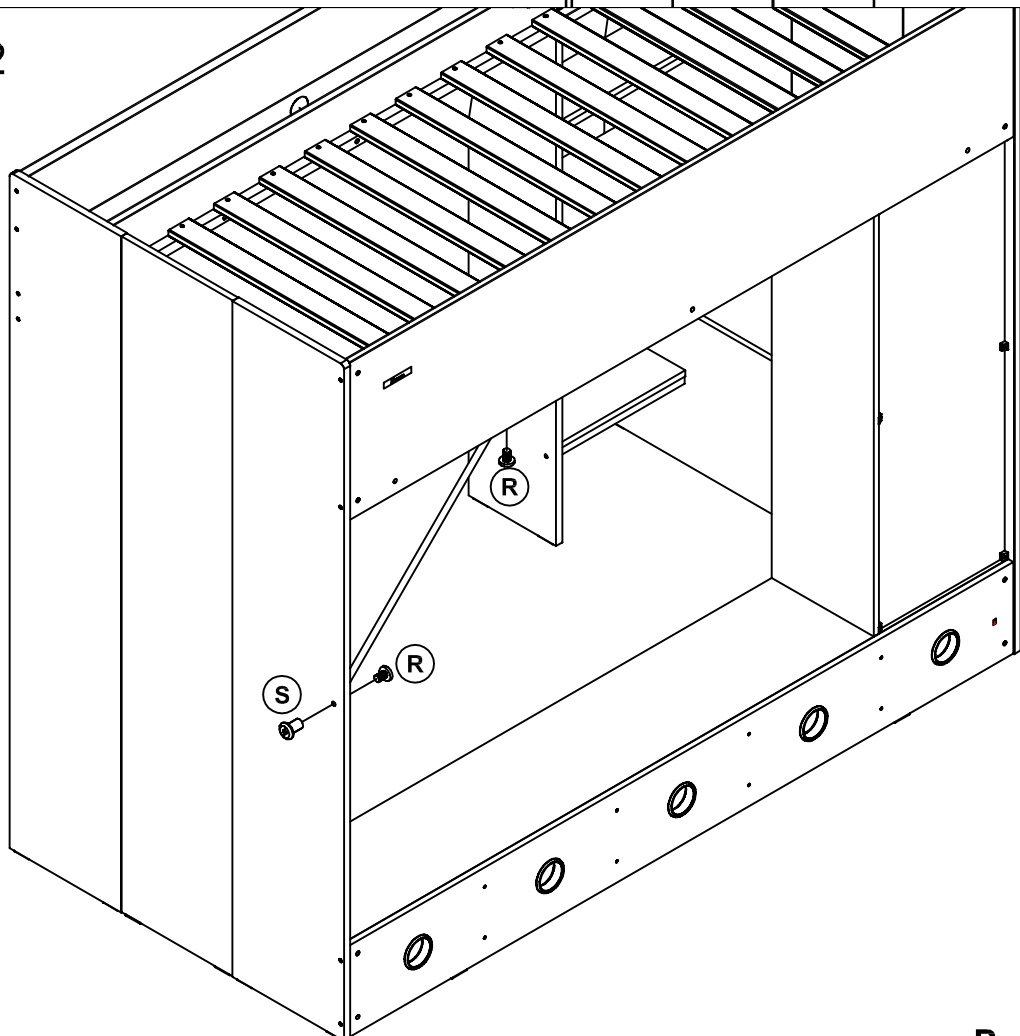

37



X x 6

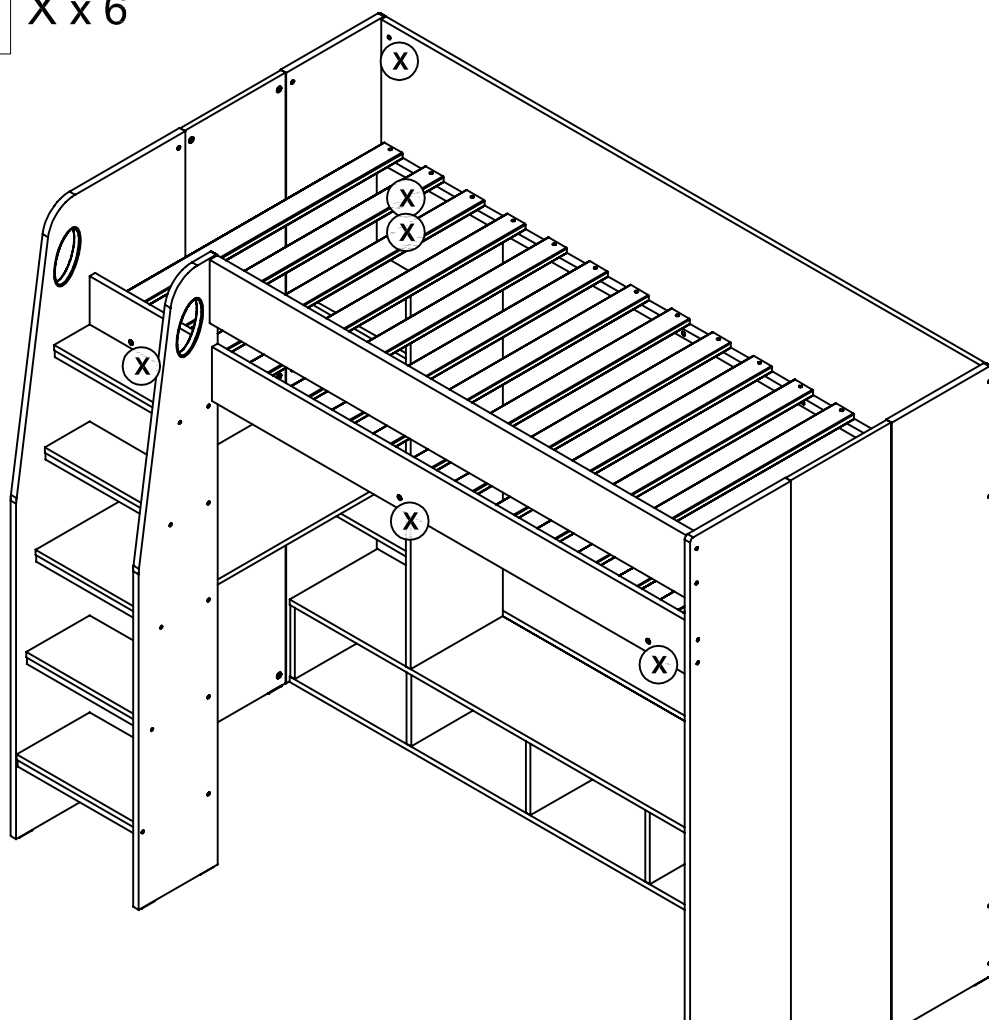

38



X x 5

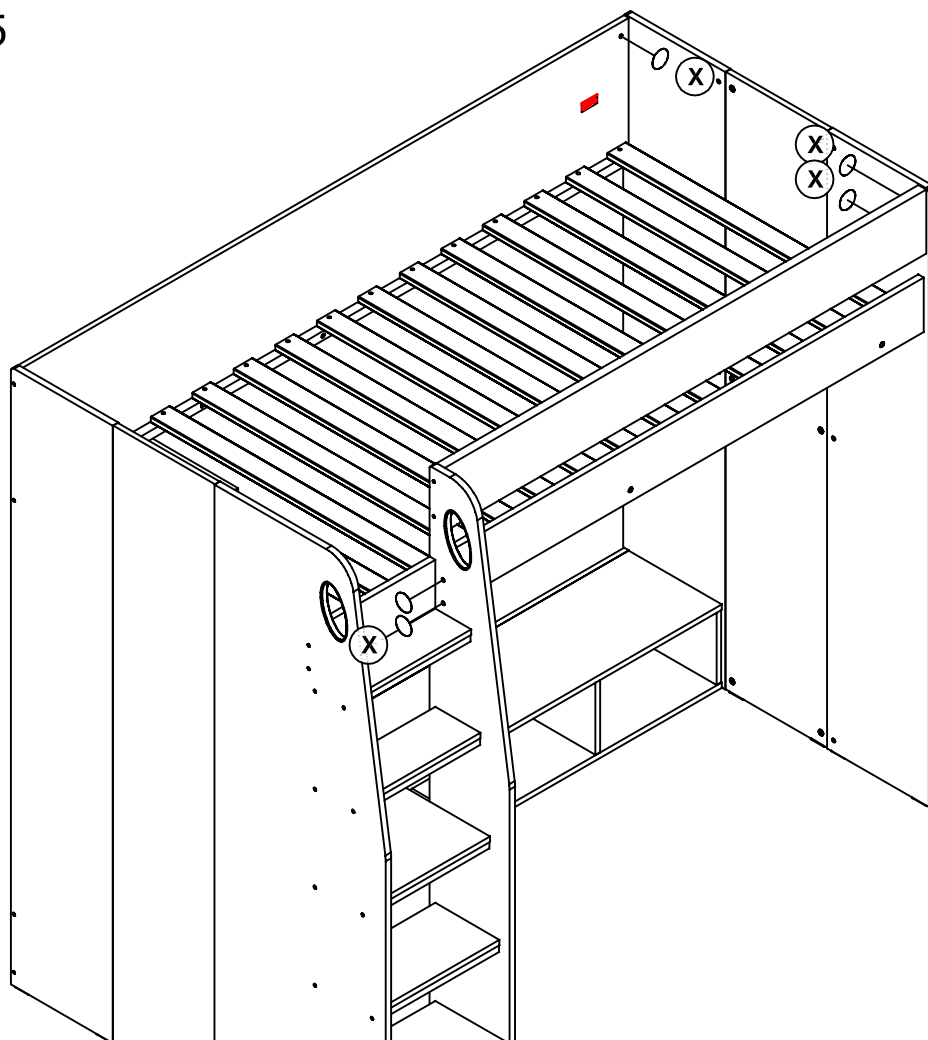

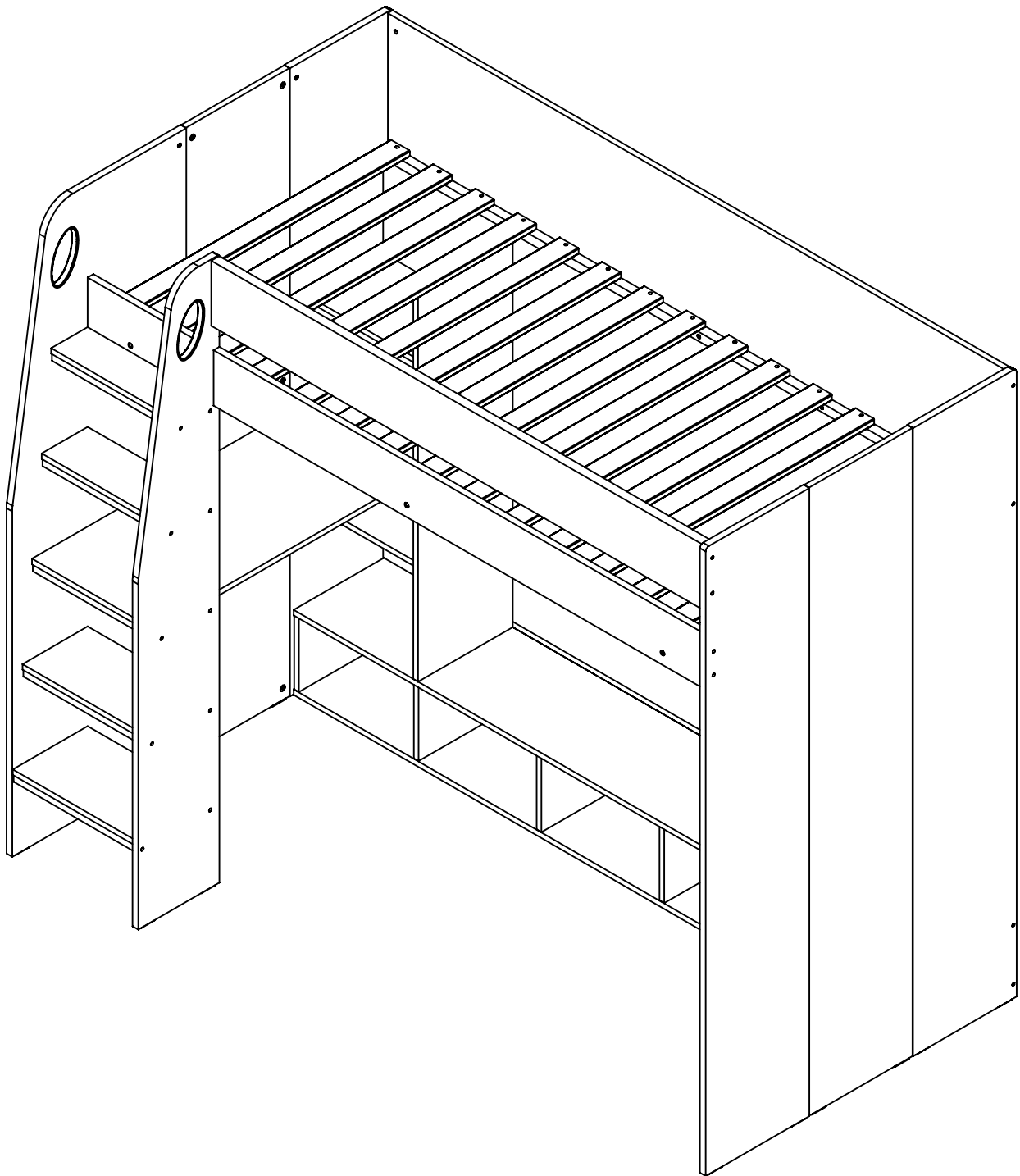

General Care

Wipe clean with a slightly damp soft cloth.

Avoid the use of all household cleaners and abrasives.

When moving your furniture, carefully lift into place. Never drag or push the pieces across the floor as this will cause damage to the joints and could result in failure to the product that will invalidate the warranty.

Recommendations

Periodical re-tightening of fixings.

Warning

This unit is heavy. Please use an assistant when lifting.