

Part List

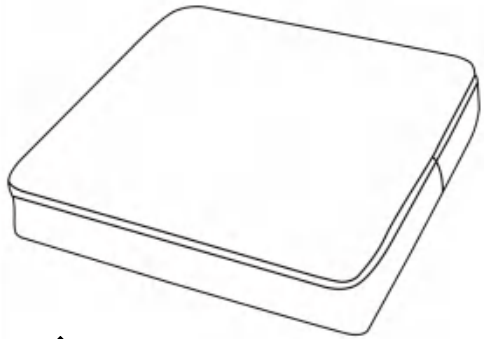

A Cushion×1



B Base×1



C Gas lift×1

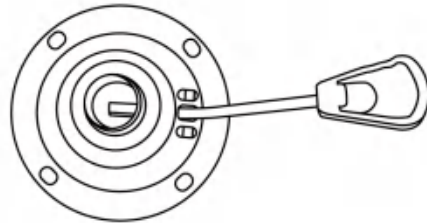

D Adjustment handle×1



E Wheel×5

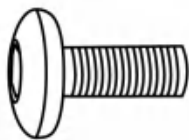

M 6×16

F Screw×4

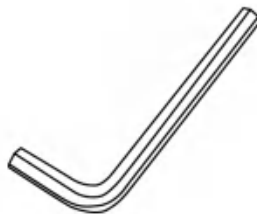

G Wrench×1

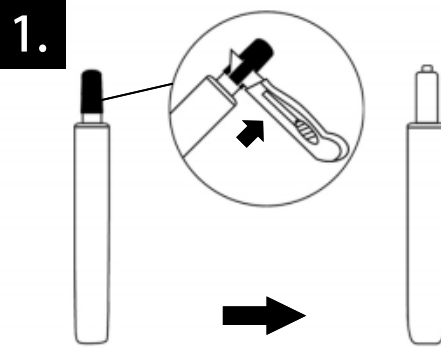

★ Caution: Remove the plastic cap before assembly. This is a part of packaging only. Sometimes the cap cracked firmly inside the seat plate, you' d better to remove it by tools like knife scissor.

