

# INSTRUCTION MANUAL

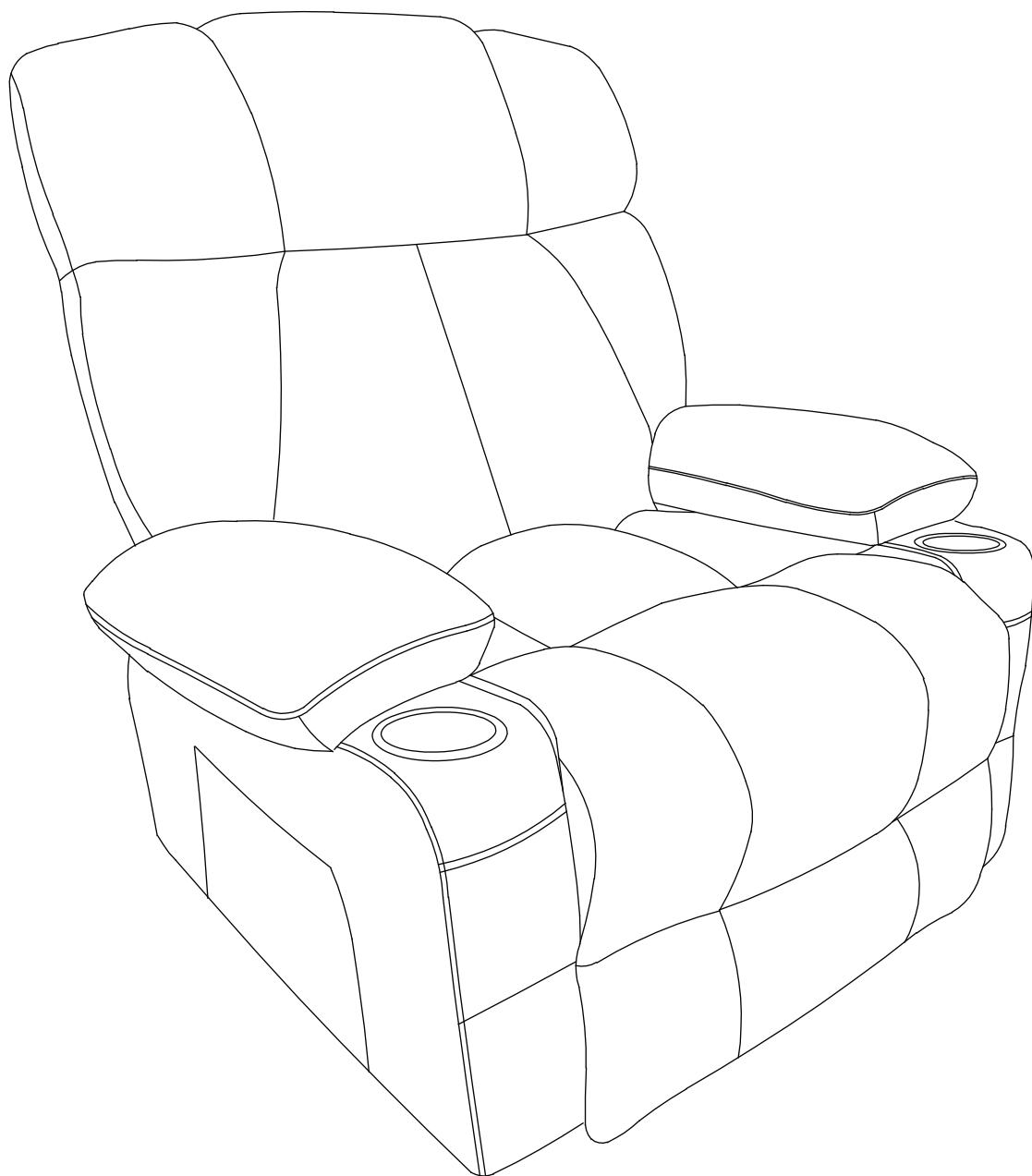

# ASSEMBLY GUIDE

Congratulations, you now have a new function sofa with massage.

Before enjoy the comfort chair, you have to put it together. This Assembly Guide will take you through the basic assembly process. To make sure your assembly goes smoothly, please follow the assembly instructions, and especially the important safety information.

Also, while it is possible to assemble the chair on your own, having a second person to help you makes it even easier.

Before you begin, please check if there are any missing parts from the package. Should there be any issues, please don't hesitate to drop us an email and we'll help you out ASAP.

# PACKAGE LIST

02

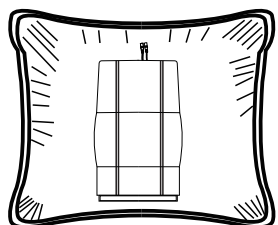

Seat cushion

(A) \*1

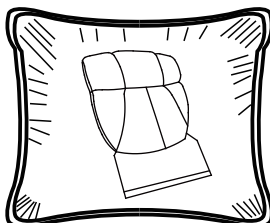

Back

(B) \*1

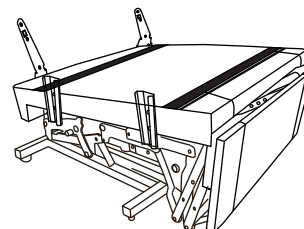

Seat frame

(C) \*1

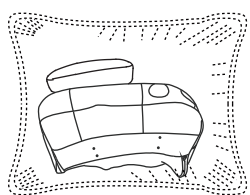

F (R)

Armrest Cover

(F)

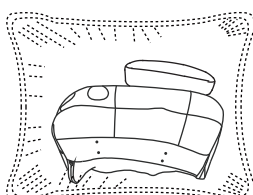

F (L)

Armrest Cover

(F)



Connector \*4

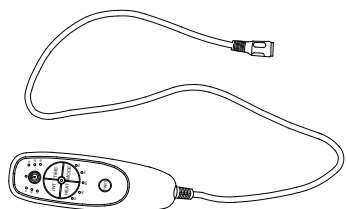

Massager remote control board

(G) \*1

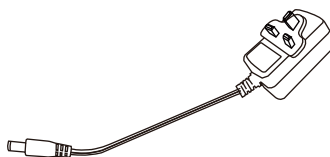

Massager power supply

(H) \*1

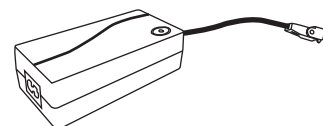

Motor power supply

(I) \*1

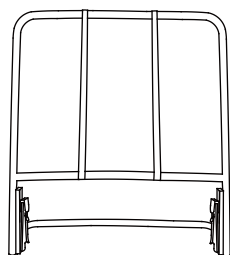

Back frame \*1

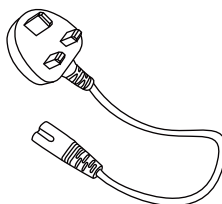

Power line

(X) \*1

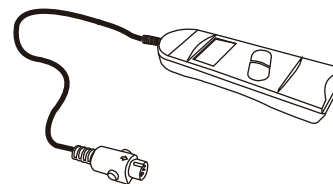

Black and white key controller

(Y) \*1

# PACKAGE LIST

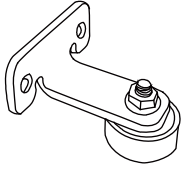

Foot support frame (J)\*2



M6 claw nut (K)\*4



screw (L)\*5

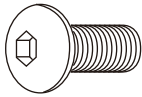

Bolts M6\*16mm (N)\*8



Spanner (O)\*1

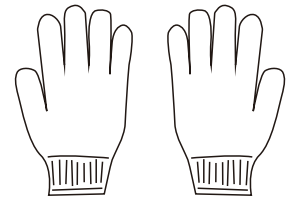

Glove\*1

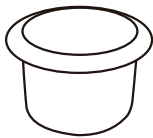

Cup holder \*2

# ASSEMBLY IN STRUCTION

04

Step1:Open the compression bag and remove the soft bag.

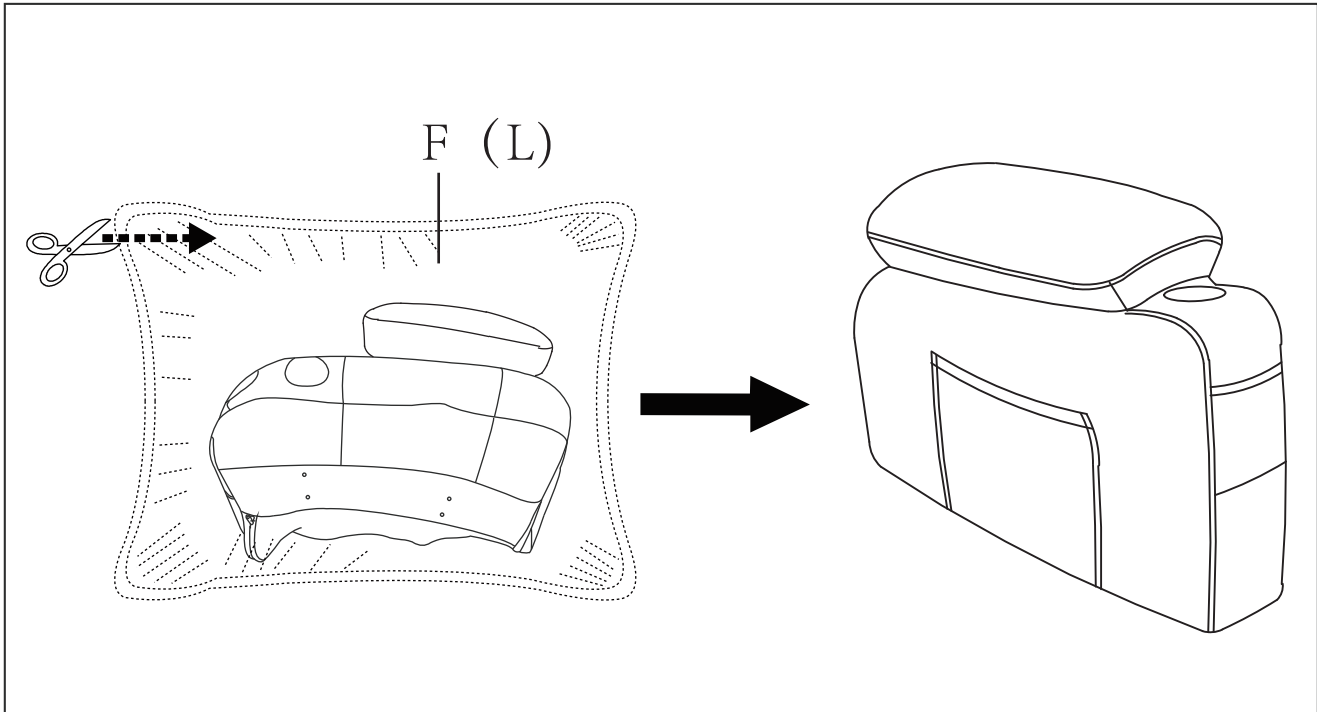

Step2:Open the compression bag and remove the soft bag.

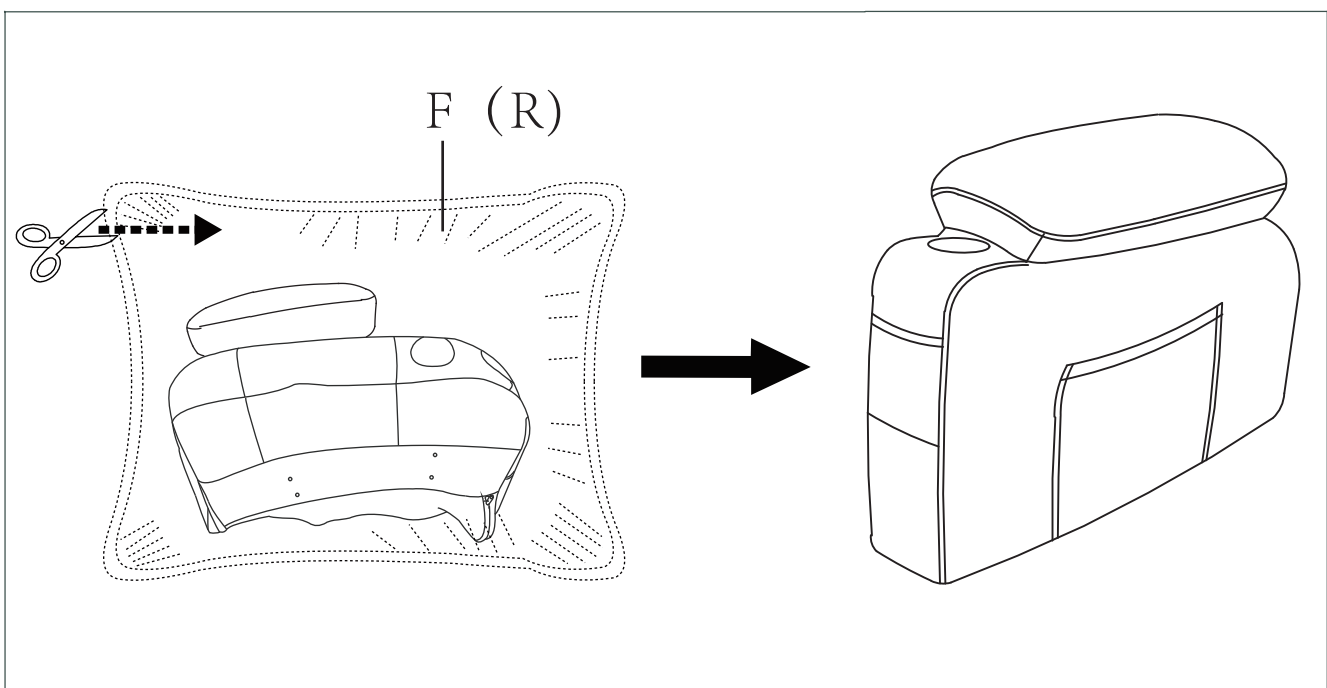

# ASSEMBLY IN STRUCTION

05

Step3:Fix the connector to the inside of the armrest with M6x16mm bolts, paying attention to the direction of fixing the connector.

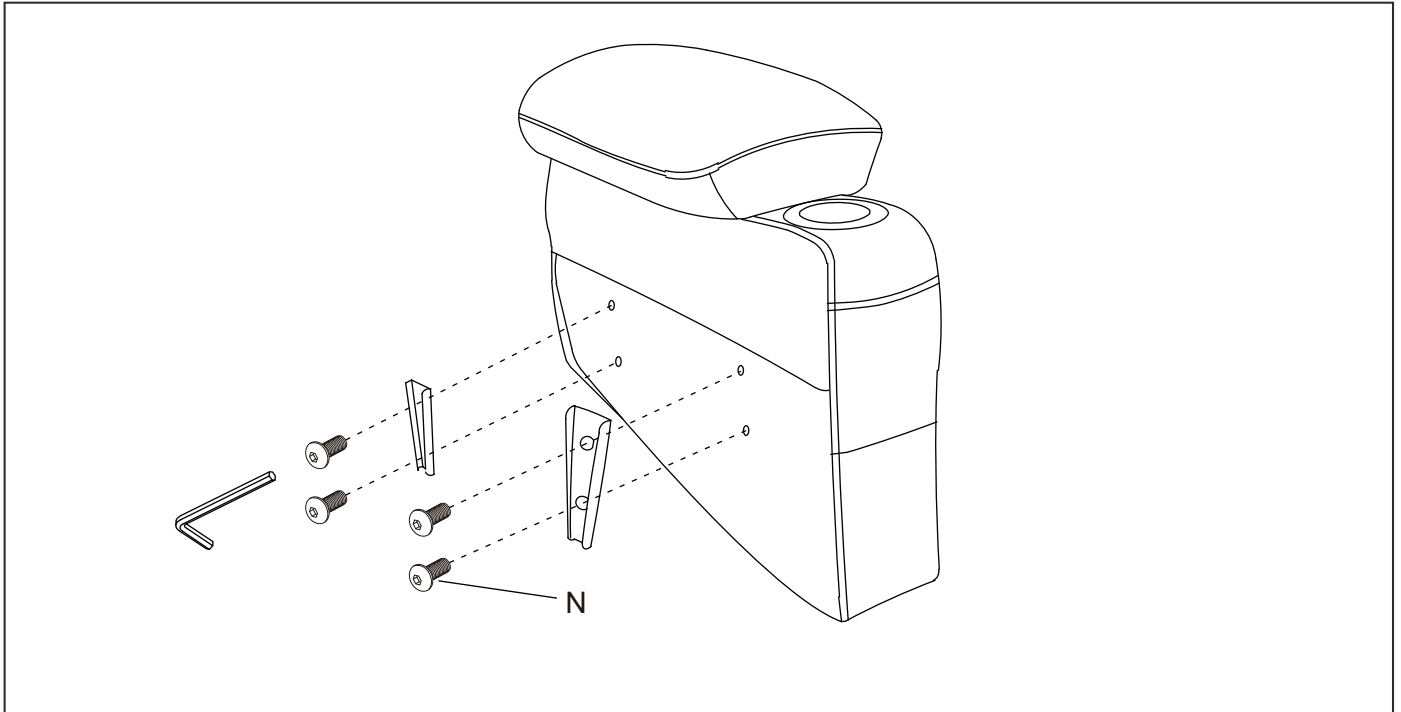

Step4:Fix the connector to the inside of the armrest with M6x16mm bolts, paying attention to the direction of fixing the connector.

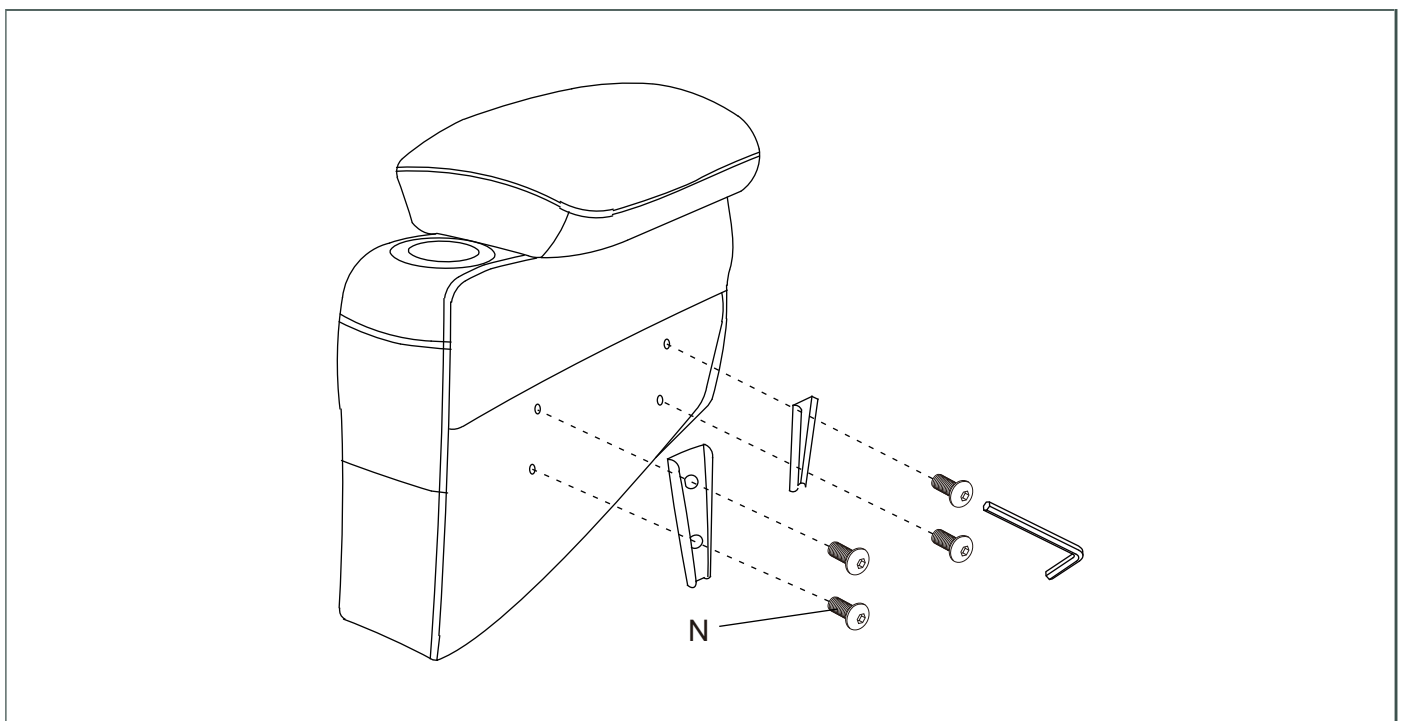

# ASSEMBLY IN STRUCTION

STEP 5: Install the armrest cup holder.

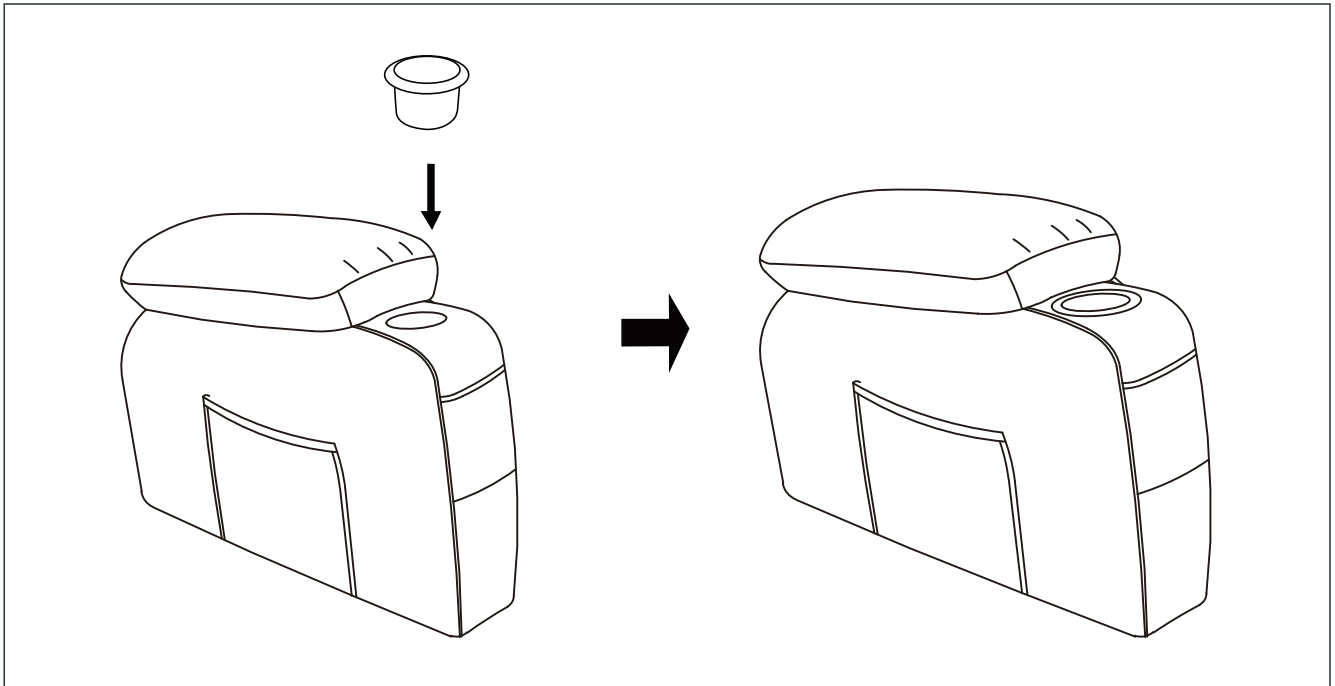

STEP 6: Insert arms so that they can fit into the seat, you will hear a "click" when they are engaged.

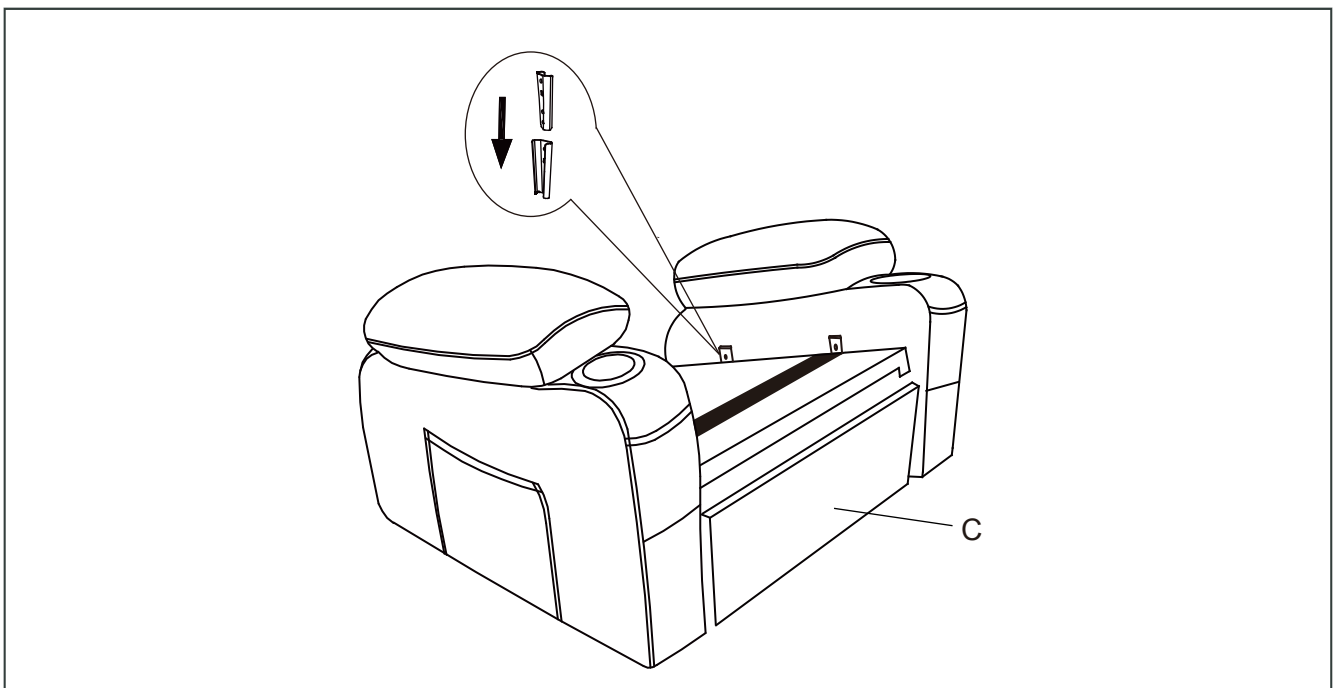

# ASSEMBLY IN STRUCTION

07

STEP 7: Connect the hand controller ( Y ), then connect the power adapter ( I ) to the motor cable, and lock locking cables, finally, connect the power cord ( X ) to the power adapter ( I ), spread out the leg rest using the controller.

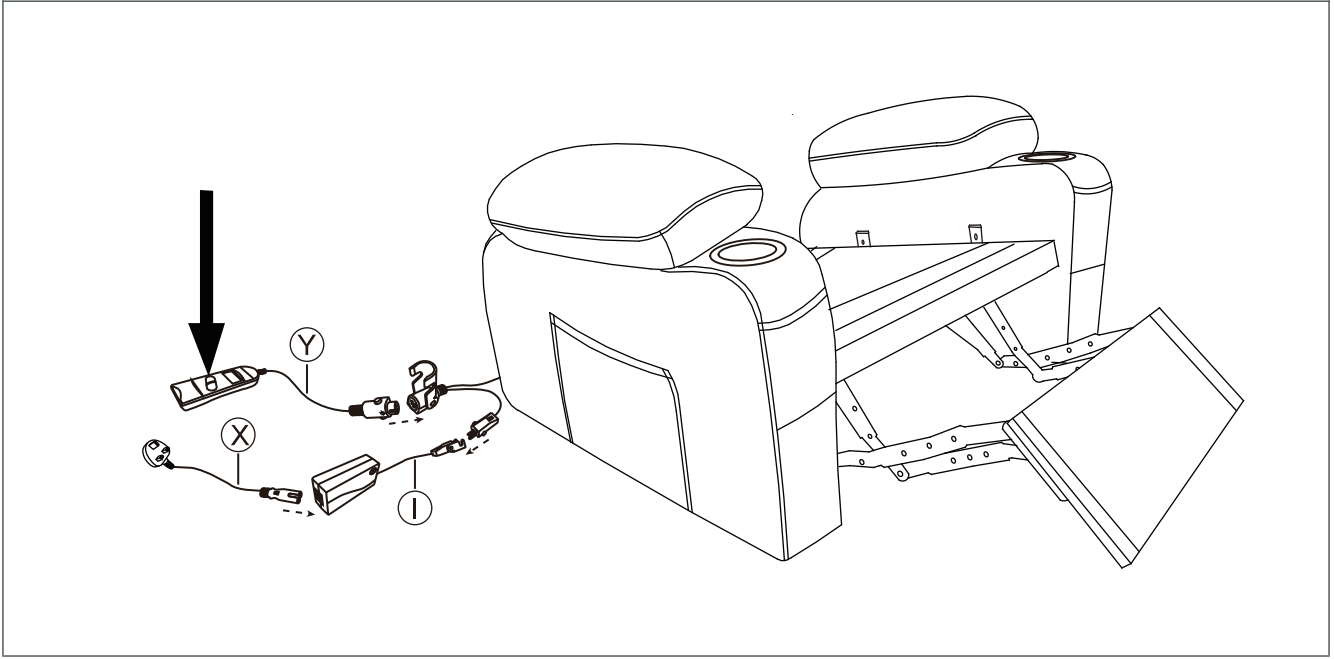

STEP 8: Put the seat cushion to the corresponding position and stick the magic sticker to fixed seat cushion.

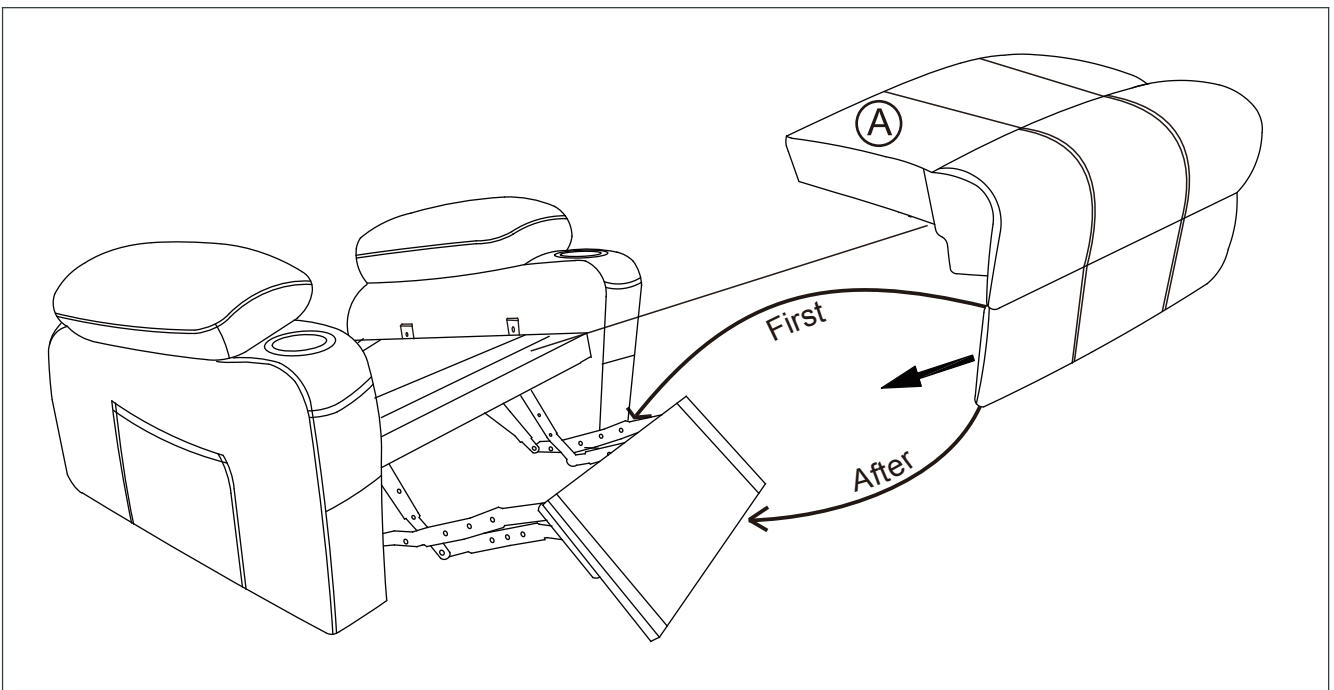

# ASSEMBLY IN STRUCTION

08

STEP 9 :Plug the back pad into the seat frame, and then connect the massager line white and white, red and red, black and black, and the massage line with the hand controller.

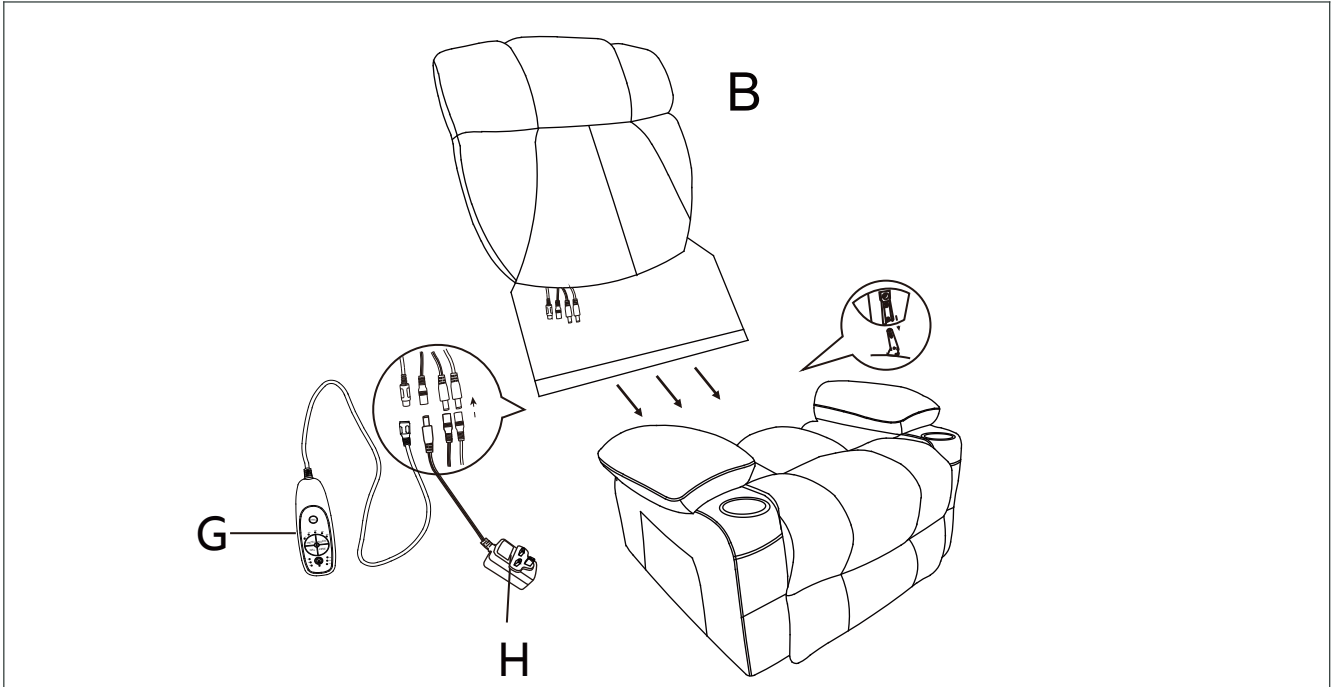

Step10: Turn the screw L through the support frame K, seat cushion frame successively, and then lock it with the nut J and the screw L.

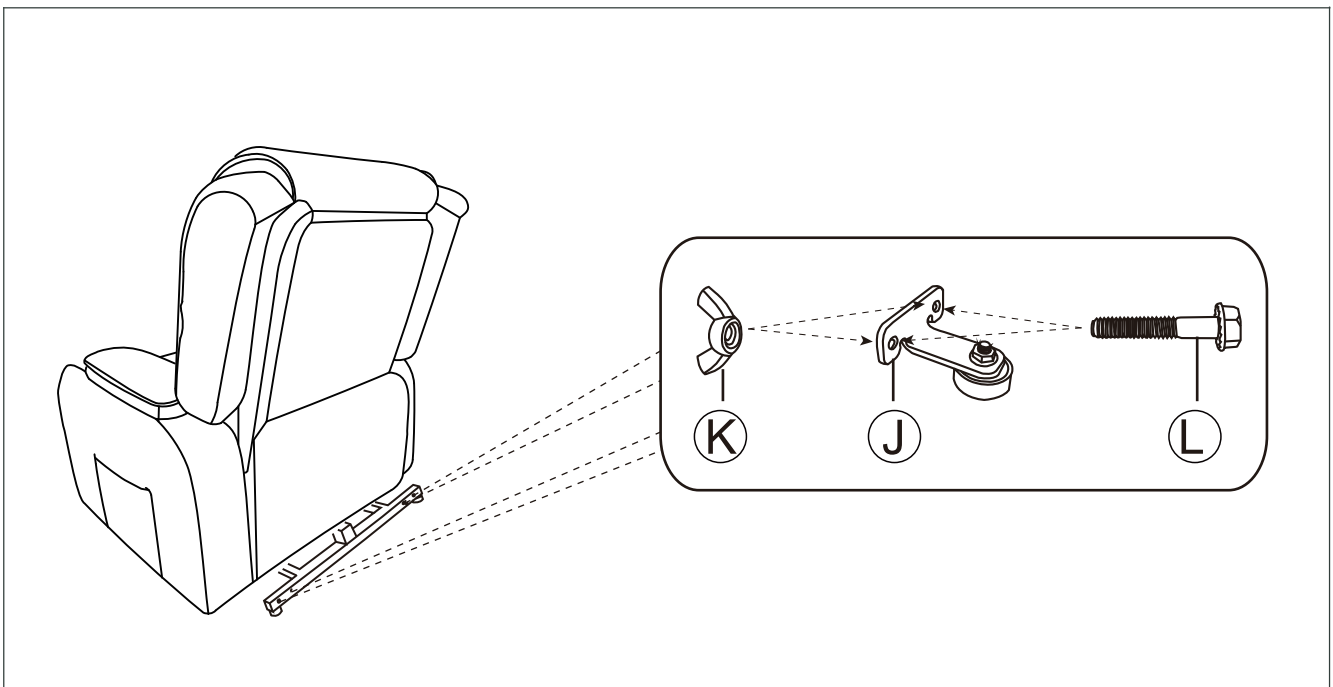

# ASSEMBLY IN STRUCTION

STEP11:Stick the velcro from the back frame to the seat frame.

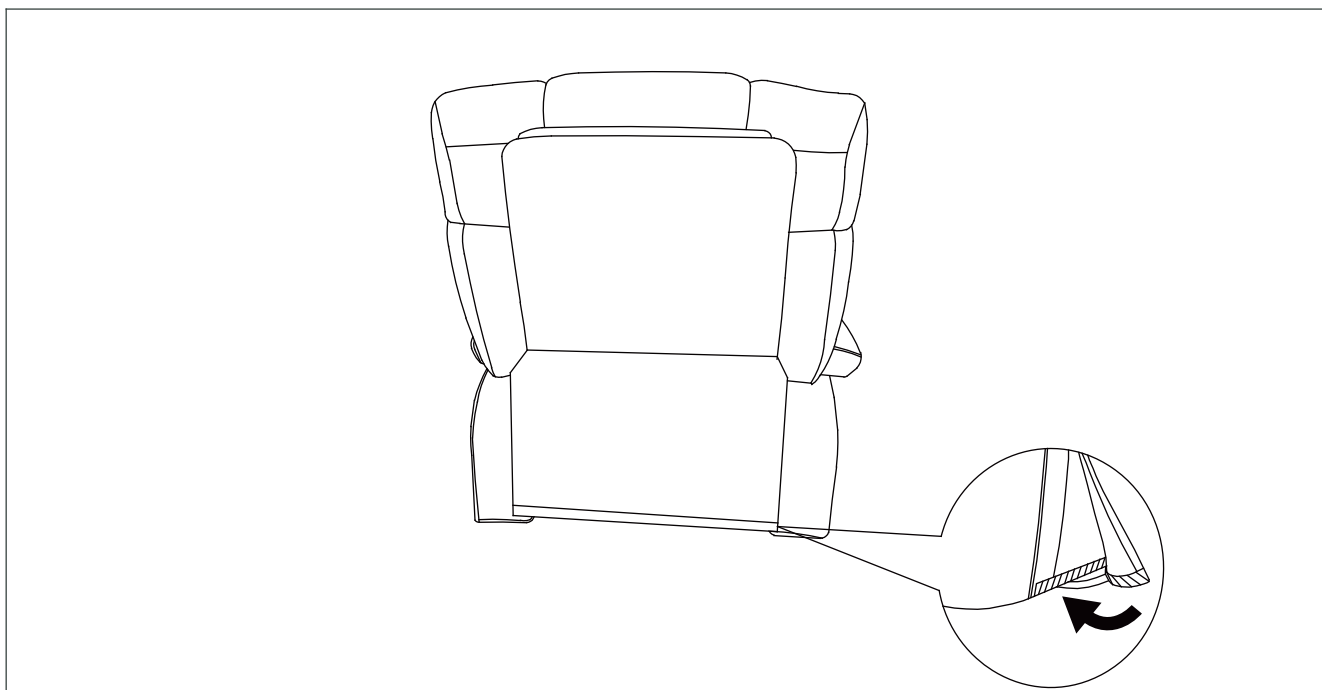

*Congratulations! You've assembled*  
**Your Sofa!**

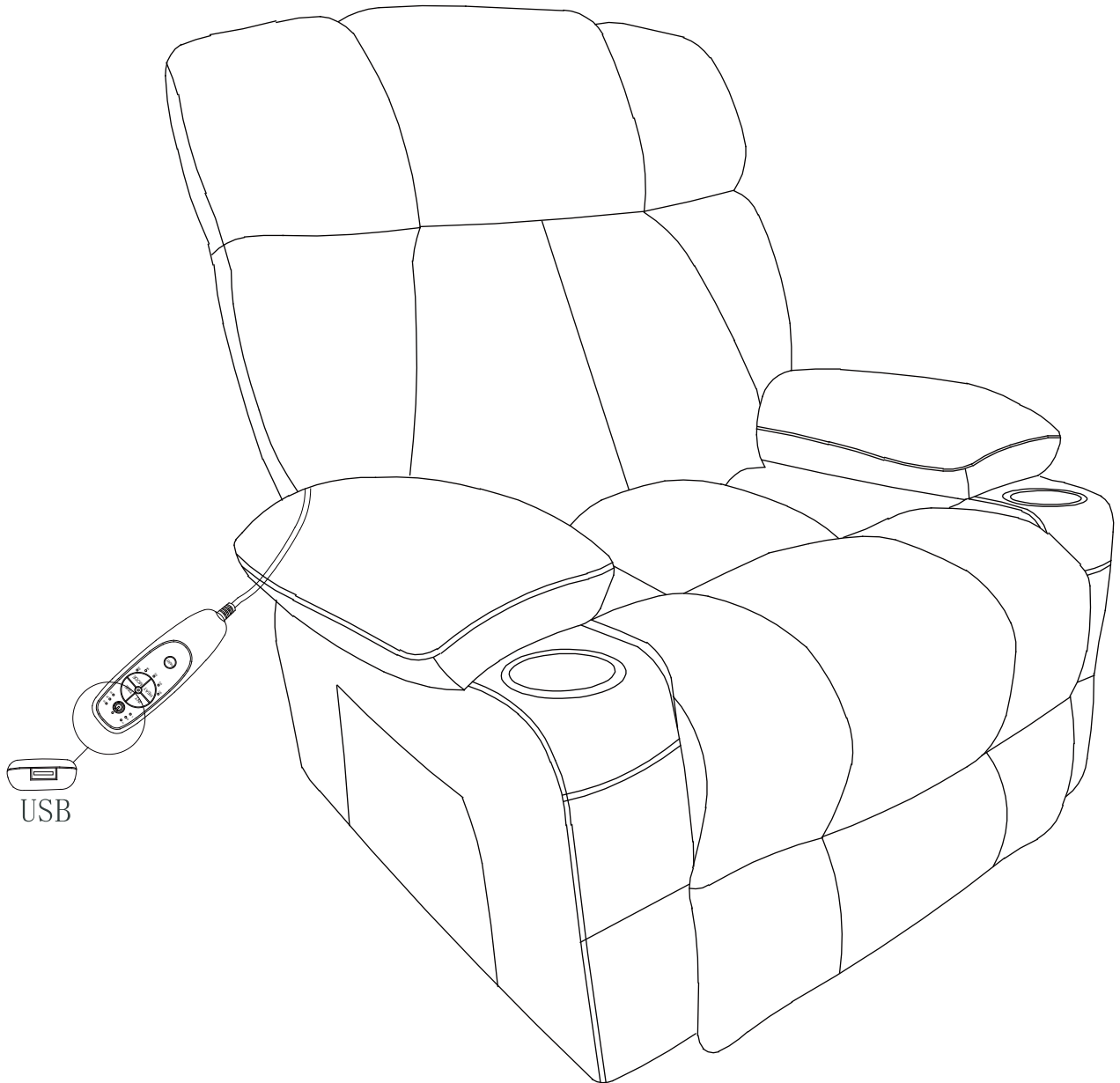

**Important Note:**

Before reclining the chair, please remove the backrest pillow from the backrest. This ensures that the chair can tilt smoothly without any obstruction. Thank you for your understanding and cooperation.

# MASSAGE CHAIR

READ ALL INSTRUCTIONS  
BEFORE USING THE ITEM

## REMOTE CONTROL

Function of remote

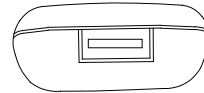

USB

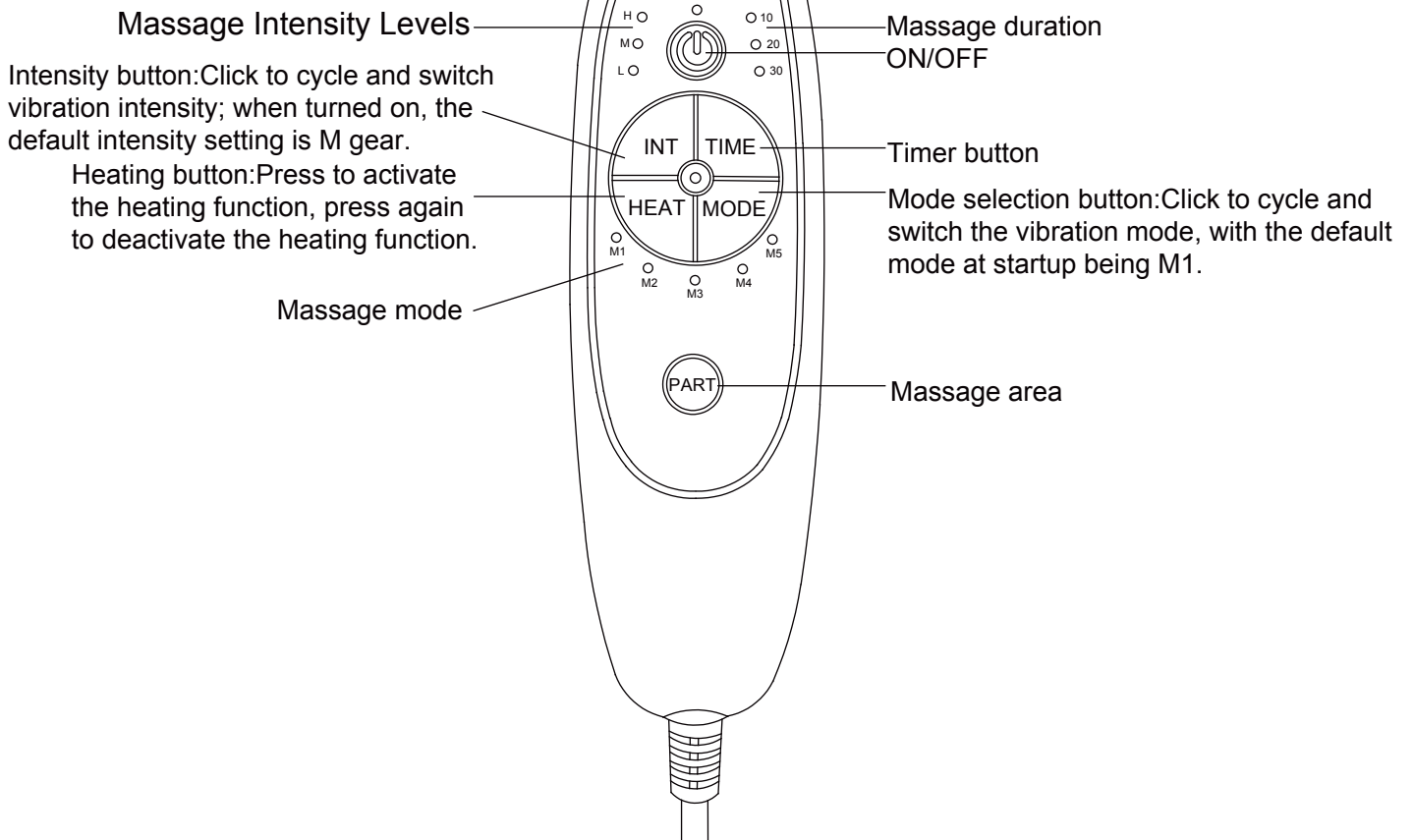

## I 、 Specifications of power adapter

The power is on in the standby state. The user can activate the function via the hand controller.

Input:AC100-240V,50Hz/60HZ;Output:DC12V1A.

## II 、 Product features

- 1、 8 points massage
- 2、 One-way switch for independent heating plate operation
- 3、 Three-segment timing, with a default shutdown time of 10 minutes.
- 4、 Three levels of vibration intensity
- 5、 5 vibration modes

## III、 Function details

- 1、 Switch on and off
- 2、 TIME: Cycling through massage durations (10/20/30 min). Default startup is 10 minutes.
- 3、 MODE: Tap the five vibration modes to switch (M1/M2/M3/M4/M5). The default startup mode is M4.
- 4、 INT: Switch intensity by vibration strength (H/M/L). Default startup is M (medium).
- 5、 HEAT: Click to toggle heating.
- 6、 PART: Vibration positioning key. Default startup is full vibration; tap to switch to single-part vibration.
- 7、 Massage Intensity Levels
- 8、 Massage duration
- 9、 Massage mode

## Warnings

1. Sit down in the chair gently. To avoid tipping over, do not throw yourself into the chair. Move the chair into the reclining position slowly, making sure that no children or pets are in close proximity. Do not allow children to play on or around the chair, particularly when it is in an open position.
2. Close the recliner completely before getting out of it.
3. Never sit on the footrest when it is open, even if it is a child.
4. To eliminate the risk of tipping over, do not sit on the arms or footrest of the chair.
5. This chair is designed to be used by 1 adult at a time.
6. Please forbid people with the following ailments from using this sofa: Those people with severe symptoms of heart disease, high blood pressure, cerebral thrombosis and others who are sensitive to heat or completely insensitive to heat, those with brittle bones or have issues with waist support pregnant women, children and others where it has been determined they are not suitable to use this product under the guidance of doctors.
7. To fully recline the sofa, ensure the sofa well, you need to put the sofa at least 19 inches away from the wall or any other obstacle.
8. Product cannot touch water, fire, etc. Product can also not come in contact with sharp objects (knives, nails, etc.)

## Maintenance Manual Instructions

1. To avoid dropping, you should carry the sofa carefully.
2. If you find dirt and or stains on the chair, spray the sofa with a sofa specific cleaner then use a sponge or cloth to wipe the dirt away. Do not use water, soapy water or cleaner with waxed wooden areas. Take care to wipe the sofa carefully and gently.
3. Do not put the sofa in an area with direct sunlight and do not put the sofa directly in front of an air conditioner, this will fade the upholstery and make it brittle.

## How to Disassemble

Please find a strong tool to prod the small piece of metal grooves, then the backrest will be pulled out. The tool is not included.

