

Drill-Free Handshower Holder

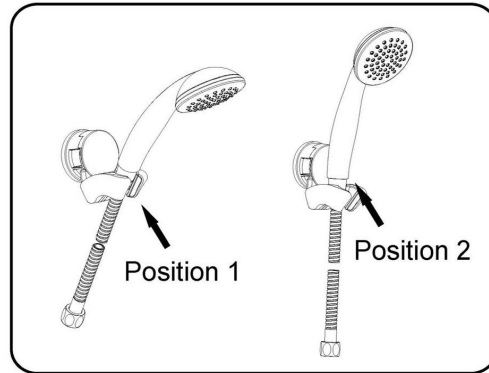

Water drops



Dirty

- Make sure the wall is **CLEAN** and **DRY** before installing the suction wall bracket
- Only work on completely flat surface, like glass and fiberglass wall
- For better suction force, please re-install every 6 months
- No tool required for installation
- 2-position handheld shower holder

Tip: Put a thin layer of lotion on the entire surface of the black rubber to improve the suction force

1. Slide the cover out.

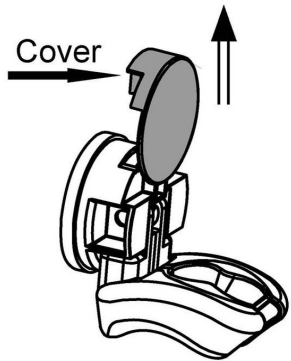

2. Push up the hook and press the drill-free handshower holder against the wall firmly.

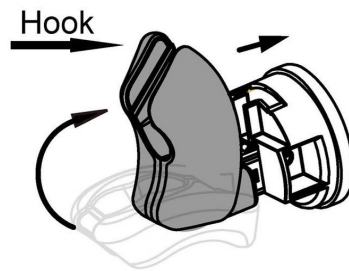

3. Push down the hook.

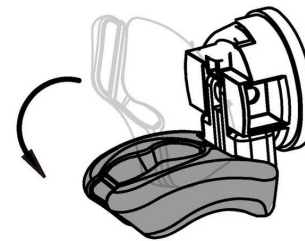

4. Slide the cover back.

