

# Bookshelf

Congratulations on the purchase of your Bookshelf. This bookshelf has been crafted to the highest standards of quality and safety and will give you many years of enjoyment and practical use.

Since this bookshelf is a natural wood product, there will be variations in color and grain, and minor checking may occur. This is normal and does not compromise the integrity of your bookshelf. In fact, variation in character of solid wood is integral to the beauty and appeal of solid wood furniture, and distinguishes it from prefabricated, synthetic and composite materials.

If you need assistance, please contact the toll-free Customer Service Team

**Thank you and Enjoy**

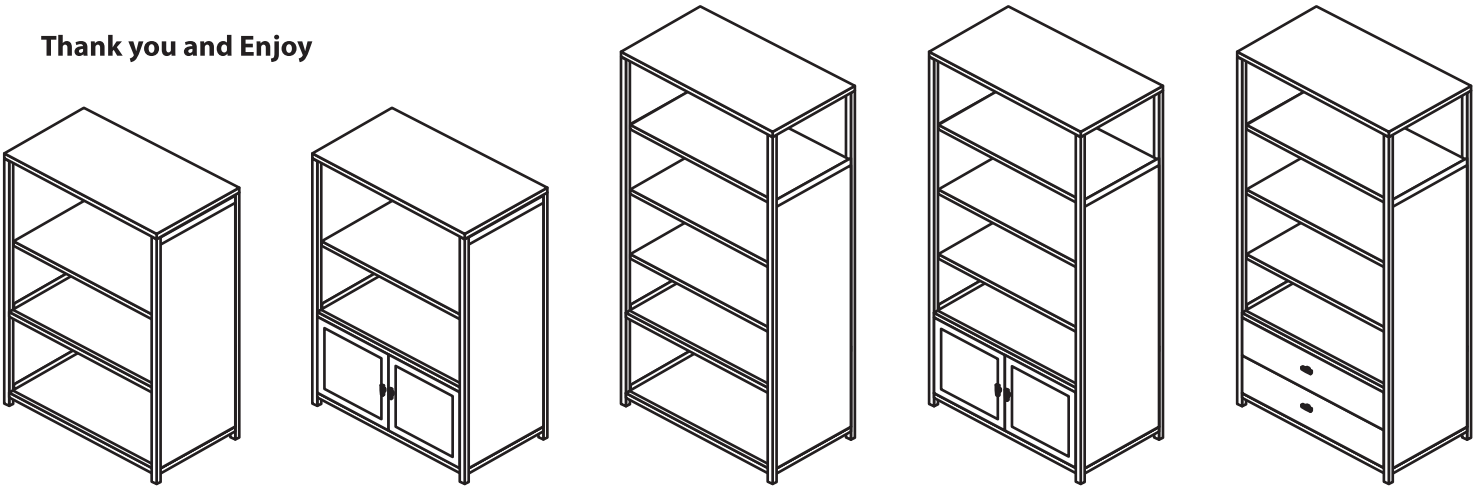

## PARTS

2



**Velcro**

1



**Tip-Over Straps Pack**

Each contains 8 screws, 4 strap brackets and 2 straps

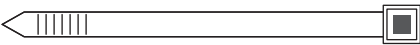

### WARNING:

Furniture tipping over can create a significant hazard in the home, particularly to young children, although adults can be injured as well. It is recommended that casegoods over 30" in height be secured with some form of anti-tip over device. This bookcase comes with anti-tip over straps that reduce the risk of tipping. These can be easily installed in minutes. We strongly recommend that you use them, especially where children are concerned and where earthquakes may pose a hazard.

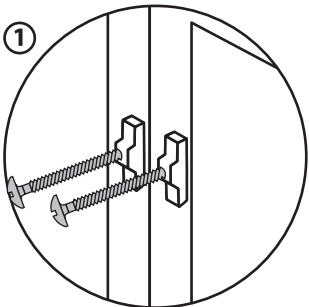

Using a Phillips head screwdriver, remove the handle screw, and install the handle on the front of the drawer.

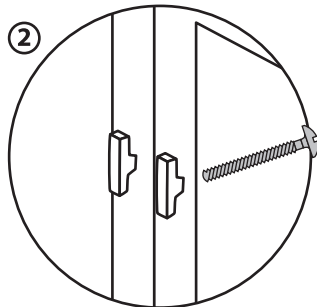

Do not turn the handle to tighten or loosen the screw. Doing so will cause the handle to scratch the front of the door. Using a Phillips head screwdriver, remove the handle screw and install the handle on the front of the door.

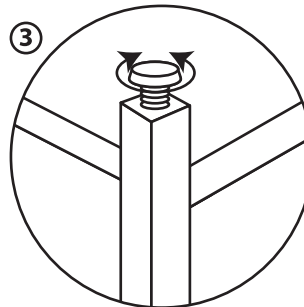

Adjust the levelers on the bottom of the legs by loosening or tightening them so all legs of the bookcase sit evenly on the floor. Turn clockwise to raise and counterclockwise to lower the leveler.

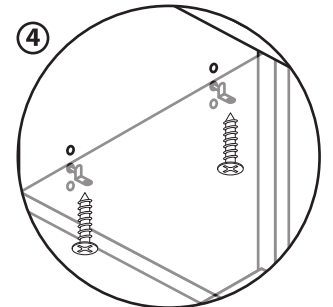

To change the position of each shelf, use a Phillips head screwdriver to remove the screws which attach the shelf pin to the bottom of the shelf.

# Anti-tip over straps installation guide

- 1) Use four of the shorter screws provided to attach two plastic strap brackets to each end of the top of bookcase using the pre-drilled holes. These holes are drilled so that the brackets will be 16" apart on center. This corresponds to typical stud placements in most homes.

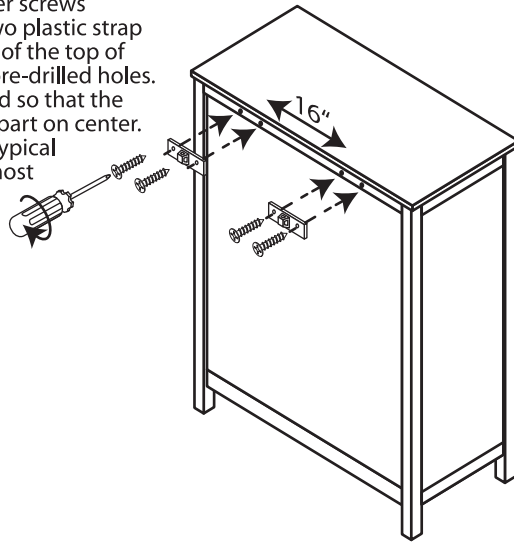

- 2) Use four of the longer screws to attach two of the plastic strap brackets to the wall at an appropriate height considering the height of the plastic brackets on the bookcase: You will want to attach the wall brackets at a height equal to or less than the height of the plastic brackets on the bookcase. Brackets should be located 16" apart in line with wall studs. If you cannot find a stud, use dry wall screws to secure the two brackets to the wall 16" apart.

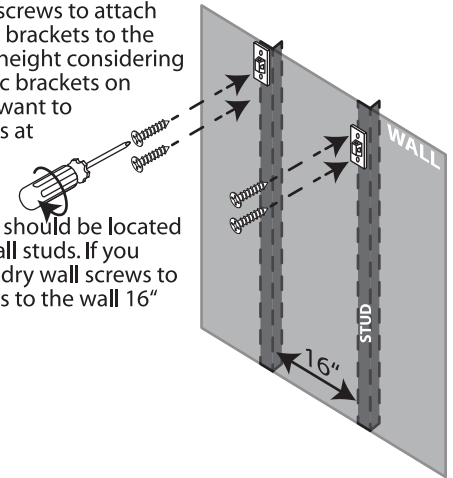

- 3) Slide the plastic straps through both wall brackets. The plastic straps should be arranged so that the bumpy side is facing away from the wall and the receiving heads are up.

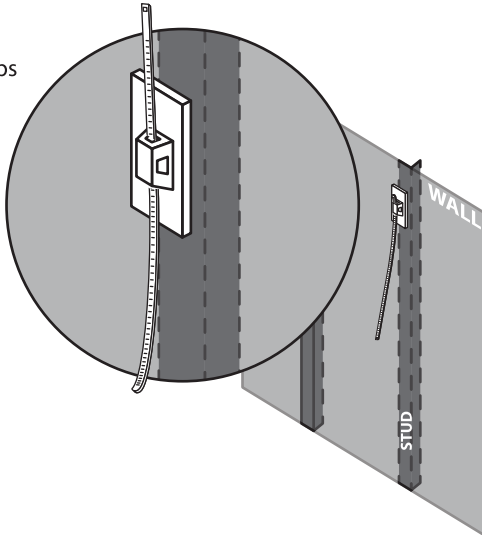

- 4) Move your bookcase near the wall brackets and slide the bottom of the straps in the wall brackets up through the brackets on the bookcase.

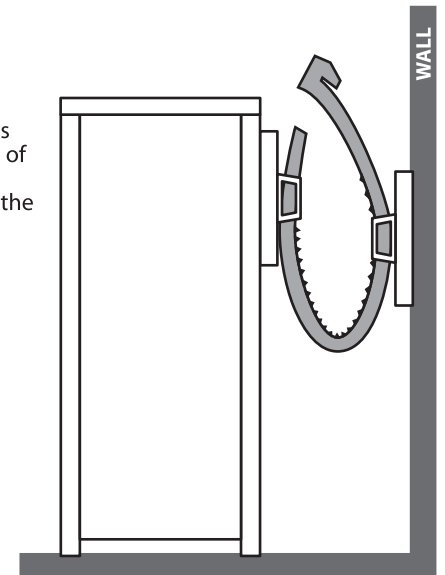

- 5) Secure the bookcase by pulling each strap back through itself into the head of the strap until the bumpy portion engages the head. Test the latching action of the strap by tugging on it to verify that it is "locked" in place. To release the strap, simply push on the lever and pull the strap off.

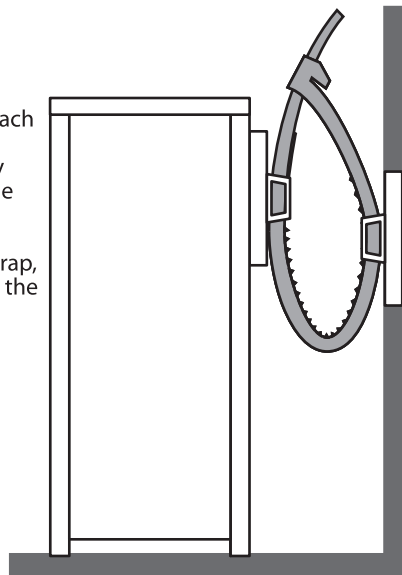

**Please note:**

These straps are provided as a courtesy; keep in mind that these straps will help reduce the risk of bookcase tip-over but will not eliminate that risk.

- 6) If you have purchased two or more 74" bookshelves, you can use Velcro on the side to hold them next to each other.

