

Brightify

User Manual



Content

Installation Dimension	02
Contents	03
Packing List	04
Installation Instruction	05
Precautions for Installation	05
Size Marks by the Template	06
Step 1: Drill Holes into the Door	07
Step 2: Adjust the Latch Length	08
Step 3: Install the Deadbolt Latch Set	09
Step 4: Install the Exterior Assembly	09
Step 5: Install the Mounting Plate	10
Step 6: Install the Interior Assembly	10
Install the Batteries	11
Step 7: Install the Deadbolt Lower Latch	12
Step 8: Install the Exterior Handle Mechanism	13
Step 9: Install the Interior Handle	14
Step 10: Install the Screw and Washer	14
Step 11: Install the Strikes	15
Programming and Operating Instructions	16
Operational Interface	17
Programming Tips	18
Left and Right Door Installation	19
Sound On and Off	20
Restore Factory Settings	21
Q&A	22
Installation Trouble Shooting	23

Please read this user manual before installing and using your keypad lock! Please let us know if you need helps.

Front Door Lock Set

Installation Dimension

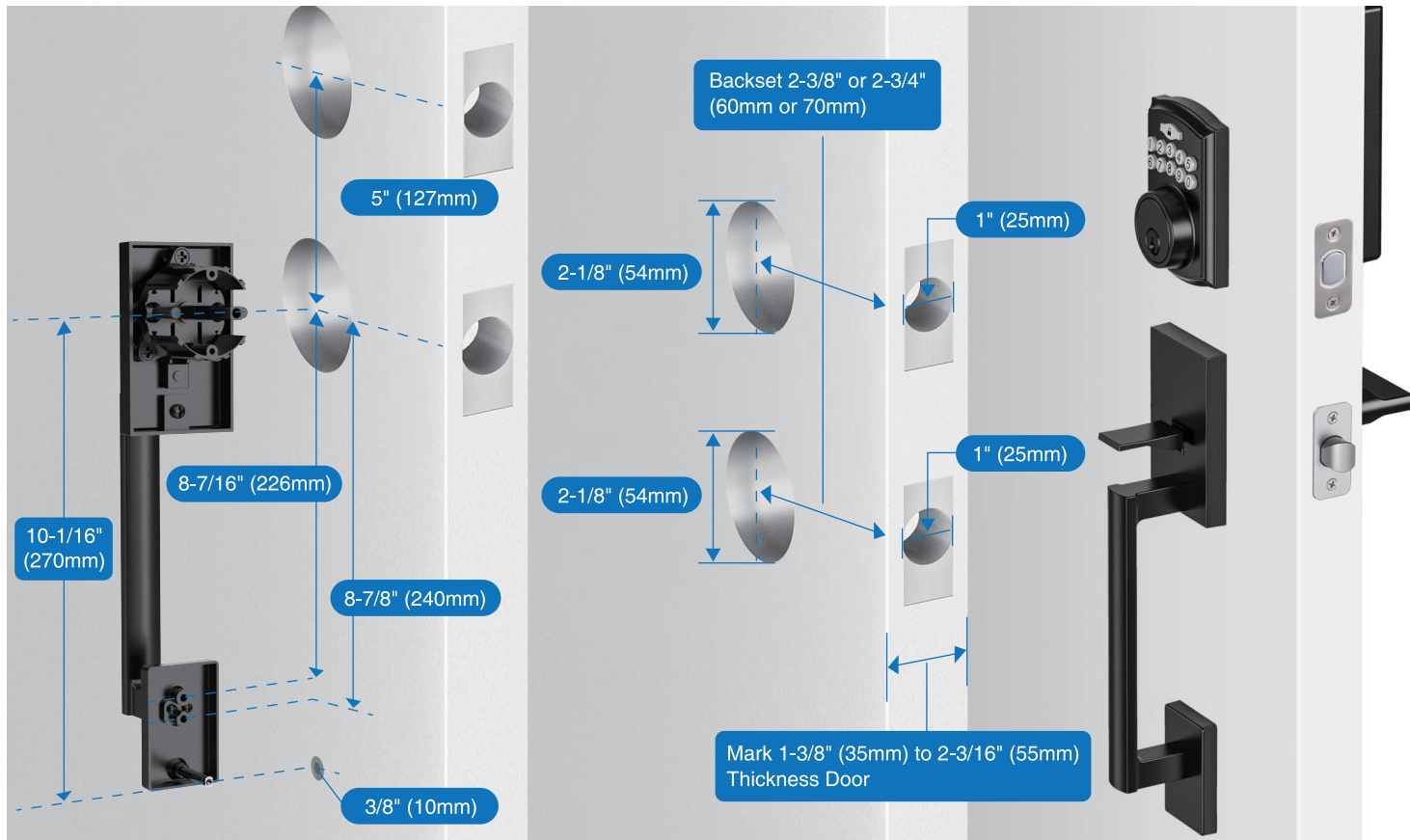

Contents

Please ensure the package contains the following parts before getting started.



Packing List



Touch Keypad Assembly



Interior Assembly



Interior Handle



Washer

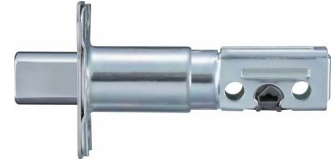

2 * Deadbolt Latch Set (Adjustable)

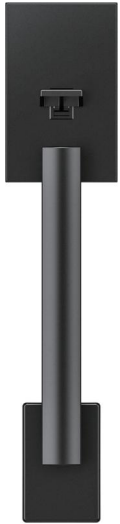

Exterior Handle

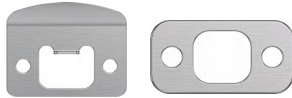

2 * Deadbolt Strike Plate



Manual



3/4" (4*20mm) Screw - 4 ea.



15/16" (4*25mm) Screw - 4 ea.



3/4" (4.2*20mm) Screw - 1 ea.



1-3/16" (M4*30mm) Screw - 2 ea.
(Use for the Keypad Lock of 35mm-45mm thickness door)



1-3/4" (M4*45mm) Screw - 2 ea.
(Use for the door handle of 45mm-55mm thickness door)



Entry Key (3 ea.)



Bottom Box



1-3/8" (M4*35mm) Screw - 5 ea.
(Use for the Keypad Lock of 45mm-55mm thickness door - 2 ea.;
Use for the door handle of 35mm-45mm thickness door - 2 ea.;
Use for the washer - 1 ea.)

Installation Instruction

Prepare the Tools



Drill



Phillips Head Screwdriver



Pencil



Hammer



1" (25mm) Drill Bit



1/16" (2mm) Drill Bit



2-1/8" (54mm) Drill Hole Saw



Chisel



Tape Measure

Precautions for Installation

- 1 Remove the packaging film on the product.
- 2 Please check and see if there is any damage on the product.
- 3 Please check and see if any installation component is missing.
- 4 Make sure the thickness of the door is between 1-3/8" and 2-3/16" (35mm-55mm).

Size Marks by the Template

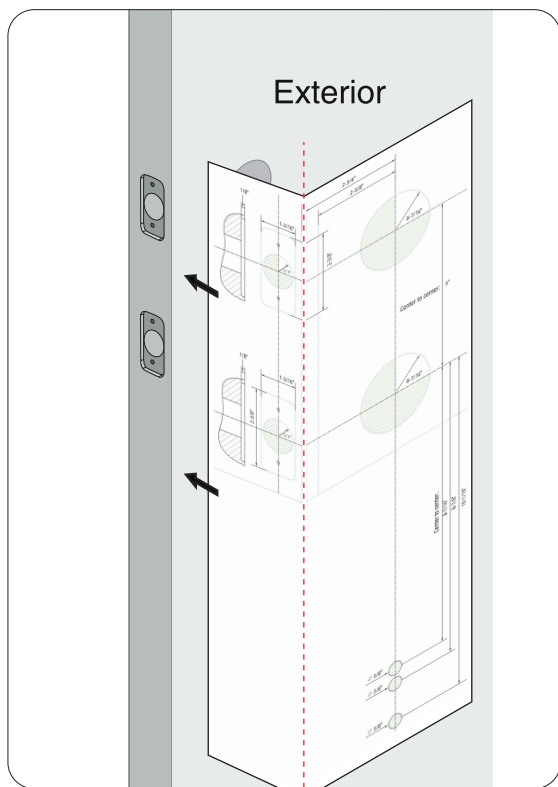

Fold the supplied template along the fold line and place it on the exterior side of your door.

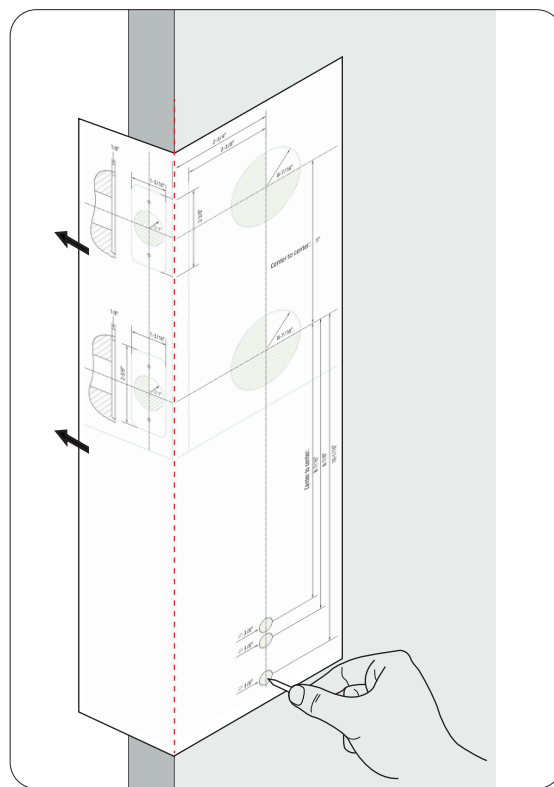

Mark the locations of the new holes on your door according to the template, and then drill the holes.

Step 1: Drill Holes into the Door

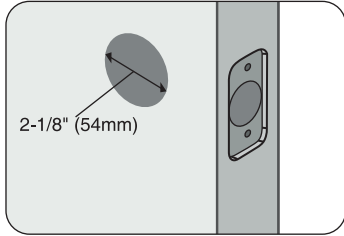

1. Measure and check that the diameter of the hole in the door is 2-1/8" (54mm).

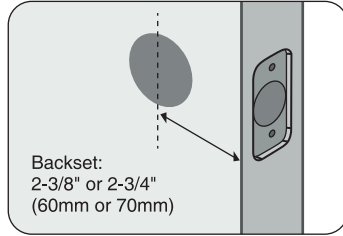

2. Measure and check that the backset if either 2-3/8" or 2-3/4" (60mm or 70mm).

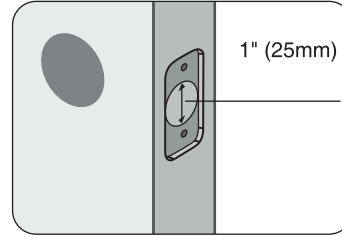

3. Measure and check that the diameter of the side hole in the door is 1" (25mm).

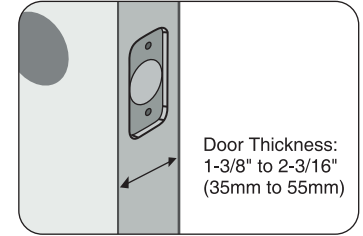

4. Mark for 1-3/8" (35mm) to 2-3/16" (55mm) thickness door.

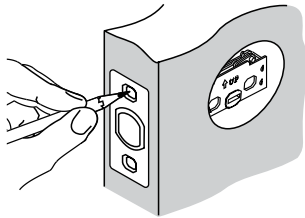

Insert the latch and ensure it is parallel to the face of the door. Mark the outline of the face plate, and then take out the latch.

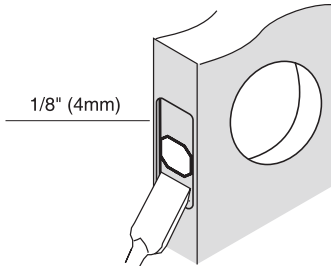

Chisel 1/8" (4mm) deep along the outline to allow the face plate to be aligned with the door edge.

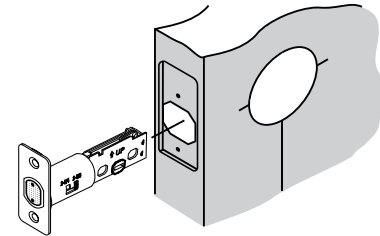

Insert the latch into the door.

Step 2: Adjust the Latch Length



Determine if the latch needs to be adjusted to the 2-3/4" (70mm) backset.

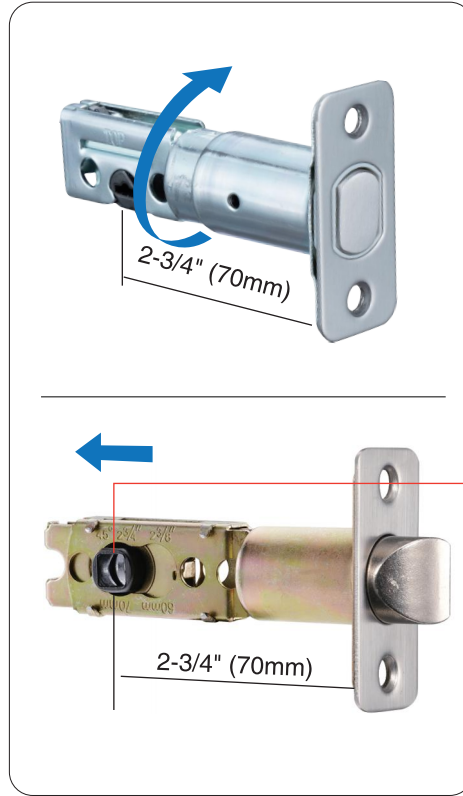

To adjust, rotate the latch until it stops. Reverse the direction to return to the 2-3/8" (60mm) backset.

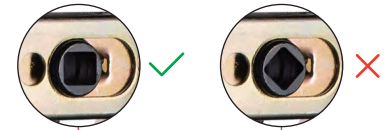

Note: Move the adjustable button horizontally to the location of 60mm or 70mm and make sure the button itself is not rotated at all. If the button suffers a 90 degree rotation, the exterior door handle will fail to work normally after the installation.

Step 3: Install Deadbolt Latch Set

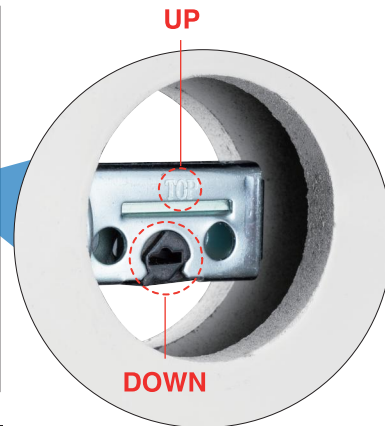
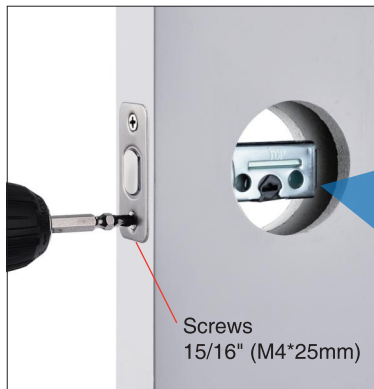

Use two 15/16" (M4*25mm) screws to tighten the latch into the door. **Do not over-tighten.**

Step 4: Install the Exterior Assembly



Step 5: Install the Mounting Plate

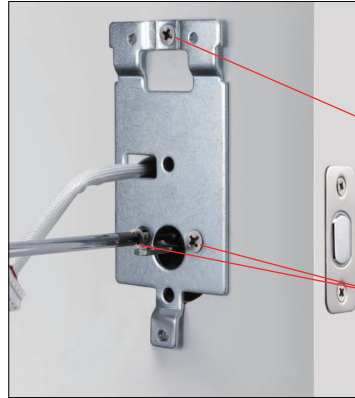

Right-Handed Door View

Screw 3/4" (4.2*20mm)

Screw 1-3/16" (M4*30mm)
(Mark for 35mm-45mm thickness door)

or

Screw 1-3/8" (M4*35mm)
(Mark for 45mm-55mm thickness door)

 **NOTE:** Lock and unlock with the key to see if the deadbolt latch is easy to open and close.

Step 6: Install the Interior Assembly

 **NOTE:** Deadbolt latch must be retracted during the process of installation.

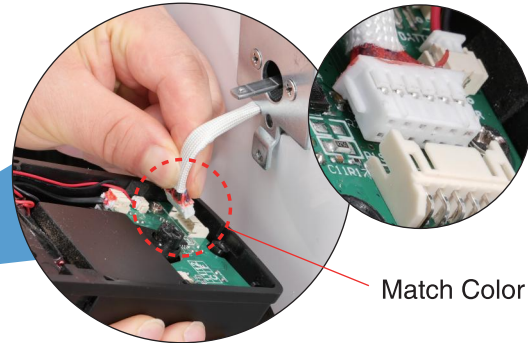

Match Color

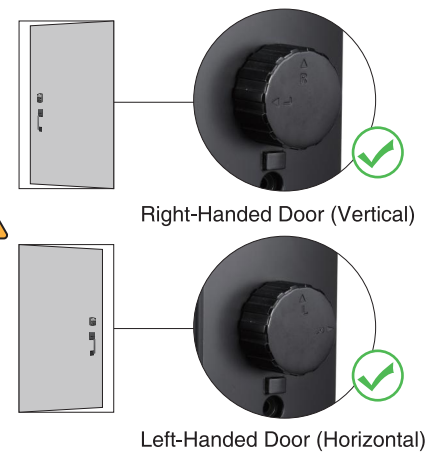
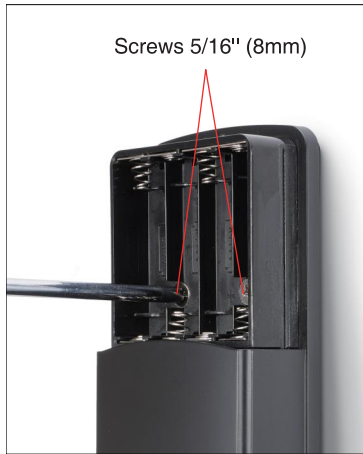

! **NOTE:** Lock and unlock with the interior knob to see if the deadbolt latch is easy to open and close.

Install the Batteries (AA Alkaline Batteries Are not Included)







! **NOTE:** Do not touch the keypad until the blue light turns off. Do not use rechargeable batteries or non-alkaline batteries.

Testing Lock



Note: Please Ensure that the Deadbolt Latch is Extended Before Setting.

Step 1: (Press) → 1 → 2 → 3 → 4 → 5 → 6 → 7 → 8 → 9 → 0 → 

Step 2:  (Hear 2 Beeps) → 9 →  → 123456 →  (Hear 1 long beep)
(Press for 3s)

- 1) If the keypad normal working, installation completed successfully.
- 2) If the keypad report an error, please reinstall and check the installation procedure.

Step 7: Install the Deadbolt Lower Latch

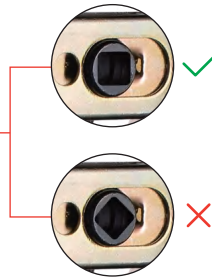
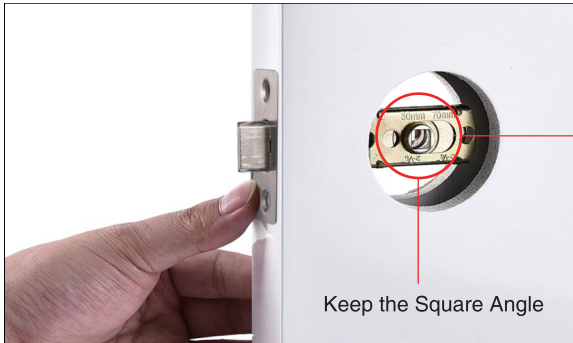

Use two 3/4" (4*20mm) screws to tighten the latch into the door. **Do not over-tighten.**

Step 8: Install the Exterior Handle Mechanism

The Middle of Latch

Please insert the steel bar of the handle into the middle of latch and make sure the midline has been covered.

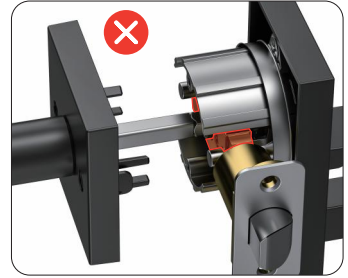
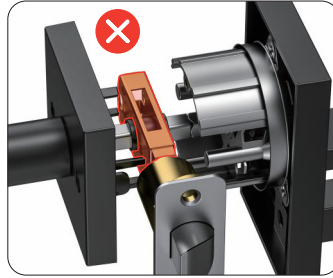
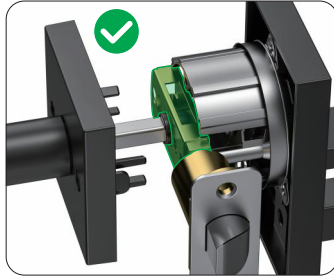
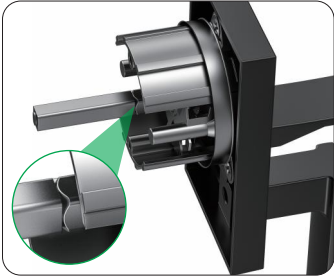

Do not tighten the screws until you have tested the functionality of the finger button and back handle to ensure they are working properly.

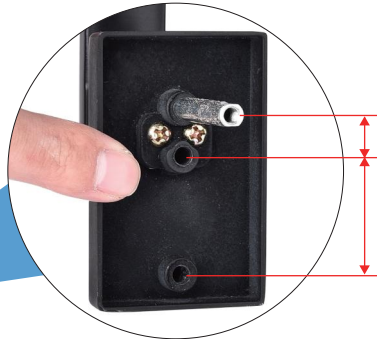

0.57" (14mm)

1.2" (30mm)

3 Standard Sizes for Adjustment



Note: During the installation, remember not to press the button; otherwise, the lock will get stuck.

Step 9: Install the Interior Handle



Step 10: Install the Screw and Washer

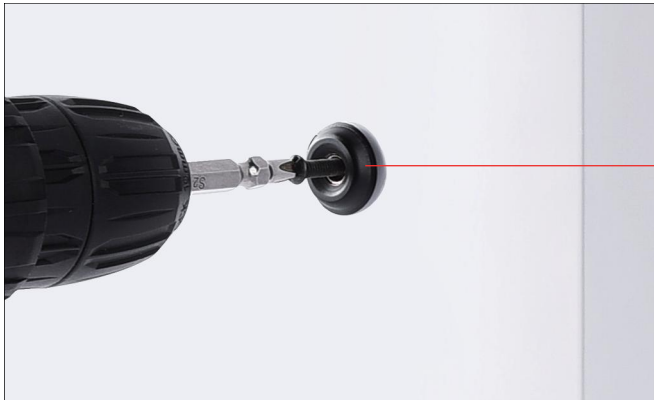

Screw 3/4" (M4*35mm)

Step 11: Install the Strikes

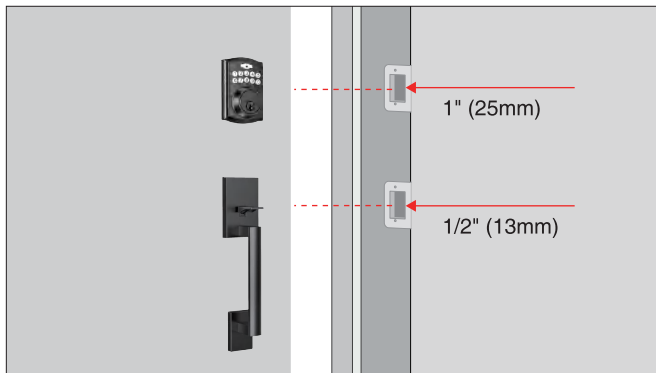

Make sure the holes for the strike are drilled at a minimum of 1" (above) and 1/2" (below) deeps.

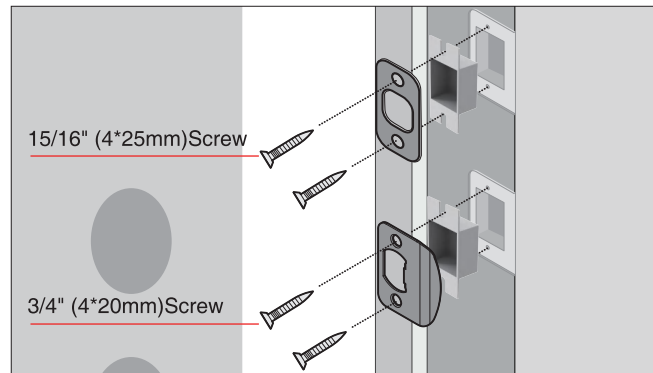

Programming and Operating Instructions

Tips: Please change the Administrator Code in the first time before operation.



When you are setting the Keypad, it's kindly suggested to record every password created.

Operational Interface

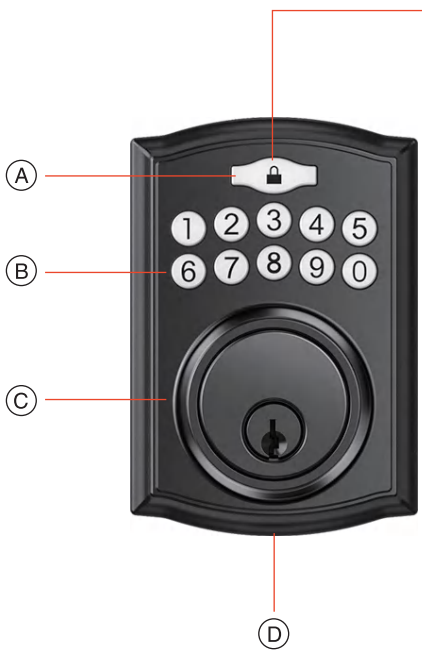





Lock and Confirm Button

Lock - For locking the door
 Clear - For clearing wrong keypad entries
 Programming - For programming steps

Back Locking / Emergency Emptying

Back Locking
 Set: Long Press , Hear 1 Beep
 AC Code+  / Inside Unlock



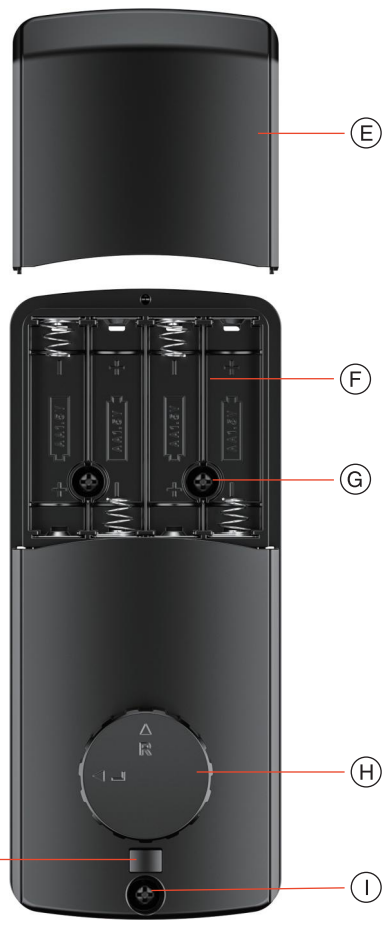

- Ⓐ Programming Button
- Ⓑ Number Buttons
- Ⓒ Cylinder
- Ⓓ Washer
- Ⓔ Battery Lid
- Ⓕ Battery Holder
- Ⓖ 5/16" (8mm) Screws
- Ⓗ Turn Piece
- Ⓘ 1" (25mm) Screw
- Ⓙ Emergency Emptying Button

Red

- Indicates failed programming step
- Indicates successful locking

Green

- Indicates successful programming step
- Indicates successful unlocking

Batteries (Not Included)



- Electronic lock requires 4 high quality AA alkaline batteries. When all 4 batteries are put in the right direction, you will hear 2 beeps and notice the keypad glows blue. **DO NOT TOUCH** the keypad until it stops glowing.

Factory Settings (New)

- The lock comes with factory presets
 - AC Administrator Code - 123456
 - UC User Code - 123456

Programming References

-  Lock/Confirm
- AC AC - Administrator Code (6 Digits, 10 groups)
- UC UC - User Code (6 Digits, 80 groups)

 **To ensure security, please change the Administrator Code (AC)  and the User Code (UC)  as soon as possible after installation.**

SET OK = Hear 1 Beep and light turns green.

The Administrator Code (AC)  and the User Code (UC)  must have 6 digits.

Programming Tips

 Before installation, please ensure to test the automatic recognition of the left and right doors.

5 Seconds Rule: Finish all the programming steps in the programming mode within 5 seconds.

Clear: Use the key to clear entries in case that a wrong button is pushed.

Locking and Unlocking

To unlock the lock

Use the keypad: Enter a valid user code (default code is 123456)+ , then bolt retracts, keypad beeps once and lights green.

To lock the lock

Use the keypad: Press  and then hear 1 beep.

Left and Right Door Installation (Automatic Recognition)

 **Note: Please Ensure that the Deadbolt Latch is Extended Before Setting.**

Use the keypad: Press  and then hear 1 beep.

 (Hear 2 beeps) → 9 →  → AC →  (Hear 1 long beep)
(Press for 3s)

Changing Administrator Code

 **Administrator Code of Factory Settings is 123456, and Administrator Code can be used to unlock. You must change the Administrator Code before you want to change the User Code.**

 (Hear 2 beeps) → 1 →  → AC →  (123456) → New AC →  (789456) → Re-enter AC →  (Hear 1 long beep)
(Press for 3s)

Adding User Codes

Please use the **New AC** to set up. The User Codes must be 6 digits.

 (Hear 2 beeps) → 2 →  → New AC →  (789456) → New UC →  → UC →  (Hear 1 long beep)
(Press for 3s)

Deleting User Codes

 (Hear 2 beeps) → 3 →  → New AC →  (789456) → UC →  (Hear 1 long beep)
(Press for 3s)

Automatic Lock Function

You can set the auto-lock function so the latch will pop out and locks automatically every time you unlock the lock. Time value range = 5-30 seconds

Set Auto Lock After setting, it can be activated only after manually locking or unlocking the lock.

 (Hear 2 beeps) → 4 →  → New AC →  → Time Value →  (Hear 1 long beep) →  (Locked)
(Press for 3s)

Cancel Auto Lock

 (Hear 2 beeps) → 4 →  → New AC →  → 00 →  (Hear 1 long beep) →  (Locked)
(Press for 3s)

Sound On and Off

Even when in "Sound Off" mode, the keypad still produces sounds during setup.



Dual Verification Mode

 Tips: When dual verification mode is enabled or disabled, the door lock can only be unlocked using Administrator codes or two User Codes.



One-Time User Code

Groups value : 10 groups.



Vacation Mode

 Tips: When vacation mode is enabled or disabled, the door lock can only be unlocked using Administrator codes. User codes will not unlock the lock.

Set Vacation Mode



Cancel Vacation Mode



Restore Factory Settings

 **Note: The Administrator Code (AC)  and all User Codes (UC)  will be removed after restoring factory settings.**

 (Hear 2 beeps) → 0 →  → →  → →  (Hear 1 long beep)
(Press for 3s)

Emergency Emptying

To install the batteries, perform a long press on this button  simultaneously.
You will hear 6 short beeps, followed by 1 long beep. The light indicator will then illuminate green.

Anti-peeping User Code

You can enter random numbers before and after the correct password to confuse the judgment. Number value: 20 digits.

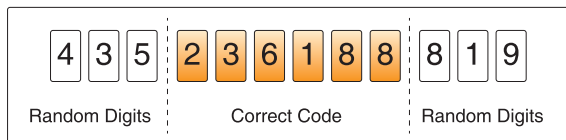

Secure Lock - Out Period

 After **5 incorrect code** attempts, the keypad will shut down for **60 seconds**.

Low Battery Warning

The keypad will beep and the light will flash red 7 times. Replace with high-quality alkaline batteries.

 **NOTE : Removing batteries does not erase active Programming or User Codes.**



Attention:

When batteries are under low voltage, the lock will give the low battery warning (Beeps and LED flashes red for 7 times). During this time your lock can still work. However, once the voltage is lower than 4.3V (called Super - Low Voltage), the operation of the locking and unlocking will not work and the batteries must be replaced immediately.

Q&A

① 1. When setting my password, how long should I stay no- inputting to cancel the setting?

☰ Setting will be cancelled after 5 seconds of no operating.

① 2. Can the Administrator Code can be used to unlock?

☰ Yes, the Administrator Code and the User Code of Factory Settings are both 123456, and the Administrator Code can be used to unlock.

① 3. Why does the deadbolt latch pop out partially but not completely?

☰ The deadbolt latch doesn't line up with the strike plate. Or the deadbolt latch is stuck inside due to product defect.

① 4. Can I still unlock the door with my User Code when I am warned of low voltage? Or is the key the only way to unlock?

☰ You can still enter your house with your User Code after the beep. But you need to replace the batteries as soon as possible.

① 5. If a new Administrator Code is set, will the factory default one (123456) be covered automatically? Do I need to delete it myself?

☰ Yes, the Administrator Code will be removed after setting.

Installation Trouble Shooting

Issue:

There is no electronic response of the lock after installation.

Solution:

- Make sure that all batteries are fresh and high-quality Alkaline Batteries.
 - Make sure that all batteries are placed in proper polarity (+ -).
 - Make sure that the control wire is attached to the interior assembly tightly.
-

Issue:

The deadbolt latch won't pop out when the door is locked or won't retract completely when the door is unlocked.

Solution:

Open the door and check if the deadbolt latch lines up with the strike plate.

- If not, adjust the strike plate position for proper alignment.
 - If so, rotate the interior door knob to see if the deadbolt latch is stuck inside, which might be caused by some product defects. Then, please contact (Brightify) Customer Service Team.
-

Deadbolt latch is stuck inside and won't pop out.

Issue:

The assembly parts are screwed too tight and have to be loosened a little bit.

Solution:

Installation screws of the lock may be too tight and have to be loosened.

- Remove the interior assembly.
- Slightly loosen the mounting plate screws.
- Lock and unlock the door with the key.
- Re-attach the control wire and the interior assembly.

Quick set up



The default programming code is 123456. It's required to change it to a code of your own before programming.



The Administrator Codes and User Code must be 6 digits combination.

Left and Right Door Installation



Changing Administrator Code



Adding User Codes



Deleting User Codes



Set Auto Lock



Cancel Auto Lock



Sound On and Off



Dual Verification Mode



One-Time User Code



Set Vacation Mode



Cancel Vacation Mode



Restore Factory Settings



