

Installation Notes

Match the number of parts

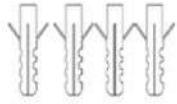

Installation Notes

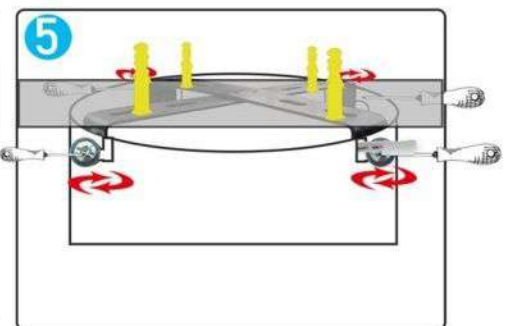
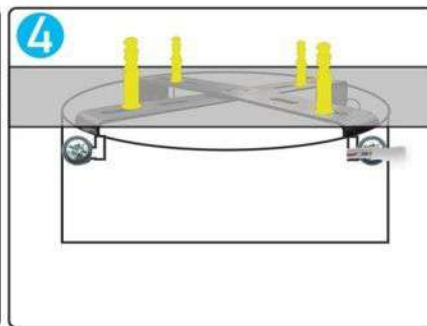
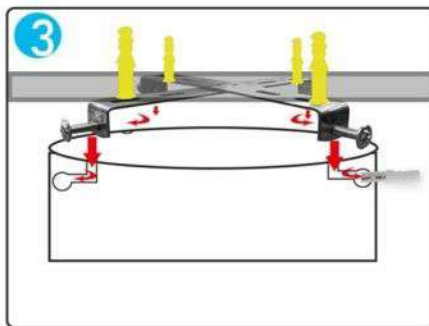
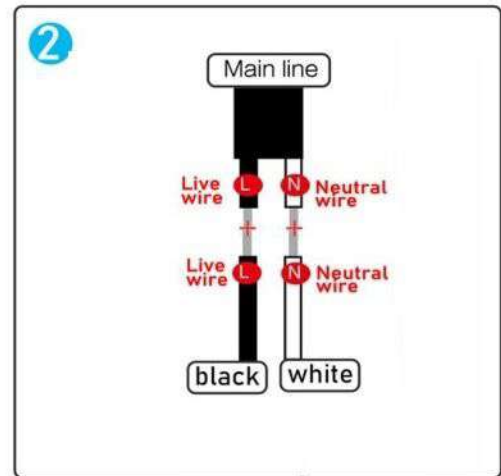
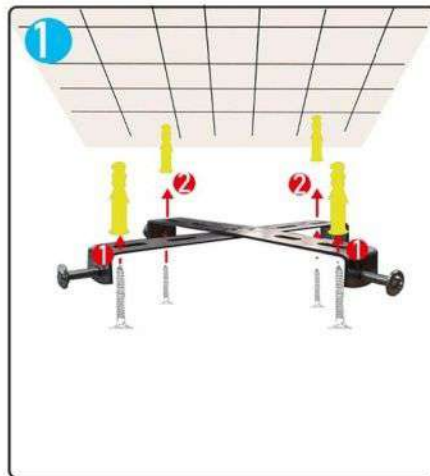

Precautions:

1

Main motor high voltage, non-professional
Please do not disassemble it.

3

If the remote control does not work, please check
Is the battery connected correctly, or
Insufficient power supply, disconnect between checks
Controller and fan lights.

2

When equipped with a pull switch as a wall switch,
It must be turned on before this control can work.

4

If not using for a long time, please turn off the power
Turn on the power and remove the control battery.

Installation Notes

Steps for Pairing Remote Control

After receiving the remote control, you must pair it with the light to adjust the light color.

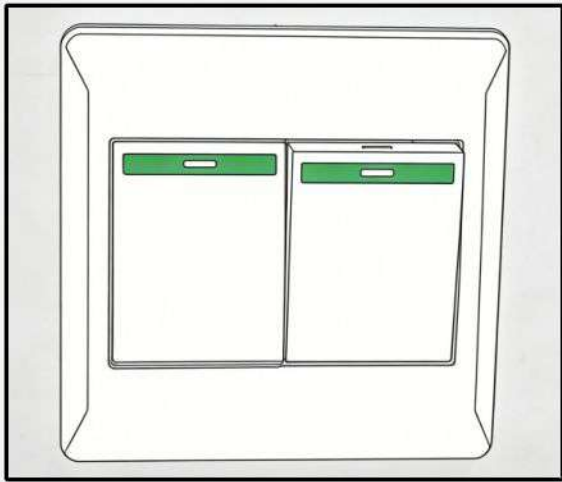

Step 1

- Turn on the wall switch.

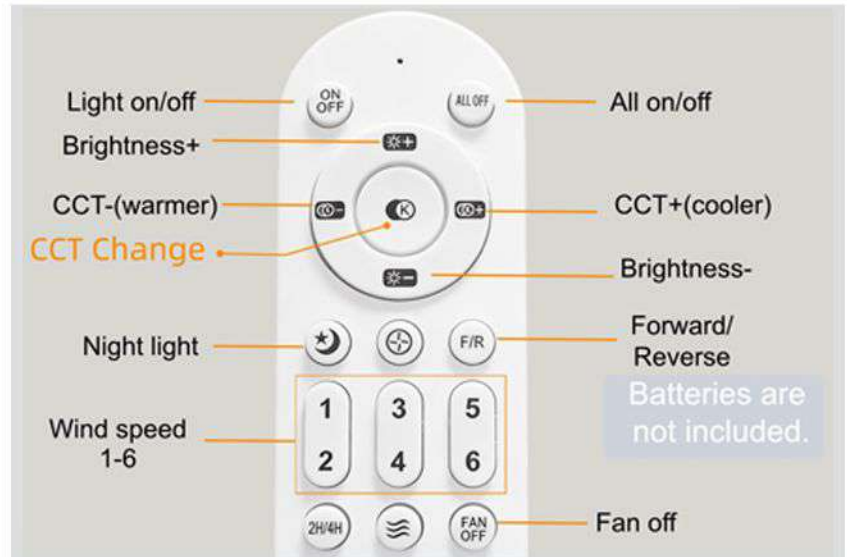

Step 2

- Press and hold the "CCT Change" button (Keep pressing for 5 seconds).



Step 3

- The light flashes and a beep is heard, indicating that the pairing was successful.