

INSTALLATION INSTRUCTIONS

WALL SCONCE

120V/60Hz

READ AND FOLLOW SAFETY INFORMATION

Turn off the main power at the circuit breaker before installing and servicing the fixture to prevent possible injury from electric shock.

All electrical connections must be in accordance with local and National Electrical Code (N.E.C.) standards. If you are unfamiliar with proper electrical wiring connections, obtain the services of a qualified electrician.

INSTALLATION & ASSEMBLY

Remove the fixture and the mounting package from the box and make sure that no parts are missing by referencing the illustrations on the installation instructions.

1. Place the mounting wall plate(3) over the outlet box(1), align the mounting slots of the wall plate with holes of the outlet box as shown. Use a level to ensure the wall plate(3) is straight.Lock the mounting wall plate (3) to the outlet box (1) with the outlet box screw(2).
3. Pull the supply wires (4 &5) and house ground wire (6) out from the outlet box (1) before attaching wall plate to outlet box.Make electrica connections, connect the black fixture black wire (10) to the black supply wire (5) and the white fixture wire (9) to the white supply wire (4) using wire nut (7). Connect the fixture ground wire (11) to the supply ground wire (6) together using wire nut (7). Wrap all wire connections with electrical tape to ensure secure connection.
4. Place the fixture body (12) over the mounting wall plate (3) and secure it to the wall plate by using fixture screws (8).
5. Place the shade(13), lamp cup (14), and lamp ring (15) in the lamp holder in order, then use tool (16) to secure the lamp ring (15).
6. Finally, attach the bulb to the fixture body (12).

Care Instructions:

WARNING: Always be certain that electric current is turned off before cleaning.Only a soft damp cloth should be used. Harsh cleaning products may damage the finish.

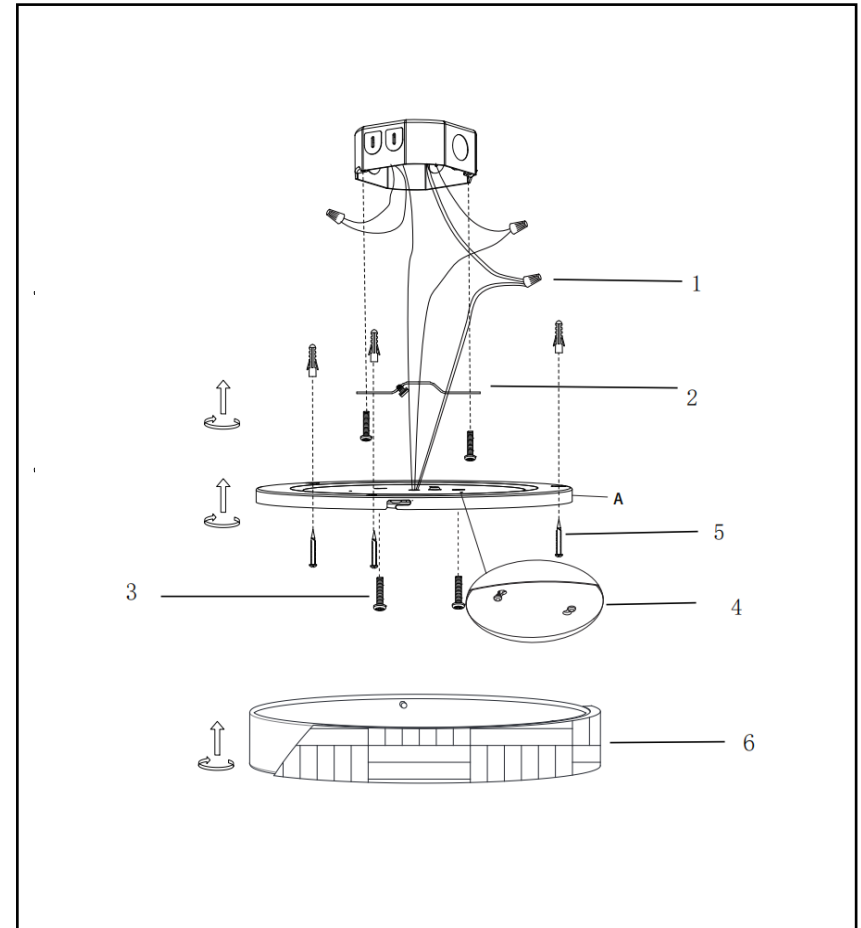

1.WIRE NUTS

2.MOUNTING BRACKET

3.FIXTURE SCREWS4 .

4.ROTARY PC COVER

5,MOUNTING SCREW

6.FIXTURE BODY