

# INSTRUCTION MANUAL

Thank you for your purchase, Please consult the installation instructions.

## PARTS LIST

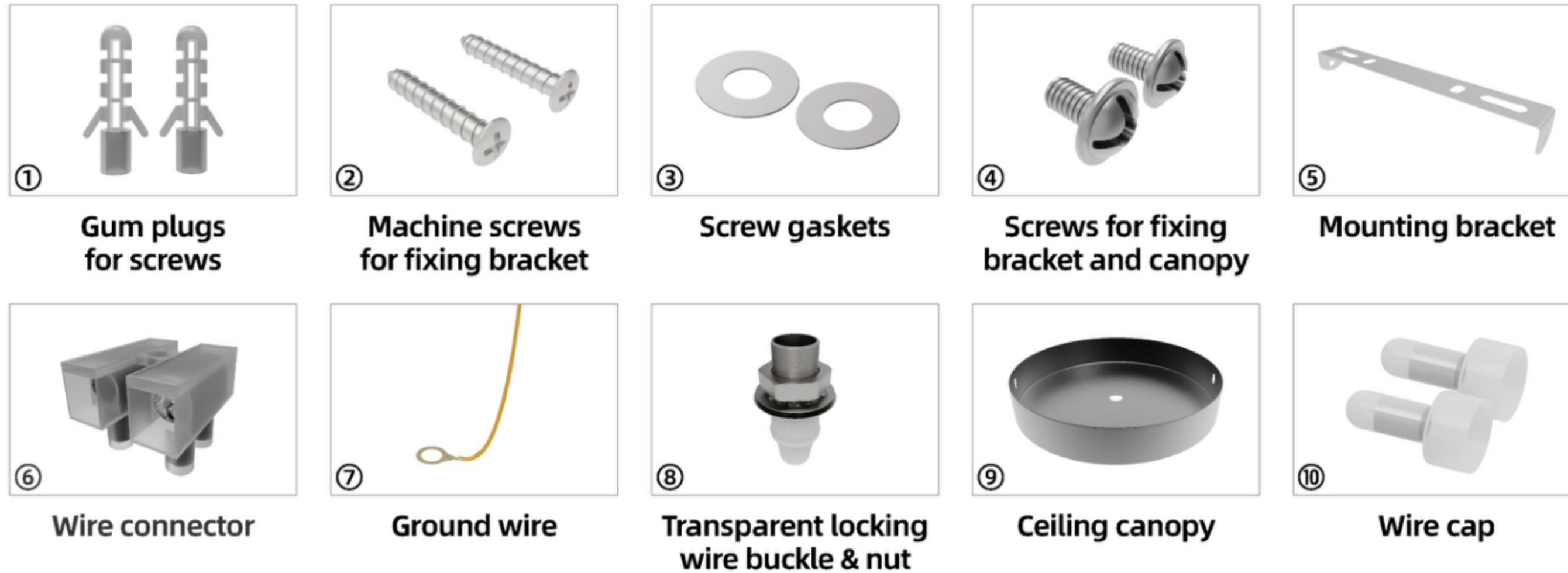

## INSTALLATION DIAGRAM

### ⚠ Note:

- Please make sure that you have all parts indicated before you begin assembly of this item.
- Please check the strength of the ceiling before installation and install it in a place where it can bear the weight.  
( if the strength is insufficient, please make sure to reinforce it before installation. )
- Do not install in a dangerous and unstable place.

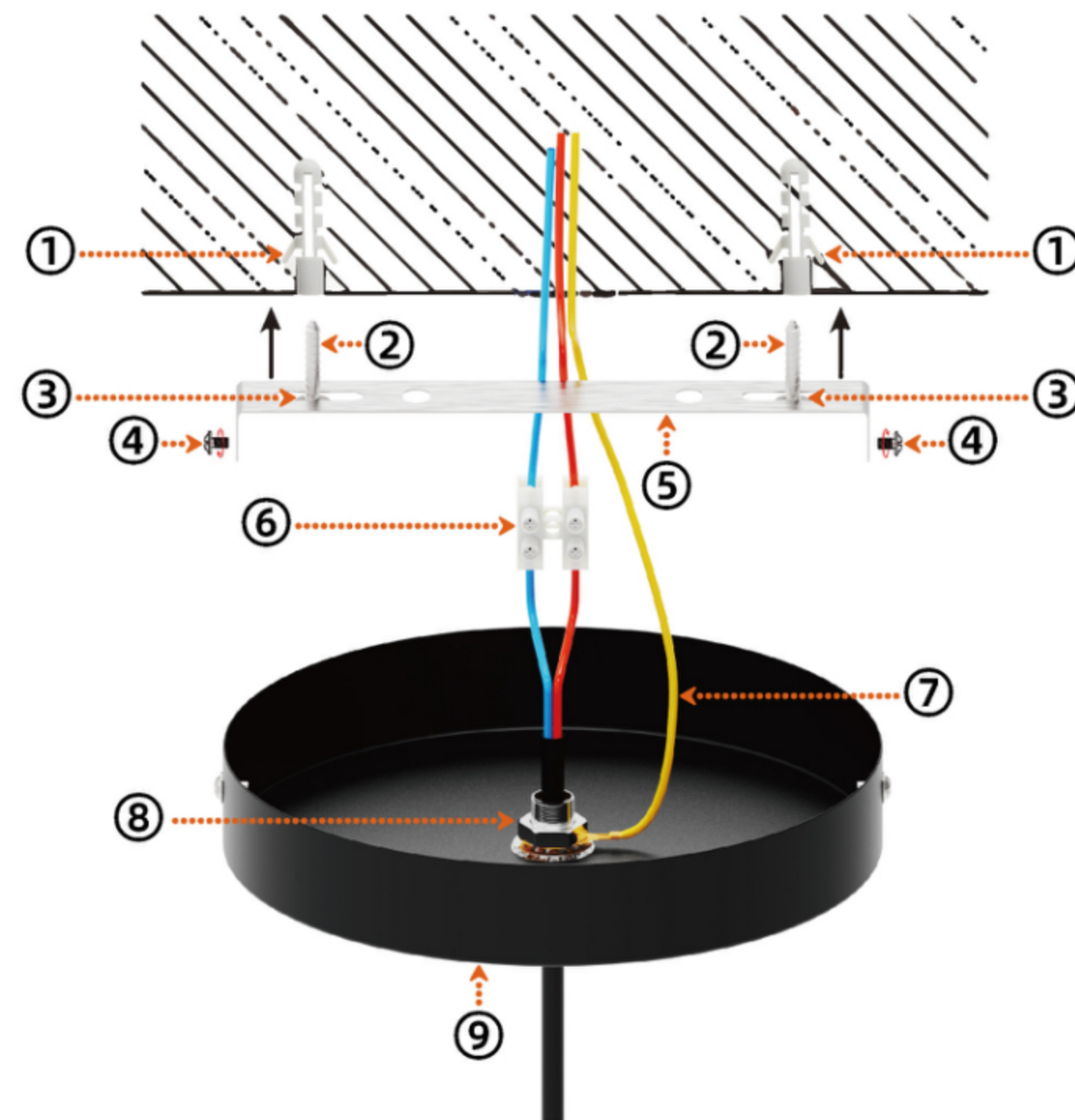

## THE INSTALLATION STEPS

### 01 Mounting the bracket to the ceiling

Punch holes in the ceiling according to the holes of ⑤ the bracket and then put ① gum plugs into the holes.

Put ③ screw gasket into ② machine screw and then fix ⑤ the bracket to the ceiling.

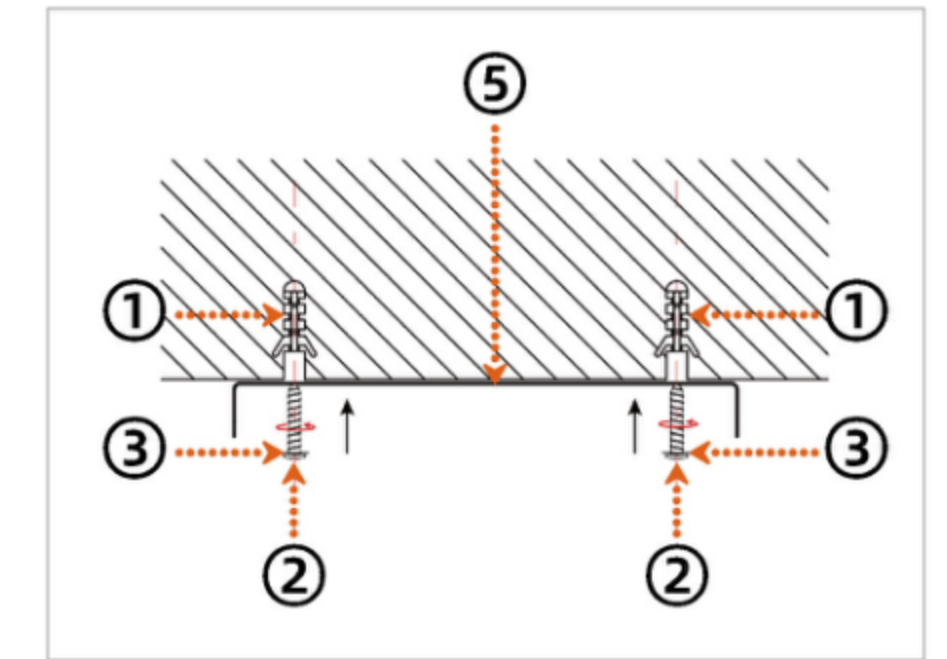

### 02 Secure the cord

Unscrew ⑧ transparent wire buckle, pass and pull the cord through the canopy to adjust the length of the cord, and then tighten transparent wire buckle.

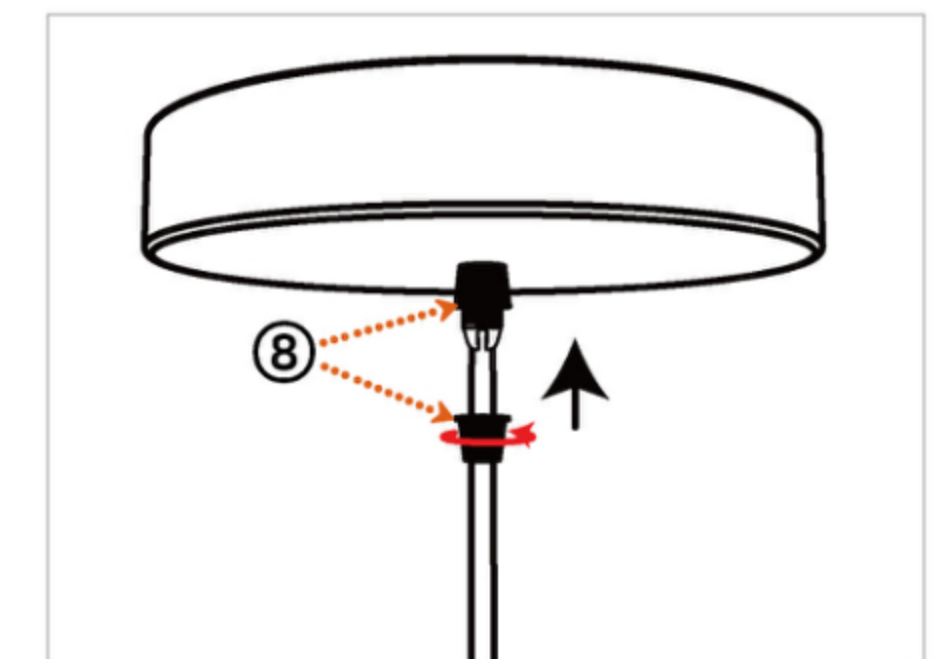

### 03 Connect the power cord

Positive and negative of your home connect the cord through ⑥ wire connector in order.  
(If you need to connect a ground wire, please use ⑦ ground wire to connect the ground wire reserved in your home with ⑧ transparent locking wire buckle.)

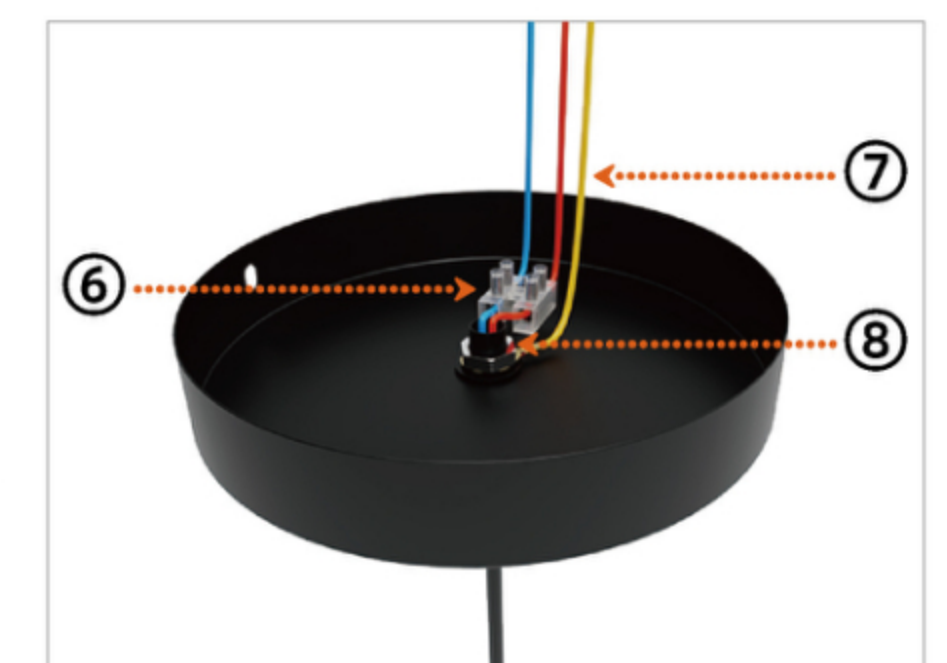

### 04 Fix the ceiling canopy

Cover ⑨ ceiling canopy in the fixed bracket, which holes match the two holes on the side of the fixed bracket, and then tighten ④ the screws to fix the bracket and ceiling canopy.

