

Ax1

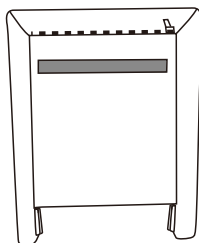

Bx1

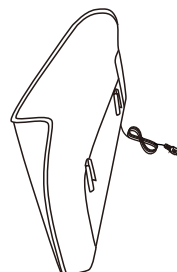

C-Lx1



C-Rx1

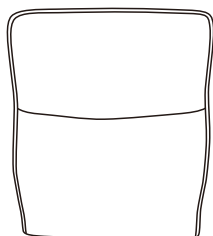

Dx1

It is under the seat cushion, please follow step 5 to take it out.

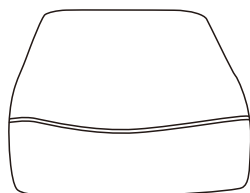

Ex1



Fx1



Gx1

STEP 1

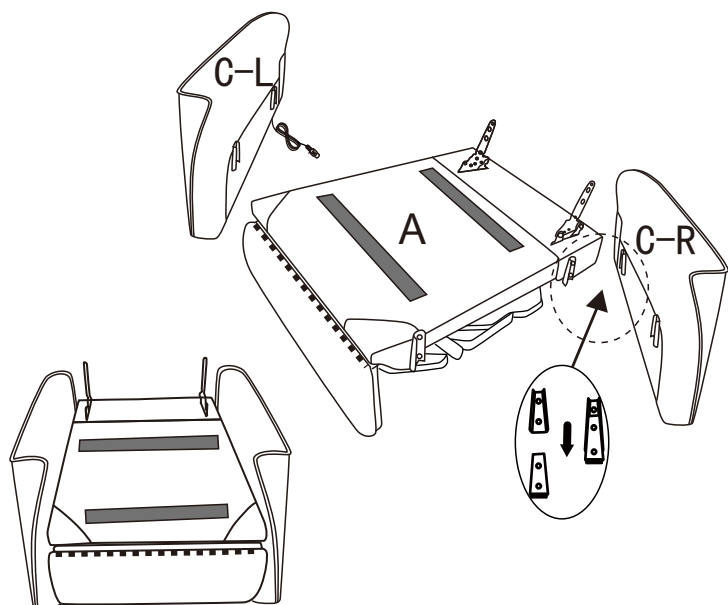

STEP 2

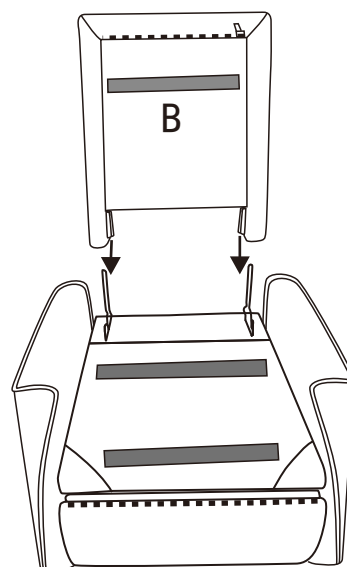

STEP 3

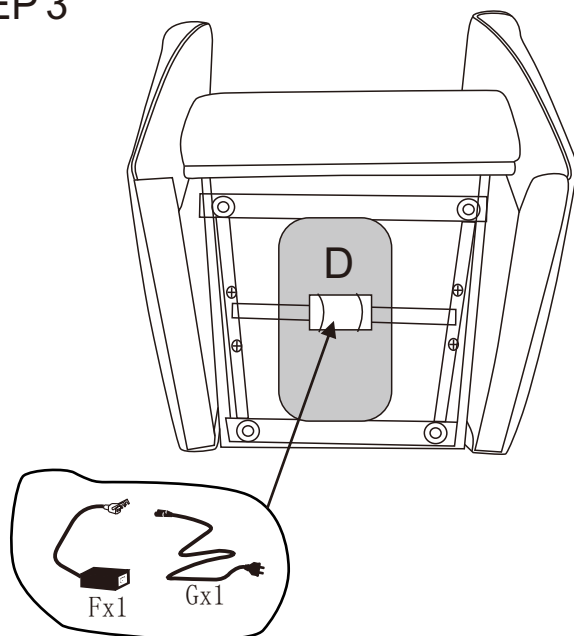

STEP 4

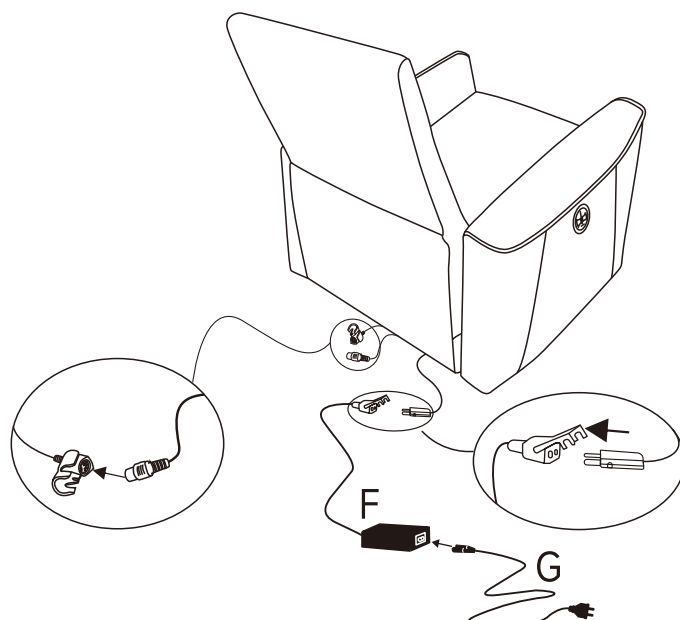

STEP 5

It is under the seat cushion, please follow step 5 to take it out.

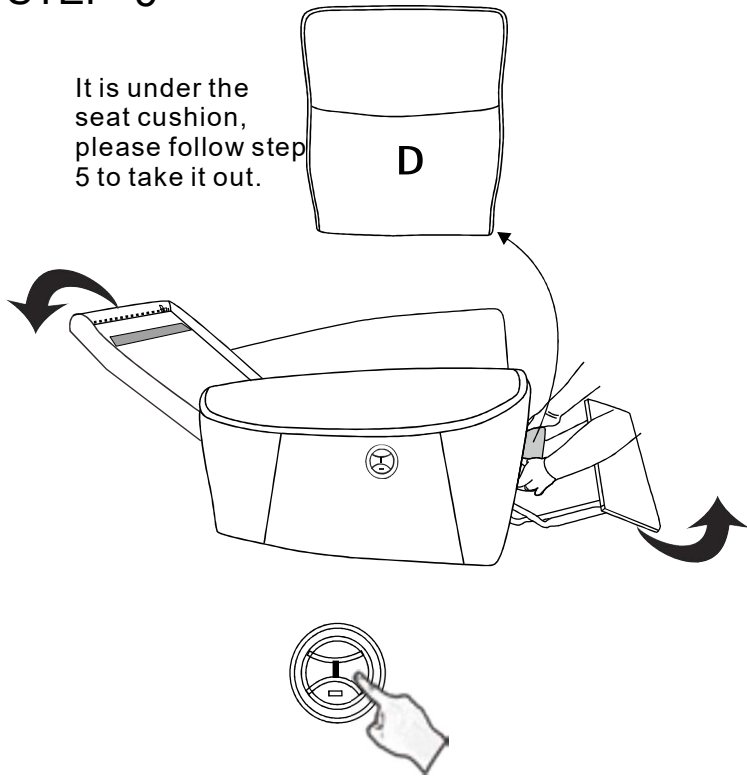

STEP 6

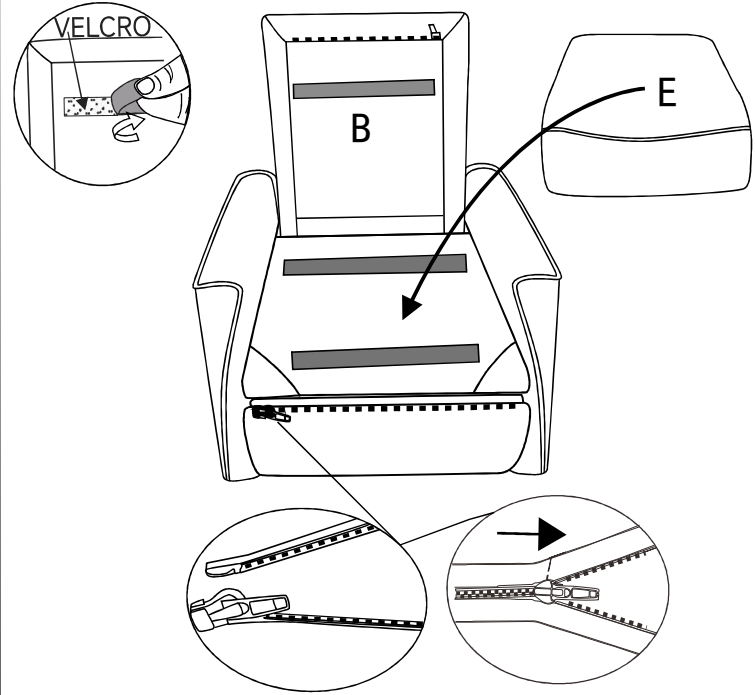

STEP 7

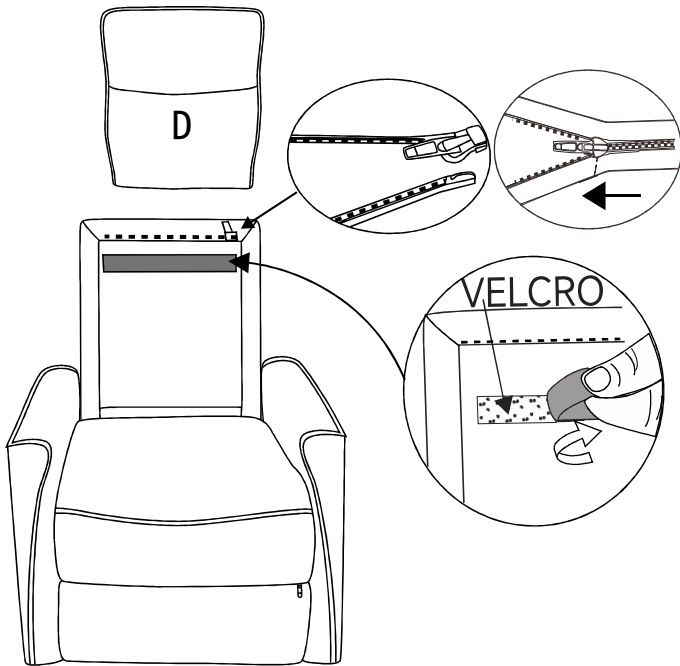

STEP 8

