

**Please un-zip the
headboard back to
find all of the parts
to assemble**

Assembly Instruction

(BOX 1) HEADBOARD, FOOTBOARD, SIDE RAIL			(BOX 1) HARDWARE LIST		
NO	ITEM	QTY	NO	ITEM	QTY
A	HEADBOARD	1 PC	1	JCBC NO HEAD	4 PCS
B	FOOTBOARD	1 PC	2	JCBB M8 x 30MM	8 PCS
C	SIDE RAIL	4 PCS	3	JCBC M6 x 30MM	8 PCS
D	SLAT 997mm	2 PCS	4	M4 x 65MM	1 PC
E	LEG Wooden Leg R/W 40 x 70 x 197-(510)	4 PCS	5	M5 x 70MM	1 PC
F	SIDE RAIL LEG 24 x 80 x 290	2 PCS	6	FLAT HEAD CHIPBOARD SCREW M4 x 32MM	24 PCS

Step 1 : Unzip the black non-woven fabric on the back of headboard and take out all the parts out.

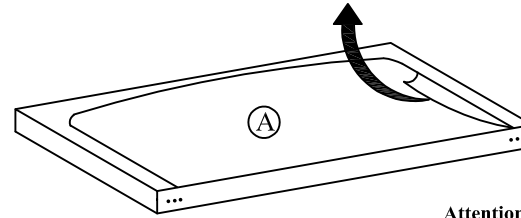

Attention: Zip the black non-woven fabric after take out the parts !!

BACK VIEW

Step 2 : Tighten the legs (E) to the headboard (A) and footboard (B) as shown.

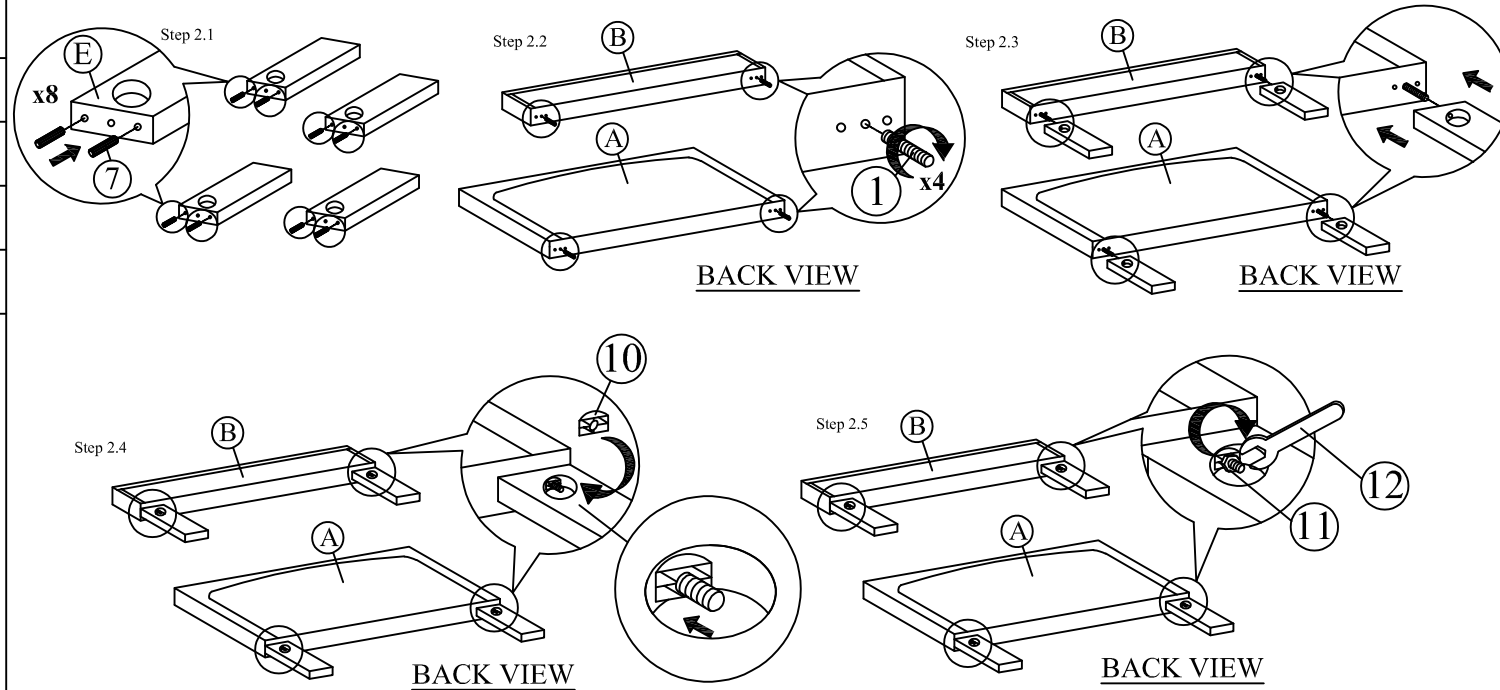

Step 3 : Attach the side rail leg (F) to the side rail (C) .

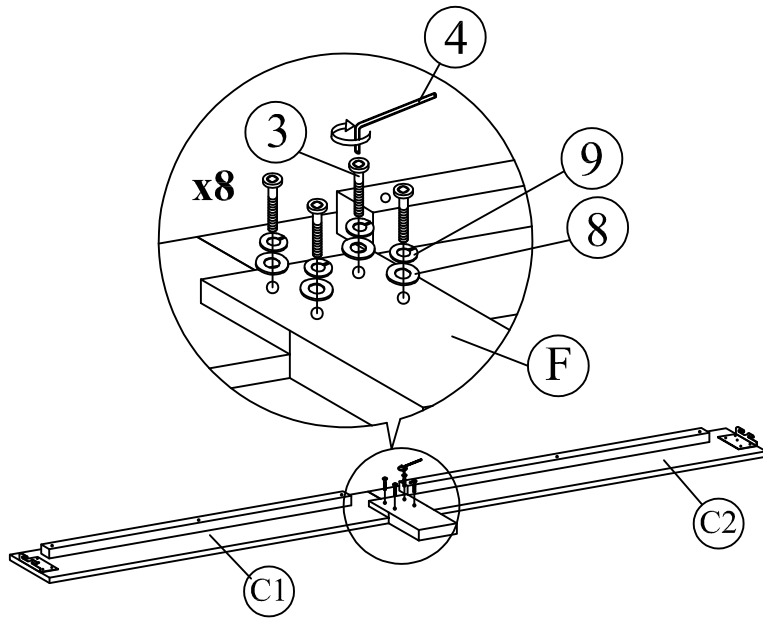

Step 4 : Attach side rail (C) to headboard (A) and footboard (B) by pushing the bracket down to fit it.

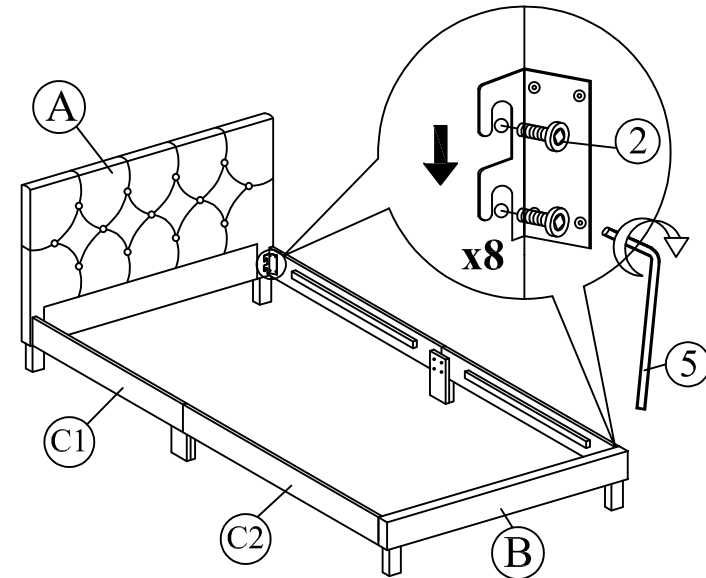

Step 5 : Tighten the 4 Corner with Allen Key (5). Install the bed slats to side rail. Tighten the slats with CSK screw. The distance of the slats should be sufficient to obtain desirable bed stability.

