

5x5x4 Dog Kennel

Assembly Instructions

5ft.(L) x 5ft.(W) x 4ft.(H)

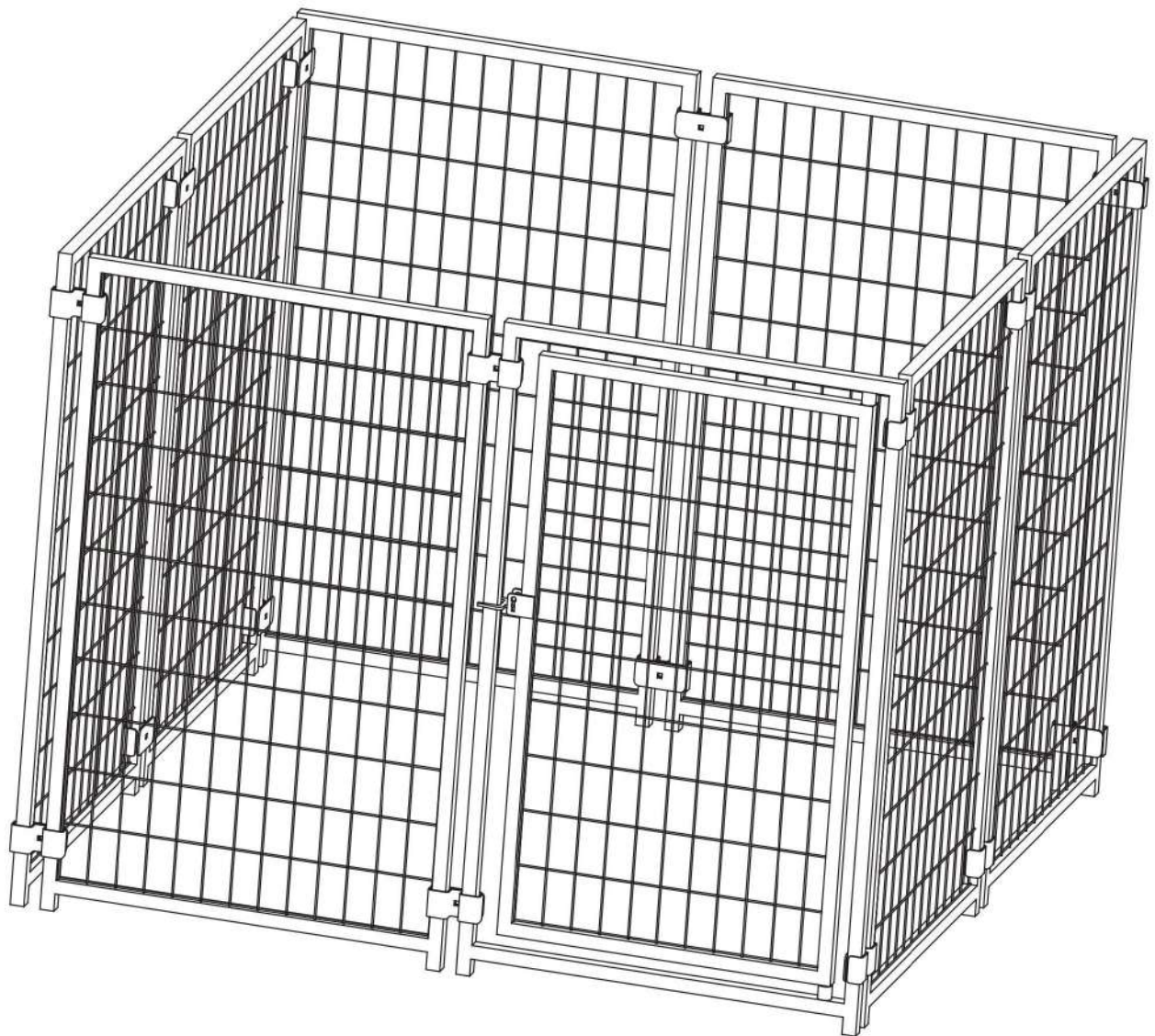

Components

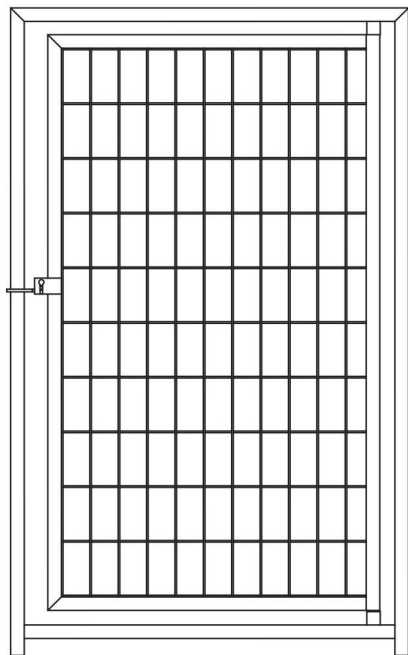

Gate Panel

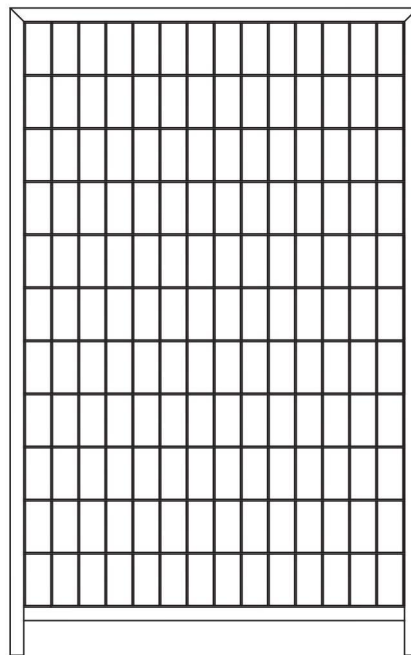

Plain Panels 7 pcs.

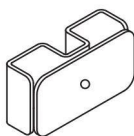

Clamps 16 pcs.



Assembly Instructions

Tools Needed

- 1/2 inch wrench
- Wire cutters

Kennel assembles easily in less than one hour.

Step 1 Determine Position of Gate Panel

1

Gate panel can be positioned on right or left side of kennel. For ease of use, it is recommended that the gate panel be positioned on the right side (1A).

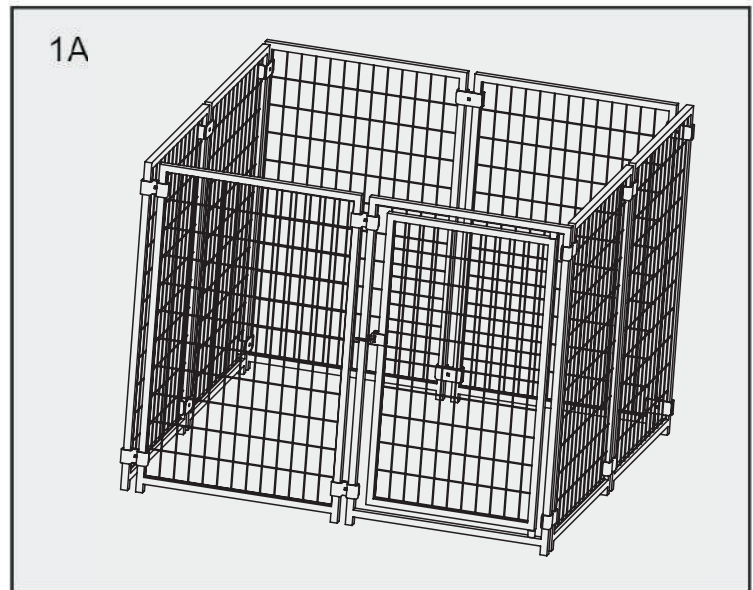

Step 2 Assemble Kennel

2

Important: Please assemble the panels as noted in illustration (2A).

1. Using a wrench, remove the two kennel clamps that are attached to the wire mesh of each of the kennel panels (2B).
2. Using a wrench and two of the supplied kennel clamps, attach a plain panel to the gate panel. Position one clamp approximately 4 inches from the top of the kennel and one clamp approximately 6 inches from the bottom of the kennel. For the safety of your dog, attach clamp so that nut is on the outside of the kennel. See (2C) for clamp and panel orientation.
3. Continue connecting remaining plain panels using wrench and two clamps per connection.

2A

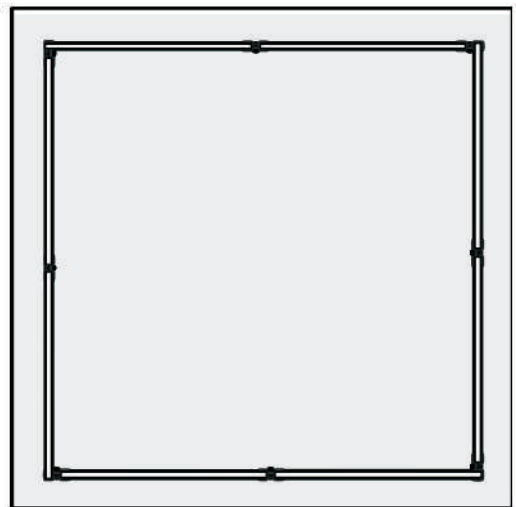

2B

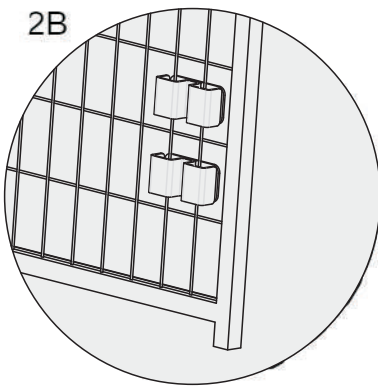

2C

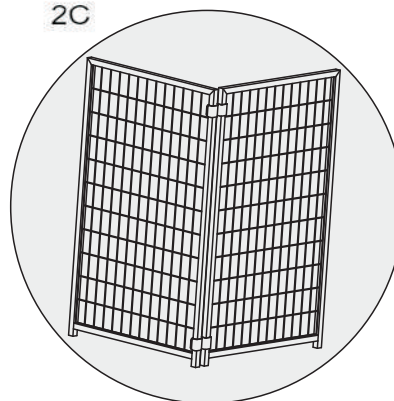

Note: Kennel can be locked

Expand your kennel by purchasing additional panels