

Assembly Instructions

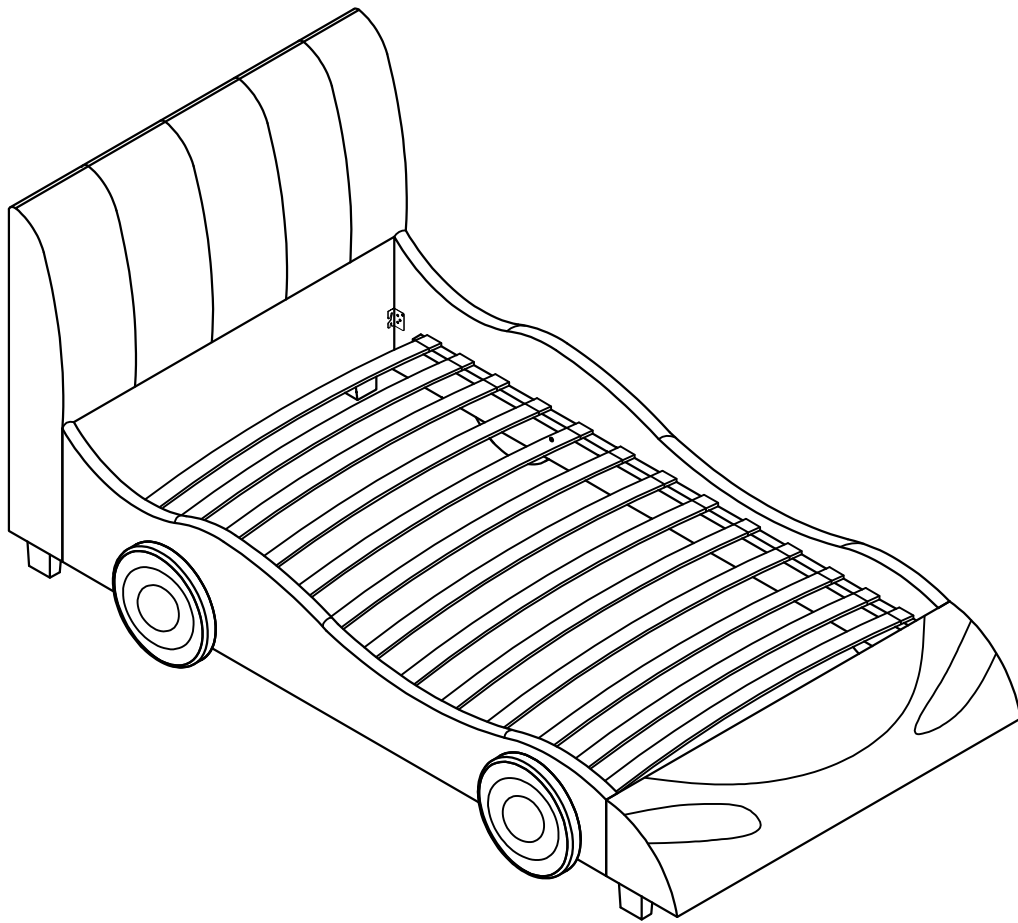

ASSEMBLY RATING

The Assembly Rating is a 5-point system that shows the degree of effort needed in assembling a specific product (with 1 being easy and 5 being difficult). For some products, two persons are recommended.

EASY



DIFFICULT

Tools Required For Assembly:

Allen Wrench

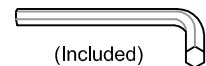

(Included)

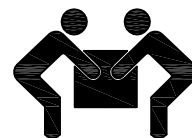

2 PERSONS RECOMMENDED

ASSEMBLY & CARE ADVICE

FOR YOUR FURNITURE TO LAST, CORRECT ASSEMBLY AND PROPER MAINTENANCE ARE NECESSARY. PLEASE FOLLOW THE INFORMATION PROVIDED BELOW TO FULLY ENJOY YOUR FURNITURE.

BASIC ASSEMBLY TECHNIQUES

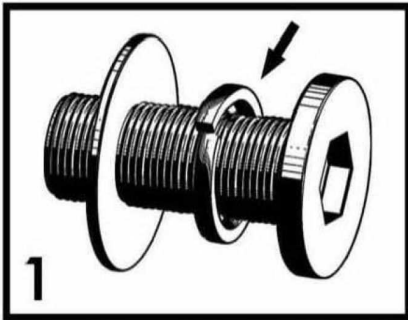

When lock or spring washer is used in an assembly, please make sure the lock or spring washer is placed between the larger flat washer and the head of the screw or bolt.



Position each part correctly and insert screws or bolts into their respective holes by hand tighten or using the proper hand tool. Only tighten when step is completed or when instructed to do so.

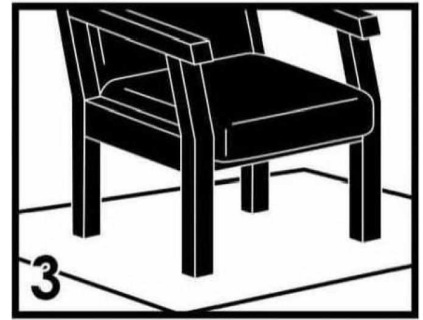

Use cardboard or carpet area when assembling furniture to prevent scratches. Make sure the furniture rests on a flat and level surface with each leg evenly touching the floor.

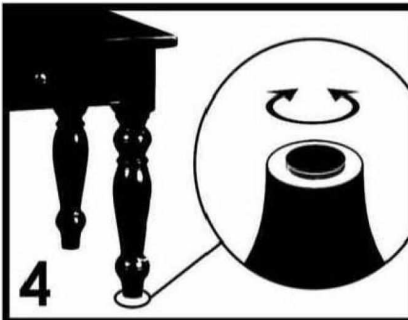

Some furniture comes with height adjustment knobs underneath each leg. To lower or to raise each leg, you need to turn clockwise or counterclockwise, respectively.

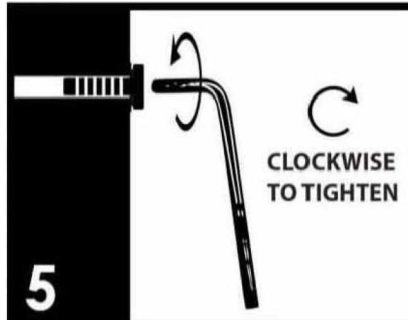

Make sure all parts are properly aligned, then use the appropriate hand tool to completely tighten the bolts or screws. Do not use power tools and do not overtighten.

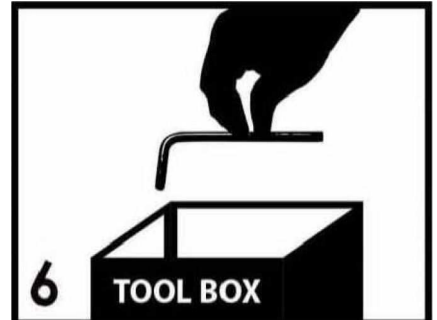

Save the instructions and store the Allen wrench or any supplied tool for later maintenance. After two weeks, check and tighten any loose hardware and repeat again every six months thereafter.

IT IS THE USER'S RESPONSIBILITY TO MAINTAIN THE FURNITURE. THE HARDWARE MAY LOOSEN OVER TIME AND MAY CAUSE THE FURNITURE TO BE WOBBLY AND UNABLE TO SUPPORT ITS INTENDED WEIGHT CAPACITY. THIS MAY LEAD TO COLLAPSE AND MAY CAUSE SERIOUS INJURY.



FAILURE TO FOLLOW THE GUIDELINES ABOVE MAY RESULT IN INJURY AND/OR PROPERTY DAMAGE.

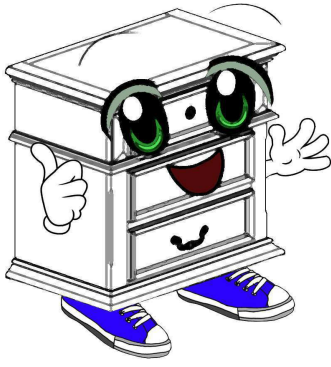

Before you begin, please read Page 2 of "Assembly and Care Advice".

And remember, do not tighten until each step is completed or instructed.

Parts List

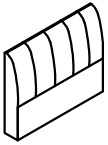

#1 x 1pc
Headboard

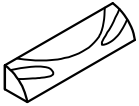

#2 x 1pc
Footboard

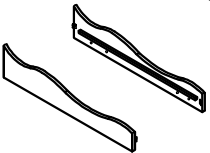

#3 x 2pcs
Side Rail (L & R)



#4 x 13pcs
Slat



#5 x 26pcs
End Cap



#6 x 4pcs
Leg



#7 x 4pcs
Side Rail disc

Hardware List



#A x 4pcs
Bolt 5/16"X2-1/2"



#B x 8pcs
Bolt 5/16"X1-1/2"



#C x 20pcs
Lock Washer

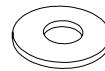

#D x 20pcs
Flat Washer



#E x 1pc
Allen Wrench



#F x 8pcs
Bolt 5/16"X 2"



- I. Align the legs (#6) to the bottom corners of the headboard (#1) and footboard (#2).
- II. Prepare 4 bolt assemblies by FIRST inserting the lock washer (#C) then the flat washer (#D) onto that SAME bolt (#A) and secure using the Allen wrench (#E).

#A x 4pcs
#C x 4pcs
#D x 4pcs

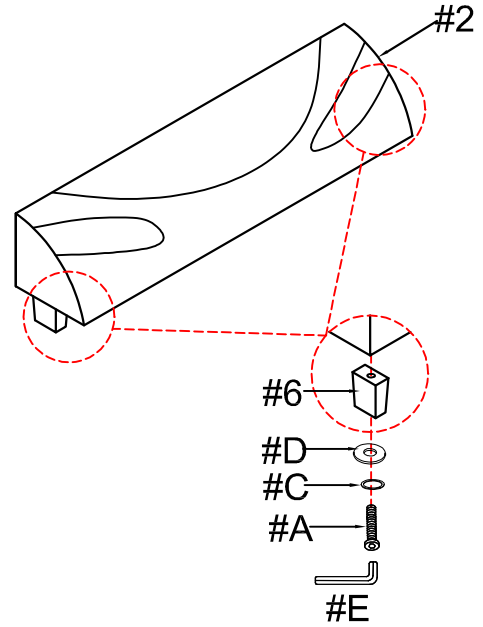
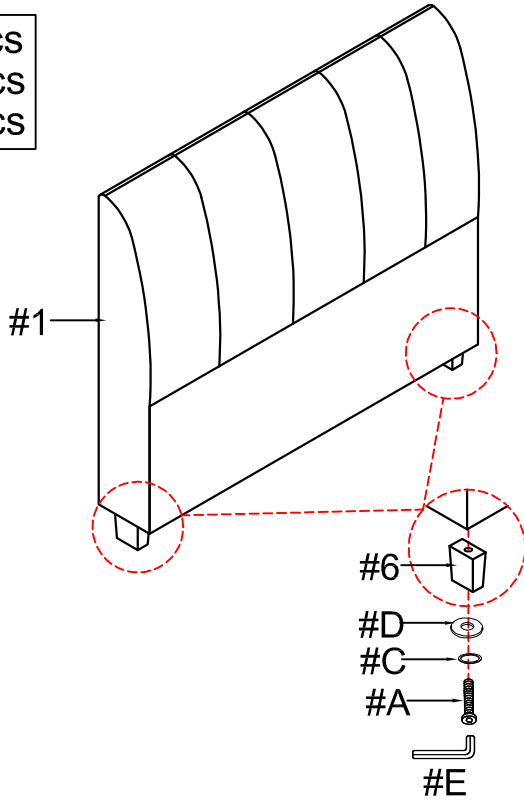

- I. Align the side rail discs (#7) to the left and right side rails (#3L/R).
- II. Prepare 8 bolt assemblies by FIRST inserting the lock washer (#C) onto the bolt (#F) then the flat washer onto that SAME bolt (#F). Secure using the Allen wrench.

#C x 8pcs
#D x 8pcs
#F x 8pcs

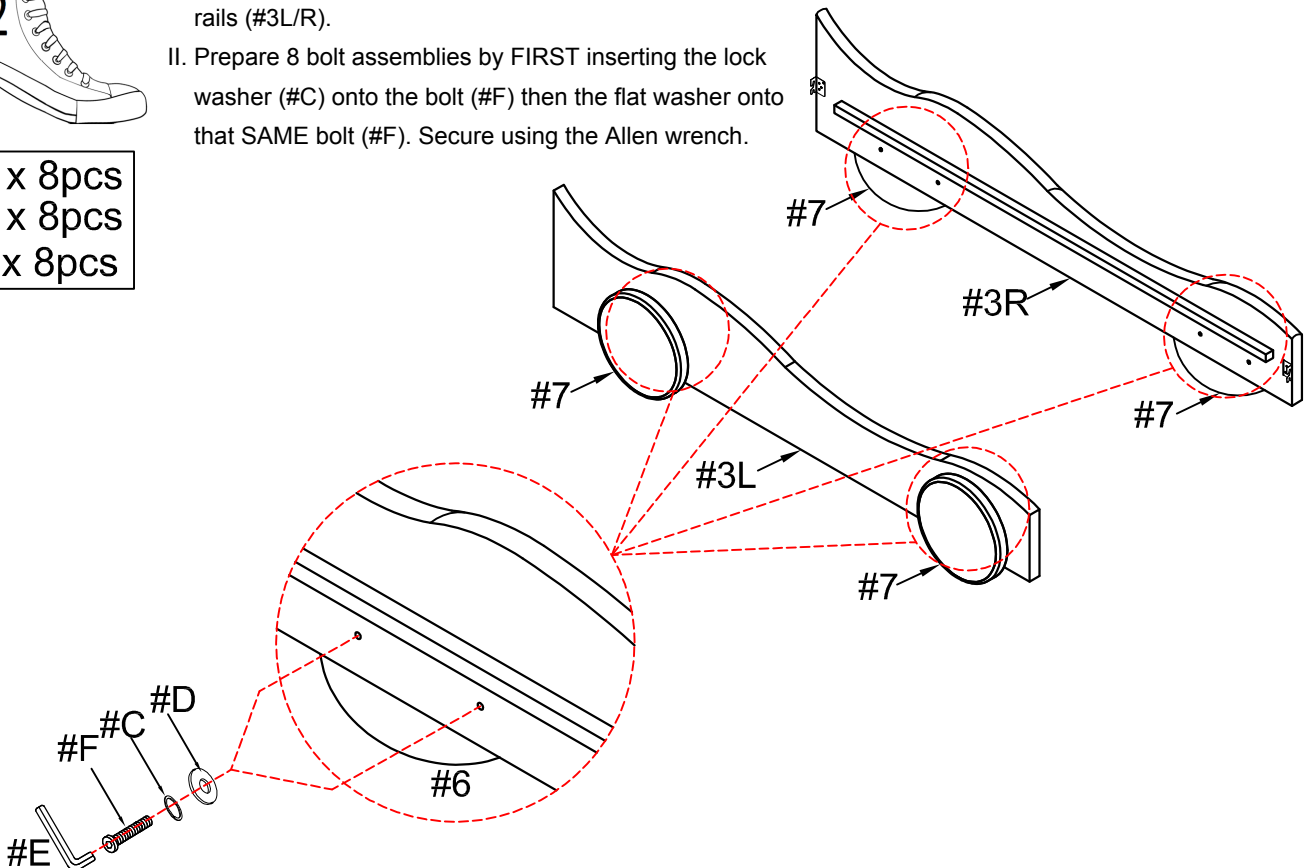



#3

- I. Align the pre-drilled holes on the left and right side rails (#3L/R) to the corners of the headboard (#1) and footboard (#2).
- II. Prepare 8 bolt assemblies by FIRST inserting the lock washer (#C) onto the bolt (#B) then the flat washer (#D) onto that SAME bolt (#B). Secure using the Allen wrench (#E).

#B x 8pcs
 #C x 8pcs
 #D x 8pcs

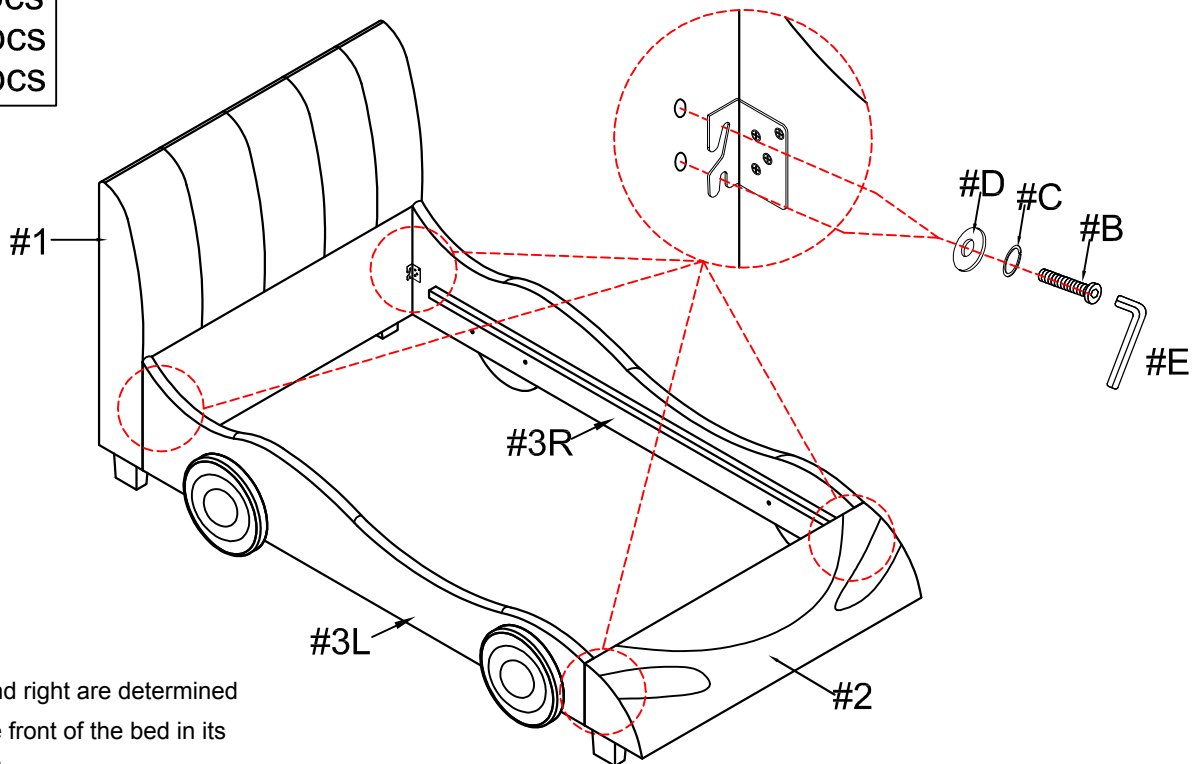

Note: Left and right are determined by facing the front of the bed in its upright position.



#4

- I. Prepare 13 slats by inserting 2 end caps (#5) to each end of the slat (#4).
- II. Insert slats into position. Make sure the curved side must be faces up when assembled.

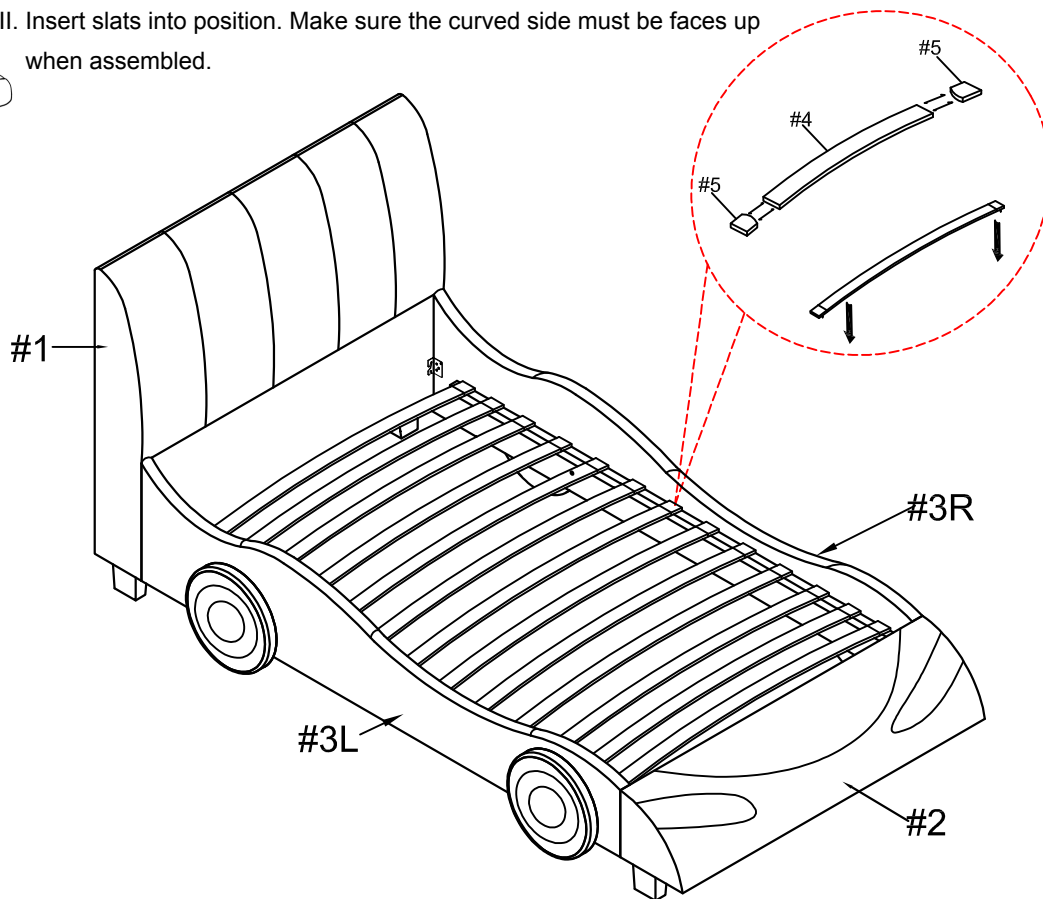

ASSEMBLY IS COMPLETED