

DESIGNER COLLECTION

# CHEYENNE

## 7236

**SIZE**

72" L x 36"W x 20"D

**WATER CAPACITY**

80 Gallons

**WEIGHT**

200 Pounds

**INSTALLATION**

Freestanding

**BACK SLOPE**

35°

**MATERIAL**

Acrylic

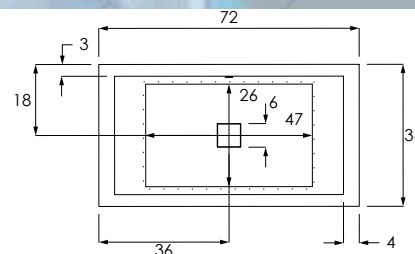
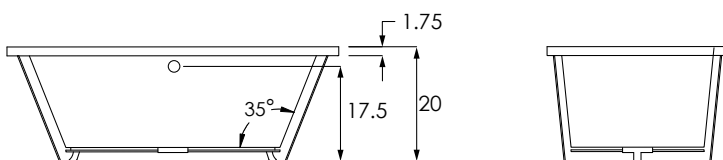

**MODEL**

CHE7236ATO	Tub Only
CHE7236ATA	Thermal Air

**COLORS**

Standard	White   Biscuit   Bone
Premium Colors	Black   Sterling Silver

**FINISH**

Matte Finish	MAT (must specify if desired)
Polished Finish	STANDARD

**DUAL COLOR OPTION**

MODEL/COLOR1/COLOR2	(XXX.XXX.XXX)
---------------------	---------------

**SURFACES (outside only)**

Metallic: Polished Nickel [PN]	
MODEL/METAL/COLOR	(XXX.XXX.XXX)

**COLD PLUNGE** | [order form](#)

CLD.PL

**EXPORT CRATE**

FRT.EXPCRT

**EXTRA HIGH DENSITY**

HI.DEN

**GRAB BARS** (Pair) Refer to price book for all available finishes

Standard Grab Bars	GRA.BAR-XXX
Universal Grab Bars	UGB.BAR-XXX

**MODEL**

**HEATED BACKREST** INCLUDED ON THERMAL AIR

**HYDRO BLANKET** 2 Zones | 3 Zones | 4 Zones | 5 Zones (W/ 2 Controls) BLA.HEA-X

**HYDRO COAT** HYC.COA

**HYDRO EXPRESS** 69.104-HYD.EXP-FRE

**HYDRO FUSION** | [order form](#)

Hydro Fusion (Tub Only)	29.102
Hydro Fusion w/ Ozone (Tub Only)	29.103
Hydro Fusion (TA, Whirlpool, Combo)	29.107

**HYDRO INDULGE** | [order form](#) HYD.IND

**HYDRO OZONE** INCLUDED ON THERMAL AIR

**ISLAND TUB DRAIN** ITD.XXX

ABS, PVC	ITD.ABS   ITD.PVC
Cast Iron	ITD.CST



HYDRO SYSTEMS



**Headquarters**  
29132 Avenue Paine  
Valencia, CA 91355

**Manufacturing Facility**  
385 Highway 155 South  
McDonough, GA 30253

**Technical Support**  
support@hydrosystem.com

**Orders Department**  
orders@hydrosystem.com

**General Information**  
info@hydrosystem.com

**Phone:** 661-775-0686

**Website:** hydrosystem.com

**CODES AND COMPLIANCES**

Massachusetts code File no: P1-0614-491



All specifications and options subject to change without notice please contact a hydro systems representative for more information.

# CHEYENNE

## 7236

DESCRIPTION	
<b>LED TEMP. READOUT KEYPAD</b> Upgrade only, must have a keypad controlled system to purchase.	LED.UPG
<b>LIGHTING</b> LED Bath Light Chromotherapy System	LIG.LED
<b>MOLDED ARMRESTS</b> Some molded armrests add an interior detail line to the bathtub 2 Armrests (one pair)	ARM.MOL-2
4 Armrests (two pairs)	ARM.MOL-4

DESCRIPTION	
<b>REMOTE CONTROL</b> Must must have system to purchase	REM.CON
<b>TOWER</b> Must specify size & location on tub. Can hide plumbing, fusion, or indulge.	TOW-XX
18" or 24"	25" - 30"
31" - 36"	37" - 42"
43" - 48"	49" - 54"
55" - 60"	Access Panel
<b>INTEGRAL W/O</b> (Std. round) Waste and overflow manufactured as part of the bath. Comes standard as a round overflow cover. Drain will be a tip-toe style and drain outlet will be a direct drain.  (WHI, BIS, PC, PB, PN, BC, BB, BN, SC, SB, SN, ORB, PE, MB)	IWO.XX (INCLUDED)
W/O - Gold Finish Upgrade (PG, BG)	
<b>LINEAR INTEGRAL W/O</b> Waste and overflow manufactured as part of the bath. Drain will be a tip-toe style and drain outlet will be a direct drain.	LWO-XXX (NO CHARGE UPGRADE)



**Headquarters**  
29132 Avenue Paine  
Valencia, CA 91355

**Manufacturing Facility**  
385 Highway 155 South  
McDonough, GA 30253

**Technical Support**  
support@hydrosystem.com

**Orders Department**  
orders@hydrosystem.com

**General Information**  
info@hydrosystem.com

**Phone:** 661-775-0686  
**Website:** hydrosystem.com

**CODES AND COMPLIANCES**

Massachusetts code File no: P1-0614-491



All specifications and options subject to change without notice please contact a hydro systems representative for more information.

# CHEYENNE

## 7236

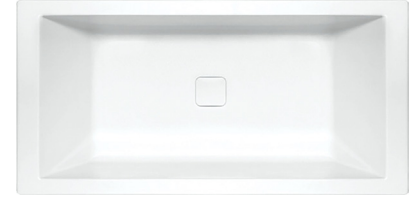

### STANDARD ACRYLIC COLORS



WHITE BISCUIT BONE

### PREMIUM ACRYLIC COLORS



BLACK STERLING SILVER

### WELLNESS OPTIONS



**Cold Plunge**  
Revitalizing cold hydrotherapy into a traditional tub



**Thermal Air**  
Tiny bubbles into the bathwater and offers untold relaxing benefits, similar to Swedish massage



**Hydro Indulge**  
A concentrated dose of oxygen-rich molecules cleanse and restore skin



**Advanced UV system**  
Ozone and UV light helps to disinfect the water and keep it clean



**Chromotherapy**  
Digitally controlled, multicolored lighting feature LED lighting system



**Hydro Fusion**  
Totally silent operation maintains ideal temperature without adding hot water constantly



**Hydro Blanket**  
Radiant heat emanates through the acrylic tub surface. Choose up to 2-5 panels..

### OTHER OPTIONS

Additional options can be found on our website



**Integral Waste and Overflow**  
Seamless built-in protection for bathtub (included)



**Grab Bars**  
Adds functionality and enhanced styling. Affords a mounting solution in virtually any position on any tub.



**Tower**  
Ideal solution adding systems or roman tub faucet to a freestanding bathtub.



**Island Tub Drain**  
Asymmetrical 18 Gauge Epoxy coated Metal Deck Flange makes installation in tight spaces easier.



HYDRO SYSTEMS



**Headquarters**  
29132 Avenue Paine  
Valencia, CA 91355

**Manufacturing Facility**  
385 Highway 155 South  
McDonough, GA 30253

**Technical Support**  
support@hydrosystem.com

**Orders Department**  
orders@hydrosystem.com

**General Information**  
info@hydrosystem.com

**Phone:** 661-775-0686  
**Website:** hydrosystem.com

### CODES AND COMPLIANCES

Massachusetts code File no: P1-0614-491



All specifications and options subject to change without notice please contact a hydro systems representative for more information.