

ASSEMBLY INSTRUCTION

Please read it carefully before assemble the chair.
If you have any question , feel free to send message to us via your order platform . we will do our best to serve you ! Thank you !

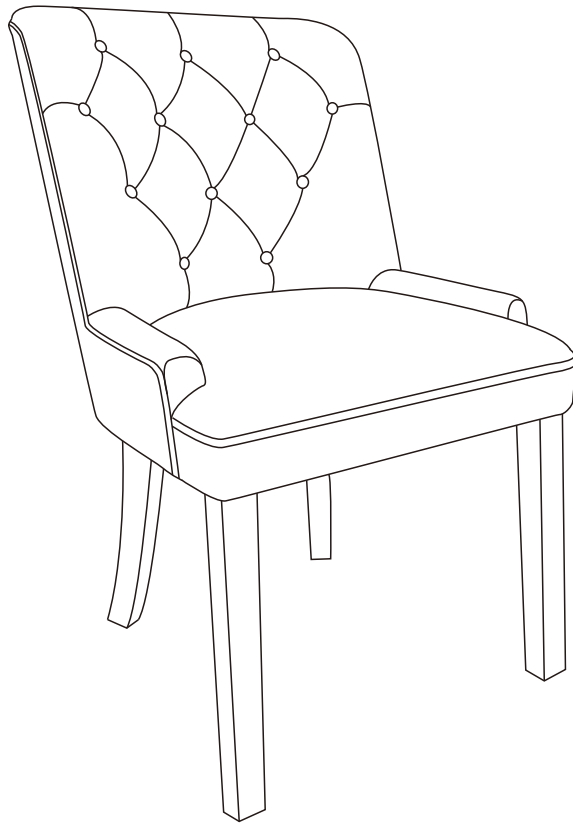

(A)x1

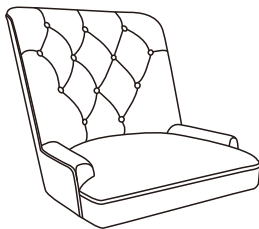

(B)x2

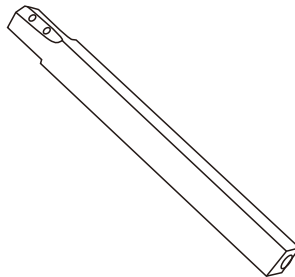

(C)x2

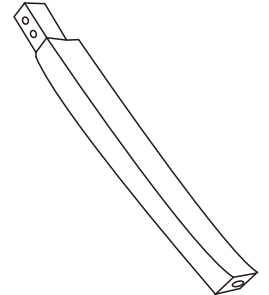

(D)x8



M8*55mm

(E)x8



M8* ϕ 22mm

(F)x8



M8* ϕ 13mm

(G)x1



ASSEMBLY INSTRUCTION

Please read it carefully before assemble the chair.
If you have any question , feel free to send message to us via your order platform . we will do our best to serve you ! Thank you !

- 1** 2 pcs Straight legs are in Front.
2 pcs Curved legs are in Rear.

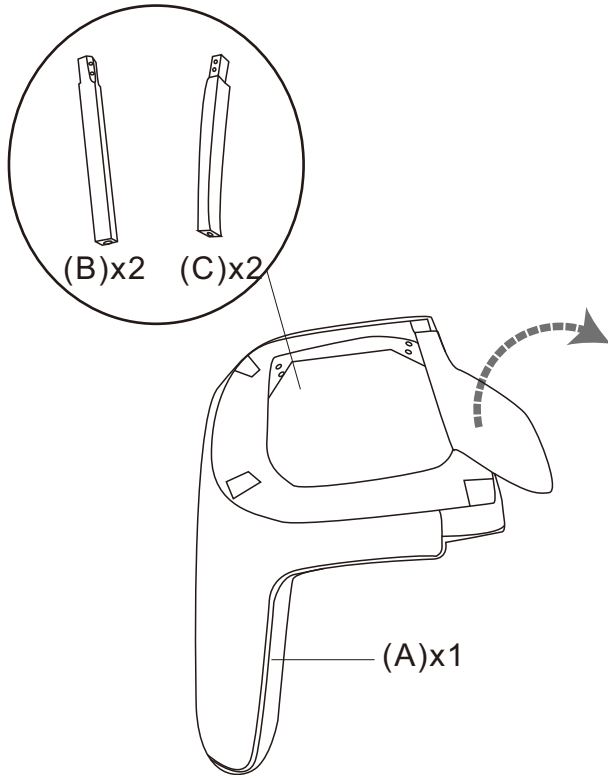

- 2** Open the zipper in the bottom of chair.
Take out chair legs and Hardware.
Put spring pad first, then put the flat pad into the screw. total 8 sets.

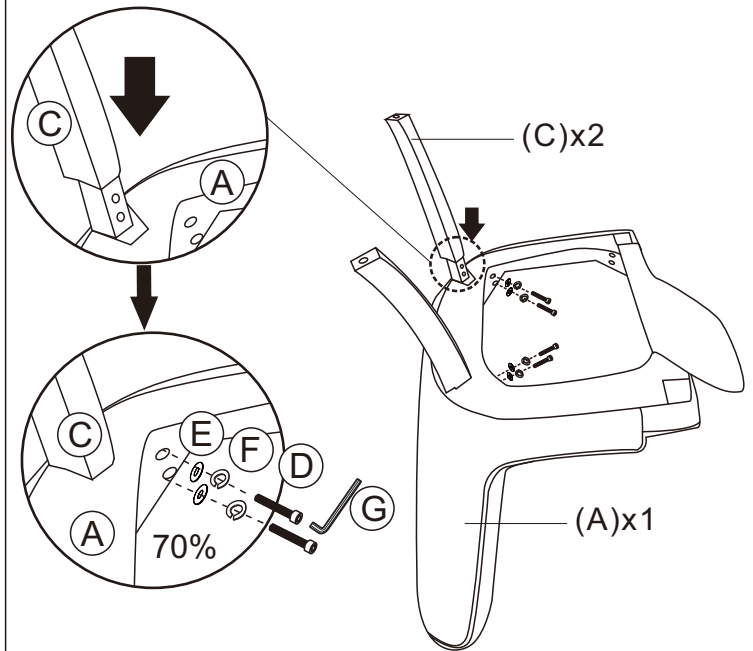

- 3** Put the legs in proper , take the screw into each hole up to 70% , then tighten them all !

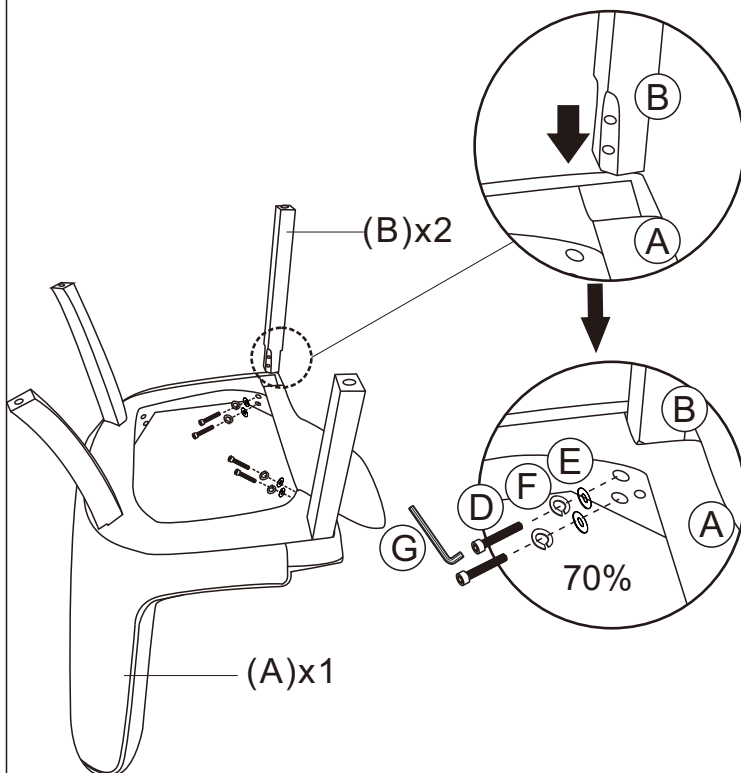

- 4** Tips: the Foot nails in the front of the chair are height adjustable .

