

Sit and surf.

View L-Shaped Desk

NOTE: THIS INSTRUCTION BOOKLET CONTAINS **IMPORTANT** SAFETY INFORMATION.

PLEASE READ AND KEEP FOR FUTURE REFERENCE.

Table of Contents

Assembly Tools Required

Part Identification	3
Hardware Identification	4-5
Assembly Steps	6-27
Français	28-31
Español	32-35
Safety	36-38
Warranty	39

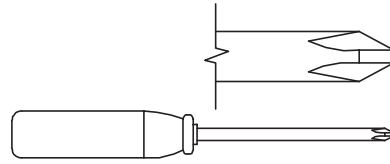

No. 2 Phillips Screwdriver
Tip Shown Actual Size

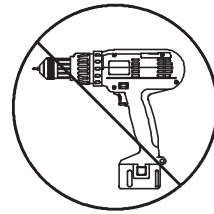

Skip the power trip.
This time.

Part Identification

Now you know
our ABCs.



⚠ While not all parts are labeled, some of the parts will have a label or an inked letter on the edge to help distinguish similar parts from each other. Use this part identification to help identify similar parts.

A	DESK TOP (1)	L	HUTCH TOP (1)	V	DRAWER BOTTOM (1)
B	RETURN TOP (1)	M	LEFT HUTCH END (1)	W	DRAWER BRACE (2)
C	END MOLDING (1)	N	RIGHT HUTCH END (1)	X	RIGHT RETURN FRAME (1)
D	LEFT END (1)	O	LEFT HUTCH UPRIGHT (1)	Y	LEFT RETURN FRAME (1)
E	REAR PANEL (1)	P	RIGHT HUTCH UPRIGHT (1)	Z	DESK FRAME (1)
F	FLIP DOWN DOOR (1)	Q	HUTCH BACK (1)	AA	LOWER RETURN MOLDING (1)
G	UPRIGHT (1)	R	DRAWER FRONT (1)	BB	UPPER RETURN MOLDING (2)
H	RIGHT END (1)	S	LEFT DRAWER SIDE (1)	CC	HUTCH MOLDING (1)
J	RETURN BACK (1)	T	RIGHT DRAWER SIDE (1)	DD	LOWER DESK MOLDING (1)
K	HUTCH BOTTOM (1)	U	DRAWER BACK (1)	EE	DIVIDER (1)

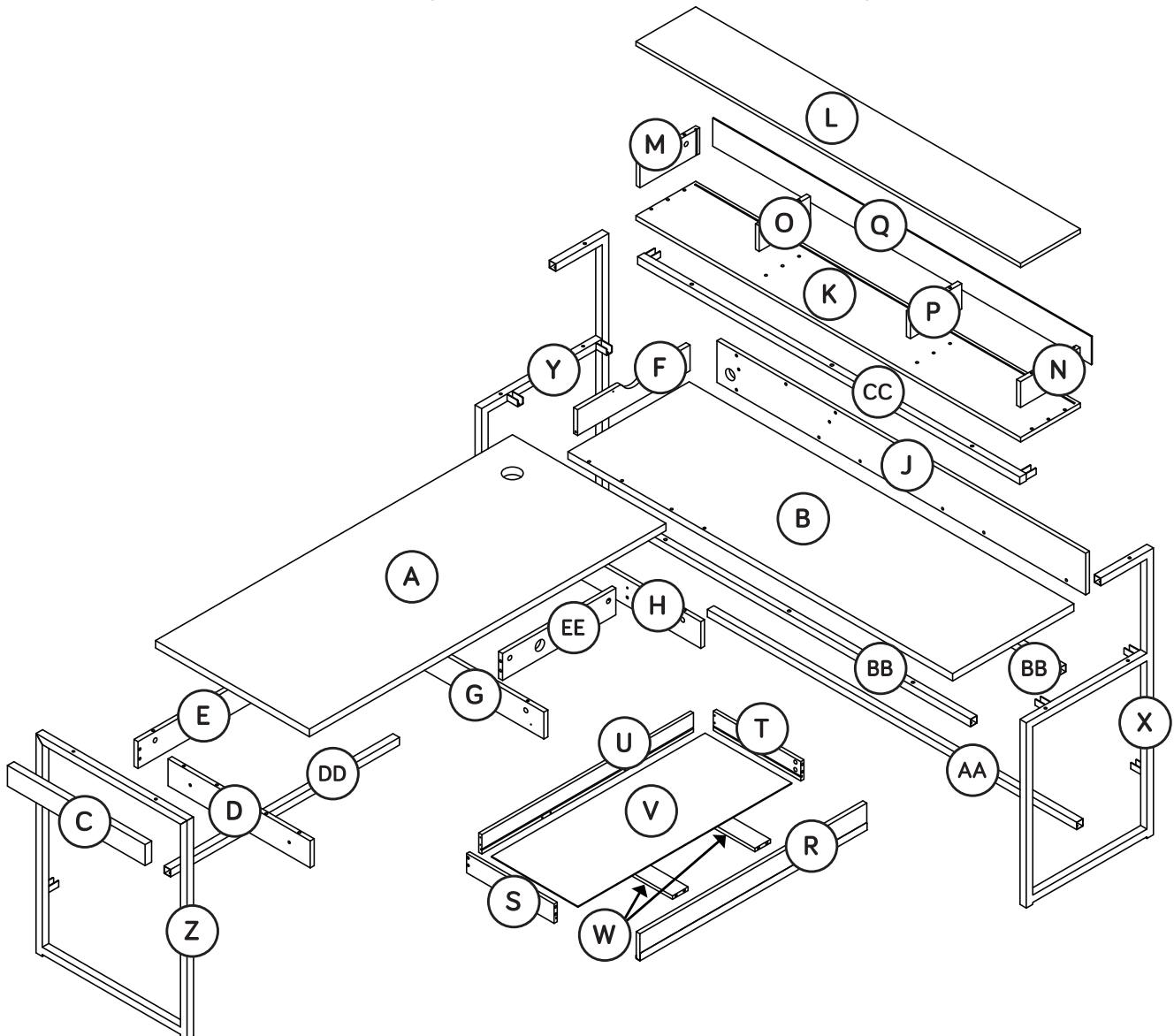

Hardware Identification

† Screws are shown actual size. You may receive extra hardware with your unit.

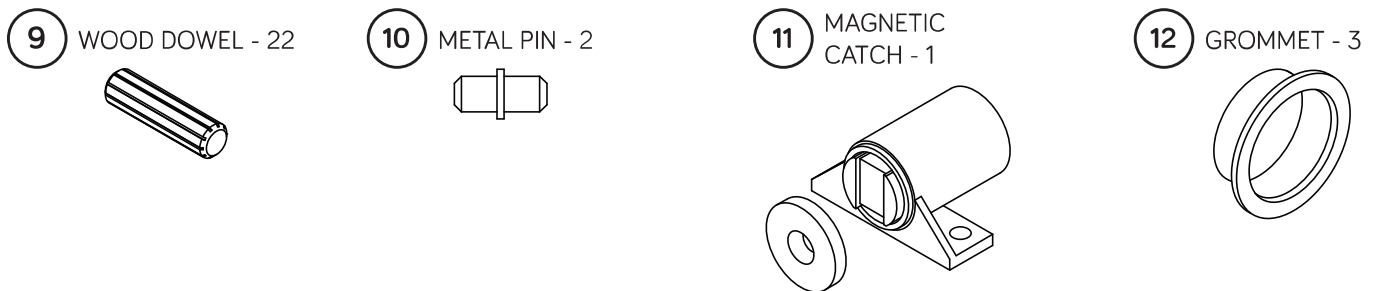
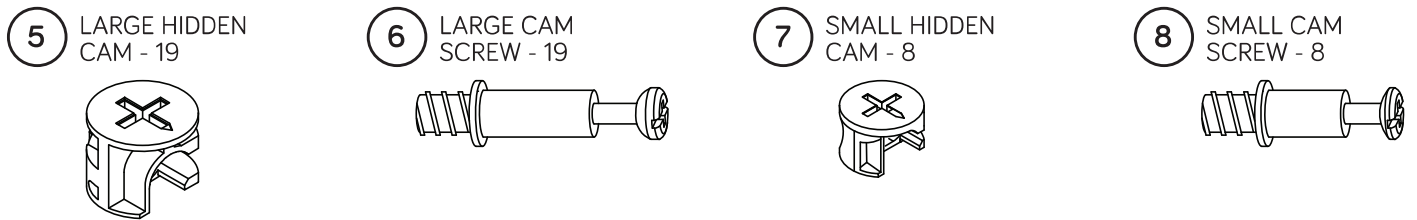
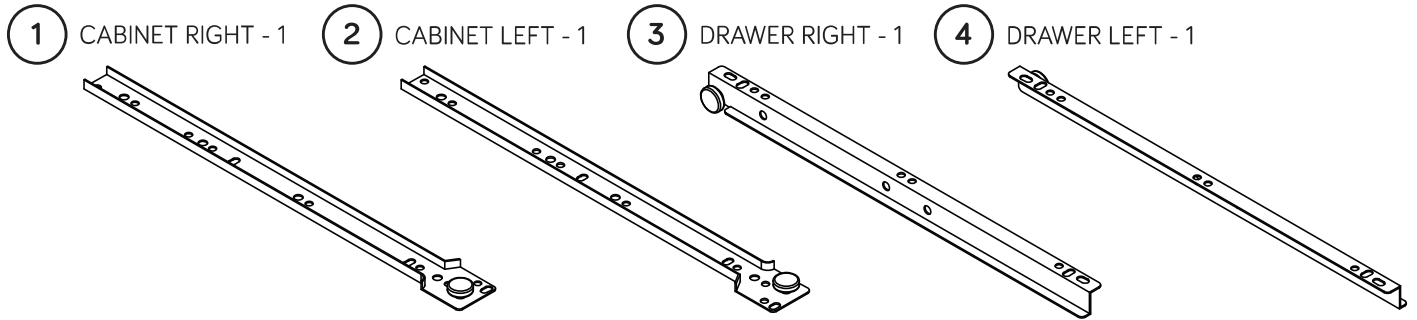

Hardware Identification

† Screws are shown actual size. You may receive extra hardware with your unit.

20 BLACK 1-7/8" HEX HEAD SCREW - 2

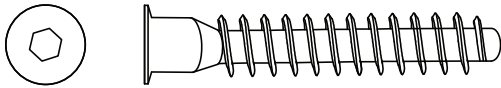

21 BLACK 1-9/16" HEX HEAD SCREW - 10

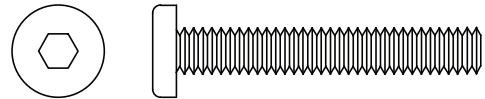

22 BLACK 1-1/2" HEX HEAD SCREW - 19

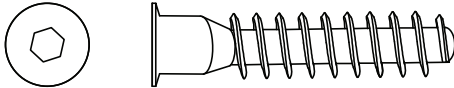

23 BLACK 1-3/8" HEX HEAD SCREW - 5

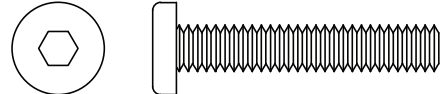

24 BLACK 1-3/8" FLAT HEAD SCREW - 8

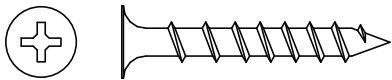

25 BLACK 1-3/8" TAPERED MACHINE SCREW - 2

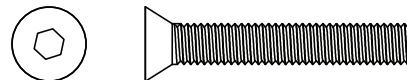

26 BLACK 1" TAPERED MACHINE SCREW - 5

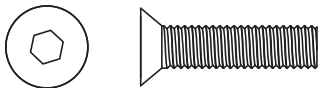

27 BLACK 9/16" FLAT HEAD SCREW - 3



28 BLACK 1/2" FLAT HEAD SCREW - 12



29 BLACK 7/16" HEX HEAD SCREW - 20



Step 1

- ✚ Assemble your unit on a carpeted floor or on the empty carton to avoid scratching your unit or the floor.
- ✚ Push nineteen LARGE HIDDEN CAMS (5) into the LEFT END (D), REAR PANEL (E), UPRIGHT (G), RIGHT END (H), HUTCH ENDS (M and N), HUTCH UPRIGHTS (O and P), and DIVIDER (EE).



Some assembly
(and snacks) required.

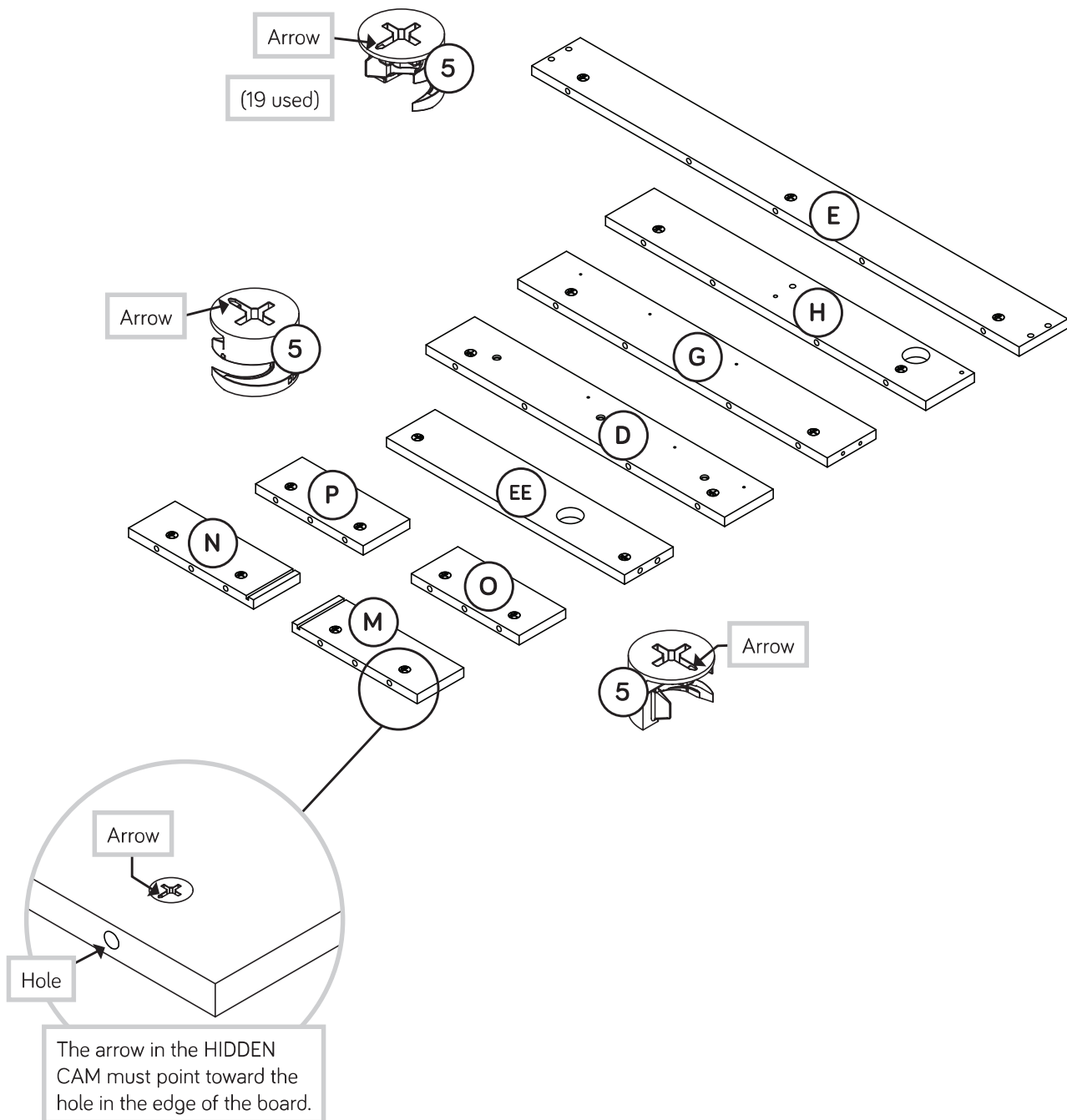

Step 2

- Fasten the CABINET RIGHT (1) to the UPRIGHT (G). Use three BLACK 1/2" FLAT HEAD SCREWS (28).
- Fasten the CABINET LEFT (2) to the LEFT END (D). Use three BLACK 1/2" FLAT HEAD SCREWS (28).

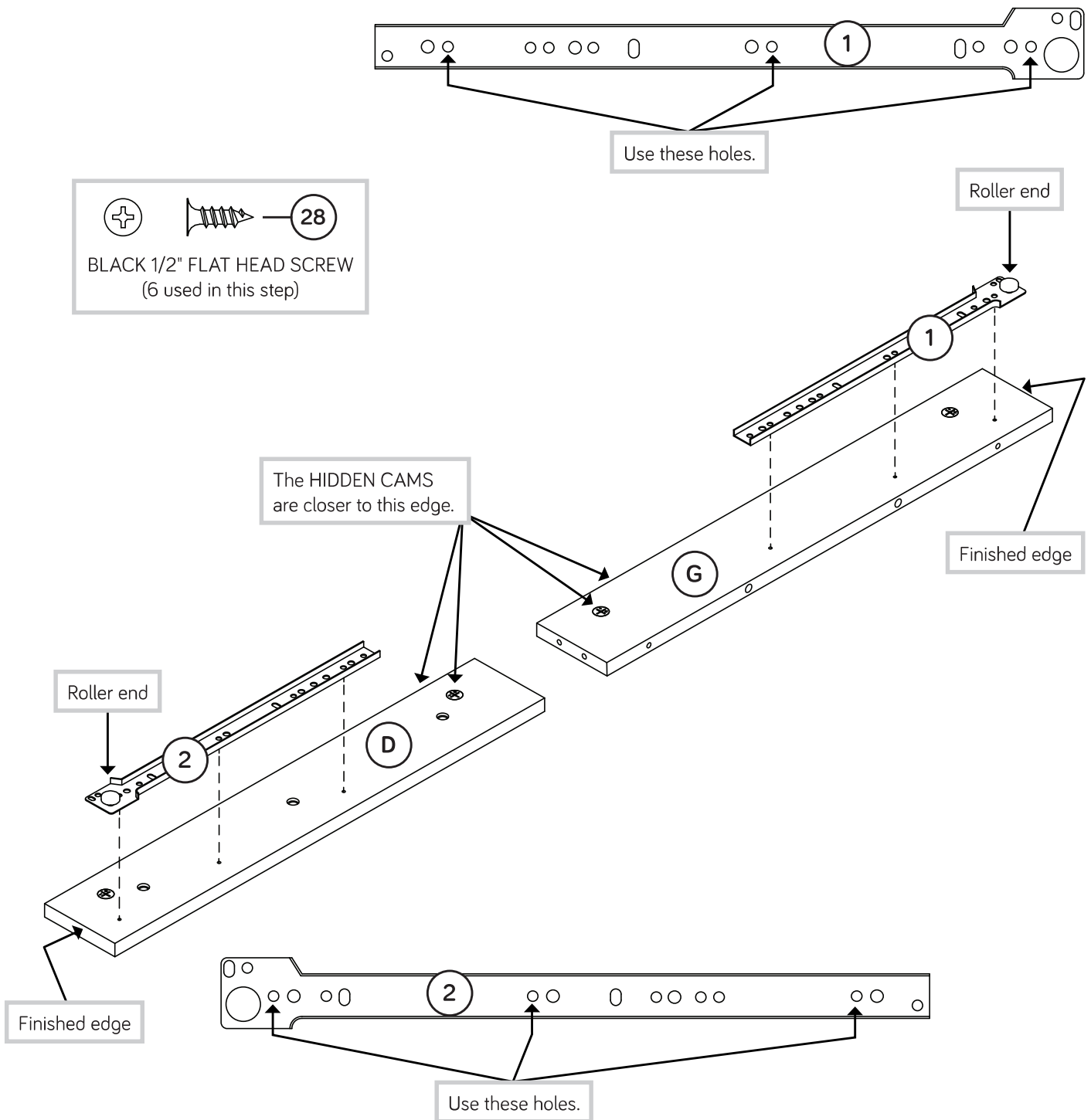

Step 3

- ✦ Separate the WASHER from the MAGNETIC CATCH (11).
- ✦ Fasten the MAGNETIC CATCH (11) to the DESK TOP (A) exactly as shown. Use two BLACK 9/16" FLAT HEAD SCREWS (27).
- ✦ Fasten the WASHER to the FLIP DOWN DOOR (F) exactly as shown. Use one BLACK 9/16" FLAT HEAD SCREW (27).
- ✦ Turn nineteen LARGE CAM SCREWS (6) into the exact holes shown in the DESK TOP (A), UPRIGHT (G), RIGHT END (H), and HUTCH TOP (L).

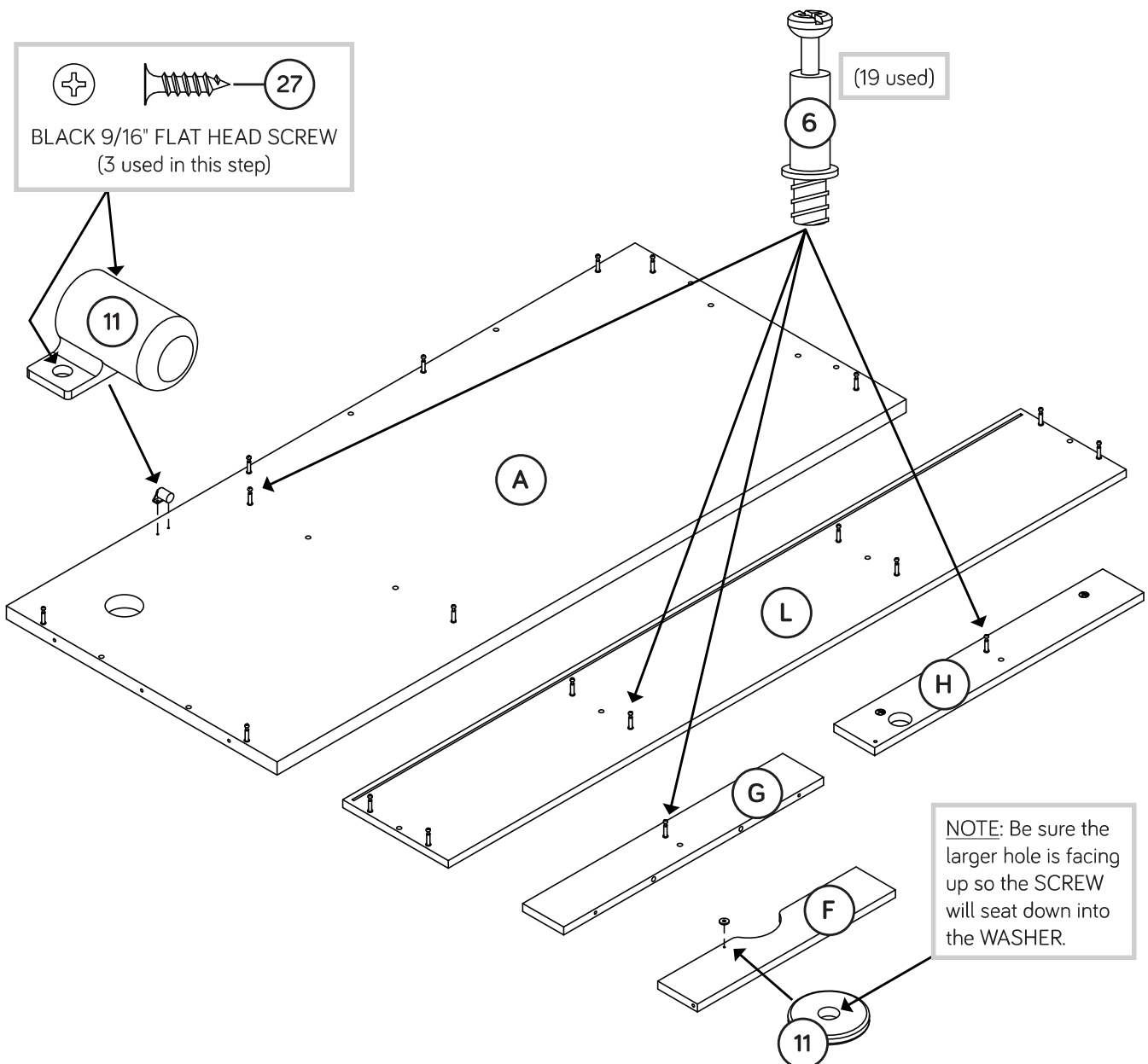
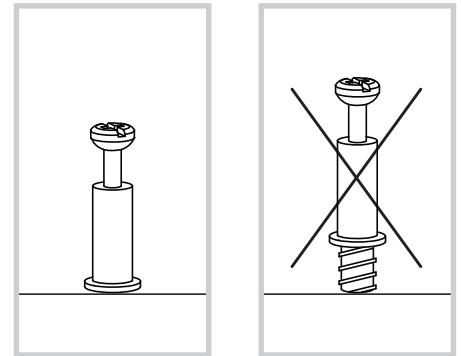

Step 4

- ✚ Insert two WOOD DOWELS (9) into the UPRIGHT (G) and RIGHT END (H).
- ✚ Fasten the DIVIDER (EE) to the UPRIGHT (G) and RIGHT END (H). Tighten two HIDDEN CAMS.
- ✚ **NOTE:** Be sure the WOOD DOWELS in the UPRIGHT and RIGHT END insert into the DIVIDER.
- ✚ Insert six WOOD DOWELS (9) into the DESK TOP (A).
- ✚ Fasten the ENDS (D and H) and UPRIGHT (G) to the DESK TOP (A). Tighten six HIDDEN CAMS.
- ✚ **NOTE:** Be sure the WOOD DOWELS in the DESK TOP insert into the ENDS and UPRIGHT.

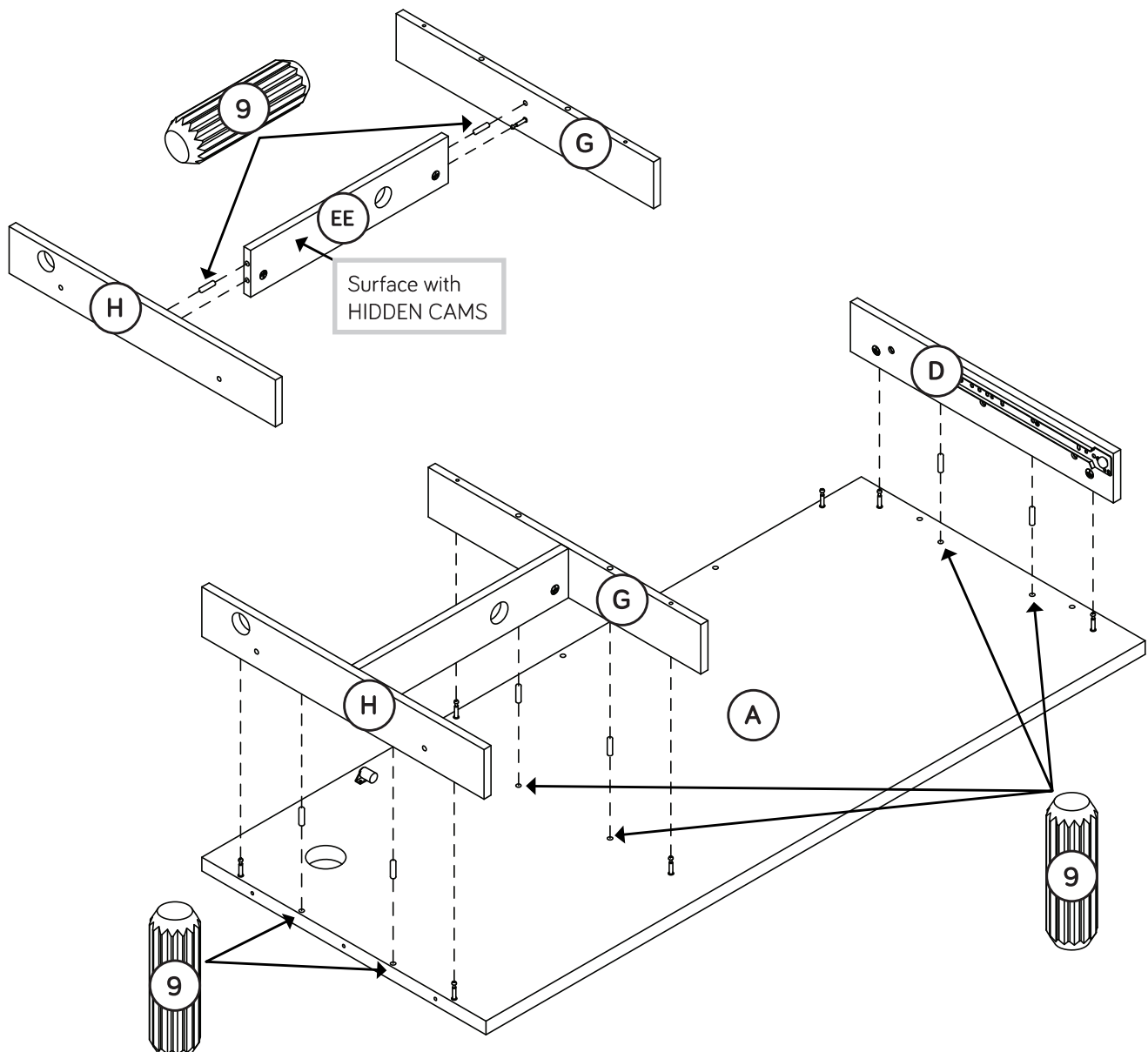
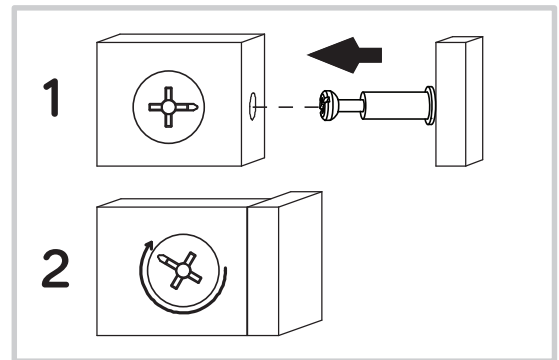

Step 5

- ✚ Insert two WOOD DOWELS (9) into the DESK TOP (A).
- ✚ Insert two METAL PINS (10) into the FLIP DOWN DOOR (F).
- ✚ Place the REAR PANEL (E) onto one of the METAL PINS in the FLIP DOWN DOOR (F).
- ✚ NOTE: Position the REAR PANEL (E) and FLIP DOWN DOOR (F) exactly as shown.
- ✚ Insert the METAL PIN in the other end of the FLIP DOWN DOOR (F) into the RIGHT END (H) keeping the REAR PANEL (E) connected to the FLIP DOWN DOOR (F).
- ✚ Fasten the REAR PANEL (E) to the DESK TOP (A). Tighten three HIDDEN CAMS.
- ✚ NOTE: Be sure the WOOD DOWELS in the DESK TOP insert into the REAR PANEL.

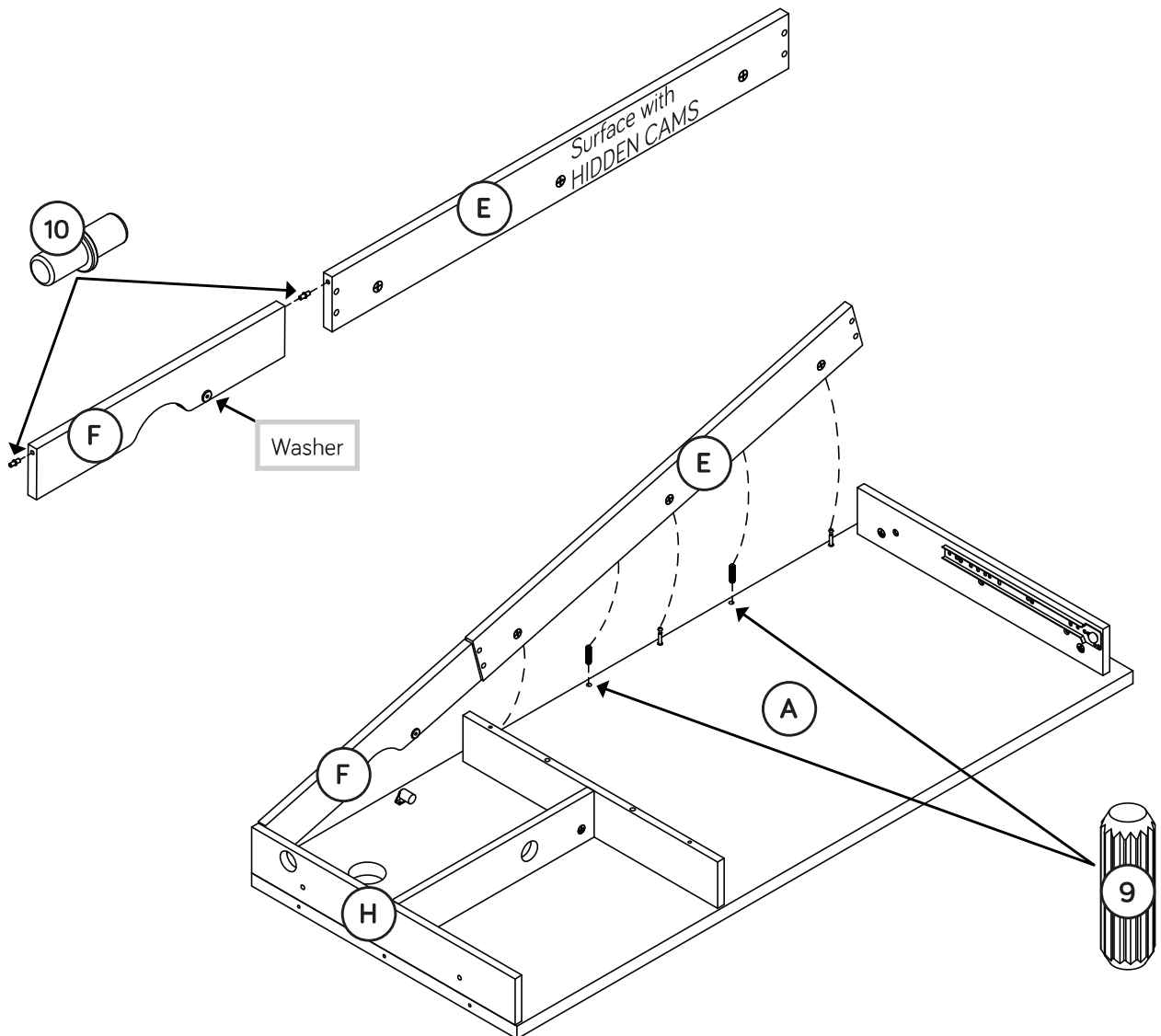

Step 6

- Fasten the REAR PANEL (E) to the LEFT END (D) and UPRIGHT (G). Tighten four BLACK 1-1/2" HEX HEAD SCREWS (22) using the L-WRENCH (15).
- Insert one of the GROMMETS (12) into the large hole in the DIVIDER (EE).
- Insert one GROMMET (12) into the large hole in the RIGHT END (H).



Just think. The sooner you do this, the sooner you do something else.

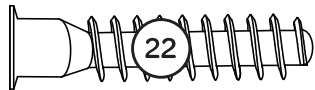
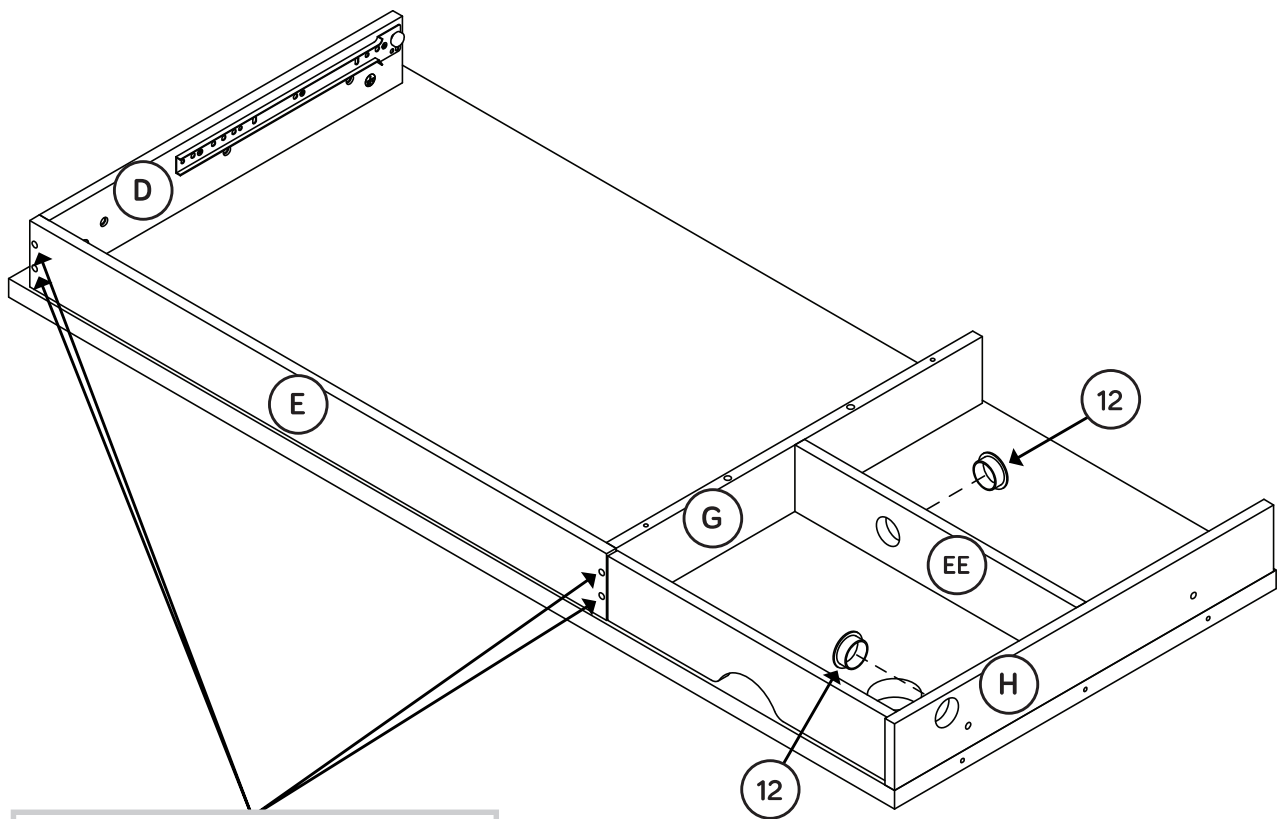

BLACK 1-1/2" HEX HEAD SCREW
(4 used in this step)

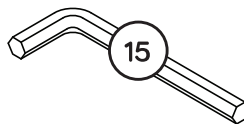

Step 7

- ✚ Insert four WOOD DOWELS (9) into the HUTCH TOP (L). Fasten the HUTCH ENDS (M and N) and HUTCH UPRIGHTS (O and P) to the HUTCH TOP (L). Tighten eight HIDDEN CAMS.

- ✚ NOTE: Be sure the WOOD DOWELS in the HUTCH TOP insert into the HUTCH ENDS and HUTCH UPRIGHTS.

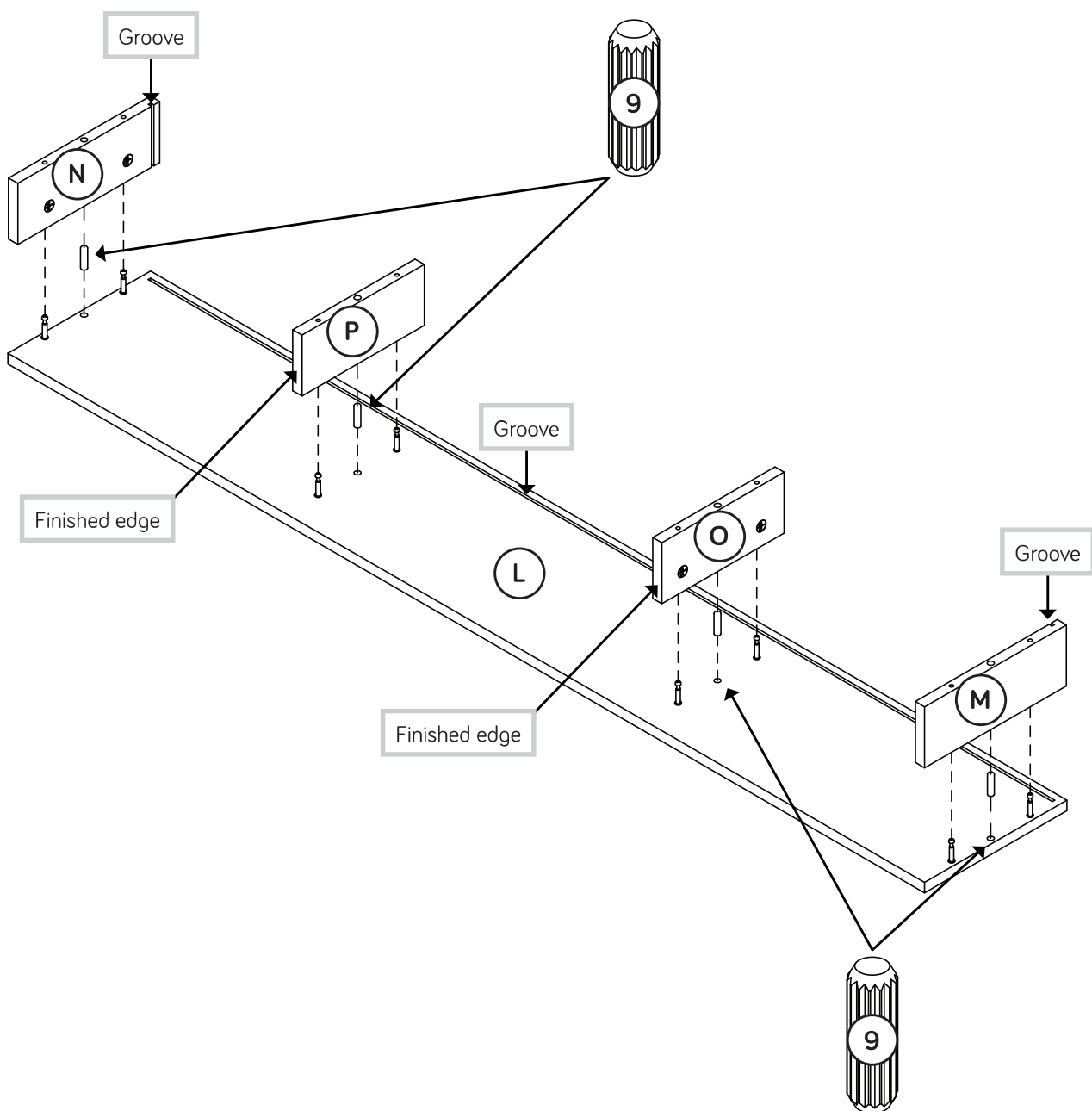

Step 8

- ✦ Slide the HUTCH BACK (Q) down into the grooves in the HUTCH TOP (L) and HUTCH ENDS (M and N).
- ✦ Insert four WOOD DOWELS (9) into the HUTCH ENDS (M and N) and HUTCH UPRIGHTS (O and P).
- ✦ Fasten the HUTCH BOTTOM (K) to the HUTCH ENDS (M and N) and HUTCH UPRIGHTS (O and P). Tighten eight BLACK 1-1/2" HEX HEAD SCREWS (22) using the L-WRENCH (15).
- ✦ **NOTE:** Be sure the WOOD DOWELS in the HUTCH ENDS and HUTCH UPRIGHTS insert into the HUTCH BOTTOM.
- ✦ **NOTE:** Be sure the HUTCH BACK inserts into the groove in the HUTCH BOTTOM.

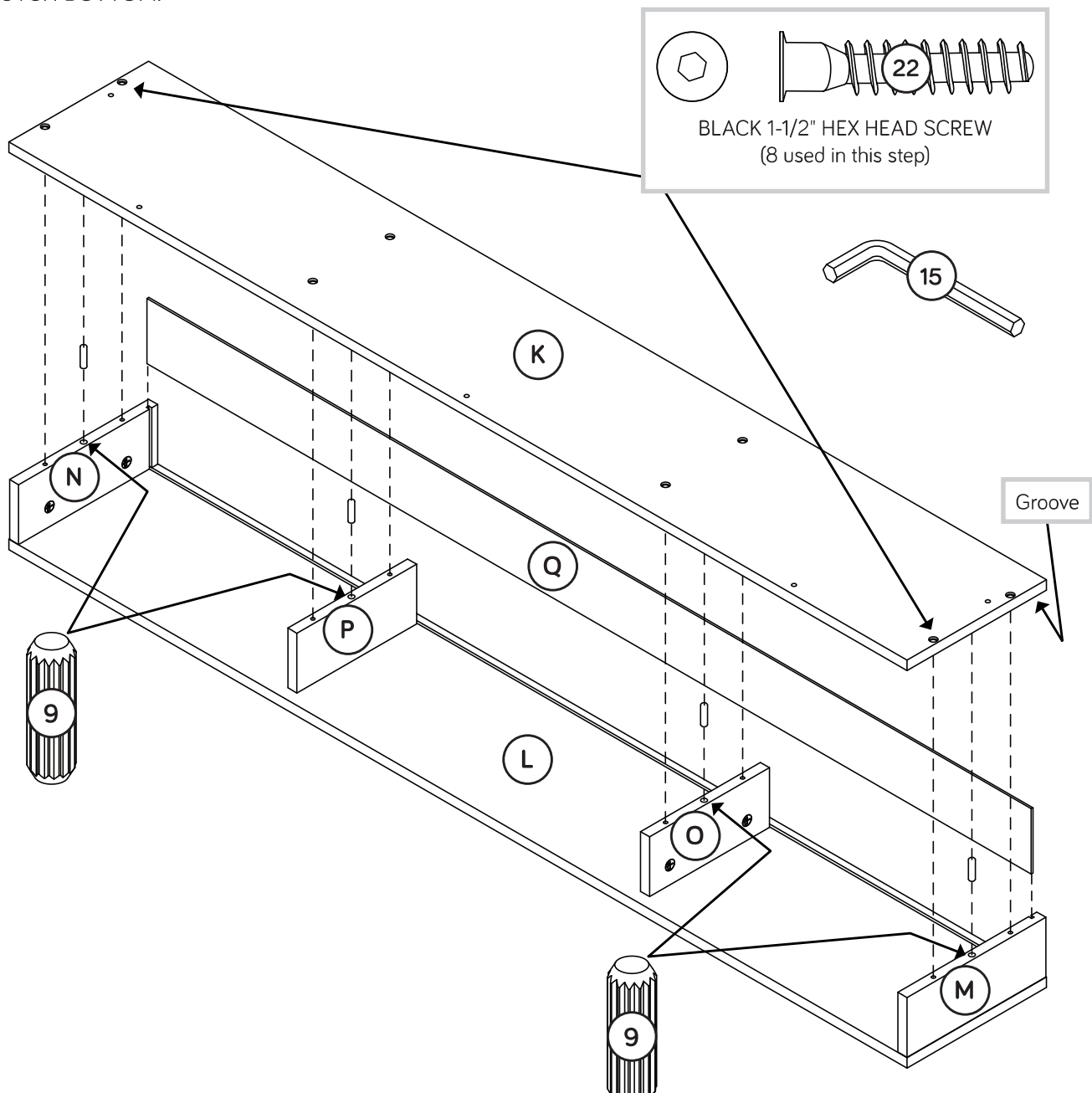

Step 9

- 🔩 **NOTE:** Do not completely tighten the SCREWS in this step.
- 🔩 Slide the MOLDINGS (AA and BB) onto the LEFT RETURN FRAME (Y).
- 🔩 Fasten the MOLDINGS (AA and BB) to the LEFT RETURN FRAME (Y). Tighten six BLACK 7/16" HEX HEAD SCREWS (29) using the L-WRENCH (15).

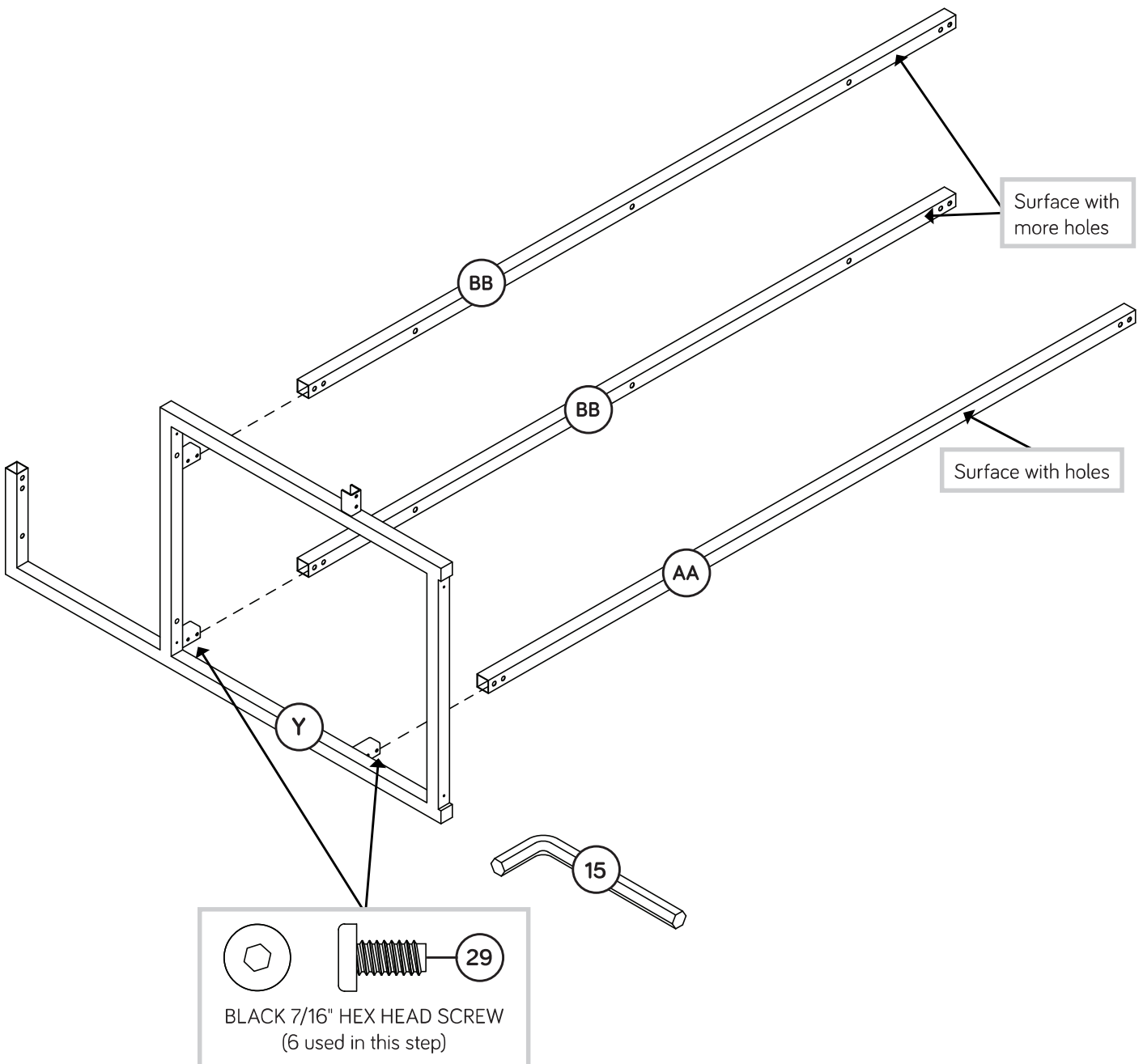

Step 10

- 🔩 **NOTE:** Do not completely tighten the SCREWS in this step.
- 🔩 Slide the RIGHT RETURN FRAME (X) into the MOLDINGS (AA and BB).
- 🔩 Fasten the RIGHT RETURN FRAME (X) to the MOLDINGS (AA and BB).
Tighten six BLACK 7/16" HEX HEAD SCREWS (29) using the L-WRENCH (15).

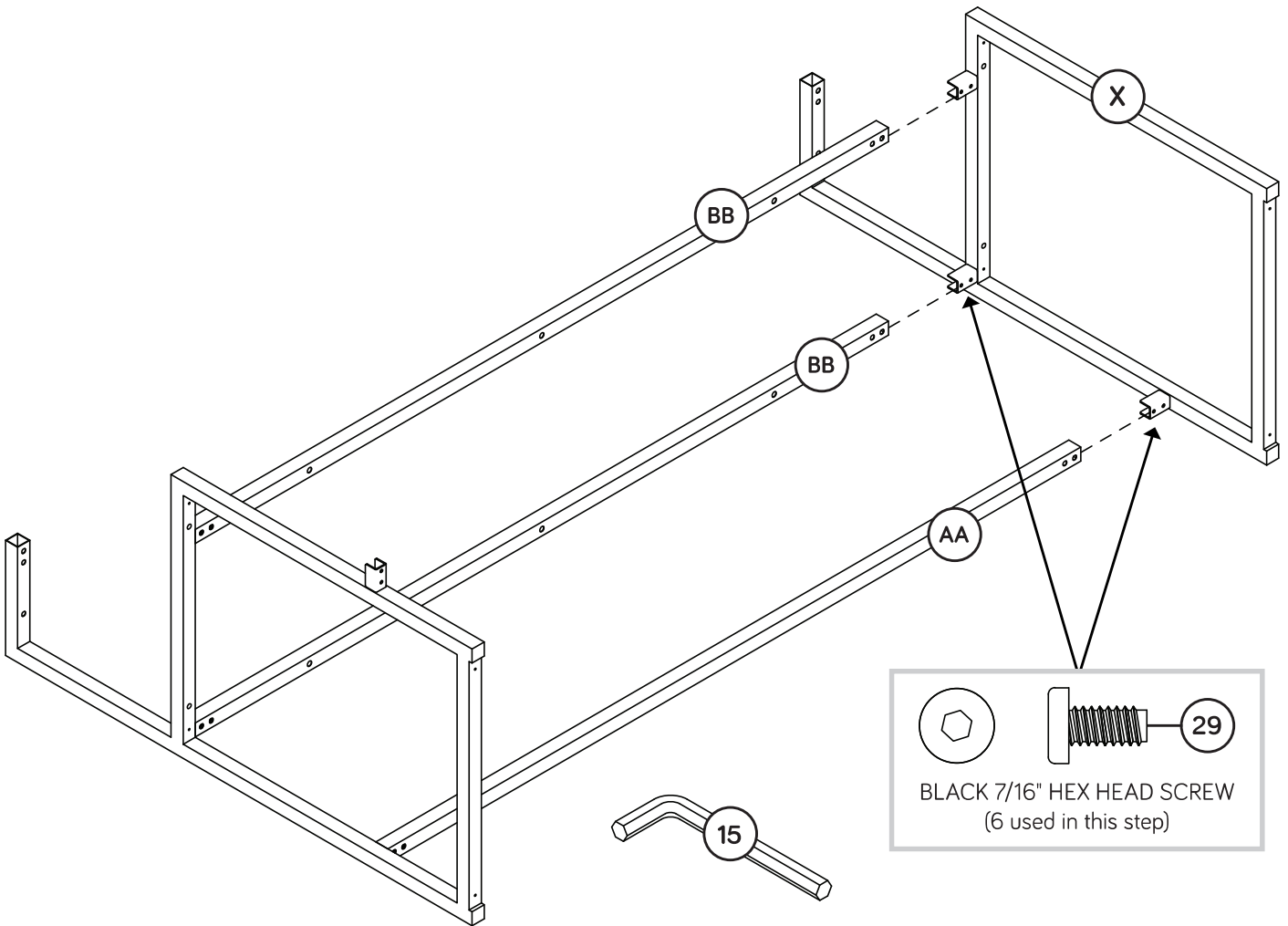

Step 11

- Fasten the HUTCH MOLDING (CC) to the RETURN FRAMES (X and Y). Tighten four BLACK 7/16" HEX HEAD SCREWS (29) using the L-WRENCH (15).
- NOTE:** Position the HUTCH MOLDING (CC) exactly as shown.
- Completely tighten all of the SCREWS in the frame.



Now might be a good time to refresh your drink.

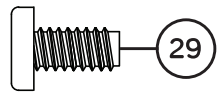

BLACK 7/16" HEX HEAD SCREW
(4 used in this step)

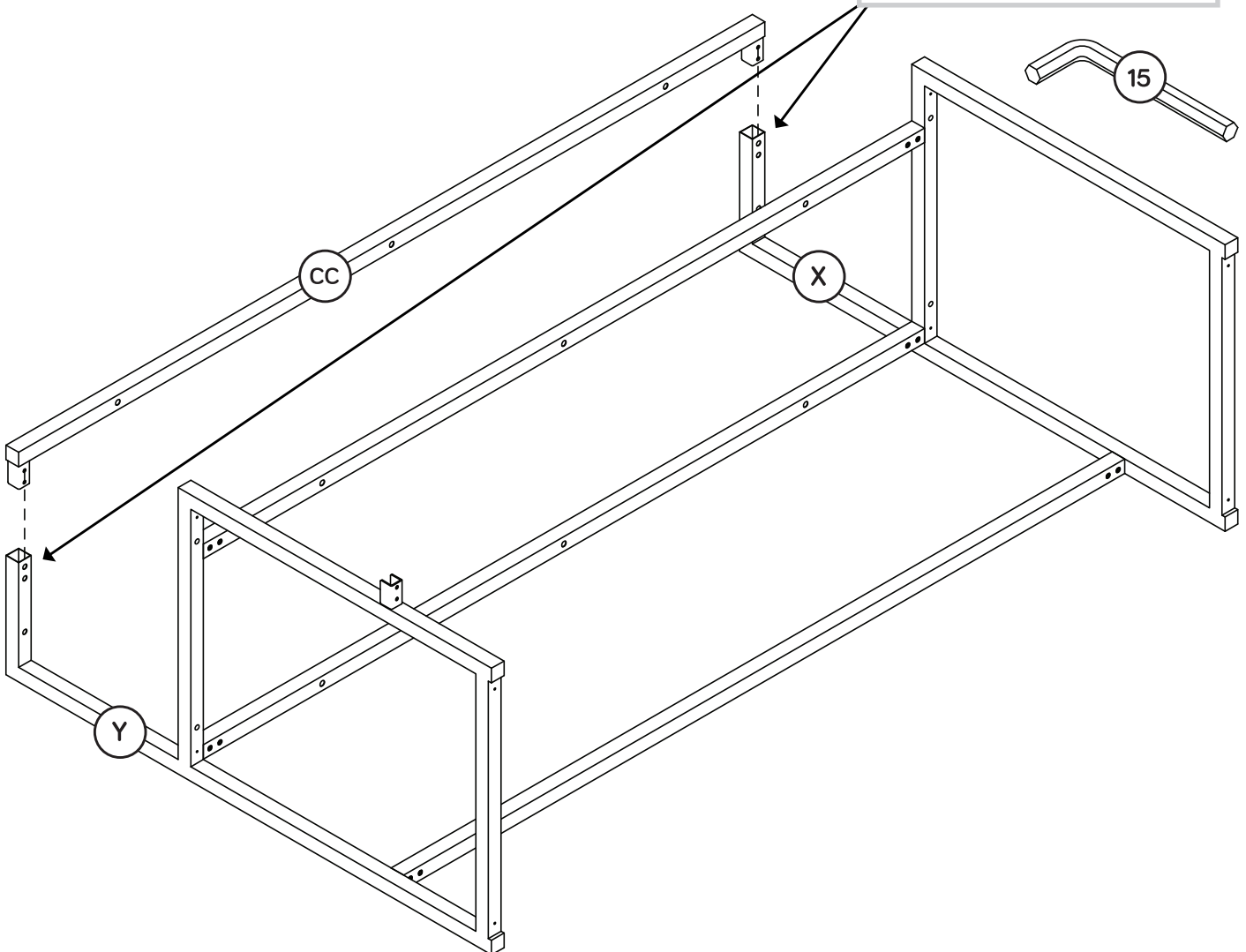

Step 12

Fasten the HUTCH BOTTOM (K) to the RETURN FRAMES (X and Y) and HUTCH MOLDING (CC). Tighten five BLACK 1-3/8" HEX HEAD SCREWS (23) using the L-WRENCH (15).

NOTE: Start each SCREW a few turns before tightening any of them.

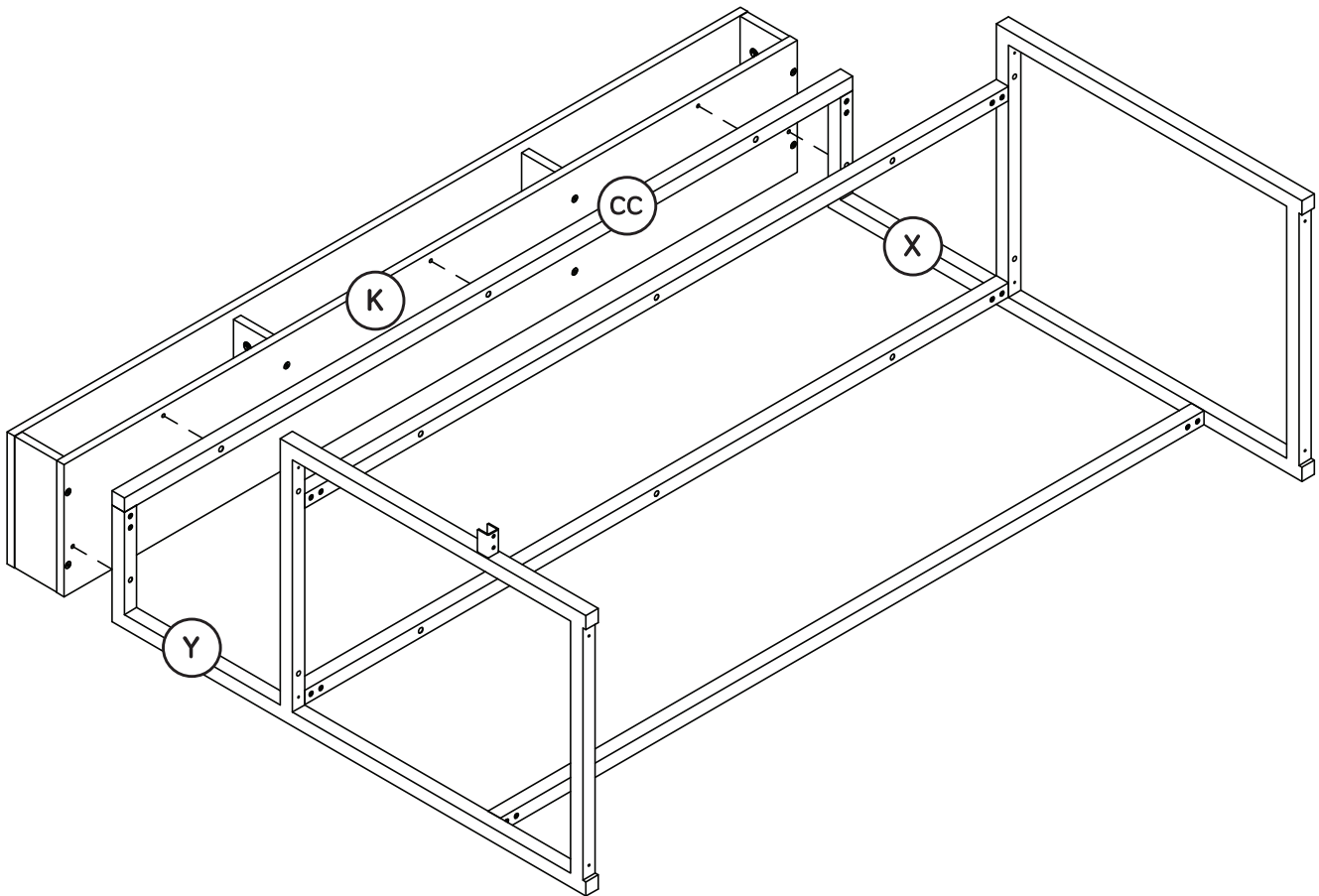
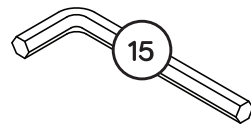
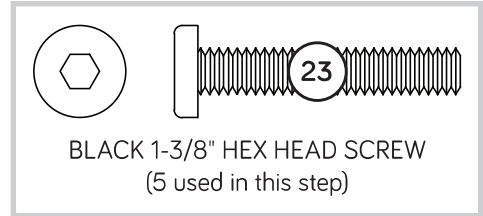

Step 13

Fasten the RETURN TOP (B) to the RETURN FRAMES (X and Y) and UPPER RETURN MOLDINGS (BB). Tighten ten BLACK 1-9/16" HEX HEAD SCREWS (21) using the L-WRENCH (15).

NOTE: Start each SCREW a few turns before tightening any of them.

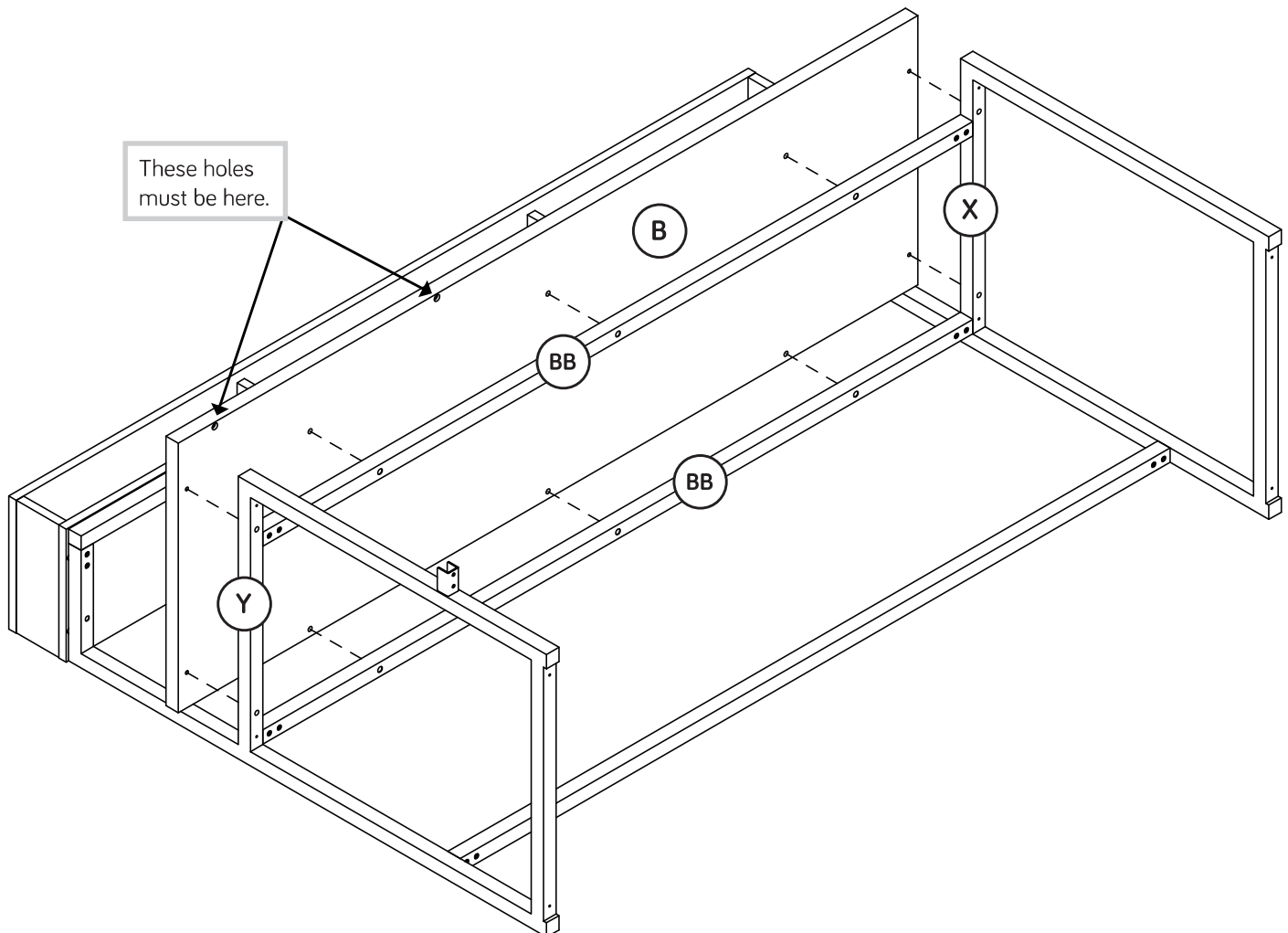
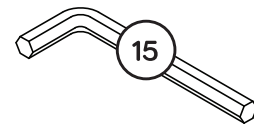
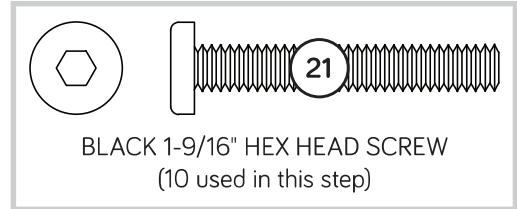

Step 14

- ✚ With someone's help, carefully stand your unit upright.
- ✚ Insert two WOOD DOWELS (9) into the RETURN BACK (J).
- ✚ Fasten the RETURN BACK (J) to the RETURN TOP (B). Tighten four BLACK 1-1/2" HEX HEAD SCREWS (22) using the L-WRENCH (15).
- ✚ **NOTE:** Start each SCREW a few turns before tightening any of them.
- ✚ **NOTE:** Be sure the WOOD DOWELS in the RETURN BACK insert into the RETURN TOP.
- ✚ Insert one GROMMET (12) into the large hole in the RETURN BACK (J).

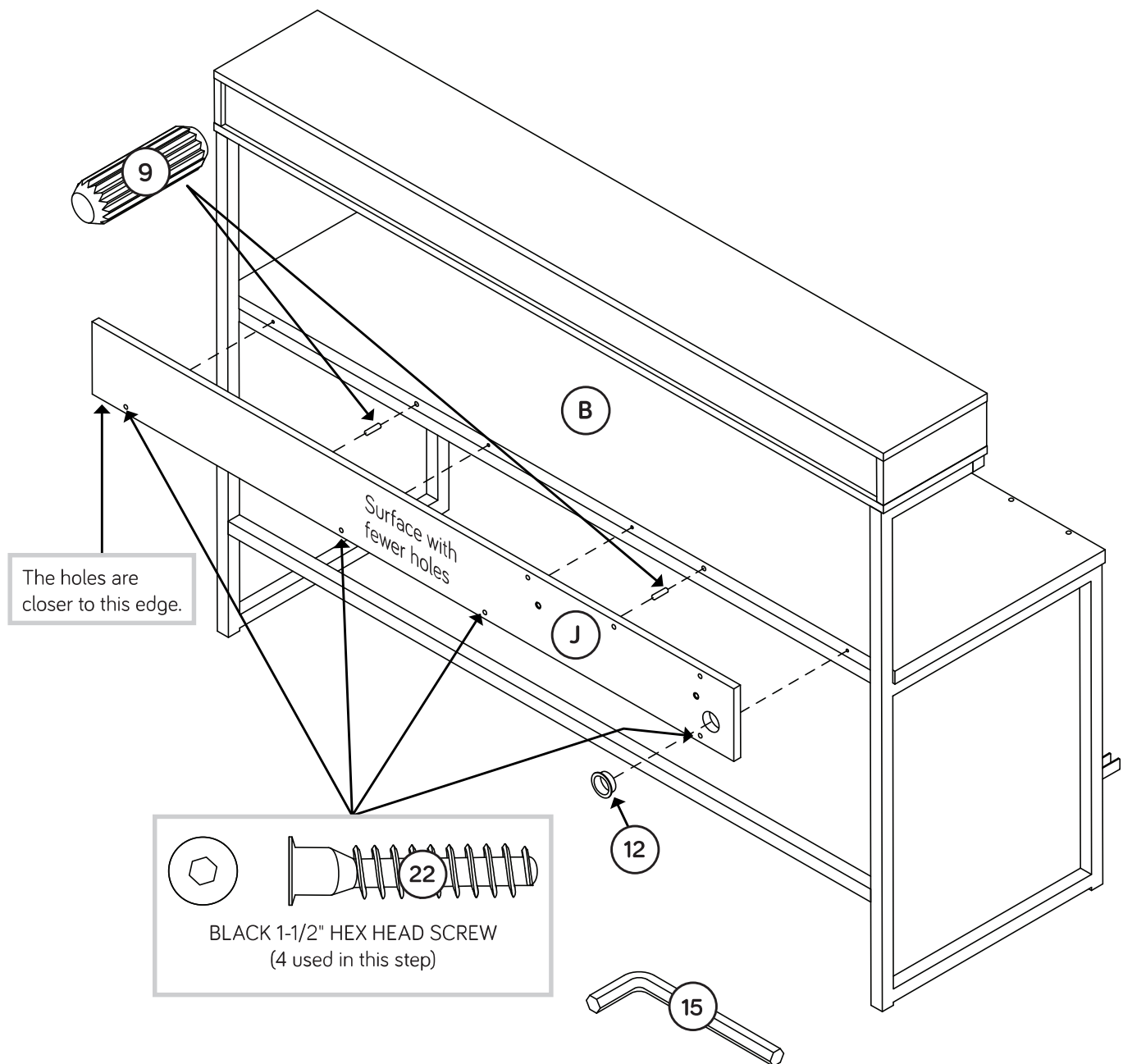

Step 15

- Fasten the LOWER DESK MOLDING (DD) to the DESK FRAME (Z). Tighten two BLACK 7/16" HEX HEAD SCREWS (29) using the L-WRENCH (15).
- Fasten the LOWER DESK MOLDING (DD) to the LEFT RETURN FRAME (Y). Tighten two BLACK 7/16" HEX HEAD SCREWS (29) using the L-WRENCH (15).

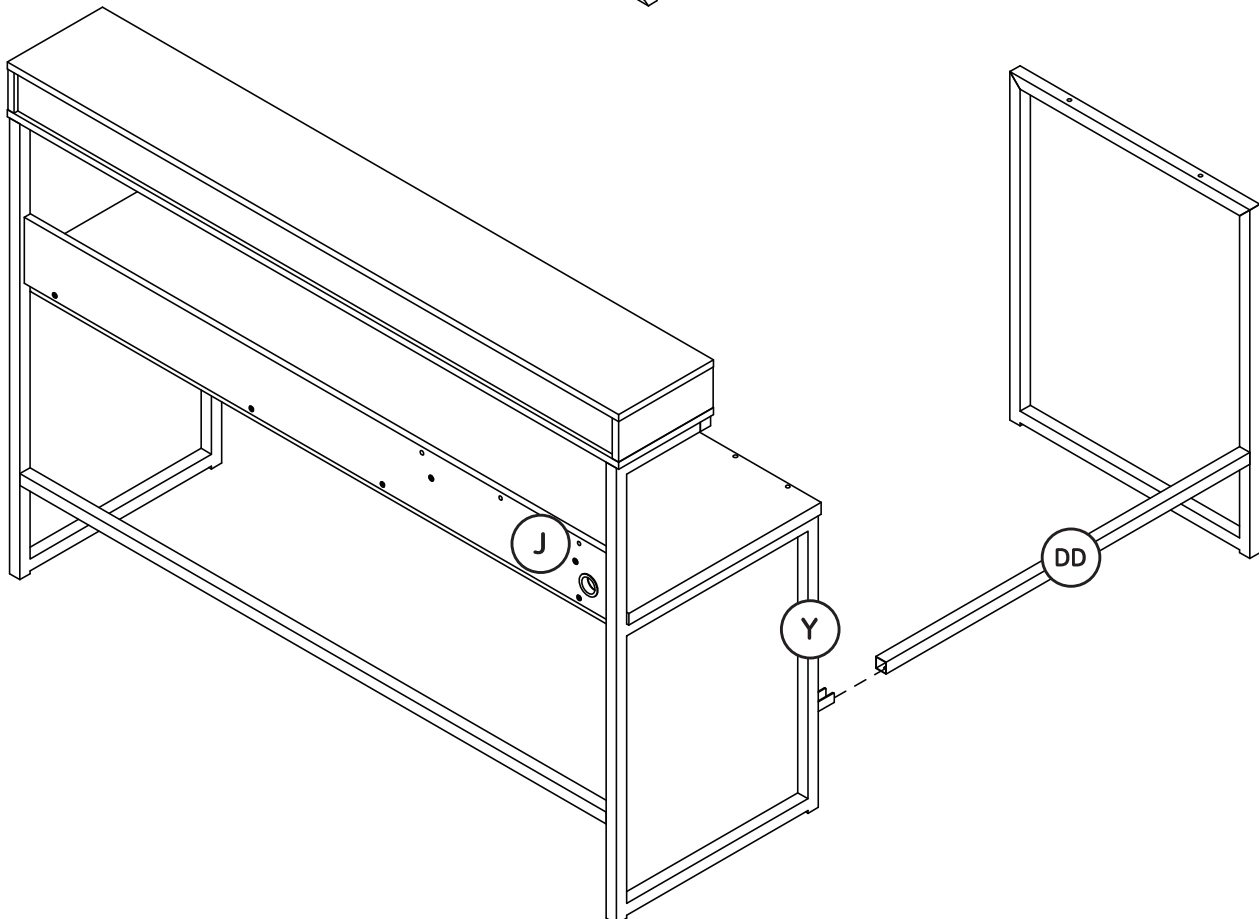
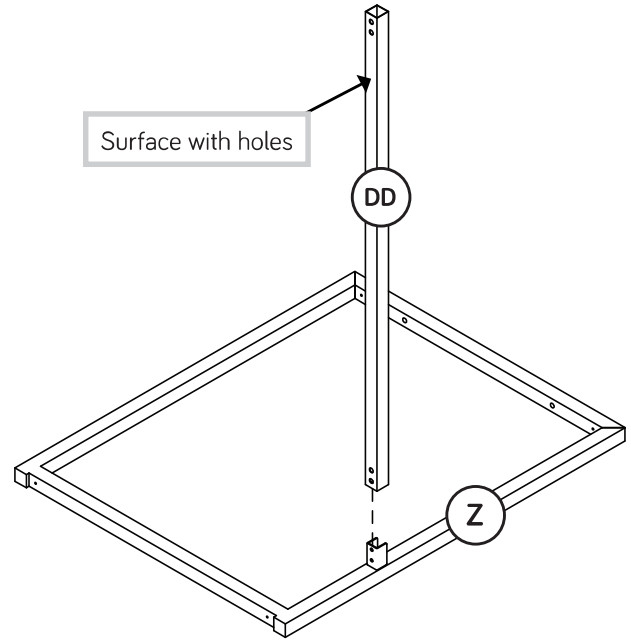
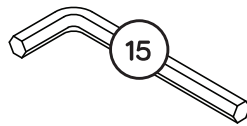
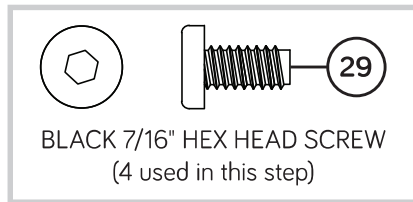

Step 16

- ✚ **NOTE:** You may need someone's help in this step.
- ✚ Insert two WOOD DOWELS (9) into the RETURN TOP (B).
- ✚ Position the DESK TOP (A) into place so the UPRIGHT (G) sits down onto the WOOD DOWELS in the RETURN TOP.
- ✚ Fasten the UPRIGHT (G) to the RETURN TOP (B). Tighten two BLACK 1-7/8" HEX HEAD SCREWS (20) using the L-WRENCH (15).
- ✚ Fasten the DESK TOP (A) to the DESK FRAME (Z). Tighten two BLACK 1-3/8" TAPERED MACHINE SCREWS (25) using the L-WRENCH (15).

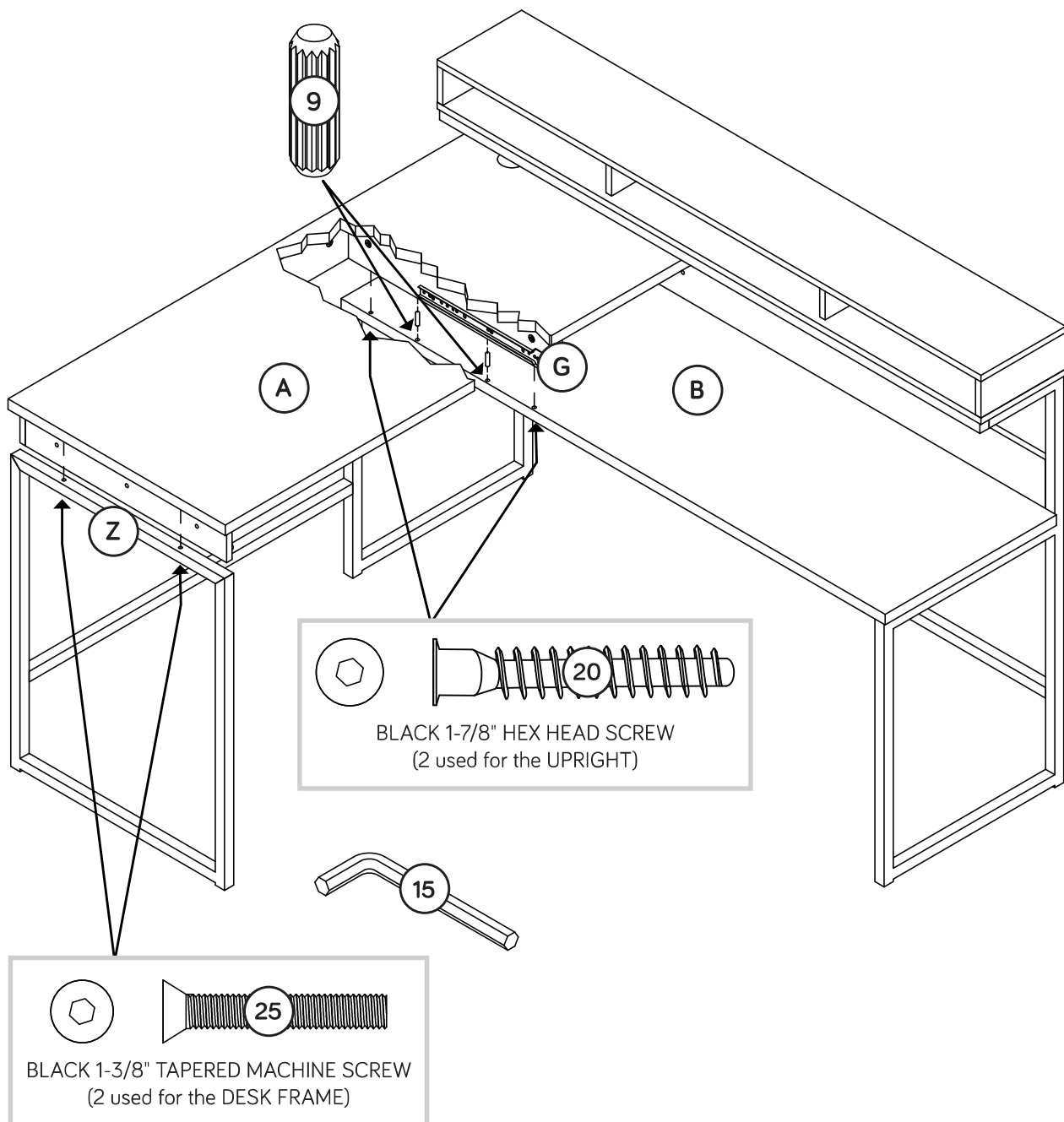

Step 17

- ✚ Fasten the RETURN BACK (J) to the DESK TOP (A).
Tighten three BLACK 1-1/2" HEX HEAD SCREWS (22) using the L-WRENCH (15).
- ✚ Fasten the RETURN BACK (J) to the RIGHT END (H).
Tighten two BLACK 1" TAPERED MACHINE SCREWS (26) using the L-WRENCH (15).

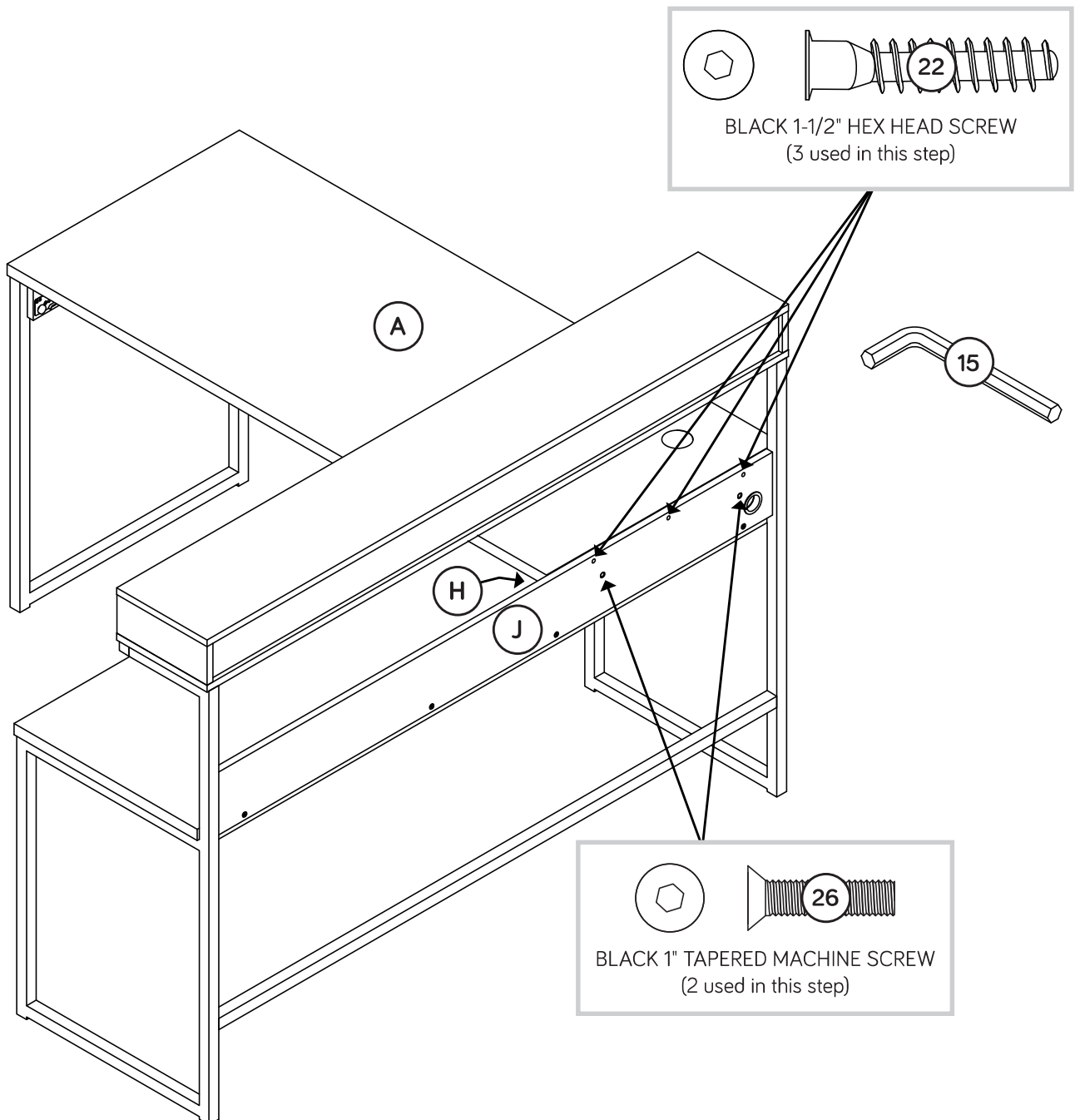

Step 18

- Fasten the END MOLDING (C) to the LEFT END (D). Tighten three BLACK 1" TAPERED MACHINE SCREWS (26) using the L-WRENCH (15).



Almost time to celebrate! With a nap.

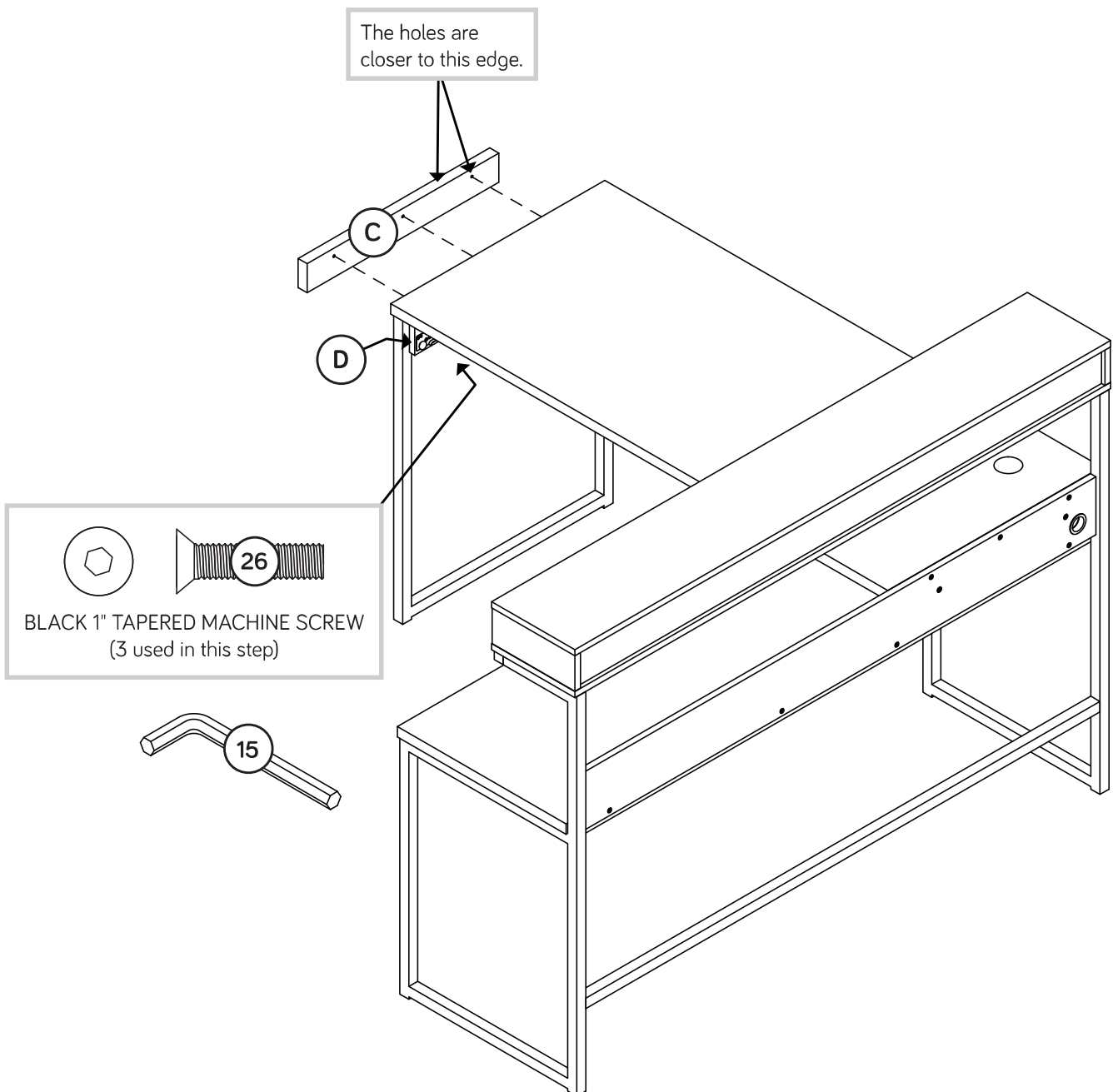

Step 19

- Turn eight SMALL CAM SCREWS (8) into the DRAWER FRONT (R).
- Push eight SMALL HIDDEN CAMS (7) into the DRAWER SIDES (S and T) and DRAWER BRACES (W).

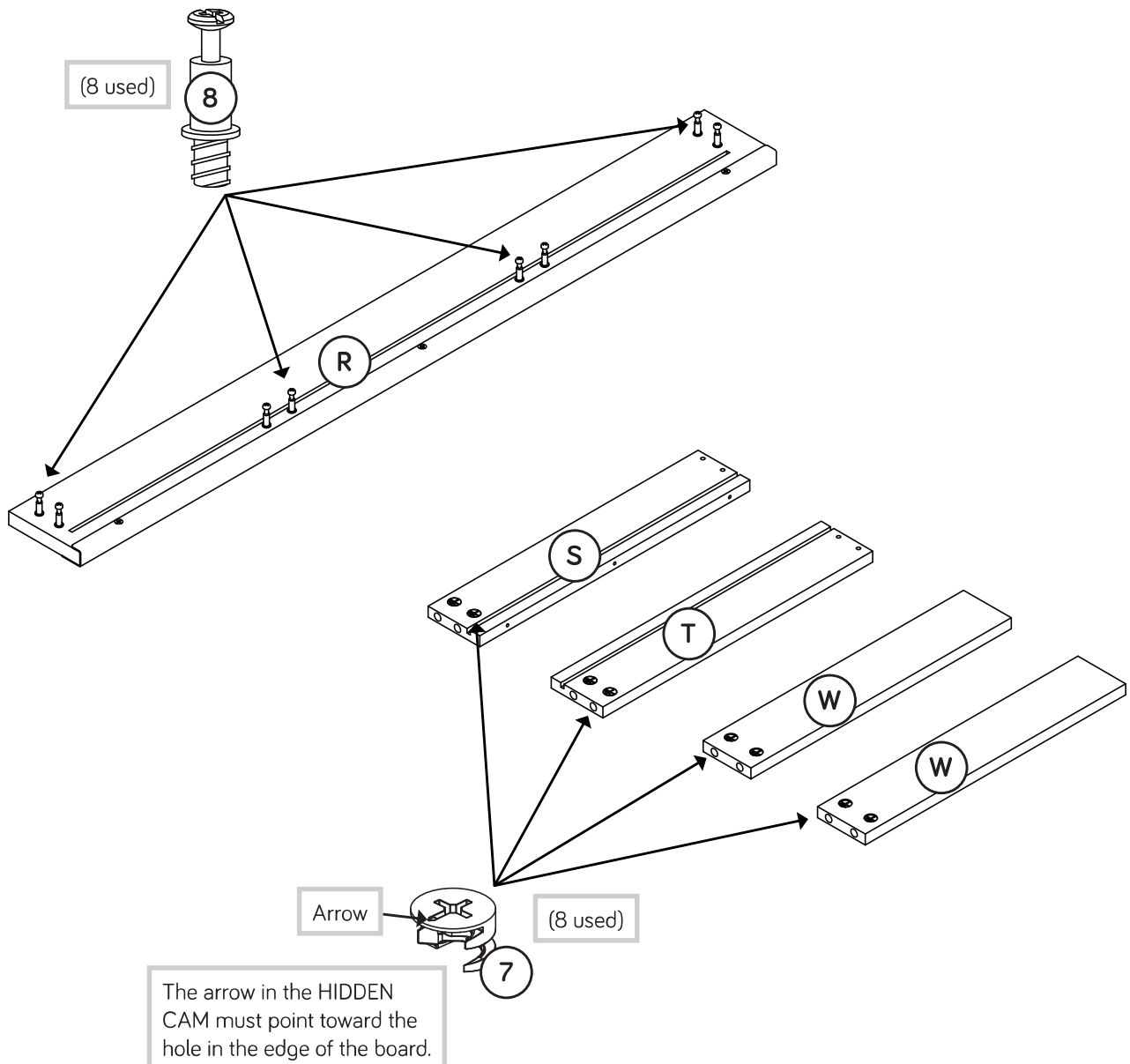
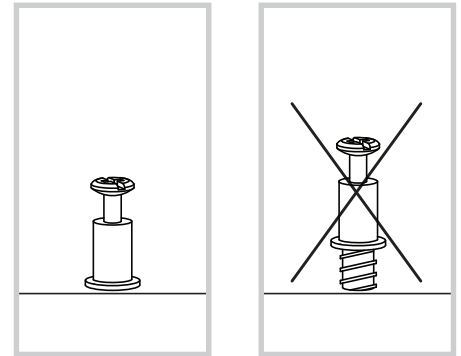

Step 20

1

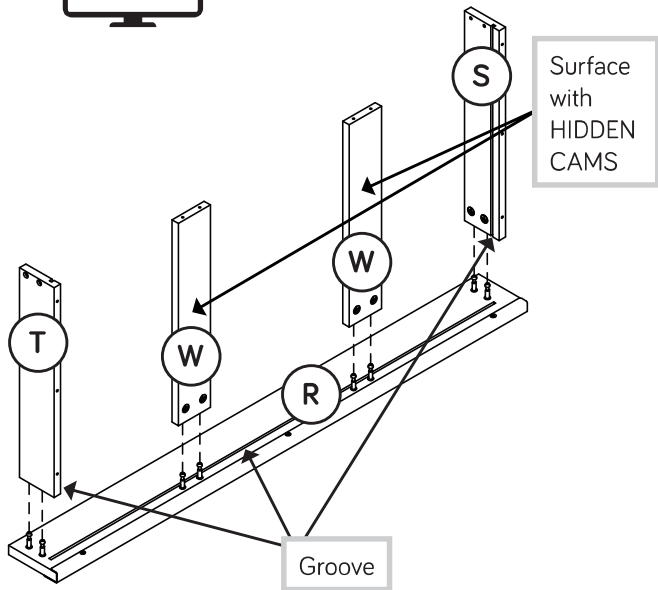

- Fasten the DRAWER SIDES (S and T) and DRAWER BRACES (W) to the DRAWER FRONT (R). Tighten eight HIDDEN CAMS.

2

With the palm of your hand, tap the DRAWER BOTTOM down into the groove.

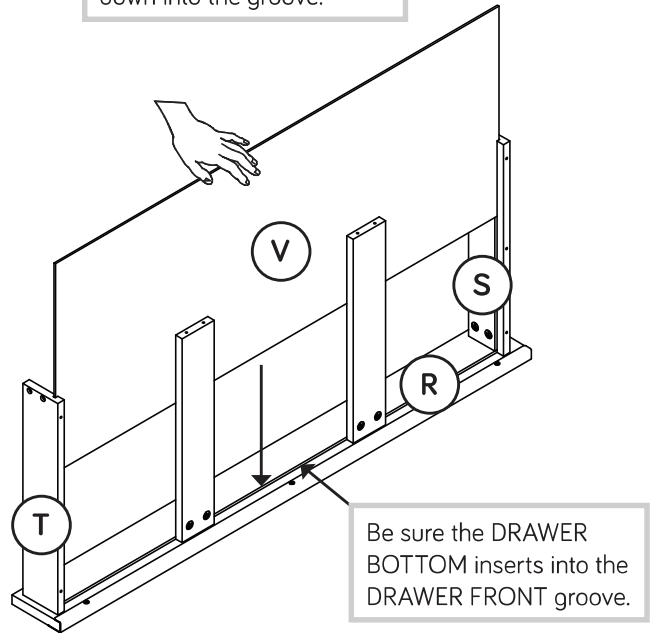

- Slide the DRAWER BOTTOM (V) into the grooves in the DRAWER SIDES (S and T) and DRAWER FRONT (R).

3

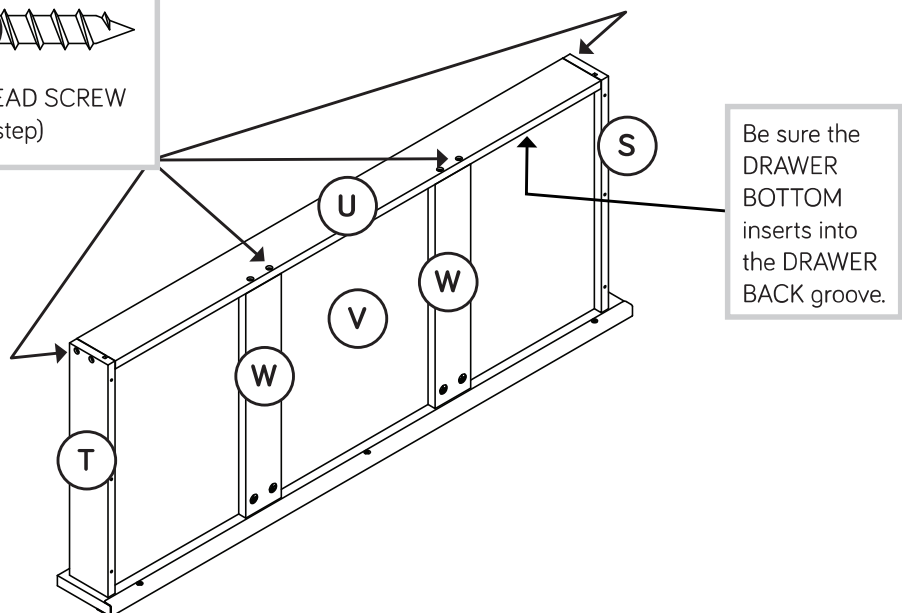
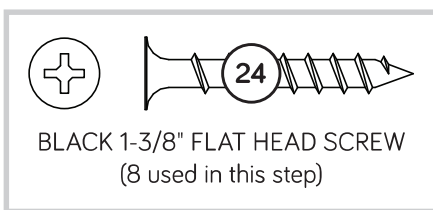

- Fasten the DRAWER BACK (U) to the DRAWER SIDES (S and T) and DRAWER BRACES (W). Use eight BLACK 1-3/8" FLAT HEAD SCREWS (24).

NOTE: Be sure the DRAWER BOTTOM (V) inserts into the groove of the DRAWER BACK (U)

Step 21

- Fasten the DRAWER RIGHT (3) to the RIGHT DRAWER SIDE (T). Use three BLACK 1/2" FLAT HEAD SCREWS (28).
- Fasten the DRAWER LEFT (4) to the LEFT DRAWER SIDE (S). Use three BLACK 1/2" FLAT HEAD SCREWS (28).

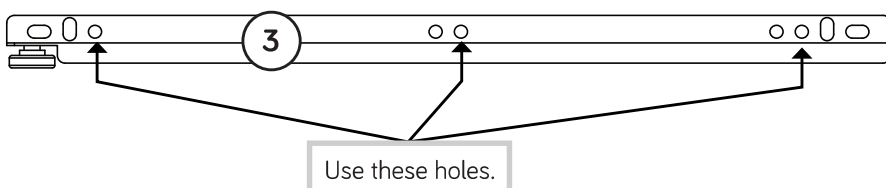
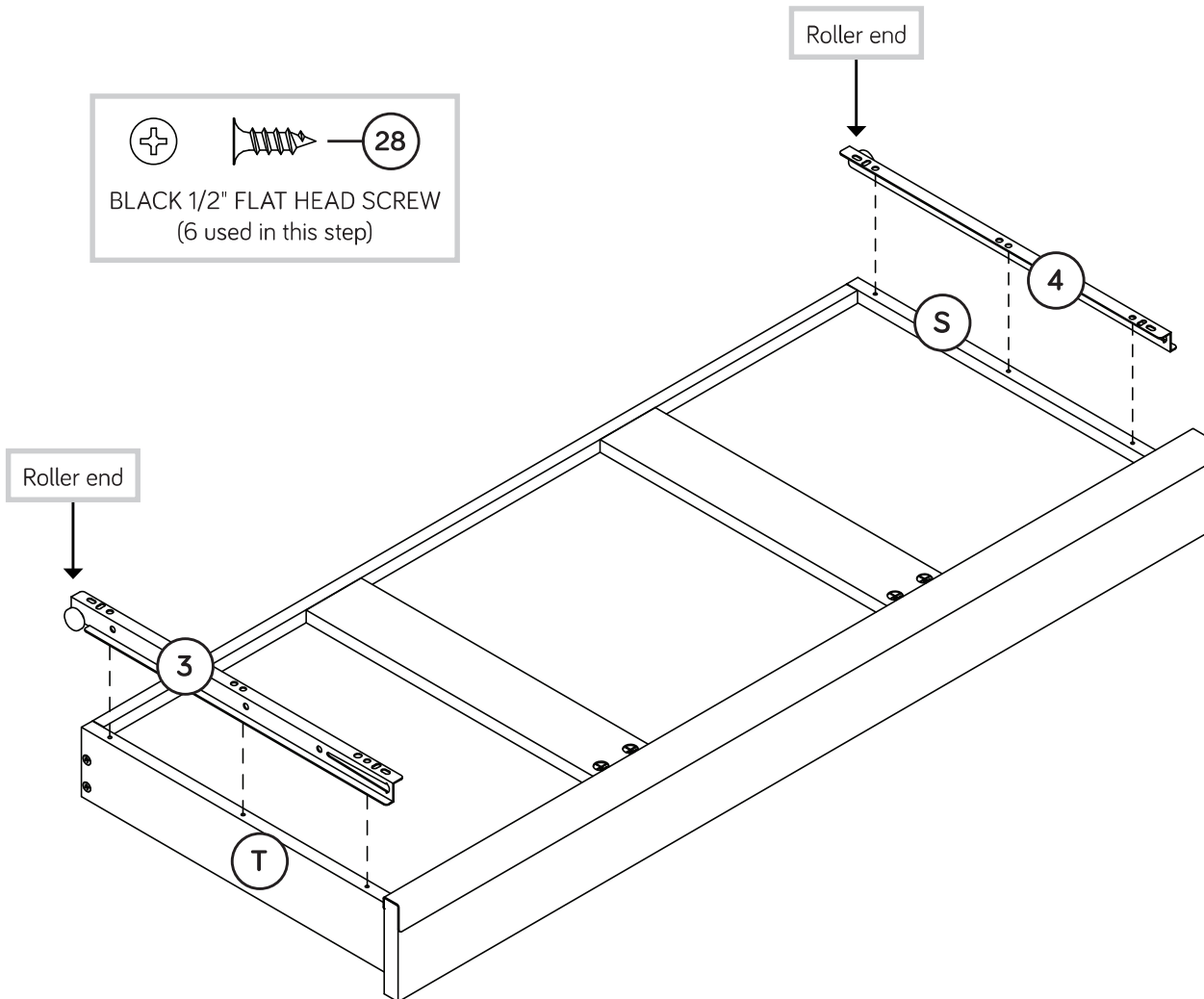
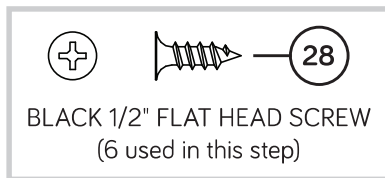
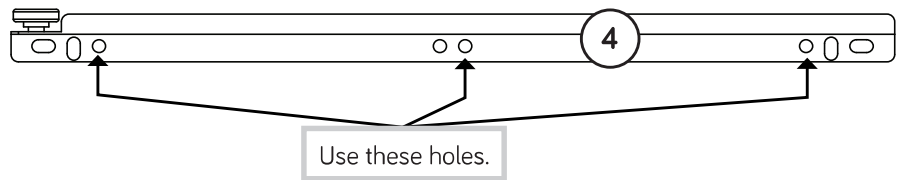

Step 22

- ✚ Insert the GROMMET WITH CAP (14) into the large hole in the DESK TOP (A).
- ✚ To insert the drawer into your unit, tip the front of the drawer down and drop the rollers on the drawer behind the rollers on the unit. Lift the front of the drawer up and slide it into the unit.
- ✚ Peel APPLIQUES from the APPLIQUE CARD (13) and stick them onto each visible HIDDEN CAM / SCREW head.
- ✚ NOTE: Please read the back pages of the instruction booklet for important safety information.
- ✚ This completes assembly. Clean with a damp cloth. Wipe dry.

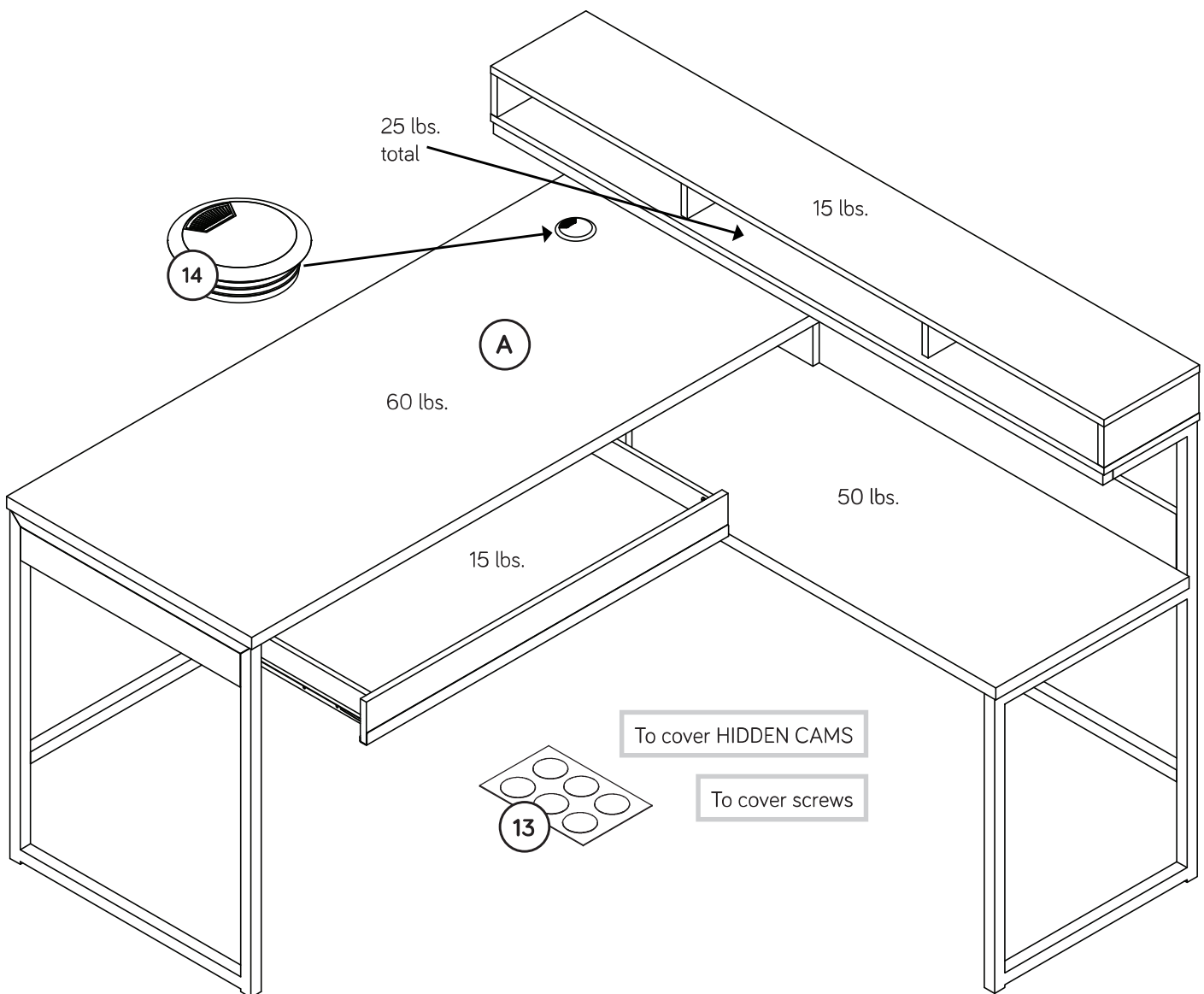

⚠ WARNING

Please use your furniture correctly and safely. Improper use can cause safety hazards, or damage to your furniture or household items. **Carefully read the following chart.**

Look out for:	What can happen:	How to avoid the problem:
<ul style="list-style-type: none">• Overloaded shelves or drawers.• Improper loading can cause the product to be top-heavy.	<ul style="list-style-type: none">• Risk of injury.• Top-heavy furniture can tip over.• Overloaded shelves and drawers can break.	<ul style="list-style-type: none">• Never exceed the weight limits shown in the instructions.• Work from bottom to top when loading shelves and drawers. Place the heavier items on the lower shelves or in lower drawers.
<ul style="list-style-type: none">• Improperly moving furniture that is not designed and equipped with casters.	<ul style="list-style-type: none">• Furniture can tip over or break if improperly moved.• Physical injury. Furniture can be very heavy.• Breakage of tops - particularly with double pedestal furniture (drawers at both ends).	<ul style="list-style-type: none">• Unload shelves and drawers from top to bottom before moving the unit.• Do not push furniture, especially on a carpeted floor. Have a friend help you lift the item and set it in place.• Provide support to the center section of the top when lifting the furniture.
<ul style="list-style-type: none">• Placing TVs on furniture items that are not designed to support a television is hazardous.	<ul style="list-style-type: none">• Risk of injury or death. TVs can be very heavy. Plus the weight and location of the picture tube tends to make TVs unbalanced and prone to tipping forward.	<ul style="list-style-type: none">• This product is not designed to support a television.