

Product Content

1.1, 1 x Rail

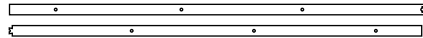

2.1, 4 x Hnager

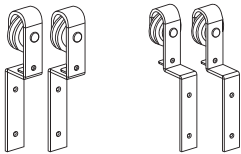

A

B

2.2, 8 x 2³/₈" Door Screw



2.3, 8 x 2" Door Screw



3.1, 7 x Wall Spacer



3.2, 7 x Anchor
(For concrete wall)



3.3, 7 x Lag Bolt
(For wood wall)

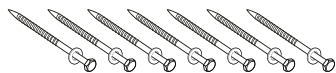

4.1, 2 x Hex Key



4.2, 1 x Floor Guide

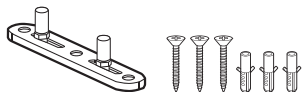

4.3, 2 x Door Stopper

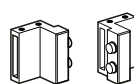

Tools Needed

1, Pencil



2, Phillips Screwdriver



3, Drill Bit



4, Tape



5, Wrench



6, Plumb Bob



7, Level



8, Drill



Measurements

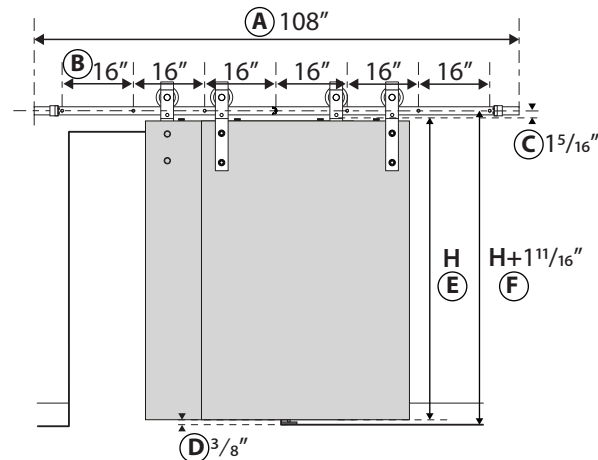

A Overall track length is 108".

B Gap between each pre-drilled hole is 16".

C Distance from door top side to track holes is 1⁵/₁₆".

D Distance from bottom of the door to the floor is ³/₈".

E Door height is H.

F Height of holes for track on the wall is H + 1¹¹/₁₆".

Instructions

It is very important to determine whether you will be installing a Header Board prior to installing the track.

Due to many overlapping factors such as the location of wall studs (Our rail come with pre-drilled holes every 16" on center), the weight of a barn door and the various types of trim used in homes, we recommend using a Header Board in all situations.

Please install a 1" x 4" or 1" x 6" Header Board above the door opening directly into studs.

Header Board must be solid wood and measure at least the full length of the track or longer.

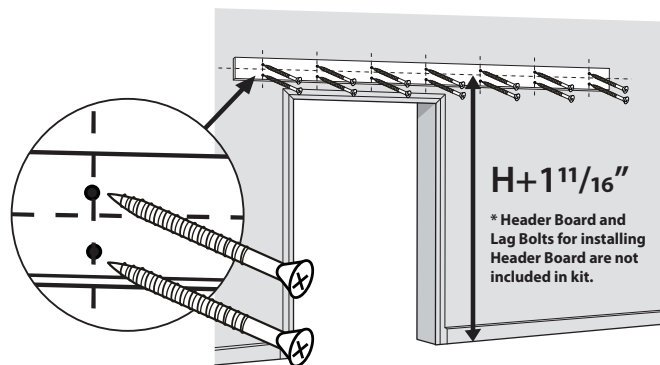

1 Place the rail against the wall, and use a pencil to mark where the holes should be. Make sure the height of holes on the wall is H + 1¹¹/₁₆".

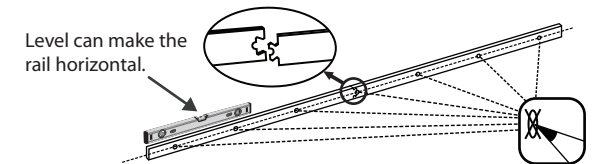

2 We provide 2 kinds of screws for you to install rail onto concrete wall or drywall.

A Concrete wall Installation.

Install the anchor to holes on the concrete wall first, then install carriage bolt to anchor.

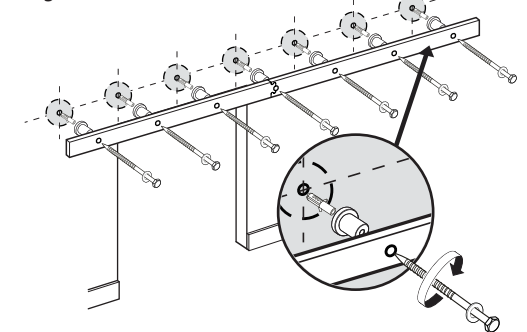

B Drywall Installation.

Install the lag bolt to wood stud or head board directly.

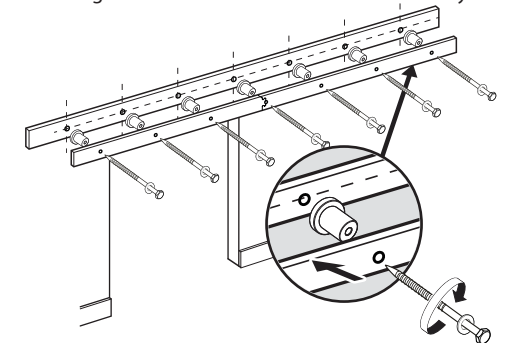

3 Insert door stoppers into rail. Install door stoppers between A-B and C-D. Door stopper is used to prevent the hangers coming out of the rail.

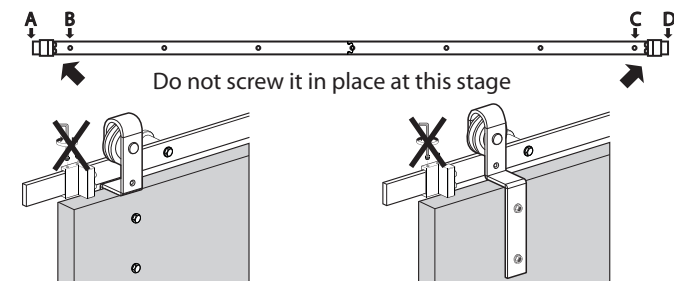

- ④ Use router or circular saw to create a kerf at bottom of the door, along the center to allow the tip of the T-shaped floor guide to fit in between, to keep your door stable and prevent the door bottom swinging back and forth when you slide it open and closed.

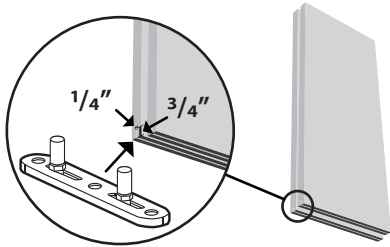

- ⑤ Install the hangers onto the door according to the measurement in the pictures below. Before doing this, remove the anti-bouncer from the pulley. Maximum door thickness is $2\frac{3}{8}$ ". If your door's thickness is less than 2", please use the short door bolts (2"). If your door's thickness is more than 2" and less than $2\frac{3}{8}$ ", use the long door bolts ($2\frac{3}{8}$ ").

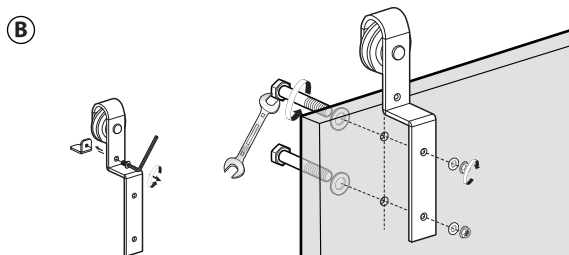
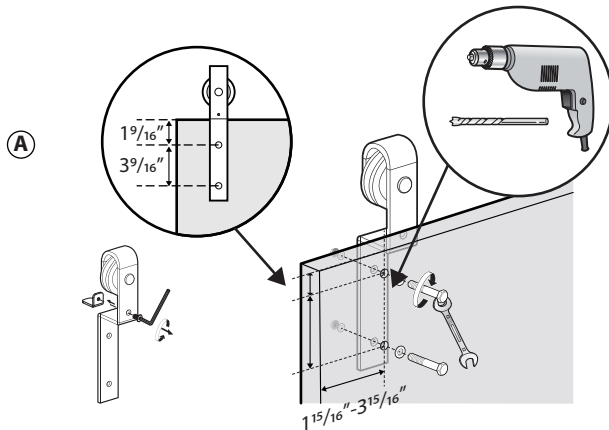

- ⑥ Hang the door over the rail

Ⓐ Put the pulley (A) on the track first.

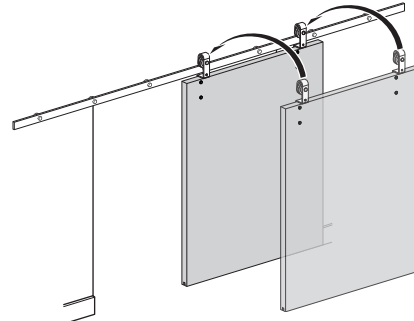

Ⓑ Next, Put pulley B on the track, so that the pulley B and pulley A cross. As shown in the figure below.

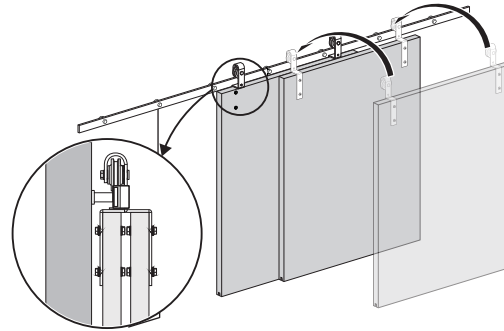

- ⑦ As shown in the figure, after all the pulley blocks are connected to the track, the anti-bouncer are fixed with hexagonal screw rod.

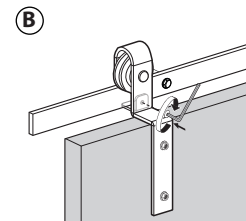
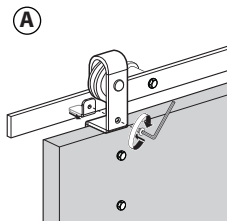

- ⑧ Adjust the 2 door stoppers to find a suitable position, Use the hex key to screw the door stoppers in place.

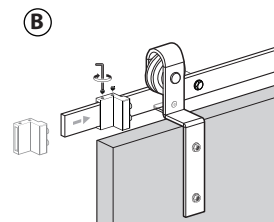
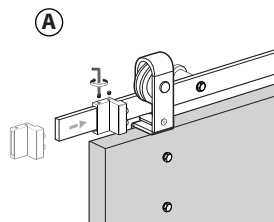

- ⑨ Install the floor guide. Put floor guide on the floor first to fix a suitable position and make a mark so that the tip of the floor guide can work well in the slot. Use suitable drill bit to drill holes on the floor where the mark is, and then install the floor guide.

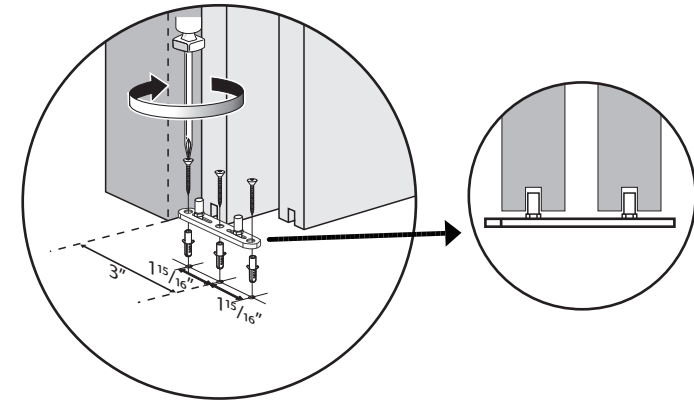

Sliding Door Hardware Manual

(Bypass 9.0ft)