

Bifold Door Installation Guide

Including(2 Door Set) For 4 Door Set: Refer to Page 8-14

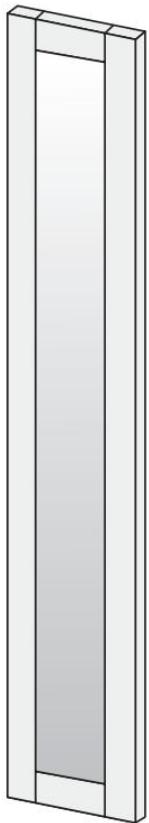

(2) Door Panel

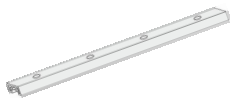

Track x 1

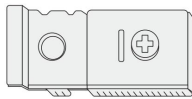

Top Pivot Bracket x 1

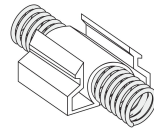

Snugger x 1

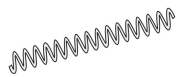

Spring x 1

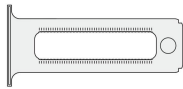

Jamb Bracket x 1

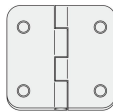

Hinge x 3



Guide Roller x 1



Top Pivot x 1

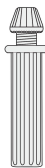

Bottom Pivot x 1

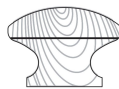

Pull x 1



Machine Screw x 1
(Pull)

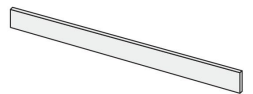

Fascia x 1



Fascia Block x 1
(for 4-Door installation)

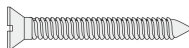

Long Screw x 8



Short Screw x 12

Tools Required:

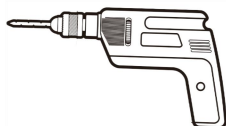

Driller



Measuring Tape



Pencil

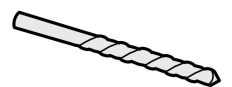

1/8" Drill Bit
3/16" Drill Bit

Preparation

In case of questions or missing parts, please contact
Dooraftersale@gmail.com



Scan this QR code to access the installation video

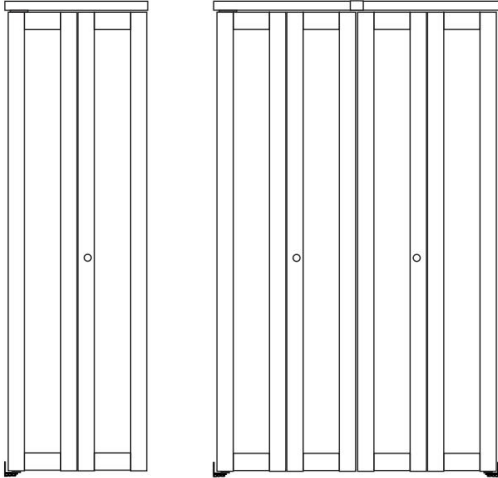

2-Door Set

4-Door Set



**2 PERSONS
ASSEMBLY**



**UP TO 30MIN
ASSEMBLY**

Note:

- Wear Safety Goggles
 - Dimensions are in inches
Millimeters are shown in brackets
 - Fits normal finished opening height of 80 1/2"
 - 2-Door and 4-Door Installation below.
- For 4-Door Installations, 2(two) 2-Door sets will need to be purchased

Track Installation

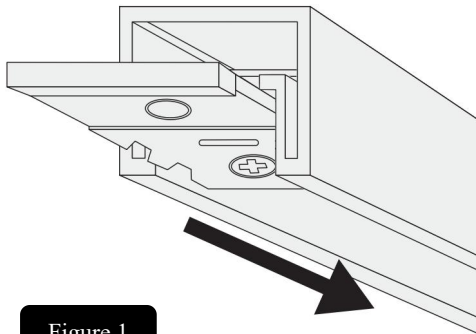

Figure 1

Step 1: Insert top pivot bracket into track as shown (Figure 1).

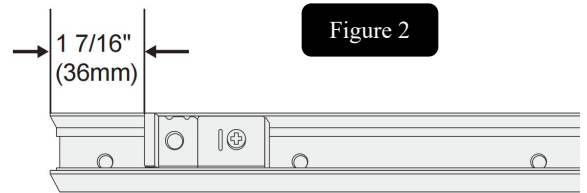

Figure 2

Step 2: Secure top pivot bracket as shown (Figure 2). The distance from the edge of top pivot bracket to the edge of track should be 1 7/16" (36 mm).

Note: Verify continuous parallel alignment during mounting.

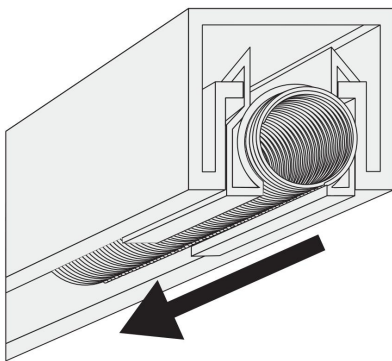

Figure 3

Step 3: Insert guide roller into the other end of track as shown (Figure 3).

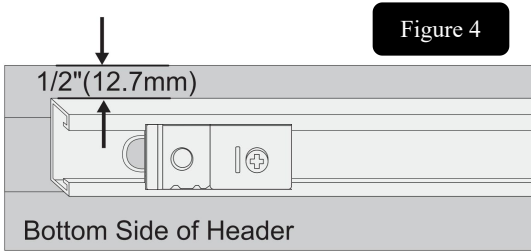

Figure 4

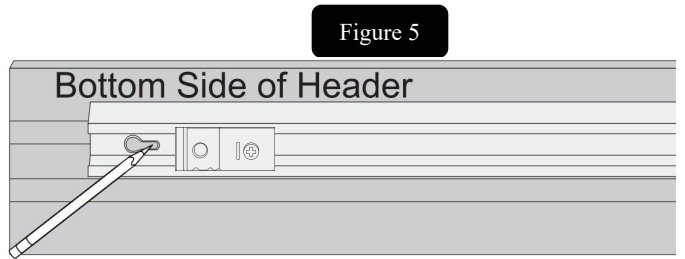

Figure 5

Step 5: Install track onto the header as shown (Figure 4). The distance from track to the header edge should be 1/2" (12.7mm) as shown.

Note: If it is a left swing door, keep the left end of track tight against the left side jamb, vice versa.

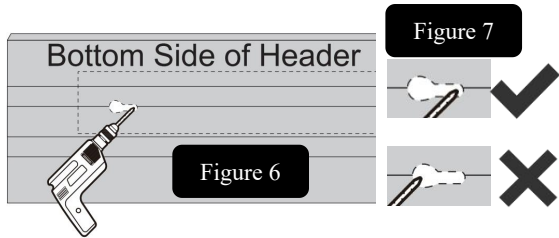

Figure 7

Figure 6

Step 7: Predrill 4 pilot holes on the header using 1/8" drill bit (Figure 6). **Note:** Predrill the holes on the retention slot. Do not predrill the holes on clearance hole (Figure 7).

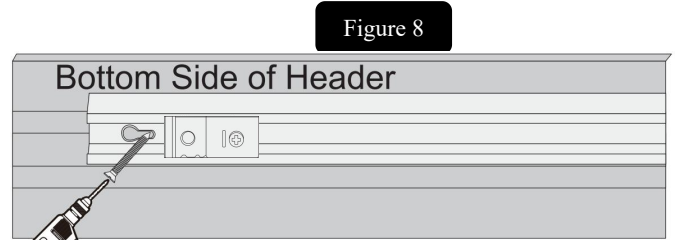

Figure 8

Step 8: Fasten track to the header using long screws (Figure 8).

Lower Jamb Pivot Installation

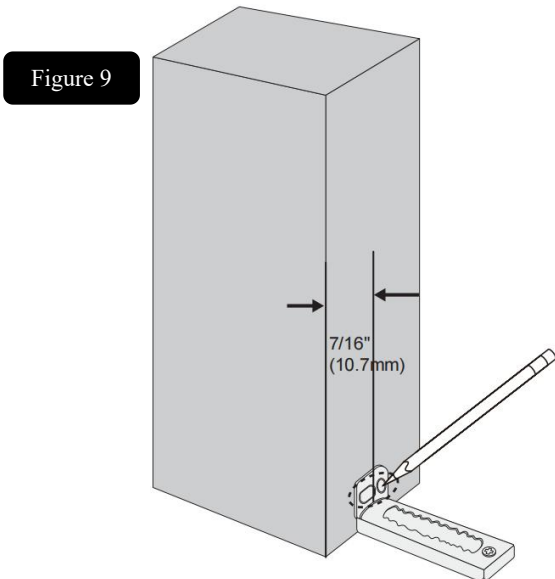

Figure 9

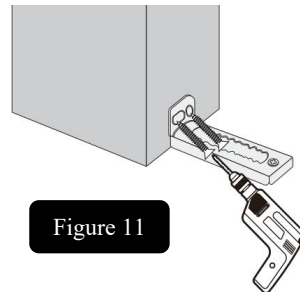

Figure 10

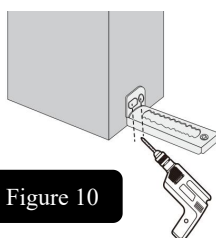

Figure 11

- **Step 1:** Place jamb bracket right under top pivot bracket, tight to the floor. The distance from jamb bracket to the edge of the jamb should be 7/16" (10.7mm) as shown (Figure 9). Use a pencil to mark the 2 places where holes are to be drilled as shown (Figure 9).
- **Step 2:** Predrill the marked places using 1/8" drill bit (Figure 10).
- **Step 3:** Fasten jamb bracket to jamb using long screws as shown (Figure 11).

Hinge Installation

Note: The side with predrilled holes is the back side of the door.

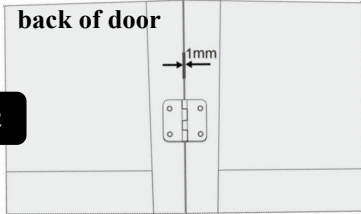

Figure 12

Step 1: Place door panels flat on a platform with the back side facing up. Maintain a "1 mm" gap between the door panels as shown to ensure proper opening and closing (Figure 12).

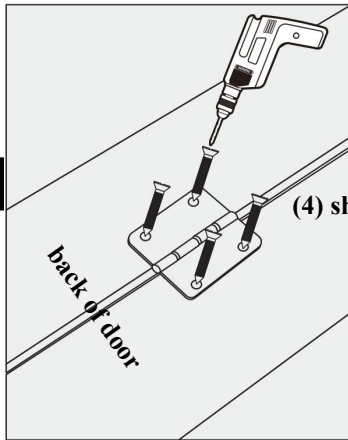
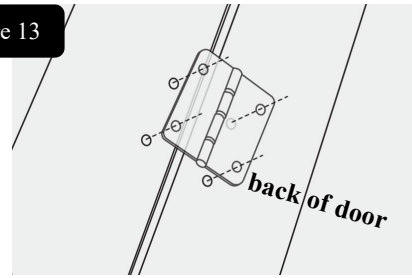

Figure 14

Step 3: Fasten the hinge to the door using short screws (Figure 14).

Figure 13



Step 2: Attach the hinge onto the top of the door as shown, aligning the holes on the hinge with the predrilled holes on the door (Figure 13).

Step 4: Install the rest two hinges using the same way.

Door Brackets Installation

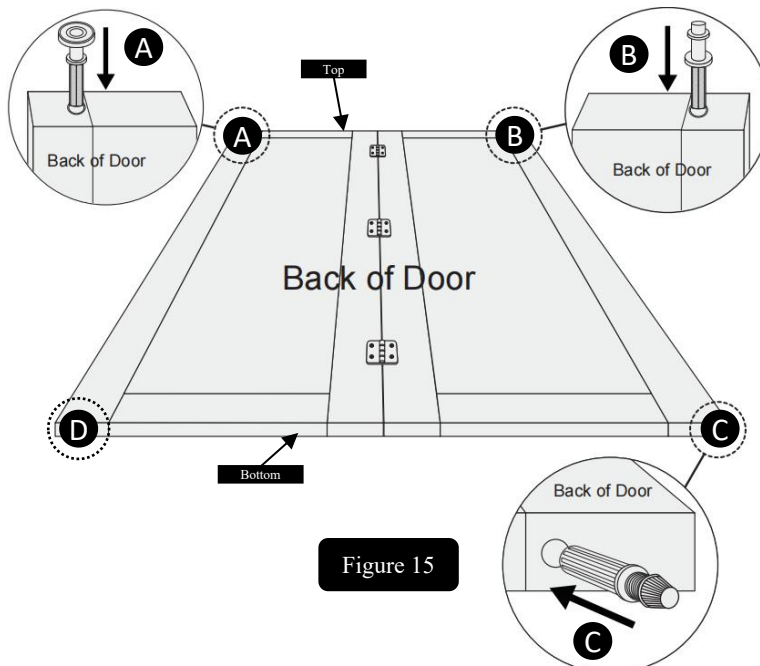

Figure 15

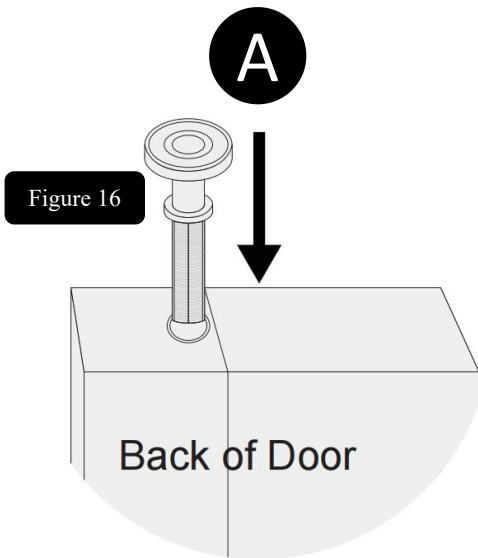

Figure 16

Top Left Corner "A" - Back View

1. Determine whether your door is a left swing or right swing door.
2. If it is a **left** swing door, install **guide roller** on the upper left corner "A" of the back side of the door by inserting it into the predrilled hole (Figure 15 & Figure 16).
3. If it is a **right** swing door, install **upper pivot** instead.

Detailed mounting information can be found in Table 1 & Table 2 on the following page.

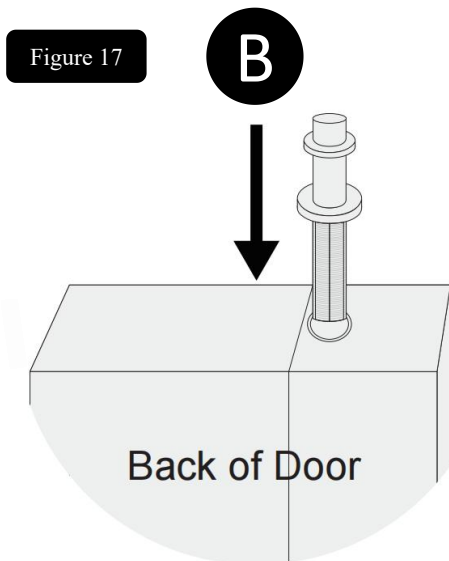

Figure 17

Top Right Corner "B" - Back View

1. If your door is a **left** swing door, install **upper pivot** on the upper right corner "B" of the back side of the door (Figure 15 & Figure 17).
2. If your door is a **right** swing door, install **guide roller** instead.

Detailed mounting information can be found in Table 1 & Table 2 on the following page.

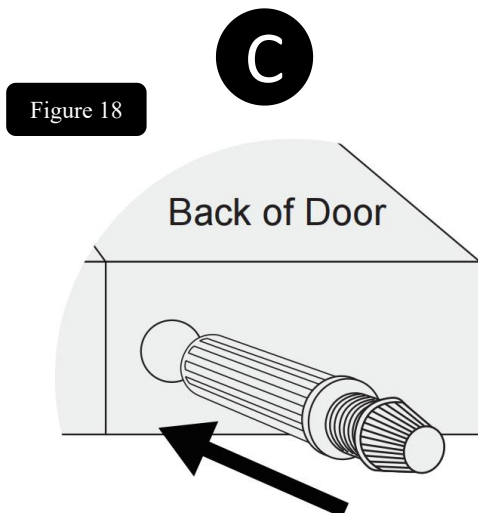

Figure 18

Bottom Left/Right Corner "C" / "D" - Back View

1. If your door is a **left** swing door, install **bottom pivot** on the bottom right corner "C" of the back side of the door (Figure 15 & Figure 18).
2. If your door is a **right** swing door, install **bottom pivot** on the bottom left corner "D" of the back side of the door.

Detailed mounting information can be found in Table 1 & Table 2 on the following page.

Table 1

Left Swing / Back View				
	Top Left	Top Right	Bottom Left	Bottom Right
Required Hardware	guide roller	Top Pivot	/	Bottom Pivot

Table 2

Right Swing / Back View				
	Top Left	Top Right	Bottom Left	Bottom Right
Required Hardware	Top Pivot	guide roller	Bottom Pivot	/

Door Installation

Figure 19

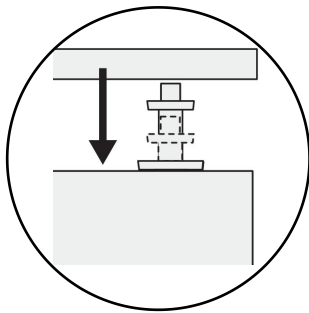

Step 1: Insert top pivot into the hole of top pivot bracket by depressing the top pivot.

Step 2: Lift the door and place bottom pivot into jamb bracket.

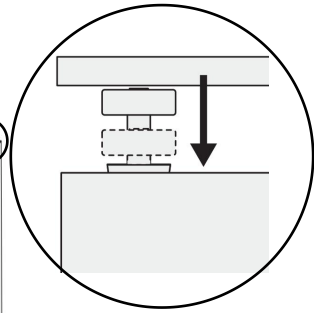
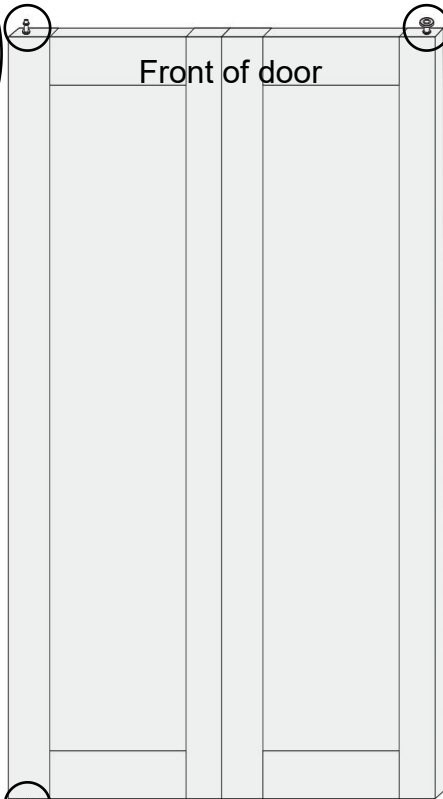
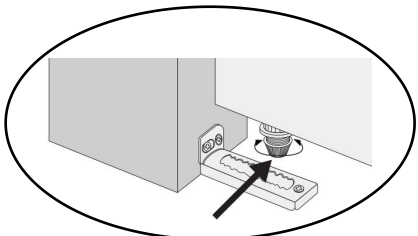

Step 3: Depress guide roller and insert it into the track.

Note: If the door is not well seated between the top pivot bracket and bottom pivot or it falls, adjust the bottom pivot by turning the screw clockwise or counterclockwise.

Fascia & Pull Installation

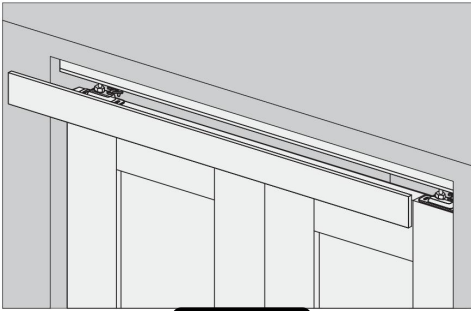
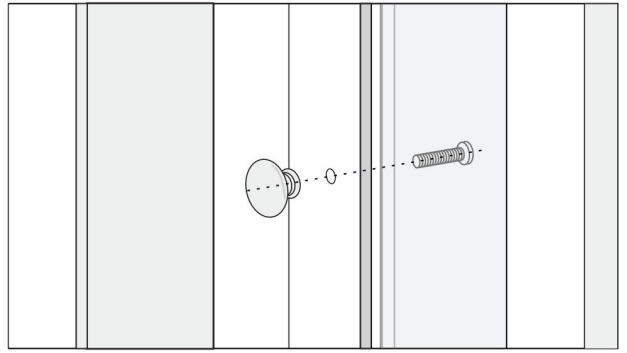
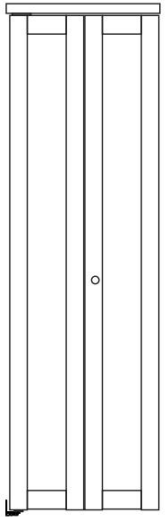

Figure 25

For 2-Door set : Remove the tape on the back of the fascia and attach it to the track with both ends flush with the track. Push it against the track as shown (Figure 25). Cut Fascia to fit if necessary (cut with Fascia front up).



- Use a pencil to mark the middle of the inner frame on the back of the door.
- Drill a hole on the marked position using 3/16" drill bit.
- Insert the machine screw into the hole and fasten the pull to the door.



Bifold Door Installation Guide

Including(2 Door Set) For 4 Door Set: Refer to Page 8-14

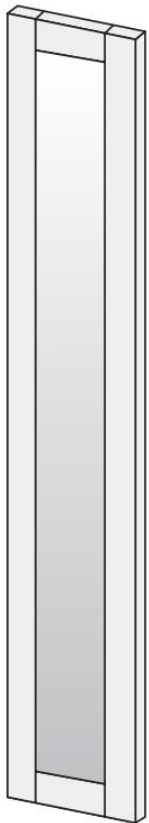

(4) Door Panel

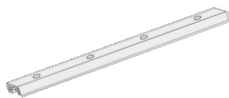

Track x 2

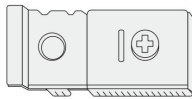

Top Pivot Bracket x 2

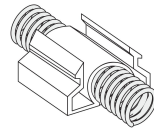

Snagger x 1

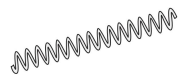

Spring x 1

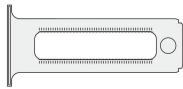

Jamb Bracket x 2

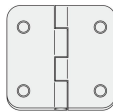

Hinge x 6



Guide Roller x 2



Top Pivot x 2

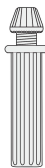

Bottom Pivot x 2



Pull x 2



Machine Screw x 2
(Pull)

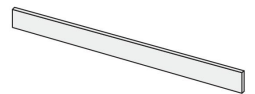

Fascia x 2



Fascia Block x 1
(for 4-Door installation)

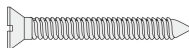

Long Screw x 16



Short Screw x 24

Tools Required:

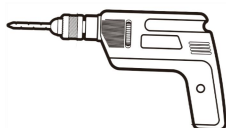

Driller



Measuring Tape



Pencil

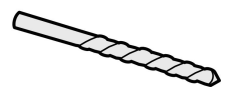

1/8" Drill Bit
3/16" Drill Bit

Preparation

In case of questions or missing parts, please contact
Dooraftersale@gmail.com

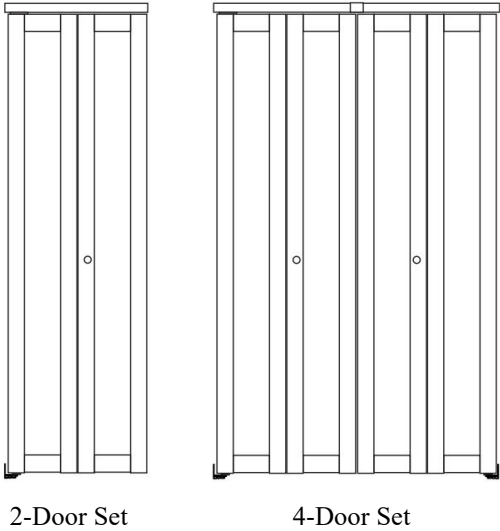

**2 PERSONS
ASSEMBLY**



**UP TO 30MIN
ASSEMBLY**



Scan this QR code to access
the installation video

Note:

- Wear Safety Goggles
 - Dimensions are in inches
Millimeters are shown in brackets
 - Fits normal finished opening height of 80 1/2"
 - 2-Door and 4-Door Installation below.
- For 4-Door Installations, 2(two) 2-Door sets will need to be purchased

Track Installation

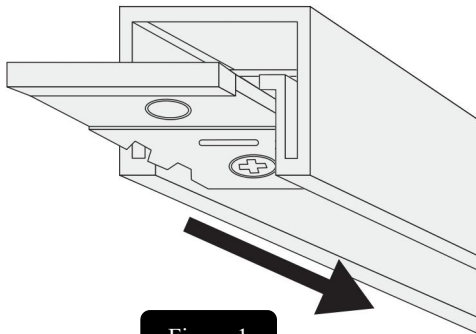

Figure 1

Step 1: Insert top pivot bracket into track as shown (Figure 1).

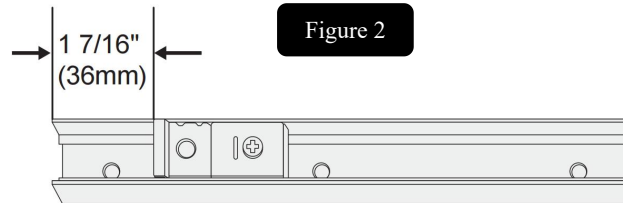

Figure 2

Step 2: Secure top pivot bracket as shown (Figure 2). The distance from the edge of top pivot bracket to the edge of track should be 1 7/16" (36 mm).

Note: Verify continuous parallel alignment during mounting.

Install the other top pivot bracket using the same way.

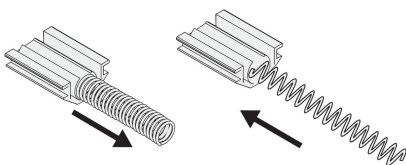

Figure 4

Step 3: Replace the short spring of the snigger with the long spring as shown.

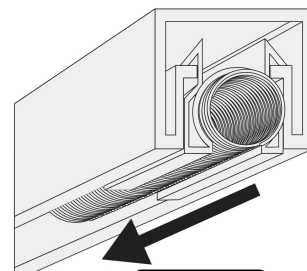
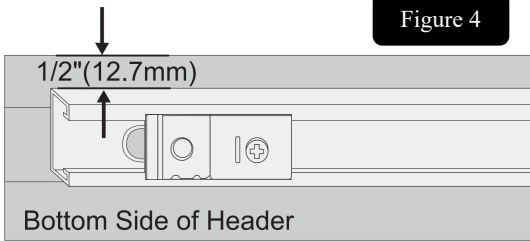

Figure 3

Step 4: Insert guide roller into the other end of track as shown (Figure 3).

Figure 4



Step 5: Install track onto the header as shown (Figure 4). The distance from track to the header edge should be 1/2" (12.7mm) as shown.

Note: If it is a left swing door, keep the left end of track tight against the left side jamb, vice versa.

Figure 5

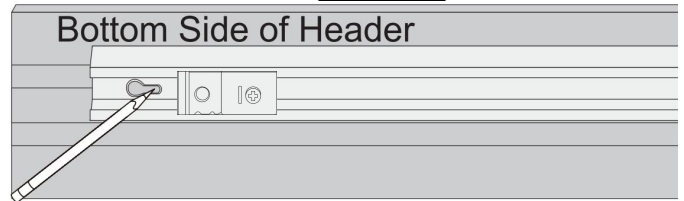

Step 6: Use a pencil to mark the places where holes are to be drilled. (Figure 5)

Figure 8

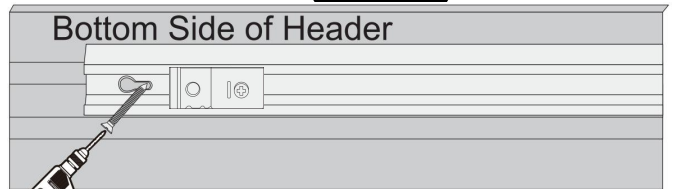

Step 8: Fasten track to the header using long screws (Figure 8).

Figure 7

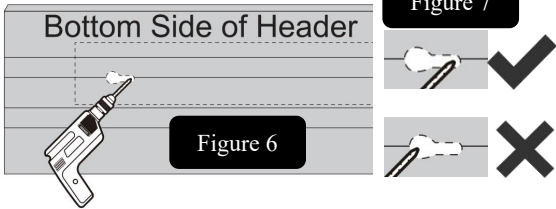

Step 7: Predrill 4 pilot holes on the header using 1/8" drill bit (Figure 6). **Note:** Predrill the holes on the retention slot. Do not predrill the holes on clearance hole (Figure 7).

Install the other track using the same way.

Step 9: Adjust the snugger until it connects the two tracks (Figure 8-1).

Lower Jamb Pivot Installation

Figure 9

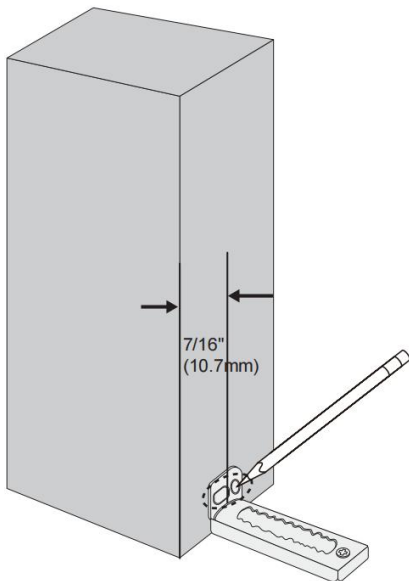
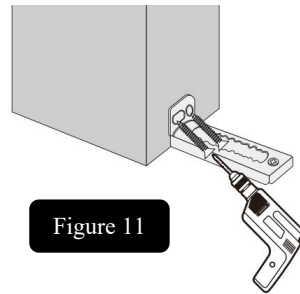
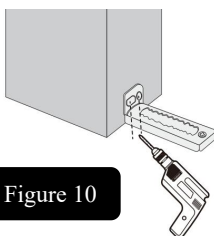

Figure 11



- **Step 1:** Place jamb bracket right under top pivot bracket, tight to the floor. The distance from jamb bracket to the edge of the jamb should be 7/16" (10.7mm) as shown (Figure 9). Use a pencil to mark the 2 places where holes are to be drilled as shown (Figure 9).
- **Step 2:** Predrill the marked places using 1/8" drill bit (Figure 10).
- **Step 3:** Fasten jamb bracket to jamb using long screws as shown (Figure 11).

Figure 10



Install the other jamb bracket using the same way.

Hinge Installation

Note: The side with predrilled holes is the back side of the door.

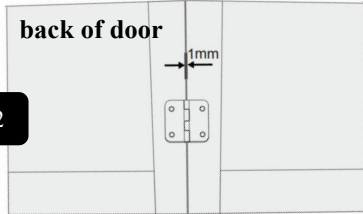

Figure 12

Step 1: Place door panels flat on a platform with the back side facing up. Maintain a "1 mm" gap between the door panels as shown to ensure proper opening and closing (Figure 12).

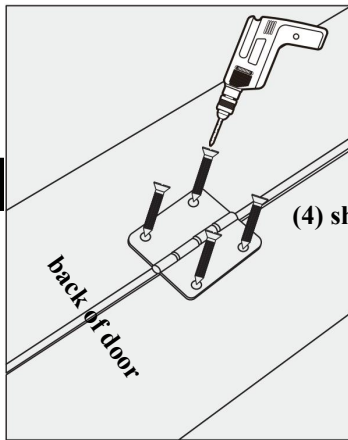
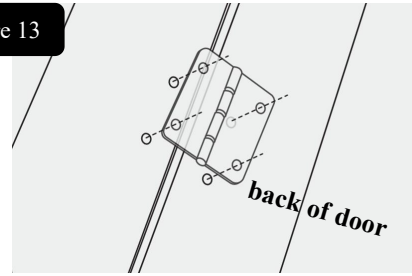

Figure 14

Step 3: Fasten the hinge to the door using short screws (Figure 14).

Figure 13



Step 2: Attach the hinge onto the top of the door as shown, aligning the holes on the hinge with the predrilled holes on the door (Figure 13).

Step 4: Install the rest two hinges using the same way.

Door Brackets Installation

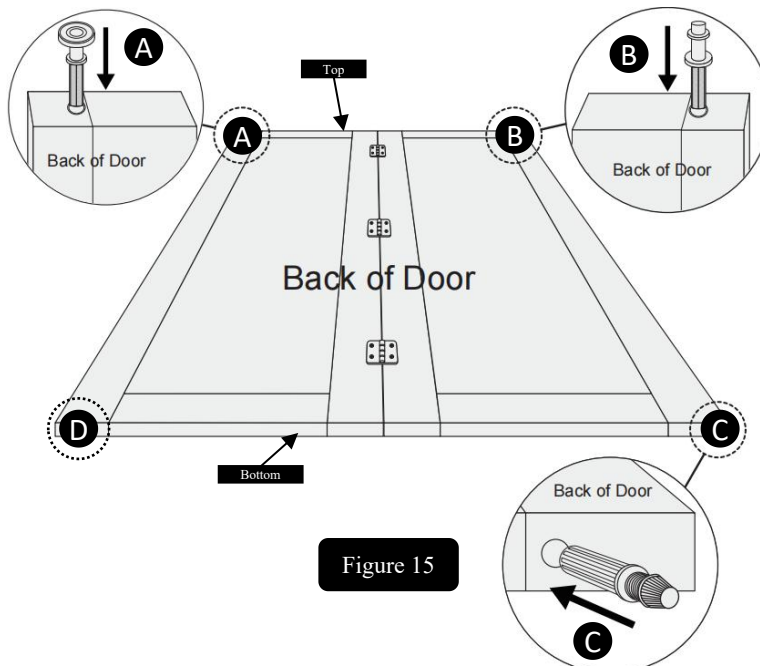

Figure 15

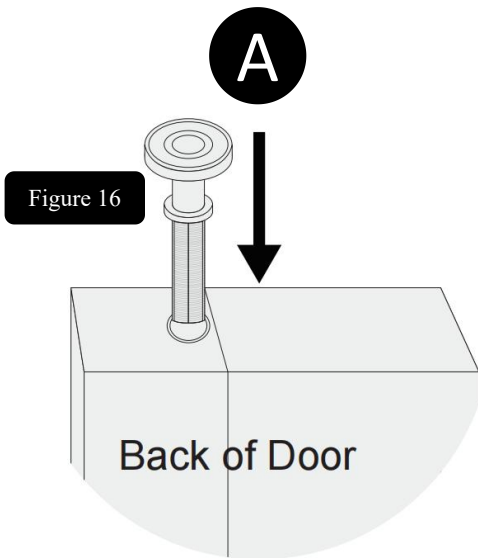

Figure 16

Top Left Corner "A" - Back View

1. Determine whether your door is a left swing or right swing door.
2. If it is a **left** swing door, install **guide roller** on the upper left corner "A" of the back side of the door by inserting it into the predrilled hole (Figure 15 & Figure 16).
3. If it is a **right** swing door, install **upper pivot** instead.

Detailed mounting information can be found in Table 1 & Table 2 on the following page.

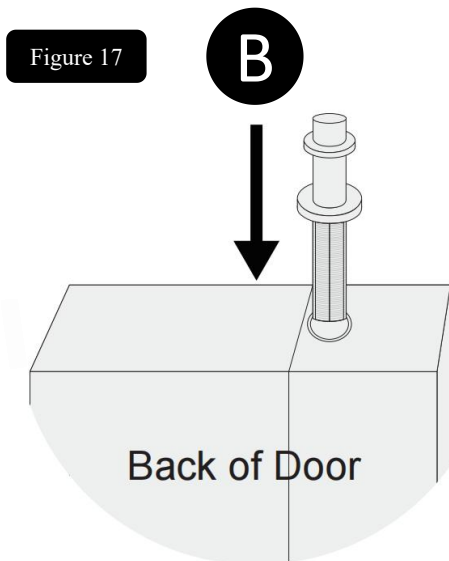

Figure 17

Top Right Corner "B" - Back View

1. If your door is a **left** swing door, install **upper pivot** on the upper right corner "B" of the back side of the door (Figure 15 & Figure 17).
2. If your door is a **right** swing door, install **guide roller** instead.

Detailed mounting information can be found in Table 1 & Table 2 on the following page.

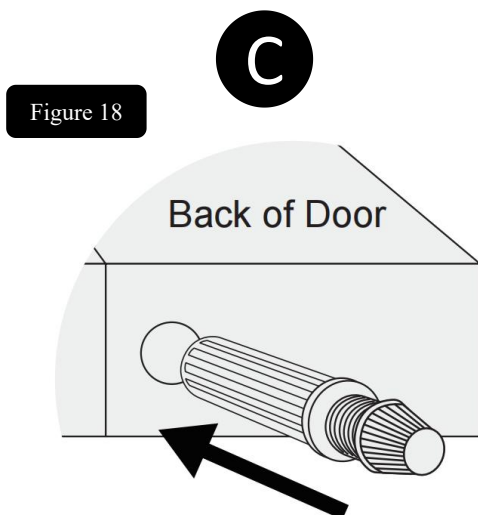

Figure 18

Bottom Left/Right Corner "C" / "D" - Back View

1. If your door is a **left** swing door, install **bottom pivot** on the bottom right corner "C" of the back side of the door (Figure 15 & Figure 18).
2. If your door is a **right** swing door, install **bottom pivot** on the bottom left corner "D" of the back side of the door.

Detailed mounting information can be found in Table 1 & Table 2 on the following page.

Table 1

Left Swing / Back View				
	Top Left	Top Right	Bottom Left	Bottom Right
Required Hardware	guide roller	Top Pivot	/	Bottom Pivot

Table 2

Right Swing / Back View				
	Top Left	Top Right	Bottom Left	Bottom Right
Required Hardware	Top Pivot	guide roller	Bottom Pivot	/

Door Installation

Figure 19

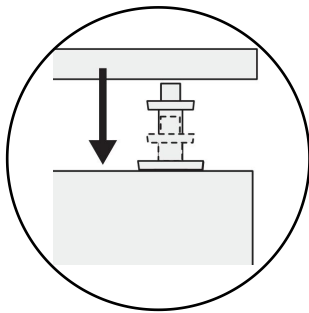

Step 1: Insert top pivot into the hole of top pivot bracket by depressing the top pivot.

Step 2: Lift the door and place bottom pivot into jamb bracket.

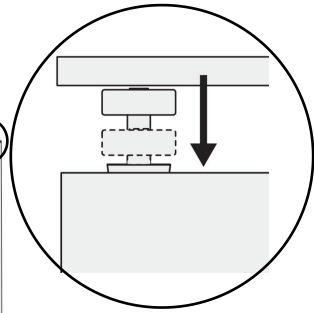
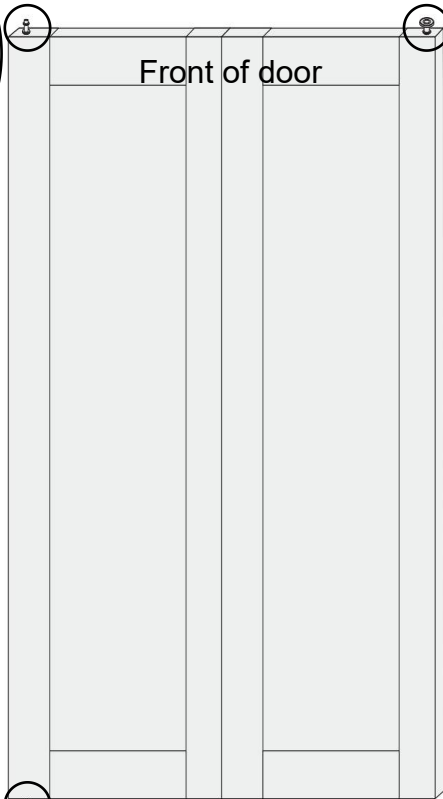
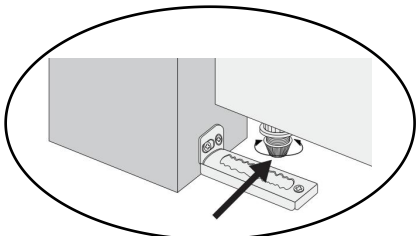

Step 3: Depress guide roller and insert it into the track.

Note: If the door is not well seated between the top pivot bracket and bottom pivot or it falls, adjust the bottom pivot by turning the screw clockwise or counterclockwise.

Install the other door set using the same way.

Fascia & Pull Installation

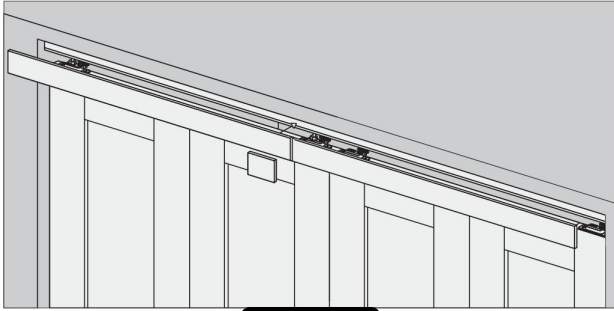
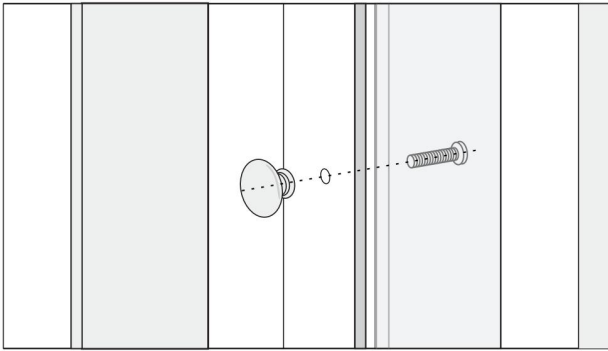

Figure 26

Cut Fascia to fit if necessary (cut with Fascia front up).

Remove the tape on the back of the fascia and attach it to the upper corner of the track with both ends flush with the track. Push them against the track as shown (Figure 26). Then attach the fascia block to the fascia by removing the tape on the back.



- Use a pencil to mark the middle of the inner frame on the back of the door.
- Drill a hole on the marked position using 3/16" drill bit.
- Insert the machine screw into the hole and fasten the pull to the door.