

# FITTING OF ANTI-TIP SAFETY STRAP

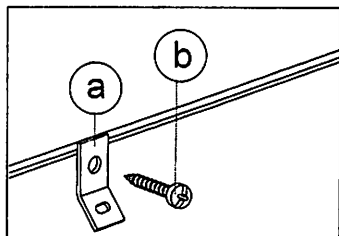

## STEP 1:

- Attach the mounting bracket (a) to the furniture in the solid part below the top panel a few inches away from the side of the unit.
- Screw (b) through the smallest hole of (a).

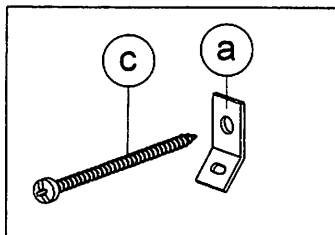
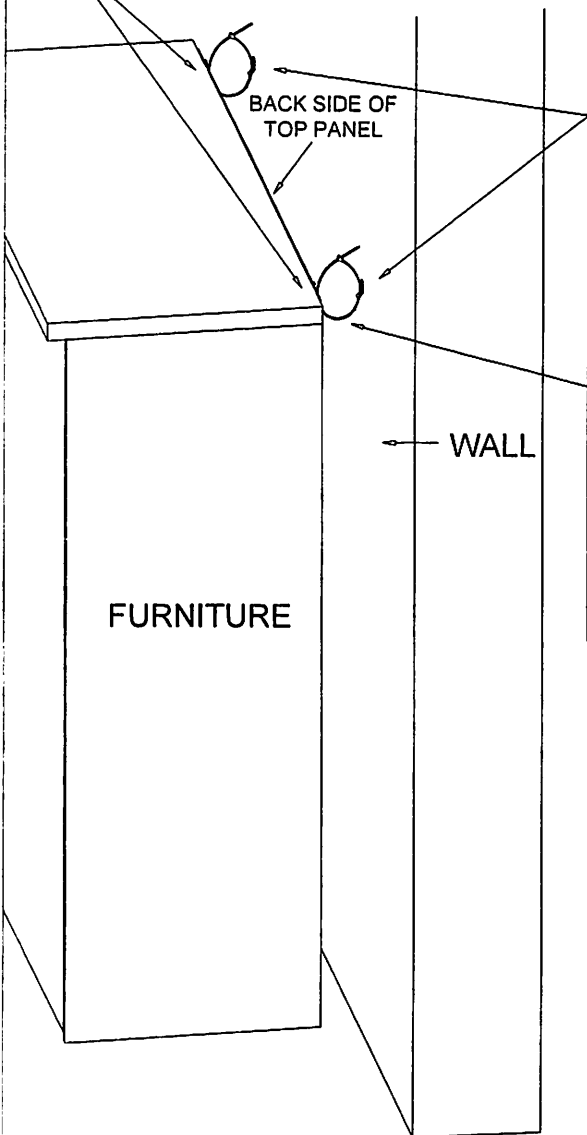

## STEP 2:

- Locate a stud in the wall behind the unit, does not have to be centered
- Place the other mounting bracket (a) on the wall stud 2 inches below the mounting bracket secure to the back of your unit.
- Attach to the wall stud using (c) through the smaller hole of (a).

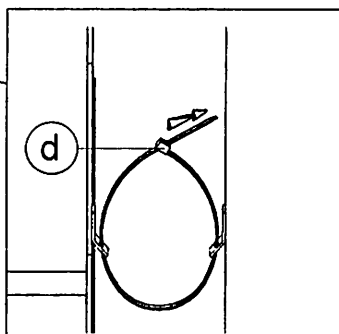

## STEP 3:

- Repeat the same step a few inches away from the other side of the unit.
- Place the furniture into position so both mounting brackets are vertically in line.
- Lace the end of the restraint strap through the larger holes in each mounting bracket.
- Secure the straps and lock into place.

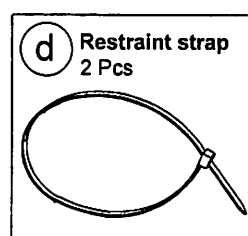
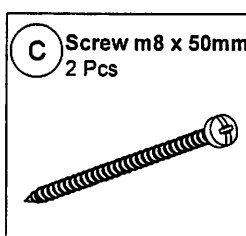
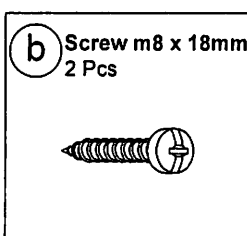
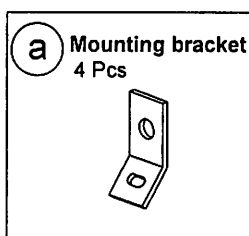

**STEP 13** Screw the Plastic Leg L Shape (L2) at between panel no. 17 & side panel. Assemble the L Bracket (R1) at between panel no. 14 & 17.

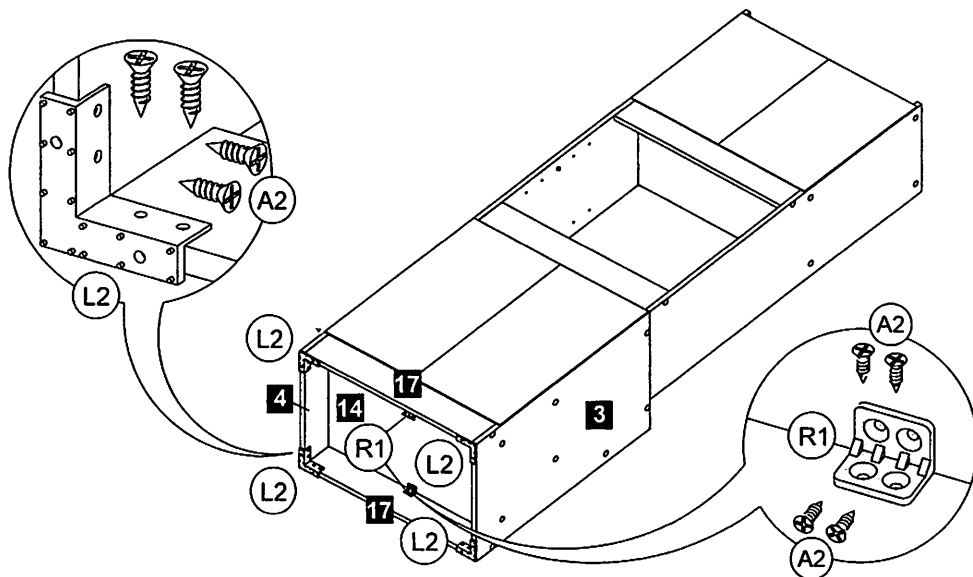

**STEP 14** Attach door & adjusting the Hinges (E9) to panel no. 5 & 6. Adjust the door gap.

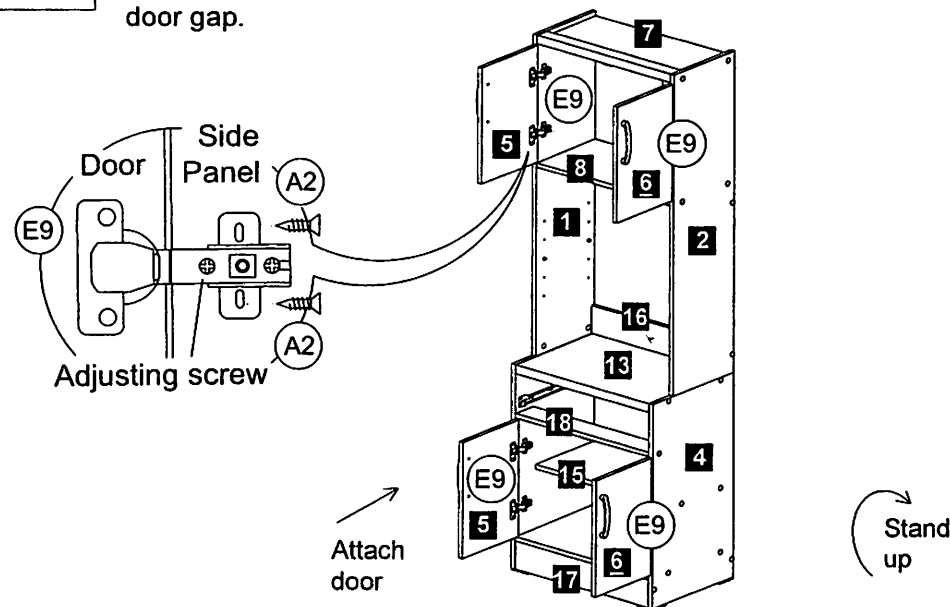

**STEP 15** Insert the panel no. 9 & drawer to the unit.

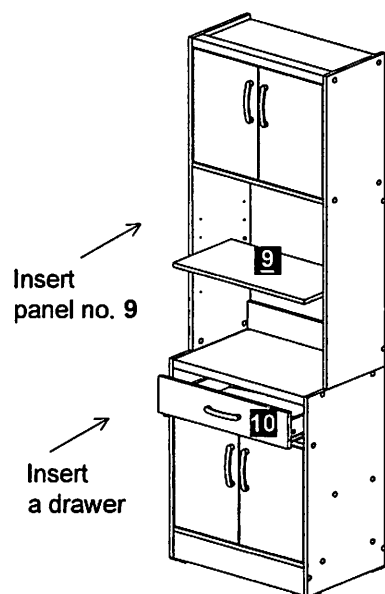

**COMPLETE**

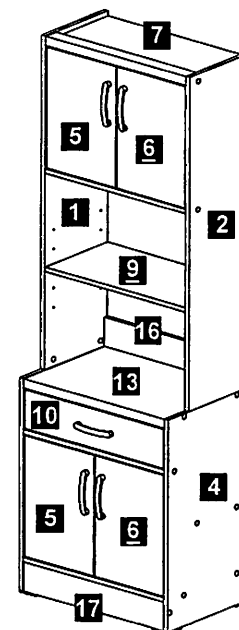

**STEP 9** Use Allen Key (N1) to tighten the Crosshead Screw 6.3 x 40mm (A17) & button the screw head with Crosshead Cover (Y).

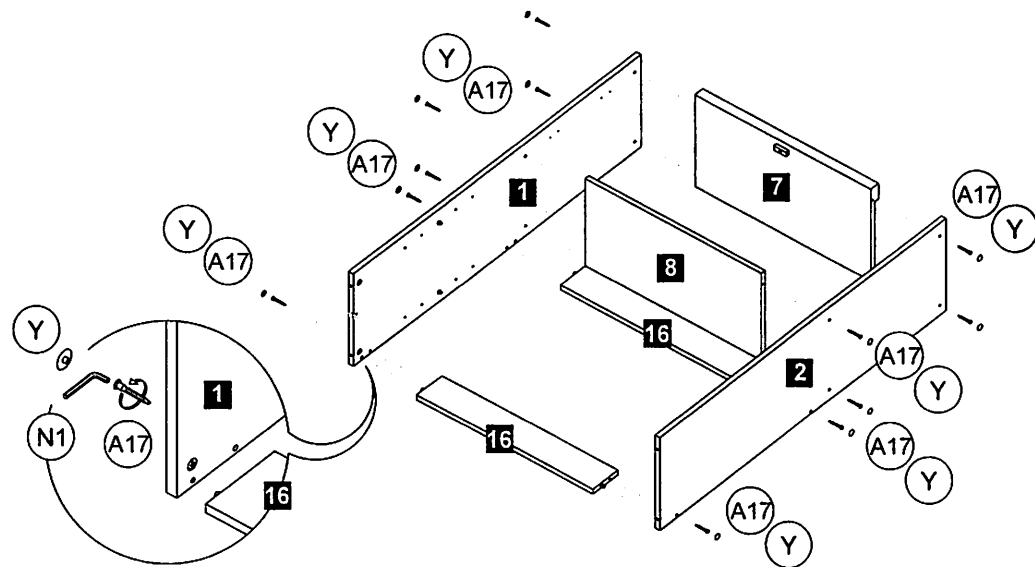

**STEP 10** Use Allen Key (N1) to tighten the Crosshead Screw 6.3 x 40mm (A17) & button the screw head with Crosshead Cover (Y).

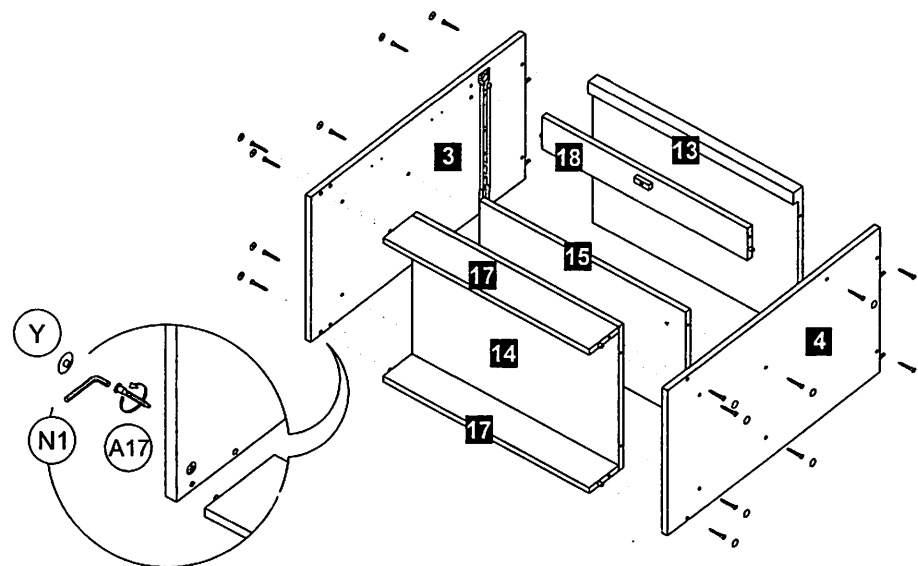

**STEP 11** Assemble the upper unit to the main unit by using Mini Fix 15mm (F2) & cover the Mini Fix by using Mini Fix Cap (Y).

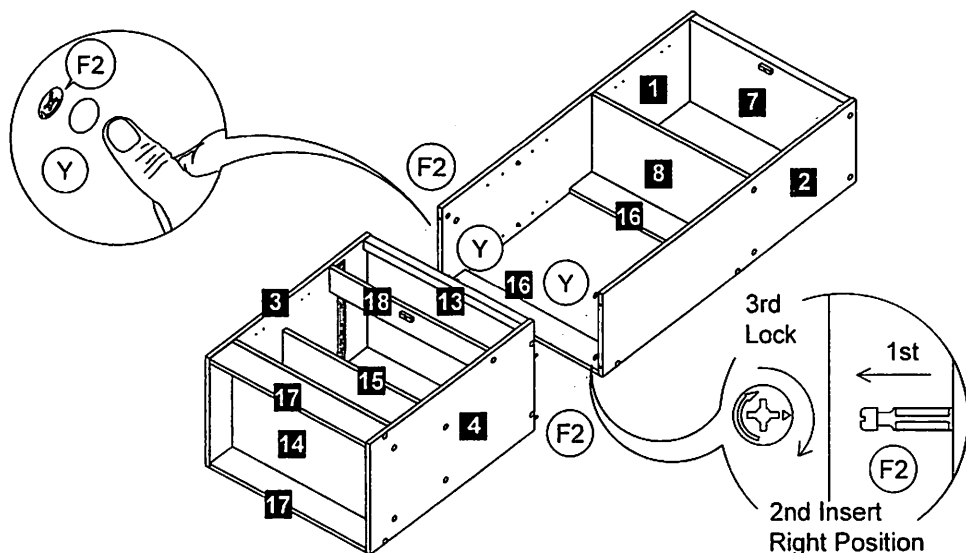

**STEP 12** Assemble the back panel no. 21 & 22 with secure by Nail (N3).

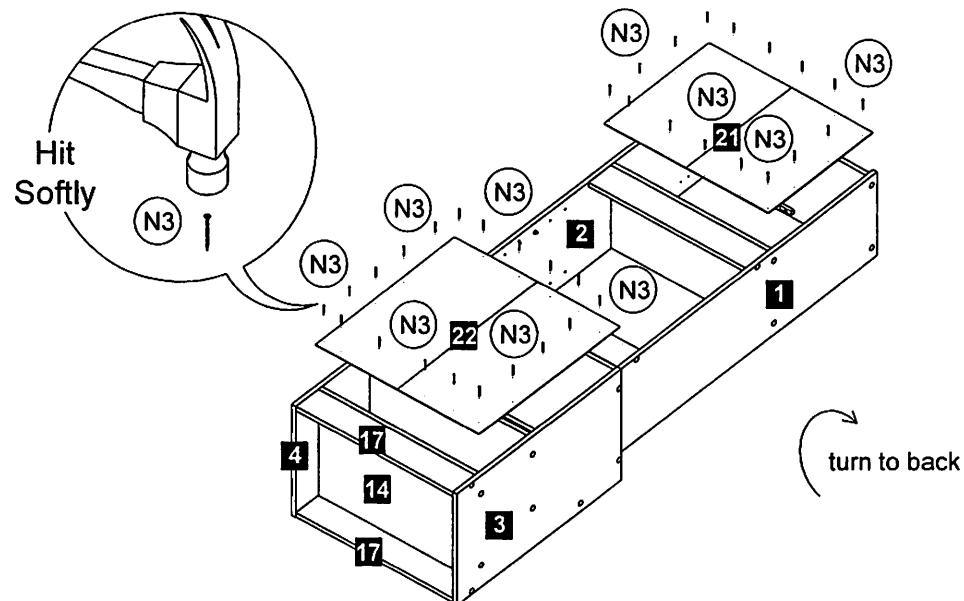

**STEP 5** Insert the Plastic Shelf Holder (Q1) & Mini Fix Bolt (F2) at panel no. 1 & 2.

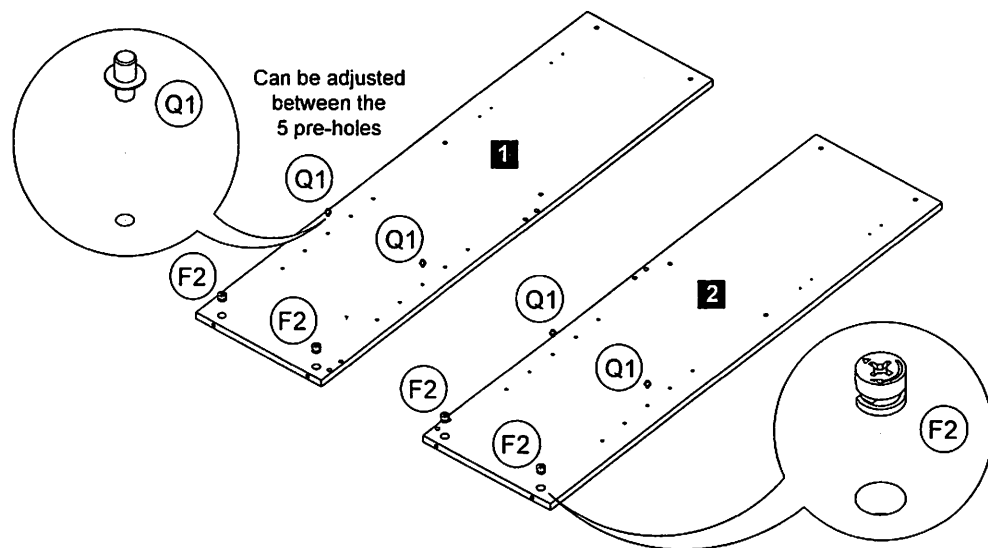

**STEP 6** Insert the Mini Fix Bolt (F2) & use Two Screws (A34) to assemble left & right Drawer Metal Slide 350mm (D6) at marking hole at panel no. 3 & 4.

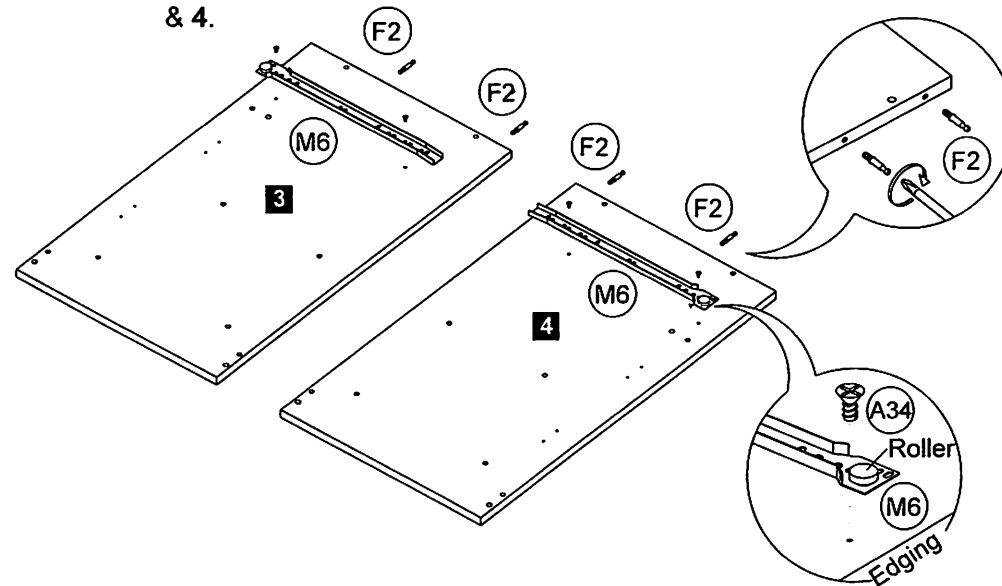

**STEP 7** Assemble each hardware with a different size screw at door panel no. 5 & 6.

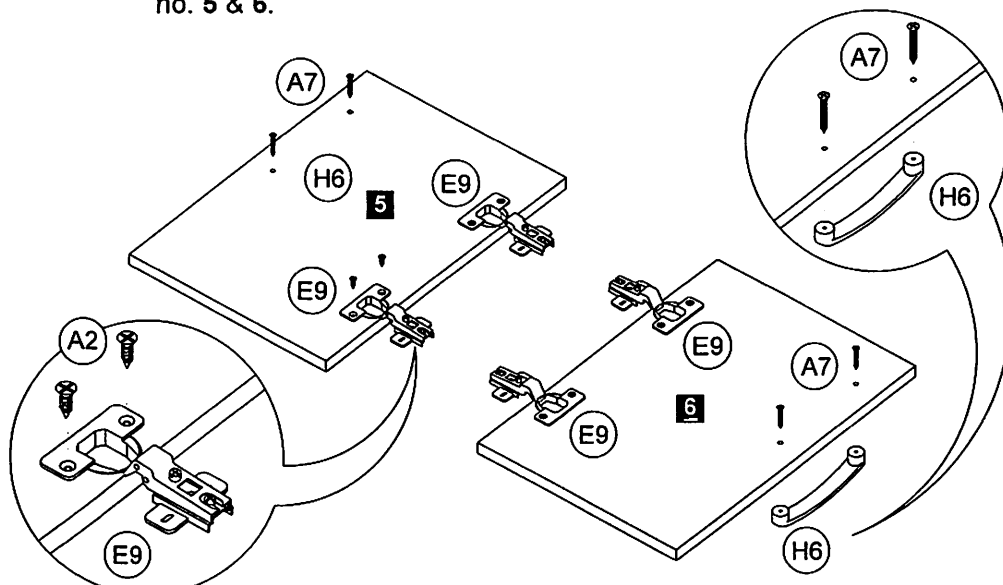

**STEP 8** Insert the Door Stopper (S2) at panel no. 7 & 18. Insert the Wood Dowel 8 x 25mm (D6) at panel no. 16, 17 & 18.

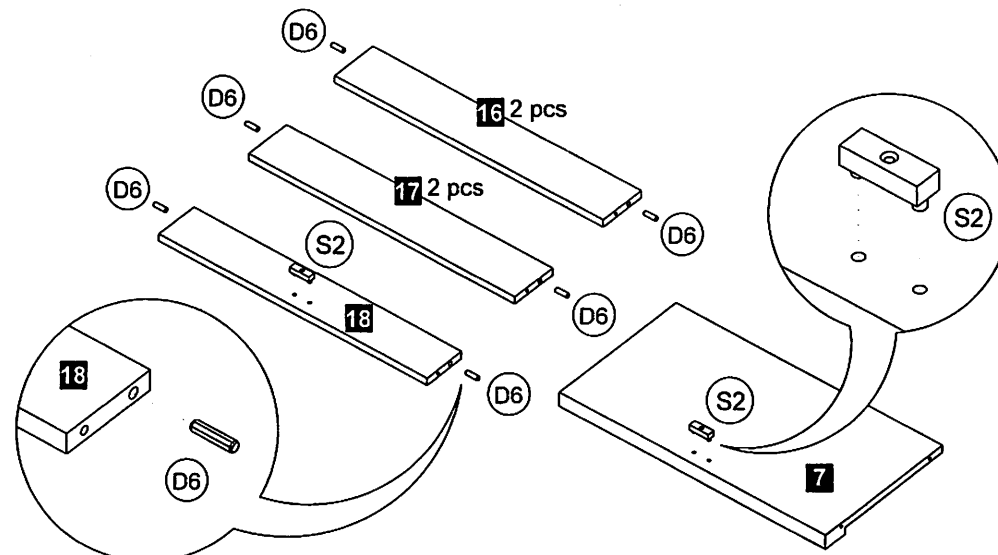

- STEP 1** Fix the Mini Fix Bolt (F2) and use Screw m4 x 30mm (A7) to secure the Handle (H6) at panel no. 10. Insert Mini Fix Cam (F2) & Wood Dowel 6 x 25mm (D4) at panel no. 11 & 12.

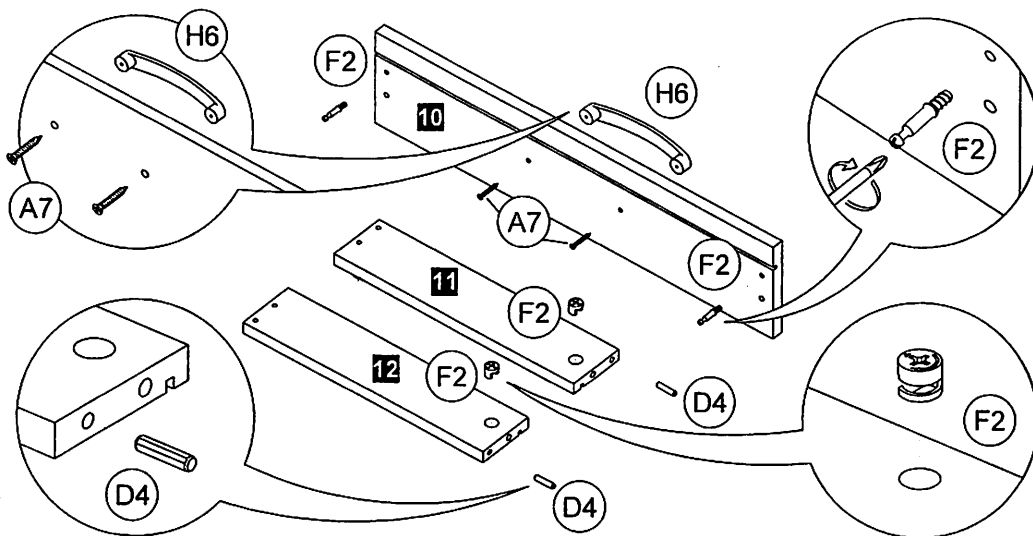

- STEP 2** Use Screw m4 x 38mm (A10) to assemble the drawer frame.

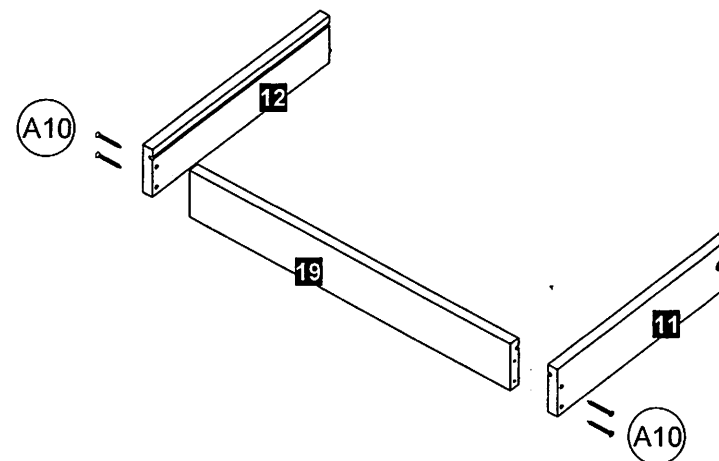

- STEP 3** Slide the panel no. 22 along the groove until end. Then, assemble panel no. 10 by using Mini Fix 15mm (F2).

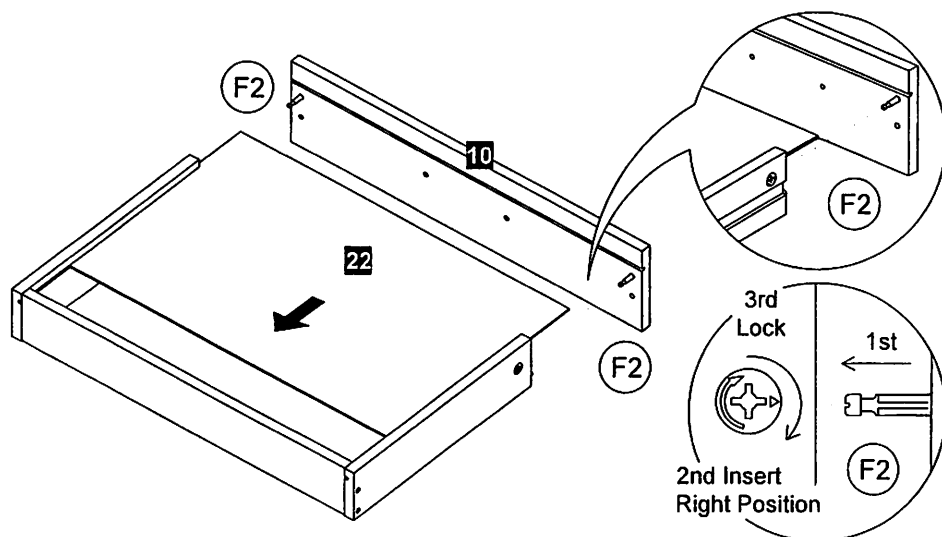

- STEP 4** Use Screw m3.5 x 14mm (A2) to assemble the Drawer Metal Slide 350mm (M6) & Single Plastic Cap (R2).

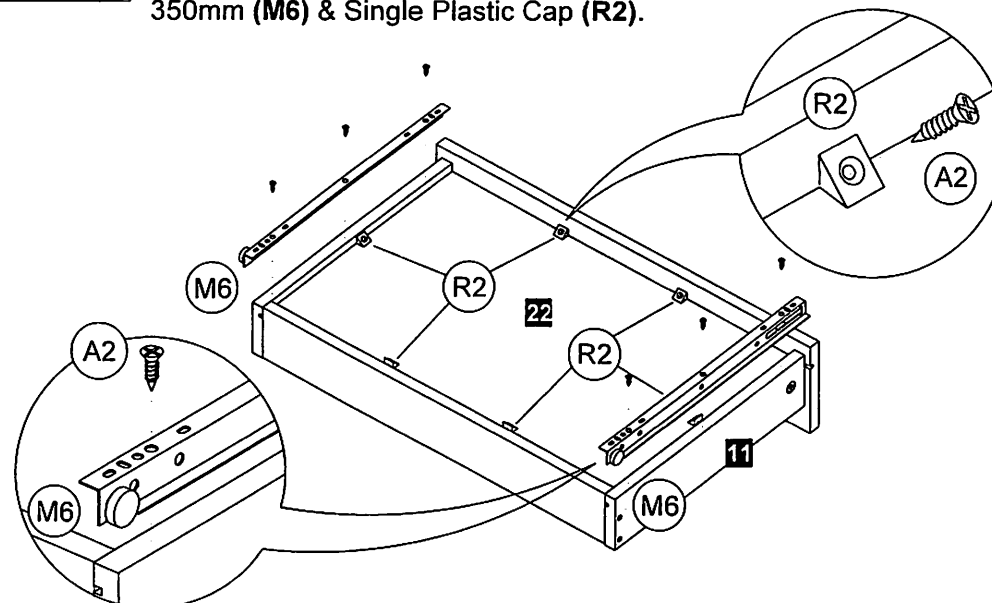

Reference Screw Size.

Place your screw on top to identify the size

A2



Screw  
m3.5 x 14mm

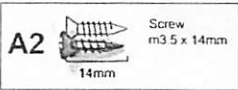

A17

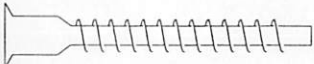

Crosshead Screw  
6.3 x 40mm

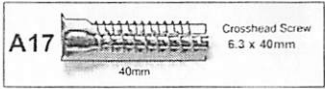

A7



Screw  
m4 x 30mm

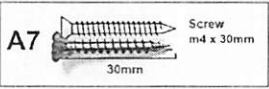

A34



Euro Screw  
m5 x 8mm

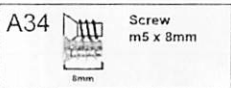

A10



Screw  
m4 x 38mm

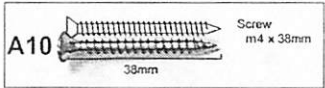









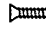
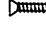
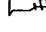
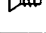
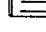
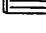

**Before you begin, please follow assembly instruction carefully, then follow step by step.**

Read instruction carefully. See furniture Parts List and Hardware List for guidance. Be sure you have all parts before you start assembling. Place and assemble furniture on a clean flat soft surface, such as carpet, rug or carton to prevent being scratched.

### Reminder :

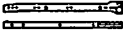
Please ensure that all surface and edges with colours / laminations are facing forward / outward.

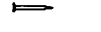
HARDWARE LIST			QTY
A2		Screw m3.5 x 14mm	68
A7		Screw m4 x 30mm	10
A10		Screw m4 x 38mm	4
A17		Crosshead Screw 6.3 x 40mm	30
A34		Euro Screw m5 x 8mm	4
D4		Wood Dowel 6 x 25mm	2
D6		Wood Dowel 8 x 25mm	10
E9		Door Hinges 7/8"	8
E21		Anti-Tipping Kit	2 Sets
F2		Mini Fix 15mm	6 Sets

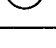
H6		Handle 128mm (Silver)	5
L2		Plastic Leg L Shape	4
M6		Drawer Metal Slide 350mm	1 Set
N1		Allen Key	1
N3		Nail	35 (+3)
R1		L Bracket	2
R2		Single Plastic Cap	6
S2		Door Stopper	2
Q1		Plastic Shelf Holder	4
Y		Crosshead Cover / Mini Fix Cap	34

Each pack have contain different type hardware and size of screw for easy assemble.  
Please refer to page 2, check a screw size.

### CAUTION

MATERIAL USE LAMINATED PARTICLE BOARD, TO CLEAN USE SOFT, DRY CLOTH. DO NOT USE DETERGENT OR CHEMICAL  
AVOID CONTACT WITH WATER AND DIRECT SUNLIGHT. TO BE ASSEMBLED ON A SOFT, DRY, CLEAN SMOOTH SURFACE.



USE OF POWER TOOLS TO ASSEMBLE THIS PRODUCT WILL INVALIDATE  
ANY CLAIM AND MAY DAMAGE THIS PRODUCT MAKING IT UNSAFE.

